

Path: \\mcc\dfs\resources\Local\Clients\KCM\ENR\103828_Sweetland\Wind\ArcGIS\Geospatial\DataFiles\ArcDocs\PUC_A-9_WaterResourcesNEW.mxd apwoehler 3/4/2019
 COPYRIGHT © 2019 BURNS & MCDONNELL ENGINEERING COMPANY, INC.
 Service Layer Credits: Esri, HERE, Garmin, © OpenStreetMap contributors, and the GIS user community

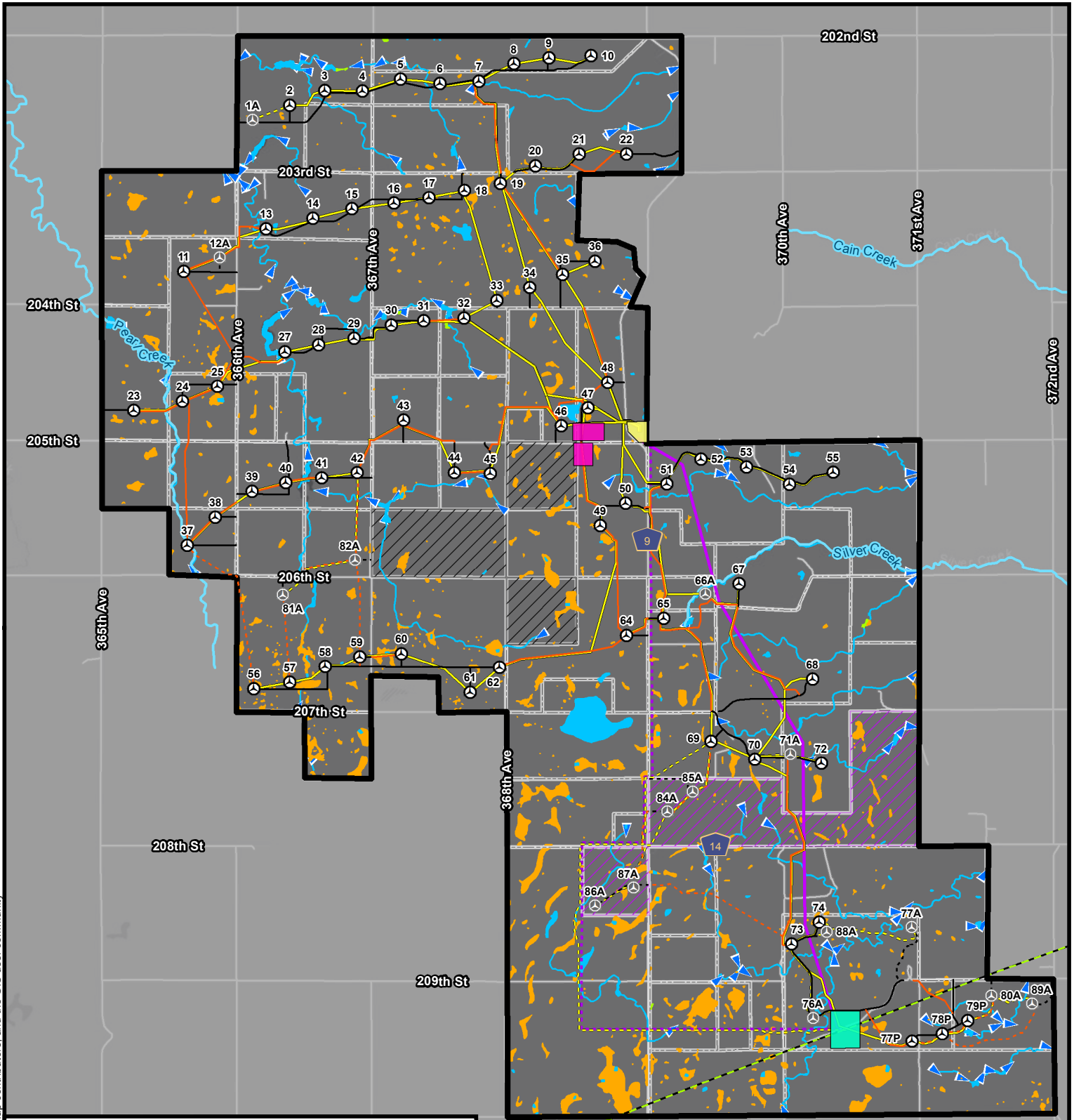

- | | |
|----------------------------------|---|
| Project Area | WAPA 230-kV Transmission Line |
| Primary Turbine | Local Street |
| Alternate Turbine | Parcels |
| Crane Path Primary | Participating |
| Crane Path Alternate | Pending Participation |
| Collection Line Primary | Not Participating |
| Collection Line Alternate | River |
| Wind Turbine Access Road Primary | NHD Flowline with Flow Direction |
| Wind Turbine Access Road | National Wetland Inventory Wetland |
| Transmission Facility Preferred | Freshwater Emergent Wetland |
| Transmission Facility Alternate | Freshwater Forested/Shrub Wetland |
| Laydown Yard/O&M Facility | Freshwater Pond/Lake |
| Substation | |
| Switchyard | |

0 0.5 1
 Miles

BURNS & MCDONNELL SM

Figure A-9
 Water Resources
 Sweetland Wind Farm, LLC
 Hand County, South Dakota