

Crooks: T102N R50W S2

1. BEGINNING at the NW corner of Government Lot 1 in the NW ¼ of Section 2 of T102N, R50W, Minnehaha County,
2. THENCE continue east to the NE corner of Government Lot 1 in the NW ¼ of Section 2,
3. THENCE continue south to the SE corner of the SW ¼ of Section 2,
4. THENCE continue west along the southern boundary of the SW1/4 of Section 2, to the centerline of the Burlington Northern/Santa Fe Railroad right-of-way in the SW ¼ of Section 2,
5. THENCE continue northwest following the center-line of the railroad right-of-way to a point that intersects with the far western boundary of Section 2,
6. THENCE continue north ending at the NW corner of Government Lot 1 in the NW ¼ of Section 2.

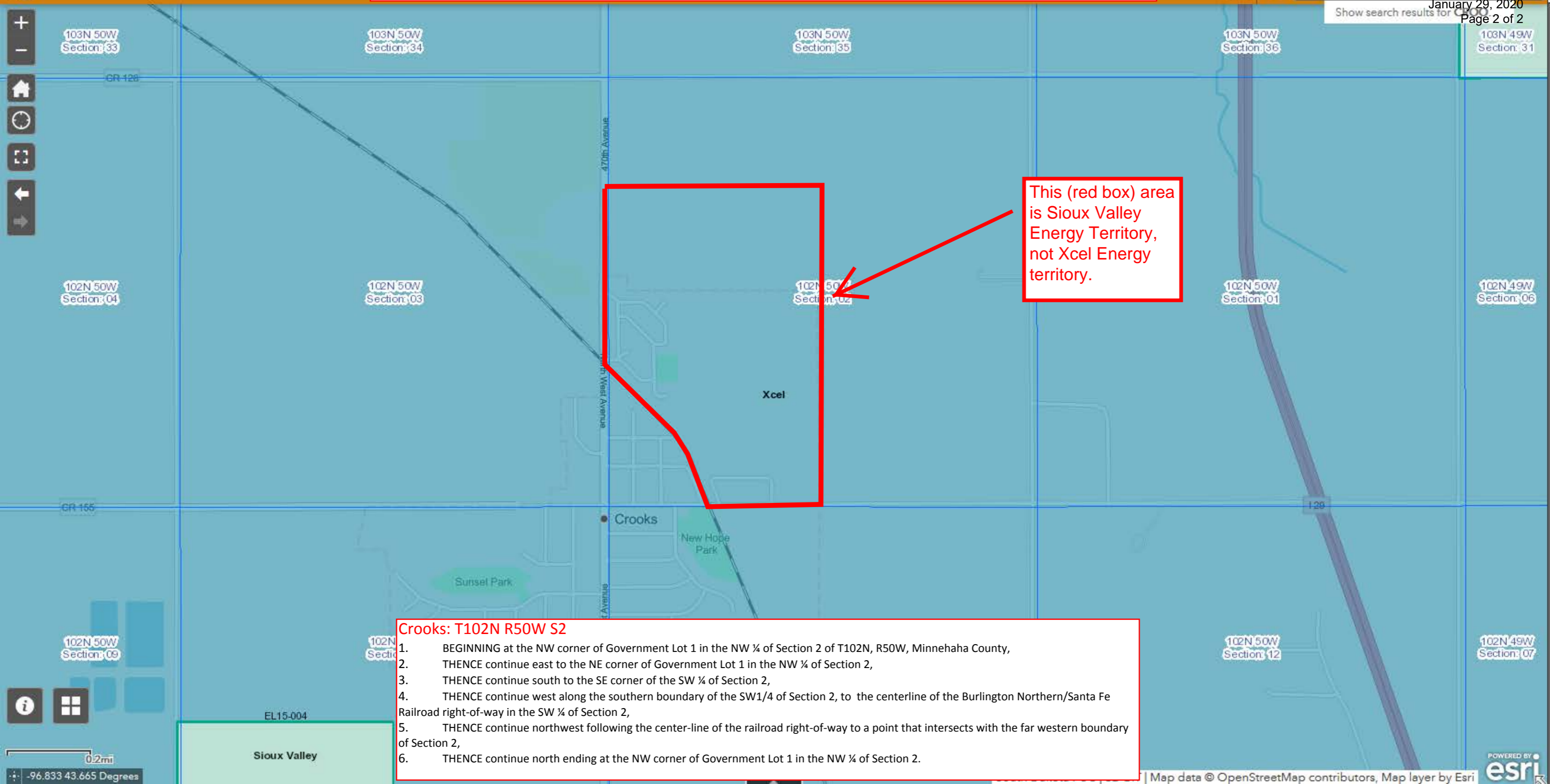

This (red box) area is Sioux Valley Energy Territory, not Xcel Energy territory.

Crooks: T102N R50W S2

1. BEGINNING at the NW corner of Government Lot 1 in the NW ¼ of Section 2 of T102N, R50W, Minnehaha County,
2. THENCE continue east to the NE corner of Government Lot 1 in the NW ¼ of Section 2,
3. THENCE continue south to the SE corner of the SW ¼ of Section 2,
4. THENCE continue west along the southern boundary of the SW1/4 of Section 2, to the centerline of the Burlington Northern/Santa Fe Railroad right-of-way in the SW ¼ of Section 2,
5. THENCE continue northwest following the center-line of the railroad right-of-way to a point that intersects with the far western boundary of Section 2,
6. THENCE continue north ending at the NW corner of Government Lot 1 in the NW ¼ of Section 2.

EL15-004
Sioux Valley