

**SOUTH DAKOTA DEPARTMENT OF TRANSPORTATION
APPLICATION FOR UTILITY PERMIT**

DOT-200 (9/15)

Permit No. _____

Highway No. 29 County _____ Grant _____ Approximately 10 Mi. ☐ N ☒ X ☐ S ☐ E ☐ W

from Summit (City or well defined point) for construction of Redundant fiber communications line
(type of utility facility)

Begin Legal Description Section 33, Township 121N, Range 51W End Legal Description Section 33, Township 121N, Range 51W

Intended usage or rating Redundant fiber optic communications cable as part of the Dakota Range III Wind Project

Cable Size/Type Fiber optic cable, size 50/125 Casing Size/Type 3mm outer diameter

Outsize pipe diameter _____ Maximum pipeline operation pressure _____

Minimum depth of cable or pipeline: (Under Rural Roadway 48") _____ (Under Curb/Gutter 24") _____ (All Other Areas 36") _____ (Overhead) X

Method of installation Overhead crossing on 2 pole structures.

Approximate construction dates – Start June 2020 Finish September 2020

Special conditions _____

I, the undersigned, request permission to construct and maintain a utility facility on public right-of-way at the above location and as shown on the attached layout sheet and in accordance with provisions of Administrative Rules of South Dakota, Chapter 70:04:05. In consideration for this permission, I agree to abide by all conditions of said rules and in addition, the following:

1. This Utility Permit does not replace any other permit, license, or other approval which may be required by any other entity holding a property interest in the right of way, including but not limited to any tribal government, the Office of School and Public Lands, the United States Forest Service and the Bureau of Indian Affairs. The issuance of this Utility Permit does not relieve the applicant of the obligation to obtain any other approvals that might be required for use of the highway right of way for utility purposes. The applicant is solely responsible for investigating whether additional approval is required and complying with any other applicable requirements. If the applicant fails to secure all necessary approvals or comply with all applicable requirements, this permit is of no effect whatsoever and the Department may, at the applicant's sole expense, cause the immediate removal of the utility facilities.
2. To furnish all materials, labor, incidentals and pay all costs involved with the construction and maintenance of the utility facility. To perform approved open cut trench operations in accordance with current DOT Open Cut Method of Utility Installation or Repair, Administrative Rule Chapter 70:04:05, Appendix A. To restore any damaged portions of the roadway and right-of-way to equal or better conditions than existed prior to beginning work covered by this permit. To not install a utility over the top of any highway drainage structure. To permanently mark above ground pedestals / facilities with metal flags or markers located at least 48" above ground.
3. If deemed necessary by the South Dakota Department of Transportation to move or alter the utility installation in any way due to maintenance or highway reconstruction within its present right-of-way width, the alteration will be accomplished by the owner without cost to the State.
4. To provide protection to highway traffic during construction and maintenance by the use of proper signs, barricades, flag persons and lights as prescribed in the "Manual on Uniform Traffic Control Devices."
5. Workers are required to wear high-visibility safety apparel intended to provide conspicuity during both daytime and nighttime usage, and meeting the Performance Class 2 or 3 requirements of the ANSI/SEA 107-2004 publication entitled "American National Standard for High-Visibility Safety Apparel and Headwear".
6. To indemnify and hold the State of South Dakota, its Department of Transportation, its officers, agents and employees harmless, from and against any and all actions, suits, damages, liability or other proceedings of any kind or nature brought because of any injuries or damage received or sustained by any person or property on account of the use or occupancy of highway right-of-way designated in this application.

Company Dakota Range III, LLC Date 6/8/2020 Email Address Lauren Kaapcke

Address 3760 State Street, Suite 200 City Santa Barbara State CA Zip 93105 Telephone (510) 320-1138

By: (Sig.) L Kaapcke (Typed) Lauren Kaapcke Title Wind Development Associate

To be completed by the Department of Transportation

Project 029 Milepost 200.0 Maintenance Unit 172

1. Prior to commencing construction and upon completion of work the applicant shall notify Matt Brey, Area Engineer at Watertown telephone 882-5166

2. Special Conditions: Poles and supports to be placed outside right of way. Contact SD DOT and SD Highway Patrol before work begins and prior to any disruption of traffic.

3. Failure to construct and maintain the utility facility in accordance with the provisions of this permit will automatically render this permit null and void and constitute grounds for its removal and/or full restoration of the site at the applicant's expense.

Recommended: _____

Approved: Mark Peterson City Representative Date 6/11/2020 Bridge/Roadway Design _____ Date _____

Approved: Mark Peterson Area Engineer Date 6/11/2020 This permit to construct and maintain a utility facility is granted subject to all conditions as herein stated.
Region Engineer Date _____

INSTRUCTIONS FOR DOT-200

APPLICANT:

1. Complete all items in upper portion of form. **Please print or type.**
2. Prepare a separate sheet showing details of the proposed installation. The drawings should include:
 - a. Location of the facility dimensioned to the highway centerline and to the right-of-way line. Show all section lines and approaches that will be crossed. Show legal description on drawing, i.e., Section, Township, and Range for rural areas and Blocks and Lots in urban areas. Show box culverts, bridges and any other permanent features. No utility installation will be allowed on top of drainage pipes.
 - b. Installations on bridges must include details of method of attachment. Allow two (2) additional weeks for approval of the permit.
 - c. Utility company name, a North arrow, sheet number and total number of sheets if more than one. **Use one side of sheet only.**
 - d. Any other pertinent information.
3. Sign and submit one (1) copy of the request and one (1) copy of the attachment to the SDDOT Area Engineer for processing.

DEPARTMENT OF TRANSPORTATION:

Area Engineer:

1. Review request and complete lower portion of form.
2. If request is not approved, return request to applicant stating reason for denial.
3. Obtain city recommendation and DOT Bridge/Roadway Design approval when applicable.
4. Forward to Region Engineer only if application location is within Interstate ROW.
5. If request is approved, forward request and all attachments to the Permit Manager, Office of Right of Way.

PERMIT MANAGER:

1. Review request and if denied, return to applicant stating reason for denial with copy to Area Engineer.
2. If request is granted, issue permit and send copies of the permit and attachments as follows:
Area Engineer (2 copies); Applicant (1 copy), and Record Center (original).

AREA ENGINEER ADDRESS AND APPROXIMATE COVERAGE AREA BY COUNTY:

PO Box 1767, Aberdeen: Brown, Day, Edmunds, McPherson and Marshall.

5000 9th Ave SE, Watertown: Brookings, Codington, Deuel, Grant, Hamlin and Roberts.

PO Box 940 Huron: Beadle, Clark, Hand, Hyde, Kingsbury and Spink.

PO Box 1206, Mitchell: Aurora, Brule, Buffalo, Charles Mix, Douglas, Davison, Gregory, Hanson, N. & W. Hutchinson, Jerauld, McCook, W. Miner and Sanborn.

5316 W. 60th St. N., Sioux Falls: Lake, N. Lincoln, N.E. Miner, Minnehaha, Moody and N.E. Turner.

1306 W. 31st St., Yankton: Bon Homme, S. Charles Mix, Clay, S. & E. Hutchinson, S. Lincoln, S.W. Turner, Union and Yankton.

104 S. Garfield, Pierre: Haakon, Hughes, I90 N. in Jackson and Jones, Stanley, Sully and Potter.

PO Box 771 Winner: Bennett, Lyman, Mellette, Todd, Tripp and I90 S. in Jackson and Jones.

PO Box 488, Mobridge: Campbell, Corson, Dewey, Walworth and Ziebach.

PO Box 1970, Rapid City: W. Jackson, I90 S. in Lawrence, SD34 S. in Meade and Pennington.

10921 SD Hwy 34, Belle Fourche: Butte, Harding, N. Lawrence, N. Meade and Perkins.

PO Box 431, Custer: Custer, Fall River, Oglala Lakota and S.W. Pennington.

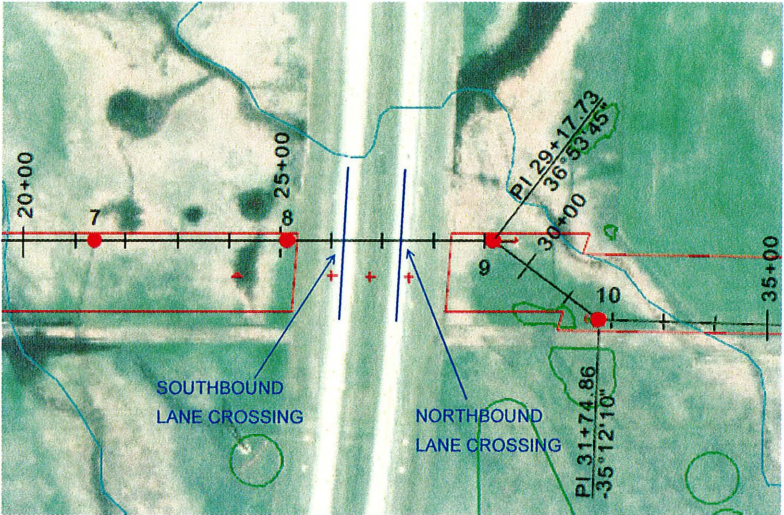
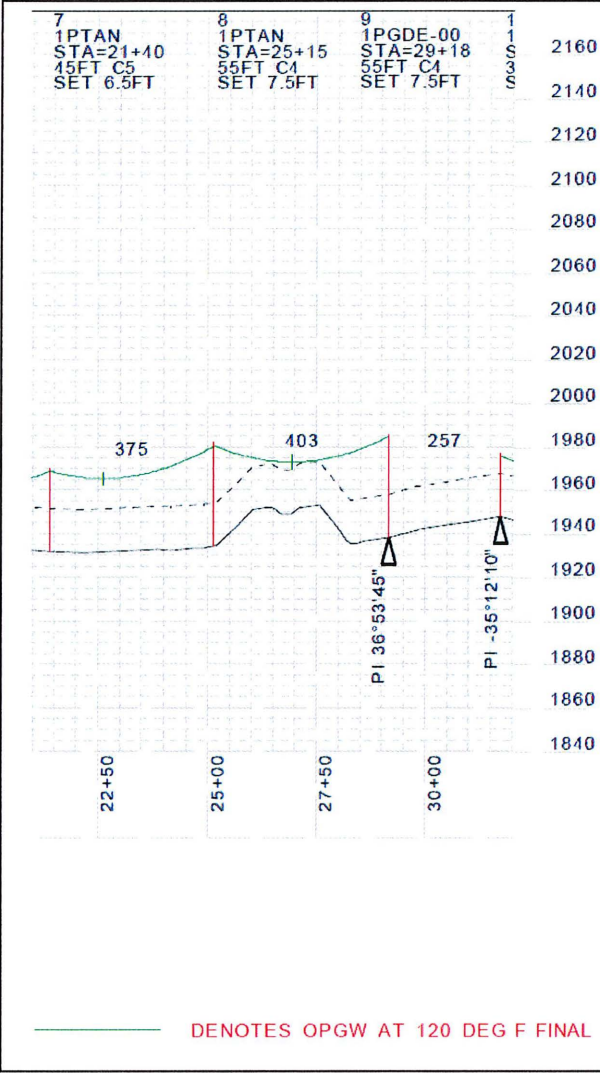

NOTES:

GRANT COUNTY

SOUTHBOUND CROSSING: LAT: 45.209692
LON: -97.051356

NORTHBOUND CROSSING: LAT: 45.209685
LON: -97.050935

STR 8 TO SOUTHBOUND LANE EDGE: 80 FT
STR 9 TO NORTHBOUND LANE EDGE: 170 FT

CLEARANCE: 30 FT

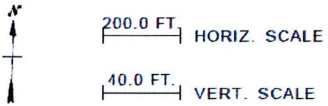

BY AMERICAN ENERGY, INC. FOR DAKOTA RANGE III WIND PROJECT	DAKOTA RANGE III WIND PROJECT REDUNDANT FIBER CROSSING HWY 81
--	---