

First, I would like to thank the PUC for being here to listen to our community.

I am Lori Fuerniss. I live at ^{spell name} [REDACTED] Delmont, SD 57330.

Our family lives roughly 1-1 1/4 miles from the Beethoven Wind farm. And we do hear the turbines in our yard and they are much louder than the noise of a refrigerator. But I am not here to talk about the sound these giants make but I would like to share how our life has been since the Beethoven turbines are running. My husband's sleeping pattern started to change...waking up during the night. I ~~was~~ joked about it ~~for~~ saying that the wind turbines were getting to him. But after sometime I ^{decided} ~~thought~~ that this was ~~not~~ no joke ~~at all~~ after noticing that I was not sleeping normally anymore. I have gone from 8 hours of sleep ~~at night~~ to 4-6 hours of not so good sleep each night as they are 2 hours of sleep then awake and 2 or 3 more hours of sleep. I did some research and found that this has nothing to do with the actually sound that we hear from the turbines but the infrasound-sounds we don't hear and vibrations that affect our inner ear which causes chaos with our health. Here is an example of the sleep I have been getting. I have been getting to sleep by 10:30-11:00 and wake up at 6-7.

Wednesday night- finally fell asleep at 3:00

Thursday night-woke up at 4:30 til 6:00

Friday night-I did sleep from 11:30 to 6:30

Saturday night-woke up at 2:30 until 4:30 or 5:00

Sunday night-~~woke up at 4:30 til 5:30~~

4 Monday night-woke up at 4:30 til 5:30

Tues night-went to sleep at 12:30 and woke at 3:45

Last night-went to sleep at 12:00 and woke at 4:35

In June I was in Rosebud for a couple days and spent the night there and I actually had a good night's sleep for once.

On Sunday night when I woke up at 4:30, I had a pain on my side. It reminded me of shingles which is virus you can get if you've had the chickenpox. It affects nerve ends and is caused by stress. It feels like a sharp knife stabbing you, not just once, but 20-30 times per minute and may last minutes, ^{days} hours. It is very uncomfortable. I have felt this pain quite often lately. Maybe from the stress of not sleeping.

Besides ~~the~~ lack of sleep and the pain on my side, I have noticed more headaches recently. I probably had more headaches in the past 3 years than I have had altogether. Thankfully, they haven't been bad migraine headaches but just kind of annoying. These usually occur when I wake up in the morning.

These things along with my husband being diagnosed with vertigo have for the most part started or increased since the PUC was here two years ago.

It is pretty tough to farm when you can't get enough sleep and feel like crap. Even worse when my husband can't get out of bed for days because of vertigo. Small family farms do not have people to come to take over our work when we aren't feeling good. There is no calling in sick. The work still needs to be done.

Right now my BIG concern is the blueprint for the new turbines which are much larger than the Beethoven turbines (from 405 ft to 590 ft). There will be 5 within 1 ¼ miles from our yard. 3 of those will be just at mile from the yard and will also be 185 feet taller than the Beethoven turbines. And I am just talking about the turbines in relation to the farmyard; they will be even closer to the ground we farm.

Please take into consideration how this has affected us. If, in the final decision making, the project is approved, please consider making setbacks of 2 miles to a residence. I do not feel 1 mile is enough. If it were enough, we would not be experiencing sleeplessness nights, vertigo, headaches, etc. Common sense tells me that as our bodies get worn down do to the lack of sleep we will be seeing more health issues

Also there are too many families that will be affected by turbines that are only a mile from their homes.

Please deny this project

~~One last thing crosses my mind. The past two years we have had a lot of cattle die. While it is normal to lose some every now and then, the number has gone way beyond normal. Could the infrasound from the turbines be affecting the cattle also? Dead cows don't pay any of the bills. Also if something is happening to the cows, it could be a sign of what we humans will be dealing with.~~

Thanks for your time and consideration.

I have a map I'd like to submit to you of the turbines that will surround us of which no one from Prevailing Winds has ever approached us about

5280 feet = 1 mile

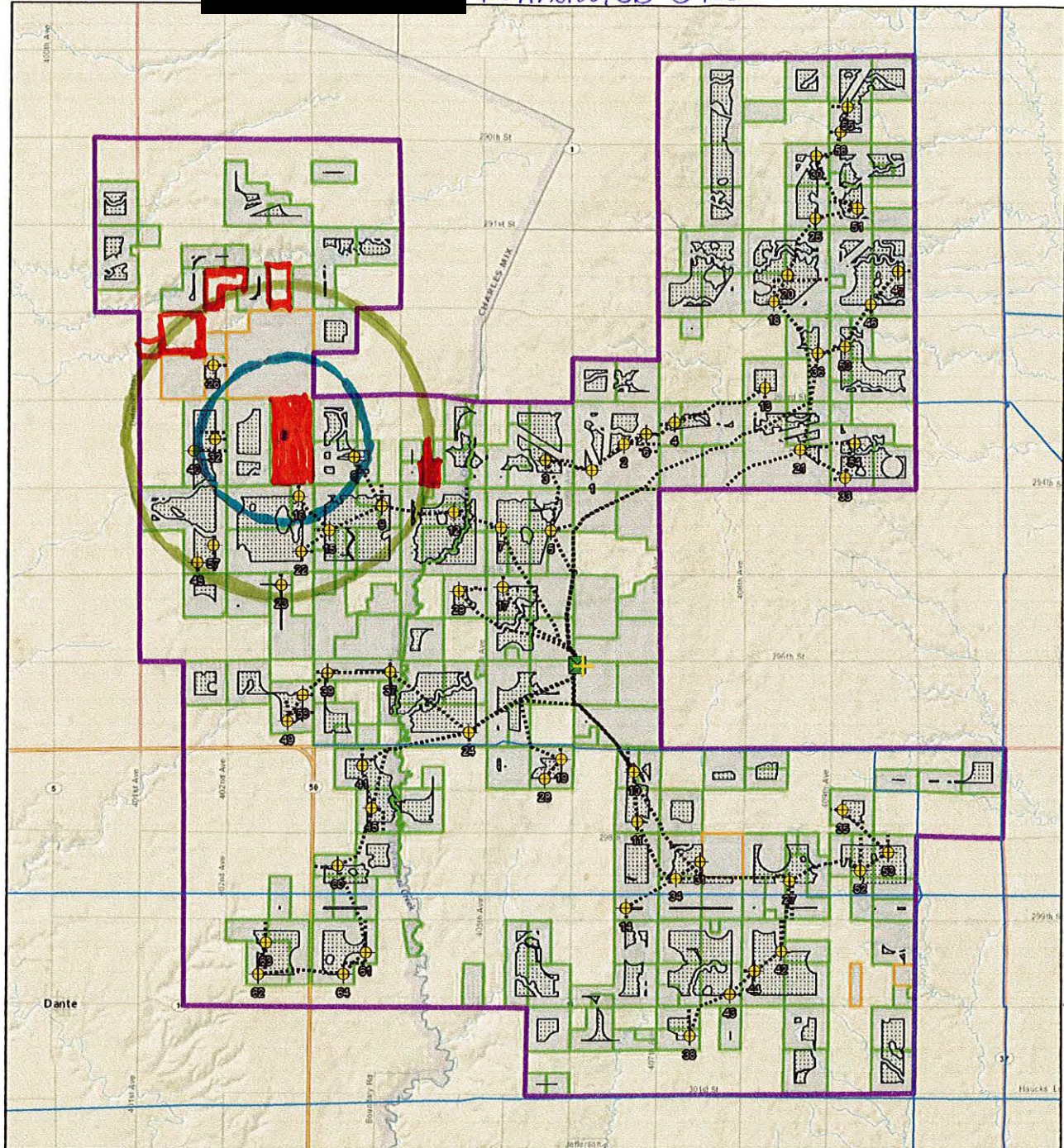

• home

1 1/4 mile

2 1/2 mile

□ rented

■ owned



4 turbines
with 1 1/4
miles from
the yard

11 turbines
within 2 1/2
miles from
yard

Another 1
turbines in
2 1/2 mile
range from
land we
farm

Another 5
Beethoven
turbines
within
2 1/2 miles

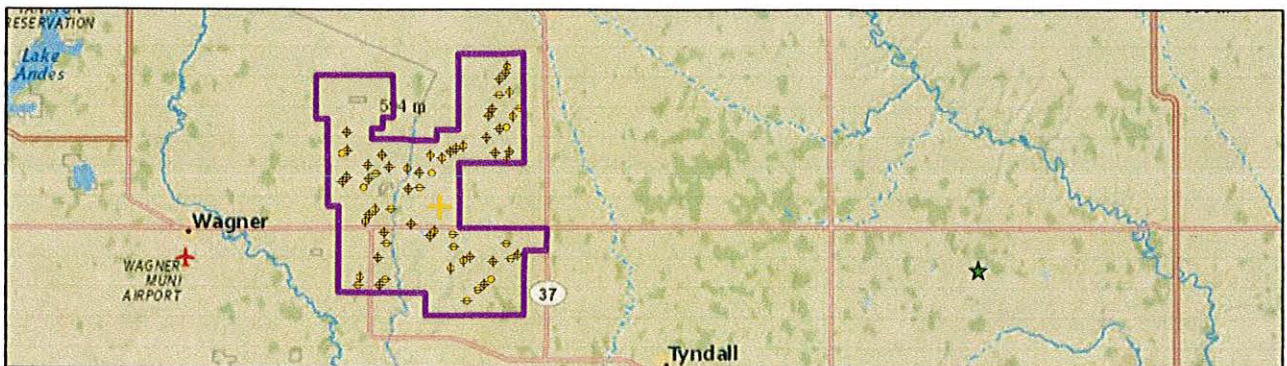

18 turbines
within 2 1/2
miles of
where we
lived & farm
plus 5
more
Beethoven
turbines

23 total

