

SINGLE-FAMILY RESIDENTIAL SALES SUMMARY
FROM THE DATA FOUND IN THE LAWRENCE SURREBUTTAL

Exhibit A22-1

BK No.	Location	Sale Price	Sale Date	Site Size (Acres)	Year Built	Building Size (Sq. Ft.)	Sale Price Per Acre	Sale Price Per Sq. Ft. of Bldg. Area Incl. Land
1	21088 487th Ave. (Gravel) Elkton, South Dakota	\$183,000	10/16	8.00	2003	2,746	\$22,875.00	\$66.64
2	19824 478th Ave. (Paved) Toronto, South Dakota	\$234,900	3/11	10.00	1998	2,341	\$23,490.00	\$100.34
3	20937 486th Ave. (Paved) Elkton, South Dakota	\$175,000	12/11	14.28	1918	2,208	\$12,254.90	\$79.26
4	19636 475th Ave. (Gravel) Toronto, South Dakota	\$530,000	11/13	13.00	1989	3,496	\$40,769.23	\$151.60
5	48646 207th St. (Gravel) Elkton, South Dakota	\$215,000	3/14	6.95	1936	2,160	\$30,935.25	\$99.54
7	20922 485th Ave. (Gravel) Elkton, South Dakota	\$180,000	8/10	13.35	1992	1,680	\$13,483.15	\$107.14
	5705 Rathum Loop (Gravel) Brookings, South Dakota	\$142,000	6/15	0.49	1973	2,078	\$289,795.92	\$68.33

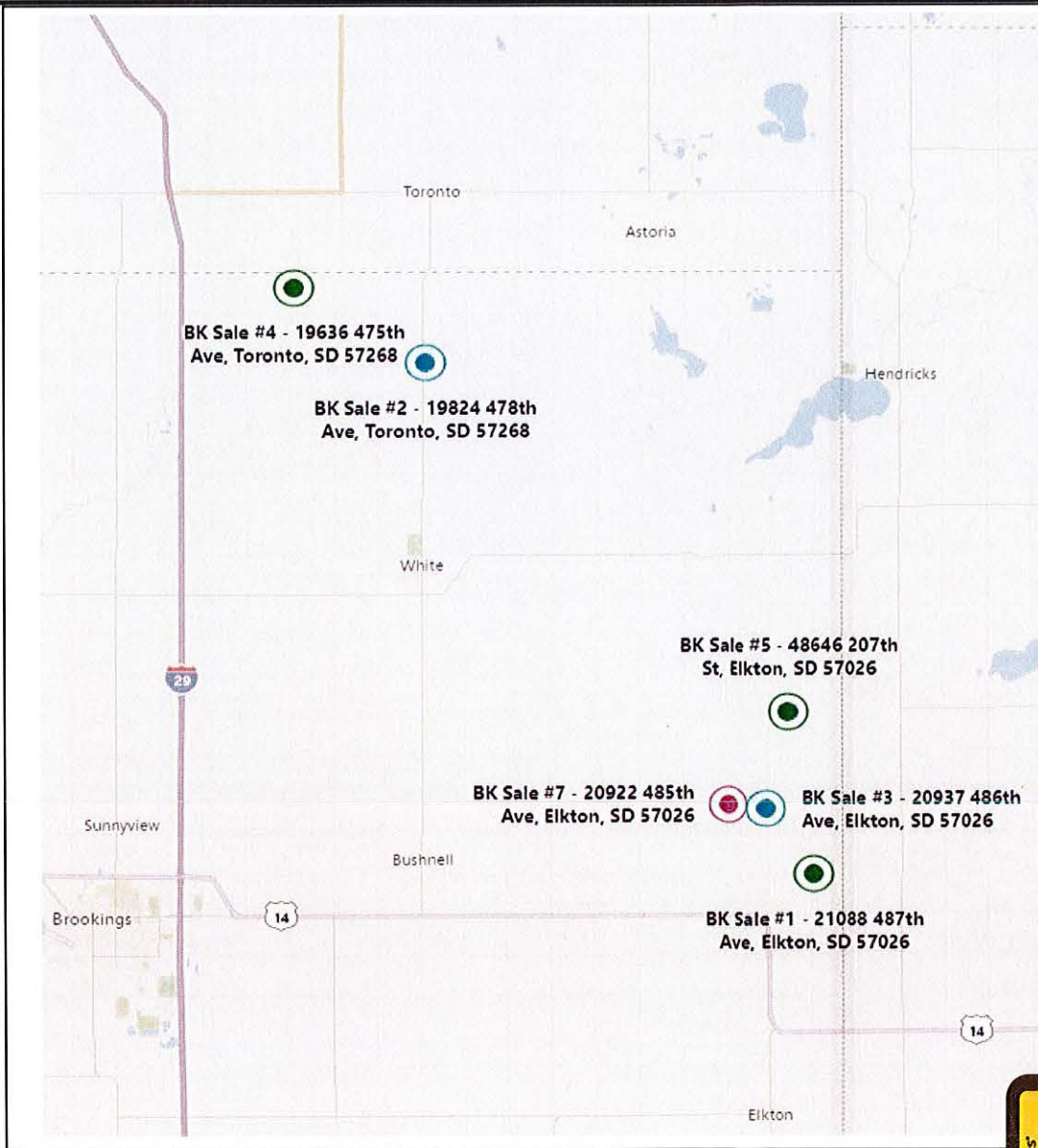

EXHIBIT
A22-1