

Application for Highway Access Permit

South Dakota Department of Transportation

| | | | |
|--|--|---|---|
| Permit Application (to be completed by applicant). | Instructions: Please contact the local South Dakota Department of Transportation office to determine what supporting documents must accompany this application. Please submit a separate application and supporting documentation for each access requested. Attach additional sheets as necessary. Please print or type. Owner and applicant agree to comply with special and standard conditions if access permitted. | | |
| | Property Owner: Name(s): Mailing Address: City, State, Zip Daytime Phone: | | Applicant (if different from Owner): Name(s): <i>Willow Creek Wind Power LLC</i> Mailing Address: <i>1201 Wisconsin St #3200</i> City, State, Zip: <i>Houston, TX 7702</i> Daytime Phone: |
| | Property to be Served by Approach: County: <i>Butte</i> Section: <i>13</i> Township: <i>10N</i> Range: <i>7E</i> Or Subdivision: Block/Lot: Street Address: City: | | State Highway to be Accessed by Approach: State Highway Number: <i>212</i> Access would be <i>9550</i> feet (north, south, east or west) from <i>New Twilight Rd</i> (nearest cross street). |
| | Land Use of Property to be Served (check one): <input type="checkbox"/> Agricultural: acres served _____ <input type="checkbox"/> Business: type _____ total square footage of buildings: _____ number of employees _____ <input type="checkbox"/> Residential: number of single-family dwellings _____, or number of multi-family dwellings _____ <input type="checkbox"/> Other: describe _____ | | Type of Permit Requested (check one) <input checked="" type="checkbox"/> New approach <input type="checkbox"/> Change in use <input checked="" type="checkbox"/> Temporary access <input type="checkbox"/> Improve existing access <input type="checkbox"/> Relocate existing access <input type="checkbox"/> Remove existing access Requested Approach Width (circle one) 24' 30' 36' <u>40'</u> |
| | Local Government Reviews: County: _____ Municipality: _____ Comments: _____ Comments: _____ Concurrence signature: _____ Date: _____ Concurrence signature: _____ Date: _____ | | |
| | Estimated Date of Construction: <i>6-1-2019</i> | | |
| | I, the undersigned, request permission to construct or modify an access approach subject to the rules and regulations set forth in SDCL 70.09. | | |
| | Signature of Applicant: <i>[Signature]</i> | | Date: <i>1/24/19</i> |
| | Signature of Owner (if different than applicant): | | Date: <i>1/1/19</i> |
| | Permit Decision (to be completed by SDDOT). | Supporting Materials Required: (Required) (Received) <input type="checkbox"/> Access Approach Design <input type="checkbox"/> Vicinity Map <input type="checkbox"/> Traffic Volumes <input type="checkbox"/> Three Copies of Site Plan <input type="checkbox"/> Traffic Control Plan <input type="checkbox"/> Proof of Liability Insurance <input type="checkbox"/> Detailed Development Plan <input type="checkbox"/> Drainage Plan <input type="checkbox"/> Traffic Impact Study <input type="checkbox"/> Revegetation Plan <input type="checkbox"/> Other _____ | |
| Terms and Conditions of Approval (or Reason for Denial) <i>Temporary traffic control as per SDDOT + MUTCD will be used when hauling turbines, windmills, etc. See Special Conditions attachment sheet. Temporary approach for construction only. To be removed when finished.</i> | | | |
| Access Must be Constructed By: <i>6/6/20</i> | | | |
| SDDOT Area Engineer Signature: <i>[Signature]</i> Date: <i>6/6/19</i> | | SDDOT Area: Area Office: <i>Belle Fourche</i> Contact Person: <i>Jim Dortschmidt</i> Contact Phone: <i>605-210-2212</i> Permit Number: _____ | |

| SDDOT Highway Access Permit Application Review Sheet (to be completed by SDDOT) | | | |
|--|--|---|--|
| Highway Access Classification: (check one) <input type="checkbox"/> Expressway <input type="checkbox"/> Free Flow Urban <input type="checkbox"/> Intermediate Urban <input type="checkbox"/> Urban Developed <input type="checkbox"/> Urban Fringe <input checked="" type="checkbox"/> Rural | | Highway <u>212</u> MRM + Displacement <u>52 + 35</u> Left <input checked="" type="checkbox"/> Right <input type="checkbox"/> Average Daily Traffic <u>609</u> Accidents (three years) <u>1</u> | |
| Highway Alignment to Left of Access (as seen when standing on access) <input checked="" type="checkbox"/> Straight <input type="checkbox"/> Turns left <input type="checkbox"/> Turns right <input type="checkbox"/> Flat <input checked="" type="checkbox"/> Slopes up <input type="checkbox"/> Slopes down | | Highway Alignment to Right of Access (as seen when standing on access) <input checked="" type="checkbox"/> Straight <input type="checkbox"/> Turns left <input type="checkbox"/> Turns right <input type="checkbox"/> Flat <input type="checkbox"/> Slopes up <input checked="" type="checkbox"/> Slopes down | |
| Stopping Sight Distance: <u>393</u> ft. Entering Sight Distance: <u>846</u> ft. Posted Speed Limit: <u>65</u> mph <input checked="" type="checkbox"/> 0-3% grade <input type="checkbox"/> 3-5% grade <input type="checkbox"/> >5% grade | | Stopping Sight Distance: <u>393</u> ft. Entering Sight Distance: <u>790</u> ft. Posted Speed Limit <u>65</u> mph <input checked="" type="checkbox"/> 0-3% grade <input type="checkbox"/> 3-5 % grade <input type="checkbox"/> >5% grade | |
| Significant Design and Potential Impact Considerations (check all that apply and explain checked items): | | | |
| <input type="checkbox"/> Sidewalks or Bike Paths <input type="checkbox"/> Curb & Gutter <input type="checkbox"/> On-Street Parking <input type="checkbox"/> Shoulder Width <input type="checkbox"/> Historical Resources | | <input type="checkbox"/> Surface Drainage <input type="checkbox"/> Drainage Structures <input type="checkbox"/> Major Structures <input type="checkbox"/> Guard Rail <input type="checkbox"/> Above-Ground Utilities <input type="checkbox"/> Railroad Tracks | |
| <input type="checkbox"/> Distance to Nearby Streets, Both Directions <input type="checkbox"/> Distance to Nearby Driveways, Both Directions <input type="checkbox"/> Others Streets with Access or Available Access <input type="checkbox"/> Traffic Control Devices or Relocation Needed <input type="checkbox"/> Median Crossovers | | | |
| Explain impact on design: | | | |
| SDDOT Region Traffic Engineer Review (optional): Comments: | | SDDOT Access Management Review (optional): Comments: | |
| Signature: _____ date: ____/____/____ | | Signature: _____ date: ____/____/____ | |
| APPROACH DESIGN SKETCH <div style="font-family: cursive; font-size: 1.2em; color: blue;"> See attached picture Area recently seeded </div> | | List Attachments: <input type="checkbox"/> Driveway details <input type="checkbox"/> Culvert details <input type="checkbox"/> Mailbox details <input type="checkbox"/> Fencing details <input type="checkbox"/> Cattle guard <input type="checkbox"/> Sidewalk details <input type="checkbox"/> Median crossovers <input type="checkbox"/> Recreation paths <input type="checkbox"/> Rail crossings <input type="checkbox"/> Auxiliary lanes <input type="checkbox"/> Storm sewer <input type="checkbox"/> Pavement <input type="checkbox"/> Curb & gutter <input type="checkbox"/> Traffic Control <input type="checkbox"/> Sign/signal/markings <input type="checkbox"/> Other | |
| SDDOT Review Performed by: | | Date: <u>10/30/20</u> | |



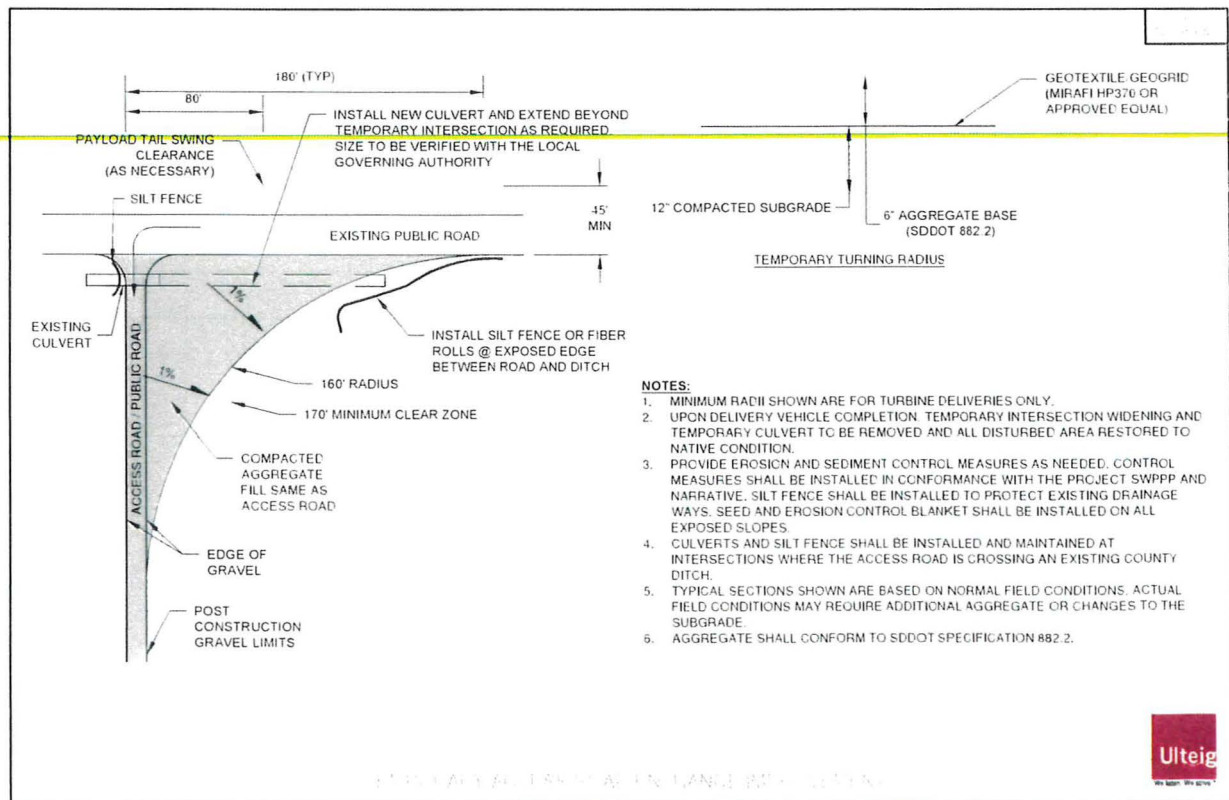
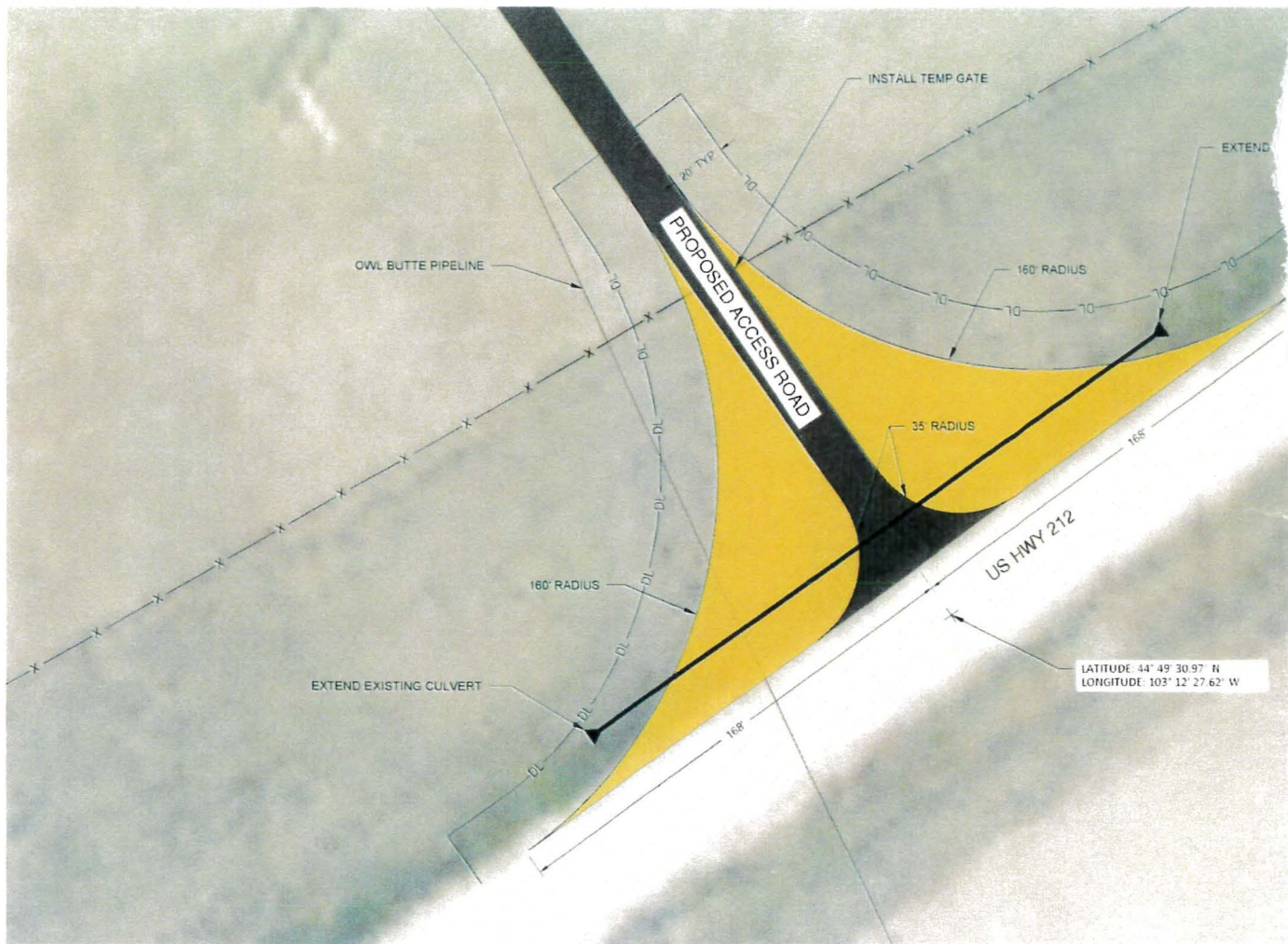

Dorfschmidt, Jim

From: Bartlett, Stacy
Sent: Wednesday, April 17, 2019 12:33 PM
To: Dorfschmidt, Jim
Cc: Matthesen, John (DOT)
Subject: RE: Windfarm App. Permits
Attachments: Scan from TRBE1P02; Scan from TRBE1P02

Jim,

Thank you for the detailed information provided on the approach permits and for taking the time to visit with me today.

The temporary access improvement on US212 at Double R Rd looks good.

The proposed new approach on US212 does not meet Access Location Criteria contained in Chapter 70:09:02 of South Dakota administrative rules, <http://legis.sd.gov/Rules/DisplayRule.aspx?Rule=70:09:02:0A>. This portion of US212 is classified as Rural with a minimum spacing of 1000' between access points. A variance can be allowed to reduce the spacing to 660', but the approach does not have adequate sight distance for the 65 MPH posted speed limit. The proposed approach may be used for temporary access to US212 since pilot cars and temporary traffic control will be used when equipment is being delivered to the site and once the equipment is delivered to the site, the proposed approach should be entirely removed. Please visit with the applicant to see if the existing approach, 660' west of the proposed approach will suffice for equipment maintenance purposes.

Please do not hesitate to contact me with any questions or concerns.

Stacy Bartlett, PE
SDDOT Access Management Engineer
Office: (605)773-2268
Cell: (605)295-0626

From: Dorfschmidt, Jim
Sent: Monday, April 8, 2019 10:42 AM
To: Bartlett, Stacy <Stacy.Bartlett@state.sd.us>
Cc: Matthesen, John (DOT) <John.Matthesen@state.sd.us>
Subject: Windfarm App. Permits

Stacy,

John wanted me to have you look at these. The permit at Double D Rd. will just be a temporary widening for hauling the turbines in. Everything on that one looks good to me. The other that is a permanent permit, however, the additional widening will just be for the hauling. They will narrow back to a regular approach after the turbines are in. The site distance is short, but they will be using pilot cars and temporary traffic control when hauling. Please let me know if you need anything else.

Thanks

Jim Dorfschmidt
Transportation Specialist