

DOCKET NUMBER EL 94-0111

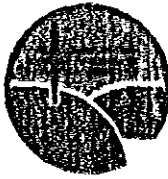

**SIoux
VALLEY
ELECTRIC**

P.O. Box 216 • Colman, South Dakota, 57017-0216

Phone: 605-634-3535

Toll Free: 1-800-234-1960

May 13, 1994

RECEIVED

MAY 16 1994

SOUTH DAKOTA PUBLIC
UTILITIES COMMISSION

Marshall Damgaard, Executive Director
South Dakota Public Utilities Commission
500 East Capitol
Pierre, SD 57501

Dear Mr. Damgaard:

Enclosed for filing please find an original signed "Joint Request for Electric Service Territory Exception" between Northern States Power Company and Sioux Valley Empire Electric Association.

This agreement between the two parties seeks an exception to our existing service territories. This agreement will allow NSP to serve a SD Department of Transportation highway intersection at the junction of Highways 38 and 11 east of Sioux Falls. This service lies within Sioux Valley's territory but we feel the consumer's interests will be better served with service from NSP in this instance.

Accompanying correspondence and a map provide additional information. Sioux Valley Electric respectfully requests South Dakota Public Utilities Commission consideration and an order approving this agreement.

Sincerely,

James M. Kiley
General Manager

Enclosure

cc: Michael J. Hanson

3
6
2
8
JOINT REQUEST FOR ELECTRIC SERVICE TERRITORY EXCEPTION

Sioux Valley Empire Electric Association (SVEEA) and Northern States Power Company (NSP) jointly request an exception to the existing electric service territorial agreement to permit Northern States Power Company to provide electric service to the proposed South Dakota Department of Transportation lighting service located at the intersection of SD Highways 30 and 11 in the SW 1/4 of Section 13 and the NE 1/4 of Section 24, T101N, R49W, Minnehaha County. This service consists of six 400 watt, high pressure sodium light fixtures, two of which are located in the service territory assigned to NSP and four of which are located in the service territory assigned to SVEEA. A drawing of the general area, proposed lighting facilities and service territory boundary is attached for your information.

Representatives of both SVEEA and NSP have met on several occasions and discussed different ways of serving this load. It is our mutual conclusion, that in this instance, the customer's interests will be best served by receiving service from one power supplier. We have agreed that in this instance it should be NSP, and that we should request an exception to the existing territorial agreement.

We have also agreed that each such instance where territory boundaries become a factor should be dealt with on an individual basis.

As stated above, the decision by SVEEA to consent to NSP providing service to this installation was influenced by the fact that the customer's interests will be best served through a single metering point.

This consent on the part of SVEEA is limited to the said SD Department of Transportation lighting service request and will automatically terminate upon removal or abandonment of such service.

This exception is not to be construed as having any impact upon or indicating a desire to change the service areas assigned by the South Dakota Public Utilities Commission.

SIoux VALLEY EMPIRE ELECTRIC ASSN. NORTHERN STATES POWER COMPANY--SD

By James M. Riley By Richard J. [Signature]
General Manager General Manager & Chief Executive
Date May 9, 1971 Date May 10, 1971

A. S. N. C. 10

Exhibit A

R.O.P.

SE 1/4 Section 13
Twp. 101N. - R. 41W.

NSP Territory

Residential
Boundary Line

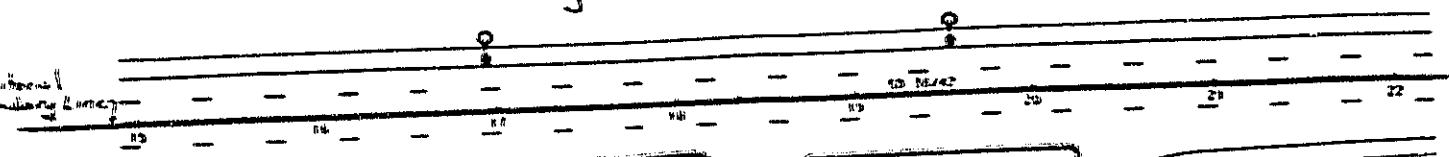

Sioux Valley Electric Territory

NE 1/4 Section 24
Twp. 101N. - R. 41W.

LUMINAIRE LAYOUT
 MINNEHAHA COUNTY
 SD 38/42 & SD 11
 MRM 375.3

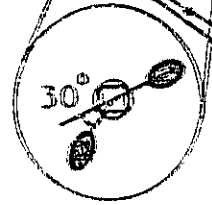

400 W. 825

10 W. 1150



1" = 60'

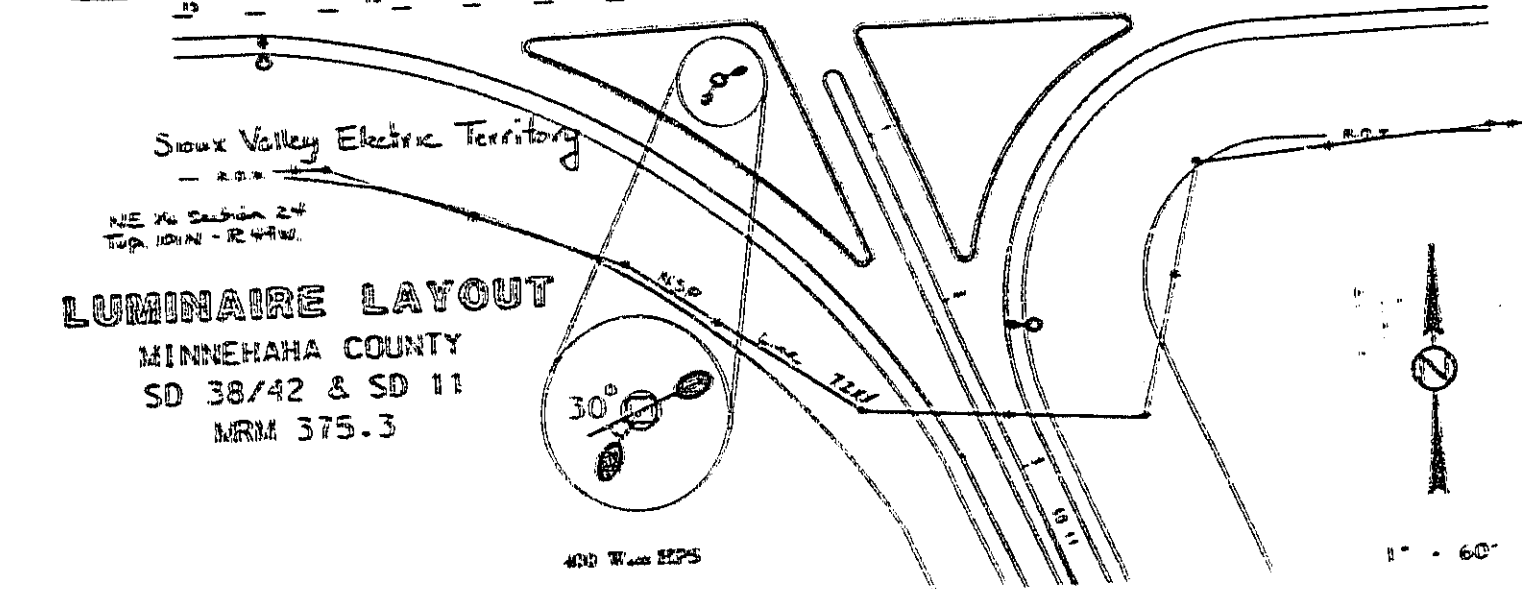



Michael J. Hanson
General Manager and Chief Executive



Northern States Power Company
South Dakota

500 West Russell
P.O. Box 900
Sioux Falls, SD 57101-0900
Telephone (605) 339-8200

May 12, 1994

Mr. Marshall Damgaard, Executive Director
South Dakota Public Utilities Commission
500 East Capitol
Pierre, SD 57501

Dear Marshall:

Enclosed for filing please find an original signed "Joint Request for Electric Service Territory Exception" between Northern States Power Company and Sioux Valley Electric Association.

This agreement between the two parties seeks an exception to our existing service territories. This agreement will allow NSP to serve a SD Department of Transportation highway intersection at the junction of Highways 38 and 11 east of Sioux Falls. This service lies within Sioux Valley territory but will be more cost effectively served from NSP lines.

Accompanying correspondence and a map provide additional information. NSP respectfully requests South Dakota Public Utilities Commission consideration and an order approving this agreement.

Sincerely,

Michael J. Hanson
General Manager and Chief Executive

MJH:mt

cc: Jim Kiloy



Northern States Power Company
South Dakota

500 West Russell
P.O. Box 000
Sioux Falls, SD 57101-0900
Telephone (605) 339-8200

May 10, 1994

James M. Kiloy, General Manager
Sioux Valley Electric
P.O. Box 216
Colman, SD 57017-0216

Subject: Service Territory Exception - South Dakota Department of Transportation,
Lighting Service for Intersection of Highways 11 and 38, Minnehaha
County.

Dear Mr. Kiloy:

Enclosed are the two (2) fully executed copies of the Joint Request for Electric Service Territory Exception which are being returned as requested.

One fully executed copy has been delivered to the South Dakota Public Utilities Commission.

Our sincerest appreciation for your efforts in the development of this agreement; and we look forward to working with you in the future in this same spirit of cooperation.

Sincerely,

Russell F. Bartunok
Manager, Customer Operations

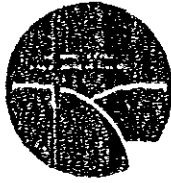

**SIoux
VALLEY**
ELECTRIC

P.O. Box 218 • Colman, South Dakota, 57017-0218

Phone: 605-834-3535

Toll Free: 1-800-234-1960

May 9, 1994

Russ Bartunek, Manager
Customer Operations
Northern States Power Company
P.O. Box 988
Sioux Falls, SD 57101

Subject: Service Territory Exception - South Dakota Department of
Transportation, Lighting service for intersection of
Highways 11 and 38, Minnehaha County

Dear Mr. Bartunek:

Enclosed for execution by NSP are four (4) copies of an agreement
entitled Joint Request for Electric Service Territory Exception
pertaining to the Subject service request. These four copies have
been executed by Sioux Valley Electric, and we request you return
two (2) fully executed copies.

We suggest that each of us send a copy of the executed Agreement to
the Public Utilities Commission. If you would like a copy of our
transmittal letter to the PUC, please advise.

We appreciate the cooperative spirit which prevailed during the
negotiation of this agreement, and look forward to a continuation
of this relationship in future circumstances.

Sincerely

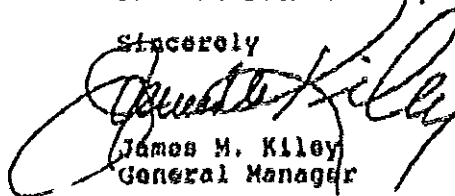

James M. Kiley
General Manager

Enclosures

cc: Scott Jansen, Regional Traffic Engineer
SD Department of Transportation
P.O. Box 1206
Mitchell, SD 57301

05/20/94 15:30

DOCKET NUMBER

EL 94-011



Department of Transportation

Mitchell Region Office

PO Box 1205
Mitchell, SD 57301-7208 605/938-4737
FAX: 605/938-7117

May 20, 1994

RECEIVED

MAY 23 1994

SOUTH DAKOTA PUBLIC UTILITIES COMMISSION

Mr. Jim Wilcox
Customer Service Manager
Northern States Power
P.O. Box 888
Sioux Falls, South Dakota 57101-0988

Re: PH 0001(00), Mitchell Region, PCEHS 4398
Roadway Lighting of Intersections at Various Locations

Dear Mr. Wilcox:

This letter is to document our phone conversations this past week regarding the State's position on the maintenance of the proposed roadway lighting at the intersection of SD 38/SD 42 and SD 11 South.

The State has no preference as to which utility company provides power and maintenance of the roadway lighting at the intersections to be lighted with the above referenced project. However, the Department prefers that the power and maintenance at each intersection be provided by only one utility company. These issues must be settled between the utility companies having facilities at the intersections.

Conversations between Northern States Power, Sioux Valley Electric, and Department of Transportation personnel to date have indicated that Northern States Power will be providing the power and maintaining the bulbs for the six luminaires on a routine basis at the intersection of SD 38/SD 42 and SD 11 South. Any future major repair of the roadway lights (pole replacement, luminaire replacement, etc.) will be negotiated with Northern States Power if and when the repair is required.

In the near future, the Department of Transportation will send form DOT-121, Review Certification and Agreement Record and attachments for signature. The Review Certification and Agreement Record will specify that power and bulb maintenance of the roadway lighting is to be provided by Northern States Power.

If you know of information contrary to the above please advise.

Very truly yours,

DEPARTMENT OF TRANSPORTATION
Robert F. Kirwan
Region Engineer

Scott Janssen
Scott Janssen
Region Traffic Engineer

cc: Kirwan/Kappanan
Orville Gran, Utilities
Bjornberg/Linn
Reiff
File

Post-It brand fax transmittal memo 7071
To: *Martin Ollonari*
From: *Jim Wilcox*
Date: _____
Time: _____

813269



Michael J. Hanson
General Manager and Chief Executive



Northern States Power Company
South Dakota

500 West Russell
P.O. Box 800
Sioux Falls, SD 57101-0800
Telephone (605) 339-8200

May 12, 1994

Mr. Marshall Damgaard, Executive Director
South Dakota Public Utilities Commission
500 East Capitol
Pierre, SD 57501

RECEIVED
MAY 13 1994
SOUTH DAKOTA PUBLIC UTILITIES COMMISSION

Dear Marshall:

Enclosed for filing please find an original signed "Joint Request for Electric Service Territory Exception" between Northern States Power Company and Sioux Valley Empire Electric Association.

This agreement between the two parties seeks an exception to our existing service territories. This agreement will allow NSP to serve a SD Department of Transportation highway intersection at the junction of Highways 38 and 11 east of Sioux Falls. This service lies within Sioux Valley territory but will be more cost effectively served from NSP lines.

Accompanying correspondence and a map provide additional information. NSP respectfully requests South Dakota Public Utilities Commission consideration and an order approving this agreement.

Sincerely,

Michael J. Hanson
General Manager and Chief Executive

MJH:mt

cc: Jim Kiley

813216110

JOINT REQUEST FOR ELECTRIC SERVICE TERRITORY EXCEPTION

Sioux Valley Empire Electric Association (SVEEA) and Northern States Power Company (NSP) jointly request an exception to the existing electric service territorial agreement to permit Northern States Power Company to provide electric service to the proposed South Dakota Department of Transportation lighting service located at the intersection of SD Highways 39 and 11 in the SW 1/4 of Section 13 and the NE 1/4 of Section 24, T101N, R49W, Minnehaha County. This service consists of six 400 watt, high pressure sodium light fixtures, two of which are located in the service territory assigned to NSP and four of which are located in the service territory assigned to SVEEA. A drawing of the general area, proposed lighting facilities and service territory boundary is attached for your information.

Representatives of both SVEEA and NSP have met on several occasions and discussed different ways of serving this load. It is our mutual conclusion, that in this instance, the customer's interests will be best served by receiving service from one power supplier. We have agreed that in this instance it should be NSP, and that we should request an exception to the existing territorial agreement.

We have also agreed that each such instance where territory boundaries become a factor should be dealt with on an individual basis.

As stated above, the decision by SVEEA to consent to NSP providing service to this installation was influenced by the fact that the customer's interests will be best served through a single metering point.

This consent on the part of SVEEA is limited to the said SD Department of Transportation lighting service request and will automatically terminate upon removal or abandonment of such service.

This exception is not to be construed as having any impact upon or indicating a desire to change the service areas assigned by the South Dakota Public Utilities Commission.

SIoux VALLEY EMPIRE ELECTRIC ASSN. NORTHERN STATES POWER COMPANY--SD

By *James M. Kelly*
General Manager

By *Richard J. Hanson*
General Manager & Chief Executive

Date *May 9, 1994*

Date *May 10, 1994*

Exhibit A

SE 1/4 Section 13
Twp. 101N - R. 49W.

NSP Territory

Territorial
Boundary Line

Sioux Valley Electric Territory

NE 1/4 Section 24
Twp. 101N - R. 49W.

LUMINAIRE LAYOUT
MINNEHAHA COUNTY
SD 38/42 & SD 11
MRM 375.3

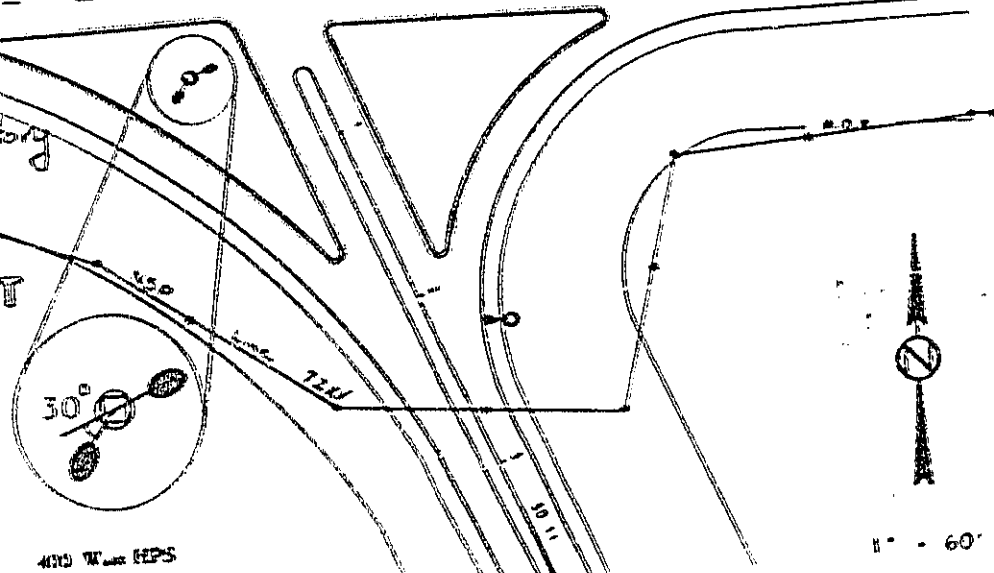

400' W. of R.F.S.

100' S. of R.F.S.

1" = 60'

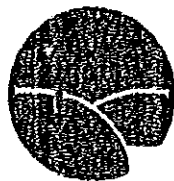

**SIoux
VALLEY
ELECTRIC**

P.O. Box 218 • Colman, South Dakota, 57017-0218

Phone: 605-534-3535

Toll Free: 1-800-234-1960

May 9, 1994

Russ Bartunek, Manager
Customer Operations
Northern States Power Company
P.O. Box 980
Sioux Falls, SD 57101

Subject: Service Territory Exception - South Dakota Department of
Transportation, Lighting Service for Intersection of
Highways 11 and 30, Minnehaha County

Dear Mr. Bartunek:

Enclosed for execution by NSP are four (4) copies of an agreement
entitled Joint Request for Electric Service Territory Exception
pertaining to the Subject service request. These four copies have
been executed by Sioux Valley Electric, and we request you return
two (2) fully executed copies.

We suggest that each of us send a copy of the executed Agreement to
the Public Utilities Commission. If you would like a copy of our
transmittal letter to the PUC, please advise.

We appreciate the cooperative spirit which prevailed during the
negotiation of this agreement, and look forward to a continuation
of this relationship in future circumstances.

Sincerely

James M. Kiley
General Manager

Enclosures

cc: Scott Jansen, Regional Traffic Engineer
SD Department of Transportation
P.O. Box 1206
Mitchell, SD 57301



Northern States Power Company
South Dakota

600 West Russell
PO Box 960
Sioux Falls, SD 57101-0960
Telephone (605) 339-8200

May 10, 1994

James M. Kiley, General Manager
Sioux Valley Electric
P.O. Box 216
Colman, SD 57017-0216

Subject: Service Territory Exception - South Dakota Department of Transportation,
Lighting Service for Intersection of Highways 11 and 38, Minnehaha
County.

Dear Mr. Kiley:

Enclosed are the two (2) fully executed copies of the Joint Request for Electric Service
Territory Exception which are being returned as requested.

One fully executed copy has been delivered to the South Dakota Public Utilities
Commission.

Our sincerest appreciation for your efforts in the development of this agreement; and
we look forward to working with you in the future in this same spirit of cooperation.

Sincerely,

Russell F. Bartunek
Manager, Customer Operations

bcc: Mike Hanson ✓
Jim Wilcox ✓