

Attachment No. 1

EXHIBIT "B"

PRELIMINARY ROUTE

MCPHERSON COUNTY, SOUTH DAKOTA

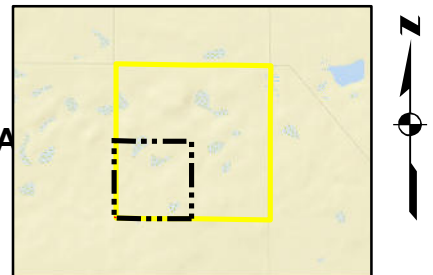

VICINITY MAP
N.T.S.

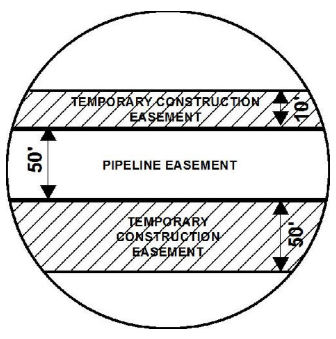

SEC. 27 T128N R70W

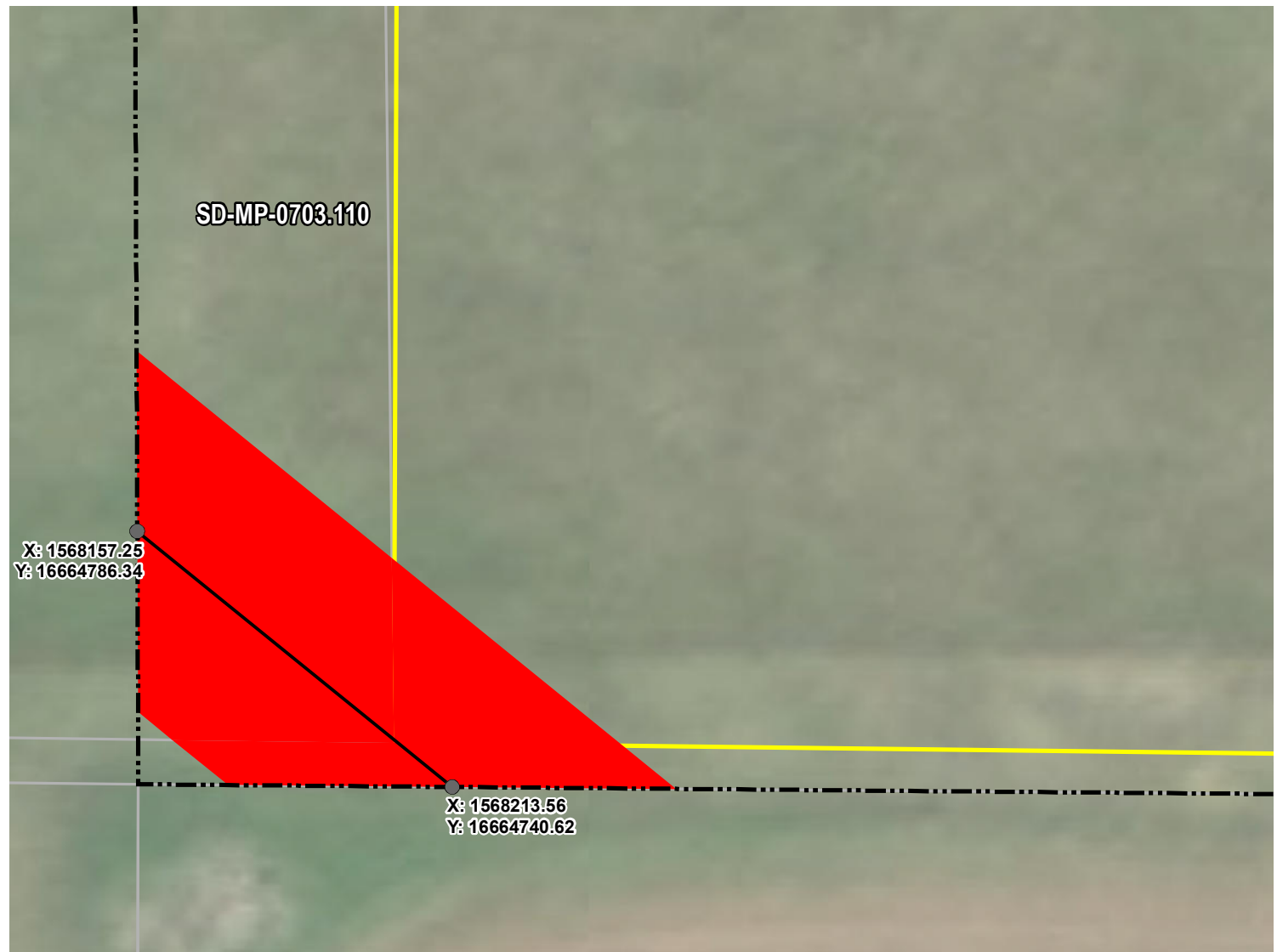

ROUTING LENGTH = 72.532 FT +/-
IMPACTS: PIPELINE EASEMENT = 0.083 AC. +/- / TEMPORARY CONSTRUCTION EASEMENT = 0 AC. +/-

Legend

PROPOSED ROUTE	PIPELINE EASEMENT
PARCEL BOUNDARY	TEMPORARY CONSTRUCTION EASEMENT
ADJACENT PROPERTIES	SECTION BOUNDARY
	COUNTY BOUNDARY

NOTES:

1. THIS IS A PRELIMINARY DOCUMENT AND IS INTENDED TO DEPICT THE APPROXIMATE LOCATION OF A PROPOSED PIPELINE EASEMENT.
2. THIS DOCUMENT DOES NOT REPRESENT A LAND SURVEY AND IS NOT INTENDED TO DEPICT THE FINAL ALIGNMENT
3. COORDINATE SYSTEM: UTM ZONE 14 NORTH, NAD83, US SURVEY FEET

PRELIMINARY PIPELINE ROUTE		
DRAWN BY:	AC	SUMMIT CARBON SOLUTIONS MIDWEST CARBON EXPRESS R & C FEICKERT LAND LLC TAX ID: 3815 TRACT NUMBER: SD-MP-0703.110
CHECKED BY:	JW	
MAP DATE:	12/17/2021	
SCALE:	1 inch = 29'	
REV NO.	DATE	DESCRIPTION
B	3/8/2022	REVISED WORKSPACE
C	5/17/2022	REVISED WORKSPACE
DRAWING NO. C-MCE-ACQ-SD-MP-0703.110		PROJECT NO. 450959
		SHEET NO. 01 of 01



EXHIBIT "B"

PRELIMINARY ROUTE

MCPHERSON COUNTY, SOUTH DAKOTA

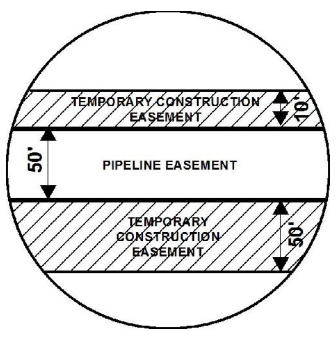
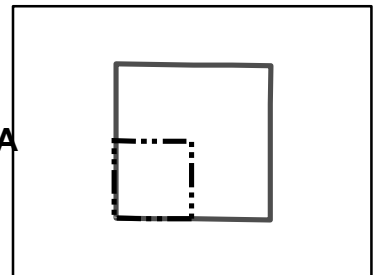

VICINITY MAP
N.T.S.

SEC. 27 T128N R70W

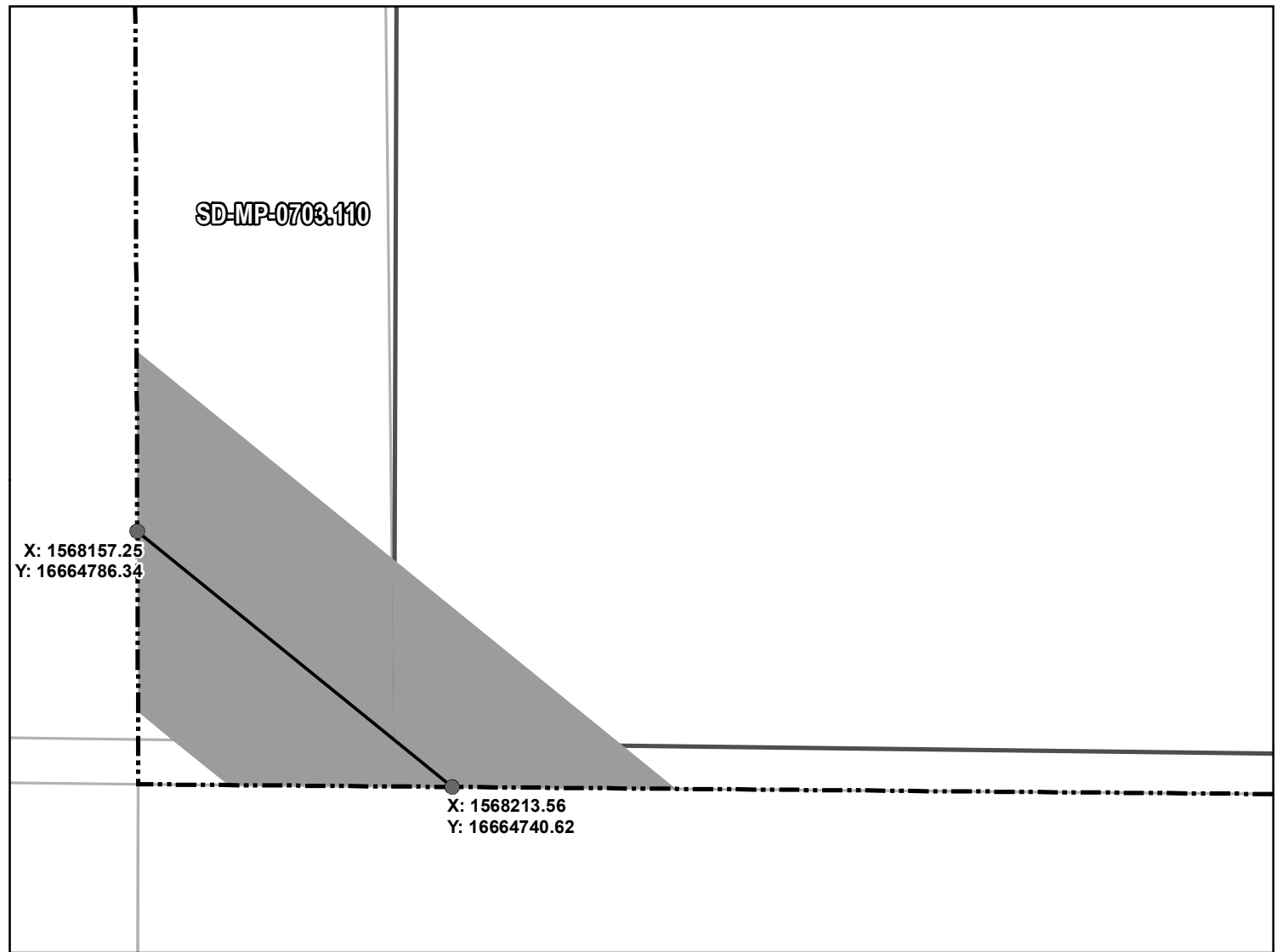

ROUTING LENGTH = 72.532 FT +/-
IMPACTS: PIPELINE EASEMENT = 0.083 AC. +/- / TEMPORARY CONSTRUCTION EASEMENT = 0 AC. +/-

- Legend**
- PROPOSED ROUTE
 - ROADS
 - PARCEL BOUNDARY
 - ADJACENT PROPERTIES
 - PIPELINE EASEMENT
 - TEMPORARY CONSTRUCTION EASEMENT
 - SECTION BOUNDARY
 - COUNTY BOUNDARY

NOTES:

1. THIS IS A PRELIMINARY DOCUMENT AND IS INTENDED TO DEPICT THE APPROXIMATE LOCATION OF A PROPOSED PIPELINE EASEMENT.
2. THIS DOCUMENT DOES NOT REPRESENT A LAND SURVEY AND IS NOT INTENDED TO DEPICT THE FINAL ALIGNMENT
3. COORDINATE SYSTEM: UTM ZONE 14 NORTH, NAD83, US SURVEY FEET

SIGNATURE: _____ DATE: _____



PRELIMINARY PIPELINE ROUTE		
DRAWN BY:	AC	SUMMIT CARBON SOLUTIONS MIDWEST CARBON EXPRESS R & C FEICKERT LAND LLC TAX ID: 3815 TRACT NUMBER: SD-MP-0703.110
CHECKED BY:	JW	
MAP DATE:	12/17/2021	
SCALE:	1 inch = 29'	
REV NO.	DATE	DESCRIPTION
B	3/8/2022	REVISED WORKSPACE
C	5/17/2022	REVISED WORKSPACE
DRAWING NO. BW-MCE-ACQ-SD-MP-0703.110		PROJECT NO. 450959
		SHEET NO. 01 of 01

EXHIBIT "B"

PRELIMINARY ROUTE

MCPHERSON COUNTY, SOUTH DAKOTA

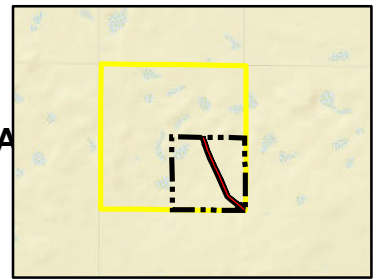

VICINITY MAP
N.T.S.

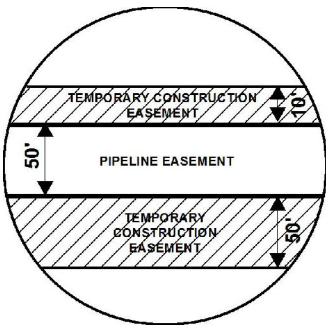

SEC. 28 T128N R70W



ROUTING LENGTH = 3155.712 FT +/-

IMPACTS: PIPELINE EASEMENT = 3.608 AC. +/- / TEMPORARY CONSTRUCTION EASEMENT = 4.597 AC. +/-

Legend

- PROPOSED ROUTE
- PIPELINE EASEMENT
- PARCEL BOUNDARY
- TEMPORARY CONSTRUCTION EASEMENT
- ADJACENT PROPERTIES
- SECTION BOUNDARY
- COUNTY BOUNDARY

NOTES:

1. THIS IS A PRELIMINARY DOCUMENT AND IS INTENDED TO DEPICT THE APPROXIMATE LOCATION OF A PROPOSED PIPELINE EASEMENT.
2. THIS DOCUMENT DOES NOT REPRESENT A LAND SURVEY AND IS NOT INTENDED TO DEPICT THE FINAL ALIGNMENT
3. COORDINATE SYSTEM: UTM ZONE 14 NORTH, NAD83, US SURVEY FEET

PRELIMINARY PIPELINE ROUTE

DRAWN BY: AC		SUMMIT CARBON SOLUTIONS MIDWEST CARBON EXPRESS R & C FEICKERT LAND LLC TAX ID: 3822 TRACT NUMBER: SD-MP-0704.100
CHECKED BY: JW		
MAP DATE: 12/17/2021		
SCALE: 1 inch = 575'		
REV NO.	DATE	DESCRIPTION
C	5/4/2022	REVISED WORKSPACE
D	5/17/2022	REVISED WORKSPACE
DRAWING NO. C-MCE-ACQ-SD-MP-0704.100		PROJECT NO. 450959
		SHEET NO. 01 of 01

EXHIBIT "B"

PRELIMINARY ROUTE

MCPHERSON COUNTY, SOUTH DAKOTA

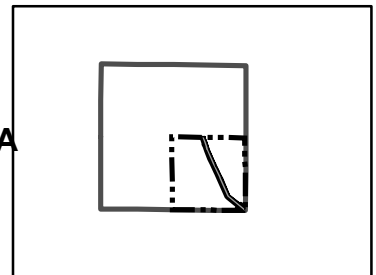

VICINITY MAP
N.T.S.

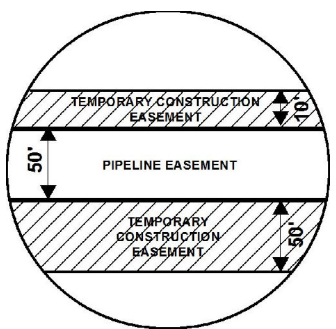

SEC. 28 T128N R70W

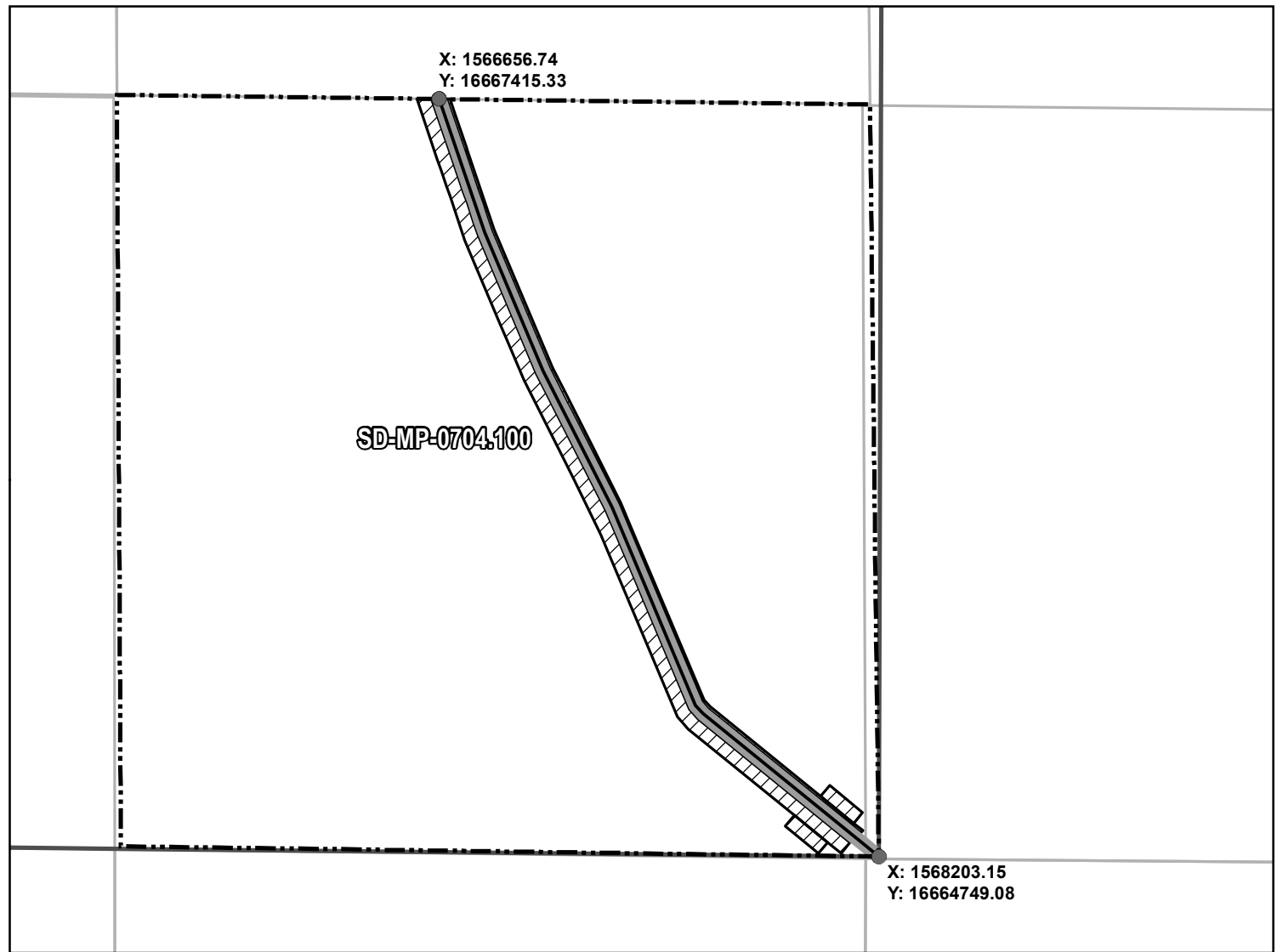

ROUTING LENGTH = 3155.712 FT +/-
IMPACTS: PIPELINE EASEMENT = 3.608 AC. +/- / TEMPORARY CONSTRUCTION EASEMENT = 4.597 AC. +/-

- Legend**
- PROPOSED ROUTE
 - ROADS
 - ▭ PARCEL BOUNDARY
 - ▭ ADJACENT PROPERTIES
 - ▭ PIPELINE EASEMENT
 - ▨ TEMPORARY CONSTRUCTION EASEMENT
 - ▭ SECTION BOUNDARY
 - ▭ COUNTY BOUNDARY

NOTES:

1. THIS IS A PRELIMINARY DOCUMENT AND IS INTENDED TO DEPICT THE APPROXIMATE LOCATION OF A PROPOSED PIPELINE EASEMENT.
2. THIS DOCUMENT DOES NOT REPRESENT A LAND SURVEY AND IS NOT INTENDED TO DEPICT THE FINAL ALIGNMENT
3. COORDINATE SYSTEM: UTM ZONE 14 NORTH, NAD83, US SURVEY FEET

SIGNATURE: _____ DATE: _____



PRELIMINARY PIPELINE ROUTE		
DRAWN BY:	AC	SUMMIT CARBON SOLUTIONS MIDWEST CARBON EXPRESS R & C FEICKERT LAND LLC TAX ID: 3822 TRACT NUMBER: SD-MP-0704.100
CHECKED BY:	JW	
MAP DATE:	12/17/2021	
SCALE:	1 inch = 574'	
REV NO.	DATE	DESCRIPTION
C	5/4/2022	REVISED WORKSPACE
D	5/17/2022	REVISED WORKSPACE
DRAWING NO. BW-MCE-ACQ-SD-MP-0704.100		PROJECT NO. 450959
		SHEET NO. 01 of 01

EXHIBIT "B"

PRELIMINARY ROUTE

MCPHERSON COUNTY, SOUTH DAKOTA

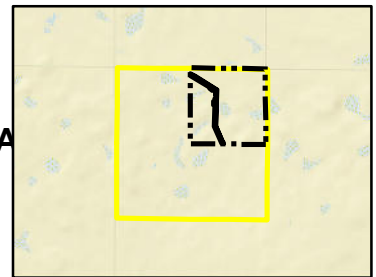

VICINITY MAP
N.T.S.

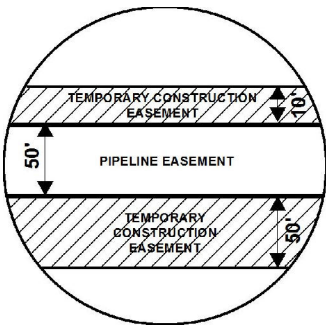

SEC. 28 T128N R70W

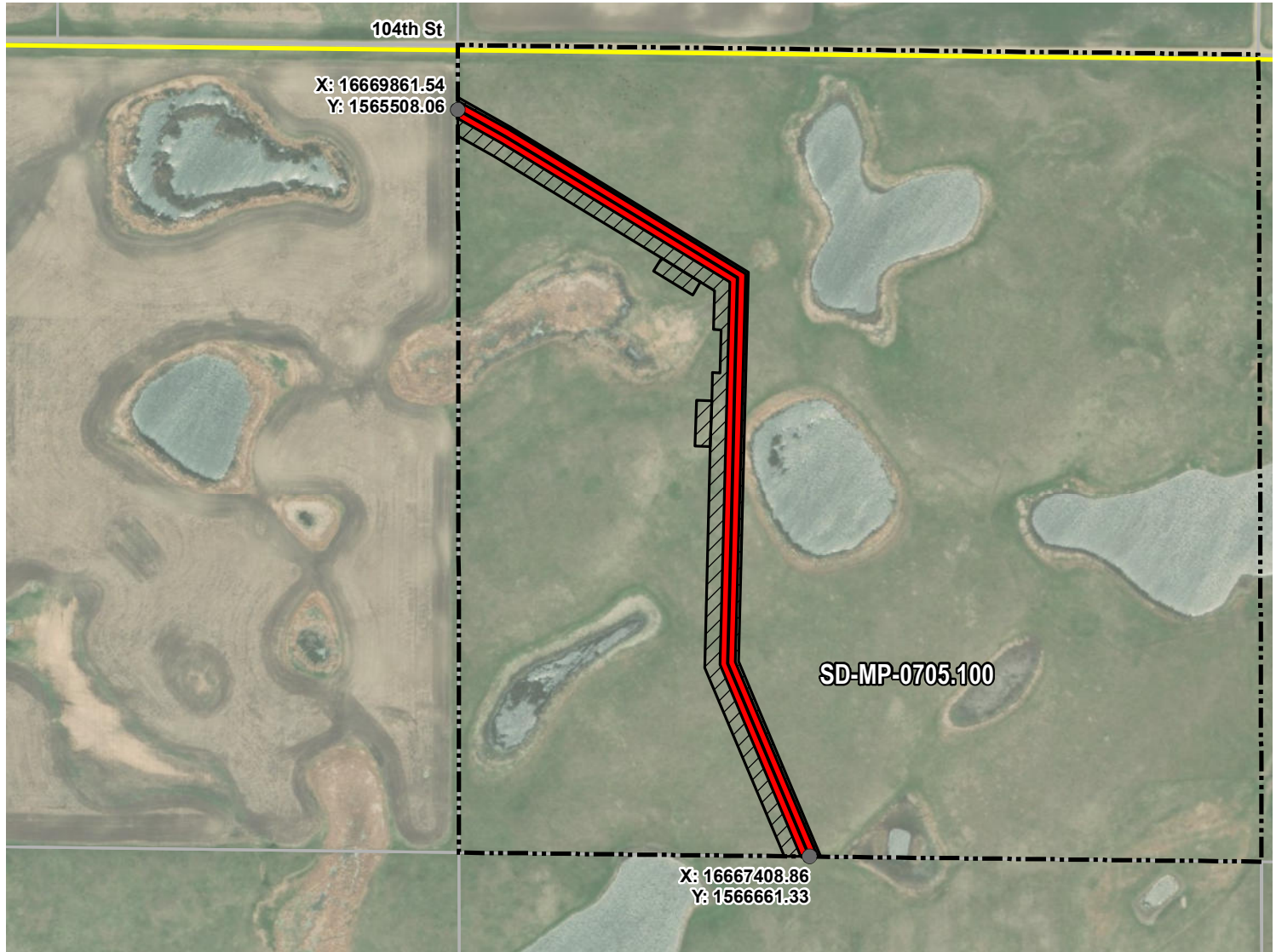

ROUTING LENGTH = 3026.869 FT +/-

IMPACTS: PIPELINE EASEMENT = 3.475 AC. +/- / TEMPORARY CONSTRUCTION EASEMENT = 4.343 AC. +/-

Legend

- PROPOSED ROUTE
- PIPELINE EASEMENT
- PARCEL BOUNDARY
- TEMPORARY CONSTRUCTION EASEMENT
- ADJACENT PROPERTIES
- SECTION BOUNDARY
- COUNTY BOUNDARY

NOTES:

1. THIS IS A PRELIMINARY DOCUMENT AND IS INTENDED TO DEPICT THE APPROXIMATE LOCATION OF A PROPOSED PIPELINE EASEMENT.
2. THIS DOCUMENT DOES NOT REPRESENT A LAND SURVEY AND IS NOT INTENDED TO DEPICT THE FINAL ALIGNMENT
3. COORDINATE SYSTEM: UTM ZONE 14 NORTH, NAD83, US SURVEY FEET

PRELIMINARY PIPELINE ROUTE

DRAWN BY: AC		SUMMIT CARBON SOLUTIONS MIDWEST CARBON EXPRESS R & C FEICKERT LAND LLC TAX ID: 3819 TRACT NUMBER: SD-MP-0705.100
CHECKED BY: JW		
MAP DATE: 12/17/2021		
SCALE: 1 inch = 537'		
REV NO.	DATE	DESCRIPTION
A	12/17/2021	INITIAL ISSUE
B	3/8/2022	REVISED WORKSPACE
DRAWING NO. C-MCE-ACQ-SD-MP-0705.100		PROJECT NO. 450959
		SHEET NO. 01 of 01



EXHIBIT "B"

PRELIMINARY ROUTE

MCPHERSON COUNTY, SOUTH DAKOTA

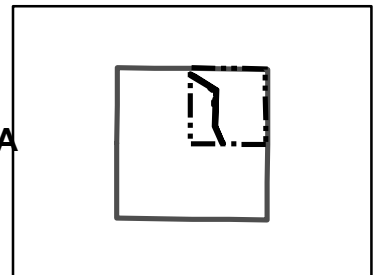

VICINITY MAP
N.T.S.

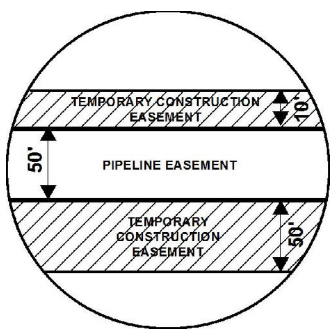

SEC. 28 T128N R70W

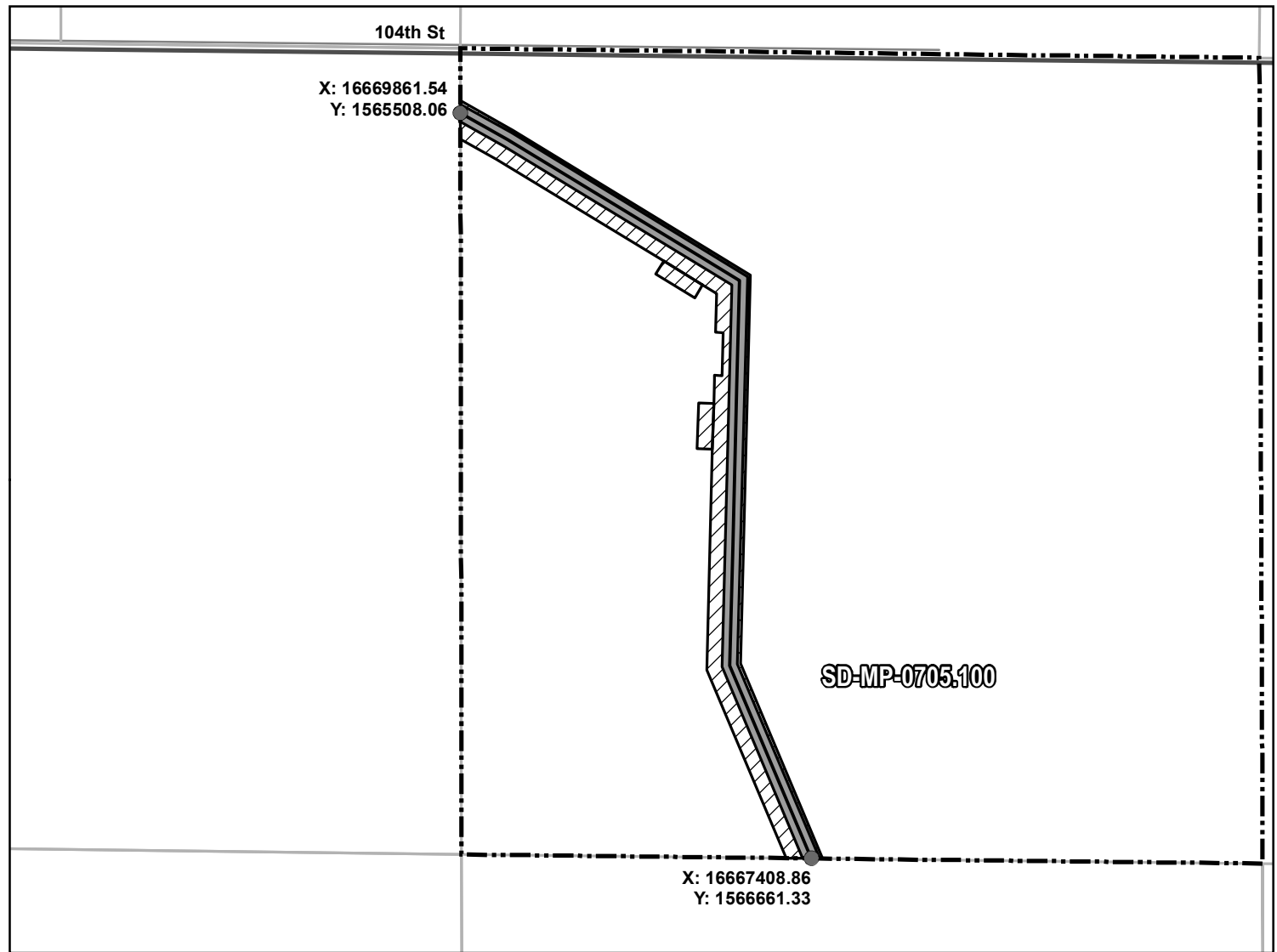

ROUTING LENGTH = 3026.869 FT +/-
IMPACTS: PIPELINE EASEMENT = 3.475 AC. +/- / TEMPORARY CONSTRUCTION EASEMENT = 4.343 AC. +/-

- Legend**
- PROPOSED ROUTE
 - ROADS
 - ▭ PARCEL BOUNDARY
 - ▭ ADJACENT PROPERTIES
 - ▭ PIPELINE EASEMENT
 - ▨ TEMPORARY CONSTRUCTION EASEMENT
 - ▭ SECTION BOUNDARY
 - ▭ COUNTY BOUNDARY

NOTES:

1. THIS IS A PRELIMINARY DOCUMENT AND IS INTENDED TO DEPICT THE APPROXIMATE LOCATION OF A PROPOSED PIPELINE EASEMENT.
2. THIS DOCUMENT DOES NOT REPRESENT A LAND SURVEY AND IS NOT INTENDED TO DEPICT THE FINAL ALIGNMENT
3. COORDINATE SYSTEM: UTM ZONE 14 NORTH, NAD83, US SURVEY FEET

SIGNATURE: _____ DATE: _____



PRELIMINARY PIPELINE ROUTE		
DRAWN BY:	AC	SUMMIT CARBON SOLUTIONS MIDWEST CARBON EXPRESS R & C FEICKERT LAND LLC TAX ID: 3819 TRACT NUMBER: SD-MP-0705.100
CHECKED BY:	JW	
MAP DATE:	12/17/2021	
SCALE:	1 inch = 537'	
REV NO.	DATE	DESCRIPTION
A	12/17/2021	INITIAL ISSUE
B	3/8/2022	REVISED WORKSPACE
DRAWING NO. BW-MCE-ACQ-SD-MP-0705.100	PROJECT NO. 450959	SHEET NO. 01 of 01