

Attachment No. 1

EXHIBIT "B"

PRELIMINARY ROUTE

MCPHERSON COUNTY, SOUTH DAKOTA

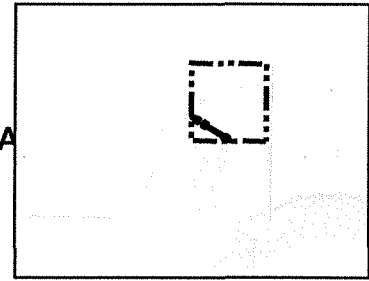
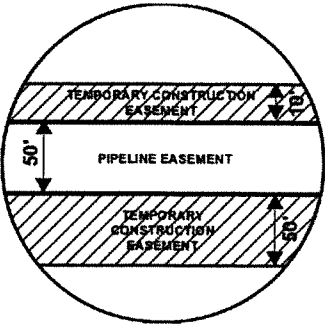

VICINITY MAP
N.T.S.

SEC. 34 T128N R70W

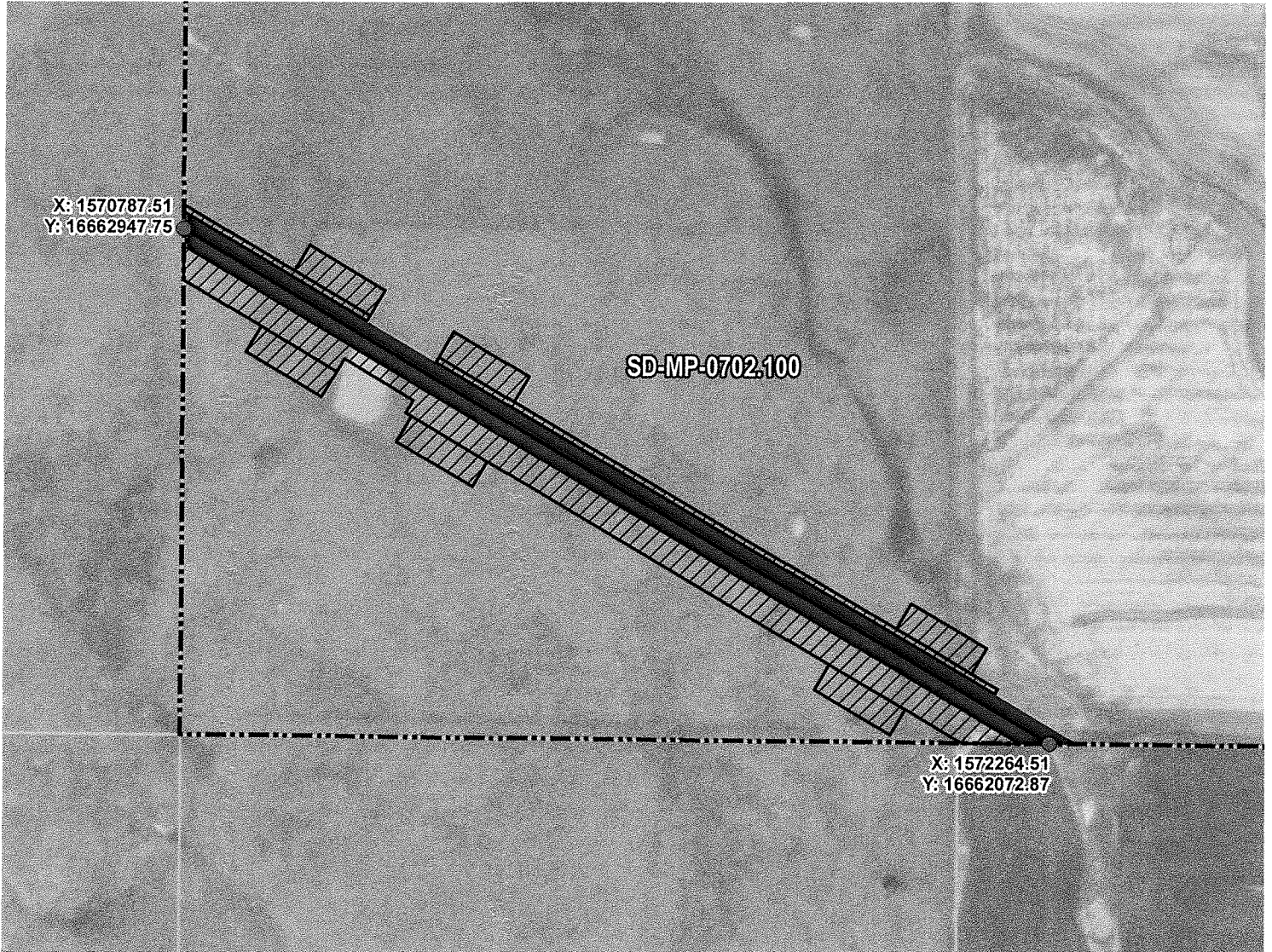

ROUTING LENGTH = 1716.764 FT +/-
 IMPACTS: PIPELINE EASEMENT = 1.971 AC. +/- / TEMPORARY CONSTRUCTION EASEMENT = 3.131 AC. +/-

PROPOSED ROUTE	PIPELINE EASEMENT
PARCEL BOUNDARY	TEMPORARY CONSTRUCTION EASEMENT
ADJACENT PROPERTIES	SECTION BOUNDARY
	COUNTY BOUNDARY

NOTES:

1. THIS IS A PRELIMINARY DOCUMENT AND IS INTENDED TO DEPICT THE APPROXIMATE LOCATION OF A PROPOSED PIPELINE EASEMENT.
2. THIS DOCUMENT DOES NOT REPRESENT A LAND SURVEY AND IS NOT INTENDED TO DEPICT THE FINAL ALIGNMENT
3. COORDINATE SYSTEM: UTM ZONE 14 NORTH, NAD83, US SURVEY FEET

PRELIMINARY PIPELINE ROUTE		
DRAWN BY:	AC	SUMMIT CARBON SOLUTIONS MIDWEST CARBON EXPRESS QUINTON WOLFF TAX ID: 3851 TRACT NUMBER: SD-MP-0702.100
CHECKED BY:	JW	
MAP DATE:	12/17/2021	
SCALE: 1 inch = 278'		
REV NO.	DATE	DESCRIPTION
E	7/18/2022	REVISED WORKSPACE
F	1/4/2023	REVISED PARCEL BOUNDARY



EXHIBIT "B"

PRELIMINARY ROUTE

MCPHERSON COUNTY, SOUTH DAKOTA

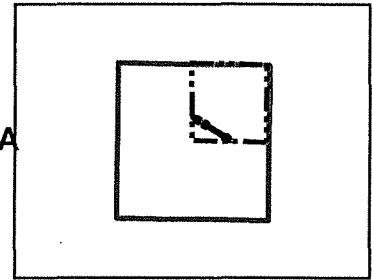
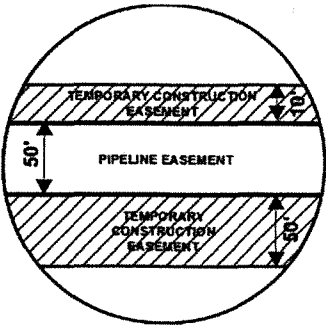

VICINITY MAP
N.T.S.

SEC. 34 T128N R70W

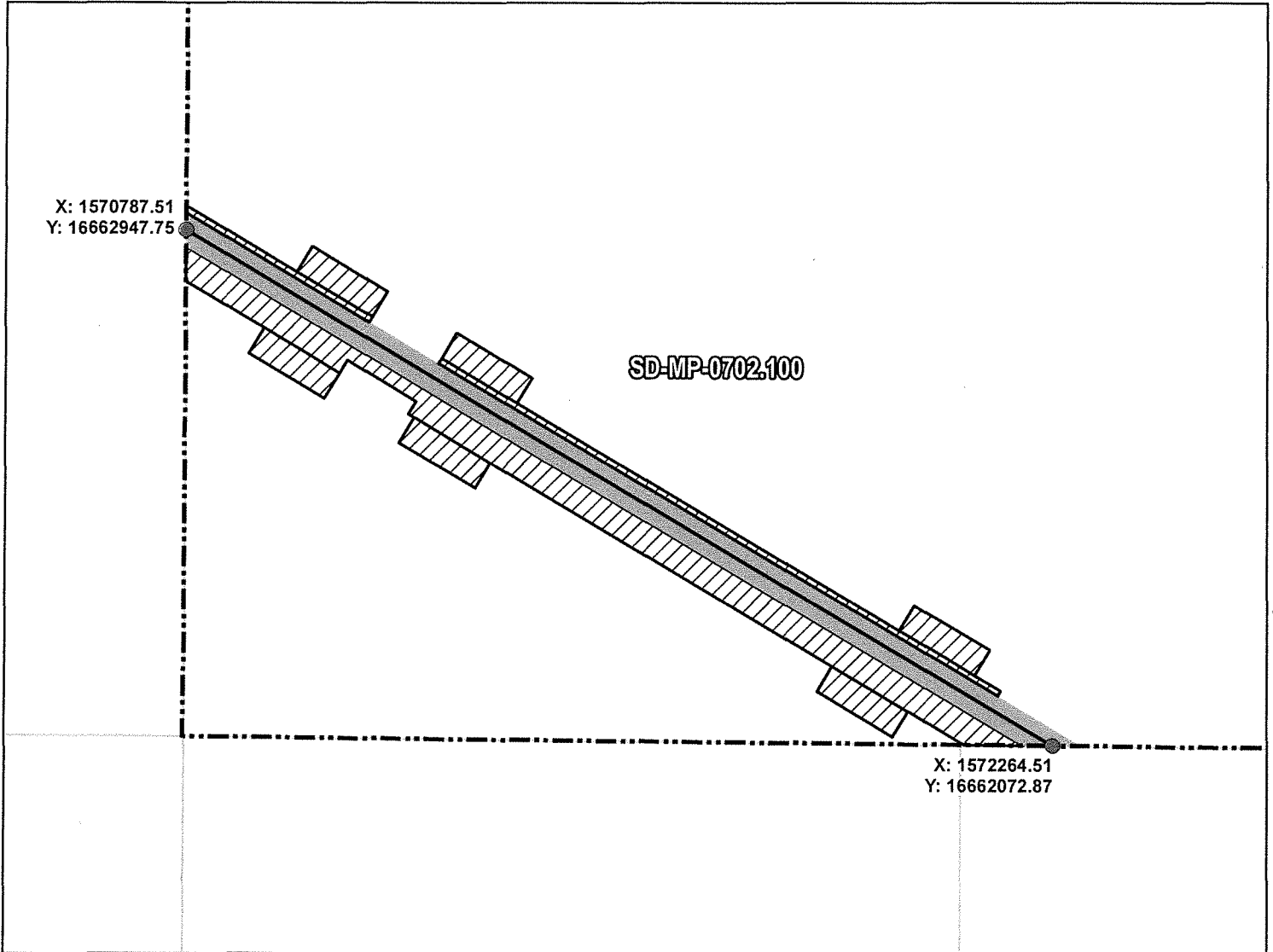

ROUTING LENGTH = 1716.764 FT +/-
 IMPACTS: PIPELINE EASEMENT = 1.971 AC. +/- / TEMPORARY CONSTRUCTION EASEMENT = 3.131 AC. +/-

PROPOSED ROUTE	PIPELINE EASEMENT
ROADS	TEMPORARY CONSTRUCTION EASEMENT
PARCEL BOUNDARY	SECTION BOUNDARY
ADJACENT PROPERTIES	COUNTY BOUNDARY

NOTES:

1. THIS IS A PRELIMINARY DOCUMENT AND IS INTENDED TO DEPICT THE APPROXIMATE LOCATION OF A PROPOSED PIPELINE EASEMENT.
2. THIS DOCUMENT DOES NOT REPRESENT A LAND SURVEY AND IS NOT INTENDED TO DEPICT THE FINAL ALIGNMENT
3. COORDINATE SYSTEM: UTM ZONE 14 NORTH, NAD83, US SURVEY FEET

SIGNATURE: _____ DATE: _____



SUMMIT CARBON

PRELIMINARY PIPELINE ROUTE		
DRAWN BY:	AC	SUMMIT CARBON SOLUTIONS MIDWEST CARBON EXPRESS QUINTON WOLFF TAX ID: 3851 TRACT NUMBER: SD-MP-0702.100
CHECKED BY:	JW	
MAP DATE:	12/17/2021	
SCALE:	1 inch = 278'	
REV NO.	DATE	DESCRIPTION
E	7/18/2022	REVISED WORKSPACE
F	1/4/2023	REVISED PARCEL BOUNDARY
DRAWING NO. _____		PROJECT NO. 450959 SHEET NO. 01 of 01

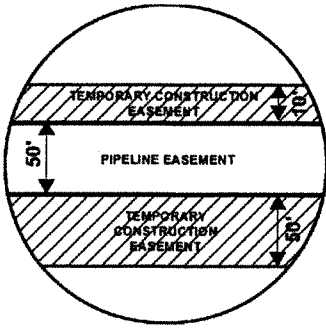
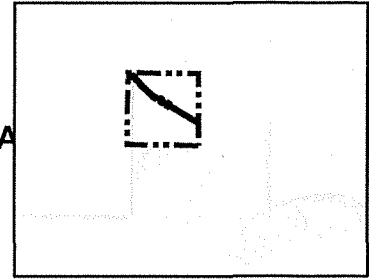

EXHIBIT "B"

PRELIMINARY ROUTE

MCPHERSON COUNTY, SOUTH DAKOTA



VICINITY MAP
N.T.S.

SEC. 34 T128N R70W

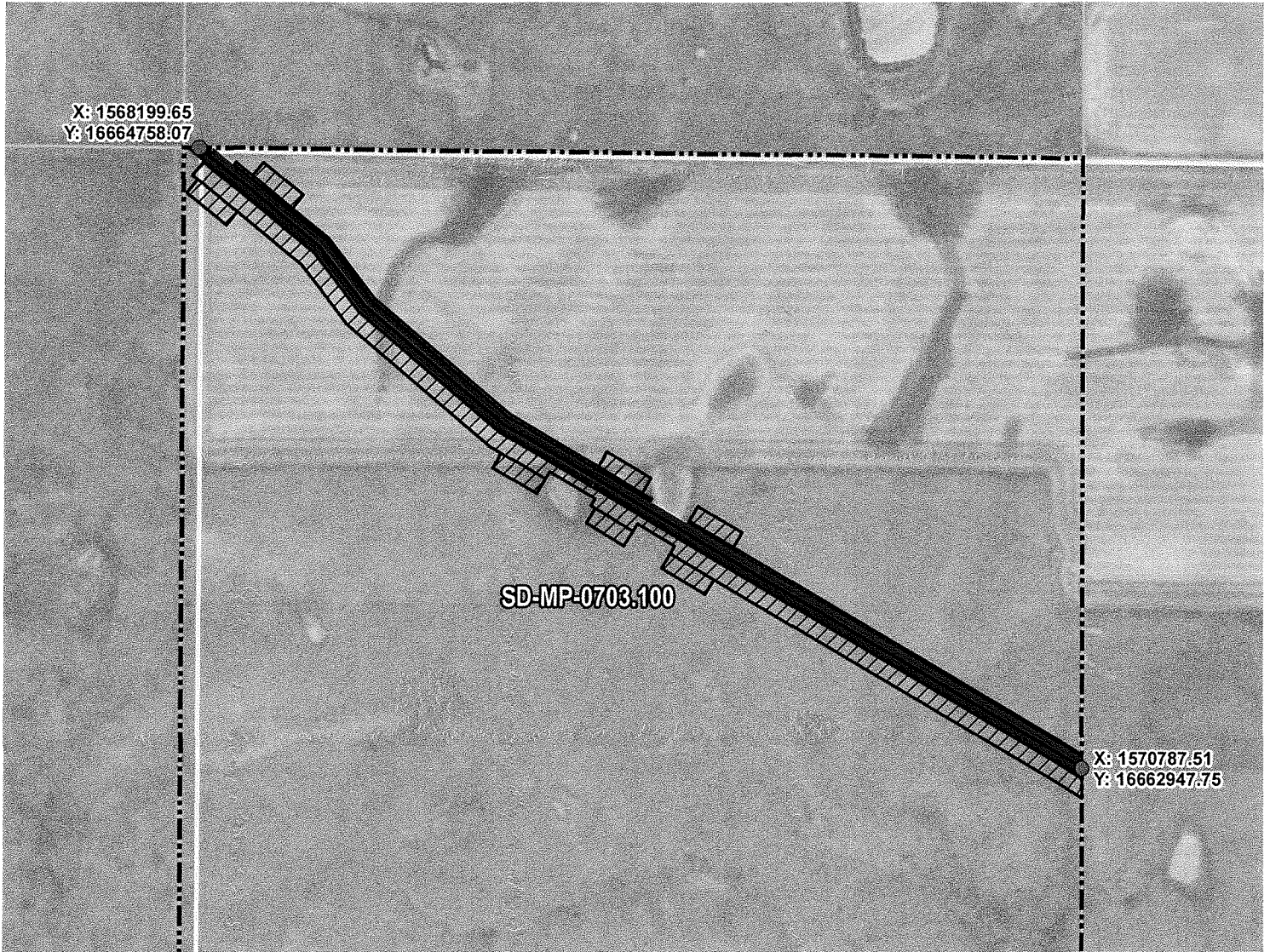

ROUTING LENGTH = 3177.447 FT +/-
 IMPACTS: PIPELINE EASEMENT = 3.647 AC. +/- / TEMPORARY CONSTRUCTION EASEMENT = 5.339 AC. +/-

PROPOSED ROUTE	PIPELINE EASEMENT
PARCEL BOUNDARY	TEMPORARY CONSTRUCTION EASEMENT
ADJACENT PROPERTIES	SECTION BOUNDARY
	COUNTY BOUNDARY

NOTES:

1. THIS IS A PRELIMINARY DOCUMENT AND IS INTENDED TO DEPICT THE APPROXIMATE LOCATION OF A PROPOSED PIPELINE EASEMENT.
2. THIS DOCUMENT DOES NOT REPRESENT A LAND SURVEY AND IS NOT INTENDED TO DEPICT THE FINAL ALIGNMENT
3. COORDINATE SYSTEM: UTM ZONE 14 NORTH, NAD83, US SURVEY FEET

PRELIMINARY PIPELINE ROUTE

DRAWN BY:	AC	SUMMIT CARBON SOLUTIONS MIDWEST CARBON EXPRESS QUINTON WOLFF TAX ID: 3852 & 3853 TRACT NUMBER: SD-MP-0703.100
CHECKED BY:	JW	
MAP DATE:	12/17/2021	
SCALE: 1 inch = 476'		
REV NO.	DATE	DESCRIPTION
E	11/14/2022	REVISED WORKSPACE
F	1/4/2023	REVISED PARCEL BOUNDARY



EXHIBIT "B"

PRELIMINARY ROUTE

MCPHERSON COUNTY, SOUTH DAKOTA

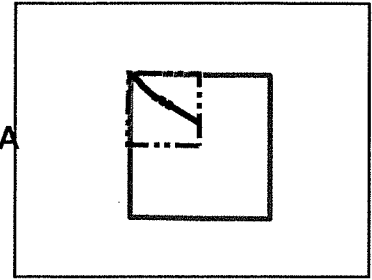
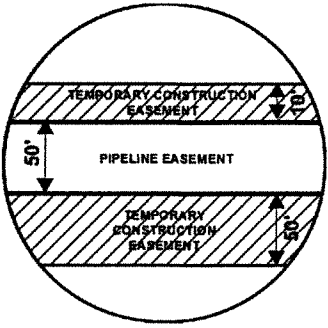

VICINITY MAP
N.T.S.



SEC. 34 T128N R70W

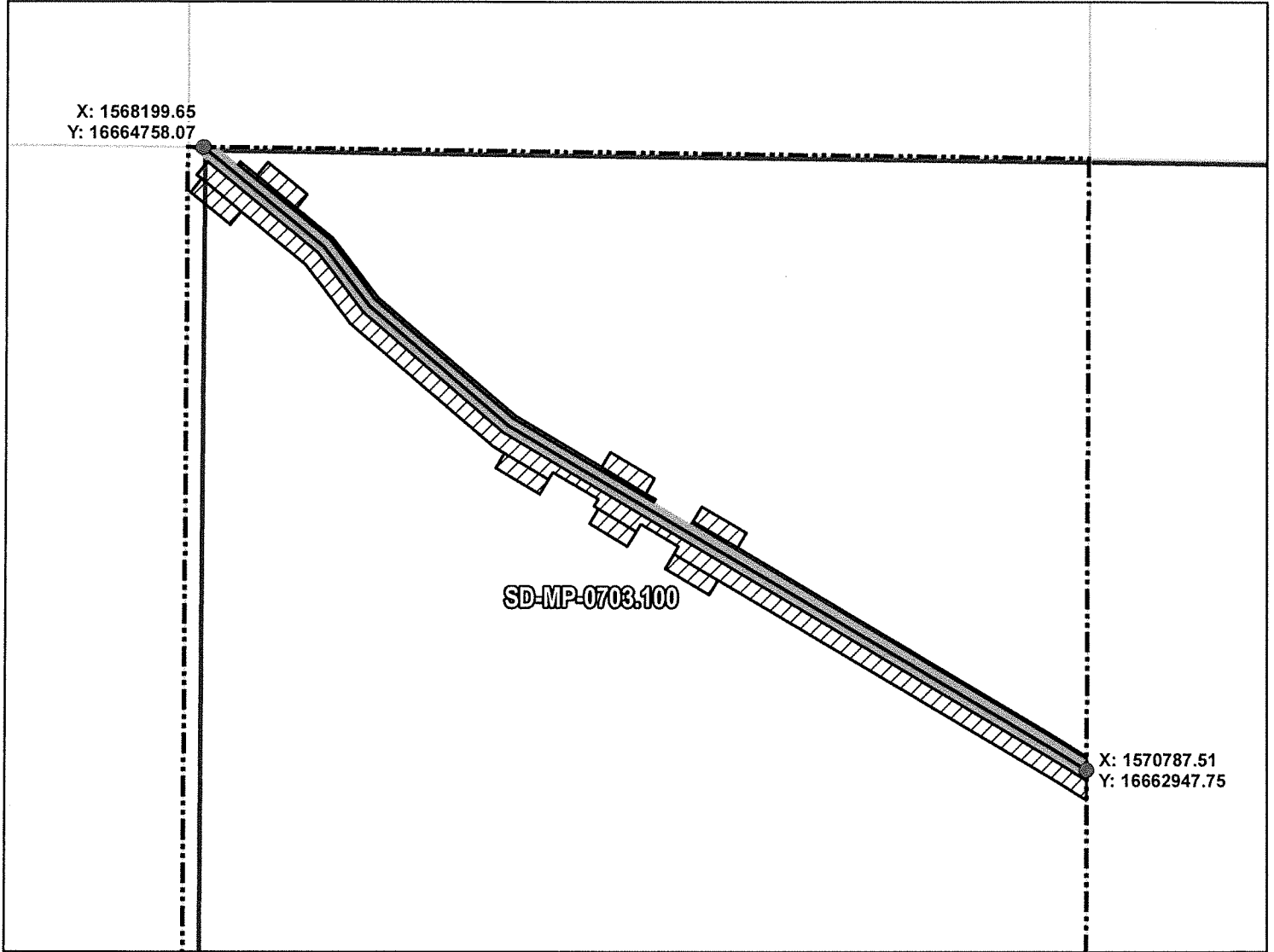

ROUTING LENGTH = 3177.447 FT +/-

IMPACTS: PIPELINE EASEMENT = 3.647 AC. +/- / TEMPORARY CONSTRUCTION EASEMENT = 5.339 AC. +/-

Legend

- PROPOSED ROUTE
- ROADS
- ▭ PARCEL BOUNDARY
- ▭ ADJACENT PROPERTIES
- ▨ PIPELINE EASEMENT
- ▨ TEMPORARY CONSTRUCTION EASEMENT
- ▭ SECTION BOUNDARY
- ▭ COUNTY BOUNDARY

NOTES:

1. THIS IS A PRELIMINARY DOCUMENT AND IS INTENDED TO DEPICT THE APPROXIMATE LOCATION OF A PROPOSED PIPELINE EASEMENT.
2. THIS DOCUMENT DOES NOT REPRESENT A LAND SURVEY AND IS NOT INTENDED TO DEPICT THE FINAL ALIGNMENT
3. COORDINATE SYSTEM: UTM ZONE 14 NORTH, NAD83, US SURVEY FEET

SIGNATURE: _____ DATE: _____



SUMMIT CARBON

PRELIMINARY PIPELINE ROUTE

DRAWN BY: AC		SUMMIT CARBON SOLUTIONS MIDWEST CARBON EXPRESS QUINTON WOLFF TAX ID: 3852 & 3853 TRACT NUMBER: SD-MP-0703.100
CHECKED BY: JW		
MAP DATE: 12/17/2021		
SCALE: 1 inch = 476'		
REV NO.	DATE	DESCRIPTION
E	11/14/2022	REVISED WORKSPACE
F	1/4/2023	REVISED PARCEL BOUNDARY

DRAWING NO.

PROJECT NO. 150050 SHEET NO. 01 of 04

EXHIBIT "B"

PRELIMINARY ROUTE

MCPHERSON COUNTY, SOUTH DAKOTA

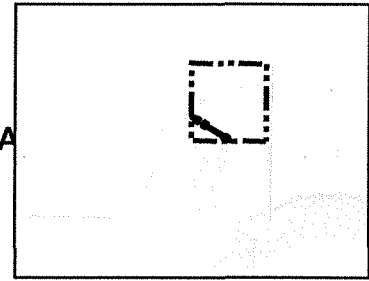
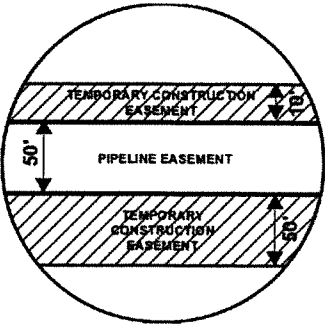

VICINITY MAP
N.T.S.

SEC. 34 T128N R70W

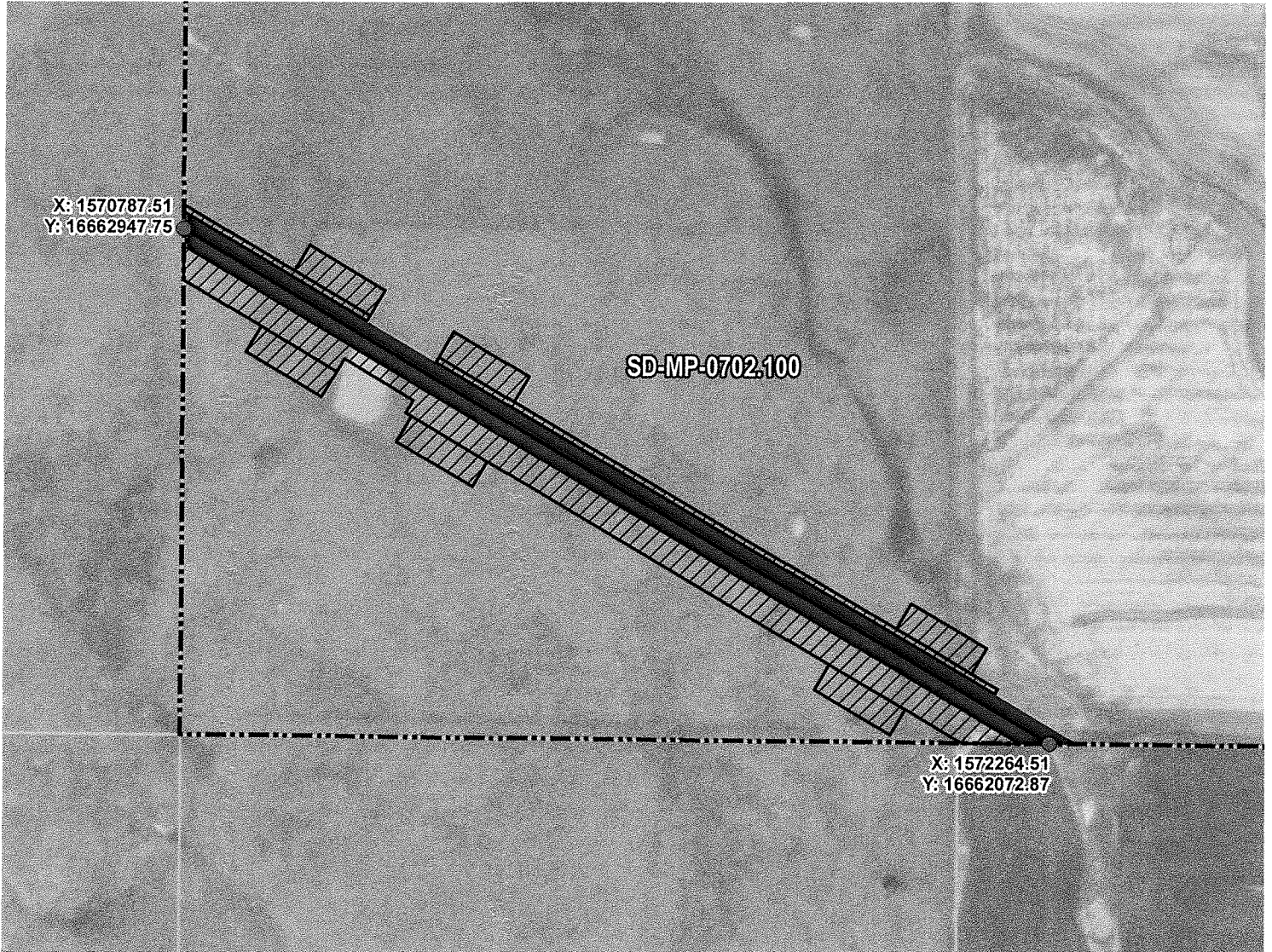

ROUTING LENGTH = 1716.764 FT +/-

IMPACTS: PIPELINE EASEMENT = 1.971 AC. +/- / TEMPORARY CONSTRUCTION EASEMENT = 3.131 AC. +/-

Legend

- PROPOSED ROUTE
- PIPELINE EASEMENT
- PARCEL BOUNDARY
- TEMPORARY CONSTRUCTION EASEMENT
- ADJACENT PROPERTIES
- SECTION BOUNDARY
- COUNTY BOUNDARY

NOTES:

1. THIS IS A PRELIMINARY DOCUMENT AND IS INTENDED TO DEPICT THE APPROXIMATE LOCATION OF A PROPOSED PIPELINE EASEMENT.
2. THIS DOCUMENT DOES NOT REPRESENT A LAND SURVEY AND IS NOT INTENDED TO DEPICT THE FINAL ALIGNMENT
3. COORDINATE SYSTEM: UTM ZONE 14 NORTH, NAD83, US SURVEY FEET



SUMMIT CARBON

PRELIMINARY PIPELINE ROUTE		
DRAWN BY:	AC	SUMMIT CARBON SOLUTIONS MIDWEST CARBON EXPRESS QUINTON WOLFF TAX ID: 3851 TRACT NUMBER: SD-MP-0702.100
CHECKED BY:	JW	
MAP DATE:	12/17/2021	
SCALE: 1 inch = 278'		
REV NO.	DATE	DESCRIPTION
E	7/18/2022	REVISED WORKSPACE
F	1/4/2023	REVISED PARCEL BOUNDARY

DRAWING NO.

PROJECT NO. 450959

SHEET NO. 01 of 01

EXHIBIT "B"

PRELIMINARY ROUTE

MCPHERSON COUNTY, SOUTH DAKOTA

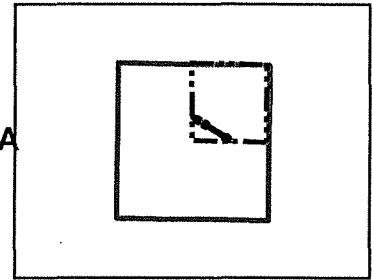
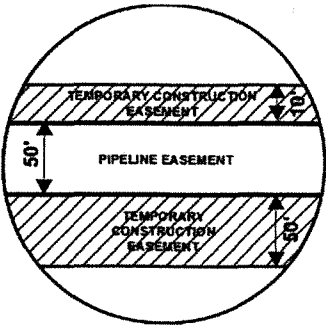

VICINITY MAP
N.T.S.

SEC. 34 T128N R70W

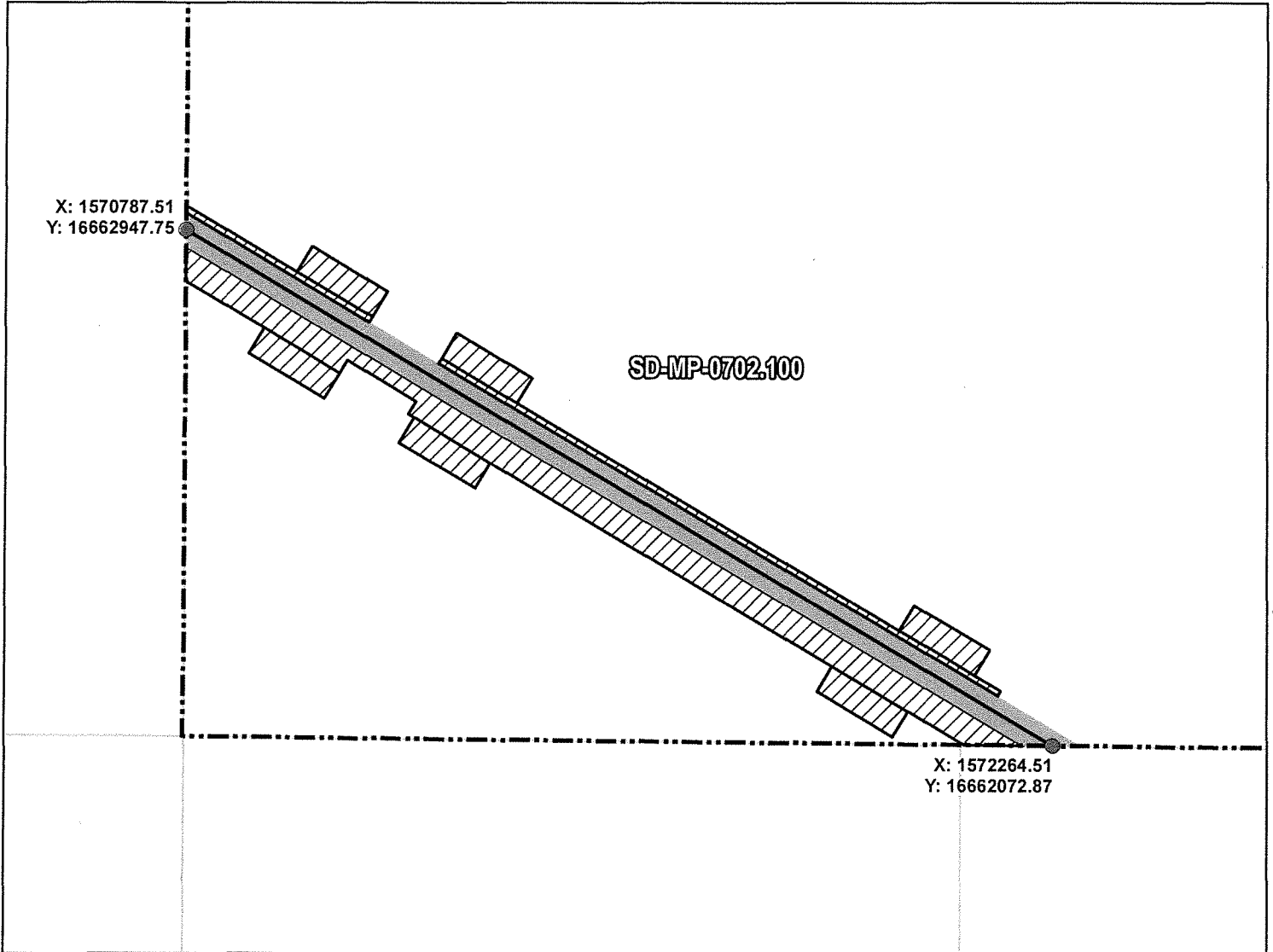

ROUTING LENGTH = 1716.764 FT +/-
 IMPACTS: PIPELINE EASEMENT = 1.971 AC. +/- / TEMPORARY CONSTRUCTION EASEMENT = 3.131 AC. +/-

PROPOSED ROUTE	PIPELINE EASEMENT
ROADS	TEMPORARY CONSTRUCTION EASEMENT
PARCEL BOUNDARY	SECTION BOUNDARY
ADJACENT PROPERTIES	COUNTY BOUNDARY

NOTES:

1. THIS IS A PRELIMINARY DOCUMENT AND IS INTENDED TO DEPICT THE APPROXIMATE LOCATION OF A PROPOSED PIPELINE EASEMENT.
2. THIS DOCUMENT DOES NOT REPRESENT A LAND SURVEY AND IS NOT INTENDED TO DEPICT THE FINAL ALIGNMENT
3. COORDINATE SYSTEM: UTM ZONE 14 NORTH, NAD83, US SURVEY FEET

SIGNATURE: _____ DATE: _____



SUMMIT CARBON

PRELIMINARY PIPELINE ROUTE		
DRAWN BY:	AC	SUMMIT CARBON SOLUTIONS MIDWEST CARBON EXPRESS QUINTON WOLFF TAX ID: 3851 TRACT NUMBER: SD-MP-0702.100
CHECKED BY:	JW	
MAP DATE:	12/17/2021	
SCALE:	1 inch = 278'	
REV NO.	DATE	DESCRIPTION
E	7/18/2022	REVISED WORKSPACE
F	1/4/2023	REVISED PARCEL BOUNDARY
DRAWING NO. _____		PROJECT NO. 450959 SHEET NO. 01 of 01

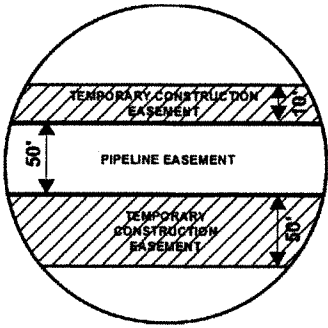
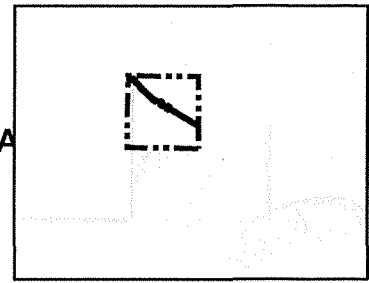

EXHIBIT "B"

PRELIMINARY ROUTE

MCPHERSON COUNTY, SOUTH DAKOTA



VICINITY MAP
N.T.S.

SEC. 34 T128N R70W

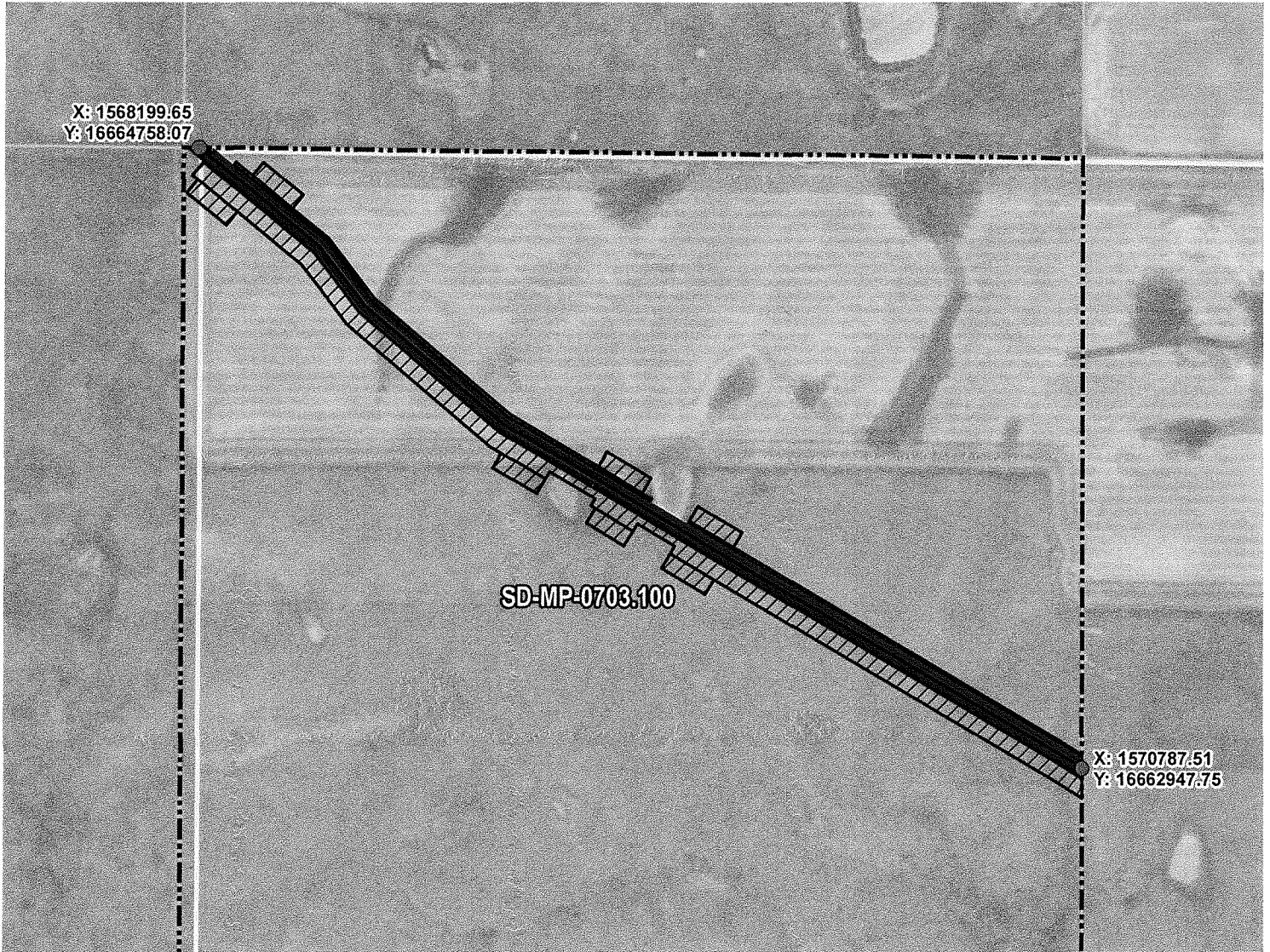

ROUTING LENGTH = 3177.447 FT +/-
 IMPACTS: PIPELINE EASEMENT = 3.647 AC. +/- / TEMPORARY CONSTRUCTION EASEMENT = 5.339 AC. +/-

Legend

- PROPOSED ROUTE
- PIPELINE EASEMENT
- PARCEL BOUNDARY
- TEMPORARY CONSTRUCTION EASEMENT
- ADJACENT PROPERTIES
- SECTION BOUNDARY
- COUNTY BOUNDARY

NOTES:

1. THIS IS A PRELIMINARY DOCUMENT AND IS INTENDED TO DEPICT THE APPROXIMATE LOCATION OF A PROPOSED PIPELINE EASEMENT.
2. THIS DOCUMENT DOES NOT REPRESENT A LAND SURVEY AND IS NOT INTENDED TO DEPICT THE FINAL ALIGNMENT
3. COORDINATE SYSTEM: UTM ZONE 14 NORTH, NAD83, US SURVEY FEET

PRELIMINARY PIPELINE ROUTE

DRAWN BY:	AC	SUMMIT CARBON SOLUTIONS MIDWEST CARBON EXPRESS QUINTON WOLFF
CHECKED BY:	JW	
MAP DATE:	12/17/2021	
SCALE: 1 inch = 476'		TAX ID: 3852 & 3853 TRACT NUMBER: SD-MP-0703.100
REV NO.	DATE	DESCRIPTION
E	11/14/2022	REVISED WORKSPACE
F	1/4/2023	REVISED PARCEL BOUNDARY

EXHIBIT "B"

PRELIMINARY ROUTE

MCPHERSON COUNTY, SOUTH DAKOTA

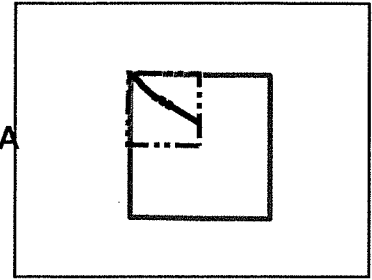
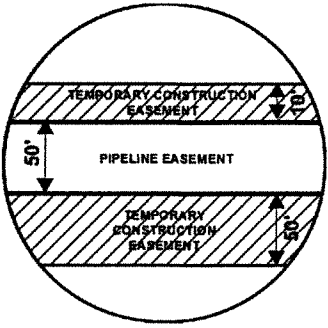

VICINITY MAP
N.T.S.

SEC. 34 T128N R70W

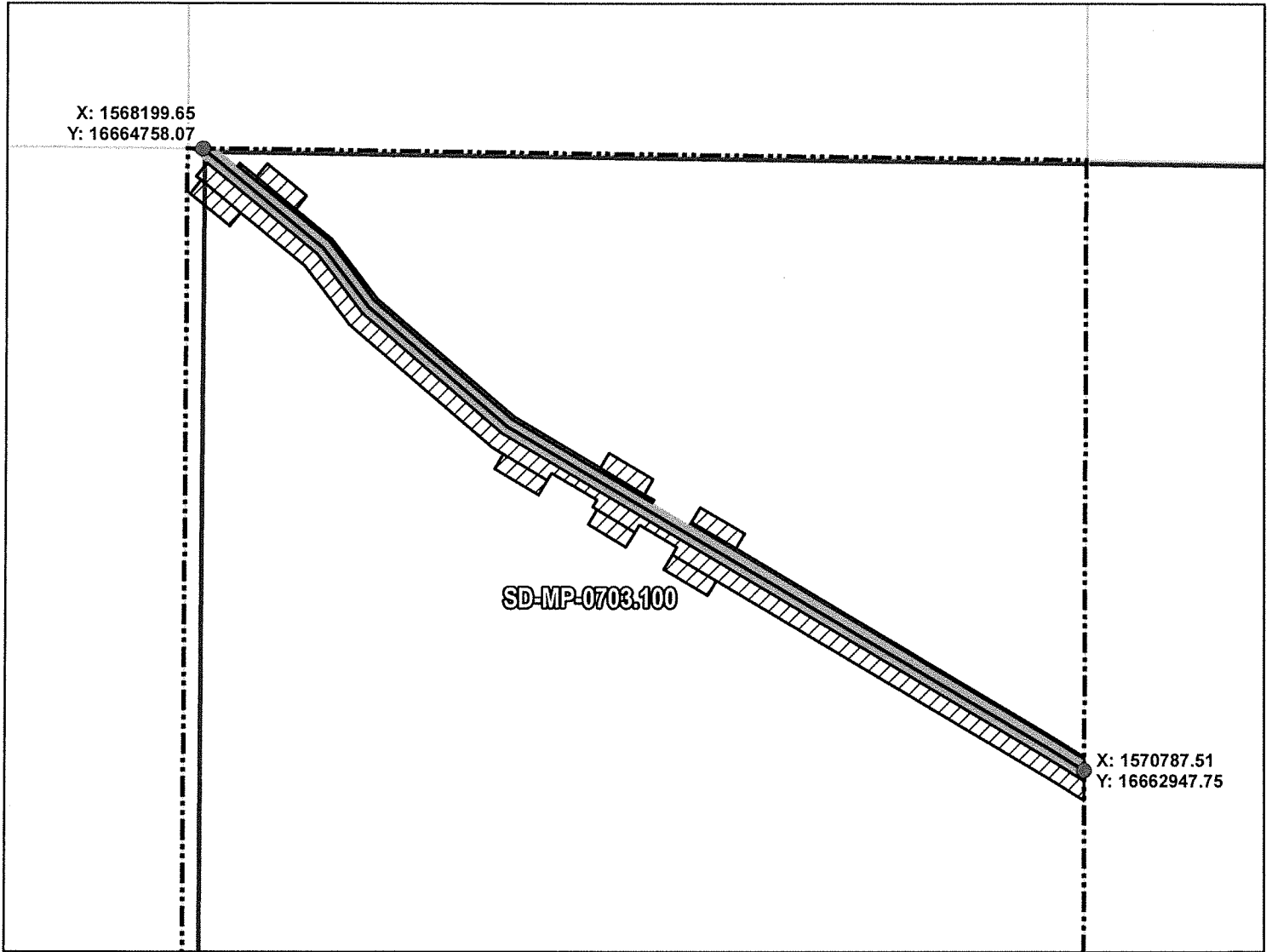

ROUTING LENGTH = 3177.447 FT +/-
 IMPACTS: PIPELINE EASEMENT = 3.647 AC. +/- / TEMPORARY CONSTRUCTION EASEMENT = 5.339 AC. +/-

PROPOSED ROUTE	PIPELINE EASEMENT
ROADS	TEMPORARY CONSTRUCTION EASEMENT
PARCEL BOUNDARY	SECTION BOUNDARY
ADJACENT PROPERTIES	COUNTY BOUNDARY

NOTES:

1. THIS IS A PRELIMINARY DOCUMENT AND IS INTENDED TO DEPICT THE APPROXIMATE LOCATION OF A PROPOSED PIPELINE EASEMENT.
2. THIS DOCUMENT DOES NOT REPRESENT A LAND SURVEY AND IS NOT INTENDED TO DEPICT THE FINAL ALIGNMENT
3. COORDINATE SYSTEM: UTM ZONE 14 NORTH, NAD83, US SURVEY FEET

SIGNATURE: _____ DATE: _____



SUMMIT CARBON

PRELIMINARY PIPELINE ROUTE

DRAWN BY: AC		SUMMIT CARBON SOLUTIONS MIDWEST CARBON EXPRESS QUINTON WOLFF TAX ID: 3852 & 3853 TRACT NUMBER: SD-MP-0703.100
CHECKED BY: JW		
MAP DATE: 12/17/2021		
SCALE: 1 inch = 476'		
REV NO.	DATE	DESCRIPTION
E	11/14/2022	REVISED WORKSPACE
F	1/4/2023	REVISED PARCEL BOUNDARY