

Attachment No. 1

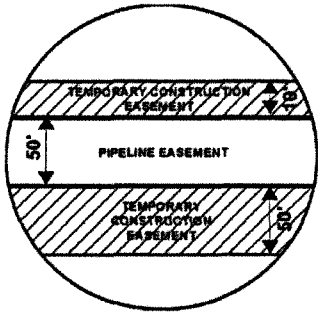
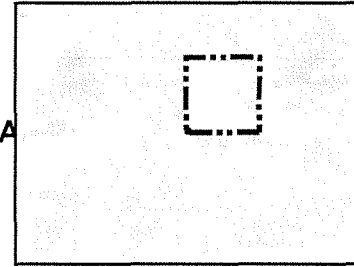

EXHIBIT "B"

PRELIMINARY ROUTE

MCPHERSON COUNTY, SOUTH DAKOTA



VICINITY MAP
N.T.S.

SEC. 35 T127N R69W

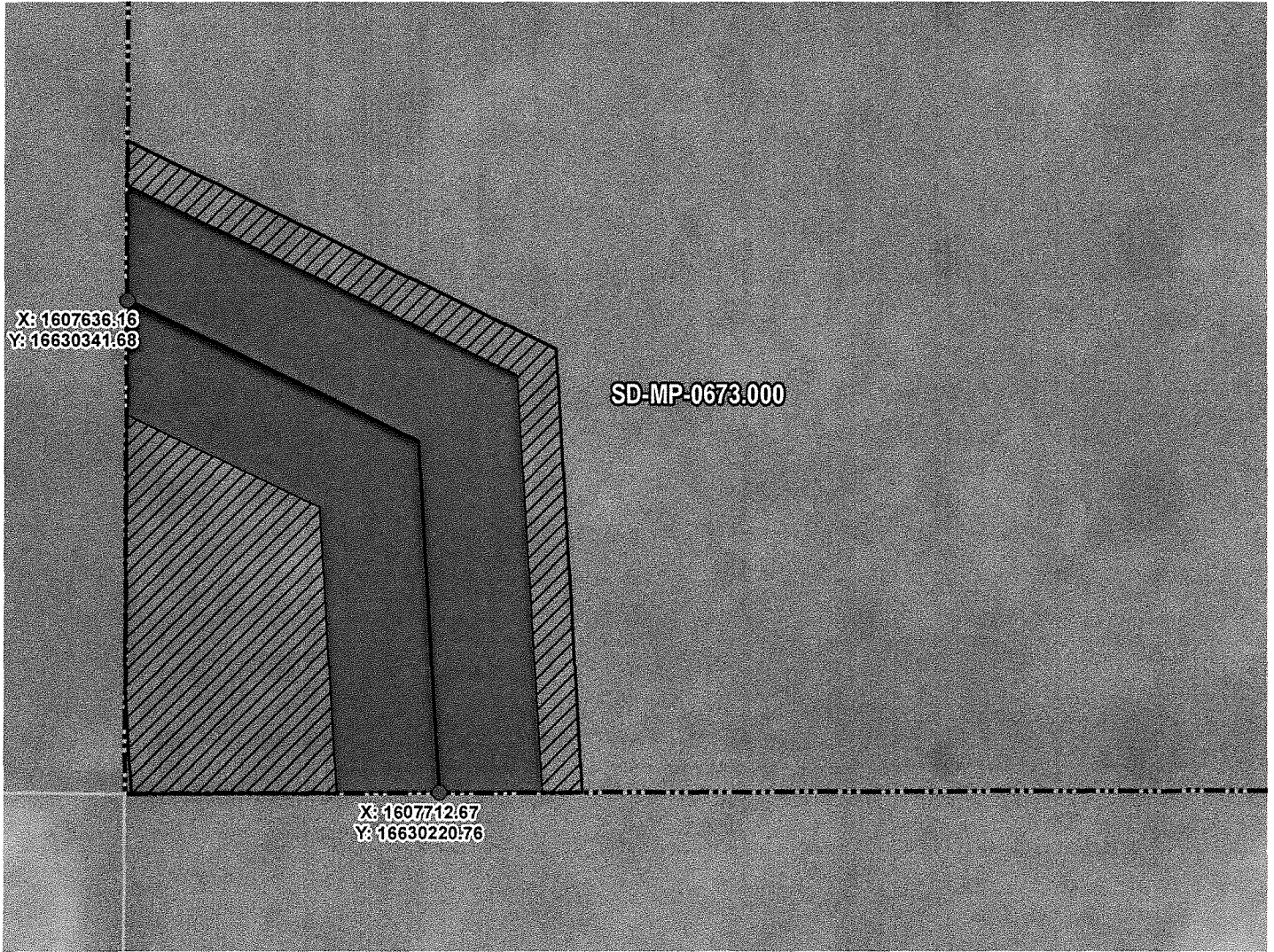

ROUTING LENGTH = 165.466 FT +/-
 IMPACTS: PIPELINE EASEMENT = 0.19 AC. +/- / TEMPORARY CONSTRUCTION EASEMENT = 0.141 AC. +/-

Legend

- PROPOSED ROUTE
- PARCEL BOUNDARY
- ADJACENT PROPERTIES
- PIPELINE EASEMENT
- TEMPORARY CONSTRUCTION EASEMENT
- SECTION BOUNDARY
- COUNTY BOUNDARY

NOTES:

1. THIS IS A PRELIMINARY DOCUMENT AND IS INTENDED TO DEPICT THE APPROXIMATE LOCATION OF A PROPOSED PIPELINE EASEMENT.
2. THIS DOCUMENT DOES NOT REPRESENT A LAND SURVEY AND IS NOT INTENDED TO DEPICT THE FINAL ALIGNMENT
3. COORDINATE SYSTEM: UTM ZONE 14 NORTH, NAD83, US SURVEY FEET

PRELIMINARY PIPELINE ROUTE

DRAWN BY:	AC	SUMMIT CARBON SOLUTIONS MIDWEST CARBON EXPRESS VILHAUER LAND LIMITED PARTNERSHIP
CHECKED BY:	JW	
MAP DATE:	12/17/2021	
SCALE:	1 inch = 40'	TAX ID: 2757 TRACT NUMBER: SD-MP-0673.000
REV NO.	DATE	DESCRIPTION
D	5/27/2022	REVISED WORKSPACE
E	12/2/2022	REVISED PARCEL BOUNDARY
DRAWING NO. C-MCE-ACQ-SD-MP-0673.000		PROJECT NO. 450959 SHEET NO. 01 of 01



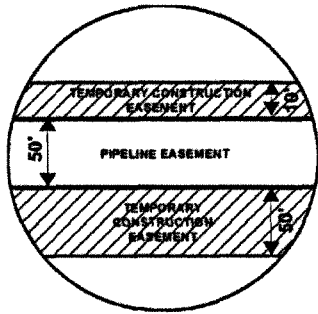
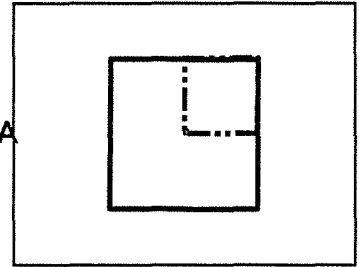

EXHIBIT "B"

PRELIMINARY ROUTE

MCPHERSON COUNTY, SOUTH DAKOTA



VICINITY MAP
N.T.S.

SEC. 35 T127N R69W

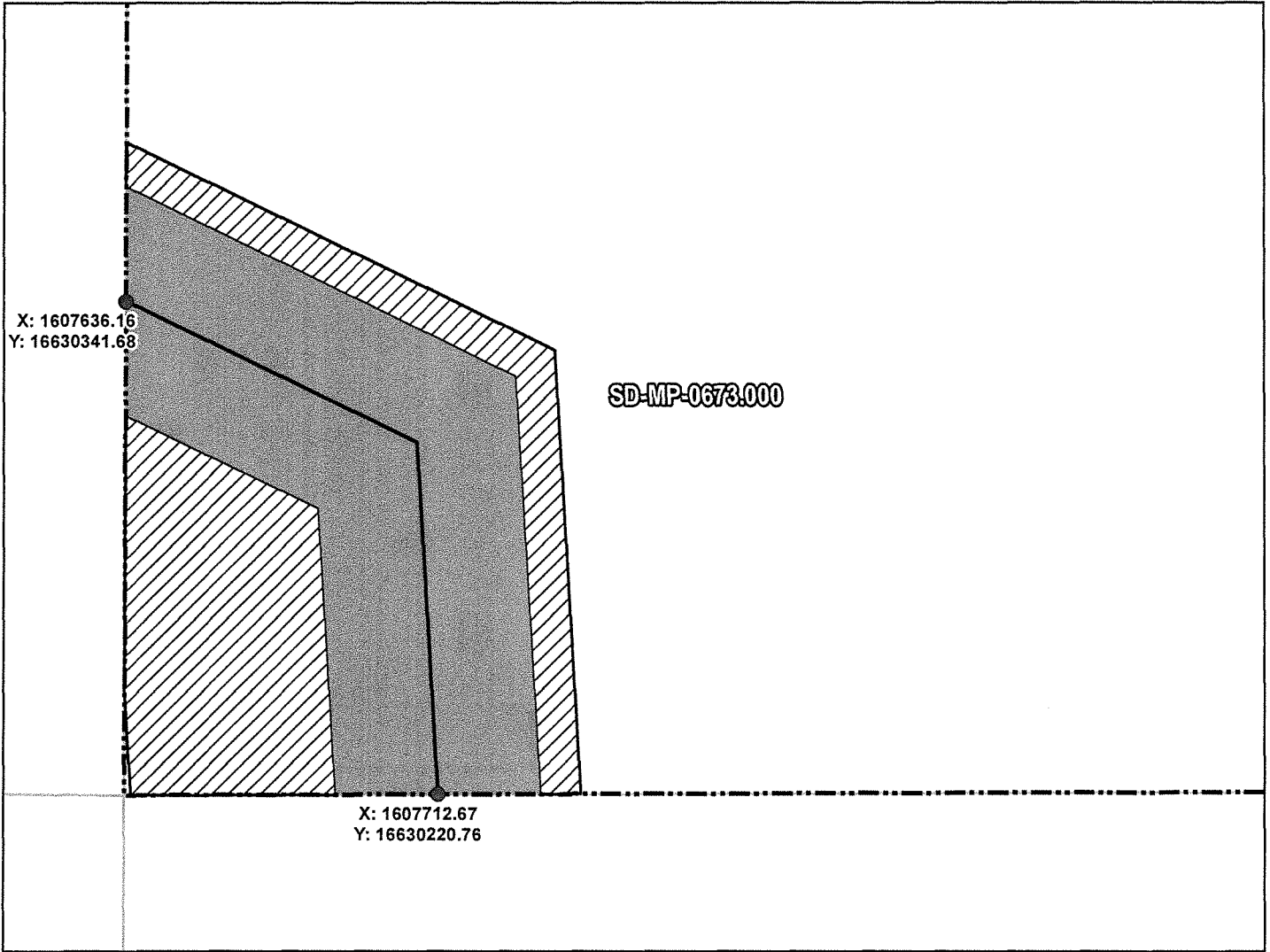

ROUTING LENGTH = 165.466 FT +/-
 IMPACTS: PIPELINE EASEMENT = 0.19 AC. +/- / TEMPORARY CONSTRUCTION EASEMENT = 0.141 AC. +/-

PROPOSED ROUTE	PIPELINE EASEMENT
ROADS	TEMPORARY CONSTRUCTION EASEMENT
PARCEL BOUNDARY	SECTION BOUNDARY
ADJACENT PROPERTIES	COUNTY BOUNDARY

NOTES:

1. THIS IS A PRELIMINARY DOCUMENT AND IS INTENDED TO DEPICT THE APPROXIMATE LOCATION OF A PROPOSED PIPELINE EASEMENT.
2. THIS DOCUMENT DOES NOT REPRESENT A LAND SURVEY AND IS NOT INTENDED TO DEPICT THE FINAL ALIGNMENT
3. COORDINATE SYSTEM: UTM ZONE 14 NORTH, NAD83, US SURVEY FEET

SIGNATURE: _____ DATE: _____



PRELIMINARY PIPELINE ROUTE

DRAWN BY:	AC	SUMMIT CARBON SOLUTIONS MIDWEST CARBON EXPRESS VILHAUER LAND LIMITED PARTNERSHIP TAX ID: 2757 TRACT NUMBER: SD-MP-0673.000
CHECKED BY:	JW	
MAP DATE:	12/17/2021	
SCALE:	1 inch = 40'	
REV NO.	DATE	DESCRIPTION
D	5/27/2022	REVISED WORKSPACE
E	12/2/2022	REVISED PARCEL BOUNDARY
DRAWING NO. BW-MCE-ACQ-SD-MP-0673.000		PROJECT NO. 450959 SHEET NO. 01 of 01

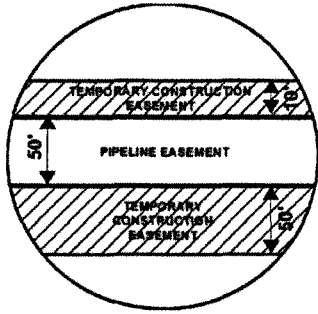
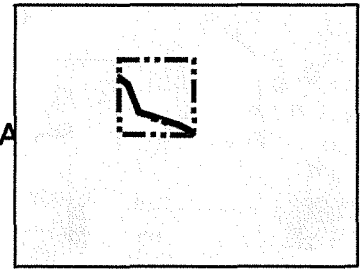

EXHIBIT "B"

PRELIMINARY ROUTE

MCPHERSON COUNTY, SOUTH DAKOTA



VICINITY MAP
N.T.S.

SEC. 35 T127N R69W

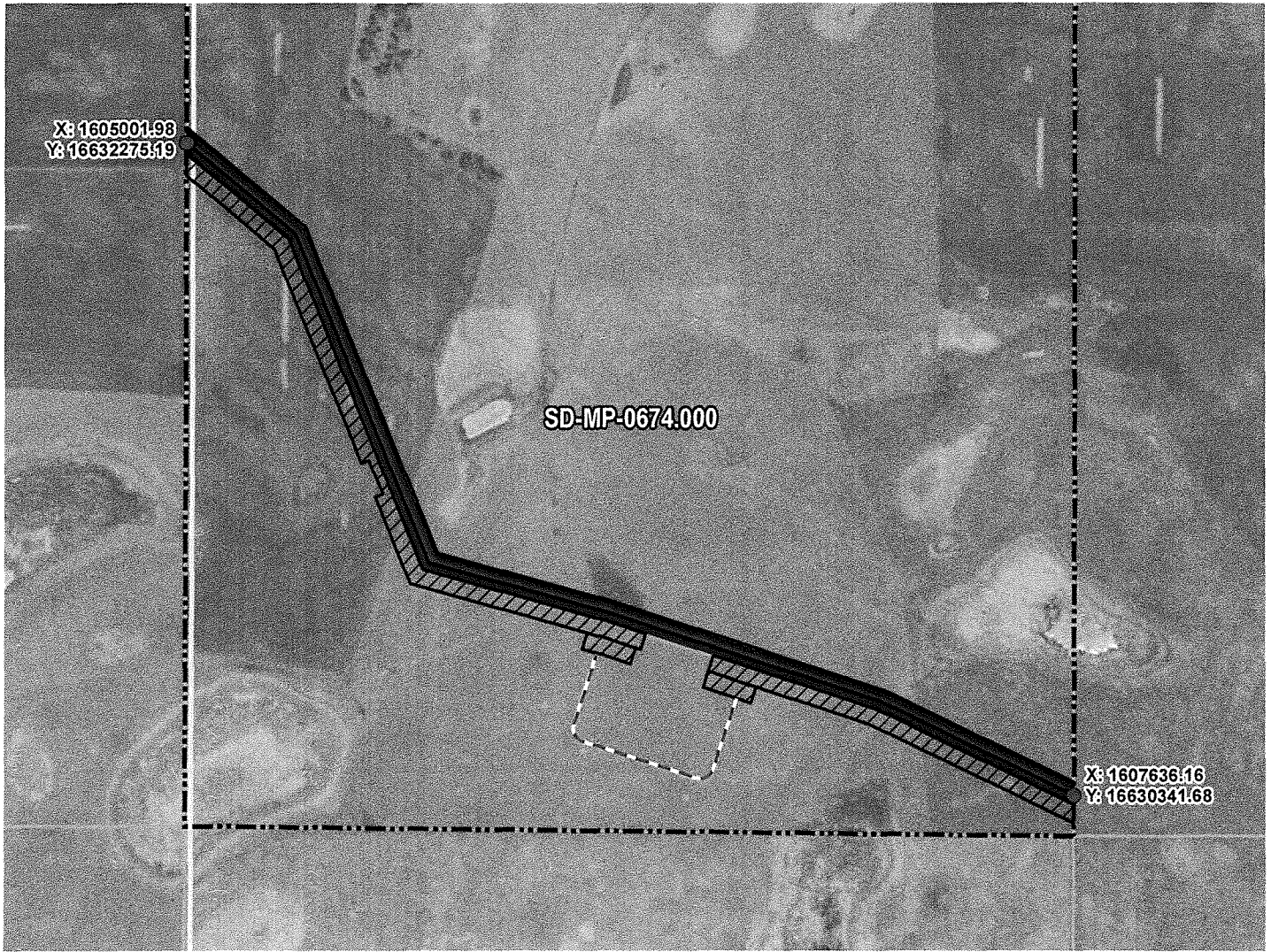

ROUTING LENGTH = 3512.96 FT +/- / ACCESS EASEMENT LENGTH = 920.388 FT +/-
 IMPACTS: PIPELINE EASEMENT = 4.032 AC. +/- / TEMPORARY CONSTRUCTION EASEMENT = 4.879 AC. +/-

Legend

- PROPOSED ROUTE
- ACCESS EASEMENT
- PARCEL BOUNDARY
- ADJACENT PROPERTIES
- PIPELINE EASEMENT
- TEMPORARY CONSTRUCTION EASEMENT
- SECTION BOUNDARY
- COUNTY BOUNDARY

NOTES:

1. THIS IS A PRELIMINARY DOCUMENT AND IS INTENDED TO DEPICT THE APPROXIMATE LOCATION OF A PROPOSED PIPELINE EASEMENT.
2. THIS DOCUMENT DOES NOT REPRESENT A LAND SURVEY AND IS NOT INTENDED TO DEPICT THE FINAL ALIGNMENT
3. COORDINATE SYSTEM: UTM ZONE 14 NORTH, NAD83, US SURVEY FEET

PRELIMINARY PIPELINE ROUTE

DRAWN BY:	AC	SUMMIT CARBON SOLUTIONS MIDWEST CARBON EXPRESS VILHAUER LAND LIMITED PARTNERSHIP TAX ID: 2758 TRACT NUMBER: SD-MP-0674.000
CHECKED BY:	JW	
MAP DATE:	12/17/2021	
SCALE:	1 inch = 483'	
REV NO.	DATE	DESCRIPTION
H	11/1/2022	REVISED WORKSPACE
J	11/4/2022	REVISED WORKSPACE
DRAWING NO. C-MCE-ACQ-SD-MP-0674.000		PROJECT NO. 450959 SHEET NO. 01 of 01



EXHIBIT "B"

PRELIMINARY ROUTE

MCPHERSON COUNTY, SOUTH DAKOTA

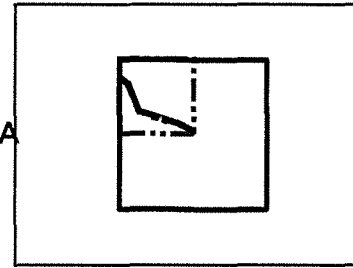
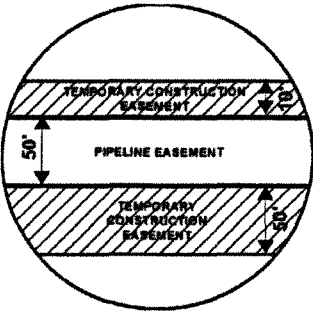

VICINITY MAP
N.T.S.

SEC. 35 T127N R69W

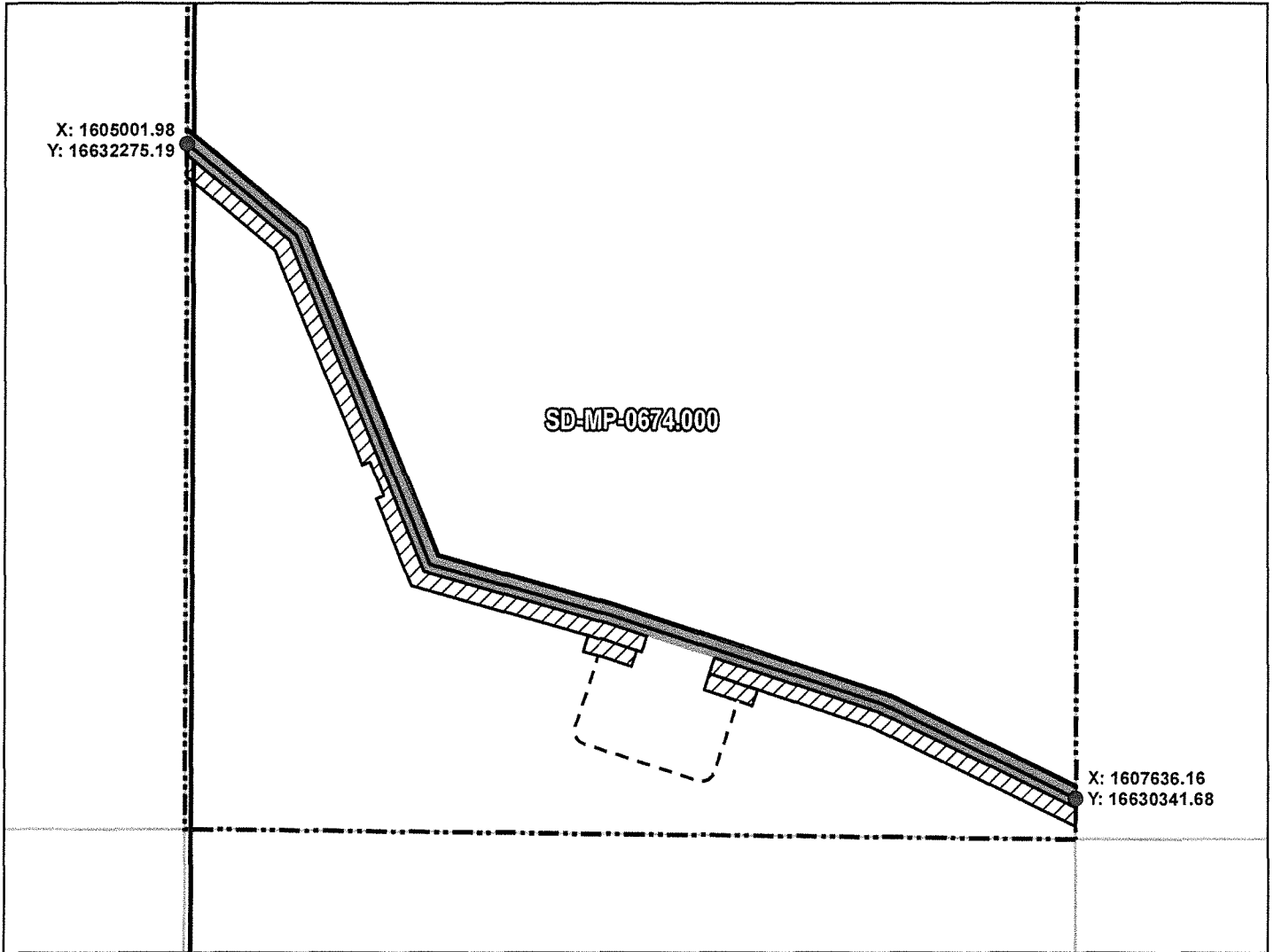

ROUTING LENGTH = 3512.96 FT +/- / ACCESS EASEMENT LENGTH = 920.388 FT +/-
 IMPACTS: PIPELINE EASEMENT = 4.032 AC. +/- / TEMPORARY CONSTRUCTION EASEMENT = 4.879 AC. +/-

Legend

- PROPOSED ROUTE
- - - ACCESS EASEMENT
- ROADS
- ▭ PARCEL BOUNDARY
- ▭ ADJACENT PROPERTIES
- ▨ PIPELINE EASEMENT
- ▨ TEMPORARY CONSTRUCTION EASEMENT
- ▭ SECTION BOUNDARY
- ▭ COUNTY BOUNDARY

NOTES:

1. THIS IS A PRELIMINARY DOCUMENT AND IS INTENDED TO DEPICT THE APPROXIMATE LOCATION OF A PROPOSED PIPELINE EASEMENT.
2. THIS DOCUMENT DOES NOT REPRESENT A LAND SURVEY AND IS NOT INTENDED TO DEPICT THE FINAL ALIGNMENT
3. COORDINATE SYSTEM: UTM ZONE 14 NORTH, NAD83, US SURVEY FEET

SIGNATURE: _____ DATE: _____



PRELIMINARY PIPELINE ROUTE

DRAWN BY:	AC	SUMMIT CARBON SOLUTIONS MIDWEST CARBON EXPRESS VILHAUER LAND LIMITED PARTNERSHIP TAX ID: 2758 TRACT NUMBER: SD-MP-0674.000
CHECKED BY:	JW	
MAP DATE:	12/17/2021	
SCALE:	1 inch = 483'	
REV NO.	DATE	DESCRIPTION
H	11/1/2022	REVISED WORKSPACE
J	11/4/2022	REVISED WORKSPACE
DRAWING NO.	PROJECT NO.	SHEET NO.
BW-MCE-ACQ-SD-MP-0674.000	450959	01 of 01

EXHIBIT "B"

PRELIMINARY ROUTE

MCPHERSON COUNTY, SOUTH DAKOTA

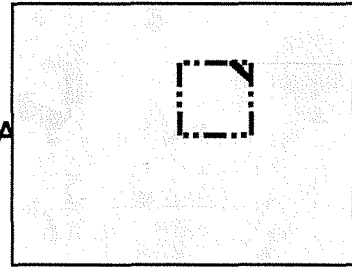
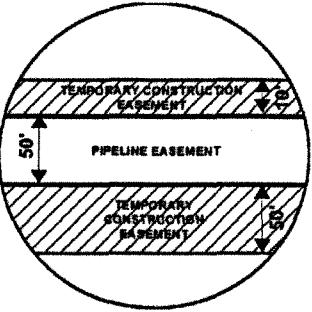

VICINITY MAP
N.T.S.

SEC. 34 T127N R69W

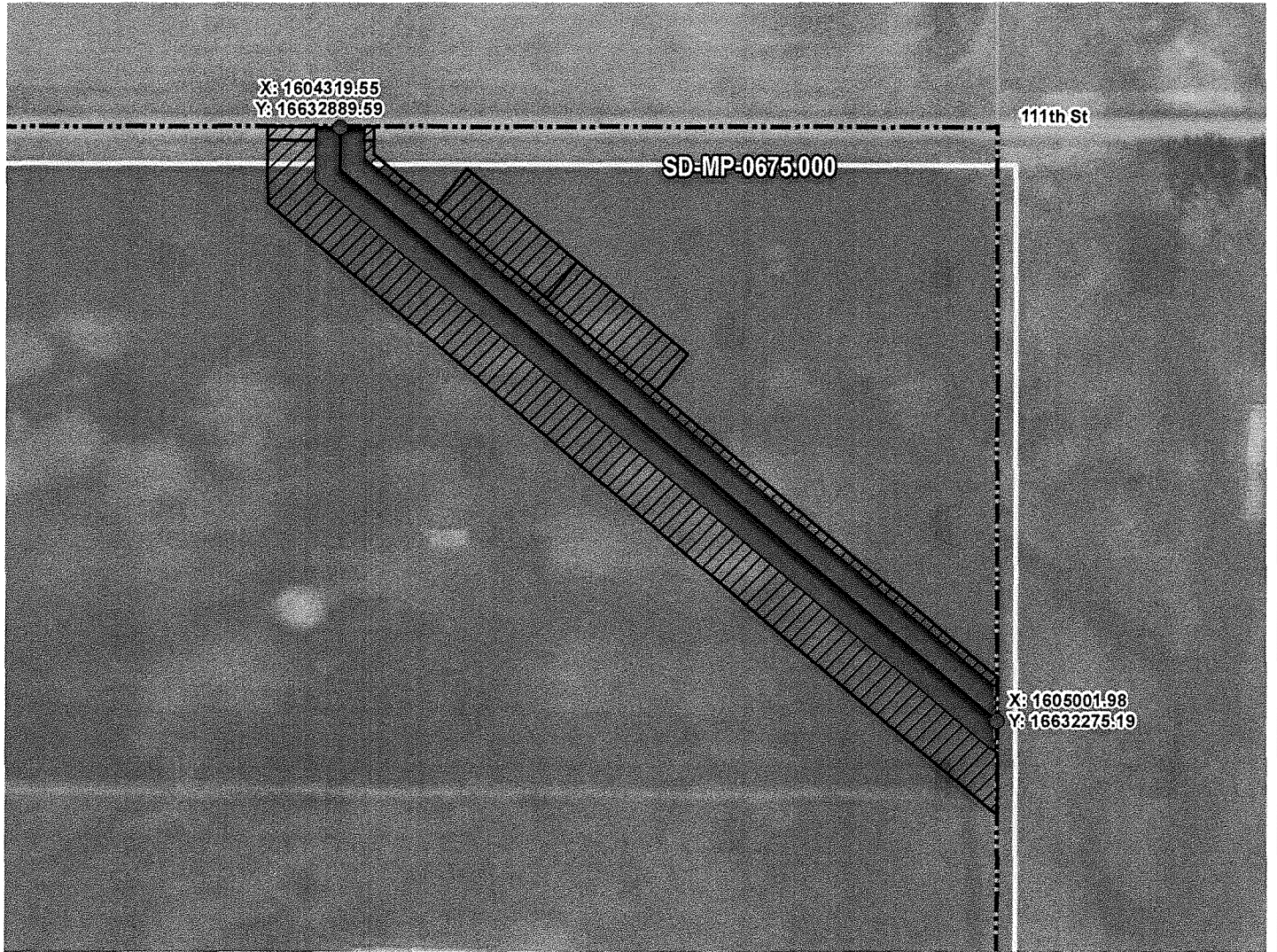

ROUTING LENGTH = 934.351 FT +/-
 IMPACTS: PIPELINE EASEMENT = 1.072 AC. +/- / TEMPORARY CONSTRUCTION EASEMENT = 1.721 AC. +/-

Legend

- PROPOSED ROUTE
- PIPELINE EASEMENT
- PARCEL BOUNDARY
- TEMPORARY CONSTRUCTION EASEMENT
- ADJACENT PROPERTIES
- SECTION BOUNDARY
- COUNTY BOUNDARY

NOTES:

1. THIS IS A PRELIMINARY DOCUMENT AND IS INTENDED TO DEPICT THE APPROXIMATE LOCATION OF A PROPOSED PIPELINE EASEMENT.
2. THIS DOCUMENT DOES NOT REPRESENT A LAND SURVEY AND IS NOT INTENDED TO DEPICT THE FINAL ALIGNMENT
3. COORDINATE SYSTEM: UTM ZONE 14 NORTH, NAD83, US SURVEY FEET

PRELIMINARY PIPELINE ROUTE

DRAWN BY:	AC	SUMMIT CARBON SOLUTIONS MIDWEST CARBON EXPRESS VILHAUER LAND LIMITED PARTNERSHIP TAX ID: 2751 TRACT NUMBER: SD-MP-0675.000
CHECKED BY:	JW	
MAP DATE:	12/17/2021	
SCALE:	1 inch = 169'	
REV NO.	DATE	DESCRIPTION
G	10/13/2022	REVISED WORKSPACE
H	11/4/2022	REVISED WORKSPACE
DRAWING NO. C-MCE-ACQ-SD-MP-0675.000		PROJECT NO. 450959 SHEET NO. 01 of 01



EXHIBIT "B"

PRELIMINARY ROUTE

MCPHERSON COUNTY, SOUTH DAKOTA

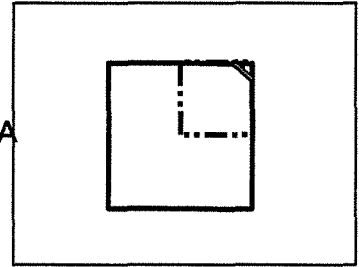

VICINITY MAP
N.T.S.

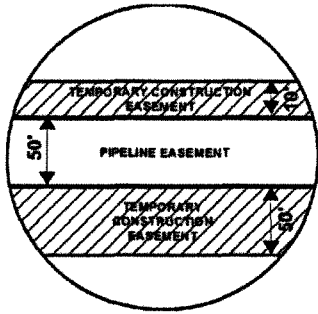

SEC. 34 T127N R69W

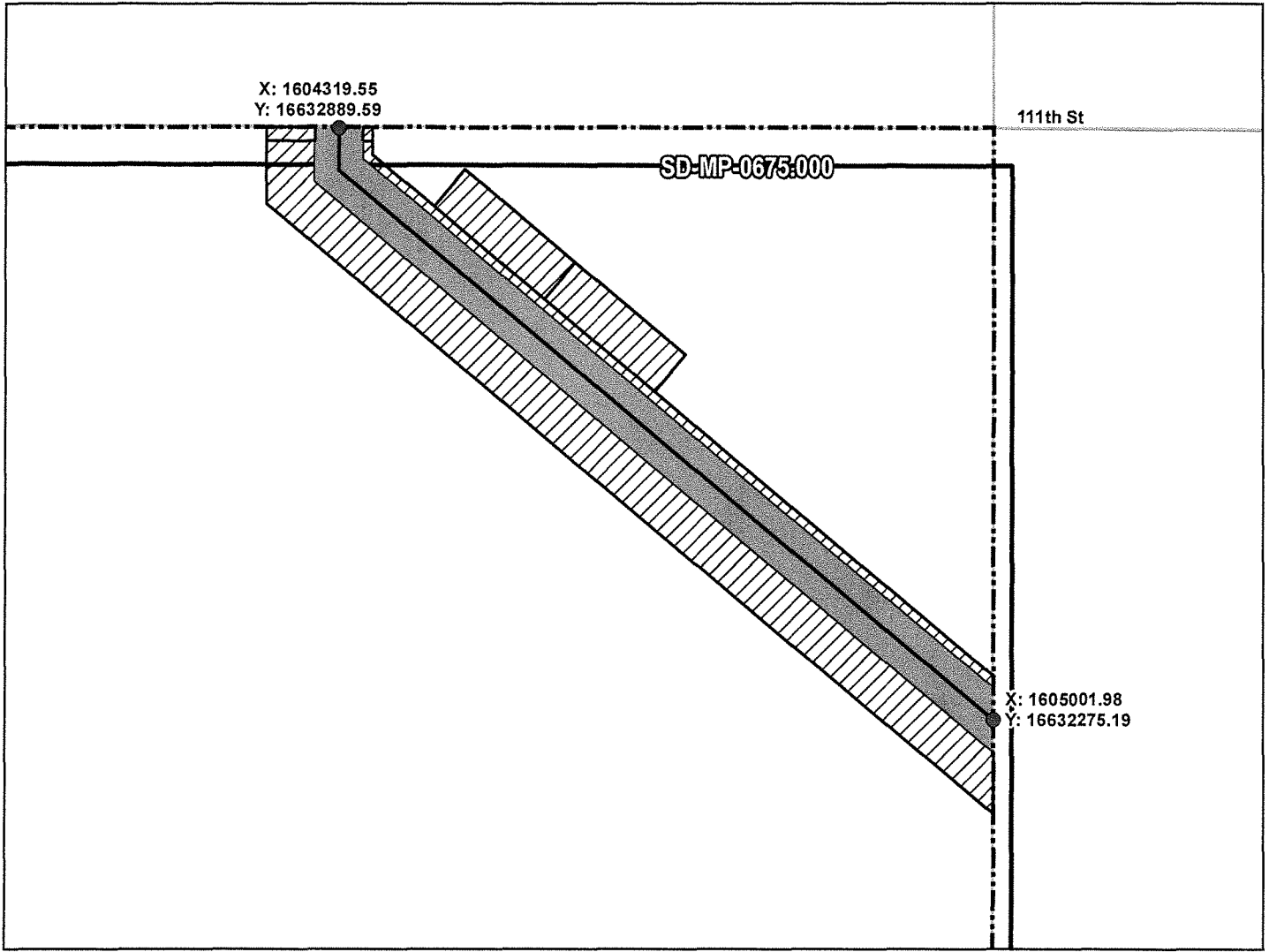

ROUTING LENGTH = 934.351 FT +/-

IMPACTS: PIPELINE EASEMENT = 1.072 AC. +/- / TEMPORARY CONSTRUCTION EASEMENT = 1.721 AC. +/-

Legend

- PROPOSED ROUTE
- ROADS
- PARCEL BOUNDARY
- ADJACENT PROPERTIES
- PIPELINE EASEMENT
- TEMPORARY CONSTRUCTION EASEMENT
- SECTION BOUNDARY
- COUNTY BOUNDARY

NOTES:

1. THIS IS A PRELIMINARY DOCUMENT AND IS INTENDED TO DEPICT THE APPROXIMATE LOCATION OF A PROPOSED PIPELINE EASEMENT.
2. THIS DOCUMENT DOES NOT REPRESENT A LAND SURVEY AND IS NOT INTENDED TO DEPICT THE FINAL ALIGNMENT
3. COORDINATE SYSTEM: UTM ZONE 14 NORTH, NAD83, US SURVEY FEET

SIGNATURE: _____ DATE: _____



PRELIMINARY PIPELINE ROUTE

DRAWN BY:	AC	SUMMIT CARBON SOLUTIONS MIDWEST CARBON EXPRESS VILHAUER LAND LIMITED PARTNERSHIP TAX ID: 2751 TRACT NUMBER: SD-MP-0675.000
CHECKED BY:	JW	
MAP DATE:	12/17/2021	
SCALE:	1 inch = 169'	
REV NO.	DATE	DESCRIPTION
G	10/13/2022	REVISED WORKSPACE
H	11/4/2022	REVISED WORKSPACE
DRAWING NO. BW-MCE-ACQ-SD-MP-0675.000		PROJECT NO. 450959 SHEET NO. 01 of 01

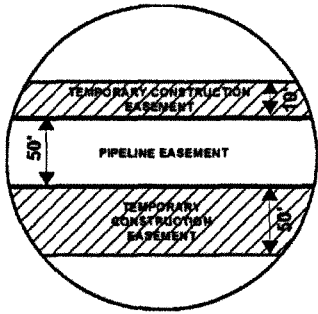
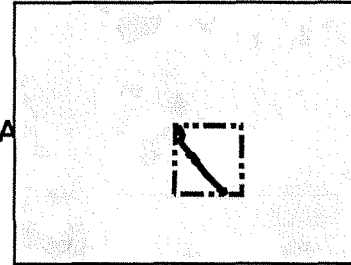

EXHIBIT "B"

PRELIMINARY ROUTE

MCPHERSON COUNTY, SOUTH DAKOTA



VICINITY MAP
N.T.S.

SEC. 27 T127N R69W

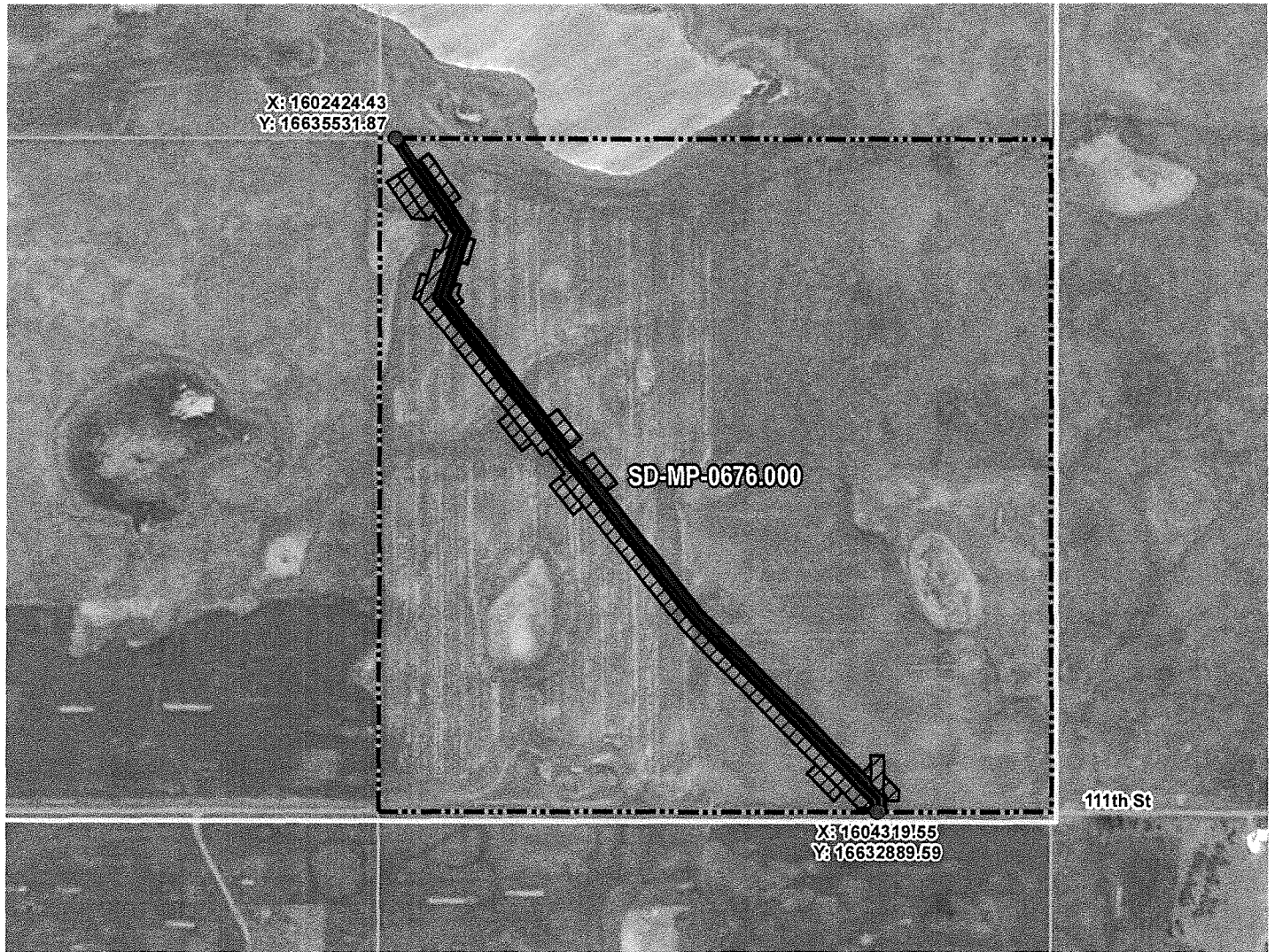

ROUTING LENGTH = 3382.89 FT +/-
 IMPACTS: PIPELINE EASEMENT = 3.883 AC. +/- / TEMPORARY CONSTRUCTION EASEMENT = 5.988 AC. +/-

Legend

- PROPOSED ROUTE
- PARCEL BOUNDARY
- ADJACENT PROPERTIES
- PIPELINE EASEMENT
- TEMPORARY CONSTRUCTION EASEMENT
- SECTION BOUNDARY
- COUNTY BOUNDARY

NOTES:

1. THIS IS A PRELIMINARY DOCUMENT AND IS INTENDED TO DEPICT THE APPROXIMATE LOCATION OF A PROPOSED PIPELINE EASEMENT.
2. THIS DOCUMENT DOES NOT REPRESENT A LAND SURVEY AND IS NOT INTENDED TO DEPICT THE FINAL ALIGNMENT
3. COORDINATE SYSTEM: UTM ZONE 14 NORTH, NAD83, US SURVEY FEET

PRELIMINARY PIPELINE ROUTE

DRAWN BY:	AC	SUMMIT CARBON SOLUTIONS MIDWEST CARBON EXPRESS VILHAUER LAND LIMITED PARTNERSHIP TAX ID: 2705 TRACT NUMBER: SD-MP-0676.000
CHECKED BY:	JW	
MAP DATE:	12/17/2021	
SCALE:	1 inch = 640'	
REV NO.	DATE	DESCRIPTION
J	11/4/2022	REVISED WORKSPACE
K	1/4/2023	REVISED PARCEL BOUNDARY
DRAWING NO. C-MCE-ACQ-SD-MP-0676.000		PROJECT NO. 450959 SHEET NO. 01 of 01



EXHIBIT "B"

PRELIMINARY ROUTE

MCPHERSON COUNTY, SOUTH DAKOTA

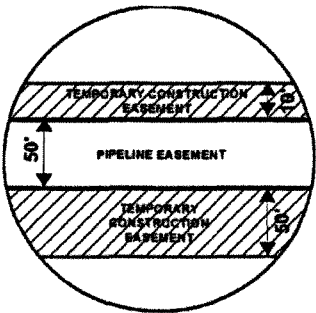
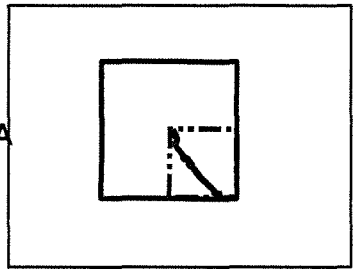

VICINITY MAP
N.T.S.

SEC. 27 T127N R69W

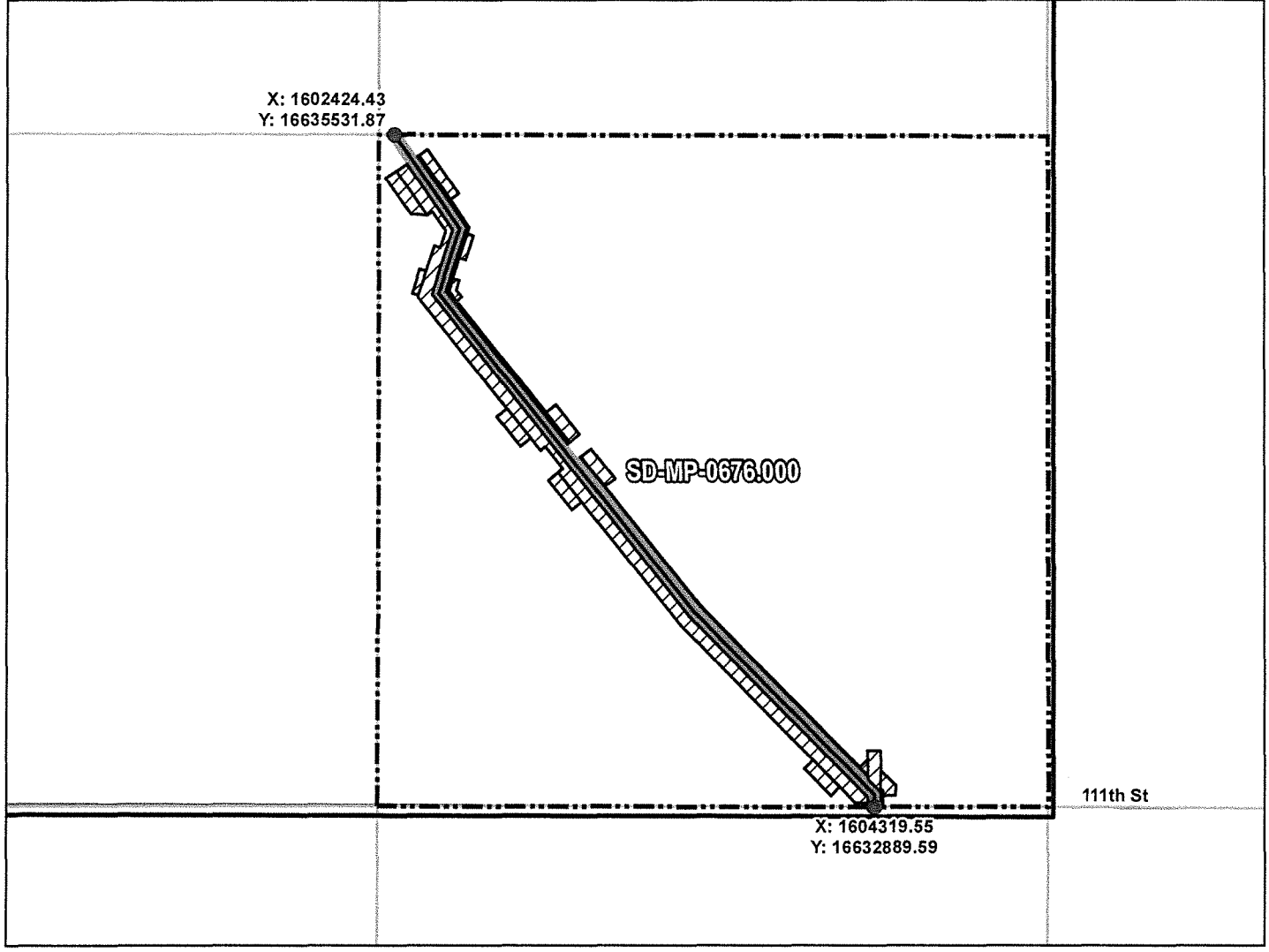

ROUTING LENGTH = 3382.89 FT +/-
 IMPACTS: PIPELINE EASEMENT = 3.883 AC. +/- / TEMPORARY CONSTRUCTION EASEMENT = 5.988 AC. +/-

- Legend**
- PROPOSED ROUTE
 - ROADS
 - PARCEL BOUNDARY
 - ADJACENT PROPERTIES
 - PIPELINE EASEMENT
 - TEMPORARY CONSTRUCTION EASEMENT
 - SECTION BOUNDARY
 - COUNTY BOUNDARY

PRELIMINARY PIPELINE ROUTE		
DRAWN BY:	AC	SUMMIT CARBON SOLUTIONS MIDWEST CARBON EXPRESS VILHAUER LAND LIMITED PARTNERSHIP TAX ID: 2705 TRACT NUMBER: SD-MP-0676.000
CHECKED BY:	JW	
MAP DATE:	12/17/2021	
SCALE:	1 inch = 640'	
REV NO.	DATE	DESCRIPTION
J	11/4/2022	REVISED WORKSPACE
K	1/4/2023	REVISED PARCEL BOUNDARY
DRAWING NO. BW-MCE-ACQ-SD-MP-0676.000		PROJECT NO. 450959 SHEET NO. 01 of 01

NOTES:

1. THIS IS A PRELIMINARY DOCUMENT AND IS INTENDED TO DEPICT THE APPROXIMATE LOCATION OF A PROPOSED PIPELINE EASEMENT.
2. THIS DOCUMENT DOES NOT REPRESENT A LAND SURVEY AND IS NOT INTENDED TO DEPICT THE FINAL ALIGNMENT
3. COORDINATE SYSTEM: UTM ZONE 14 NORTH, NAD83, US SURVEY FEET

SIGNATURE: _____ DATE: _____



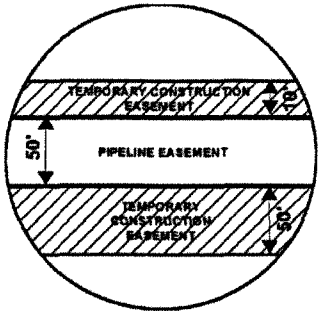
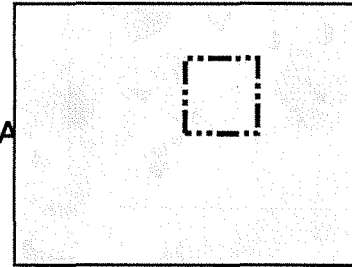

EXHIBIT "B"

PRELIMINARY ROUTE

MCPHERSON COUNTY, SOUTH DAKOTA



VICINITY MAP
N.T.S.

SEC. 27 T127N R69W

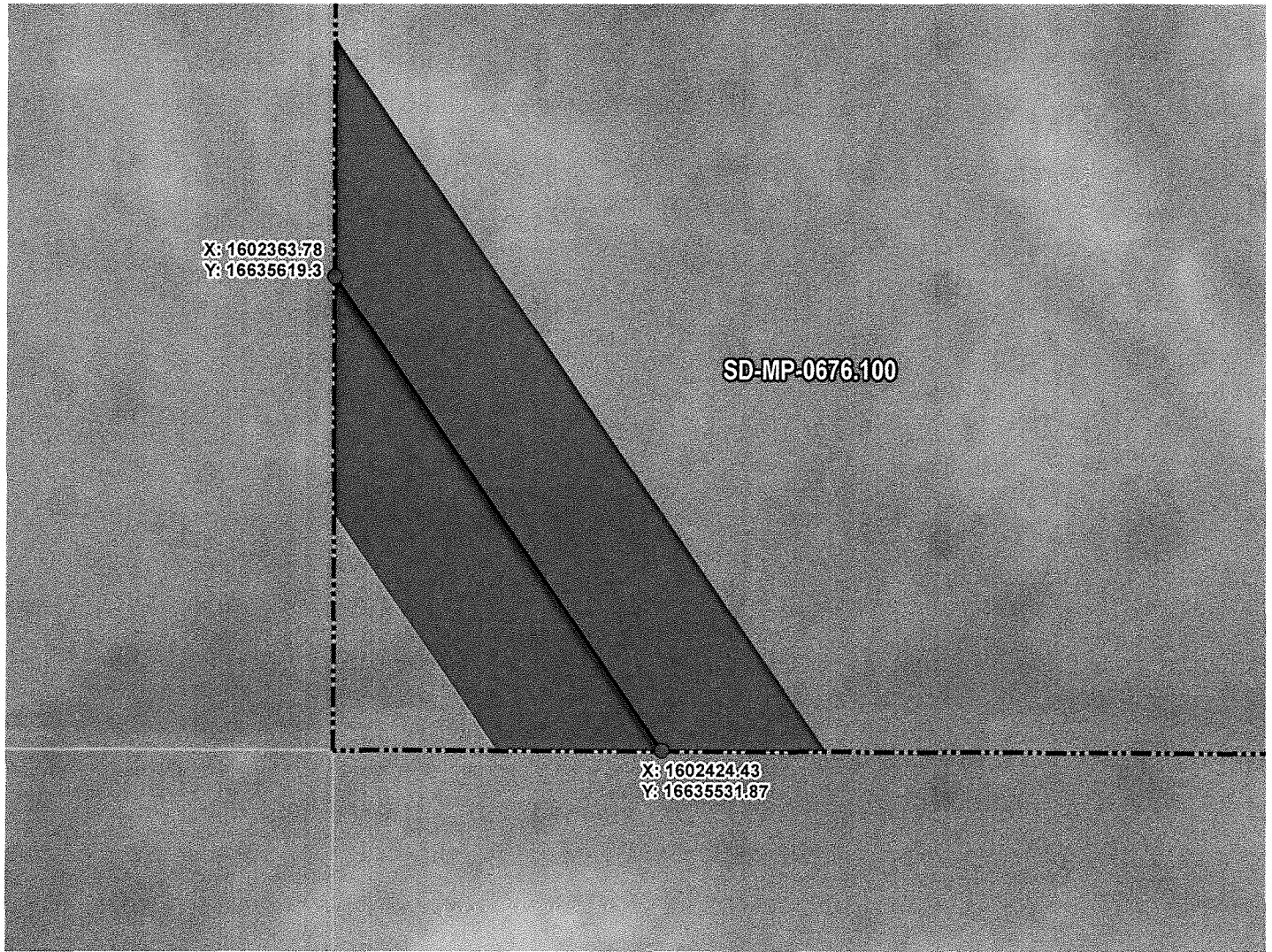

ROUTING LENGTH = 106.402 FT +/-
 IMPACTS: PIPELINE EASEMENT = 0.122 AC. +/- / TEMPORARY CONSTRUCTION EASEMENT = 0 AC. +/-

Legend

- PROPOSED ROUTE
- PARCEL BOUNDARY
- ADJACENT PROPERTIES
- PIPELINE EASEMENT
- TEMPORARY CONSTRUCTION EASEMENT
- SECTION BOUNDARY
- COUNTY BOUNDARY

NOTES:

1. THIS IS A PRELIMINARY DOCUMENT AND IS INTENDED TO DEPICT THE APPROXIMATE LOCATION OF A PROPOSED PIPELINE EASEMENT.
2. THIS DOCUMENT DOES NOT REPRESENT A LAND SURVEY AND IS NOT INTENDED TO DEPICT THE FINAL ALIGNMENT
3. COORDINATE SYSTEM: UTM ZONE 14 NORTH, NAD83, US SURVEY FEET



SUMMIT CARBON SOLUTIONS

PRELIMINARY PIPELINE ROUTE		
DRAWN BY:	AC	SUMMIT CARBON SOLUTIONS MIDWEST CARBON EXPRESS VILHAUER LAND LIMITED PARTNERSHIP TAX ID: 2702 TRACT NUMBER: SD-MP-0676.100
CHECKED BY:	JW	
MAP DATE:	12/17/2021	
SCALE:	1 inch = 30'	
REV NO.	DATE	DESCRIPTION
B	3/8/2022	REVISED WORKSPACE
C	1/4/2023	REVISED PARCEL BOUNDARY
DRAWING NO. C-MCE-ACQ-SD-MP-0676.100		PROJECT NO. 450959 SHEET NO. 01 of 01

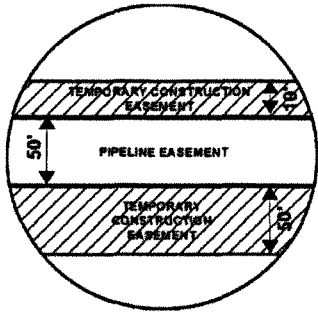
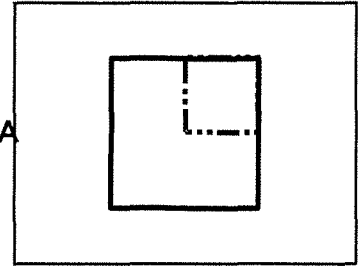

EXHIBIT "B"

PRELIMINARY ROUTE

MCPHERSON COUNTY, SOUTH DAKOTA



VICINITY MAP
N.T.S.

SEC. 27 T127N R69W

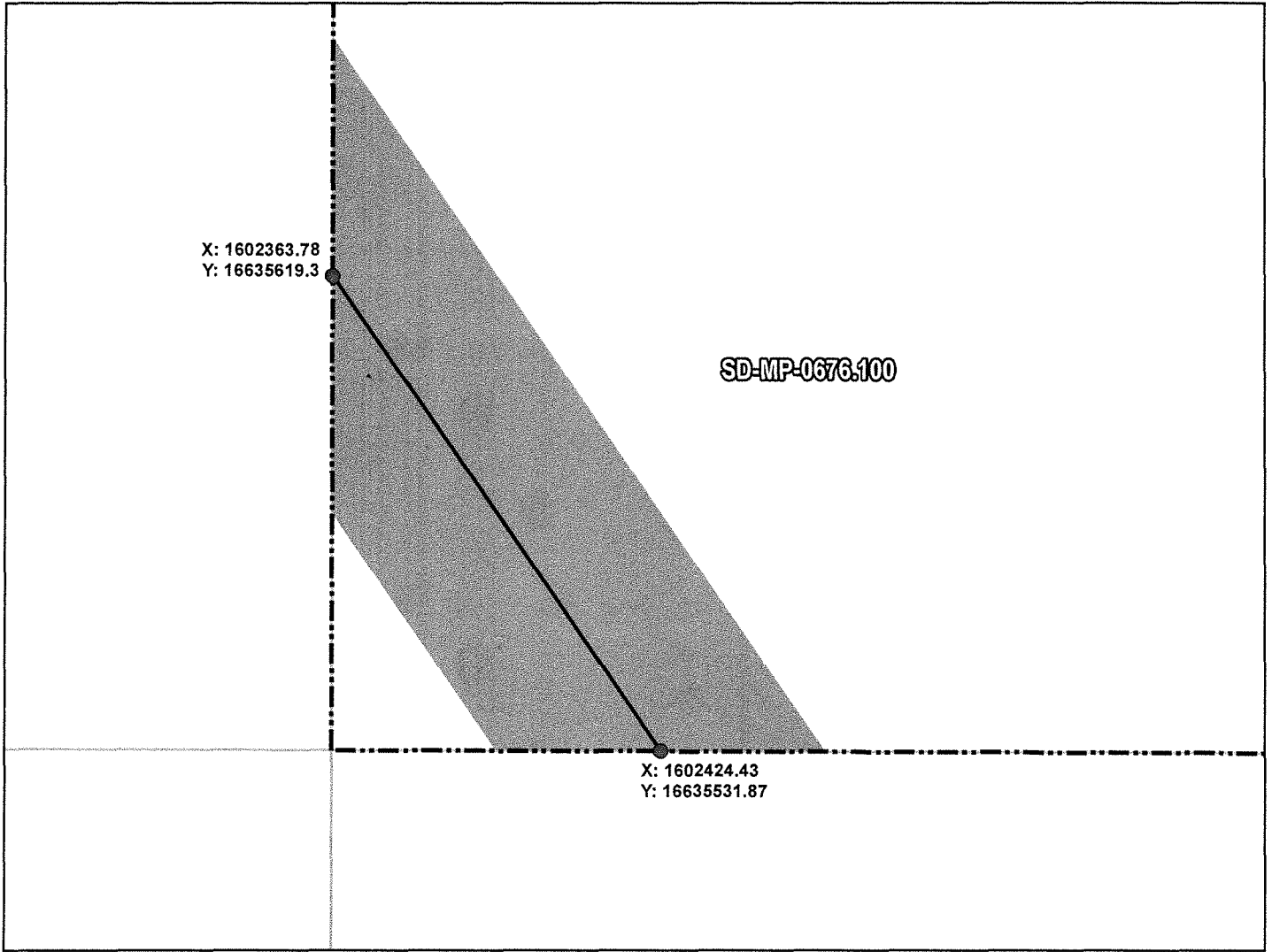

ROUTING LENGTH = 106.402 FT +/-
 IMPACTS: PIPELINE EASEMENT = 0.122 AC. +/- / TEMPORARY CONSTRUCTION EASEMENT = 0 AC. +/-

Legend

- PROPOSED ROUTE
- ROADS
- PARCEL BOUNDARY
- ADJACENT PROPERTIES
- PIPELINE EASEMENT
- TEMPORARY CONSTRUCTION EASEMENT
- SECTION BOUNDARY
- COUNTY BOUNDARY

NOTES:

1. THIS IS A PRELIMINARY DOCUMENT AND IS INTENDED TO DEPICT THE APPROXIMATE LOCATION OF A PROPOSED PIPELINE EASEMENT.
2. THIS DOCUMENT DOES NOT REPRESENT A LAND SURVEY AND IS NOT INTENDED TO DEPICT THE FINAL ALIGNMENT
3. COORDINATE SYSTEM: UTM ZONE 14 NORTH, NAD83, US SURVEY FEET

SIGNATURE: _____ DATE: _____



PRELIMINARY PIPELINE ROUTE

DRAWN BY:	AC	SUMMIT CARBON SOLUTIONS MIDWEST CARBON EXPRESS VILHAUER LAND LIMITED PARTNERSHIP
CHECKED BY:	JW	
MAP DATE:	12/17/2021	
SCALE: 1 inch = 30'		TAX ID: 2702 TRACT NUMBER: SD-MP-0676.100
REV NO.	DATE	DESCRIPTION
B	3/8/2022	REVISED WORKSPACE
C	1/4/2023	REVISED PARCEL BOUNDARY
DRAWING NO. BW-MCE-ACQ-SD-MP-0676.100		PROJECT NO. 450959 SHEET NO. 01 of 01

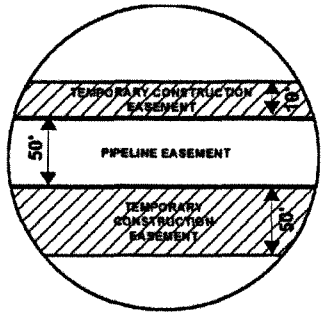
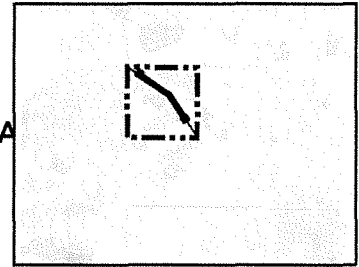

EXHIBIT "B"

PRELIMINARY ROUTE

MCPHERSON COUNTY, SOUTH DAKOTA



VICINITY MAP
N.T.S.

SEC. 27 T127N R69W



ROUTING LENGTH = 3728.517 FT +/- / ACCESS EASEMENT LENGTH = 321.717 FT +/-
 IMPACTS: PIPELINE EASEMENT = 4.272 AC. +/- / TEMPORARY CONSTRUCTION EASEMENT = 4.491 AC. +/-

Legend

- PROPOSED ROUTE
- PIPELINE EASEMENT
- ACCESS EASEMENT
- TEMPORARY CONSTRUCTION EASEMENT
- PARCEL BOUNDARY
- SECTION BOUNDARY
- ADJACENT PROPERTIES
- COUNTY BOUNDARY

NOTES:

1. THIS IS A PRELIMINARY DOCUMENT AND IS INTENDED TO DEPICT THE APPROXIMATE LOCATION OF A PROPOSED PIPELINE EASEMENT.
2. THIS DOCUMENT DOES NOT REPRESENT A LAND SURVEY AND IS NOT INTENDED TO DEPICT THE FINAL ALIGNMENT
3. COORDINATE SYSTEM: UTM ZONE 14 NORTH, NAD83, US SURVEY FEET

PRELIMINARY PIPELINE ROUTE

DRAWN BY:	AC	SUMMIT CARBON SOLUTIONS MIDWEST CARBON EXPRESS VILHAUER LAND LIMITED PARTNERSHIP TAX ID: 2703 TRACT NUMBER: SD-MP-0678.000
CHECKED BY:	JW	
MAP DATE:	12/17/2021	
SCALE:	1 inch = 580'	
REV NO.	DATE	DESCRIPTION
E	8/18/2022	REVISED WORKSPACE
F	1/4/2023	REVISED PARCEL BOUNDARY
DRAWING NO. C-MCE-ACQ-SD-MP-0678.000		PROJECT NO. 450959 SHEET NO. 01 of 01



EXHIBIT "B"

PRELIMINARY ROUTE

MCPHERSON COUNTY, SOUTH DAKOTA

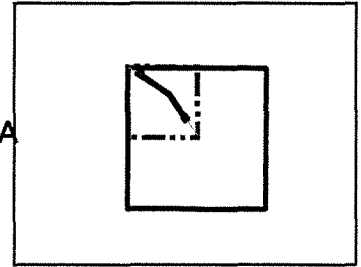

VICINITY MAP
N.T.S.

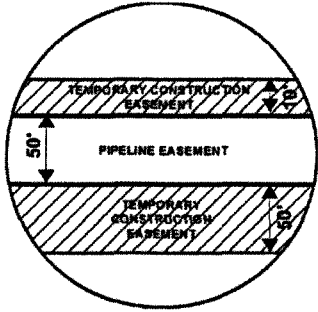

SEC. 27 T127N R69W

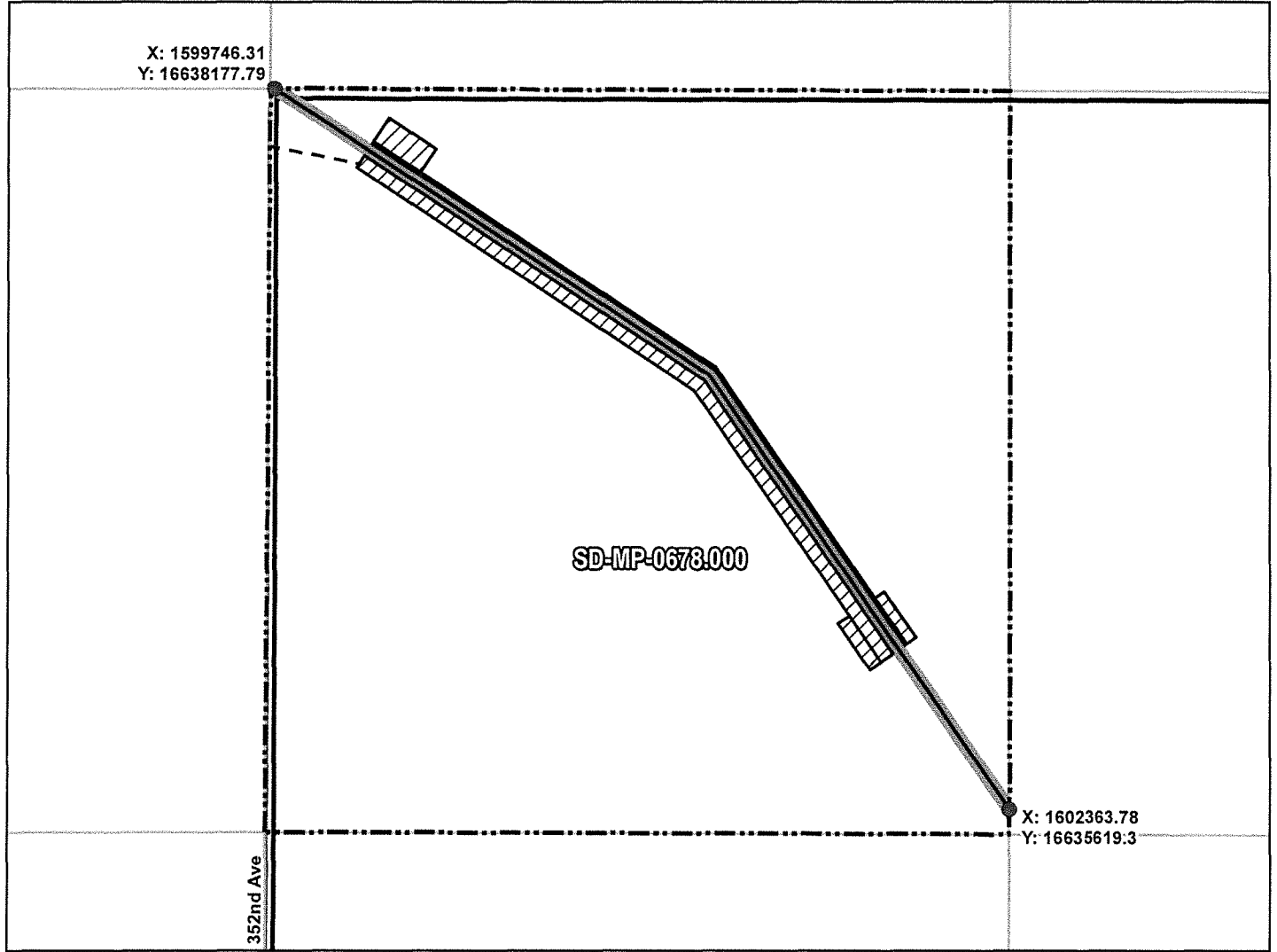

ROUTING LENGTH = 3728.517 FT +/- / ACCESS EASEMENT LENGTH = 321.717 FT +/-
 IMPACTS: PIPELINE EASEMENT = 4.272 AC. +/- / TEMPORARY CONSTRUCTION EASEMENT = 4.491 AC. +/-

Legend

- PROPOSED ROUTE
- - - ACCESS EASEMENT
- ROADS
- ▤ PARCEL BOUNDARY
- ADJACENT PROPERTIES
- ▨ PIPELINE EASEMENT
- ▧ TEMPORARY CONSTRUCTION EASEMENT
- ▭ SECTION BOUNDARY
- ▭ COUNTY BOUNDARY

NOTES:

1. THIS IS A PRELIMINARY DOCUMENT AND IS INTENDED TO DEPICT THE APPROXIMATE LOCATION OF A PROPOSED PIPELINE EASEMENT.
2. THIS DOCUMENT DOES NOT REPRESENT A LAND SURVEY AND IS NOT INTENDED TO DEPICT THE FINAL ALIGNMENT
3. COORDINATE SYSTEM: UTM ZONE 14 NORTH, NAD83, US SURVEY FEET

SIGNATURE: _____ DATE: _____



PRELIMINARY PIPELINE ROUTE

DRAWN BY:	AC	SUMMIT CARBON SOLUTIONS MIDWEST CARBON EXPRESS VILHAUER LAND LIMITED PARTNERSHIP
CHECKED BY:	JW	
MAP DATE:	12/17/2021	
SCALE: 1 inch = 580'		TAX ID: 2703 TRACT NUMBER: SD-MP-0678.000
REV NO.	DATE	DESCRIPTION
E	8/18/2022	REVISED WORKSPACE
F	1/4/2023	REVISED PARCEL BOUNDARY
DRAWING NO. BW-MCE-ACQ-SD-MP-0678.000		PROJECT NO. 450959 SHEET NO. 01 of 01

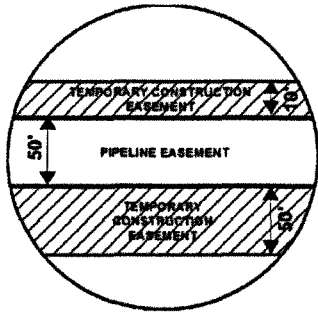
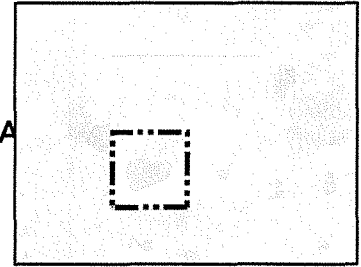

EXHIBIT "B"

PRELIMINARY ROUTE

MCPHERSON COUNTY, SOUTH DAKOTA



VICINITY MAP
N.T.S.

SEC. 22 T127N R69W

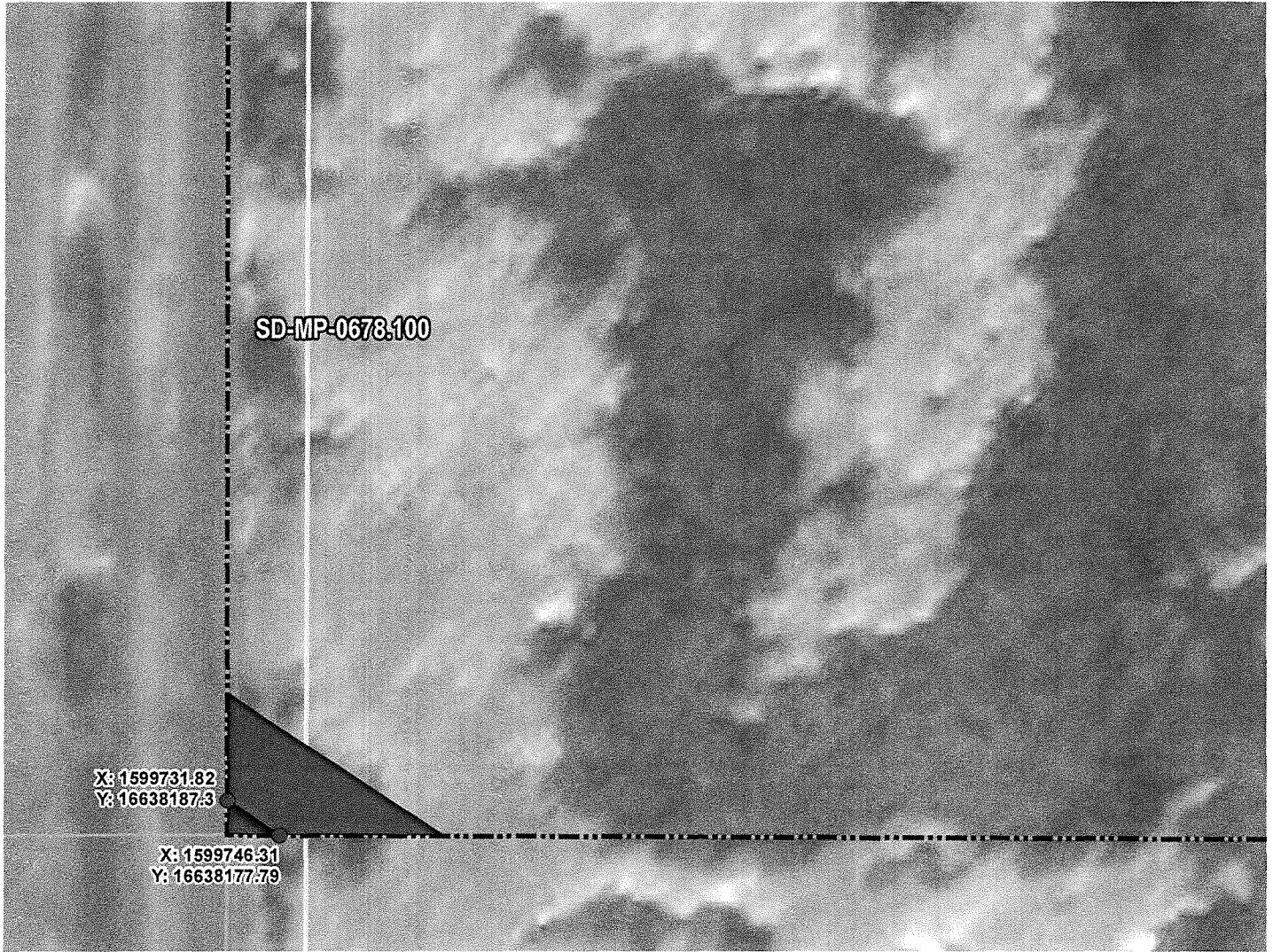

ROUTING LENGTH = 17.32 FT +/-
 IMPACTS: PIPELINE EASEMENT = 0.027 AC. +/- / TEMPORARY CONSTRUCTION EASEMENT = 0 AC. +/-

PROPOSED ROUTE	PIPELINE EASEMENT
PARCEL BOUNDARY	TEMPORARY CONSTRUCTION EASEMENT
ADJACENT PROPERTIES	SECTION BOUNDARY
	COUNTY BOUNDARY

NOTES:

1. THIS IS A PRELIMINARY DOCUMENT AND IS INTENDED TO DEPICT THE APPROXIMATE LOCATION OF A PROPOSED PIPELINE EASEMENT.
2. THIS DOCUMENT DOES NOT REPRESENT A LAND SURVEY AND IS NOT INTENDED TO DEPICT THE FINAL ALIGNMENT
3. COORDINATE SYSTEM: UTM ZONE 14 NORTH, NAD83, US SURVEY FEET

PRELIMINARY PIPELINE ROUTE

DRAWN BY:	AC	SUMMIT CARBON SOLUTIONS MIDWEST CARBON EXPRESS VILHAUER LAND LIMITED PARTNERSHIP TAX ID: 2673 TRACT NUMBER: SD-MP-0678.100
CHECKED BY:	JW	
MAP DATE:	1/11/2022	
SCALE:	1 inch = 45'	
REV NO.	DATE	DESCRIPTION
B	4/14/2022	REVISED WORKSPACE
C	1/4/2023	REVISED PARCEL BOUNDARY
DRAWING NO. C-MCE-ACQ-SD-MP-0678.100		PROJECT NO. 450959 SHEET NO. 01 of 01



EXHIBIT "B"

PRELIMINARY ROUTE

MCPHERSON COUNTY, SOUTH DAKOTA

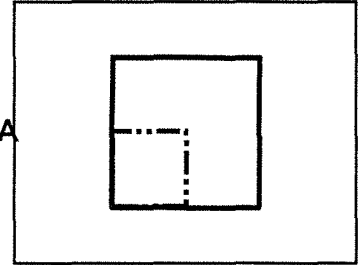
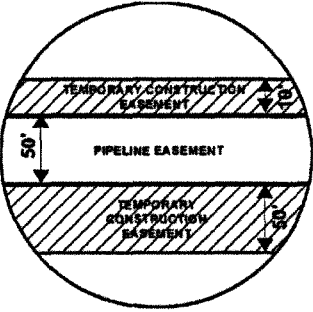

VICINITY MAP
N.T.S.

SEC. 22 T127N R69W

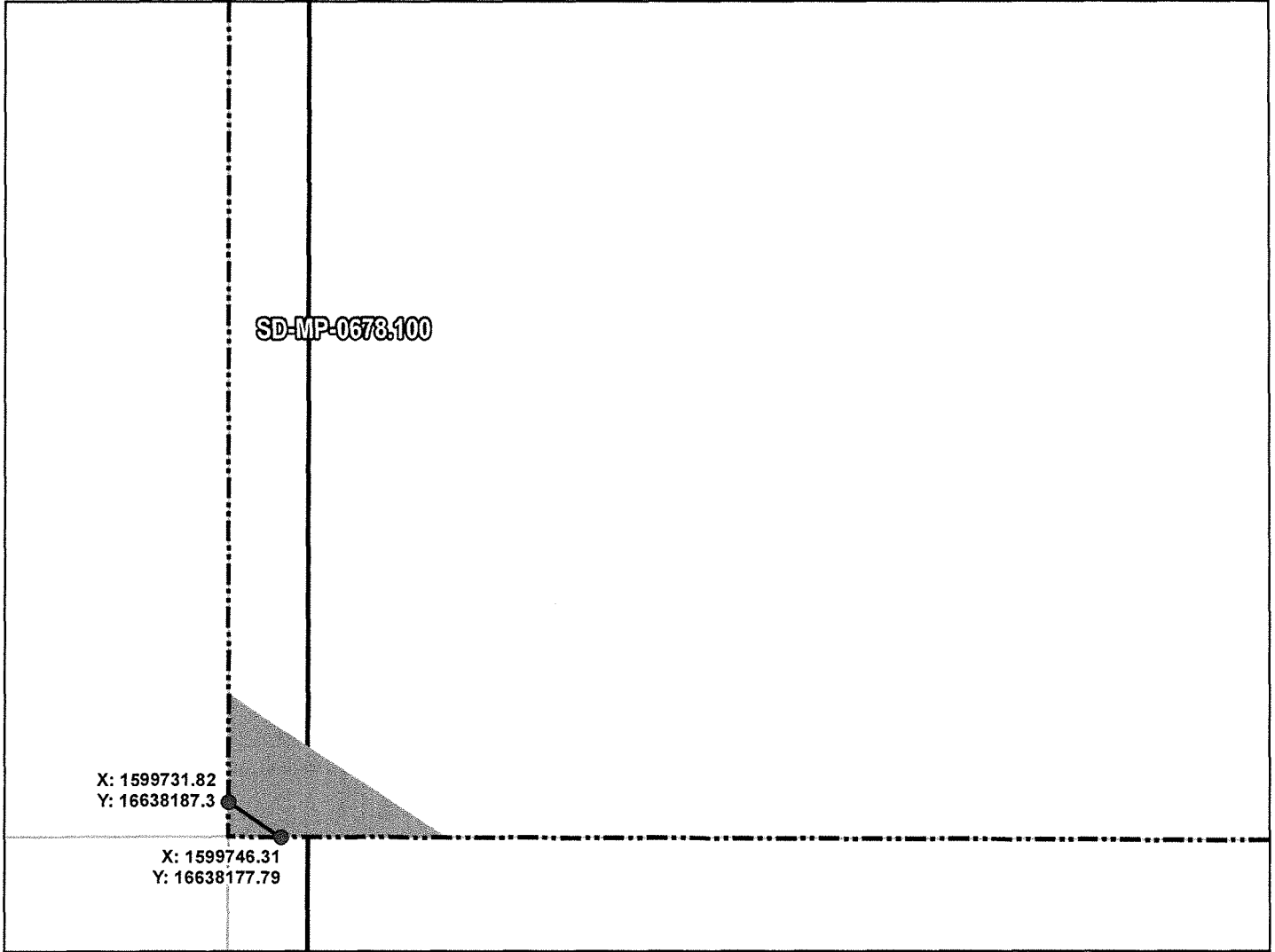

ROUTING LENGTH = 17.32 FT +/-
 IMPACTS: PIPELINE EASEMENT = 0.027 AC. +/- / TEMPORARY CONSTRUCTION EASEMENT = 0 AC. +/-

Legend

- PROPOSED ROUTE
- ROADS
- PARCEL BOUNDARY
- ADJACENT PROPERTIES
- PIPELINE EASEMENT
- TEMPORARY CONSTRUCTION EASEMENT
- SECTION BOUNDARY
- COUNTY BOUNDARY

NOTES:

1. THIS IS A PRELIMINARY DOCUMENT AND IS INTENDED TO DEPICT THE APPROXIMATE LOCATION OF A PROPOSED PIPELINE EASEMENT.
2. THIS DOCUMENT DOES NOT REPRESENT A LAND SURVEY AND IS NOT INTENDED TO DEPICT THE FINAL ALIGNMENT
3. COORDINATE SYSTEM: UTM ZONE 14 NORTH, NAD83, US SURVEY FEET

SIGNATURE: _____ DATE: _____



PRELIMINARY PIPELINE ROUTE

DRAWN BY:	AC	SUMMIT CARBON SOLUTIONS MIDWEST CARBON EXPRESS VILHAUER LAND LIMITED PARTNERSHIP TAX ID: 2673 TRACT NUMBER: SD-MP-0678.100
CHECKED BY:	JW	
MAP DATE:	1/11/2022	
SCALE:	1 inch = 45'	
REV NO.	DATE	DESCRIPTION
B	4/14/2022	REVISED WORKSPACE
C	1/4/2023	REVISED PARCEL BOUNDARY
DRAWING NO. BW-MCE-ACQ-SD-MP-0678.100		PROJECT NO. 450959 SHEET NO. 01 of 01

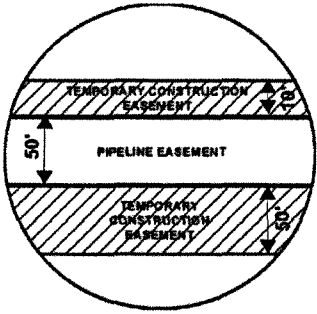
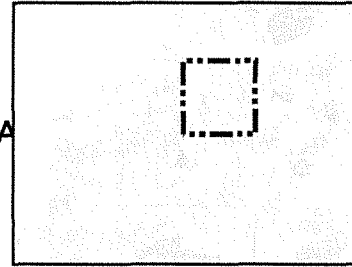

EXHIBIT "B"

PRELIMINARY ROUTE

MCPHERSON COUNTY, SOUTH DAKOTA



VICINITY MAP
N.T.S.

SEC. 28 T127N R69W

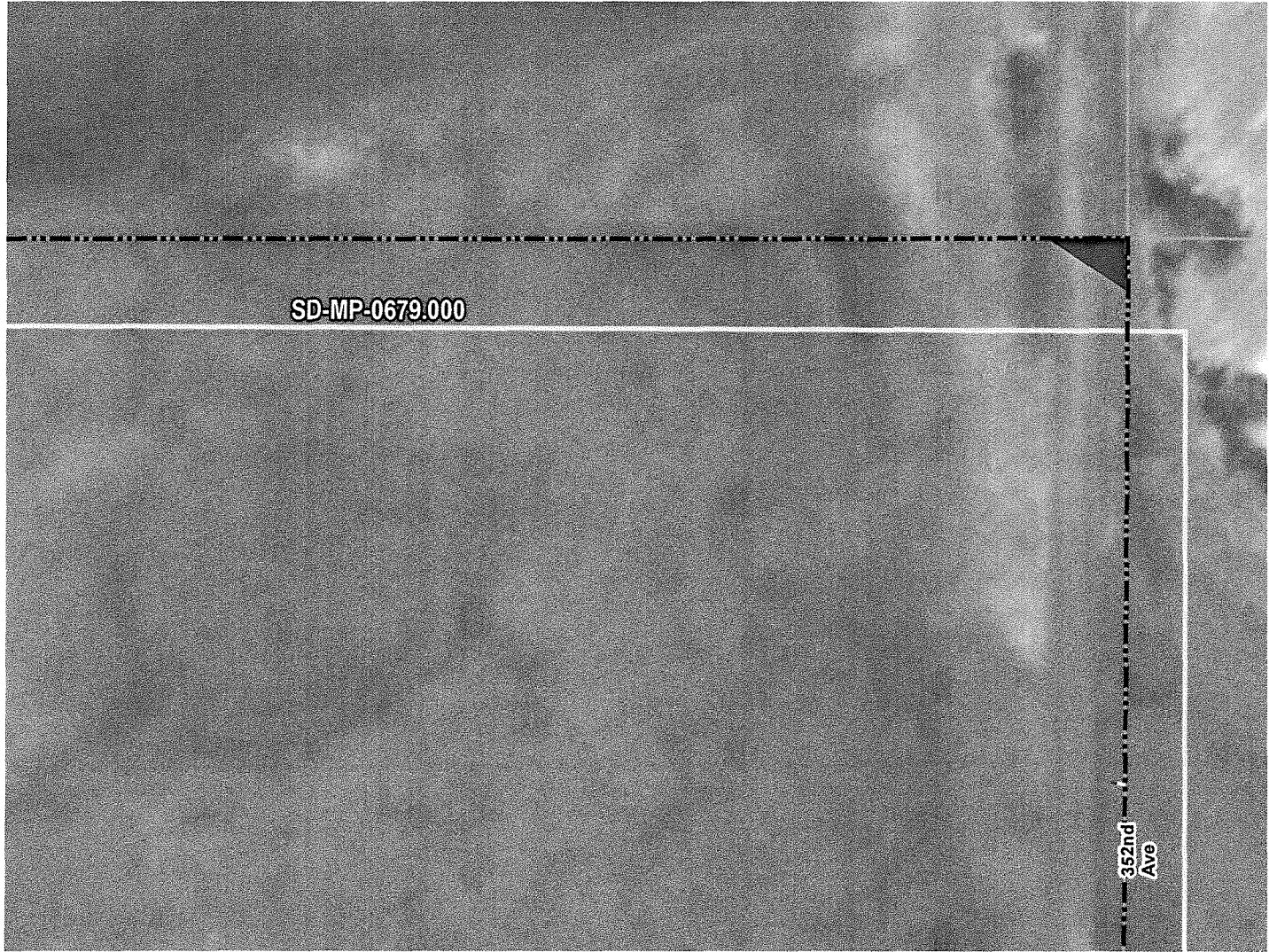

ROUTING LENGTH = 0 FT +/- / ACCESS EASEMENT LENGTH = 5.611 FT +/-
 IMPACTS: PIPELINE EASEMENT = 0.007 AC. +/- / TEMPORARY CONSTRUCTION EASEMENT = 0 AC. +/-

Legend

- PROPOSED ROUTE
- ACCESS EASEMENT
- PARCEL BOUNDARY
- ADJACENT PROPERTIES
- PIPELINE EASEMENT
- TEMPORARY CONSTRUCTION EASEMENT
- SECTION BOUNDARY
- COUNTY BOUNDARY

NOTES:

1. THIS IS A PRELIMINARY DOCUMENT AND IS INTENDED TO DEPICT THE APPROXIMATE LOCATION OF A PROPOSED PIPELINE EASEMENT.
2. THIS DOCUMENT DOES NOT REPRESENT A LAND SURVEY AND IS NOT INTENDED TO DEPICT THE FINAL ALIGNMENT
3. COORDINATE SYSTEM: UTM ZONE 14 NORTH, NAD83, US SURVEY FEET

PRELIMINARY PIPELINE ROUTE

DRAWN BY:	AC	SUMMIT CARBON SOLUTIONS MIDWEST CARBON EXPRESS VILHAUER LAND LIMITED PARTNERSHIP TAX ID: 2708 TRACT NUMBER: SD-MP-0679.000
CHECKED BY:	JW	
MAP DATE:	12/17/2021	
SCALE:	1 inch = 62'	
REV NO.	DATE	DESCRIPTION
C	4/14/2022	REVISED WORKSPACE
D	1/4/2023	REVISED PARCEL BOUNDARY
DRAWING NO. C-MCE-ACQ-SD-MP-0679.000		PROJECT NO. 450959 SHEET NO. 01 of 01



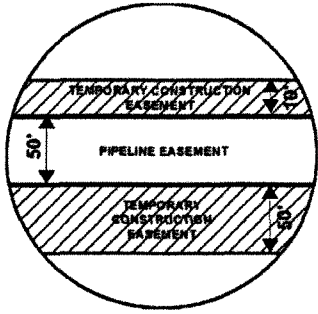
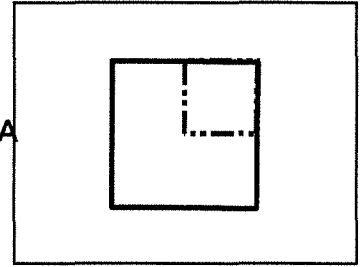

EXHIBIT "B"

PRELIMINARY ROUTE

MCPHERSON COUNTY, SOUTH DAKOTA



VICINITY MAP
N.T.S.

SEC. 28 T127N R69W

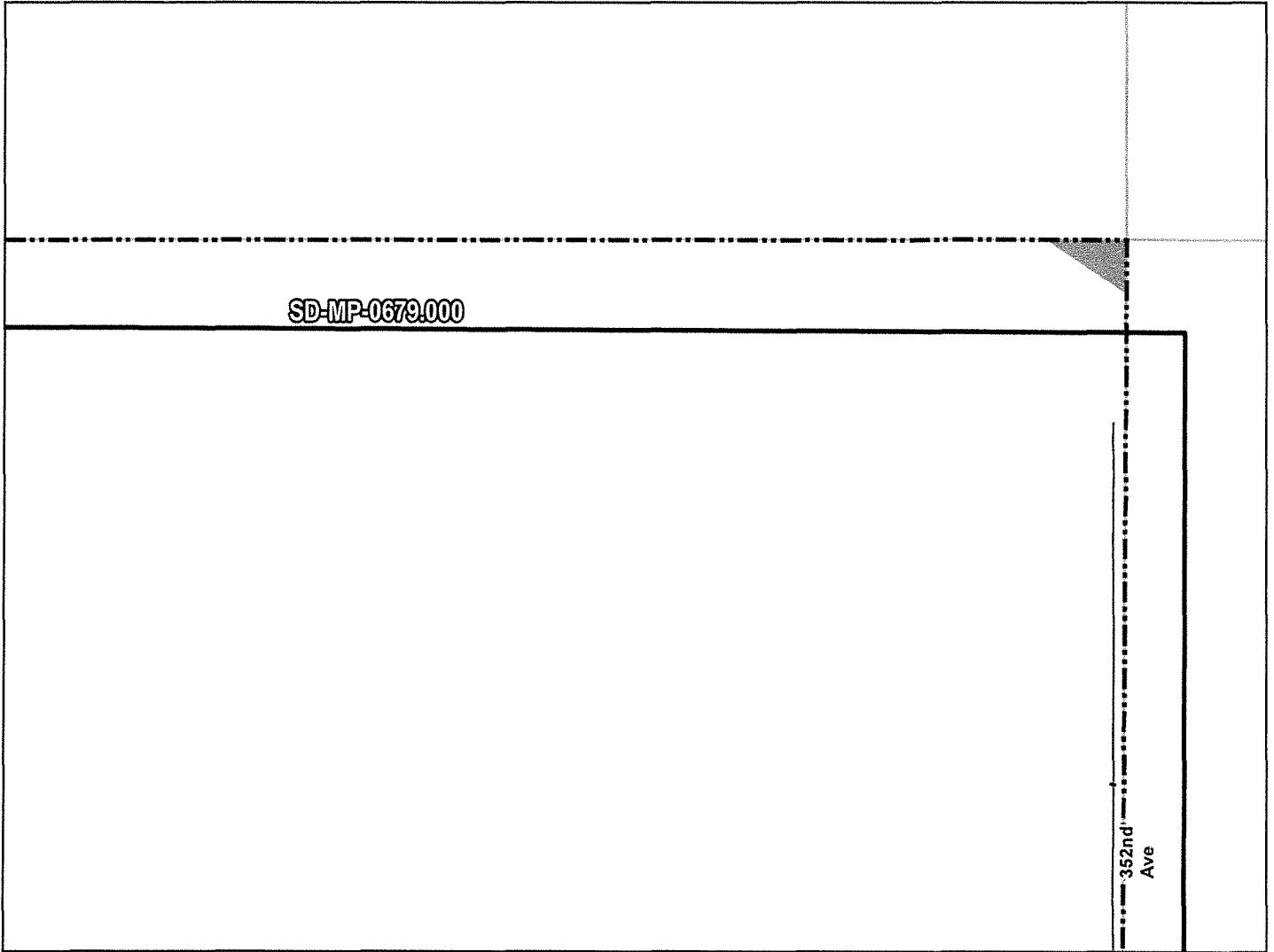

ROUTING LENGTH = 0 FT +/- / ACCESS EASEMENT LENGTH = 5.611 FT +/-
 IMPACTS: PIPELINE EASEMENT = 0.007 AC. +/- / TEMPORARY CONSTRUCTION EASEMENT = 0 AC. +/-

Legend

- PROPOSED ROUTE
- ACCESS EASEMENT
- ROADS
- PARCEL BOUNDARY
- ADJACENT PROPERTIES
- PIPELINE EASEMENT
- TEMPORARY CONSTRUCTION EASEMENT
- SECTION BOUNDARY
- COUNTY BOUNDARY

NOTES:

1. THIS IS A PRELIMINARY DOCUMENT AND IS INTENDED TO DEPICT THE APPROXIMATE LOCATION OF A PROPOSED PIPELINE EASEMENT.
2. THIS DOCUMENT DOES NOT REPRESENT A LAND SURVEY AND IS NOT INTENDED TO DEPICT THE FINAL ALIGNMENT
3. COORDINATE SYSTEM: UTM ZONE 14 NORTH, NAD83, US SURVEY FEET

SIGNATURE: _____ DATE: _____



SUMMIT CARBON SOLUTIONS

PRELIMINARY PIPELINE ROUTE

DRAWN BY:	AC	SUMMIT CARBON SOLUTIONS MIDWEST CARBON EXPRESS VILHAUER LAND LIMITED PARTNERSHIP
CHECKED BY:	JW	
MAP DATE:	12/17/2021	
SCALE:	1 inch = 62'	TAX ID: 2708 TRACT NUMBER: SD-MP-0679.000
REV NO.	DATE	DESCRIPTION
C	4/14/2022	REVISED WORKSPACE
D	1/4/2023	REVISED PARCEL BOUNDARY
DRAWING NO. BW-MCE-ACQ-SD-MP-0679.000		PROJECT NO. 450959 SHEET NO. 01 of 01

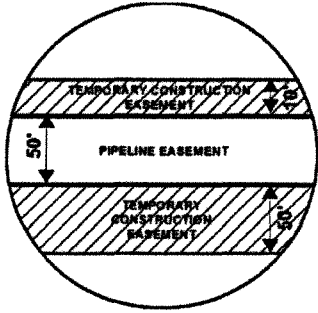
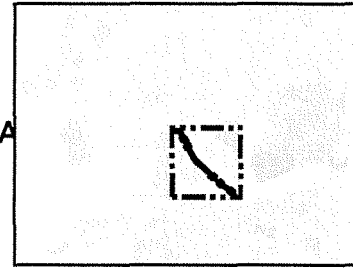

EXHIBIT "B"

PRELIMINARY ROUTE

MCPHERSON COUNTY, SOUTH DAKOTA



VICINITY MAP
N.T.S.

SEC. 21 T127N R69W

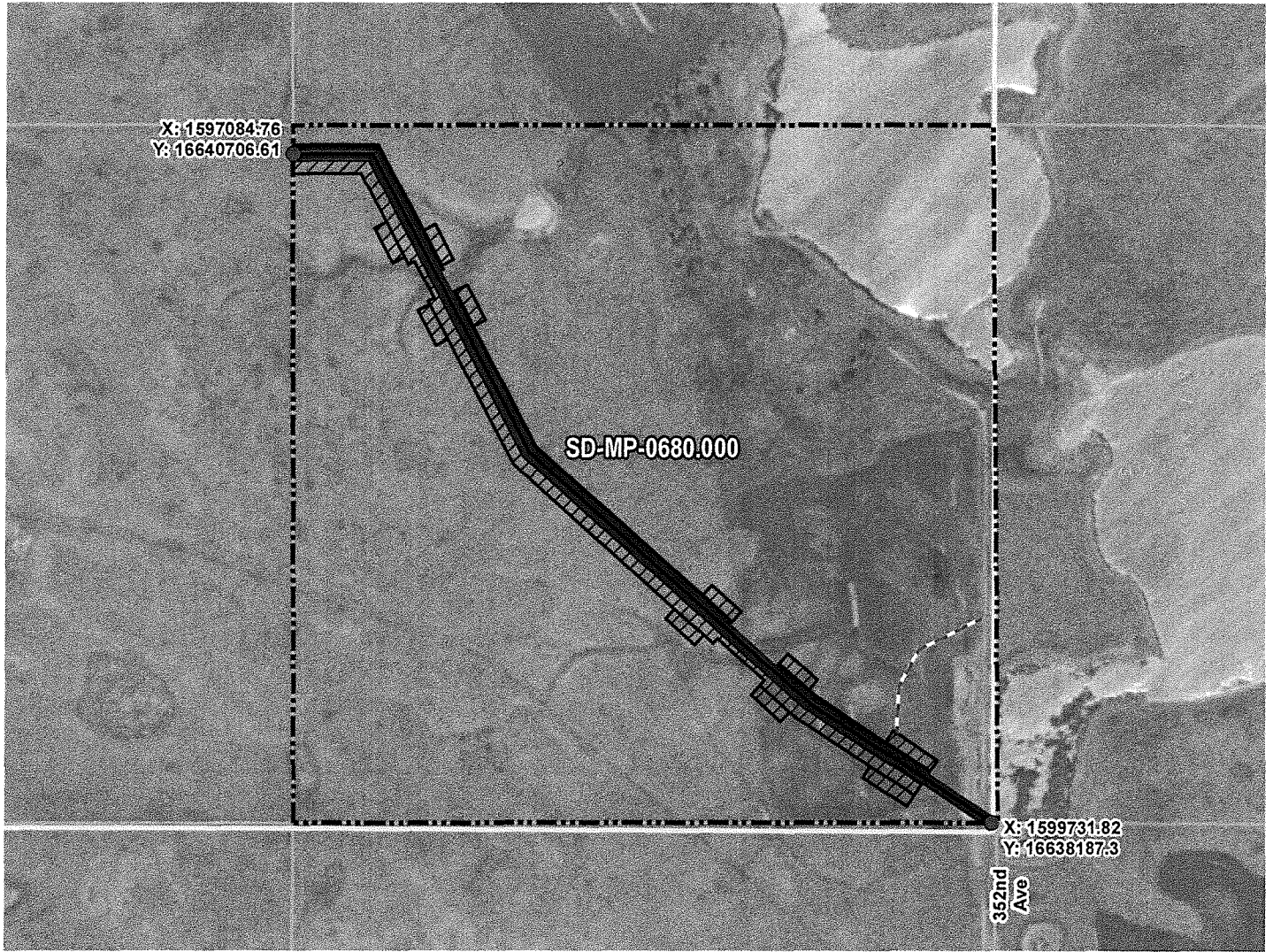

ROUTING LENGTH = 3830.038 FT +/- / ACCESS EASEMENT LENGTH = 602.983 FT +/-
 IMPACTS: PIPELINE EASEMENT = 4.393 AC. +/- / TEMPORARY CONSTRUCTION EASEMENT = 6.36 AC. +/-

Legend

- PROPOSED ROUTE
- ACCESS EASEMENT
- PARCEL BOUNDARY
- ADJACENT PROPERTIES
- PIPELINE EASEMENT
- TEMPORARY CONSTRUCTION EASEMENT
- SECTION BOUNDARY
- COUNTY BOUNDARY

NOTES:

1. THIS IS A PRELIMINARY DOCUMENT AND IS INTENDED TO DEPICT THE APPROXIMATE LOCATION OF A PROPOSED PIPELINE EASEMENT.
2. THIS DOCUMENT DOES NOT REPRESENT A LAND SURVEY AND IS NOT INTENDED TO DEPICT THE FINAL ALIGNMENT
3. COORDINATE SYSTEM: UTM ZONE 14 NORTH, NAD83, US SURVEY FEET

PRELIMINARY PIPELINE ROUTE

DRAWN BY:	AC	SUMMIT CARBON SOLUTIONS MIDWEST CARBON EXPRESS VILHAUER LAND LIMITED PARTNERSHIP TAX ID: 2670 TRACT NUMBER: SD-MP-0680.000
CHECKED BY:	JW	
MAP DATE:	12/17/2021	
SCALE:	1 inch = 617'	
REV NO.	DATE	DESCRIPTION
G	1/4/2023	REVISED PARCEL BOUNDARY
H	2/6/2023	REVISED WORKSPACE
DRAWING NO. C-MCE-ACQ-SD-MP-0680.000		PROJECT NO. 450959 SHEET NO. 01 of 01



EXHIBIT "B"

PRELIMINARY ROUTE

MCPHERSON COUNTY, SOUTH DAKOTA

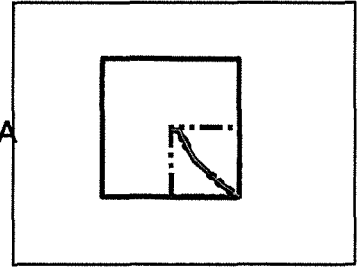
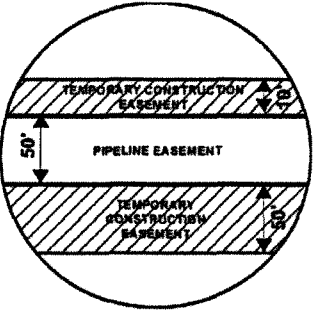

VICINITY MAP
N.T.S.

SEC. 21 T127N R69W

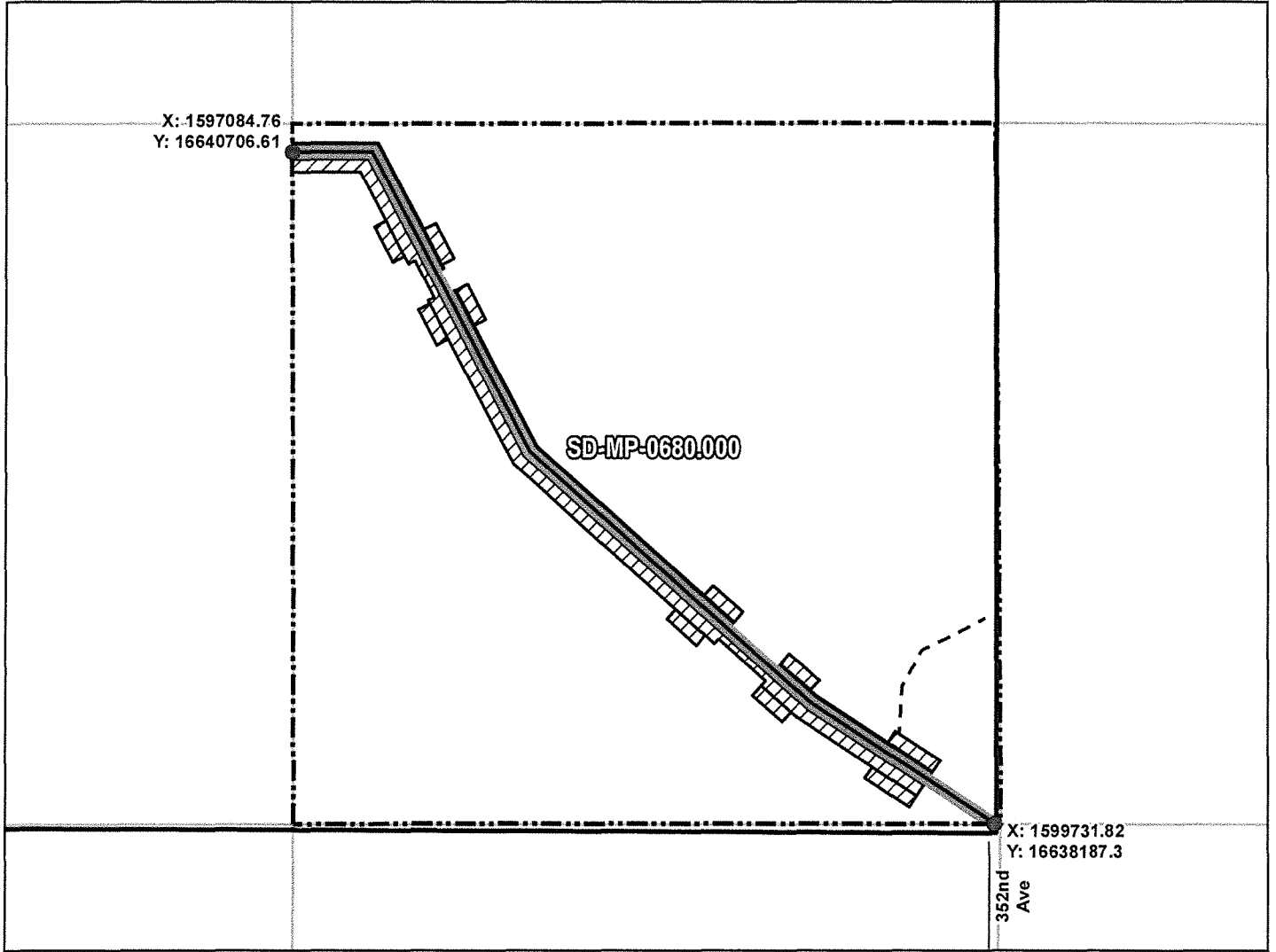

ROUTING LENGTH = 3830.038 FT +/- / ACCESS EASEMENT LENGTH = 602.983 FT +/-
 IMPACTS: PIPELINE EASEMENT = 4.393 AC. +/- / TEMPORARY CONSTRUCTION EASEMENT = 6.36 AC. +/-

Legend

- PROPOSED ROUTE
- ACCESS EASEMENT
- ROADS
- PARCEL BOUNDARY
- ADJACENT PROPERTIES
- PIPELINE EASEMENT
- TEMPORARY CONSTRUCTION EASEMENT
- SECTION BOUNDARY
- COUNTY BOUNDARY

NOTES:

1. THIS IS A PRELIMINARY DOCUMENT AND IS INTENDED TO DEPICT THE APPROXIMATE LOCATION OF A PROPOSED PIPELINE EASEMENT.
2. THIS DOCUMENT DOES NOT REPRESENT A LAND SURVEY AND IS NOT INTENDED TO DEPICT THE FINAL ALIGNMENT
3. COORDINATE SYSTEM: UTM ZONE 14 NORTH, NAD83, US SURVEY FEET

SIGNATURE: _____ DATE: _____



PRELIMINARY PIPELINE ROUTE

DRAWN BY:	AC	SUMMIT CARBON SOLUTIONS MIDWEST CARBON EXPRESS VILHAUER LAND LIMITED PARTNERSHIP TAX ID: 2670 TRACT NUMBER: SD-MP-0680.000
CHECKED BY:	JW	
MAP DATE:	12/17/2021	
SCALE: 1 inch = 616'		
REV NO.	DATE	DESCRIPTION
G	1/4/2023	REVISED PARCEL BOUNDARY
H	2/6/2023	REVISED WORKSPACE
DRAWING NO. BW-MCE-ACQ-SD-MP-0680.000		PROJECT NO. 450959 SHEET NO. 01 of 01

EXHIBIT "B"

PRELIMINARY ROUTE

MCPHERSON COUNTY, SOUTH DAKOTA

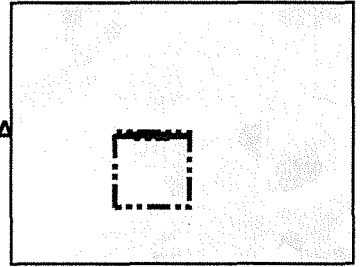
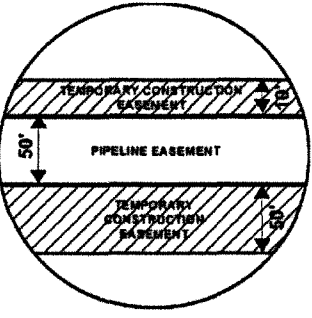

VICINITY MAP
N.T.S.

SEC. 21 T127N R69W



ROUTING LENGTH = 2656.701 FT +/-
 IMPACTS: PIPELINE EASEMENT = 3.049 AC. +/- / TEMPORARY CONSTRUCTION EASEMENT = 4.816 AC. +/-

PROPOSED ROUTE	PIPELINE EASEMENT
PARCEL BOUNDARY	TEMPORARY CONSTRUCTION EASEMENT
ADJACENT PROPERTIES	SECTION BOUNDARY
	COUNTY BOUNDARY

- NOTES:**
1. THIS IS A PRELIMINARY DOCUMENT AND IS INTENDED TO DEPICT THE APPROXIMATE LOCATION OF A PROPOSED PIPELINE EASEMENT.
 2. THIS DOCUMENT DOES NOT REPRESENT A LAND SURVEY AND IS NOT INTENDED TO DEPICT THE FINAL ALIGNMENT
 3. COORDINATE SYSTEM: UTM ZONE 14 NORTH, NAD83, US SURVEY FEET



PRELIMINARY PIPELINE ROUTE		
DRAWN BY:	AC	SUMMIT CARBON SOLUTIONS MIDWEST CARBON EXPRESS VILHAUER LAND LIMITED PARTNERSHIP TAX ID: 2668 TRACT NUMBER: SD-MP-0681.000
CHECKED BY:	JW	
MAP DATE:	12/17/2021	
SCALE:	1 inch = 478'	
REV NO.	DATE	DESCRIPTION
D	7/18/2022	REVISED WORKSPACE
E	1/4/2023	REVISED PARCEL BOUNDARY
DRAWING NO. C-MCE-ACQ-SD-MP-0681.000		PROJECT NO. 450959 SHEET NO. 01 of 01

EXHIBIT "B"

PRELIMINARY ROUTE

MCPHERSON COUNTY, SOUTH DAKOTA

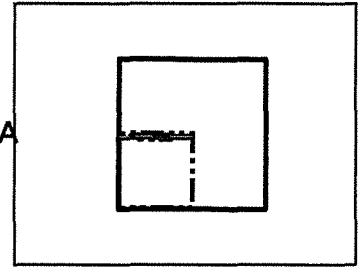

VICINITY MAP
N.T.S.

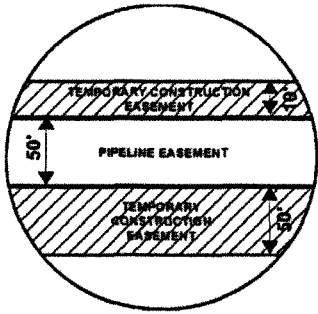

SEC. 21 T127N R69W

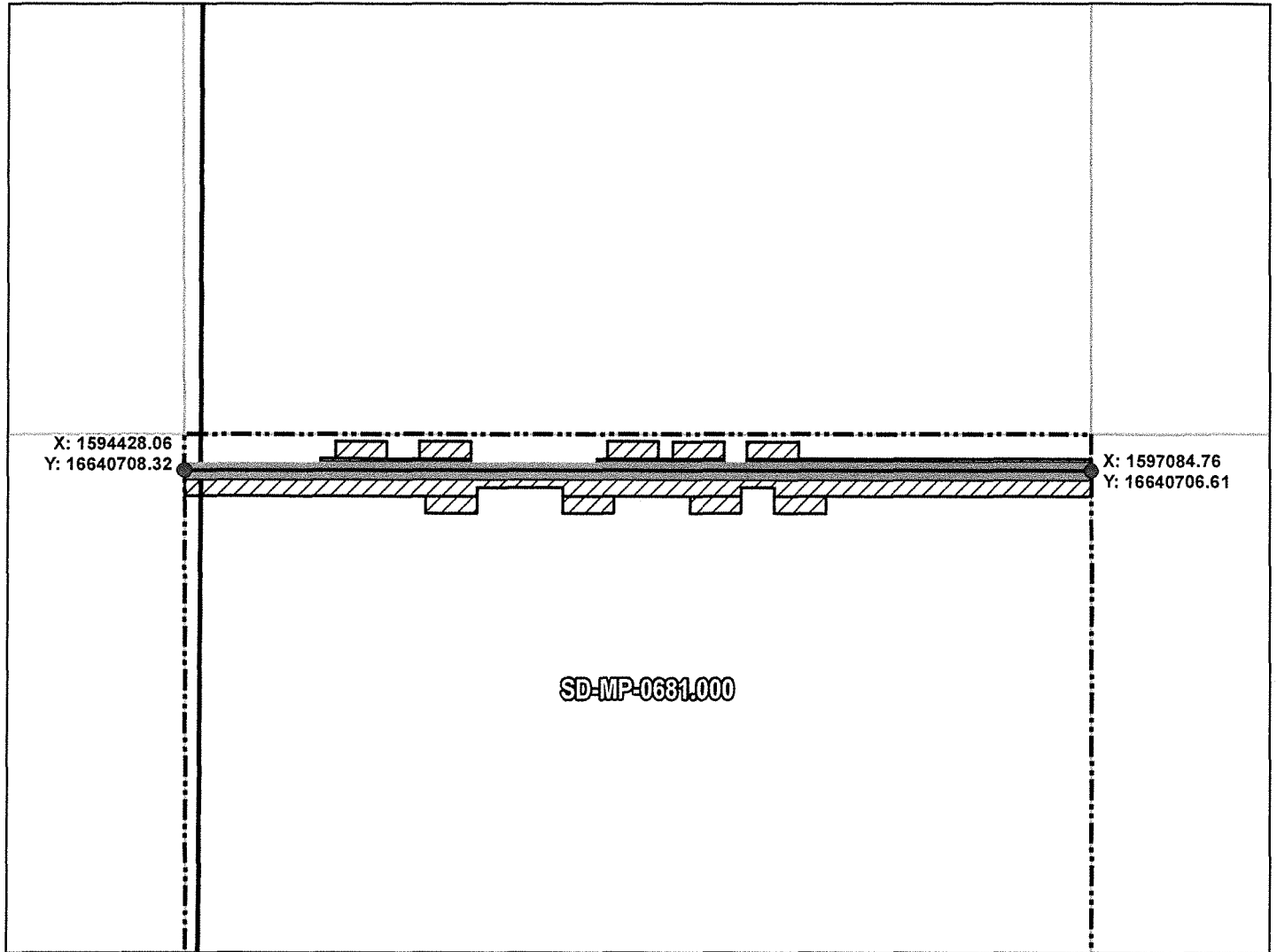

ROUTING LENGTH = 2856.701 FT +/-
 IMPACTS: PIPELINE EASEMENT = 3.049 AC. +/- / TEMPORARY CONSTRUCTION EASEMENT = 4.816 AC. +/-

Legend

- PROPOSED ROUTE
- ROADS
- PARCEL BOUNDARY
- ADJACENT PROPERTIES
- PIPELINE EASEMENT
- TEMPORARY CONSTRUCTION EASEMENT
- SECTION BOUNDARY
- COUNTY BOUNDARY

NOTES:

1. THIS IS A PRELIMINARY DOCUMENT AND IS INTENDED TO DEPICT THE APPROXIMATE LOCATION OF A PROPOSED PIPELINE EASEMENT.
2. THIS DOCUMENT DOES NOT REPRESENT A LAND SURVEY AND IS NOT INTENDED TO DEPICT THE FINAL ALIGNMENT
3. COORDINATE SYSTEM: UTM ZONE 14 NORTH, NAD83, US SURVEY FEET

SIGNATURE: _____ DATE: _____



PRELIMINARY PIPELINE ROUTE

DRAWN BY:	AC	SUMMIT CARBON SOLUTIONS MIDWEST CARBON EXPRESS VILHAUER LAND LIMITED PARTNERSHIP TAX ID: 2668 TRACT NUMBER: SD-MP-0681.000
CHECKED BY:	JW	
MAP DATE:	12/17/2021	
SCALE:	1 inch = 478'	
REV NO.	DATE	DESCRIPTION
D	7/18/2022	REVISED WORKSPACE
E	1/4/2023	REVISED PARCEL BOUNDARY
DRAWING NO. BW-MCE-ACQ-SD-MP-0681.000		PROJECT NO. 450959 SHEET NO. 01 of 01

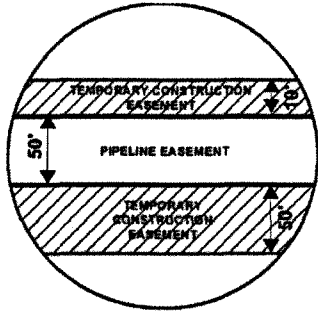
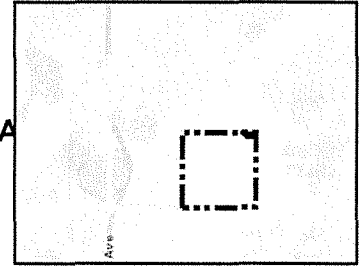

EXHIBIT "B"

PRELIMINARY ROUTE

MCPHERSON COUNTY, SOUTH DAKOTA



VICINITY MAP
N.T.S.

SEC. 20 T127N R69W

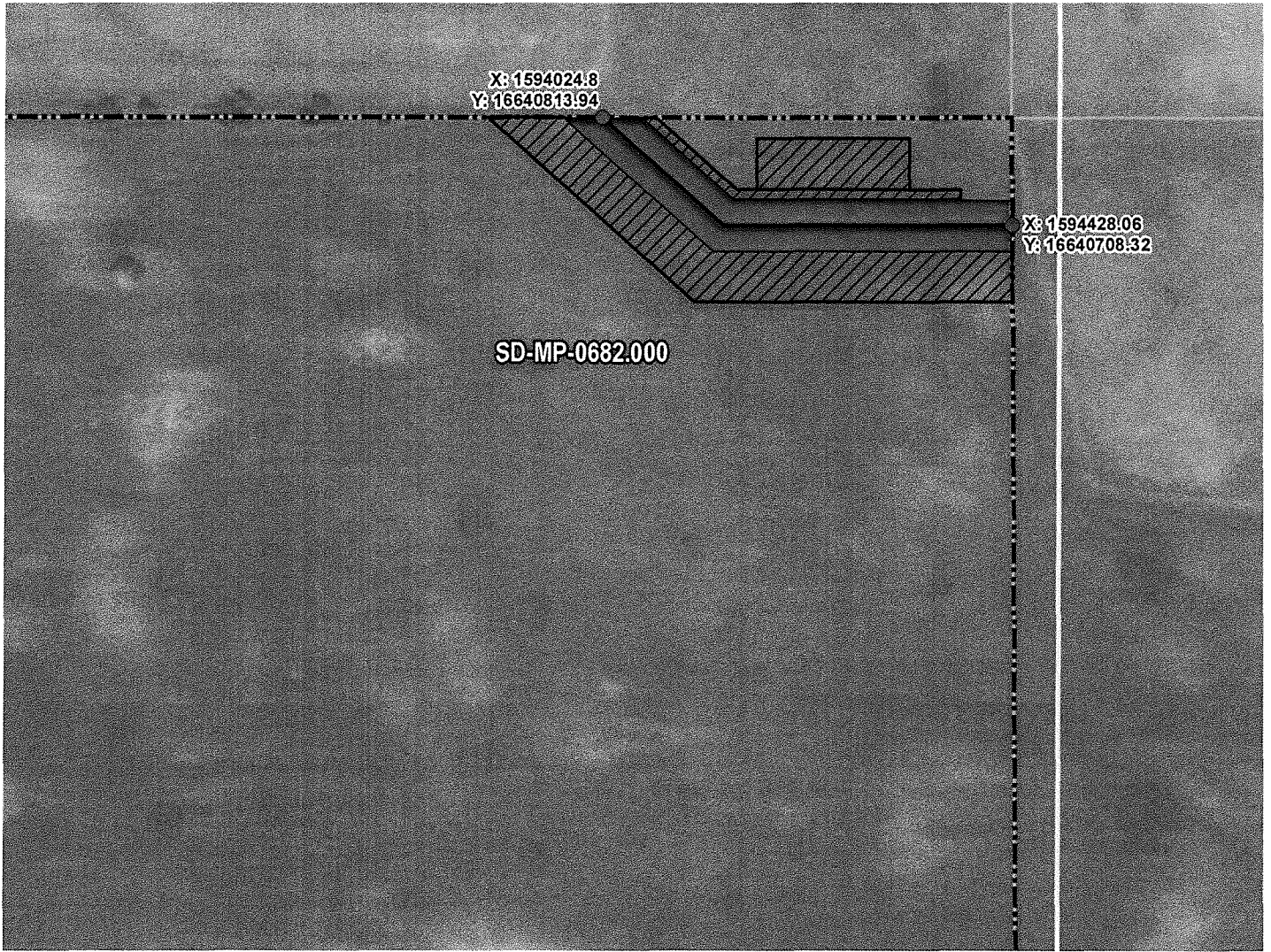

ROUTING LENGTH = 443.196 FT +/-
 IMPACTS: PIPELINE EASEMENT = 0.509 AC. +/- / TEMPORARY CONSTRUCTION EASEMENT = 0.867 AC. +/-

Legend

- PROPOSED ROUTE
- PIPELINE EASEMENT
- PARCEL BOUNDARY
- TEMPORARY CONSTRUCTION EASEMENT
- ADJACENT PROPERTIES
- SECTION BOUNDARY
- COUNTY BOUNDARY

NOTES:

1. THIS IS A PRELIMINARY DOCUMENT AND IS INTENDED TO DEPICT THE APPROXIMATE LOCATION OF A PROPOSED PIPELINE EASEMENT.
2. THIS DOCUMENT DOES NOT REPRESENT A LAND SURVEY AND IS NOT INTENDED TO DEPICT THE FINAL ALIGNMENT
3. COORDINATE SYSTEM: UTM ZONE 14 NORTH, NAD83, US SURVEY FEET

PRELIMINARY PIPELINE ROUTE

DRAWN BY:	AC	SUMMIT CARBON SOLUTIONS MIDWEST CARBON EXPRESS VILHAUER LAND LIMITED PARTNERSHIP TAX ID: 2665 TRACT NUMBER: SD-MP-0682.000
CHECKED BY:	JW	
MAP DATE:	12/17/2021	
SCALE:	1 inch = 160'	
REV NO.	DATE	DESCRIPTION
E	8/18/2022	REVISED WORKSPACE
F	1/4/2023	REVISED PARCEL BOUNDARY
DRAWING NO. C-MCE-ACQ-SD-MP-0682.000		PROJECT NO. 450959 SHEET NO. 01 of 01



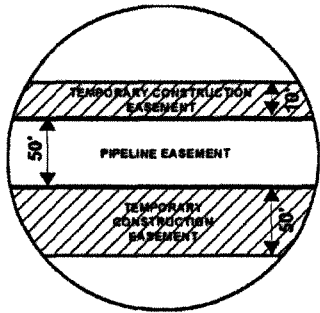
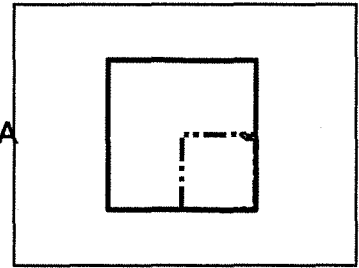

EXHIBIT "B"

PRELIMINARY ROUTE

MCPHERSON COUNTY, SOUTH DAKOTA



VICINITY MAP
N.T.S.

SEC. 20 T127N R69W

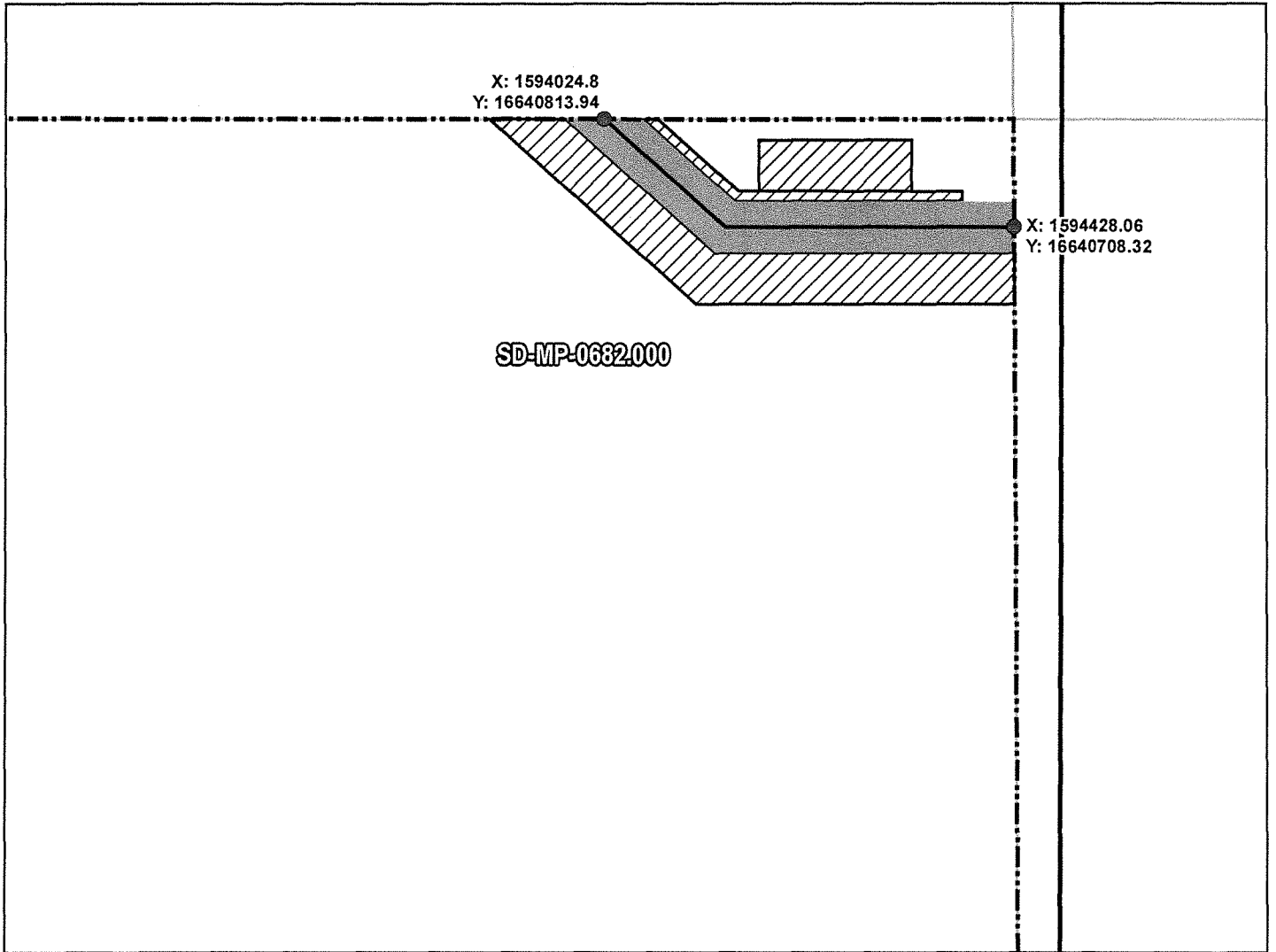

ROUTING LENGTH = 443.196 FT +/-
 IMPACTS: PIPELINE EASEMENT = 0.509 AC. +/- / TEMPORARY CONSTRUCTION EASEMENT = 0.867 AC. +/-

Legend

- PROPOSED ROUTE
- ROADS
- PARCEL BOUNDARY
- ADJACENT PROPERTIES
- PIPELINE EASEMENT
- TEMPORARY CONSTRUCTION EASEMENT
- SECTION BOUNDARY
- COUNTY BOUNDARY

NOTES:

1. THIS IS A PRELIMINARY DOCUMENT AND IS INTENDED TO DEPICT THE APPROXIMATE LOCATION OF A PROPOSED PIPELINE EASEMENT.
2. THIS DOCUMENT DOES NOT REPRESENT A LAND SURVEY AND IS NOT INTENDED TO DEPICT THE FINAL ALIGNMENT
3. COORDINATE SYSTEM: UTM ZONE 14 NORTH, NAD83, US SURVEY FEET

SIGNATURE: _____ DATE: _____



PRELIMINARY PIPELINE ROUTE

DRAWN BY:	AC	SUMMIT CARBON SOLUTIONS MIDWEST CARBON EXPRESS VILHAUER LAND LIMITED PARTNERSHIP TAX ID: 2665 TRACT NUMBER: SD-MP-0682.000
CHECKED BY:	JW	
MAP DATE:	12/17/2021	
SCALE:	1 inch = 160'	
REV NO.	DATE	DESCRIPTION
E	8/18/2022	REVISED WORKSPACE
F	1/4/2023	REVISED PARCEL BOUNDARY
DRAWING NO. BW-MCE-ACQ-SD-MP-0682.000		PROJECT NO. 450959 SHEET NO. 01 of 01