

Attachment No. 1



SUMMIT
CARBON
SOLUTIONS

July 24, 2021

Via 1st Class Mail

Joe H. Schricker & Joann Schricker Living Trust
Edwin P. Fischbach, Joell R. Fischbach
38928 152nd Street
Mellette, SD 57461

RE: CO₂ Capture & Sequestration Pipeline Project

Dear Landowner:

The state of South Dakota has been a national leader in renewable energy, and is committed to the development of affordable, reliable, and sustainable fuels while seeking ways to lower greenhouse gas emissions. Summit Carbon Solutions (Summit) (www.summitcarbonsolutions.com), an agricultural business investment company, has announced a pipeline project to take capture carbon dioxide being emitted by ethanol and biorefiners in South Dakota and elsewhere and permanently sequestering it underground. This is an example of the agriculture community continuously seeking new technologies and solutions to yield a zero-carbon footprint that provides a balance of the environmental stewardship and enhanced crop production.

The proposed pipeline route for the Project is depicted on the enclosed map, and public records indicate that you are the record taxpayer of all or certain portions of such property. Please be advised that Summit and its consultant, TRC Companies Inc., will be performing initial Project activities in the coming weeks and are currently seeking your permission to conduct field evaluation activities on your property, including route analysis, civil, environmental, geotechnical/soil testing, and archeological/cultural resource surveys to assess the viability of the pipeline alignment (Surveys).

Prior to conducting the Surveys, we would like to arrange a meeting with you to address your questions and concerns regarding the Project. Understanding that everyone has a different perspective on in-person meetings amidst the COVID-19 pandemic, we are amenable to your preference to meet either in-person, or through telephone conversations, email, mail, or video conferencing such as Teams, Facetime or Zoom. Should you agree to allow the above-mentioned Surveys on your property prior to our meeting, you may simply send an email confirmation of your intent to infoSD@summitcarbon.com, or you may sign the attached Survey Access form, include your contact information, and take a picture of the form and text it to (605) 553-9255 or email it to infoSD@summitcarbon.com.

Thank you in advance for your support of this Project and Summit's efforts to create sustainable energy solutions for the citizens of South Dakota. If you have any immediate questions or concerns prior to our meeting, you may contact Lee Ferguson toll free at (800) 948-1722 or at the phone number and e-mail address set forth above.

Eric Schovanec

Erik Schovanec, Project Director

Enclosure(s): Project Map, Survey Access Form
Tract # SD-SP-0493.000, SD-SP-0494.000, SD-SP-0506.000

Attachment
#1

State	County	Tract #
South Dakota	Spink	SD-SP-0493.000, SD-SP-0494.000, SD-SP-0506.000



SURVEY ACCESS FORM

The undersigned hereby grants to CO₂ Capture & Sequestration Pipeline Project its agents, contractors, and their employees, for permission to enter the premises of the undersigned for the purpose of conducting pipeline survey(s), including, but not limited to, civil, environmental, geotechnical/soil borings and archeological/cultural resource surveys as may be required by local, state and federal agencies for the construction of a pipeline, subject to the condition that compensation shall be paid for damage to property and/or crops caused by said survey activities.

Owners Name	Joe H. Schricker & Joann Schricker Living Trust, Edwin P. Fischbach, Joell R. Fischbach
--------------------	---

Address <input type="checkbox"/> Primary Address <input type="checkbox"/> Winter or Alternative Address	
--	--

Phone No.	Cell:	Home:	Business:
E-mail			

Owner's Signature _____ Date: _____

Owner's Verbal Permission _____ Date: _____

Tenants Name	
---------------------	--

Address	
----------------	--

Phone No.	Cell:	Home:	Business:
E-mail			

Tenant's Signature _____ Date: _____

Tenant's Verbal Signature _____ Date: _____

LANDOWNER / TENANT COMMENTS & RESTRICTIONS:

Land Agent	
-------------------	--

PRELIMINARY EXHIBIT "A" PROPOSED ROUTE

SEC 29 TWN 120 RNG 63 NW 1/4 29-120-63
SPIK COUNTY, SOUTH DAKOTA

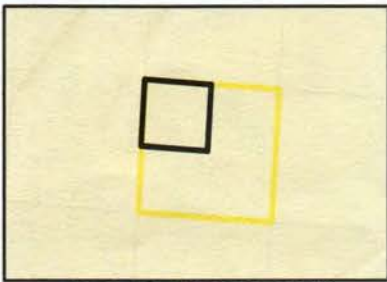

SEC. 29 T120N R63W
VICINITY MAP
N.T.S.



PROPOSED CENTERLINE = 3291.07 FT

Legend

- PROPOSED CENTERLINE
- PARCEL BOUNDARY LIMITS
- ADJACENT PROPERTIES

NOTES:

1. THE BASELINE IS APPROXIMATELY SHOWN ON EXHIBIT.
2. SKETCH WILL BE UPDATED TO A PLAT PREPARED BY A PROFESSIONAL SURVEYOR AND WILL BE FILED OF RECORD.

SIGNATURE: _____ DATE: _____



PROPOSED PIPELINE ROUTE

DRAWN BY:	TRC	SUMMIT CARBON SOLUTIONS MIDWEST CARBON EXPRESS JOE H & JOANN SCHRICKER LIVING TRUST TAX ID: 005248 TRACT NUMBER: SD-SP-0493.000
CHECKED BY:	TRC	
MAP DATE:	7/22/2021	
SCALE:	1 inch = 650'	
REV NO.	DATE	DESCRIPTION
A	7/22/2021	PRELIMINARY ROUTE
DRAWING NO. C-MCE-SD-SP-0493.000		PROJECT NO. 450959
		SHEET NO. 01 of 01

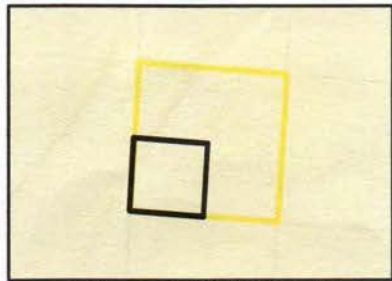

SEC. 20 T120N R63W
VICINITY MAP
N.T.S.

PRELIMINARY EXHIBIT "A" PROPOSED ROUTE

/TWN/RNG/MER: SEC 20 TWN 120 RNG 63 SW 1/4 20-
120-63
SPIK COUNTY, SOUTH DAKOTA



PROPOSED CENTERLINE = 1066.58 FT

Legend

- PROPOSED CENTERLINE
- PARCEL BOUNDARY LIMITS
- ADJACENT PROPERTIES

NOTES:

1. THE BASELINE IS APPROXIMATELY SHOWN ON EXHIBIT.
2. SKETCH WILL BE UPDATED TO A PLAT PREPARED BY A PROFESSIONAL SURVEYOR AND WILL BE FILED OF RECORD.

SIGNATURE: _____ DATE: _____

TRC
16350 Park Ten Place
Houston, TX 77084
(281) 616-0100

SUMMIT CARBON
SOLUTIONS

PROPOSED PIPELINE ROUTE

DRAWN BY: TRC		SUMMIT CARBON SOLUTIONS MIDWEST CARBON EXPRESS FISCHBACH, EDWIN P TAX ID: 005158 TRACT NUMBER: SD-SP-0494.000
CHECKED BY: TRC		
MAP DATE: 7/22/2021		
SCALE: 1 inch = 200'		
REV NO.	DATE	DESCRIPTION
A	7/22/2021	PRELIMINARY ROUTE
DRAWING NO. C-MCE-SD-SP-0494.000		PROJECT NO. 450959
		SHEET NO. 01 of 01

PRELIMINARY EXHIBIT "A" PROPOSED ROUTE

/TWN/RNG/MER: SEC 02 T120N R64W
SE 1/4 2-120-64
SPINK COUNTY, SOUTH DAKOTA

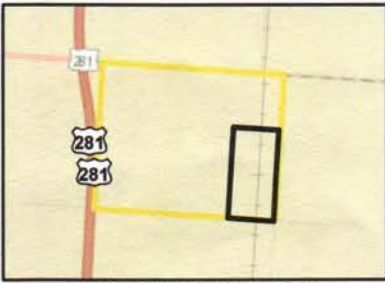

SEC. 02 T120N R64W
VICINITY MAP
N.T.S.



PROPOSED CENTERLINE = 1793.95 FT

Legend

- PROPOSED CENTERLINE
- PARCEL BOUNDARY LIMITS
- ADJACENT PROPERTIES

NOTES:

1. THE BASELINE IS APPROXIMATELY SHOWN ON EXHIBIT.
2. SKETCH WILL BE UPDATED TO A PLAT PREPARED BY A PROFESSIONAL SURVEYOR AND WILL BE FILED OF RECORD.

SIGNATURE: _____ DATE: _____

16350 Park Ten Place
Houston, TX 77084
(281) 616-0100

SUMMIT CARBON
SOLUTIONS

PROPOSED PIPELINE ROUTE

DRAWN BY: TRC		SUMMIT CARBON SOLUTIONS MIDWEST CARBON EXPRESS FISCHBACH, EDWIN P TAX ID: 004955 TRACT NUMBER: SD-SP-0506.000
CHECKED BY: TRC		
MAP DATE: 7/22/2021		
SCALE: 1 inch = 300'		
REV NO.	DATE	DESCRIPTION
A	7/22/2021	PRELIMINARY ROUTE
DRAWING NO. C-MCE-SD-SP-0506.000		PROJECT NO. 450959
		SHEET NO. 01 of 01