

# **Attachment No. 1**

# EXHIBIT "B"

## PRELIMINARY ROUTE

### MCPHERSON COUNTY, SOUTH DAKOTA

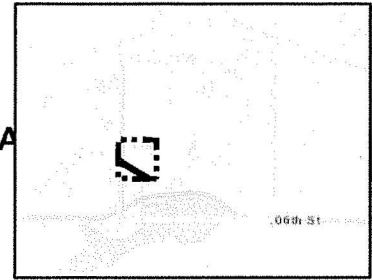
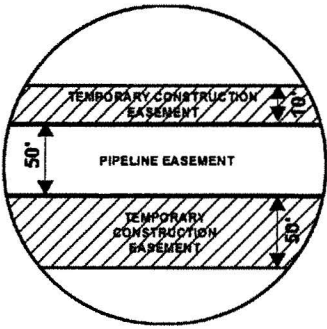

VICINITY MAP  
N.T.S.

## SEC. 35 T128N R70W

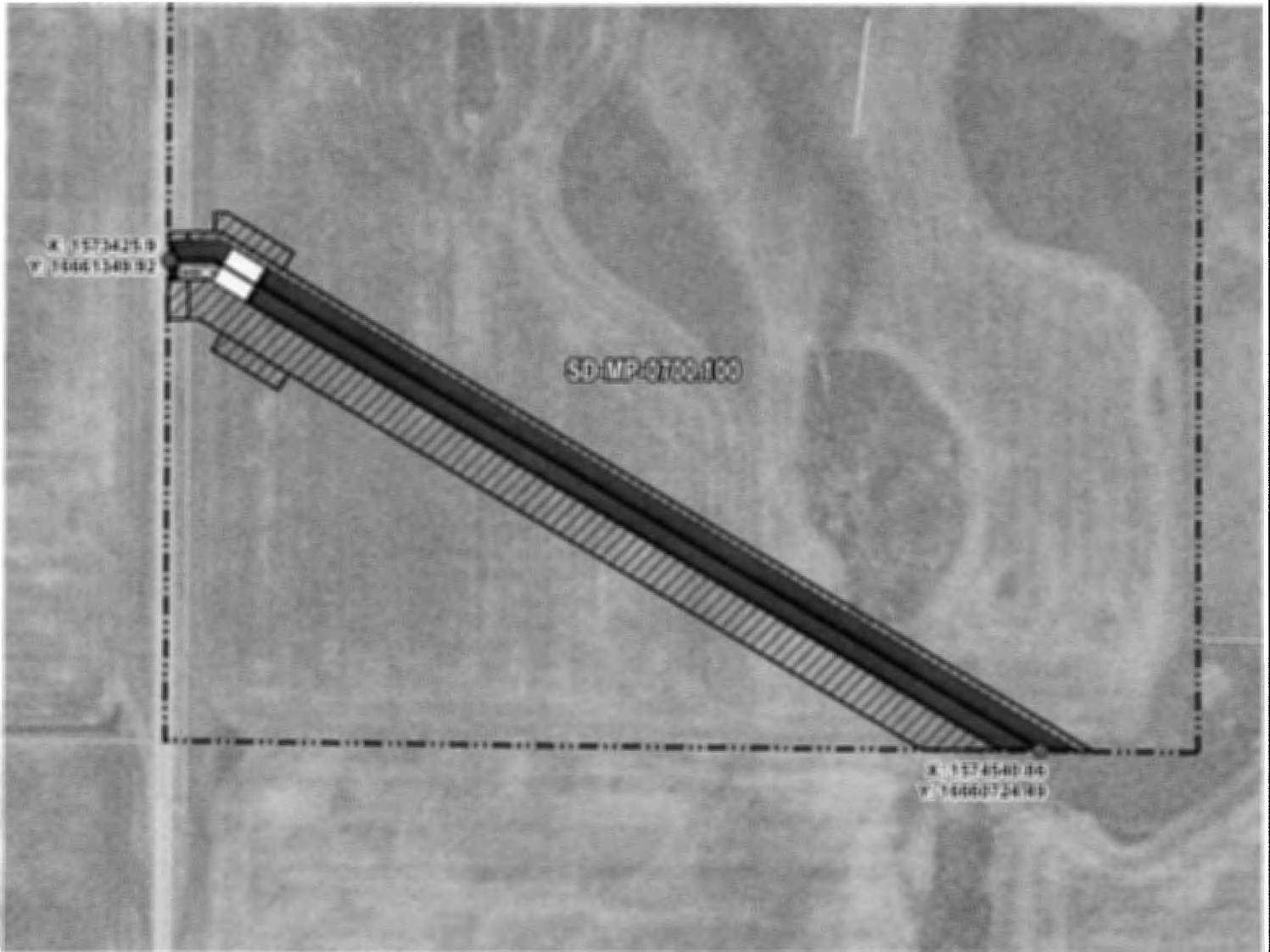

ROUTING LENGTH = 1286.359 FT +/- / ACCESS EASEMENT LENGTH = 47.9 FT +/-  
 IMPACTS: PIPELINE EASEMENT = 1.455 AC. +/- / TEMPORARY CONSTRUCTION EASEMENT = 1.776 AC. +/-

- Legend**
- PROPOSED ROUTE
  - ACCESS EASEMENT
  - PARCEL BOUNDARY
  - ADJACENT PROPERTIES
  - PIPELINE EASEMENT
  - TEMPORARY CONSTRUCTION EASEMENT
  - COUNTY BOUNDARY

**NOTES:**

1. THIS IS A PRELIMINARY DOCUMENT AND IS INTENDED TO DEPICT THE APPROXIMATE LOCATION OF A PROPOSED PIPELINE EASEMENT.
2. THIS DOCUMENT DOES NOT REPRESENT A LAND SURVEY AND IS NOT INTENDED TO DEPICT THE FINAL ALIGNMENT
3. COORDINATE SYSTEM: UTM ZONE 14 NORTH, NAD83, US SURVEY FEET



### PRELIMINARY PIPELINE ROUTE

DRAWN BY:	AC	SUMMIT CARBON SOLUTIONS MIDWEST CARBON EXPRESS DENNIS WOLFF  TAX ID: 3862 TRACT NUMBER: SD-MP-0700.100
CHECKED BY:	JW	
MAP DATE:	12/17/2021	
SCALE:	1 inch = 208'	
REV NO.	DATE	DESCRIPTION
H	1/4/2023	REVISED PARCEL BOUNDARY
J	3/10/2023	CLIENT REQUEST

DRAWING NO. PROJECT NO. SHEET NO.

# EXHIBIT "B"

## PRELIMINARY ROUTE

### MCPHERSON COUNTY, SOUTH DAKOTA

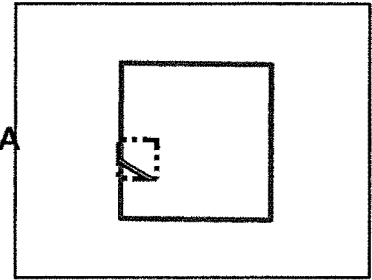
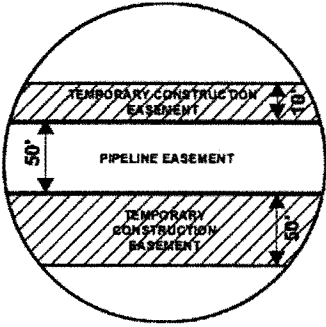

VICINITY MAP  
N.T.S.

**SEC. 35 T128N R70W**

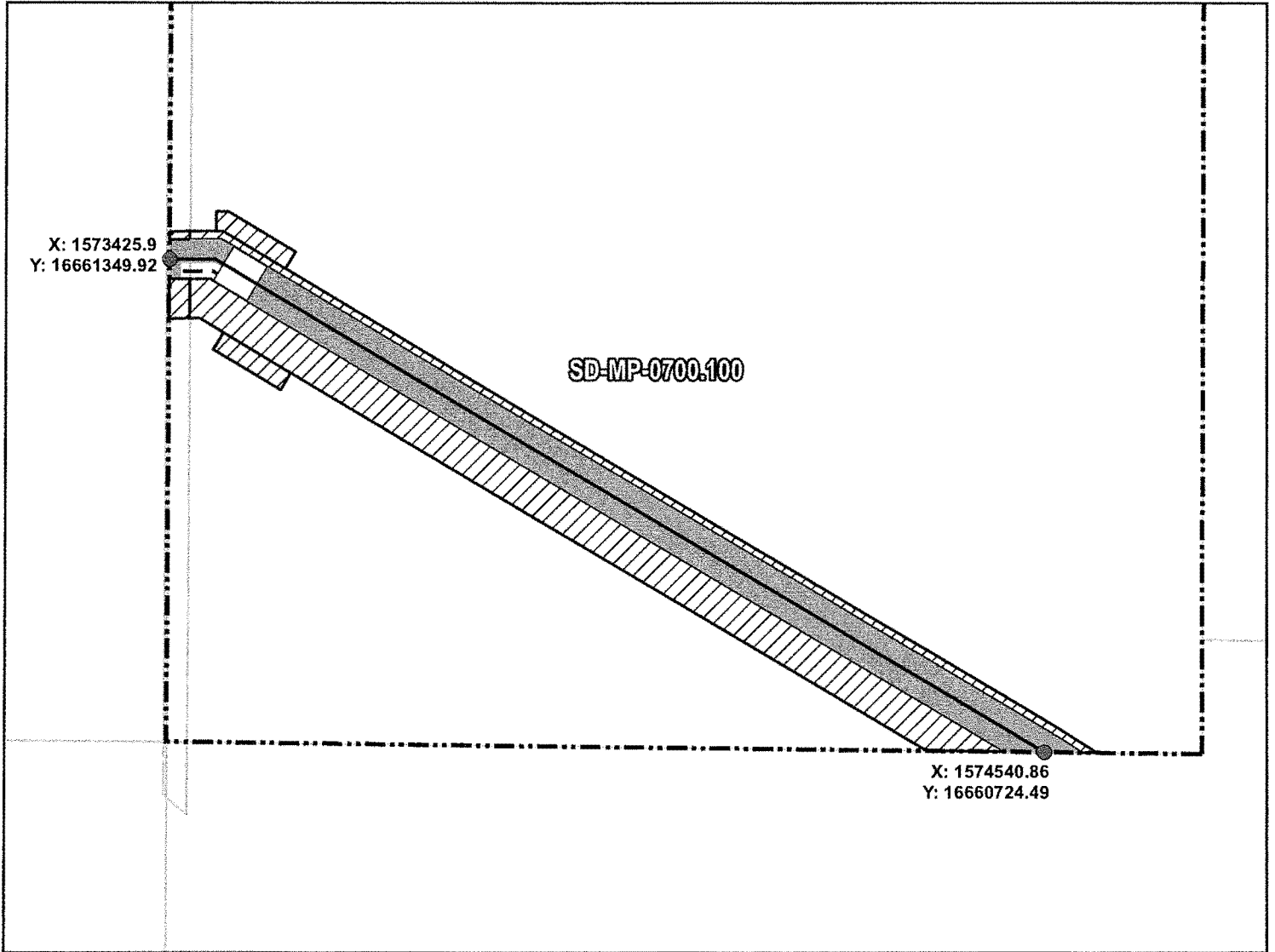

ROUTING LENGTH = 1286.359 FT +/- / ACCESS EASEMENT LENGTH = 47.9 FT +/-  
 IMPACTS: PIPELINE EASEMENT = 1.455 AC. +/- / TEMPORARY CONSTRUCTION EASEMENT = 1.776 AC. +/-

- Legend**
- PROPOSED ROUTE
  - - - ACCESS EASEMENT
  - ROADS
  - ▭ PARCEL BOUNDARY
  - ▭ ADJACENT PROPERTIES
  - ▨ PIPELINE EASEMENT
  - ▨ TEMPORARY CONSTRUCTION EASEMENT
  - ▭ COUNTY BOUNDARY

PRELIMINARY PIPELINE ROUTE		
DRAWN BY:	AC	SUMMIT CARBON SOLUTIONS MIDWEST CARBON EXPRESS DENNIS WOLFF  TAX ID: 3862 TRACT NUMBER: SD-MP-0700.100
CHECKED BY:	JW	
MAP DATE:	12/17/2021	
SCALE:	1 inch = 208'	
REV NO.	DATE	DESCRIPTION
H	1/4/2023	REVISED PARCEL BOUNDARY
J	3/10/2023	CLIENT REQUEST

**NOTES:**  
 1. THIS IS A PRELIMINARY DOCUMENT AND IS INTENDED TO DEPICT THE APPROXIMATE LOCATION OF A PROPOSED PIPELINE EASEMENT.  
 2. THIS DOCUMENT DOES NOT REPRESENT A LAND SURVEY AND IS NOT INTENDED TO DEPICT THE FINAL ALIGNMENT  
 3. COORDINATE SYSTEM: UTM ZONE 14 NORTH, NAD83, US SURVEY FEET  
 SIGNATURE: \_\_\_\_\_ DATE: \_\_\_\_\_



# EXHIBIT "B"

## PRELIMINARY ROUTE

### MCPHERSON COUNTY, SOUTH DAKOTA

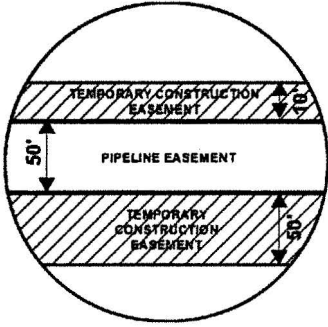

VICINITY MAP  
N.T.S.

## SEC. 34 T128N R70W

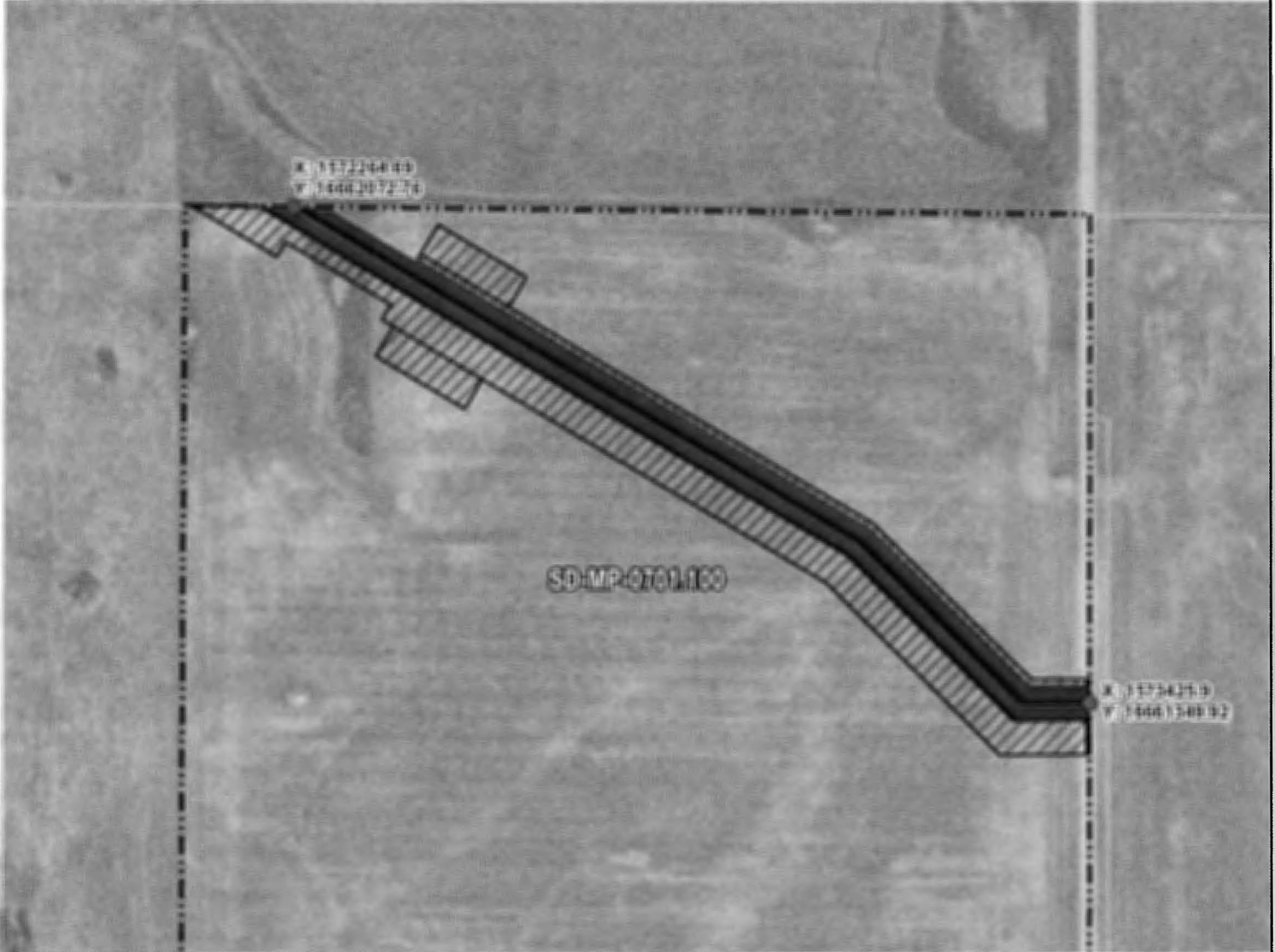

ROUTING LENGTH = 1391.969 FT +/-

IMPACTS: PIPELINE EASEMENT = 1.598 AC. +/- / TEMPORARY CONSTRUCTION EASEMENT = 2.242 AC. +/-

#### Legend

- PROPOSED ROUTE
- PIPELINE EASEMENT
- PARCEL BOUNDARY
- TEMPORARY CONSTRUCTION EASEMENT
- ADJACENT PROPERTIES
- COUNTY BOUNDARY

#### NOTES:

1. THIS IS A PRELIMINARY DOCUMENT AND IS INTENDED TO DEPICT THE APPROXIMATE LOCATION OF A PROPOSED PIPELINE EASEMENT.
2. THIS DOCUMENT DOES NOT REPRESENT A LAND SURVEY AND IS NOT INTENDED TO DEPICT THE FINAL ALIGNMENT
3. COORDINATE SYSTEM: UTM ZONE 14 NORTH, NAD83, US SURVEY FEET

#### PRELIMINARY PIPELINE ROUTE

DRAWN BY:	AC	SUMMIT CARBON SOLUTIONS MIDWEST CARBON EXPRESS DENNIS WOLFF  TAX ID: 3855 TRACT NUMBER: SD-MP-0701.100
CHECKED BY:	JW	
MAP DATE:	12/17/2021	
SCALE:	1 inch = 238'	
REV NO.	DATE	DESCRIPTION
K	1/4/2023	REVISED PARCEL BOUNDARY
L	3/10/2023	CLIENT REQUEST



SUMMIT CARBON

DRAWING NO. PROJECT NO. SHEET NO.

# EXHIBIT "B"

## PRELIMINARY ROUTE

### MCPHERSON COUNTY, SOUTH DAKOTA

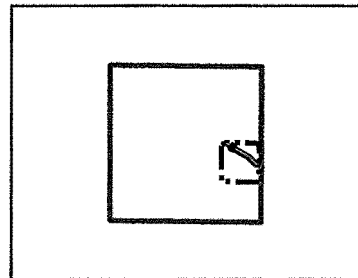
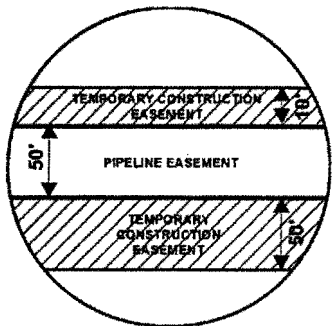

VICINITY MAP  
N.T.S.

**SEC. 34 T128N R70W**

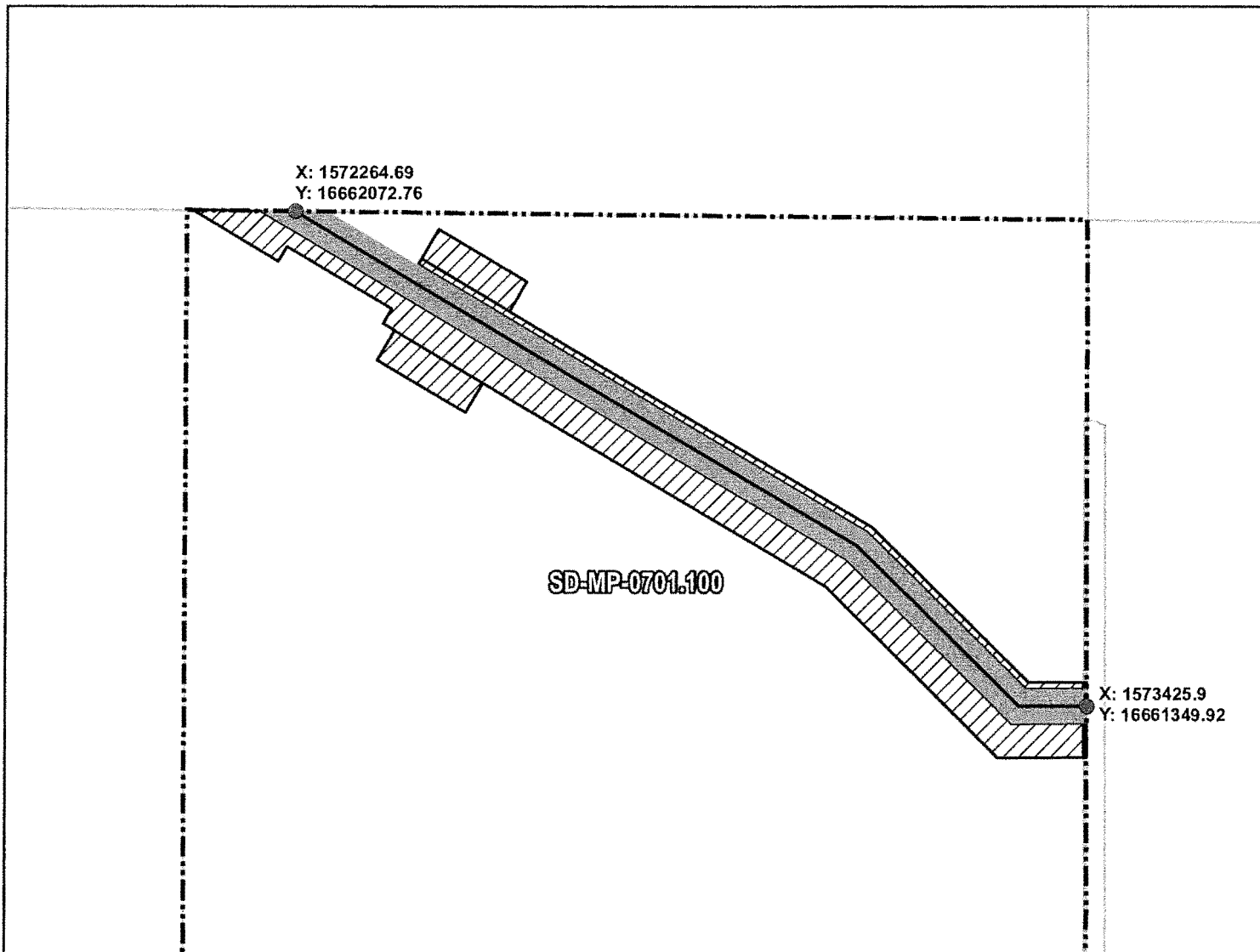

ROUTING LENGTH = 1391.969 FT +/-

IMPACTS: PIPELINE EASEMENT = 1.598 AC. +/- / TEMPORARY CONSTRUCTION EASEMENT = 2.242 AC. +/-

**Legend**

- PROPOSED ROUTE
- PIPELINE EASEMENT
- ROADS
- TEMPORARY CONSTRUCTION EASEMENT
- PARCEL BOUNDARY
- COUNTY BOUNDARY
- ADJACENT PROPERTIES

**NOTES:**

1. THIS IS A PRELIMINARY DOCUMENT AND IS INTENDED TO DEPICT THE APPROXIMATE LOCATION OF A PROPOSED PIPELINE EASEMENT.
2. THIS DOCUMENT DOES NOT REPRESENT A LAND SURVEY AND IS NOT INTENDED TO DEPICT THE FINAL ALIGNMENT
3. COORDINATE SYSTEM: UTM ZONE 14 NORTH, NAD83, US SURVEY FEET

SIGNATURE: \_\_\_\_\_ DATE: \_\_\_\_\_



**PRELIMINARY PIPELINE ROUTE**

DRAWN BY: AC  
 CHECKED BY: JW  
 MAP DATE: 12/17/2021

SUMMIT CARBON SOLUTIONS  
 MIDWEST CARBON EXPRESS  
 DENNIS WOLFF

TAX ID: 3855  
 TRACT NUMBER: SD-MP-0701.100

REV NO.	DATE	DESCRIPTION
K	1/4/2023	REVISED PARCEL BOUNDARY
L	3/10/2023	CLIENT REQUEST

DRAWING NO. \_\_\_\_\_ PROJECT NO. \_\_\_\_\_ SHEET NO. \_\_\_\_\_