

Attachment No. 1

EXHIBIT "B"

PRELIMINARY ROUTE

MCPHERSON COUNTY, SOUTH DAKOTA

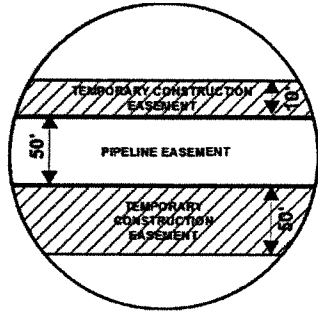

VICINITY MAP
N.T.S.

SEC. 06 T126N R68W

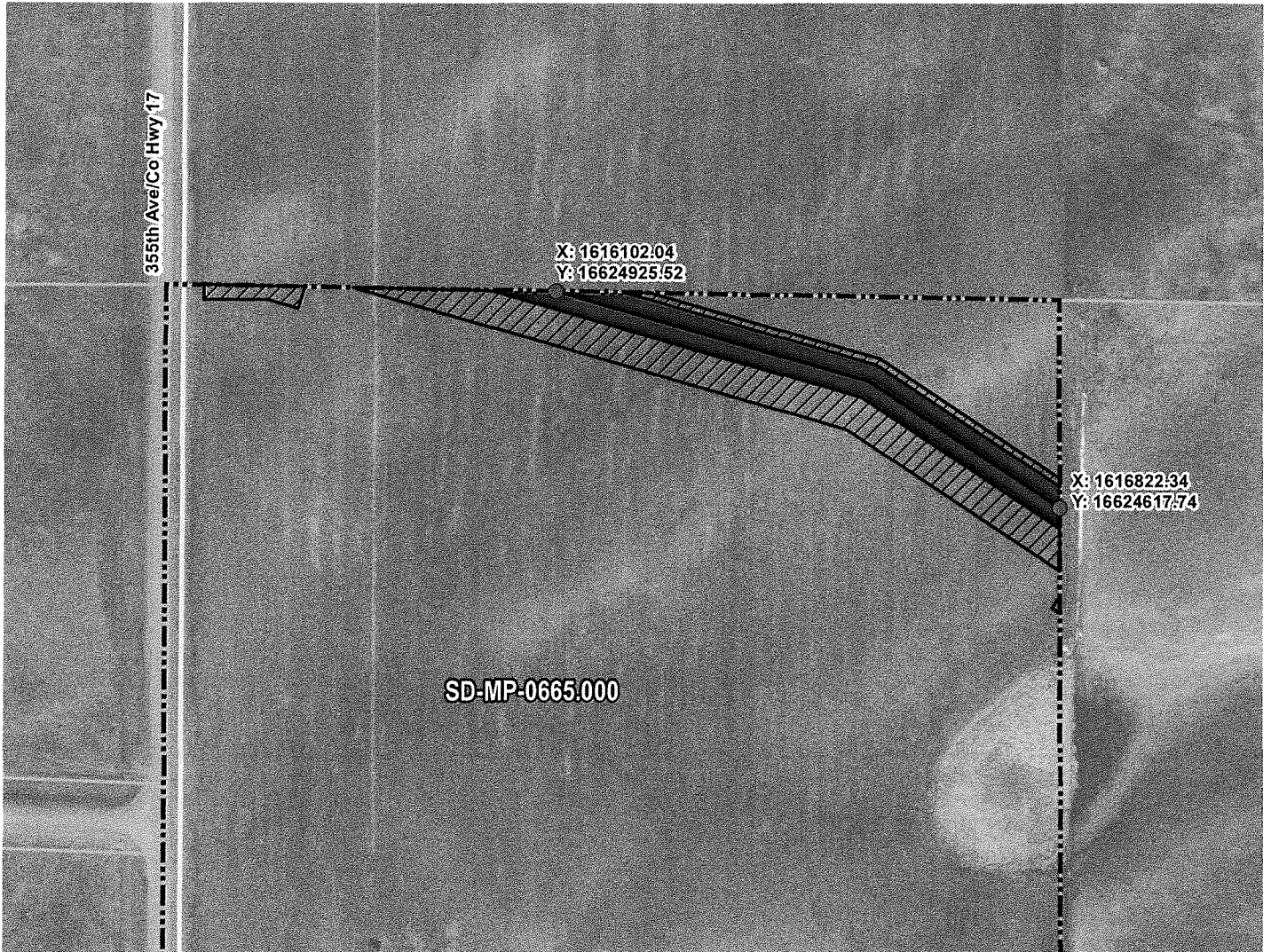

ROUTING LENGTH = 792.381 FT +/-

IMPACTS: PIPELINE EASEMENT = 0.91 AC. +/- / TEMPORARY CONSTRUCTION EASEMENT = 1.374 AC. +/-

Legend

- PROPOSED ROUTE
- PARCEL BOUNDARY
- ADJACENT PROPERTIES
- PIPELINE EASEMENT
- TEMPORARY CONSTRUCTION EASEMENT
- SECTION BOUNDARY
- COUNTY BOUNDARY

NOTES:

1. THIS IS A PRELIMINARY DOCUMENT AND IS INTENDED TO DEPICT THE APPROXIMATE LOCATION OF A PROPOSED PIPELINE EASEMENT.
2. THIS DOCUMENT DOES NOT REPRESENT A LAND SURVEY AND IS NOT INTENDED TO DEPICT THE FINAL ALIGNMENT
3. COORDINATE SYSTEM: UTM ZONE 14 NORTH, NAD83, US SURVEY FEET



SUMMIT CARBON SOLUTIONS

PRELIMINARY PIPELINE ROUTE		
DRAWN BY:	AC	SUMMIT CARBON SOLUTIONS MIDWEST CARBON EXPRESS BRIAN HOFFMAN TAX ID: 1128 TRACT NUMBER: SD-MP-0665.000
CHECKED BY:	JW	
MAP DATE:	12/17/2021	
SCALE:	1 inch = 233'	
REV NO.	DATE	DESCRIPTION
F	6/28/2022	REVISED WORKSPACE
G	12/8/2022	REVISED PARCEL BOUNDARY
DRAWING NO. C-MCE-ACQ-SD-MP-0665.000		PROJECT NO. 450959 SHEET NO. 01 of 01

EXHIBIT "B"

PRELIMINARY ROUTE

MCPHERSON COUNTY, SOUTH DAKOTA

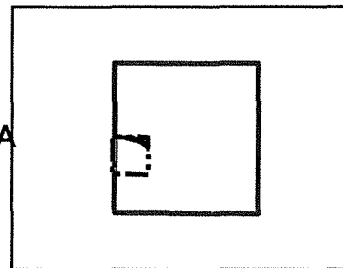
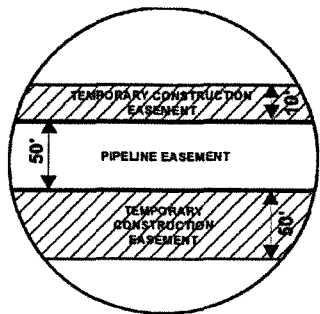

VICINITY MAP
N.T.S.

SEC. 06 T126N R68W

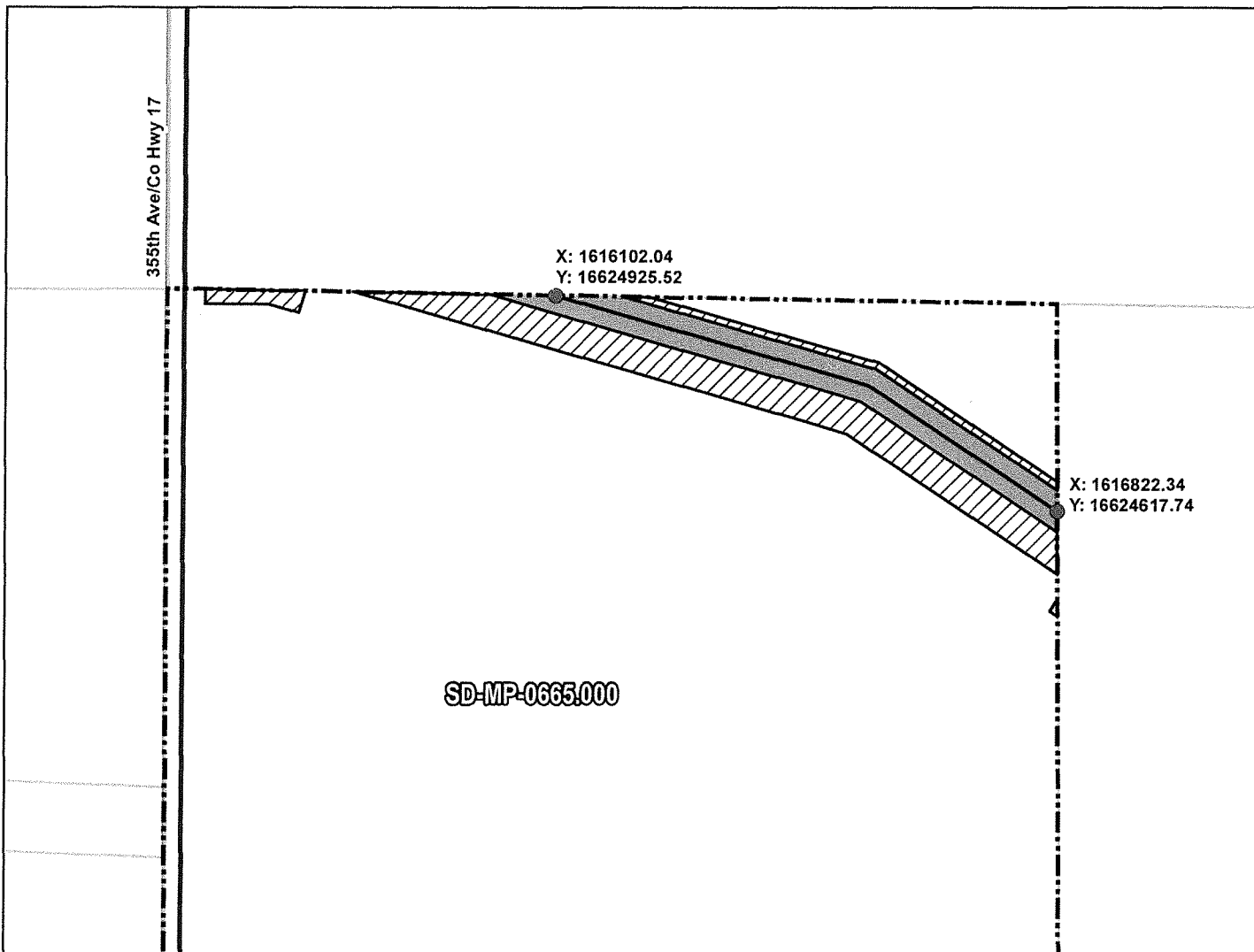

ROUTING LENGTH = 792.381 FT +/-

IMPACTS: PIPELINE EASEMENT = 0.91 AC. +/- / TEMPORARY CONSTRUCTION EASEMENT = 1.374 AC. +/-

Legend

- PROPOSED ROUTE
- ROADS
- ▭ PARCEL BOUNDARY
- ▭ ADJACENT PROPERTIES
- ▨ PIPELINE EASEMENT
- ▨ TEMPORARY CONSTRUCTION EASEMENT
- ▭ SECTION BOUNDARY
- ▭ COUNTY BOUNDARY

NOTES:

1. THIS IS A PRELIMINARY DOCUMENT AND IS INTENDED TO DEPICT THE APPROXIMATE LOCATION OF A PROPOSED PIPELINE EASEMENT.
2. THIS DOCUMENT DOES NOT REPRESENT A LAND SURVEY AND IS NOT INTENDED TO DEPICT THE FINAL ALIGNMENT
3. COORDINATE SYSTEM: UTM ZONE 14 NORTH, NAD83, US SURVEY FEET

SIGNATURE: _____ DATE: _____



SUMMIT CARBON SOLUTIONS

PRELIMINARY PIPELINE ROUTE

DRAWN BY: AC		SUMMIT CARBON SOLUTIONS MIDWEST CARBON EXPRESS BRIAN HOFFMAN TAX ID: 1128 TRACT NUMBER: SD-MP-0665.000
CHECKED BY: JW		
MAP DATE: 12/17/2021		
SCALE: 1 inch = 233'		
REV NO.	DATE	DESCRIPTION
F	6/28/2022	REVISED WORKSPACE
G	12/8/2022	REVISED PARCEL BOUNDARY
DRAWING NO. BW-MCE-ACQ-SD-MP-0665.000		PROJECT NO. 450959
		SHEET NO. 01 of 01

EXHIBIT "B"

PRELIMINARY ROUTE

MCPHERSON COUNTY, SOUTH DAKOTA

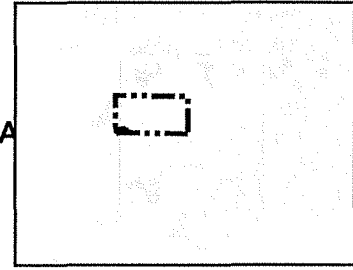

VICINITY MAP
N.T.S.

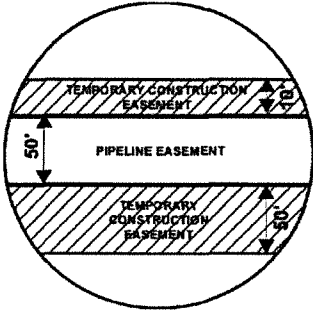

SEC. 06 T126N R68W

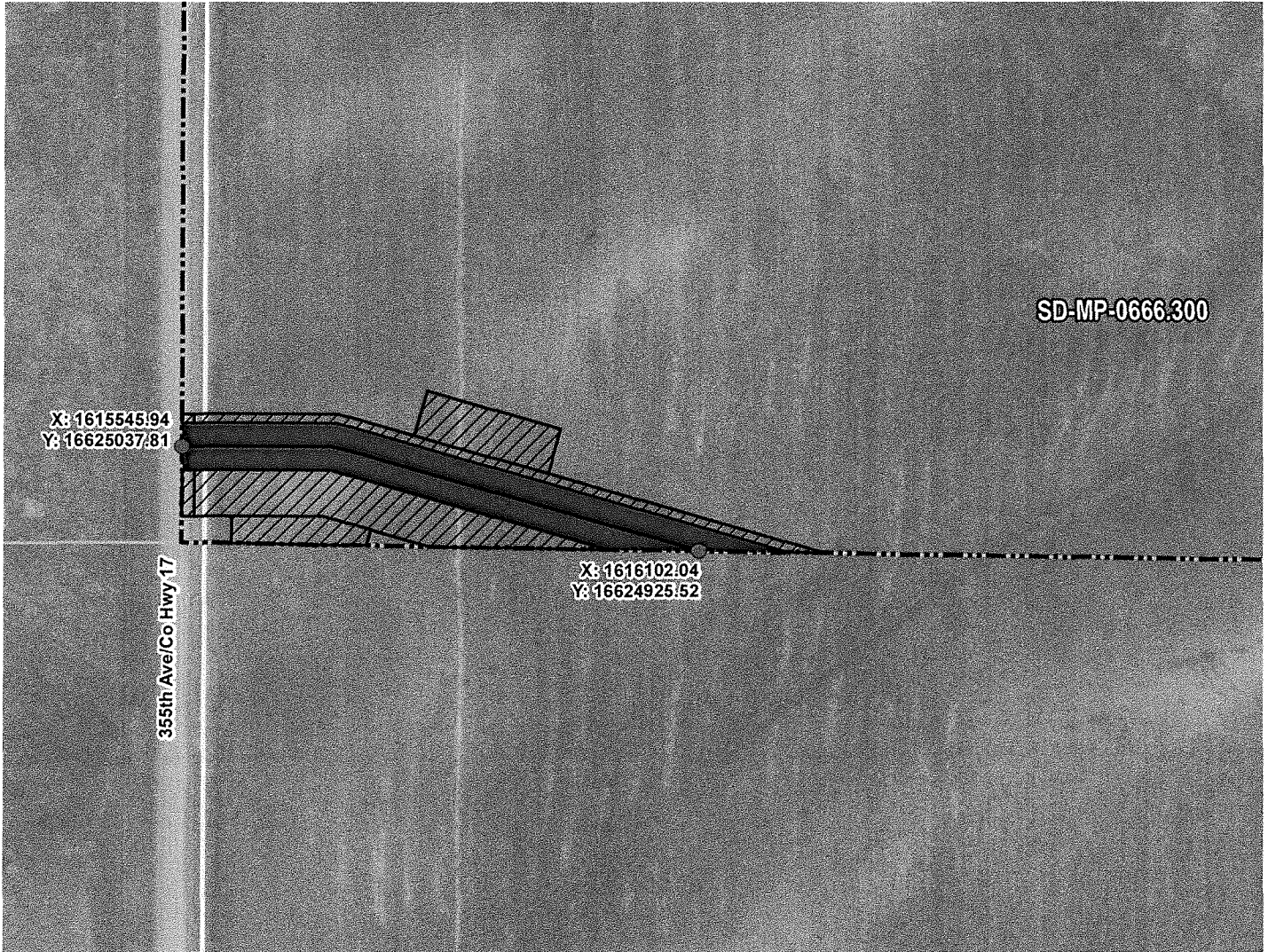

ROUTING LENGTH = 571.802 FT +/-

IMPACTS: PIPELINE EASEMENT = 0.656 AC. +/- / TEMPORARY CONSTRUCTION EASEMENT = 0.851 AC. +/-

Legend

- PROPOSED ROUTE
- PIPELINE EASEMENT
- PARCEL BOUNDARY
- TEMPORARY CONSTRUCTION EASEMENT
- ADJACENT PROPERTIES
- SECTION BOUNDARY
- COUNTY BOUNDARY

NOTES:

1. THIS IS A PRELIMINARY DOCUMENT AND IS INTENDED TO DEPICT THE APPROXIMATE LOCATION OF A PROPOSED PIPELINE EASEMENT.
2. THIS DOCUMENT DOES NOT REPRESENT A LAND SURVEY AND IS NOT INTENDED TO DEPICT THE FINAL ALIGNMENT
3. COORDINATE SYSTEM: UTM ZONE 14 NORTH, NAD83, US SURVEY FEET



PRELIMINARY PIPELINE ROUTE

DRAWN BY:	AC	SUMMIT CARBON SOLUTIONS MIDWEST CARBON EXPRESS BRIAN HOFFMAN TAX ID: 1127 TRACT NUMBER: SD-MP-0666.300
CHECKED BY:	JW	
MAP DATE:	12/17/2021	
SCALE: 1 inch = 175'		
REV NO.	DATE	DESCRIPTION
E	7/18/2022	REVISED WORKSPACE
F	12/8/2022	REVISED PARCEL BOUNDARY
DRAWING NO. C-MCE-ACQ-SD-MP-0666.300		PROJECT NO. 450959 SHEET NO. 01 of 01

EXHIBIT "B"

PRELIMINARY ROUTE

MCPHERSON COUNTY, SOUTH DAKOTA

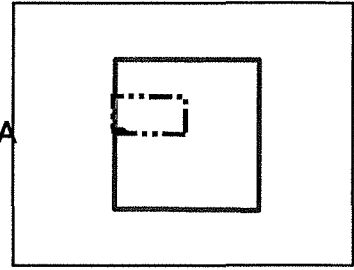
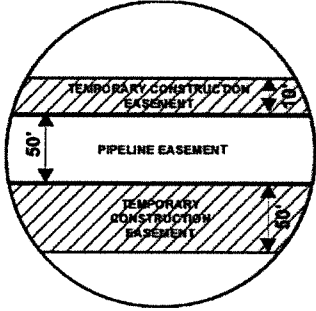

VICINITY MAP
N.T.S.

SEC. 06 T126N R68W

SD-MP-0666.300

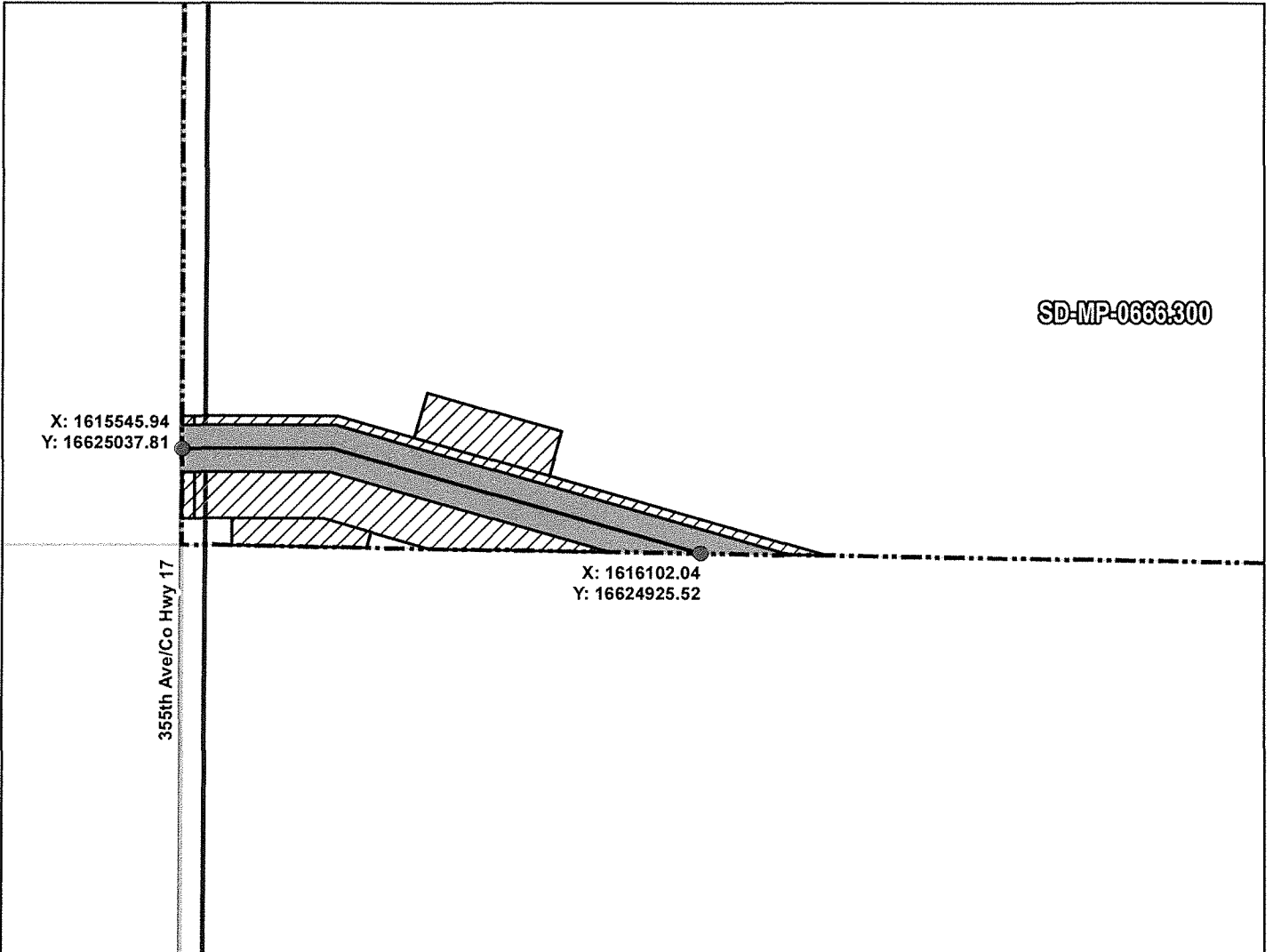

ROUTING LENGTH = 571.802 FT +/-

IMPACTS: PIPELINE EASEMENT = 0.656 AC. +/- / TEMPORARY CONSTRUCTION EASEMENT = 0.851 AC. +/-

Legend

- PROPOSED ROUTE
- ROADS
- PARCEL BOUNDARY
- ADJACENT PROPERTIES
- PIPELINE EASEMENT
- TEMPORARY CONSTRUCTION EASEMENT
- SECTION BOUNDARY
- COUNTY BOUNDARY

NOTES:

1. THIS IS A PRELIMINARY DOCUMENT AND IS INTENDED TO DEPICT THE APPROXIMATE LOCATION OF A PROPOSED PIPELINE EASEMENT.
2. THIS DOCUMENT DOES NOT REPRESENT A LAND SURVEY AND IS NOT INTENDED TO DEPICT THE FINAL ALIGNMENT
3. COORDINATE SYSTEM: UTM ZONE 14 NORTH, NAD83, US SURVEY FEET

SIGNATURE: _____ DATE: _____



SUMMIT CARBON SOLUTIONS

PRELIMINARY PIPELINE ROUTE

DRAWN BY: AC		SUMMIT CARBON SOLUTIONS MIDWEST CARBON EXPRESS BRIAN HOFFMAN TAX ID: 1127 TRACT NUMBER: SD-MP-0666.300
CHECKED BY: JW		
MAP DATE: 12/17/2021		
SCALE: 1 inch = 175'		
REV NO.	DATE	DESCRIPTION
E	7/18/2022	REVISED WORKSPACE
F	12/8/2022	REVISED PARCEL BOUNDARY
DRAWING NO. BW-MCE-ACQ-SD-MP-0666.300		PROJECT NO. 450959 SHEET NO. 01 of 01