

TO: COMMISSIONERS AND ADVISORS
FROM: BRIAN ROUNDS
SUBJECT: TC13-026 – BIENNIAL CERTIFICATION OF STUDY AREA BOUNDARIES
DATE: DECEMBER 11, 2015

STAFF MEMORANDUM

In April of this year, Staff filed a memorandum re-opening Docket TC13-026 in order to allow the Commission to complete its biennial certification of all study area boundaries (SABs) in South Dakota. Included in that memo was a list of edits Staff had made since the Commission originally approved the SABs in June of 2013.

However, before the Commission certified the SABs, Golden West Telecommunications Cooperative (Golden West) and TrioTel Communications, Inc. (TrioTel) asked Staff to make a few small corrections to their boundaries. At that point, Staff requested the Commission defer their decision until those changes were completed.

In addition to the Golden West/TrioTel edits, the Commission approved a change to the boundary between Interstate Telecommunications Cooperative, Inc. (ITC) and CenturyLink in Docket TC15-014 on July 21, 2015. **With this memo, Staff is detailing the additional edits and asking the Commission to certify the SABs.**

In the maps below, the red line shows where the boundaries were before being moved, with the gray lines showing where the boundaries currently are. In many cases, the gray line is covered by the red line, indicating that the line did not move far from its original location.

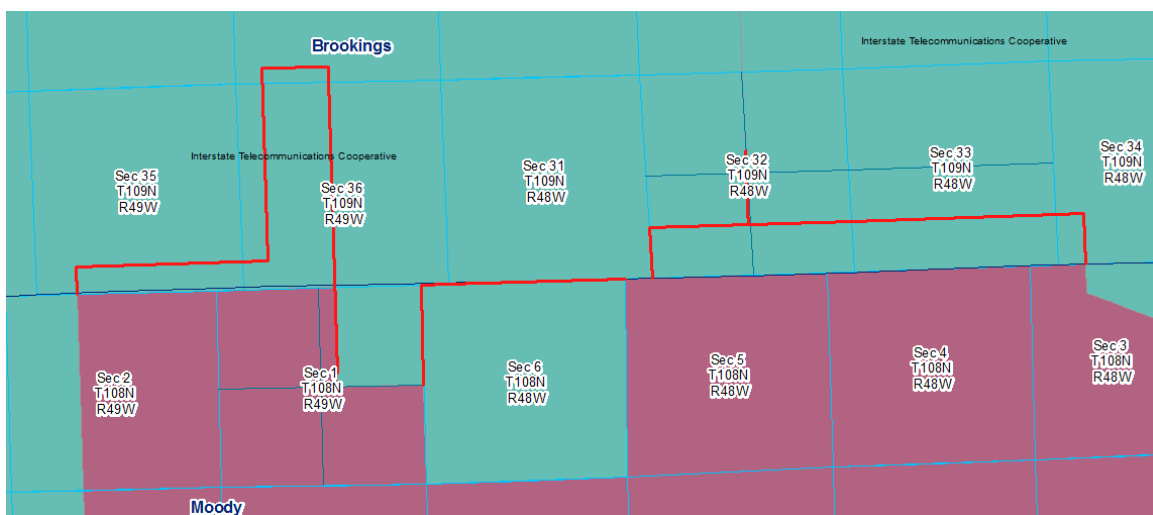

Map 1 – Changes made in Docket TC15-014

Although Golden West and TrioTel only asked to make a few small changes to the boundary between them, Staff used the opportunity to increase the accuracy of both study areas by attaching the entire boundary and all internal boundaries to geographic features, such as roads, section lines, and rivers. As a result, the changes look extensive, but most of the boundaries were only moved slightly. After the edits were made, both companies approved them.

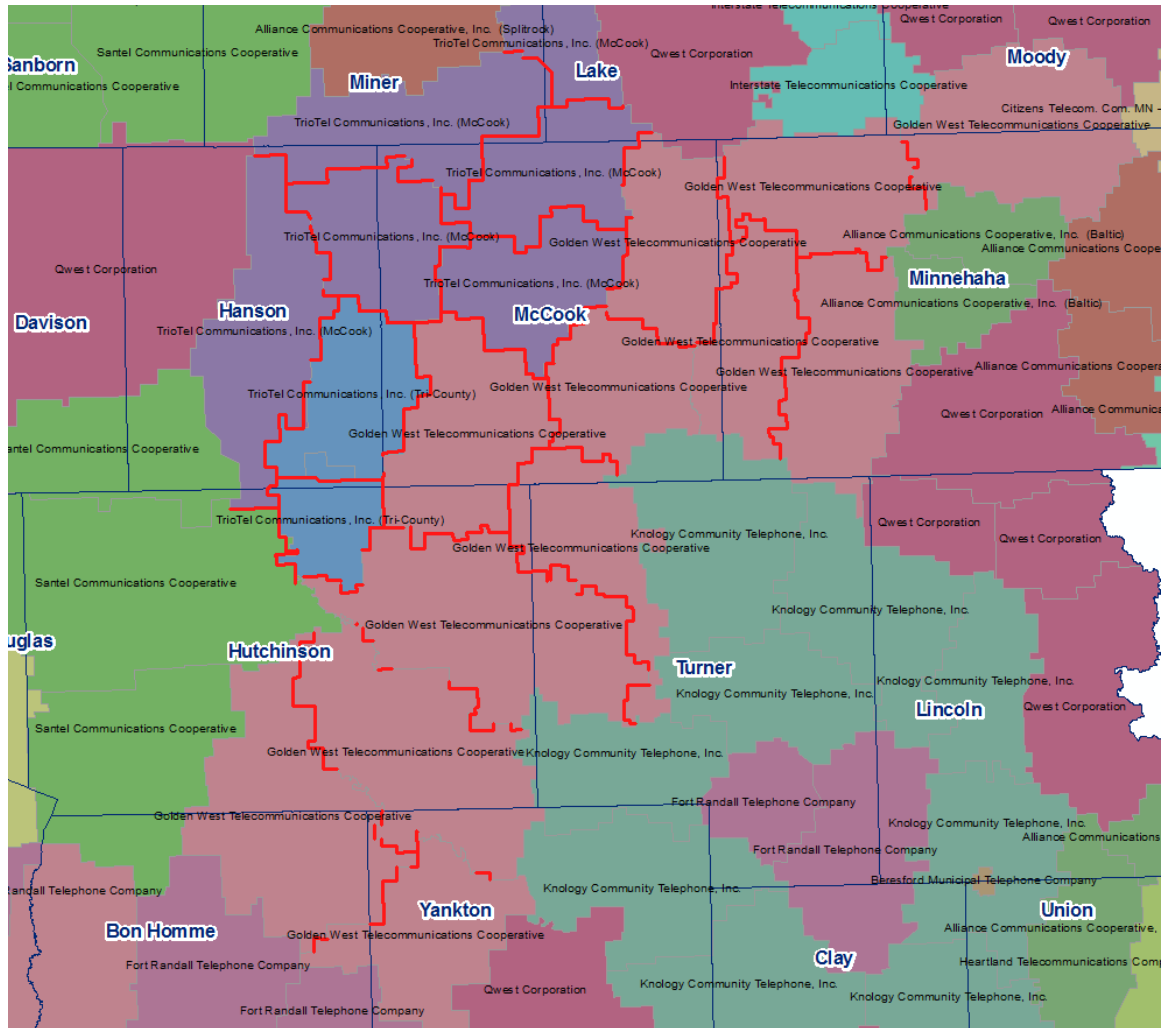

Map 2 – Comprehensive view of Golden West/TrioTel changes

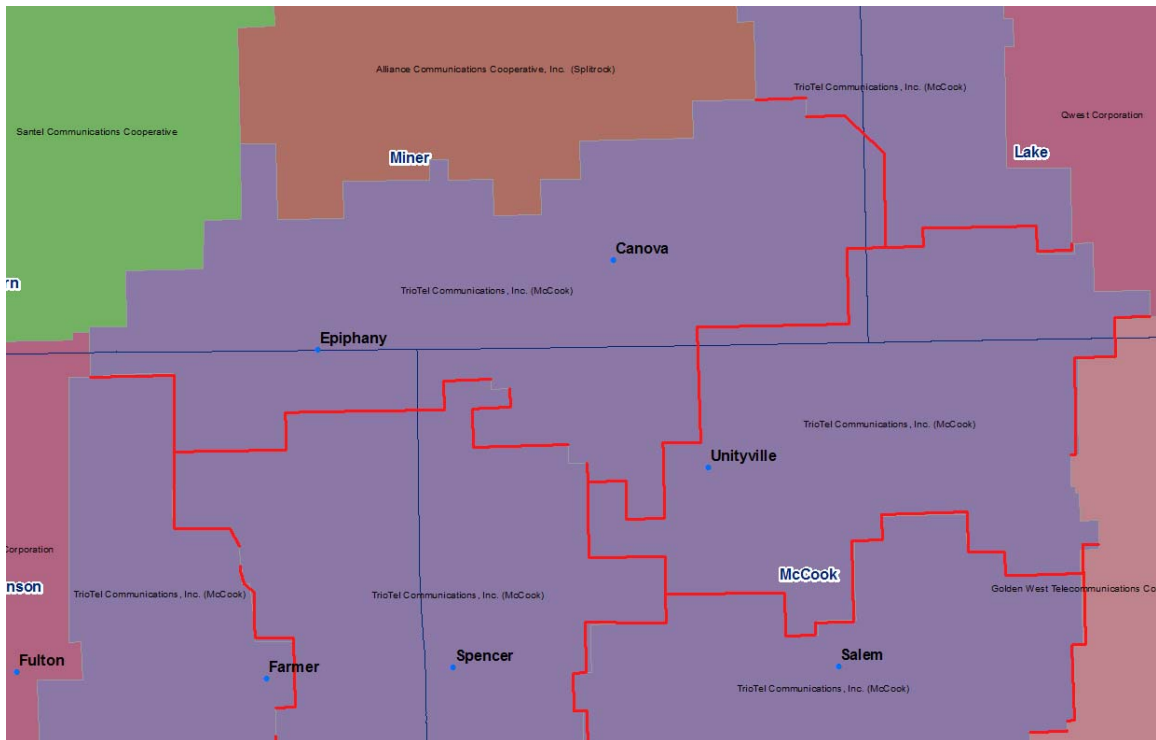

Map 3 – Northern view of changes to internal boundaries of TrioTel’s study area

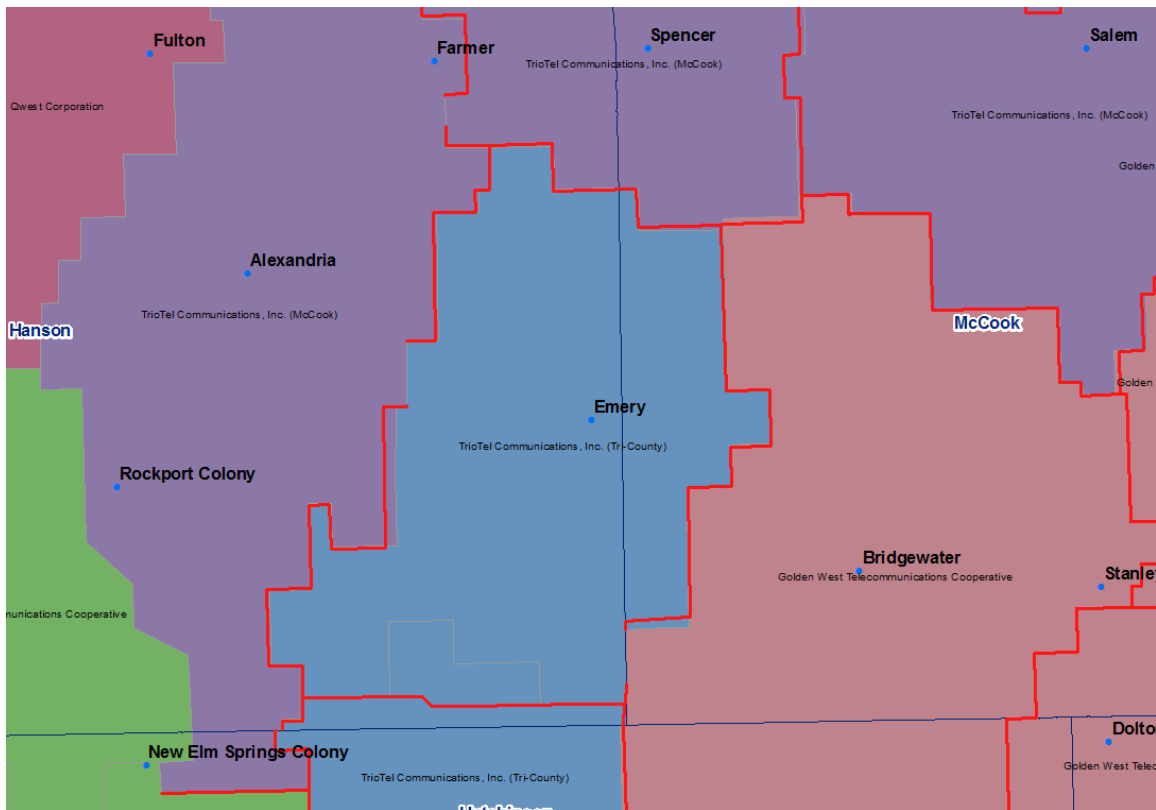

Map 4 – Southern view of changes to internal boundaries of TrioTel’s study area

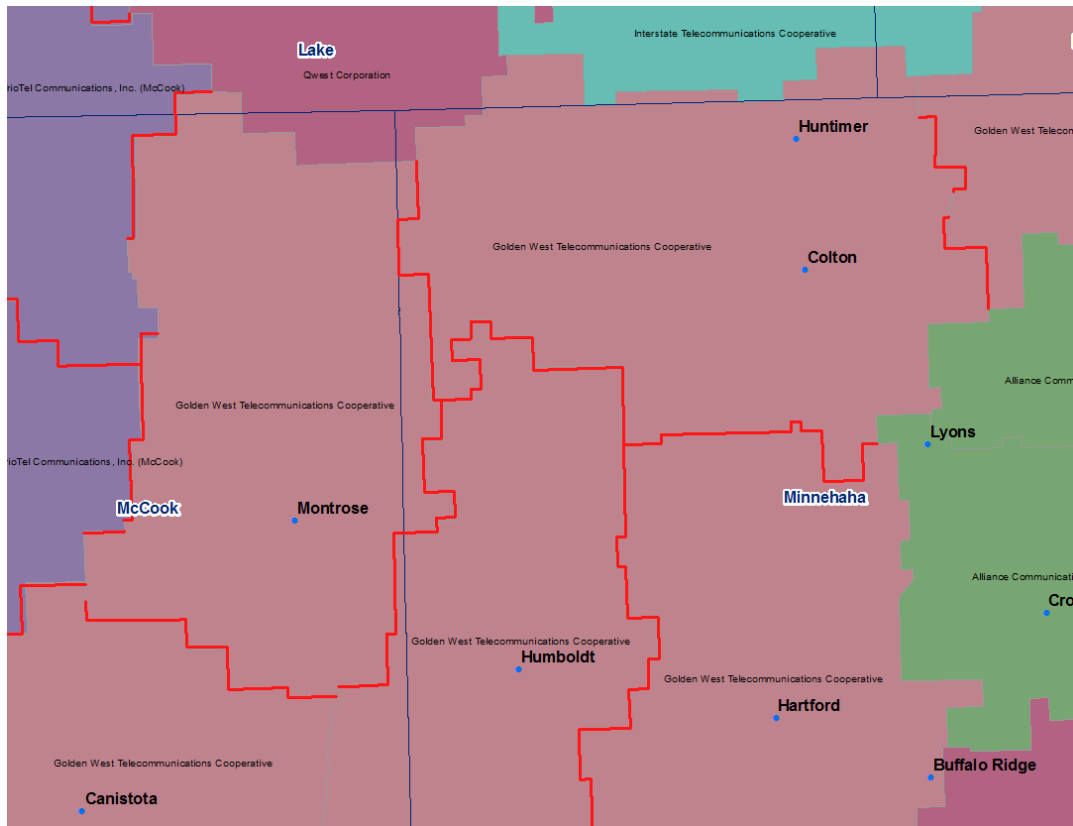

Map 5 – Northern view of changes to internal boundaries of Golden West's study area

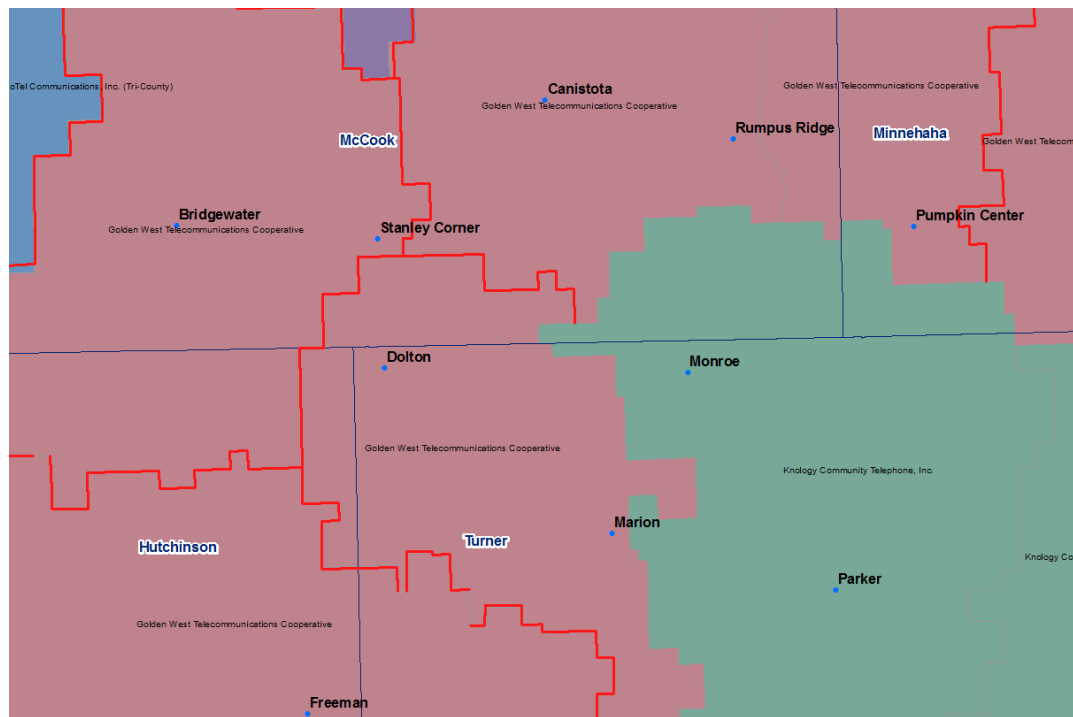

Map 6 – Central view of changes to internal boundaries of Golden West's study area

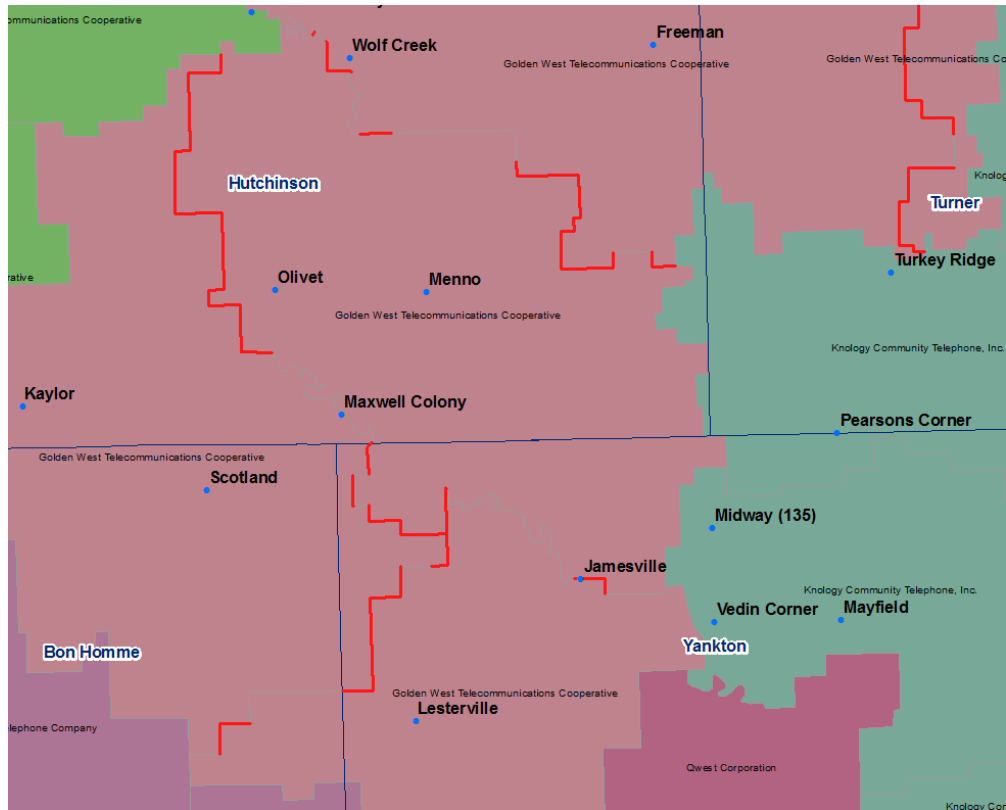

Map 7 – Southern view of changes to internal boundaries of Golden West's study area

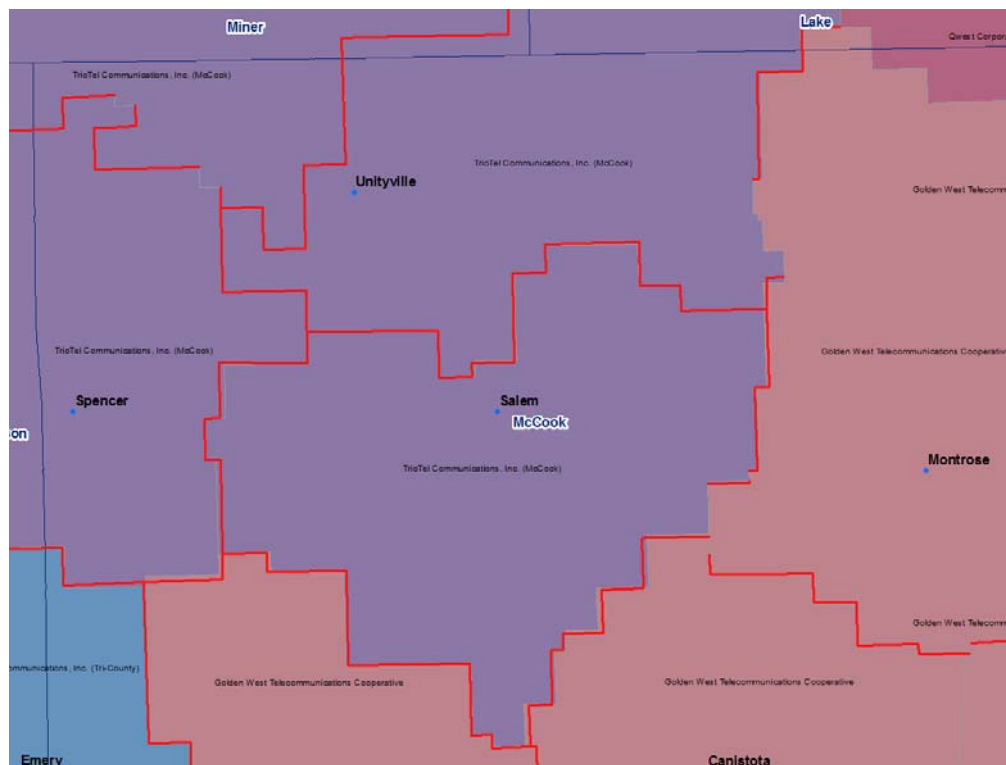

Map 8 – Northern view of SAB changes between TrioTel and Golden West

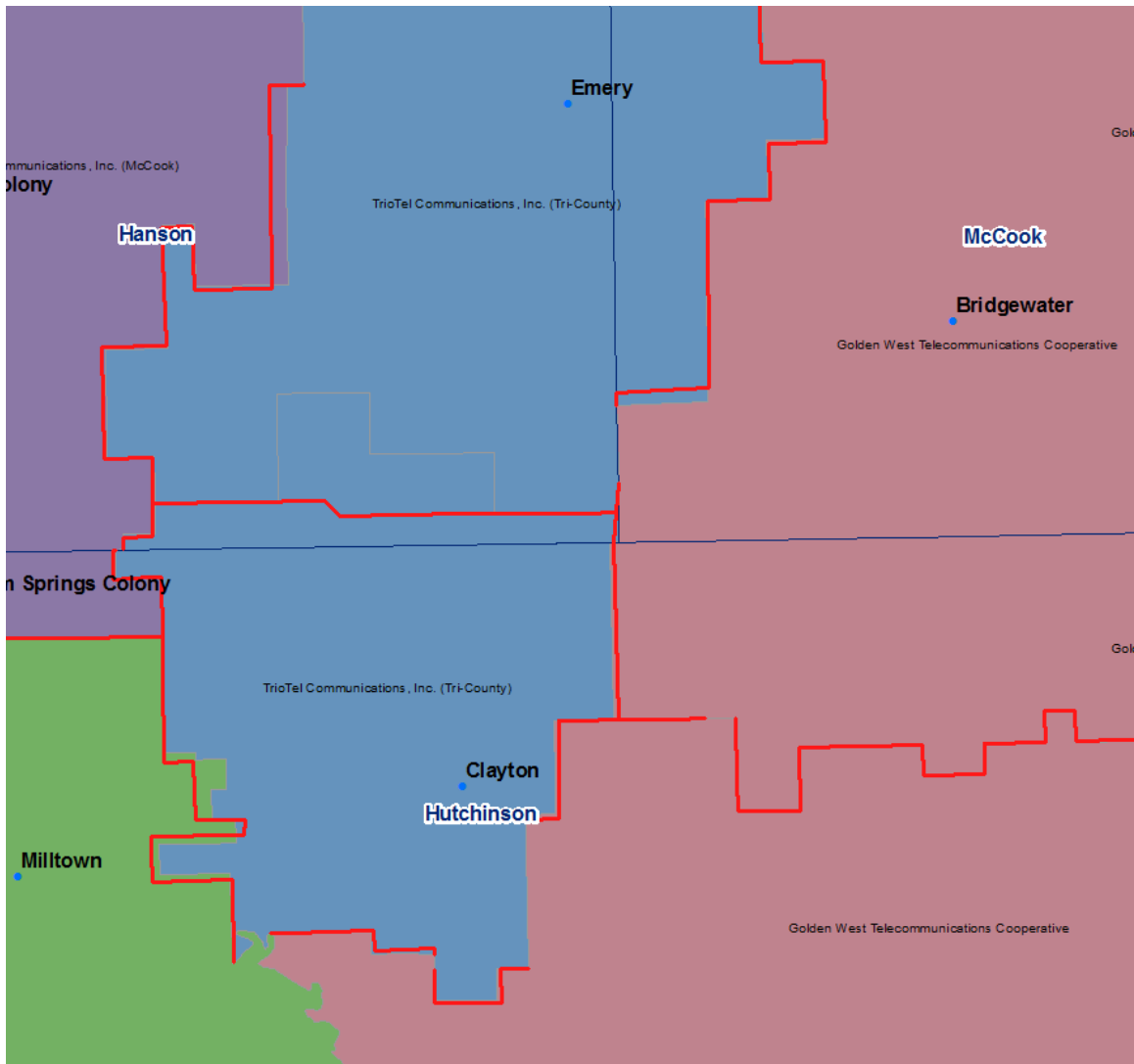

Map 9 – Southern view of SAB changes between TrioTel and Golden West