

**Figure 3. Project Map**

Crowned Ridge Wind Farm

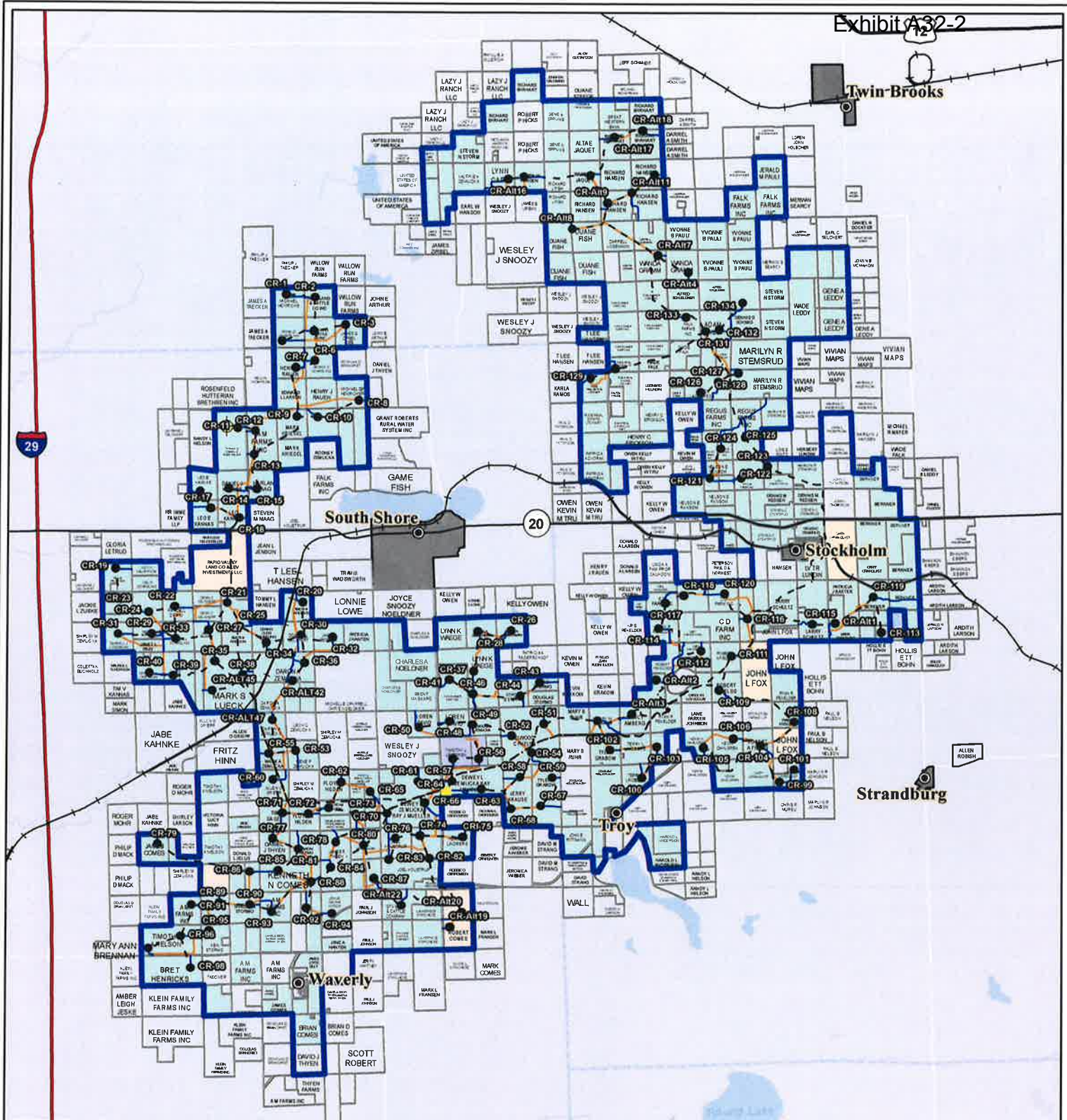
- MET Tower
  - Turbine
  - City
  - Access Road
  - Collector Line
  - Crane Path
  - Railroad
  - Interstate Highway
  - U.S. Highway
  - State Highway
  - C&M Facility/  
Substation
  - Town Boundary
  - Project Boundary
- Lease Status**
- Leased, Signed
  - Pending Approval



Kilometers  
0 2.5 5

Miles  
0 2.5 5

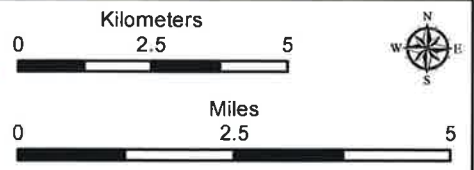
Base Map: World Light Gray Canvas Base  
Sources: Esri, HERE, Garmin, © OpenStreetMap contributors, and the GIS user community  
Codington and Grant Counties, South Dakota  
Page 000001  
Projection: NAD 1983 UTM Zone 14N



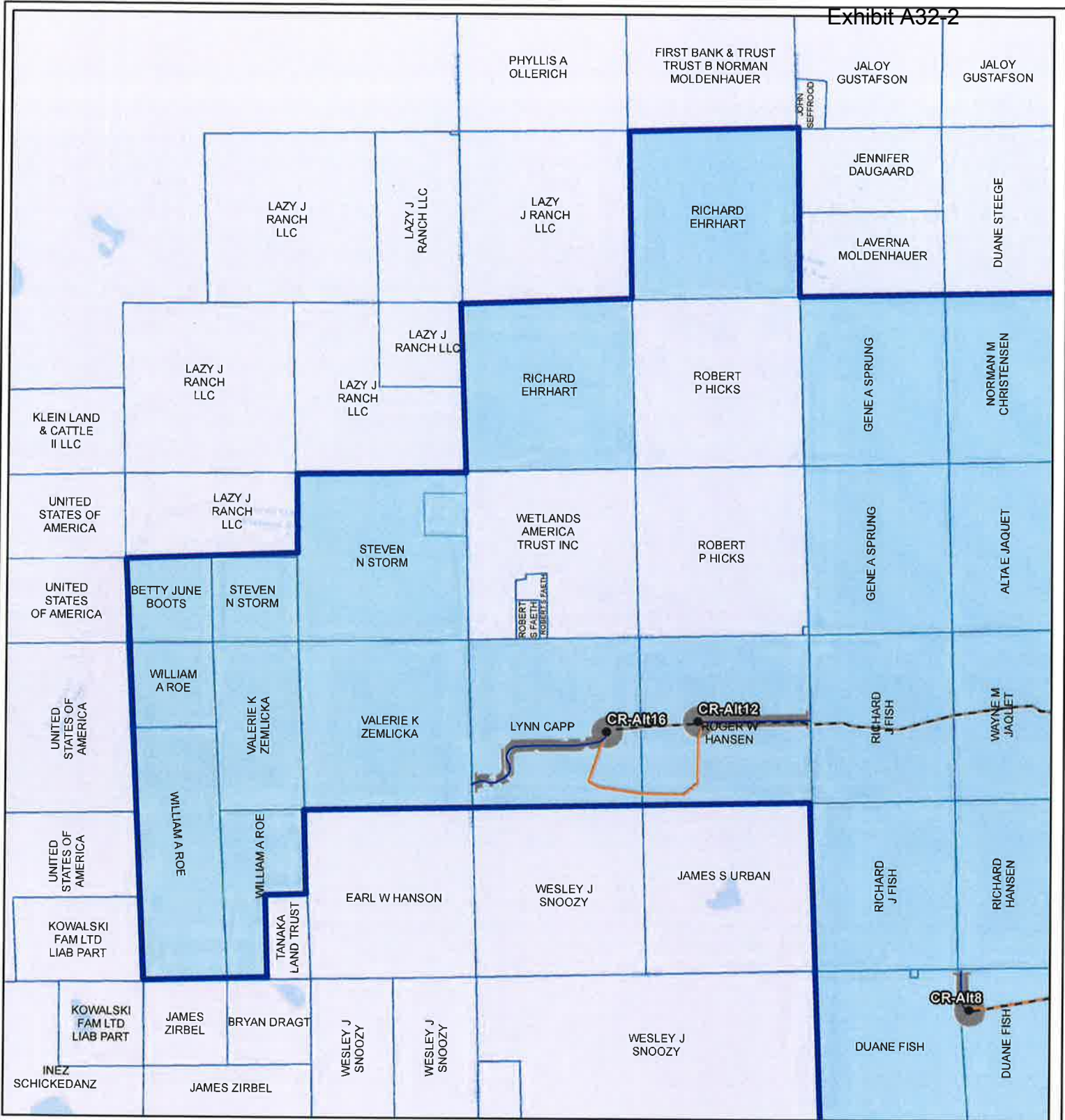
**Figure 3a. Project Map**

Crowned Ridge Wind Farm

- MET Tower
- Turbine
- City
- Access Road
- Collector Line
- Crane Path
- Railroad
- Interstate Highway
- U.S. Highway
- State Highway
- OSM Facility/  
Substation
- Town Boundary
- Project Boundary
- Parcel Boundary
- Lease Status**
- Leased, Signed
- Pending Approval
- Under Option but  
Likely to Expire/Not  
Resign

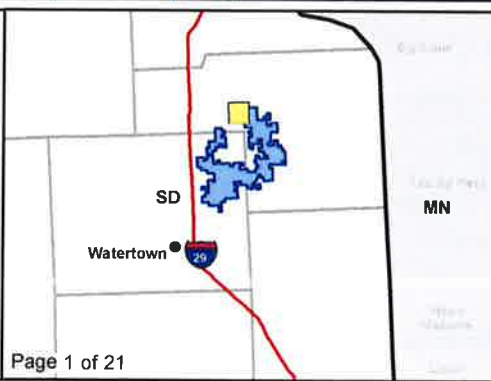


Base Map: World Light Gray Canvas Base  
Sources: Esri, HERE, Garmin, © OpenStreetMap contributors, and the GIS user community  
Codington and Grant Counties, South Dakota



**Figure 3a. Project Map**  
Crowned Ridge Wind Farm

- Turbine
- ⊕ MFT Tower
- City
- Access Road
- - - Collector Line
- Crane Path
- Railroad
- O&M Facility/ Substation
- Batch Plant
- Laydown Yard
- ▨ Construction Easement
- ▭ Parcel Boundary
- ▭ Project Boundary
- ▭ County Boundary
- Lease Status**
- ▭ Leased, Signed
- ▭ Pending
- ▭ Under Option but Likely to Expire/Not Resign



0 0.5 1  
Kilometers

0 0.25 0.5  
Miles

Service Layer Credits: Esri, HERE, Garmin, © OpenStreetMap contributors, and the GIS user community  
 Quadrangle: Antelope Valley (1973), Twin Brooks (1973)  
 Township/Range: T120N, R51W, T120N, R50W  
 Grant County, South Dakota

Projection: NAD 1983 UTM Zone 14N

Page 000003 **SWCA** ENVIRONMENTAL CONSULTANTS

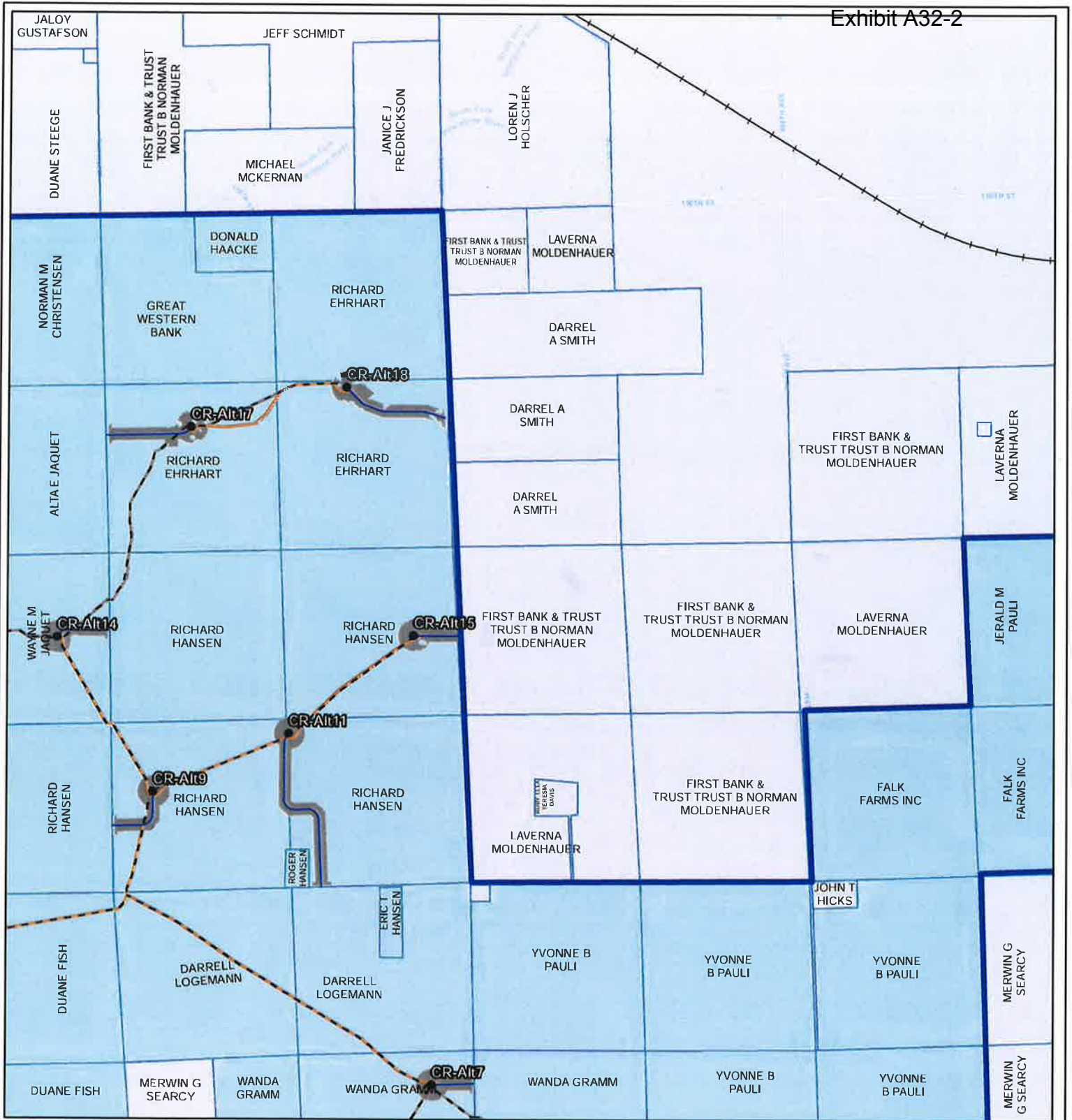
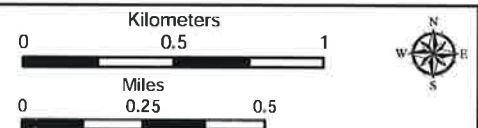


Figure 3a. Project Map  
Crowned Ridge Wind Farm

- Turbine
- ⊕ MFT Tower
- City
- Access Road
- - - Collector Line
- Crane Path
- Railroad
- O&M Facility/ Substation
- Batch Plant
- Laydown Yard
- Construction Easement
- ▭ Parcel Boundary
- ▭ Project Boundary
- ▭ County Boundary
- ▭ Lease Status
- ▭ Leased, Signed
- ▭ Pending
- ▭ Under Option but Likely to Expire/Not Resign



Service Layer Credits: Esri, HERE, Garmin,  
© OpenStreetMap contributors, and the GIS user  
community  
Quadrangle: Twin Brooks (1973)  
Township/Range: T120N, R50W  
Grant County, South Dakota

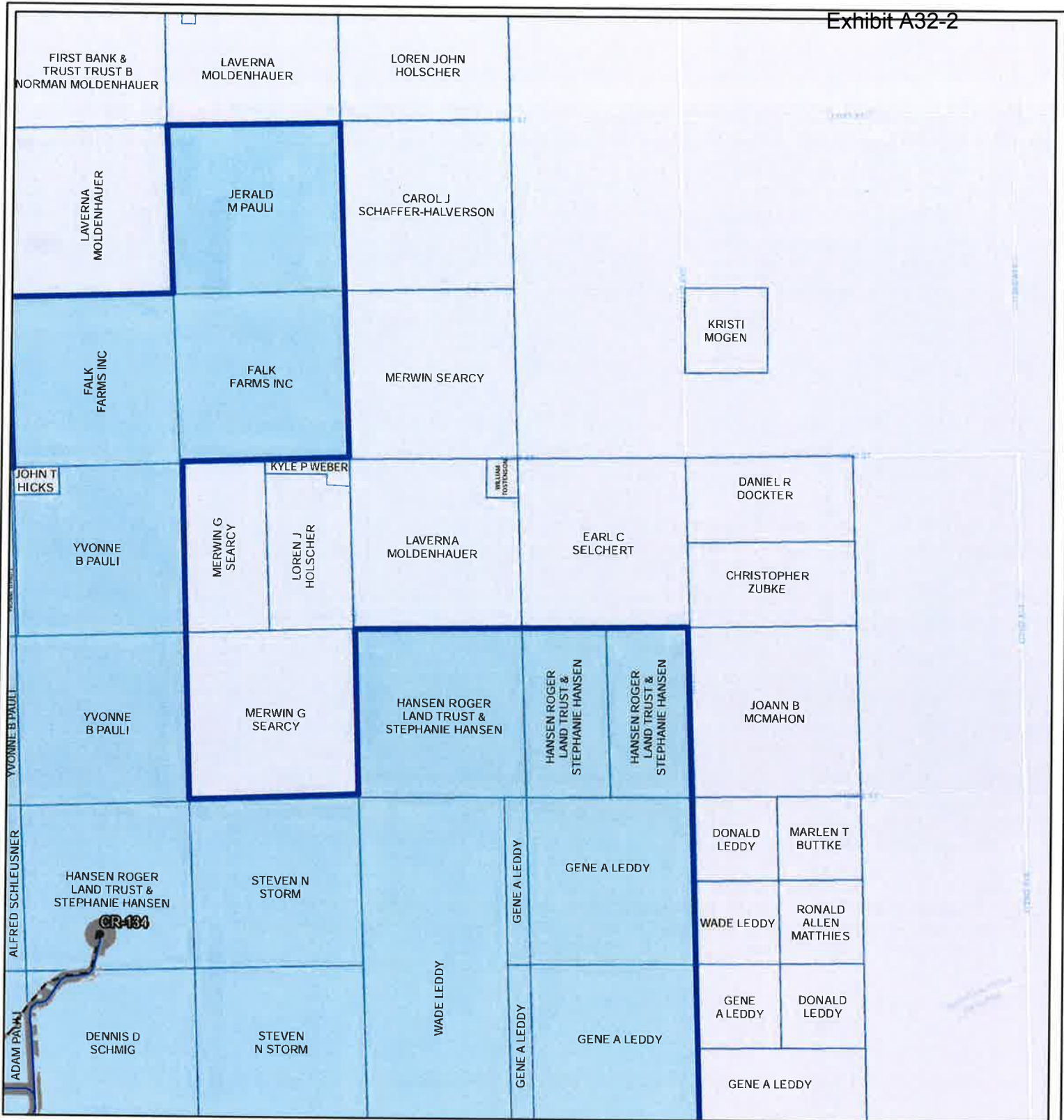
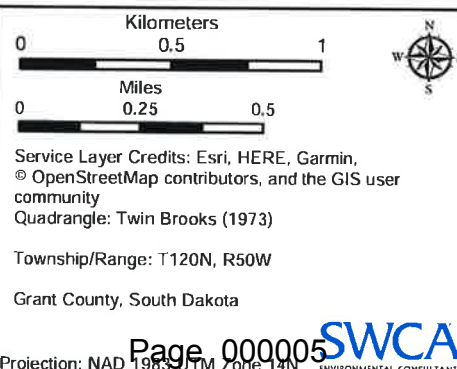
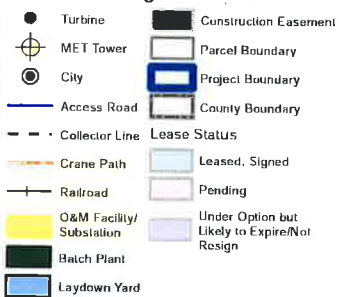


Figure 3a. Project Map  
Crowned Ridge Wind Farm



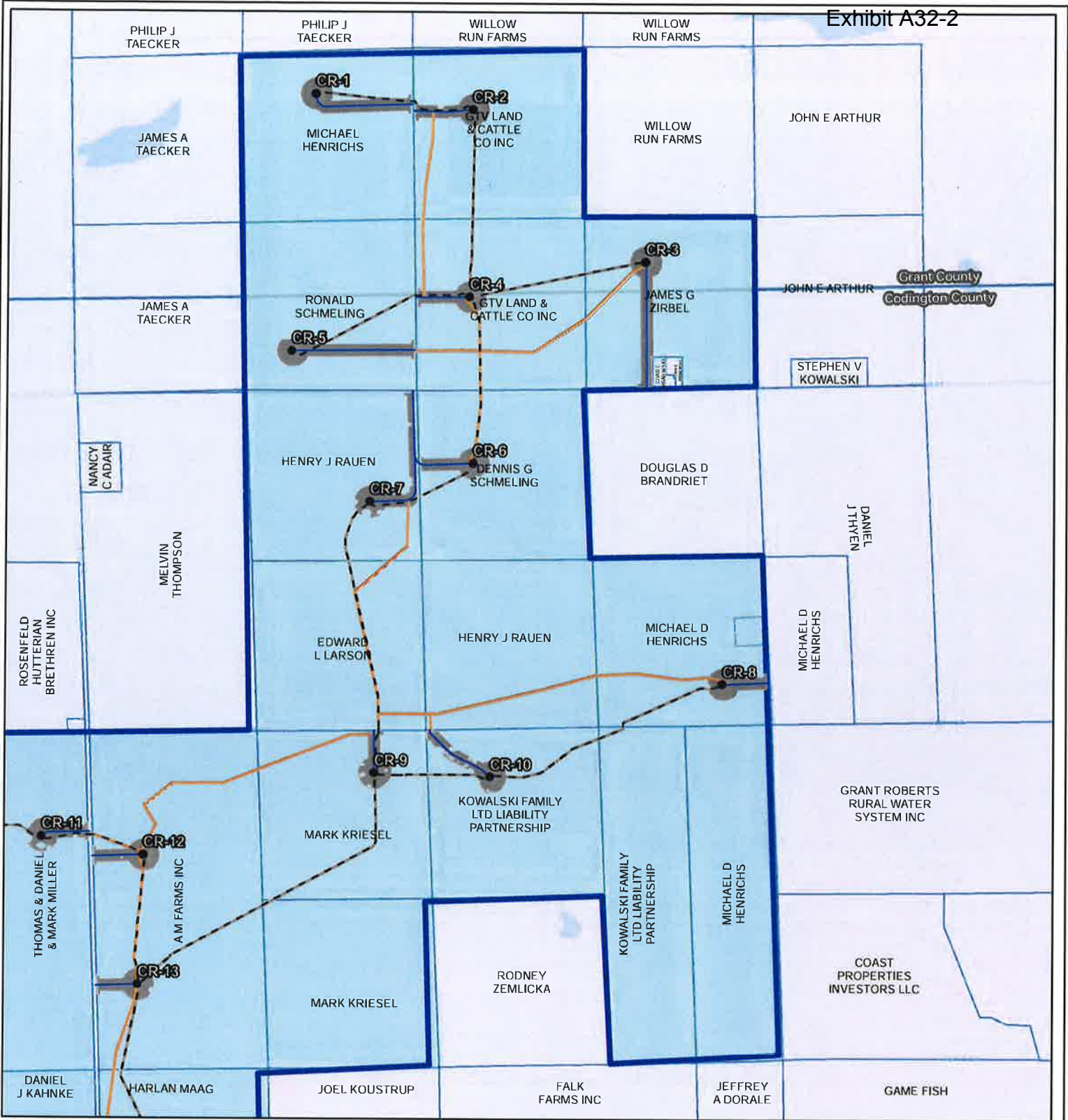
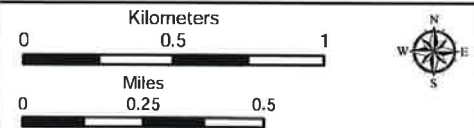


Figure 3a. Project Map  
Crowned Ridge Wind Farm

- Turbine
- ⊕ MFT Tower
- City
- Access Road
- - - Collector Line
- Crane Path
- Railroad
- O&M Facility/ Substation
- Batch Plant
- Laydown Yard
- ▭ Construction Easement
- ▭ Parcel Boundary
- ▭ Project Boundary
- ▭ County Boundary
- ▭ Lease Status
- ▭ Leased, Signed
- ▭ Pending
- ▭ Under Option but Likely to Expire/Not Resign



Service Layer Credits: Esri, HERE, Garmin, © OpenStreetMap contributors, and the GIS user community  
 Quadrangle: Antelope Valley (1973), South Shore (1973)  
 Township/Range: T120N, R51W, T119N, R51W,  
 Codington and Grant Counties, South Dakota

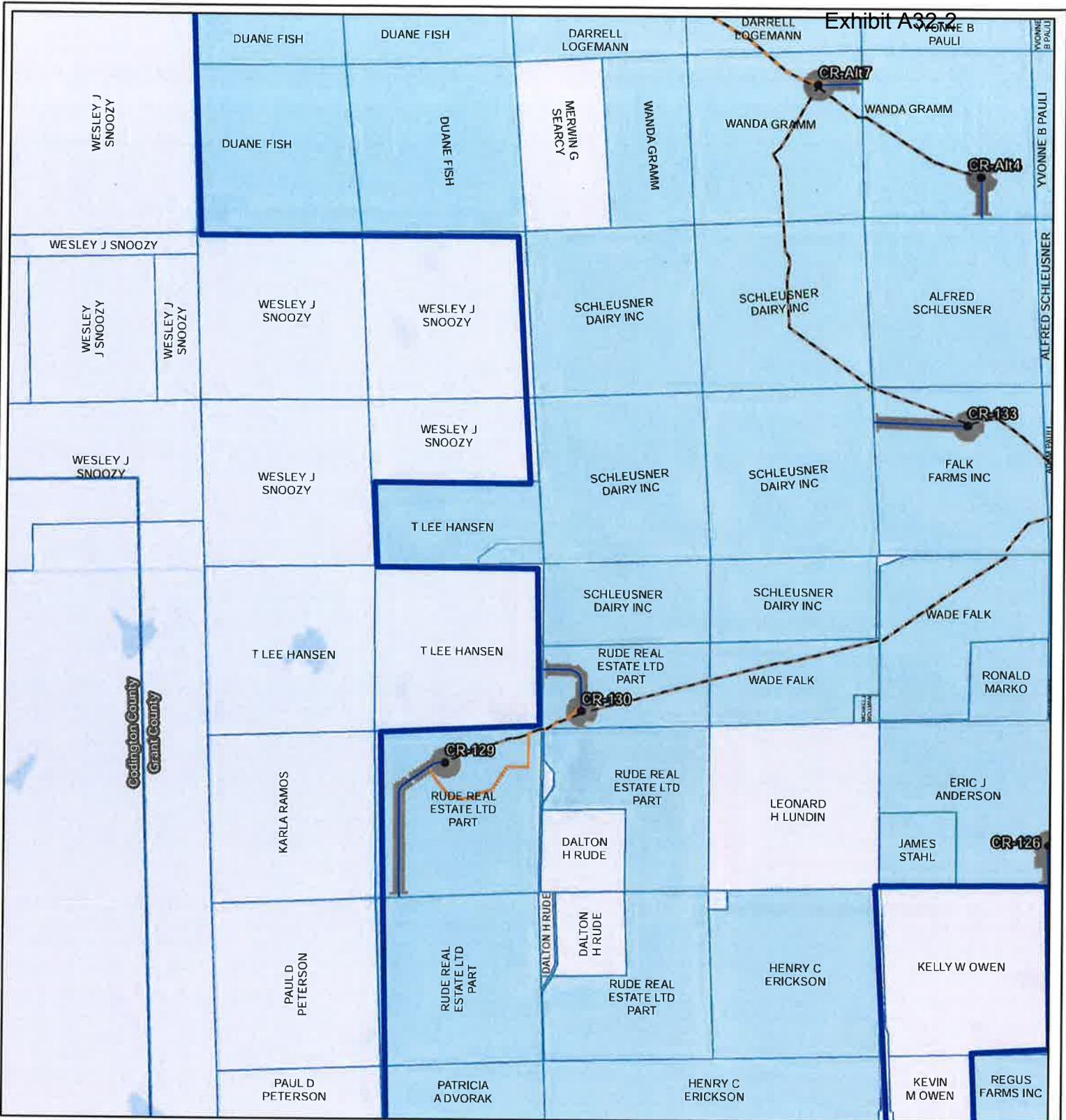
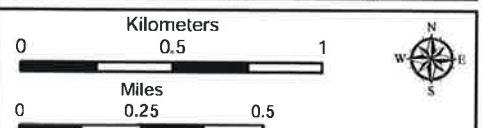
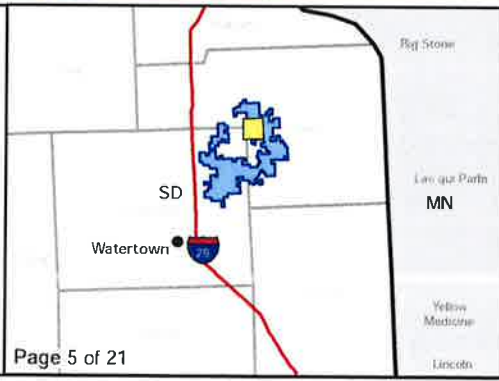


Figure 3a. Project Map  
Crowned Ridge Wind Farm

- Turbine
- ⊕ MET Tower
- City
- Access Road
- - - Collector Line
- Crane Path
- Railroad
- O&M Facility/ Substation
- Batch Plant
- Laydown Yard
- ▭ Construction Easement
- ▭ Parcel Boundary
- ▭ Project Boundary
- ▭ County Boundary
- ▭ Lease Status
- ▭ Leased, Signed
- ▭ Pending
- ▭ Under Option but Likely to Expire/Not Resign



Service Layer Credits: Esri, HERE, Garmin, © OpenStreetMap contributors, and the GIS user community  
 Quadrangle: Antelope Valley (1973), Twin Brooks (1973)  
 Township/Range: T120N, R51W, T120N, R50W, T119N, R51W, T119N, R50W  
 Codington and Grant Counties, South Dakota

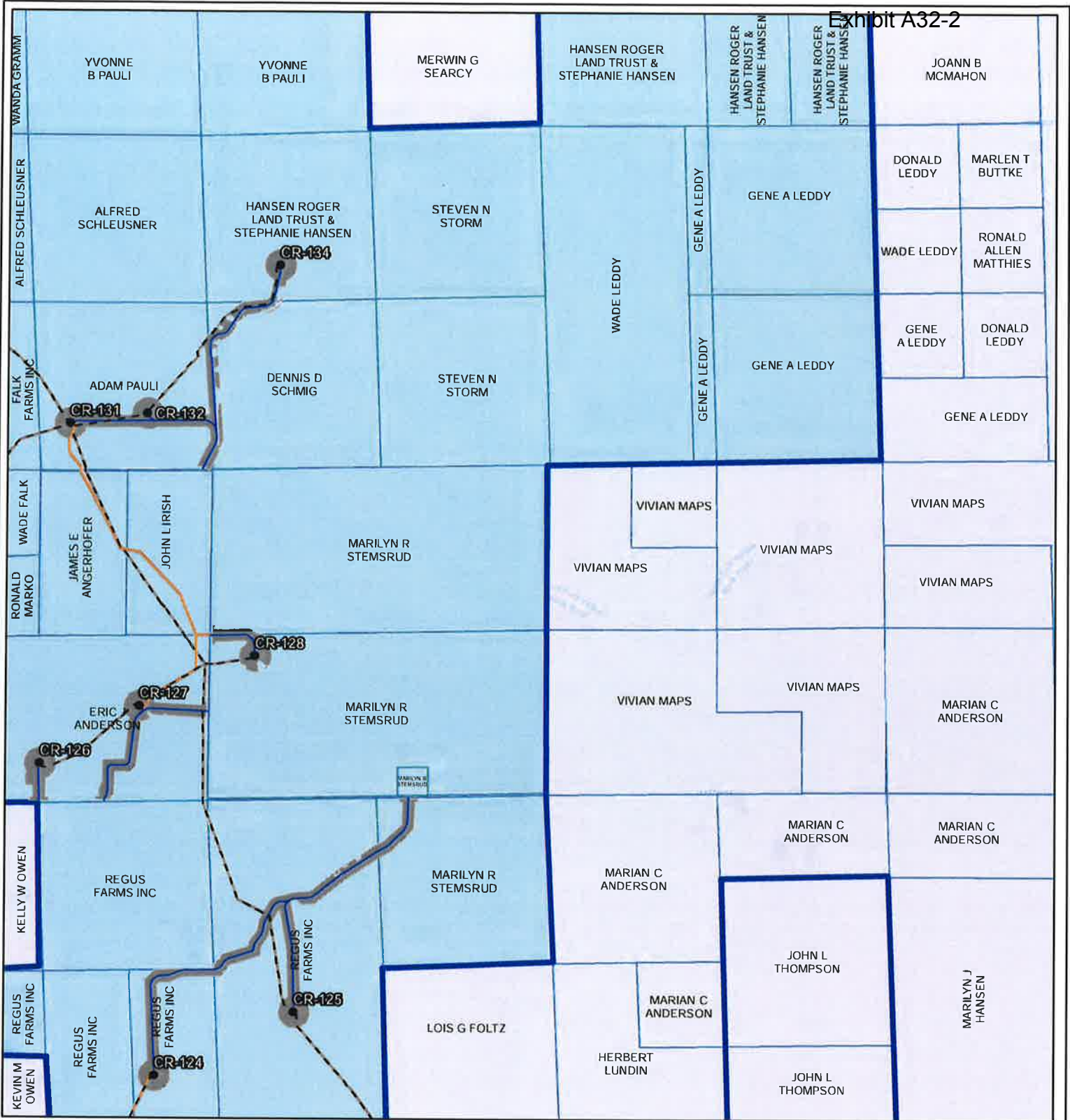
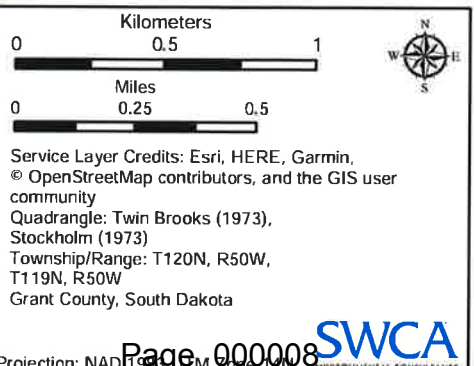
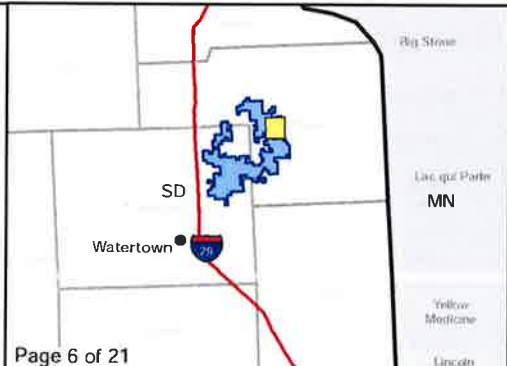
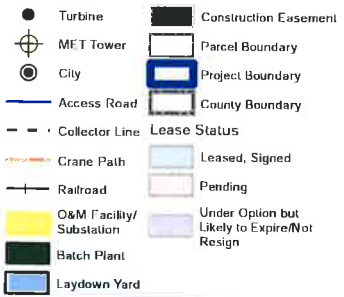


Figure 3a. Project Map  
Crowned Ridge Wind Farm





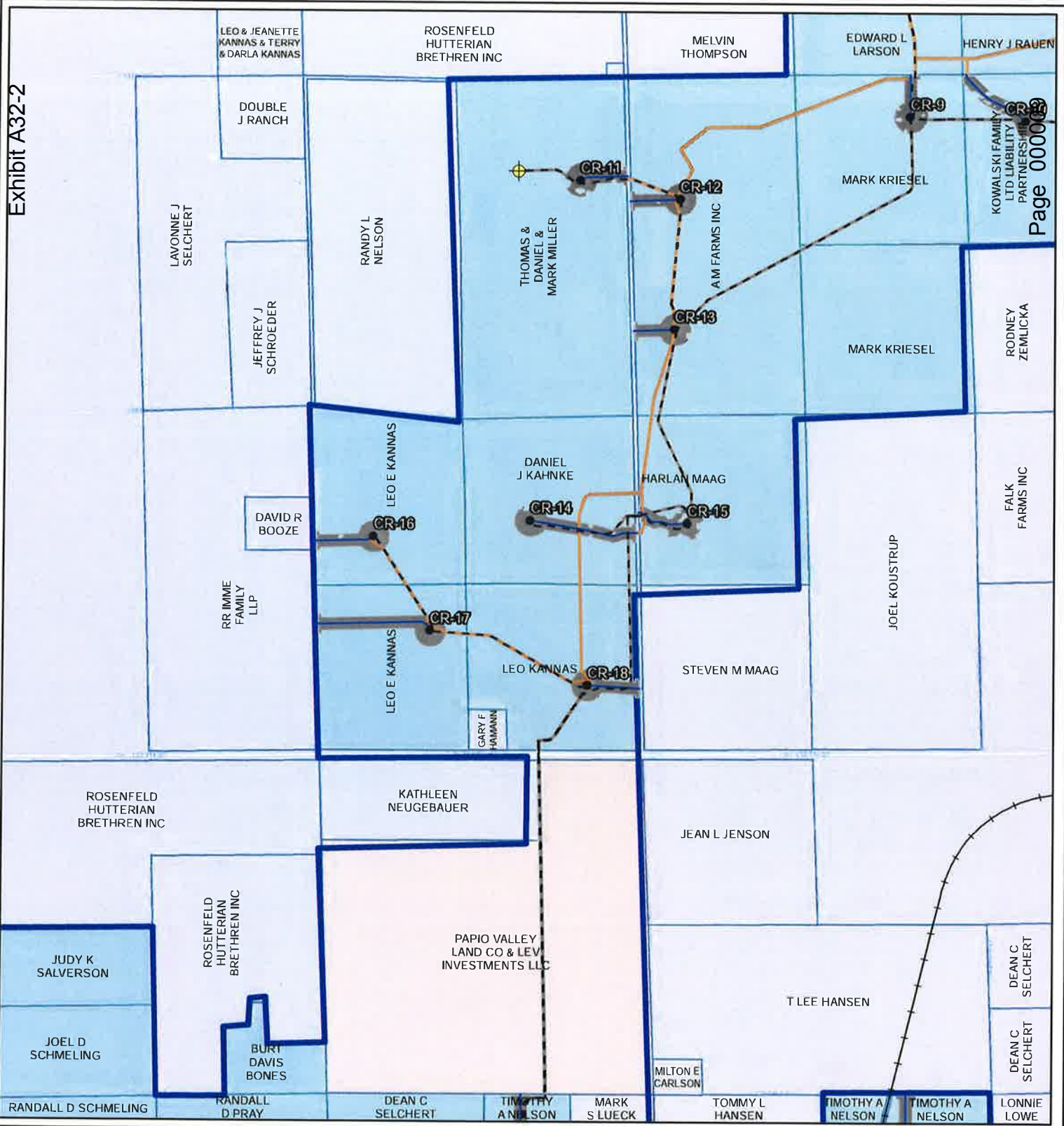
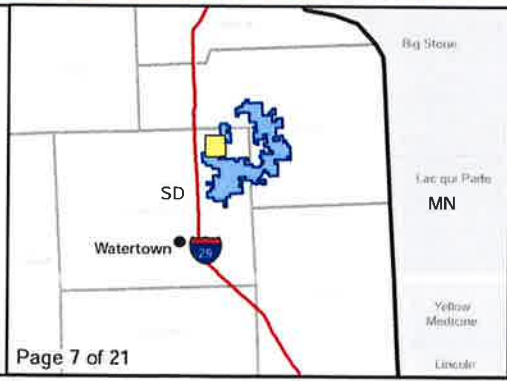


Figure 3a. Project Map  
Crowned Ridge Wind Farm

- Turbine
- MET Tower
- City
- Access Road
- Collector Line
- Crane Path
- Railroad
- O&M Facility/ Substation
- Batch Plant
- Laydown Yard
- Construction Easement
- Parcel Boundary
- Project Boundary
- County Boundary
- Lease Status
- Leased, Signed
- Pending
- Under Option but Likely to Expire/Not Resign



0 0.5 1  
Kilometers

0 0.25 0.5  
Miles

Service Layer Credits: Esri, HERE, Garmin, © OpenStreetMap contributors, and the GIS user community  
 Quadrangle: Still Lake NE (1970), Antelope Valley (1973), Still Lake SE (1970), South Shore (1973)  
 Township/Range: T119N, R52W, T119N, R51W  
 Codington County, South Dakota

Projection: NAD 1983 UTM Zone 14N

**SWCA**  
ENVIRONMENTAL CONSULTANTS

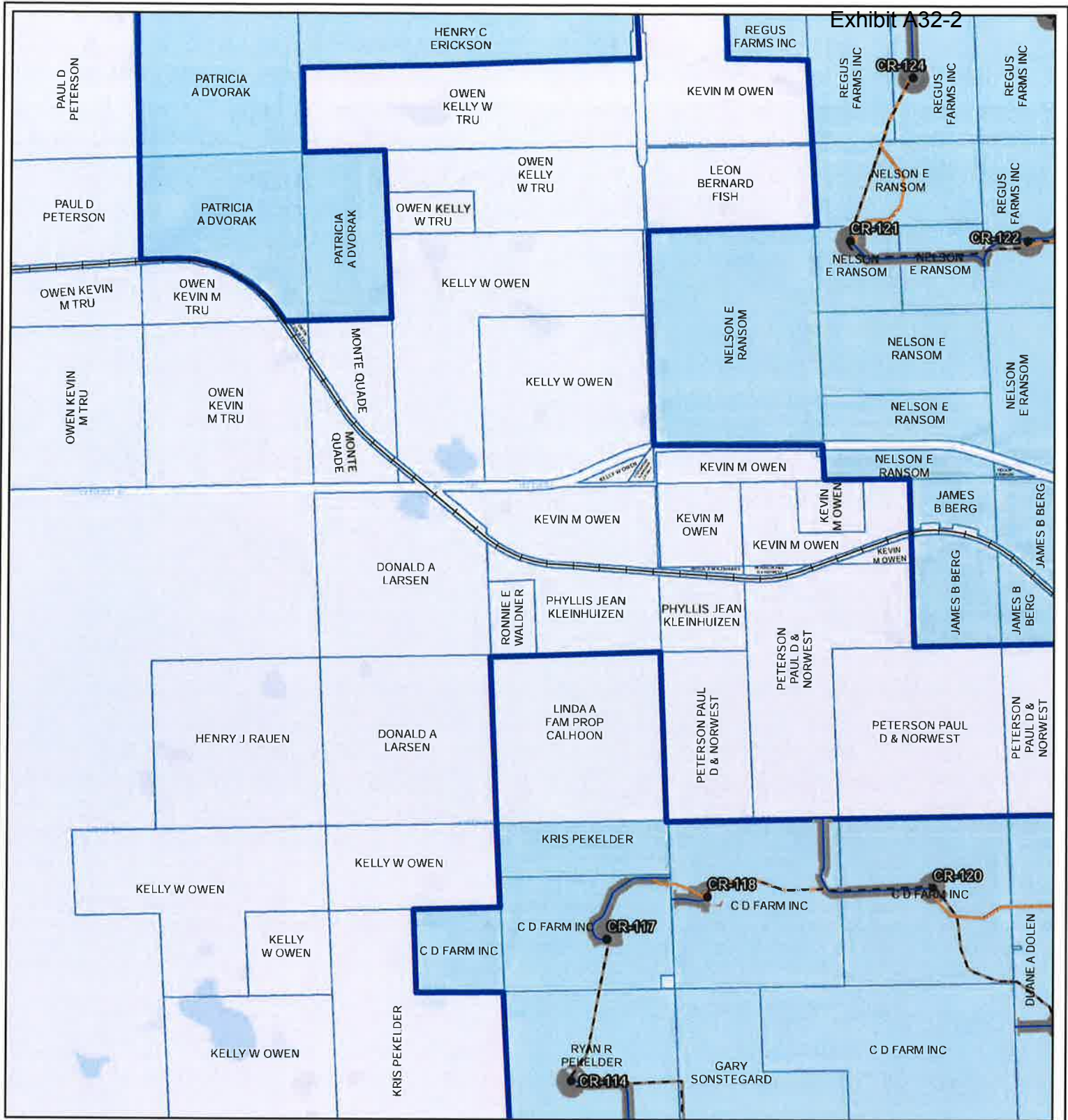
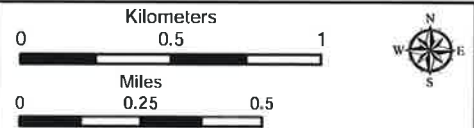
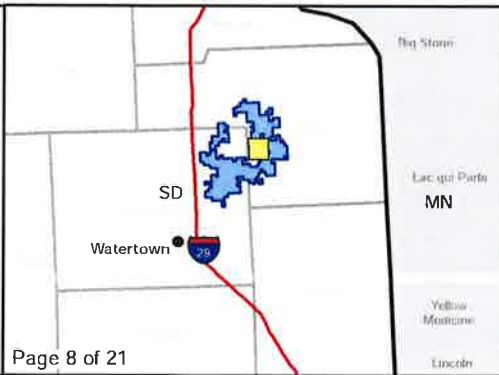


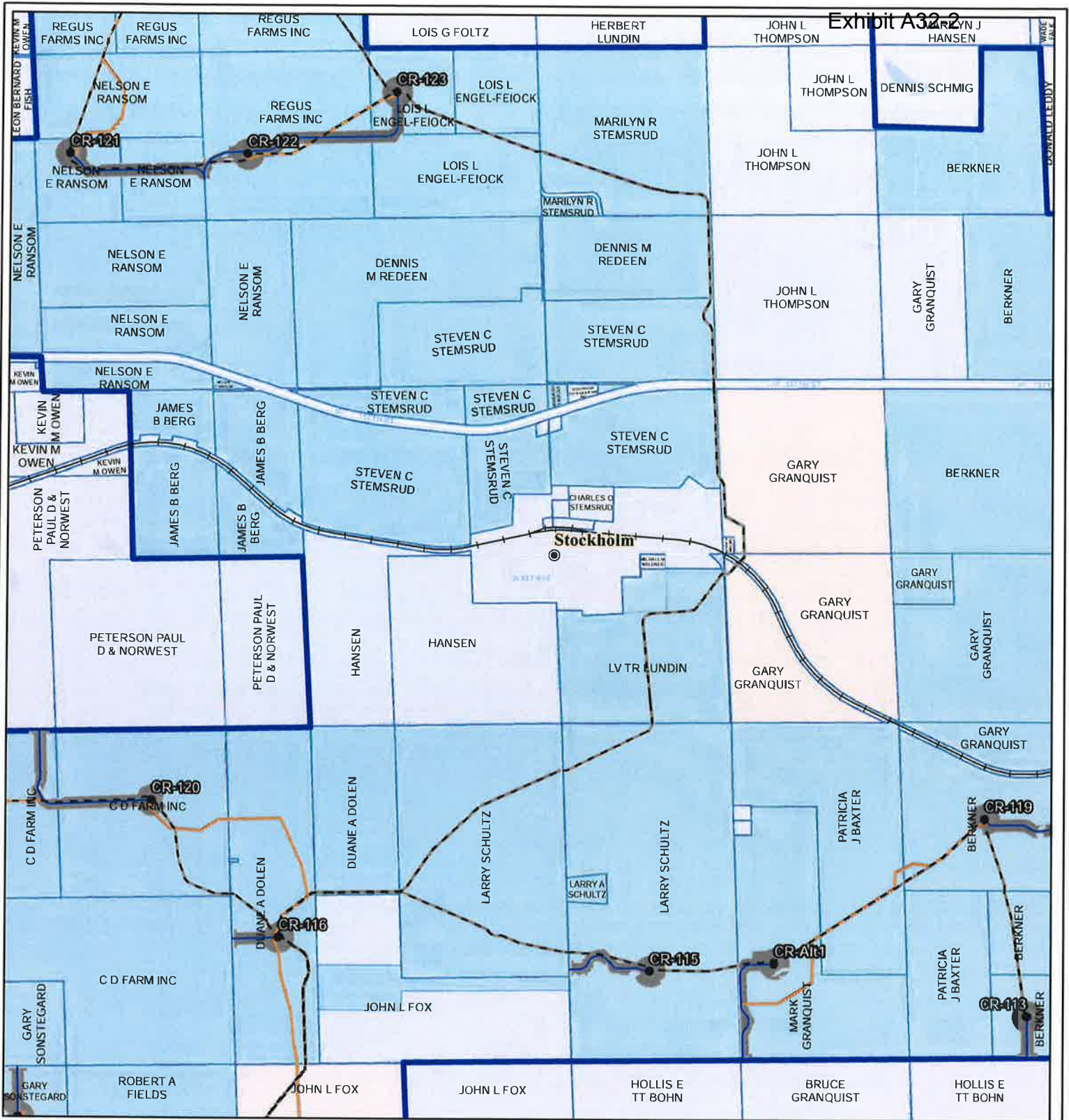
Figure 3a. Project Map  
Crowned Ridge Wind Farm

- Turbine
- ⊕ MET Tower
- ⊙ City
- Access Road
- - - Collector Line
- Crane Path
- Railroad
- O&M Facility/ Substation
- Batch Plant
- Laydown Yard
- Construction Easement
- ▭ Parcel Boundary
- ▭ Project Boundary
- ▭ County Boundary
- - - Lease Status
- Leased, Signed
- Pending
- Under Option but Likely to Expire/Not Resign



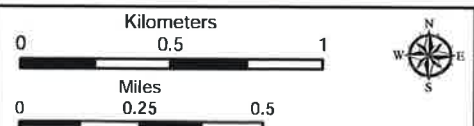
Service Layer Credits: Esri, HERE, Garmin, © OpenStreetMap contributors, and the GIS user community  
 Quadrangle: Stockholm (1973), Antelope Valley (1973), Twin Brooks (1973), South Shore (1973)  
 Township/Range: T119N, R50W

Grant County, South Dakota



**Figure 3a. Project Map**  
Crowned Ridge Wind Farm

- Turbine
- Construction Easement
- MET Tower
- Parcel Boundary
- City
- Project Boundary
- Access Road
- County Boundary
- Collector Line
- Lease Status
- Crane Path
- Leased, Signed
- Railroad
- Pending
- O&M Facility/ Substation
- Under Option but Likely to Expire/Not Resign
- Batch Plant
- Laydown Yard



Service Layer Credits: Esri, HERE, Garmin, © OpenStreetMap contributors, and the GIS user community  
 Quadrangle: Stockholm (1973)

Township/Range: T119N, R50W  
 Grant County, South Dakota

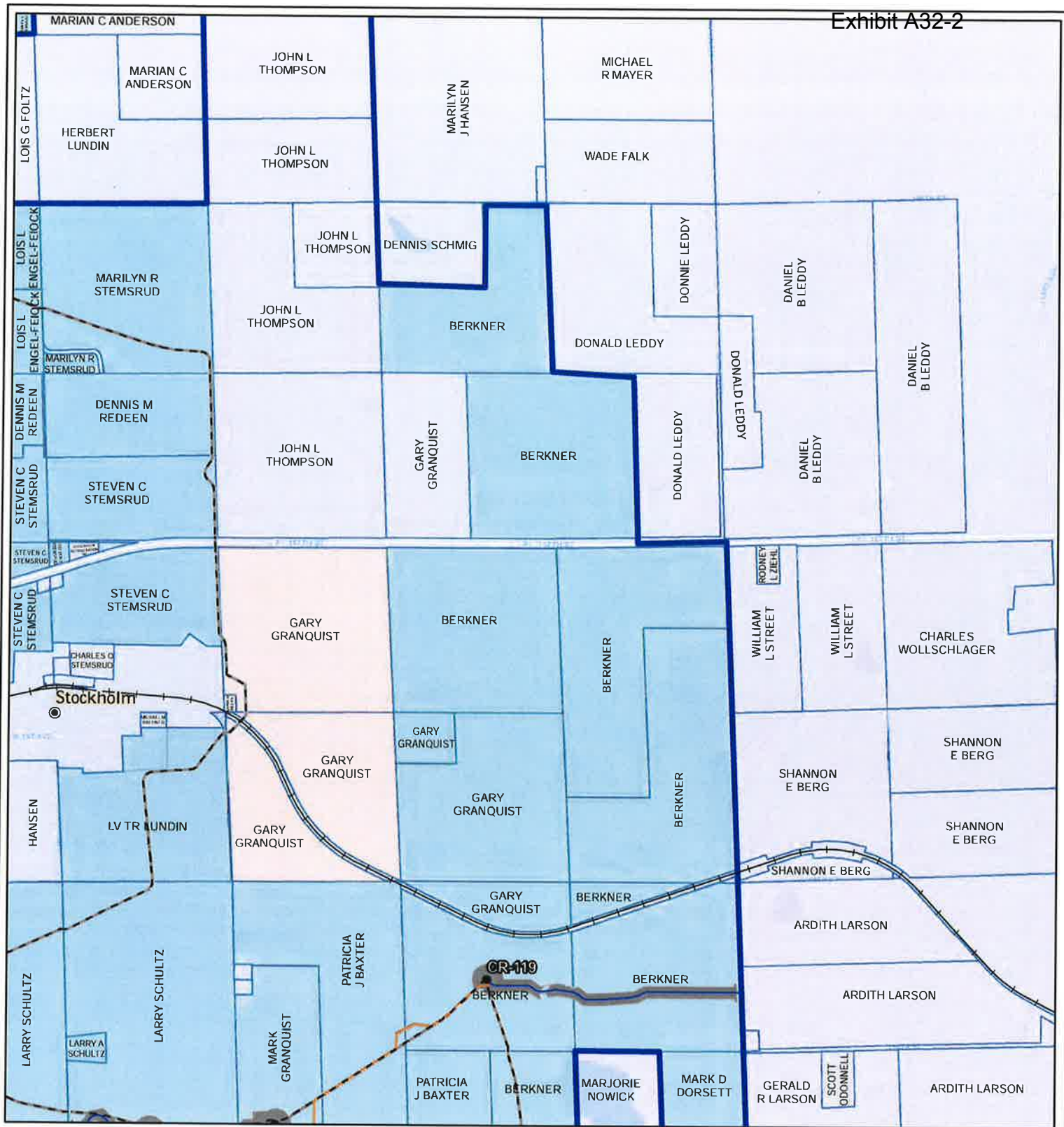
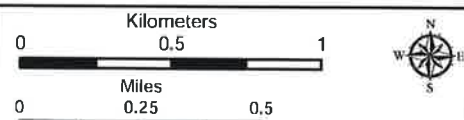


Figure 3a. Project Map  
Crowned Ridge Wind Farm

- Turbine
- MET Tower
- City
- Access Road
- Collector Line
- Crane Path
- Railroad
- O&M Facility/ Substation
- Batch Plant
- Laydown Yard
- Construction Easement
- Parcel Boundary
- Project Boundary
- County Boundary
- Lease Status
- Leased, Signed
- Pending
- Under Option but Likely to Expire/Not Resign



Service Layer Credits: Esri, HERE, Garmin, © OpenStreetMap contributors, and the GIS user community  
 Quadrangle: Twin Brooks (1973), Stockholm (1973)  
 Township/Range: T119N, R50W, T119N, R49W  
 Grant County, South Dakota

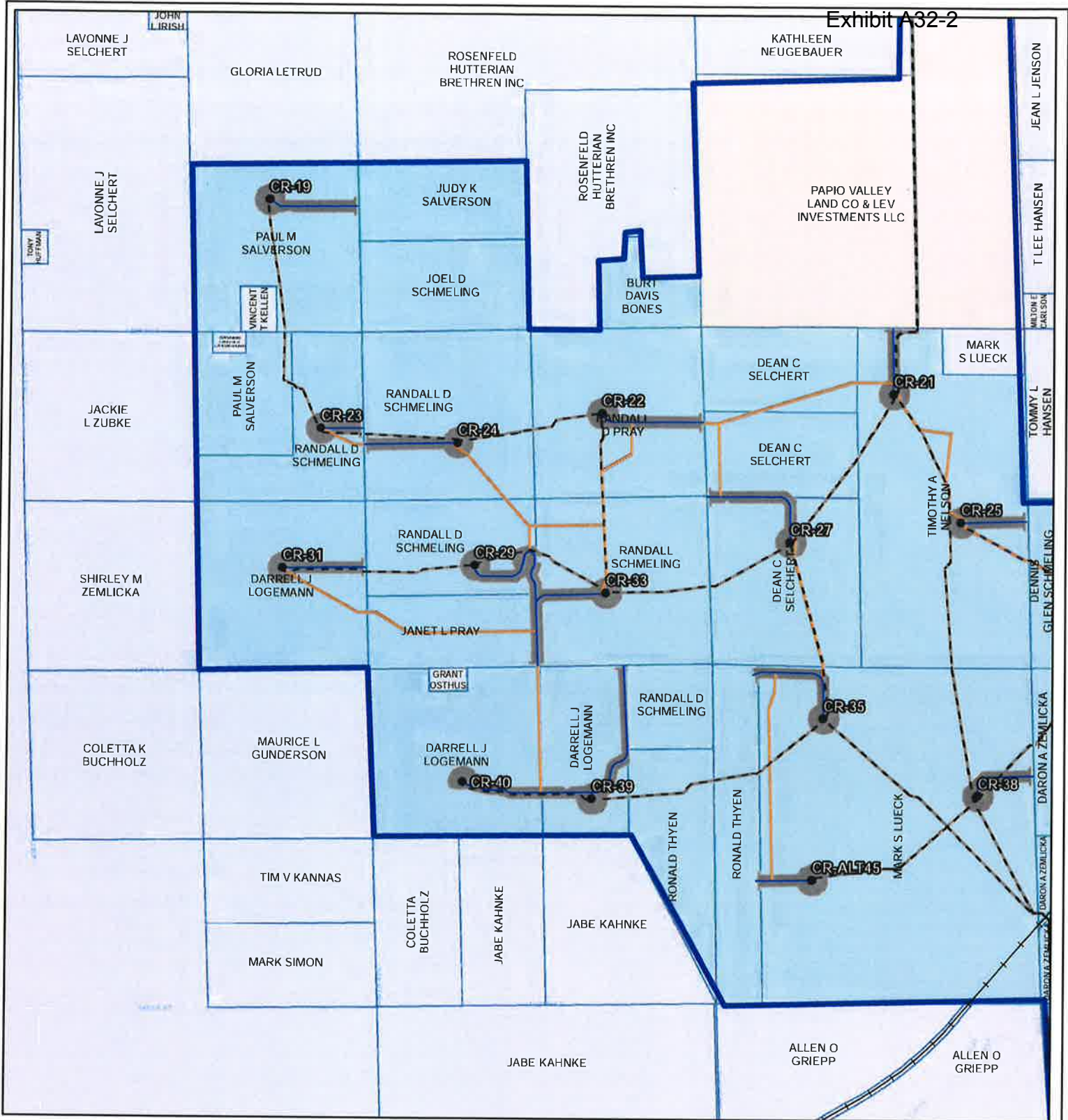
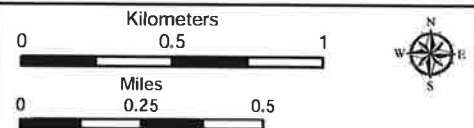


Figure 3a. Project Map  
Crowned Ridge Wind Farm

- Turbine
- ⊕ MET Tower
- City
- Access Road
- - - Collector Line
- Crane Path
- Railroad
- O&M Facility/  
Substation
- Batch Plant
- Laydown Yard
- Construction Easement
- ▭ Parcel Boundary
- ▭ Project Boundary
- ▭ County Boundary
- Lease Status
- Leased, Signed
- Pending
- Under Option but  
Likely to Expire/Not  
Resign



Service Layer Credits: Esri, HERE, Garmin,  
© OpenStreetMap contributors, and the GIS user  
community  
Quadrangle: Still Lake SE (1970),  
South Shore (1973)  
Township/Range: T119N, R52W, T119N, R51W,  
T118N, R52W, T118N, R51W  
Codington County, South Dakota

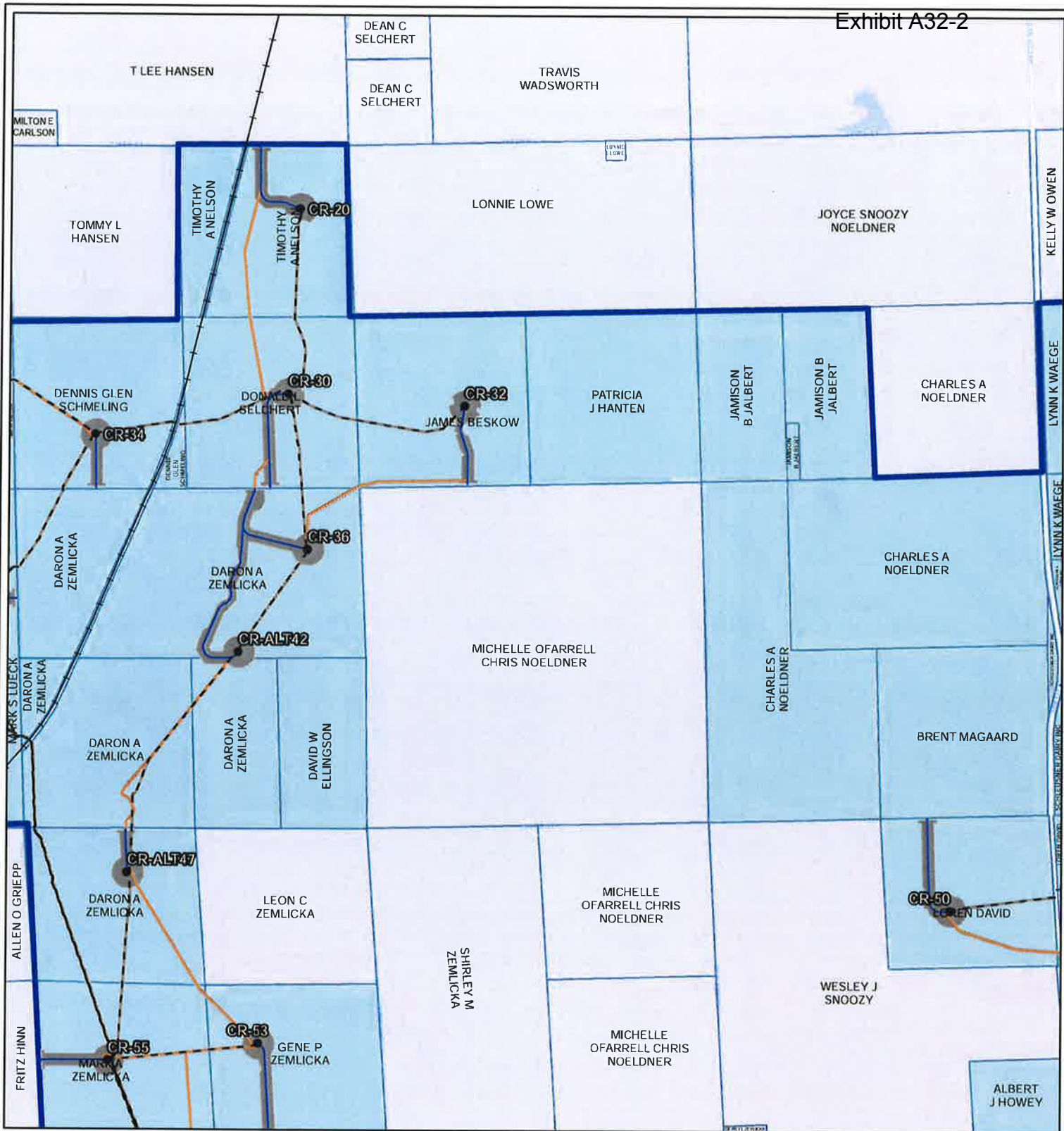
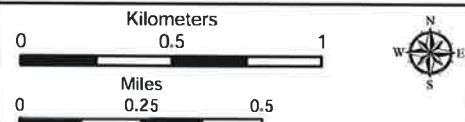
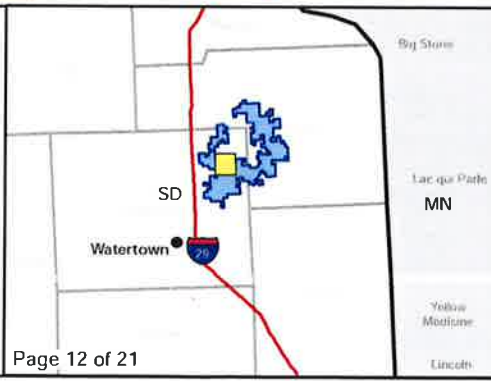


Figure 3a. Project Map  
Crowned Ridge Wind Farm

- Turbine
- ⊕ MET Tower
- City
- Access Road
- - - Collector Line
- Crane Path
- Railroad
- O&M Facility/ Substation
- Batch Plant
- Laydown Yard
- Construction Easement
- ▭ Parcel Boundary
- ▭ Project Boundary
- ▭ County Boundary
- - - Lease Status
- Leased, Signed
- Pending
- Under Option but Likely to Expire/Not Resign



Service Layer Credits: Esri, HERE, Garmin, © OpenStreetMap contributors, and the GIS user community  
 Quadrangle: South Shore (1973)  
 Township/Range: T119N, R51W, T118N, R51W  
 Codrington County, South Dakota

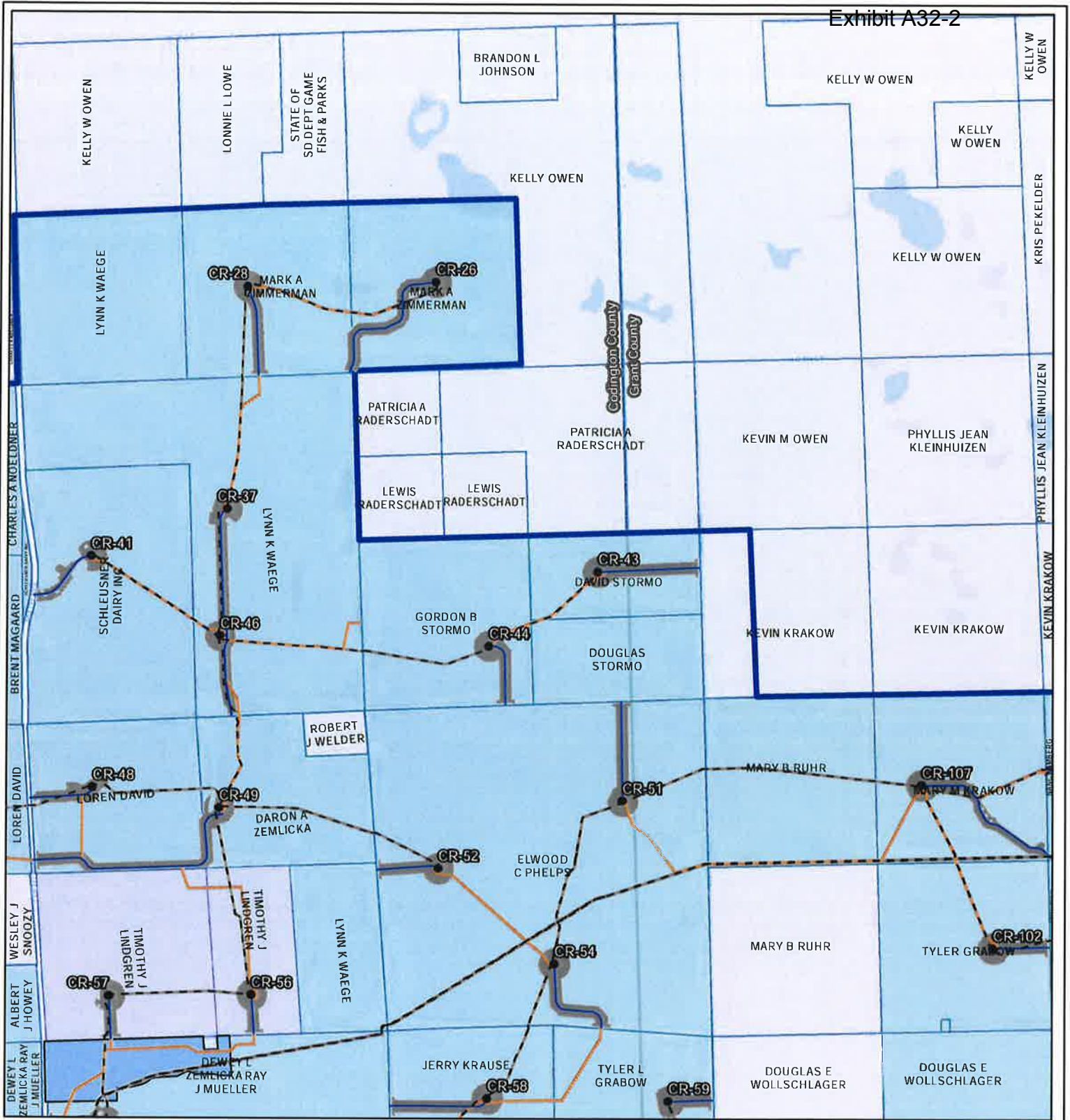
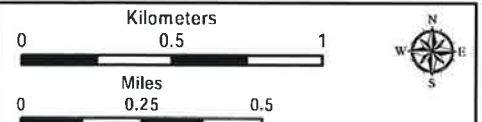
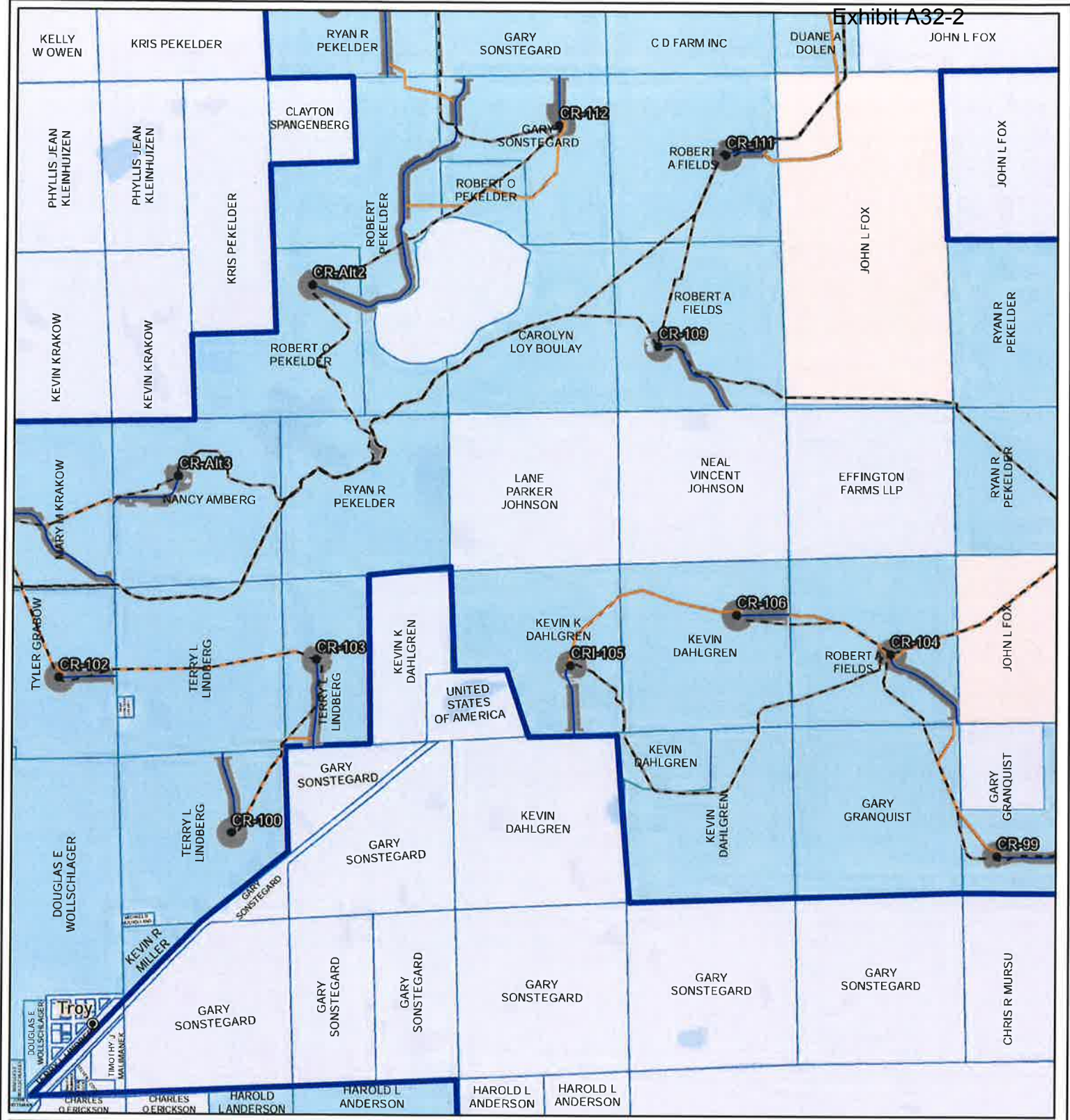


Figure 3a. Project Map  
Crowned Ridge Wind Farm

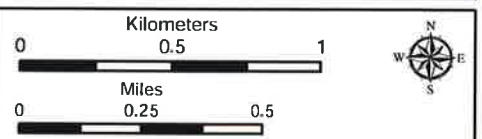
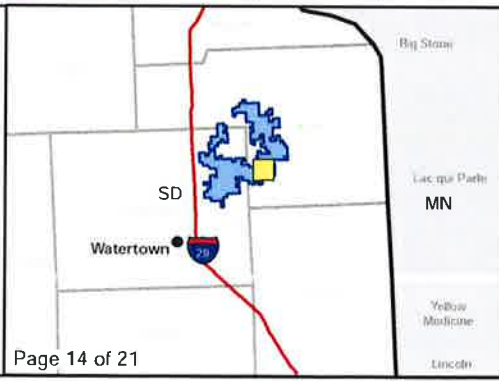
- Turbine
- ⊕ MET Tower
- City
- Access Road
- - - Collector Line
- Crane Path
- Railroad
- O&M Facility/  
Sub Station
- Batch Plant
- Laydown Yard
- ▬ Construction Easement
- ▬ Parcel Boundary
- ▬ Project Boundary
- ▬ County Boundary
- ▬ Lease Status
- ▬ Leased, Signed
- ▬ Pending
- ▬ Under Option but  
Likely to Expire/Not  
Resign



Service Layer Credits: Esri, HERE, Garmin,  
© OpenStreetMap contributors, and the GIS user  
community  
Quadrangle: South Shore (1973),  
Stockholm (1973)  
Township/Range: T119N, R51W, T119N, R50W,  
T118N, R51W, T118N, R50W  
Codrington and Grant Counties, South Dakota



**Figure 3a. Project Map**  
Crowned Ridge Wind Farm



Service Layer Credits: Esri, HERE, Garmin, © OpenStreetMap contributors, and the GIS user community  
 Quadrangle: Stockholm (1973)  
 Township/Range: T119N, R50W, T118N, R50W  
 Grant County, South Dakota  
 Projection: NAD 1983 UTM Zone 14N



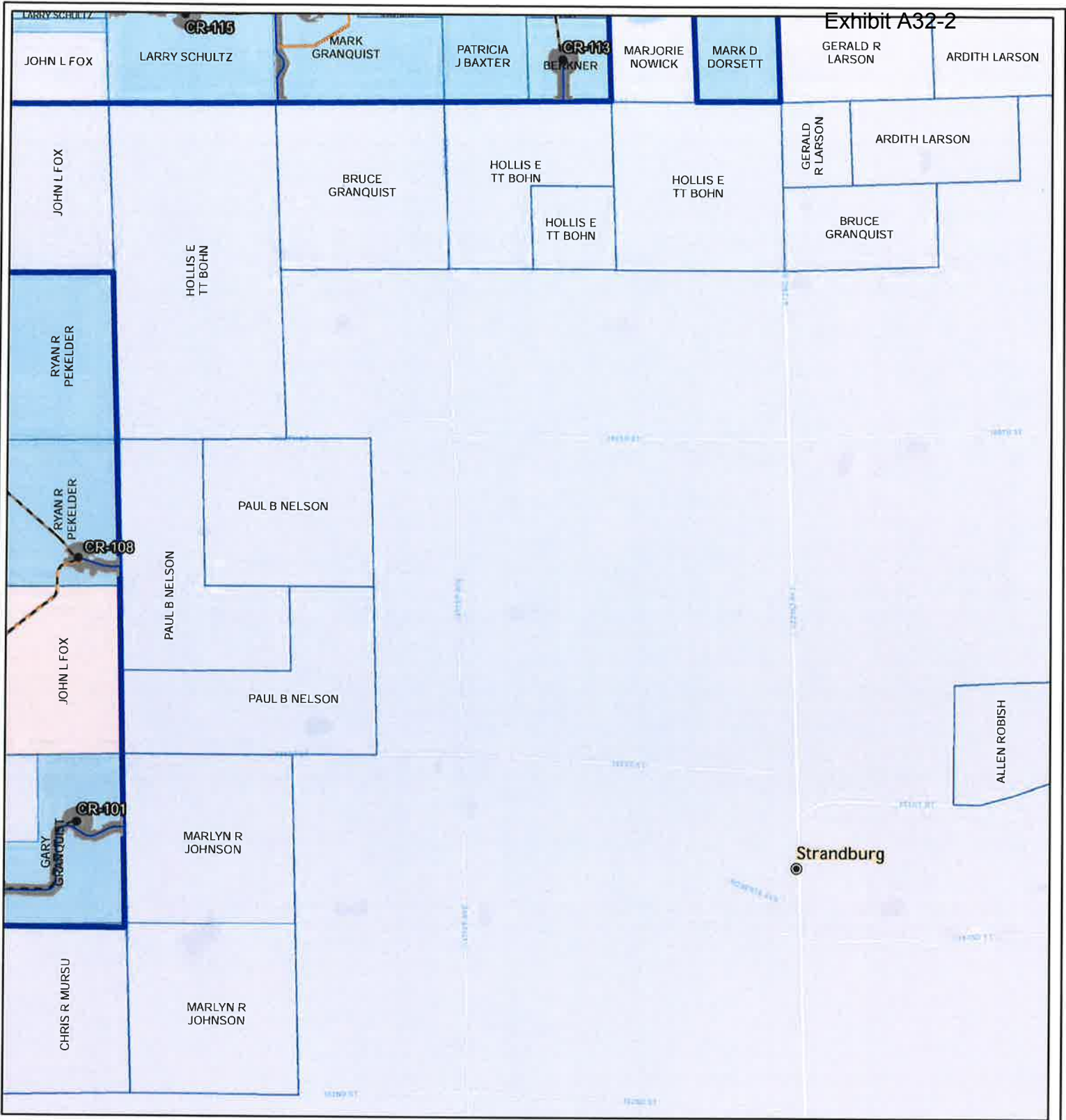
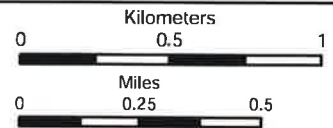
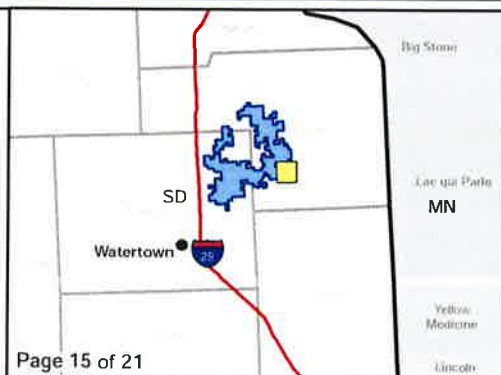


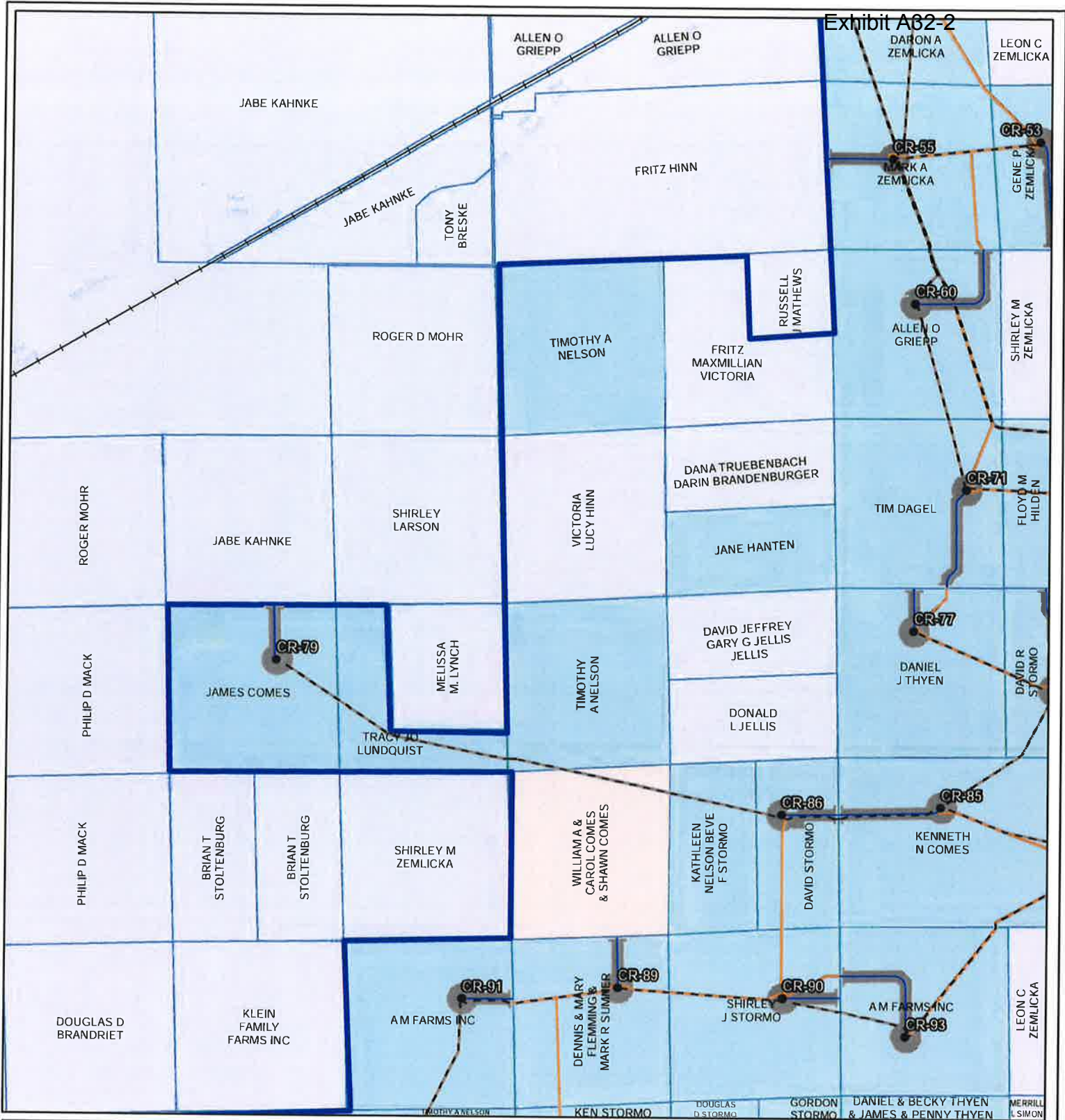
Figure 3a. Project Map  
Crowned Ridge Wind Farm

- Turbine
- ⊕ MET Tower
- City
- Access Road
- - - Collector Line
- Crane Path
- Railroad
- O&M Facility/ Substation
- Batch Plant
- Laydown Yard
- ▭ Construction Easement
- ▭ Parcel Boundary
- ▭ Project Boundary
- ▭ County Boundary
- ▭ Lease Status
- ▭ Leased, Signed
- ▭ Pending
- ▭ Under Option but Likely to Expire/Not Resign



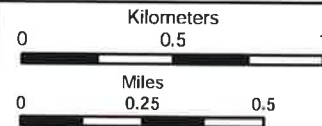
Service Layer Credits: Esri, HERE, Garmin, © OpenStreetMap contributors, and the GIS user community  
 Quadrangle: Stockholm (1973)

Township/Range: T119N, R50W,  
 T118N, R50W  
 Grant County, South Dakota



**Figure 3a. Project Map**  
Crowned Ridge Wind Farm

- Turbine
- ⊕ MET Tower
- ⊙ City
- Access Road
- - - Collector Line
- Crane Path
- Railroad
- O&M Facility/ Substation
- Batch Plant
- Laydown Yard
- ▭ Construction Easement
- ▭ Parcel Boundary
- ▭ Project Boundary
- ▭ County Boundary
- Lease Status
- ▭ Leased, Signed
- ▭ Pending
- ▭ Under Option but Likely to Expire/Not Resign



Service Layer Credits: Esri, HERE, Garmin, © OpenStreetMap contributors, and the GIS user community  
 Quadrangle: Still Lake SE (1970), South Shore (1973)  
 Township/Range: T118N, R52W, T118N, R51W  
 Codrington County, South Dakota

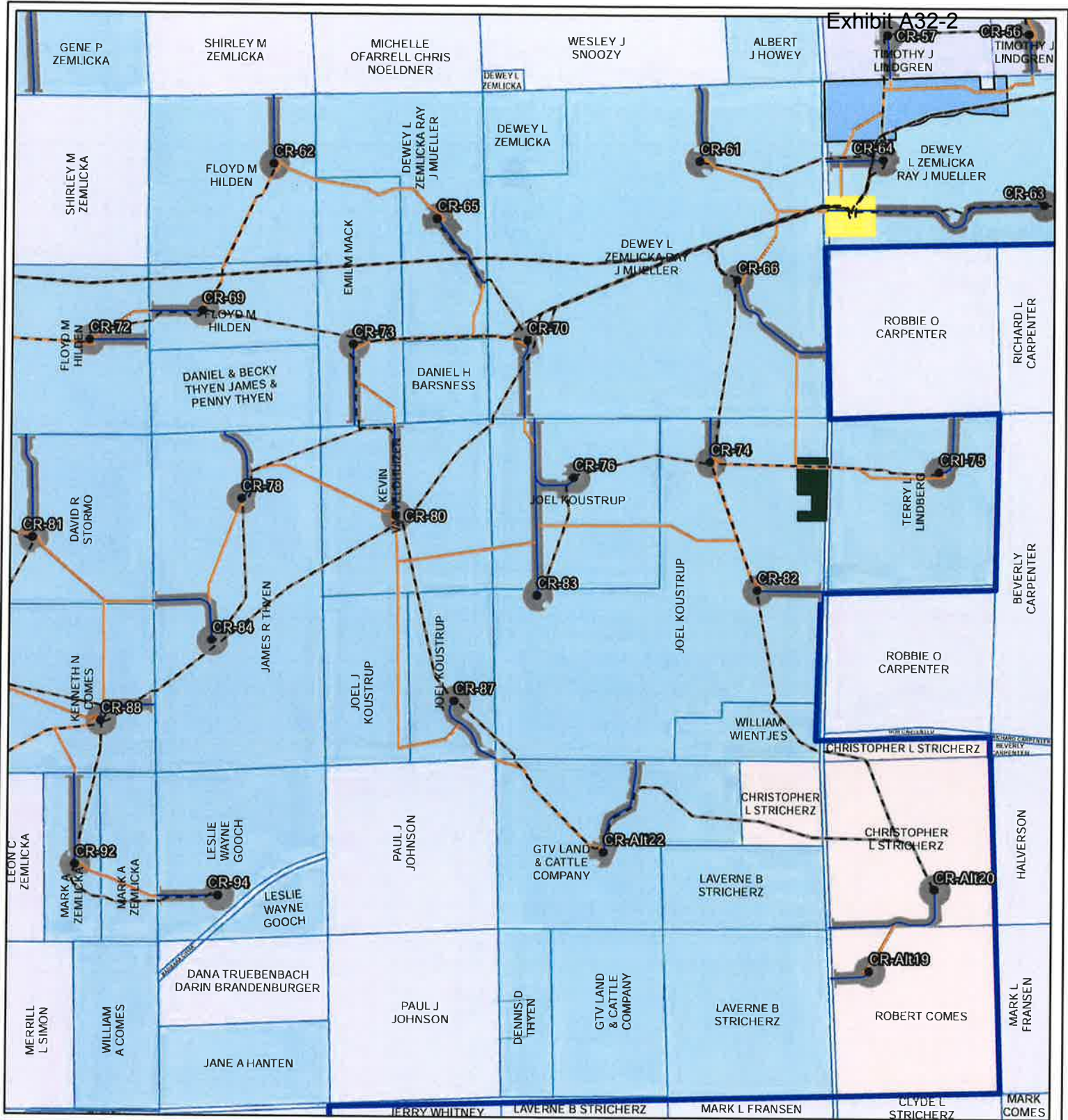
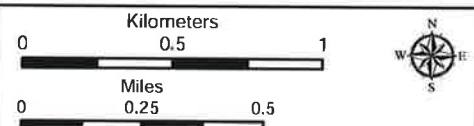


Figure 3a. Project Map  
Crowned Ridge Wind Farm

- Turbine
- ⊕ MET Tower
- ⊙ City
- Access Road
- - - Collector Line
- Crane Path
- Railroad
- O&M Facility/ Substation
- Batch Plant
- Laydown Yard
- Construction Easement
- ▭ Parcel Boundary
- ▭ Project Boundary
- ▭ County Boundary
- ▭ Lease Status
- ▭ Leased, Signed
- ▭ Pending
- ▭ Under Option but Likely to Expire/Not Resign



Service Layer Credits: Esri, HERE, Garmin, © OpenStreetMap contributors, and the GIS user community  
 Quadrangle: South Shore (1973)  
 Township/Range: T118N, R51W  
 Codington County, South Dakota

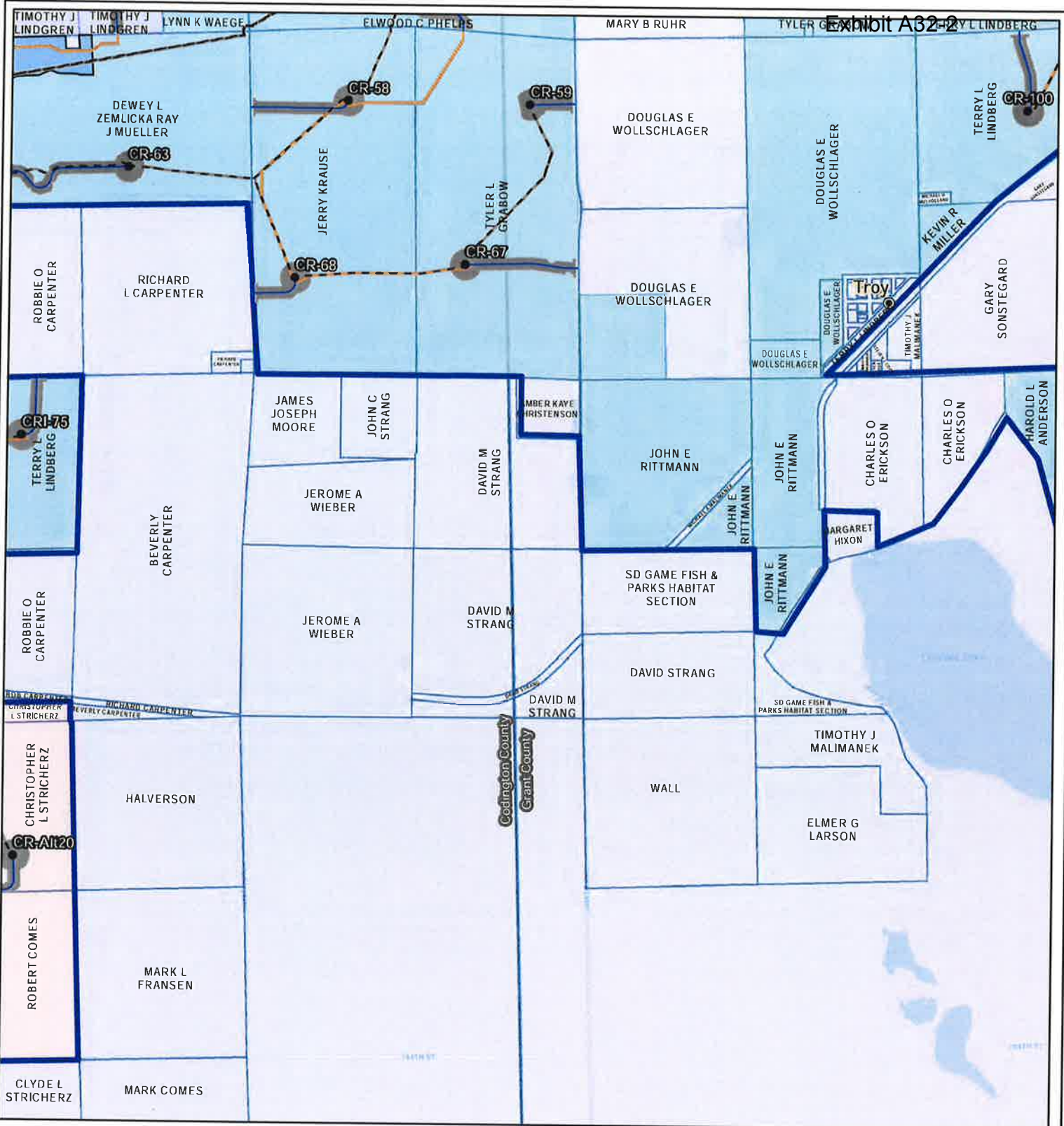


Figure 3a. Project Map  
Crowned Ridge Wind Farm

- Turbine
- MET Tower
- City
- Access Road
- Collector Line
- Crane Path
- Railroad
- O&M Facility/  
Substation
- Batch Plant
- Laydown Yard
- Construction Easement
- Parcel Boundary
- Project Boundary
- County Boundary
- Lease Status
- Leased, Signed
- Pending
- Under Option but  
Likely to Expire/Not  
Resign



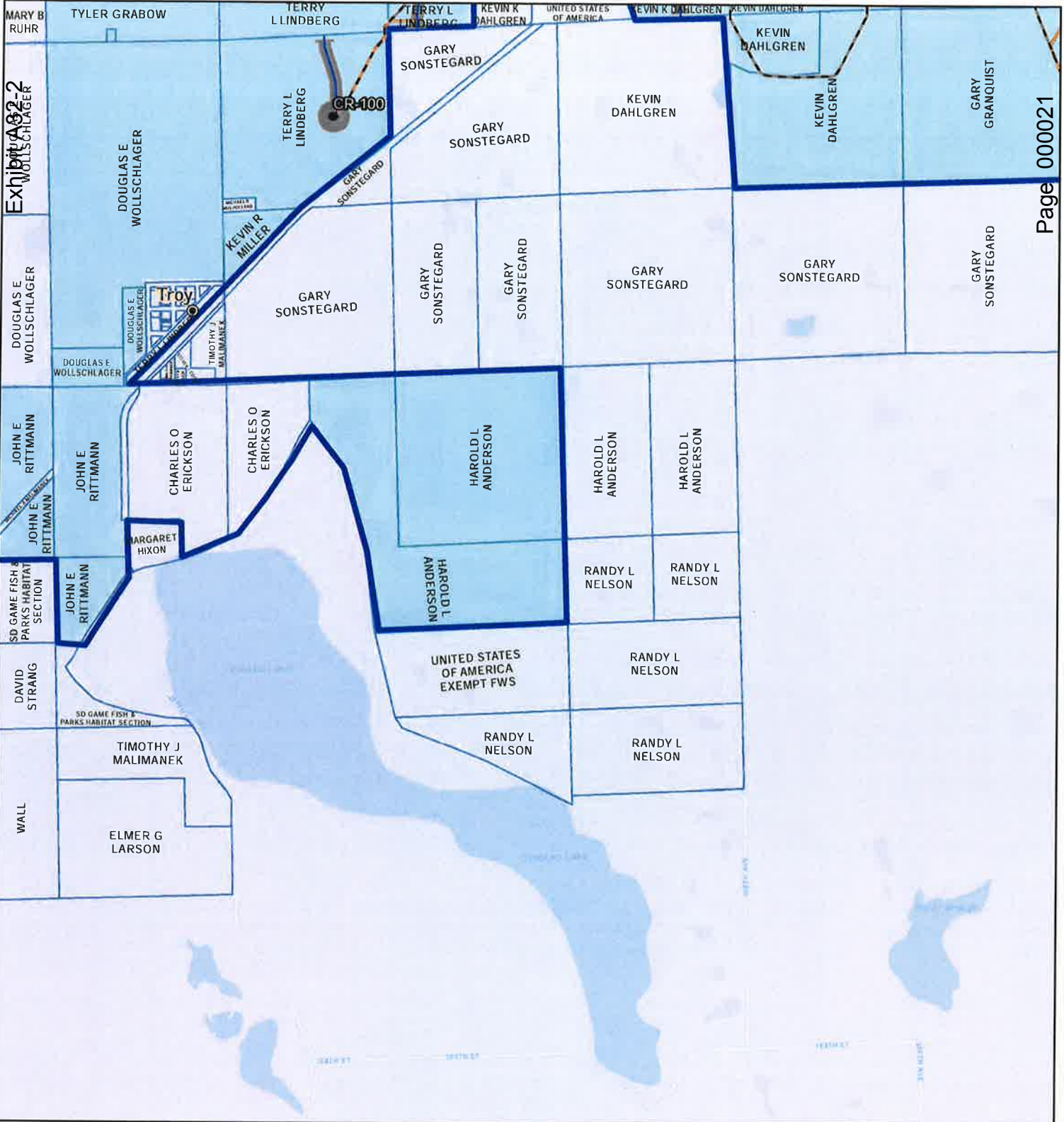
0 0.5 1  
Kilometers

0 0.25 0.5  
Miles

Service Layer Credits: Esri, HERE, Garmin,  
© OpenStreetMap contributors, and the GIS user  
community  
Quadrangle: South Shore (1973),  
Stockholm (1973)  
Township/Range: T118N, R51W,  
T118N, R50W  
Codington and Grant Counties, South Dakota

Projection: NAD 1983 UTM Zone 14N

SWCA  
ENVIRONMENTAL CONSULTANTS



**Figure 3a. Project Map**  
Crowned Ridge Wind Farm

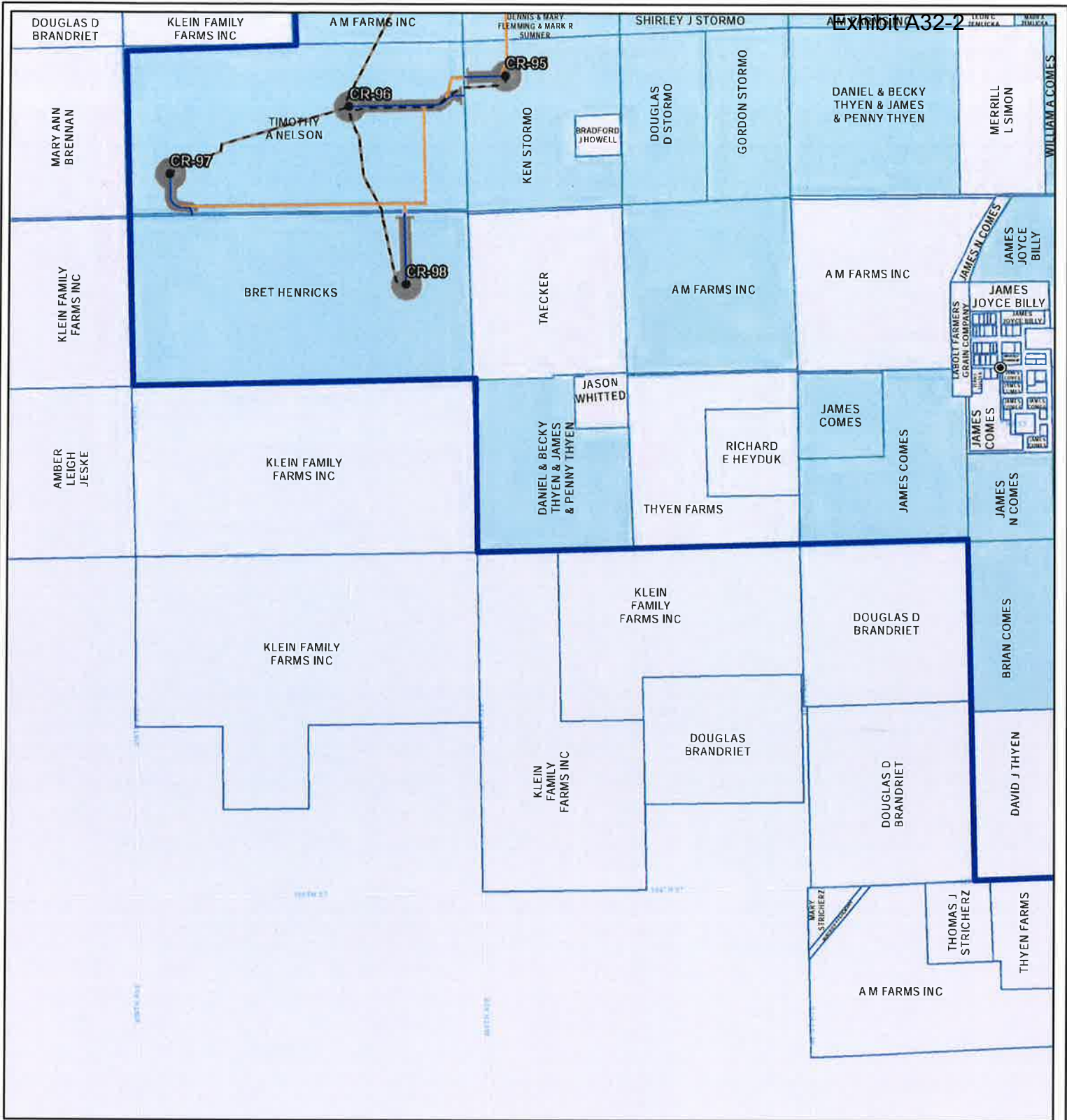
- Turbine
- MET Tower
- City
- Access Road
- Collector Line
- Crane Path
- Railroad
- O&M Facility/  
Substation
- Batch Plant
- Laydown Yard
- Construction Easement
- Parcel Boundary
- Project Boundary
- County Boundary
- Lease Status**
- Leased, Signed
- Pending
- Under Option but  
Likely to Expire/Not  
Resign



0 0.5 1  
 Kilometers  
 0 0.25 0.5  
 Miles

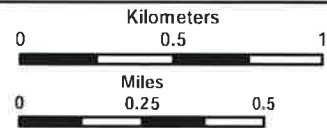
Service Layer Credits: Esri, HERE, Garmin,  
 © OpenStreetMap contributors, and the GIS user  
 community  
 Quadrangle: South Shore (1973),  
 Stockholm (1973)  
 Township/Range: T118N, R50W  
 Grant County, South Dakota

Projection: NAD 1983 UTM Zone 14N

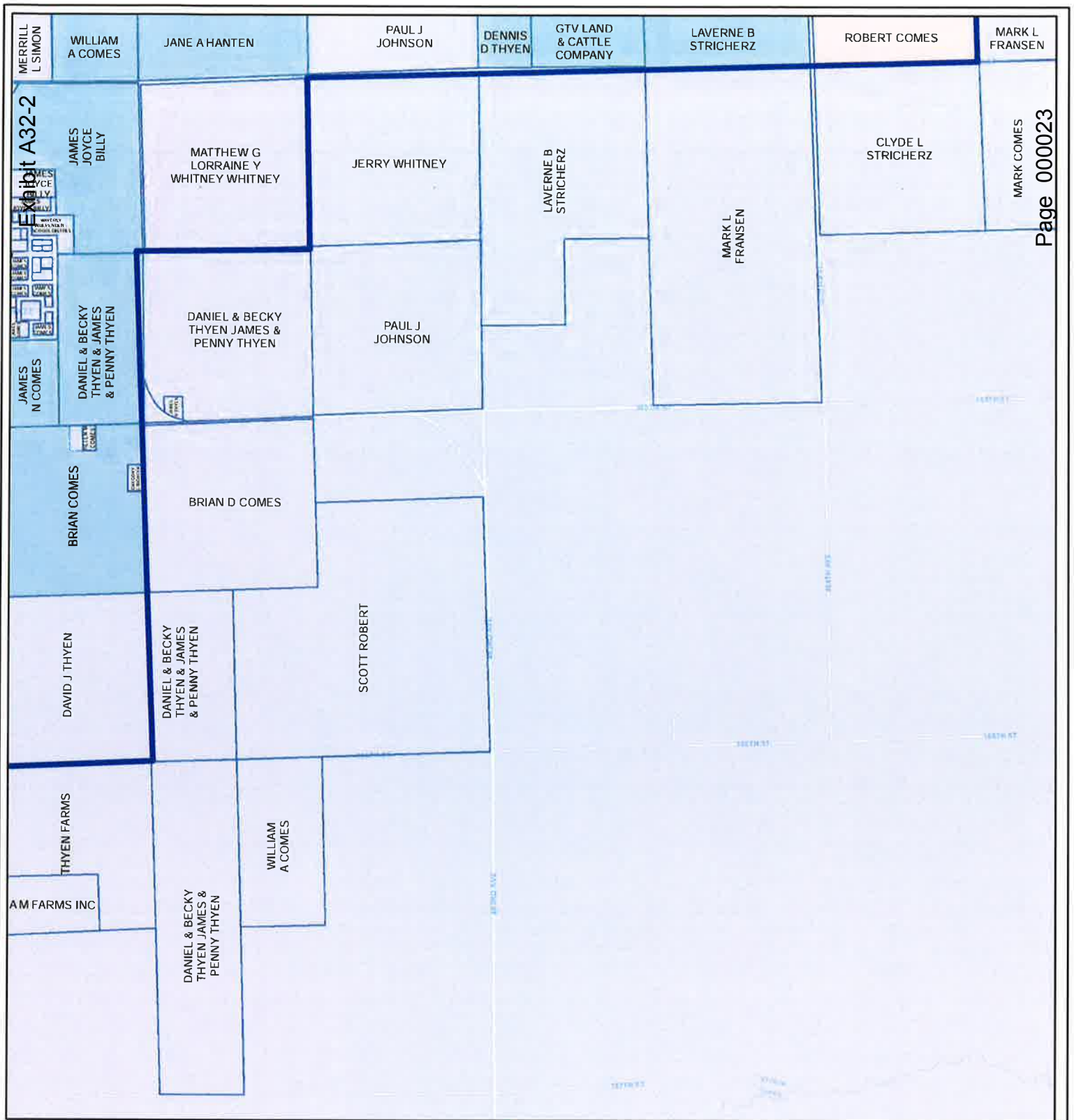


**Figure 3a. Project Map**  
Crowned Ridge Wind Farm

- Turbine
- ⊕ MET Tower
- ⊙ City
- Access Road
- - - Collector Line
- Crane Path
- Railroad
- O&M Facility/ Substation
- Batch Plant
- Laydown Yard
- ▬ Construction Easement
- ▬ Parcel Boundary
- ▬ Project Boundary
- ▬ County Boundary
- ▬ Lease Status
- ▬ Leased, Signed
- ▬ Pending
- ▬ Under Option but Likely to Expire/Not Resign

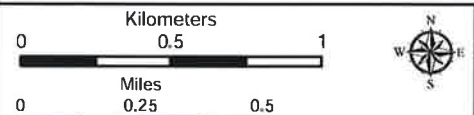


Service Layer Credits: Esri, HERE, Garmin, © OpenStreetMap contributors, and the GIS user community  
 Quadrangle: Still Lake SE (1970), Watertown East (1969), South Shore (1973), Kranzburg (1970)  
 Township/Range: T118N, R52W, T118N, R51W, T117N, R52W, T117N, R51W  
 Codington County, South Dakota



**Figure 3a. Project Map**  
Crowned Ridge Wind Farm

- Turbine
- ⊕ MET Tower
- City
- Access Road
- - - Collector Line
- Crane Path
- Railroad
- O&M Facility/ Substation
- Batch Plant
- Laydown Yard
- Construction Easement
- ▭ Parcel Boundary
- ▭ Project Boundary
- ▭ County Boundary
- ▭ Lease Status
- ▭ Leased, Signed
- ▭ Pending
- ▭ Under Option but Likely to Expire/Not Resign



Service Layer Credits: Esri, HERE, Garmin,  
© OpenStreetMap contributors, and the GIS user  
community  
Quadrangle: South Shore (1973),  
Kranzburg (1970)  
Township/Range: T118N, R51W,  
T117N, R51W  
Codington County, South Dakota

