

Figure 3a

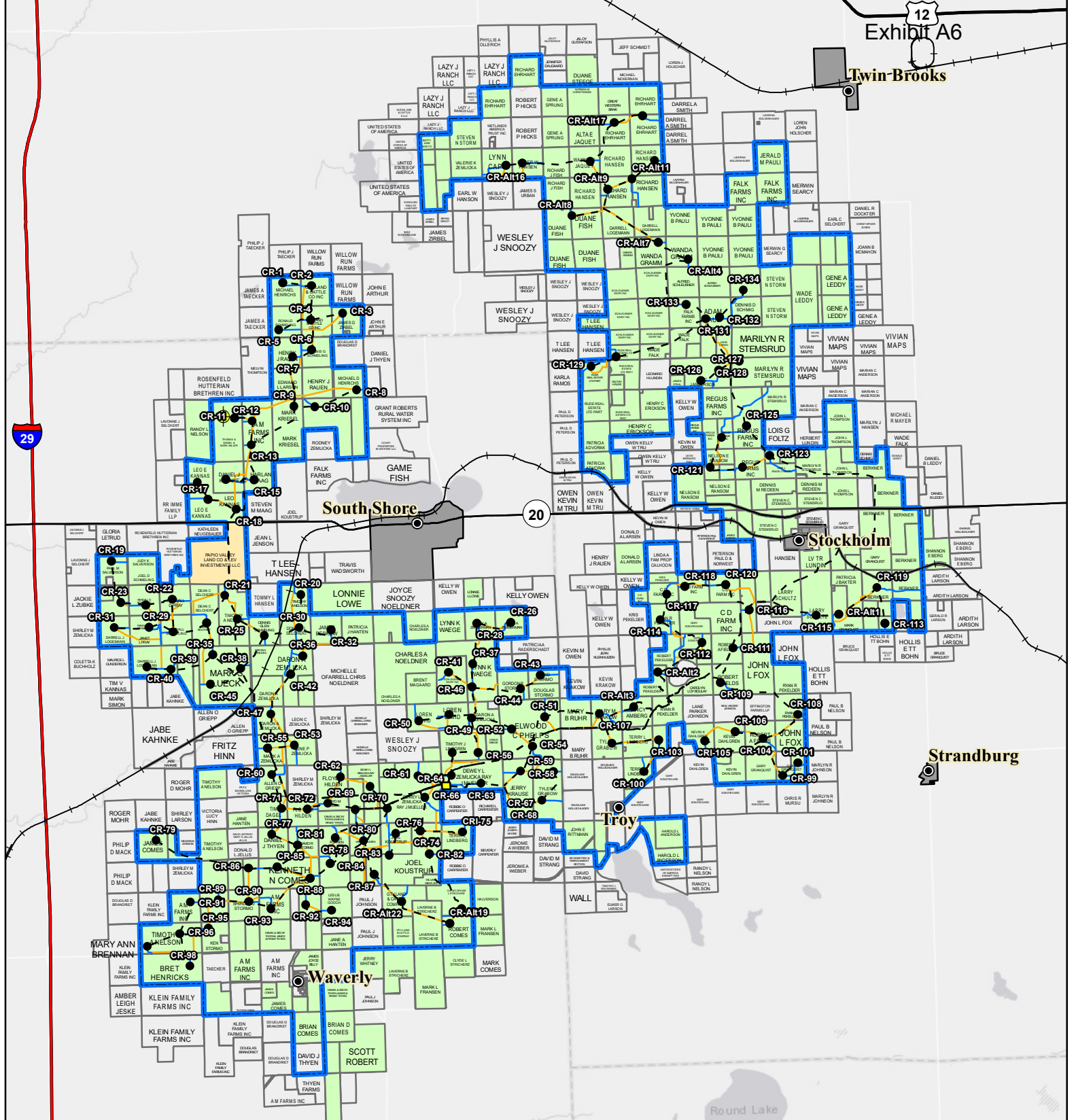
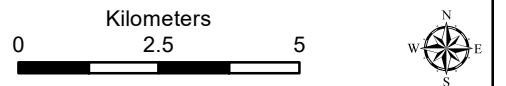
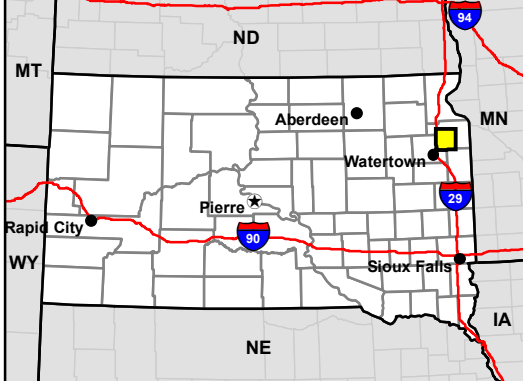

Figure 3a. Project Map
Crowned Ridge Wind Farm

- MET Tower
- Turbine
- City
- Proposed Turbine Access Road
- Collector Line
- Crane Path
- Railroad
- Interstate Highway
- U.S. Highway
- State Highway
- O&M Facility/Substation
- Town Boundary
- Project Boundary
- Lease Status**
- Lease, Signed
- Pending Approval
- Parcel Boundary



Base Map: World Light Gray Canvas Base
Sources: Esri, HERE, Garmin, © OpenStreetMap contributors, and the GIS user community
Codington and Grant Counties, South Dakota

Page 000002 **SWCA**
ENVIRONMENTAL CONSULTANTS

Projection: NAD 1983 UTM Zone 14N

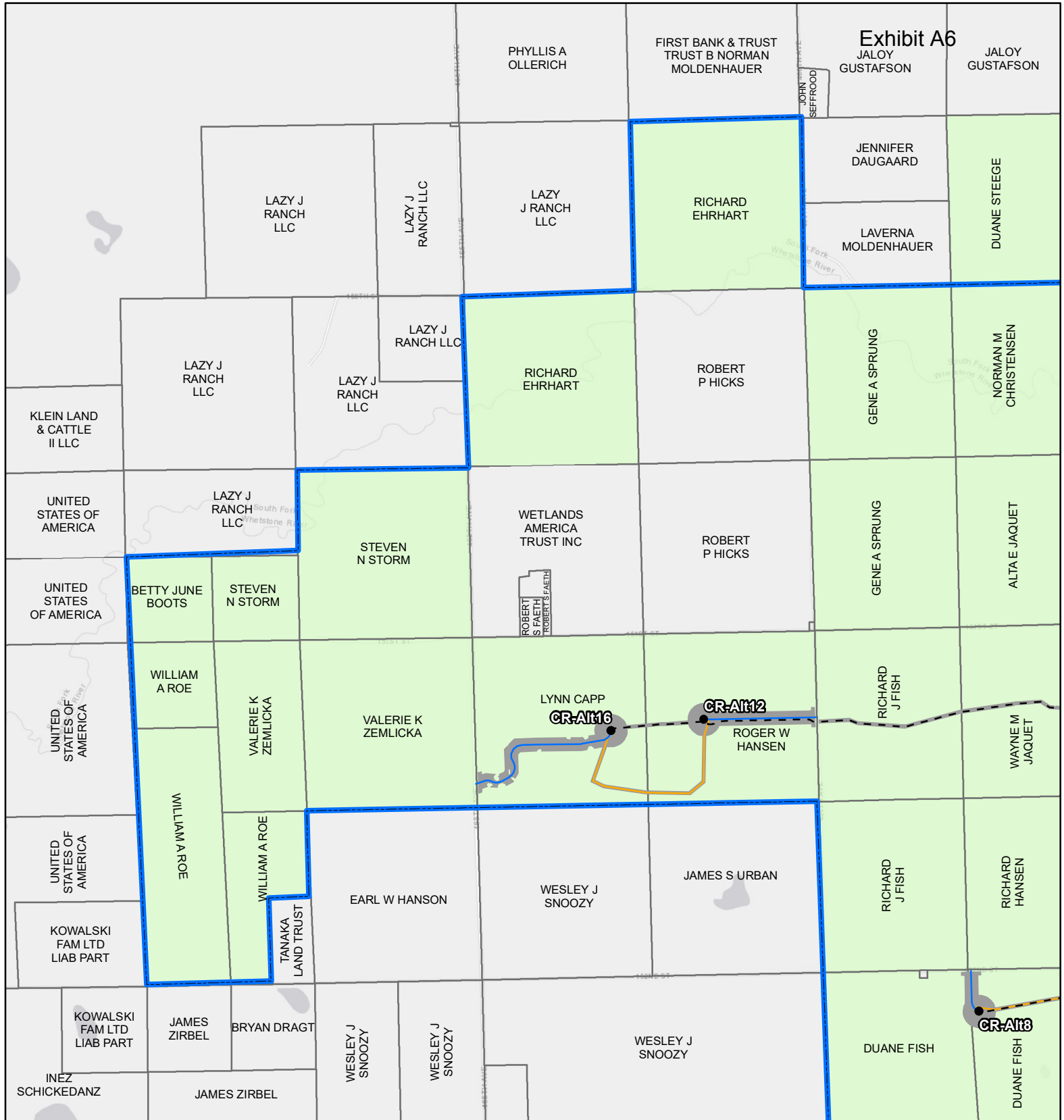
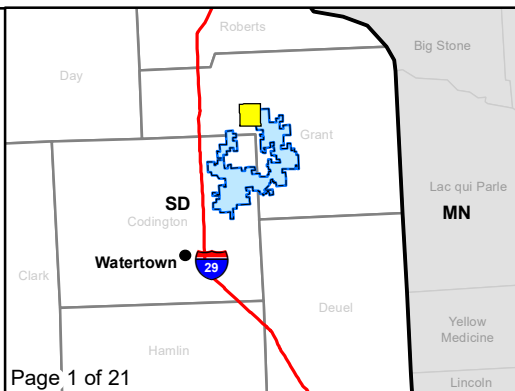

Figure 3a. Project Map
Crowned Ridge Wind Farm

- Turbine
- ⊕ MET Tower
- City
- Railroad
- - - Collector Line
- Proposed Turbine Access Road
- Crane Path
- O&M Facility/Substation
- Construction Easement
- Batch Plant
- Laydown Yard
- Land_Status**
- Lease Status**
- Lease, Signed
- Pending Approval
- Parcel Boundary
- Project Boundary
- County Boundary



Kilometers
0 0.5 1

Miles
0 0.25 0.5

Service Layer Credits: Esri, HERE, Garmin, © OpenStreetMap contributors, and the GIS user community
 Quadrangle: Antelope Valley (1973), Twin Brooks (1973)
 Township/Range: T120N, R51W, T120N, R50W
 Grant County, South Dakota

Page 000003 **SWCA**
ENVIRONMENTAL CONSULTANTS

Projection: NAD 1983 UTM Zone 14N

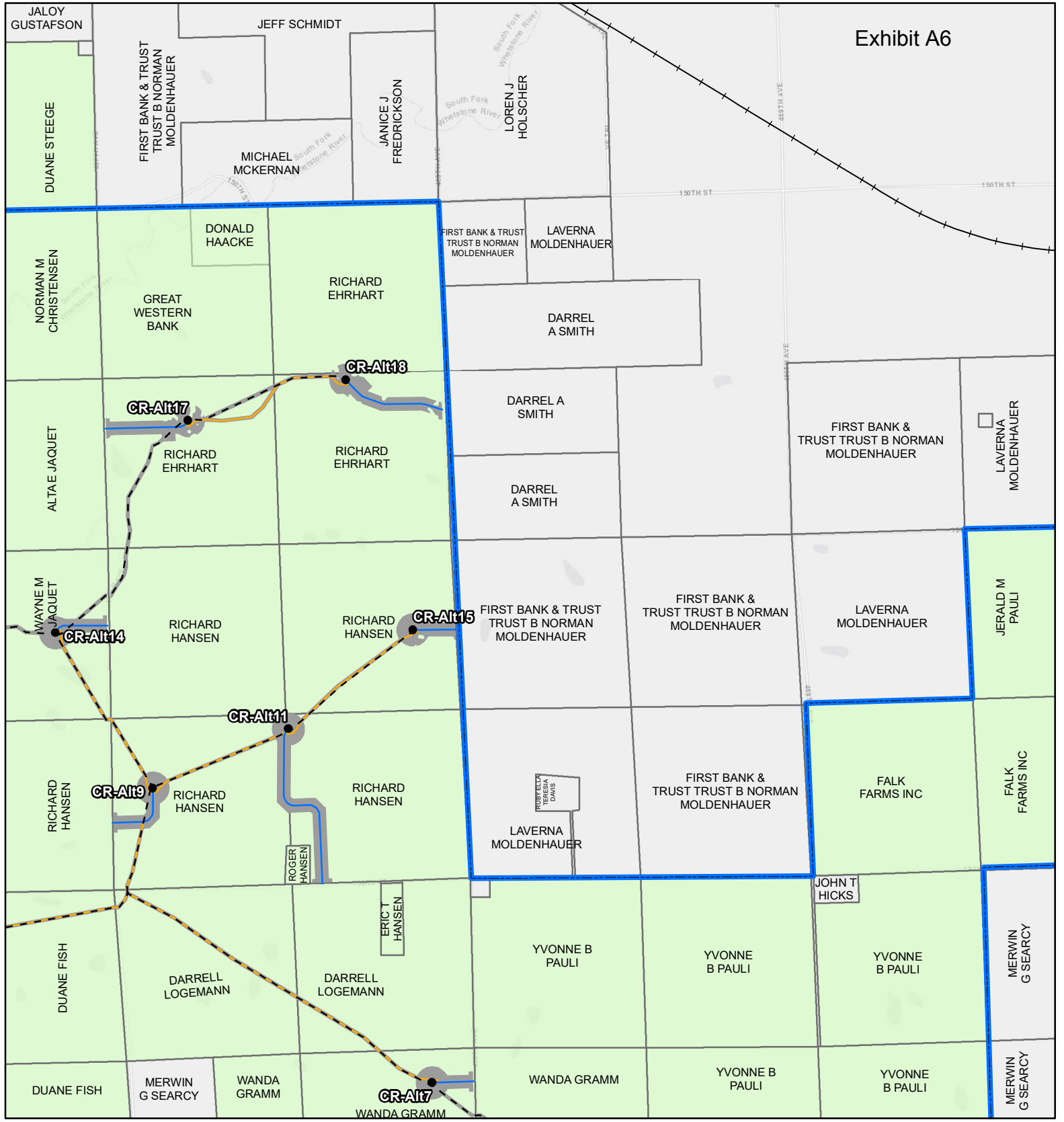
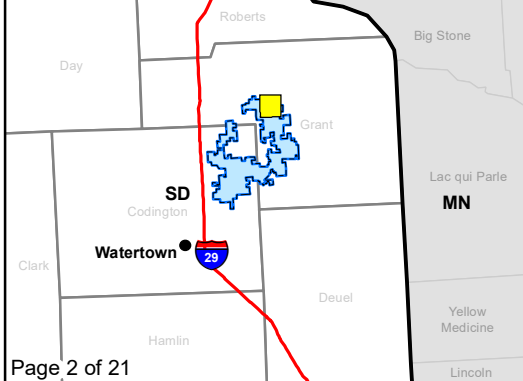

Figure 3a. Project Map
Crowned Ridge Wind Farm

- Turbine
 - ⊕ MET Tower
 - ⊙ City
 - Railroad
 - - - Collector Line
 - Proposed Turbine Access Road
 - Crane Path
 - O&M Facility/Substation
 - Construction Easement
 - Batch Plant
 - Laydown Yard
- Land_Status**
- Lease, Signed
 - Pending Approval
 - Parcel Boundary
 - Project Boundary
 - County Boundary
- Lease Status**
- Lease, Signed
 - Pending Approval
 - Parcel Boundary
 - Project Boundary
 - County Boundary



Kilometers
0 0.5 1

Miles
0 0.25 0.5

Service Layer Credits: Esri, HERE, Garmin, © OpenStreetMap contributors, and the GIS user community
Quadrangle: Twin Brooks (1973)
Township/Range: T120N, R50W
Grant County, South Dakota

Page 000004 **SWCA**
ENVIRONMENTAL CONSULTANTS

Projection: NAD 1983 UTM Zone 14N

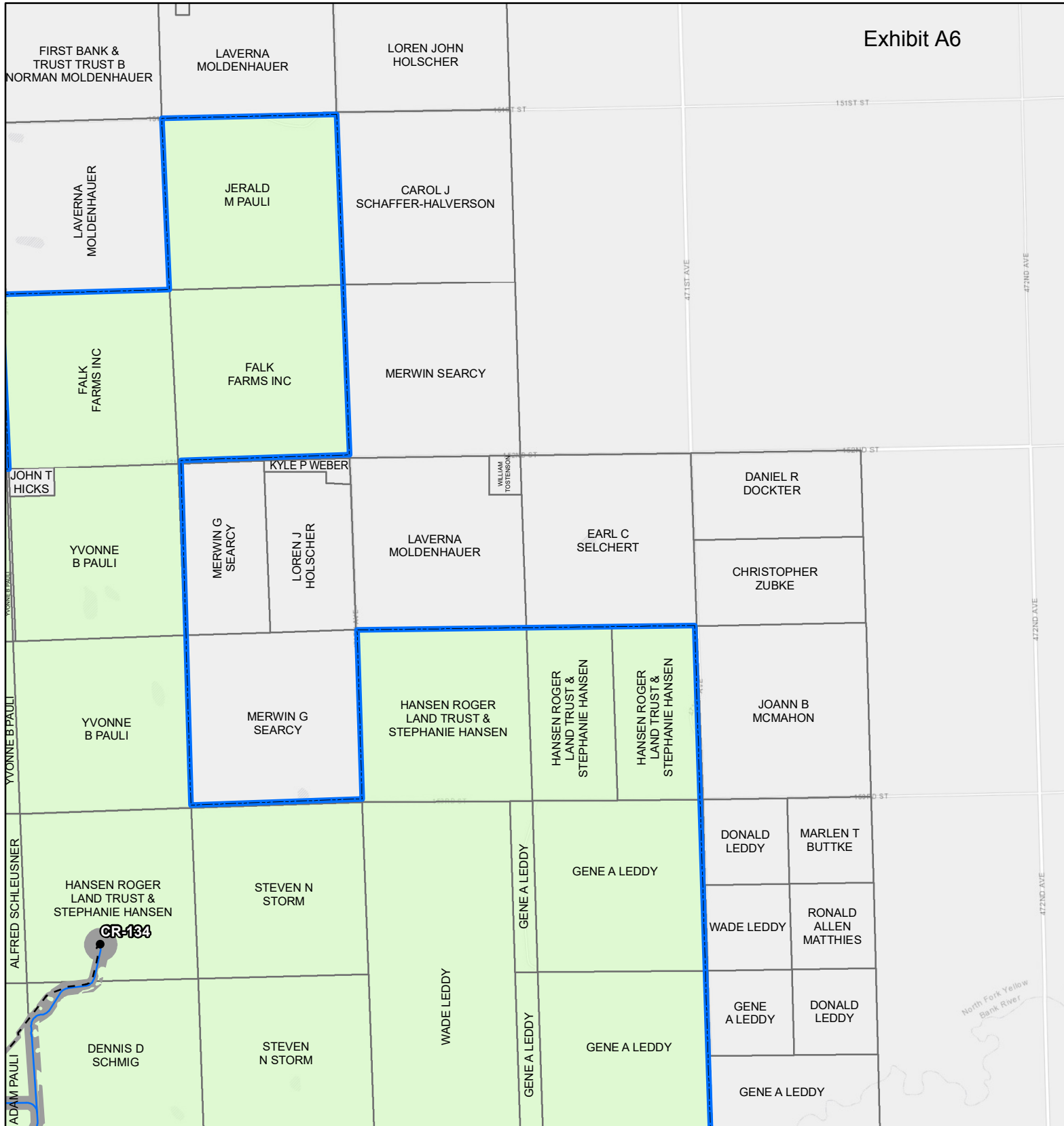
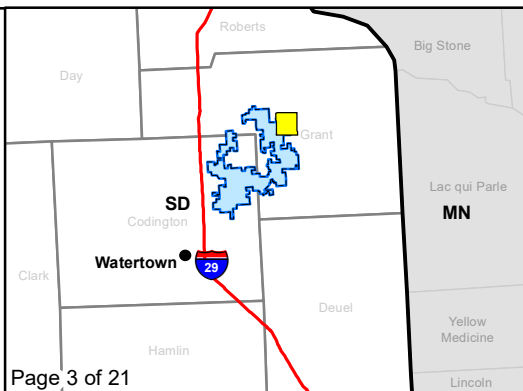

Figure 3a. Project Map
Crowned Ridge Wind Farm

- Turbine
- ⊕ MET Tower
- ⊙ City
- Railroad
- - - Collector Line
- Proposed Turbine Access Road
- Crane Path
- O&M Facility/ Substation
- Construction Easement
- Batch Plant
- Laydown Yard
- Land_Status**
- Lease, Signed
- Pending Approval
- Parcel Boundary
- Project Boundary
- County Boundary



0 0.5 1
Kilometers

0 0.25 0.5
Miles

Service Layer Credits: Esri, HERE, Garmin, © OpenStreetMap contributors, and the GIS user community
Quadrangle: Twin Brooks (1973)

Township/Range: T120N, R50W

Grant County, South Dakota

Page 000005 **SWCA**
ENVIRONMENTAL CONSULTANTS

Projection: NAD 1983 UTM Zone 14N

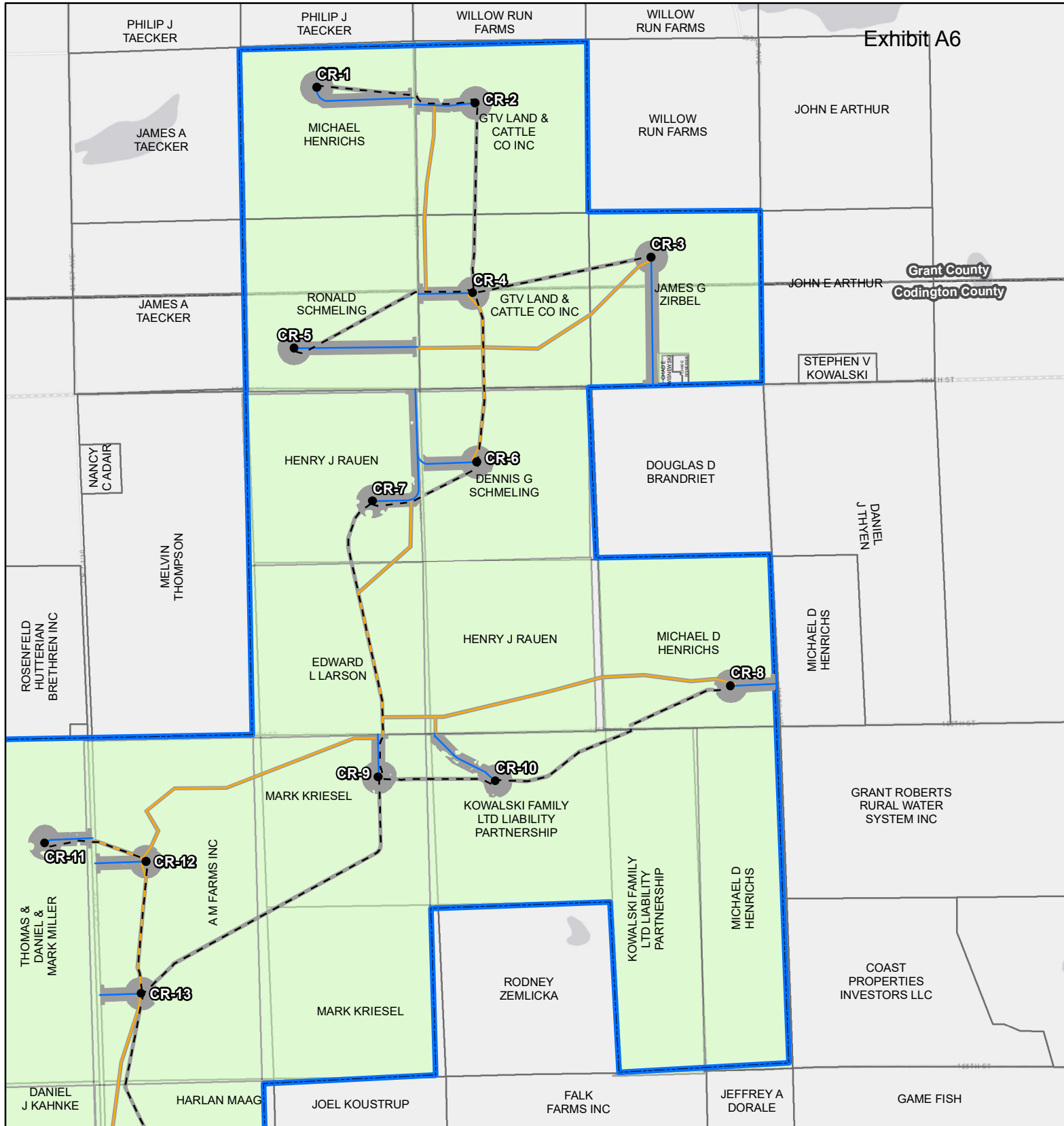
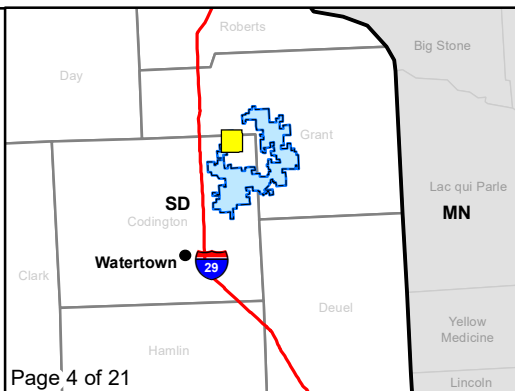

Figure 3a. Project Map
Crowned Ridge Wind Farm

- Turbine
 - ⊕ MET Tower
 - ⊙ City
 - Railroad
 - - - Collector Line
 - Proposed Turbine Access Road
 - Crane Path
 - O&M Facility/Substation
 - Construction Easement
 - Batch Plant
 - Laydown Yard
- Land_Status**
- Lease, Signed
 - Pending Approval
 - Parcel Boundary
 - Project Boundary
 - County Boundary
- Lease Status**
- Lease, Signed
 - Pending Approval
 - Parcel Boundary
 - Project Boundary
 - County Boundary



Kilometers
0 0.5 1

Miles
0 0.25 0.5

Service Layer Credits: Esri, HERE, Garmin, © OpenStreetMap contributors, and the GIS user community
 Quadrangle: Antelope Valley (1973), South Shore (1973)
 Township/Range: T120N, R51W, T119N, R51W,
 Codington and Grant Counties, South Dakota

Page 000006 **SWCA**
ENVIRONMENTAL CONSULTANTS

Projection: NAD 1983 UTM Zone 14N

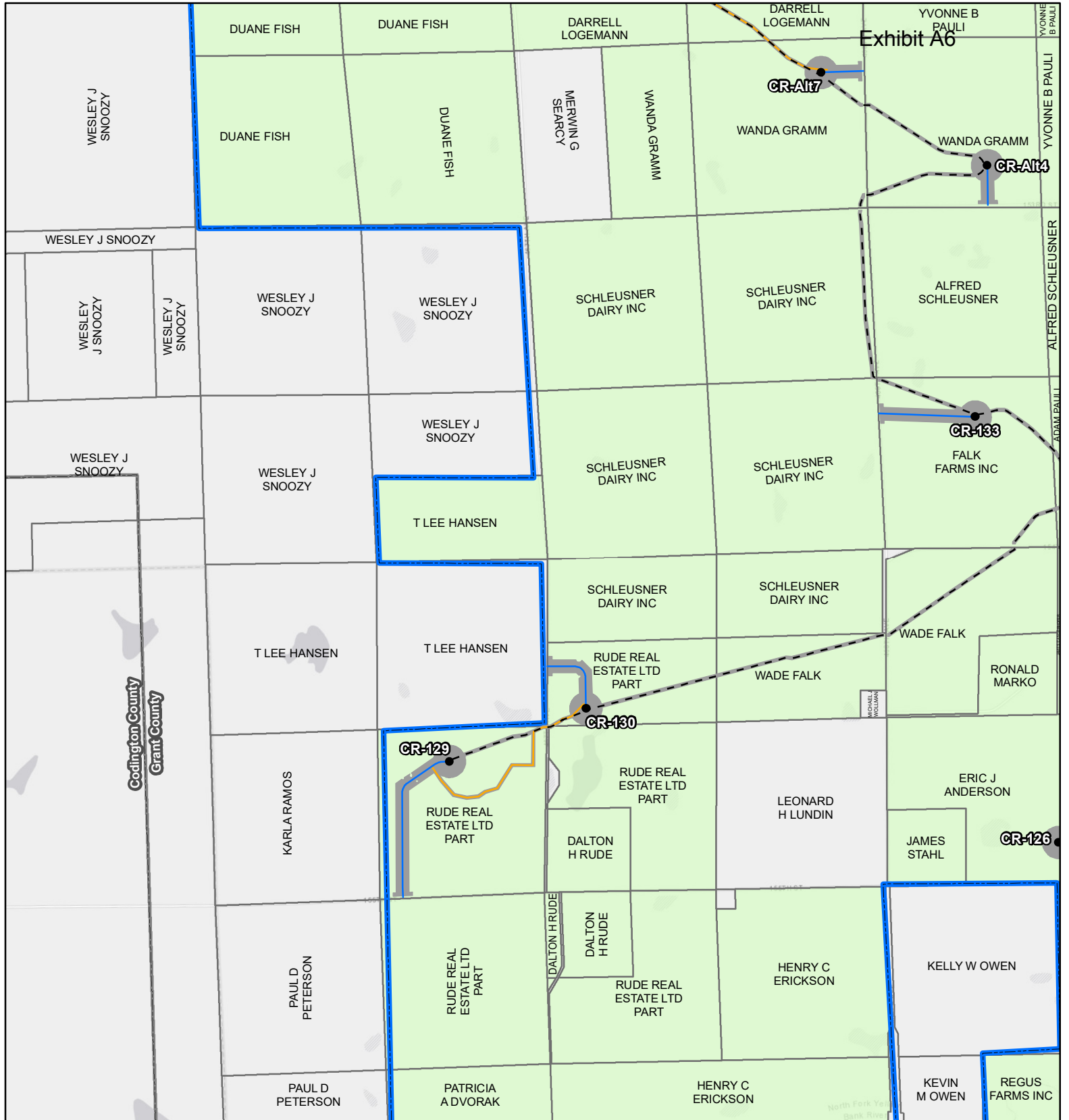

Exhibit A6

Figure 3a. Project Map
Crowned Ridge Wind Farm

- Turbine
- ⊕ MET Tower
- ⊙ City
- Railroad
- - - Collector Line
- Proposed Turbine Access Road
- Crane Path
- O&M Facility/Substation
- Construction Easement
- Batch Plant
- Laydown Yard
- Land_Status**
- Lease, Signed
- Pending Approval
- Parcel Boundary
- Project Boundary
- County Boundary



Kilometers
 0 0.5 1
 Miles
 0 0.25 0.5

Service Layer Credits: Esri, HERE, Garmin, © OpenStreetMap contributors, and the GIS user community
 Quadrangle: Antelope Valley (1973), Twin Brooks (1973)
 Township/Range: T120N, R51W, T120N, R50W, T119N, R51W, T119N, R50W
 Codrington and Grant Counties, South Dakota

Page 000007 **SWCA**
 ENVIRONMENTAL CONSULTANTS

Projection: NAD 1983 UTM Zone 14N

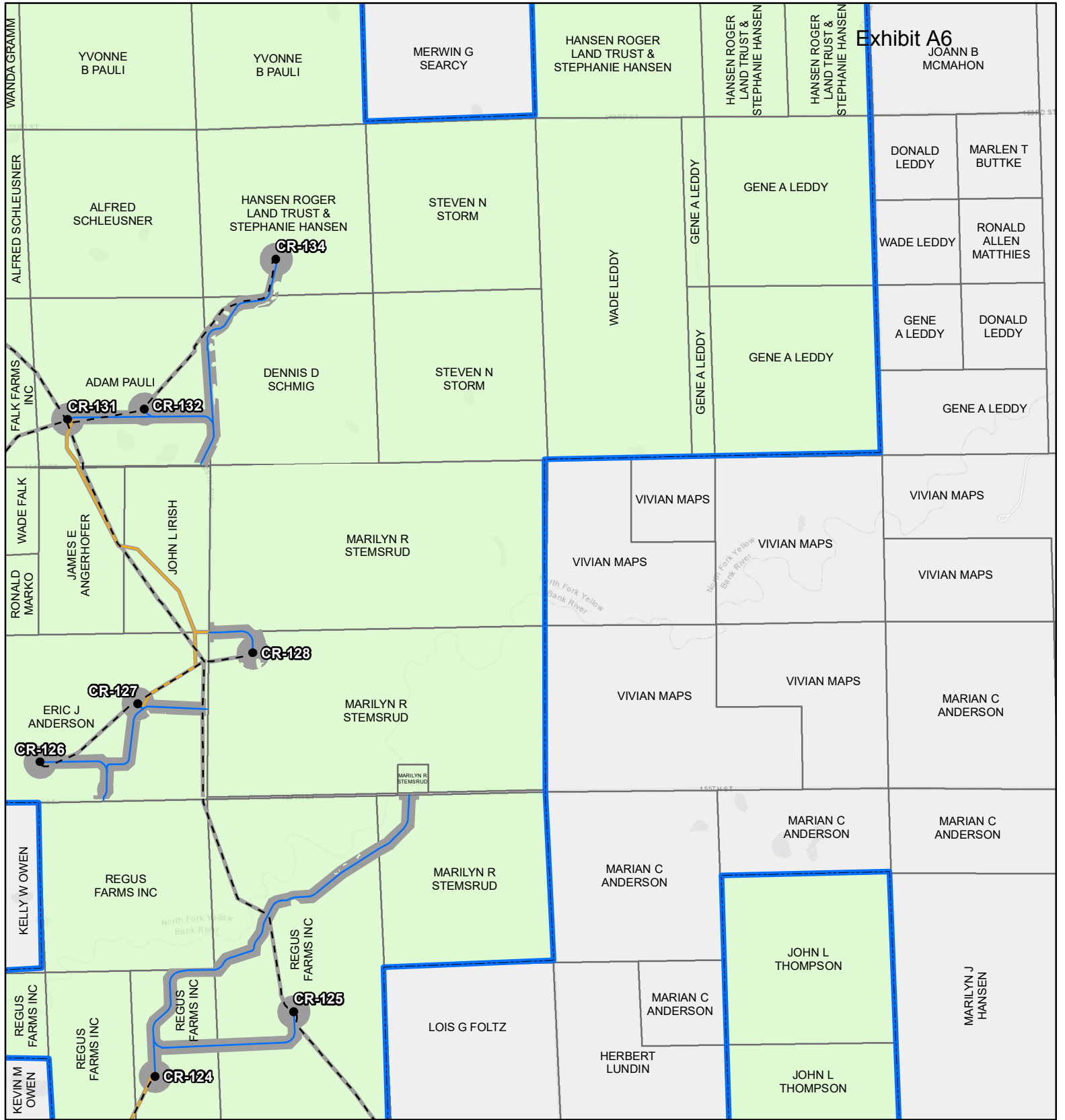
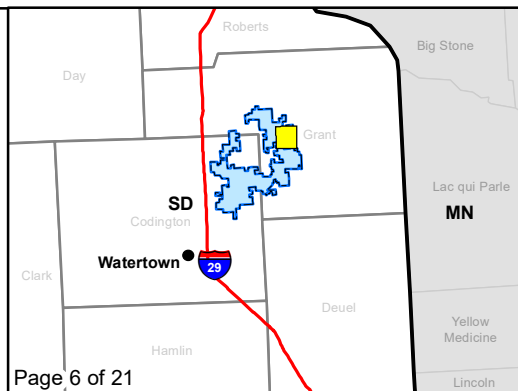

Figure 3a. Project Map
Crowned Ridge Wind Farm

- Turbine
- ⊕ MET Tower
- City
- Railroad
- - - Collector Line
- Proposed Turbine Access Road
- Crane Path
- O&M Facility/Substation
- Construction Easement
- Batch Plant
- Laydown Yard
- Land_Status**
- Lease, Signed
- Pending Approval
- Parcel Boundary
- Project Boundary
- County Boundary



0 0.5 1
Kilometers

0 0.25 0.5
Miles

Service Layer Credits: Esri, HERE, Garmin, © OpenStreetMap contributors, and the GIS user community
Quadrangle: Twin Brooks (1973), Stockholm (1973)
Township/Range: T120N, R50W, T119N, R50W
Grant County, South Dakota

Page 000008 **SWCA**
ENVIRONMENTAL CONSULTANTS

Projection: NAD 1983 UTM Zone 14N

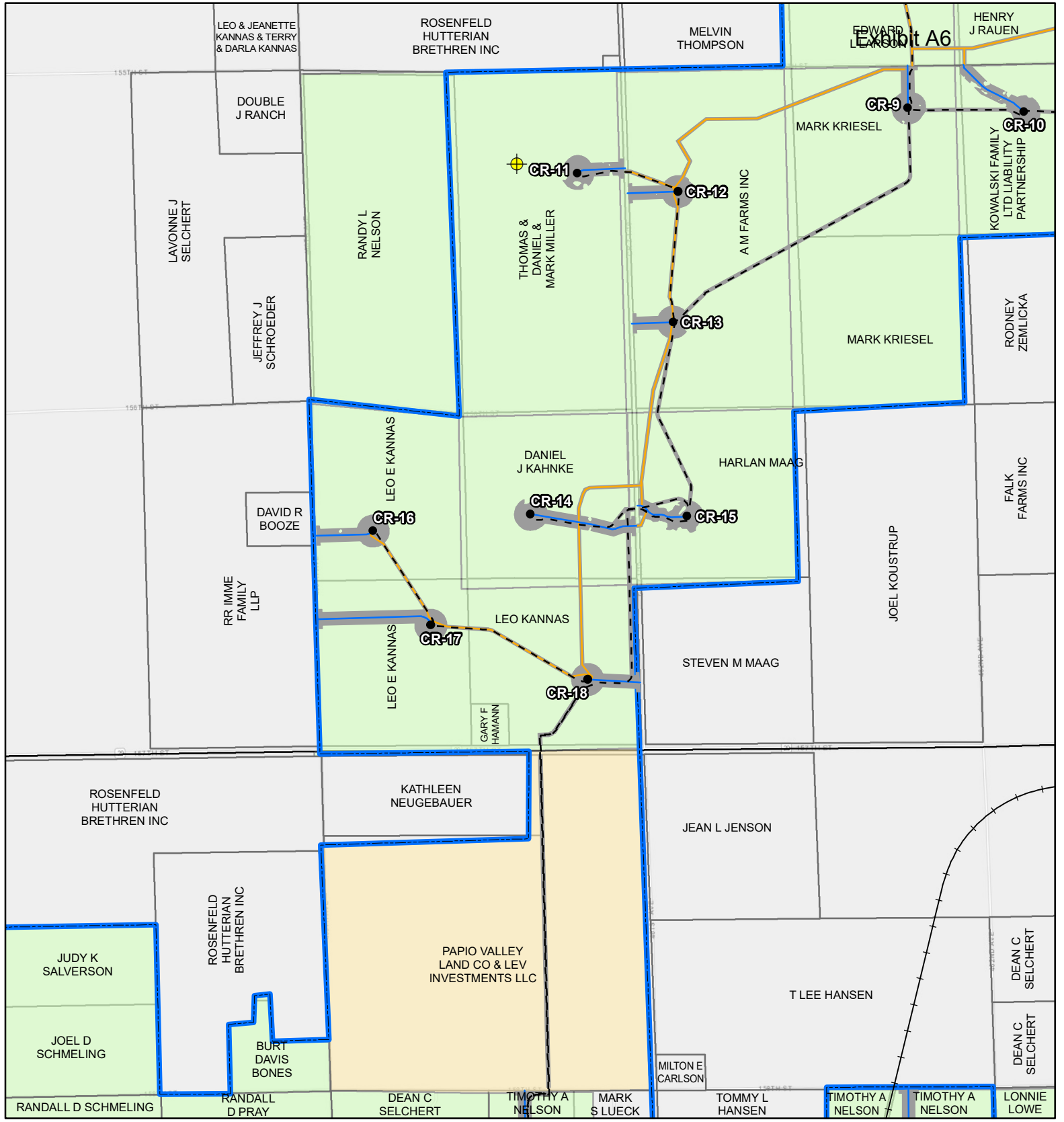

Figure 3a. Project Map
Crowned Ridge Wind Farm

- Turbine
 - ⊕ MET Tower
 - City
 - Railroad
 - - - Collector Line
 - Proposed Turbine Access Road
 - Crane Path
 - O&M Facility/Substation
 - Construction Easement
 - Batch Plant
 - Laydown Yard
- Land_Status**
- Lease, Signed
 - Pending Approval
 - Parcel Boundary
 - Project Boundary
 - County Boundary



Kilometers: 0, 0.5, 1
 Miles: 0, 0.25, 0.5

Service Layer Credits: Esri, HERE, Garmin, © OpenStreetMap contributors, and the GIS user community
 Quadrangle: Still Lake NE (1970), Antelope Valley (1973), Still Lake SE (1970), South Shore (1973)
 Township/Range: T119N, R52W, T119N, R51W
 Codington County, South Dakota

Page 000009 **SWCA**
 ENVIRONMENTAL CONSULTANTS

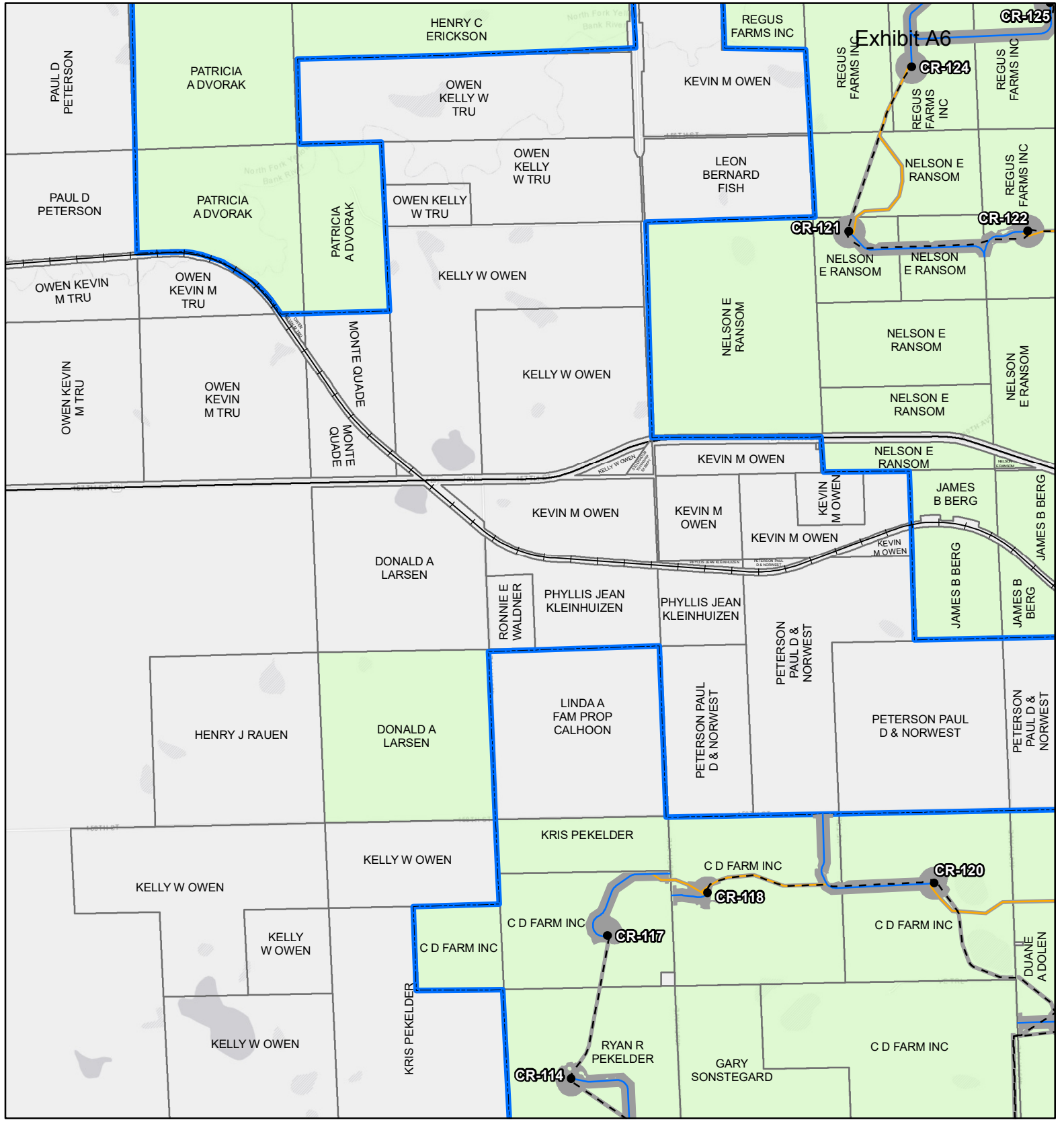

Figure 3a. Project Map
Crowned Ridge Wind Farm

- Turbine
- ⊕ MET Tower
- ⊙ City
- Railroad
- - - Collector Line
- Proposed Turbine Access Road
- Crane Path
- O&M Facility/Substation
- Construction Easement
- Batch Plant
- Laydown Yard
- Land_Status**
- Lease, Signed
- Pending Approval
- Parcel Boundary
- Project Boundary
- County Boundary



Kilometers
 0 0.5 1
 Miles
 0 0.25 0.5

Service Layer Credits: Esri, HERE, Garmin, © OpenStreetMap contributors, and the GIS user community
 Quadrangle: Stockholm (1973), Antelope Valley (1973), Twin Brooks (1973), South Shore (1973)
 Township/Range: T119N, R50W

Grant County, South Dakota
 Page 000010
 Projection: NAD 1983 UTM Zone 14N

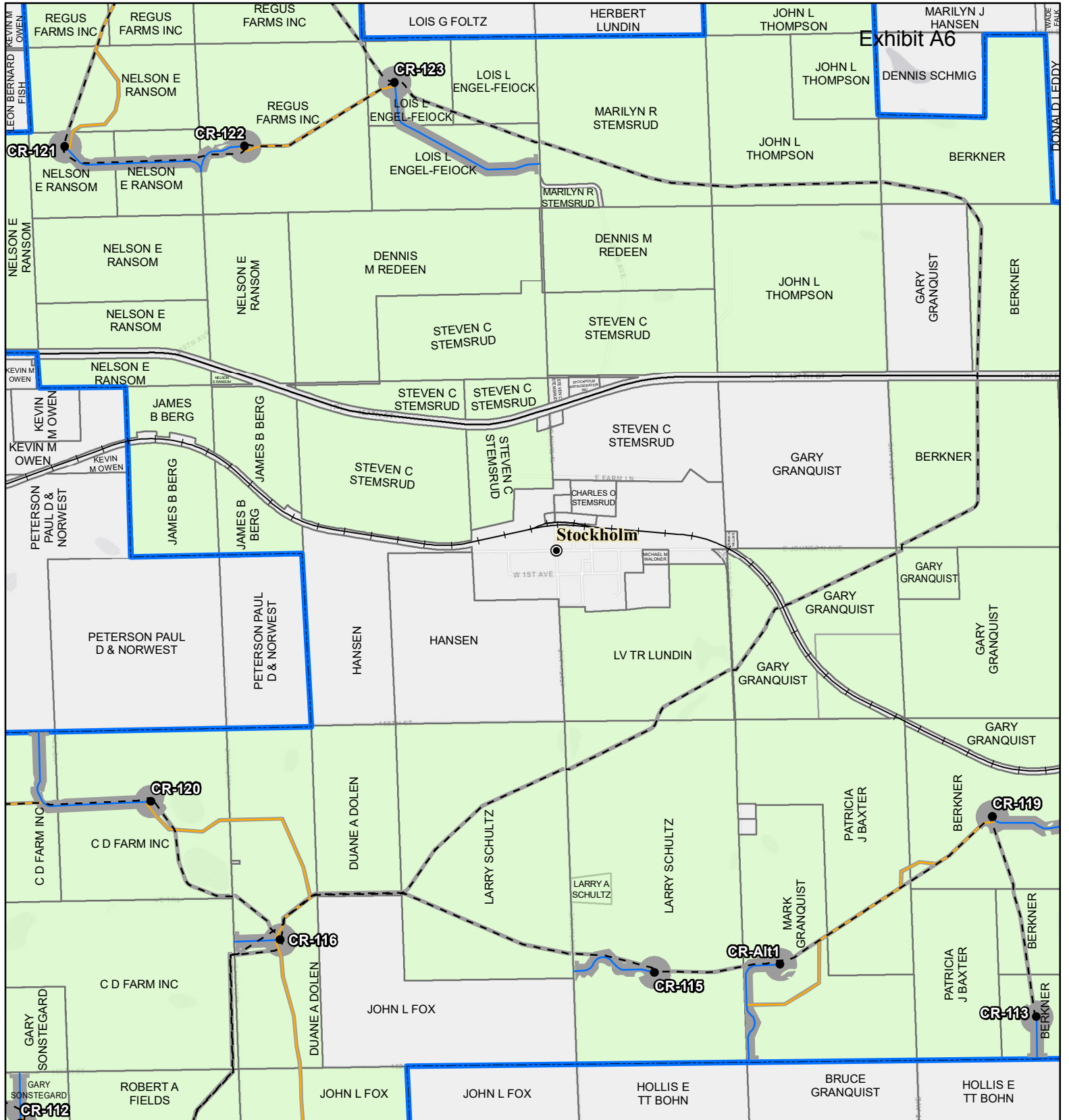
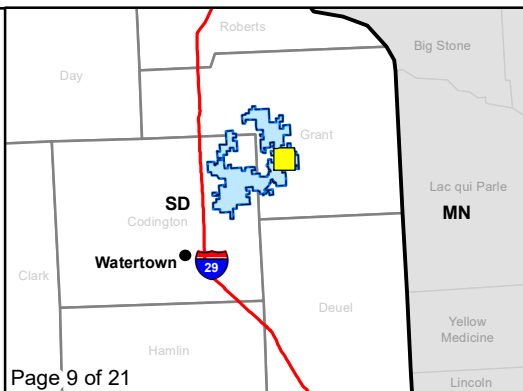

Figure 3a. Project Map
Crowned Ridge Wind Farm

- Turbine
- ⊕ MET Tower
- ⊙ City
- Railroad
- - - Collector Line
- Proposed Turbine Access Road
- Crane Path
- O&M Facility/Substation
- Construction Easement
- Batch Plant
- Laydown Yard
- Land_Status**
- Lease Status**
- Lease, Signed
- Pending Approval
- Parcel Boundary
- Project Boundary
- County Boundary



0 0.5 1
Kilometers

0 0.25 0.5
Miles

Service Layer Credits: Esri, HERE, Garmin, © OpenStreetMap contributors, and the GIS user community
Quadrangle: Stockholm (1973)

Township/Range: T119N, R50W

Grant County, South Dakota

Page 000011 **SWCA**
ENVIRONMENTAL CONSULTANTS

Projection: NAD 1983 UTM Zone 14N

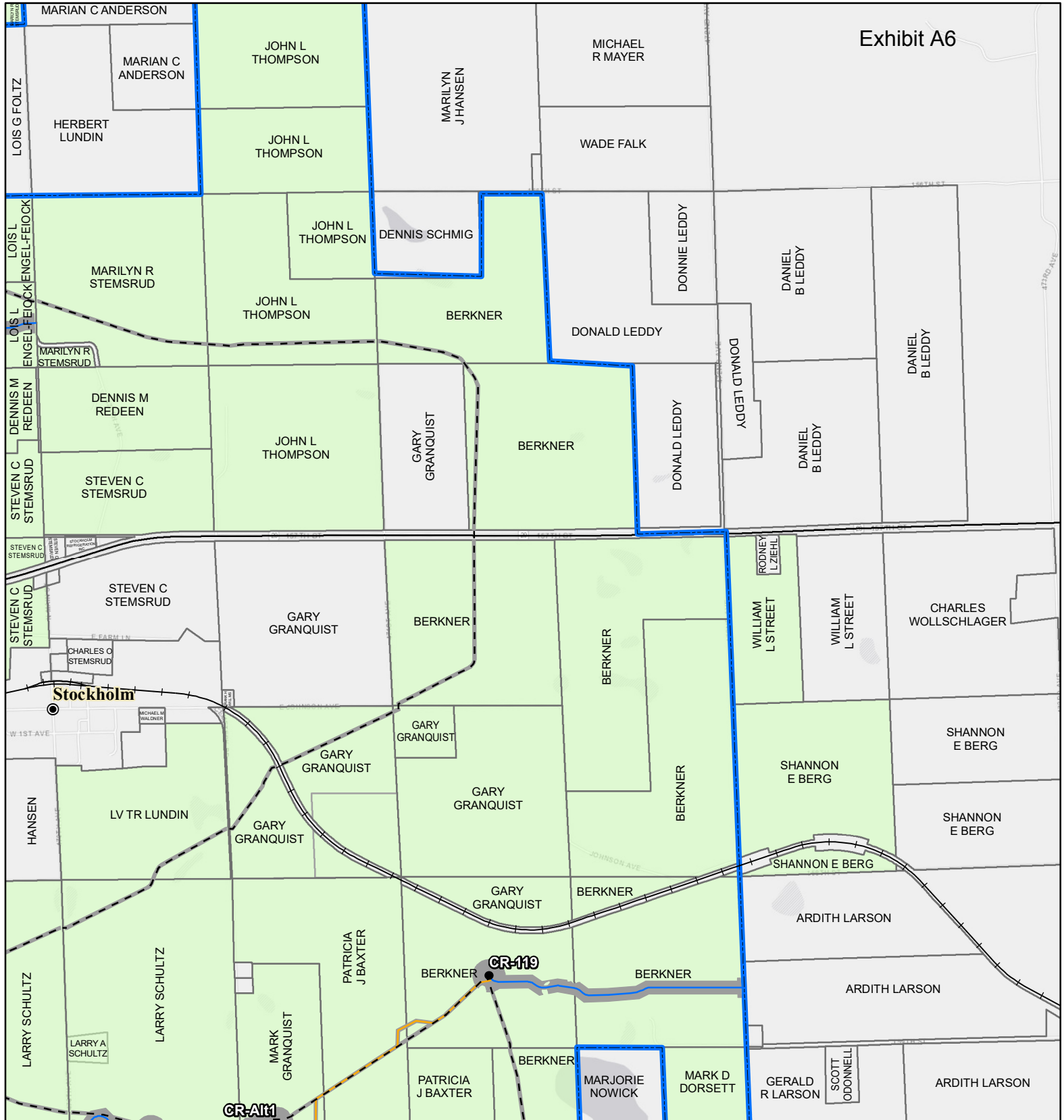
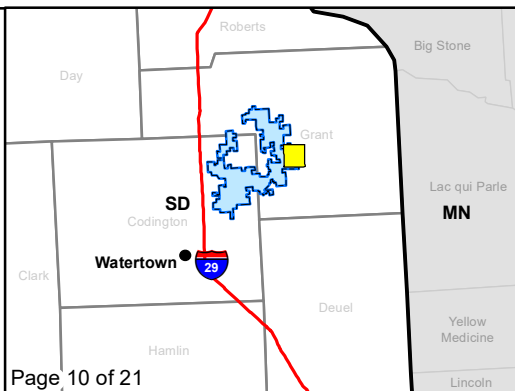

Figure 3a. Project Map
Crowned Ridge Wind Farm

- Turbine
- ⊕ MET Tower
- ⊙ City
- Railroad
- - - Collector Line
- Proposed Turbine Access Road
- Crane Path
- O&M Facility/Substation
- Construction Easement
- Batch Plant
- Laydown Yard
- Land_Status**
- Lease, Signed
- Pending Approval
- Parcel Boundary
- Project Boundary
- County Boundary



0 0.5 1
Kilometers

0 0.25 0.5
Miles

Service Layer Credits: Esri, HERE, Garmin, © OpenStreetMap contributors, and the GIS user community
 Quadrangle: Twin Brooks (1973), Stockholm (1973)
 Township/Range: T119N, R50W, T119N, R49W
 Grant County, South Dakota

Page 000012 **SWCA**
ENVIRONMENTAL CONSULTANTS

Projection: NAD 1983 UTM Zone 14N

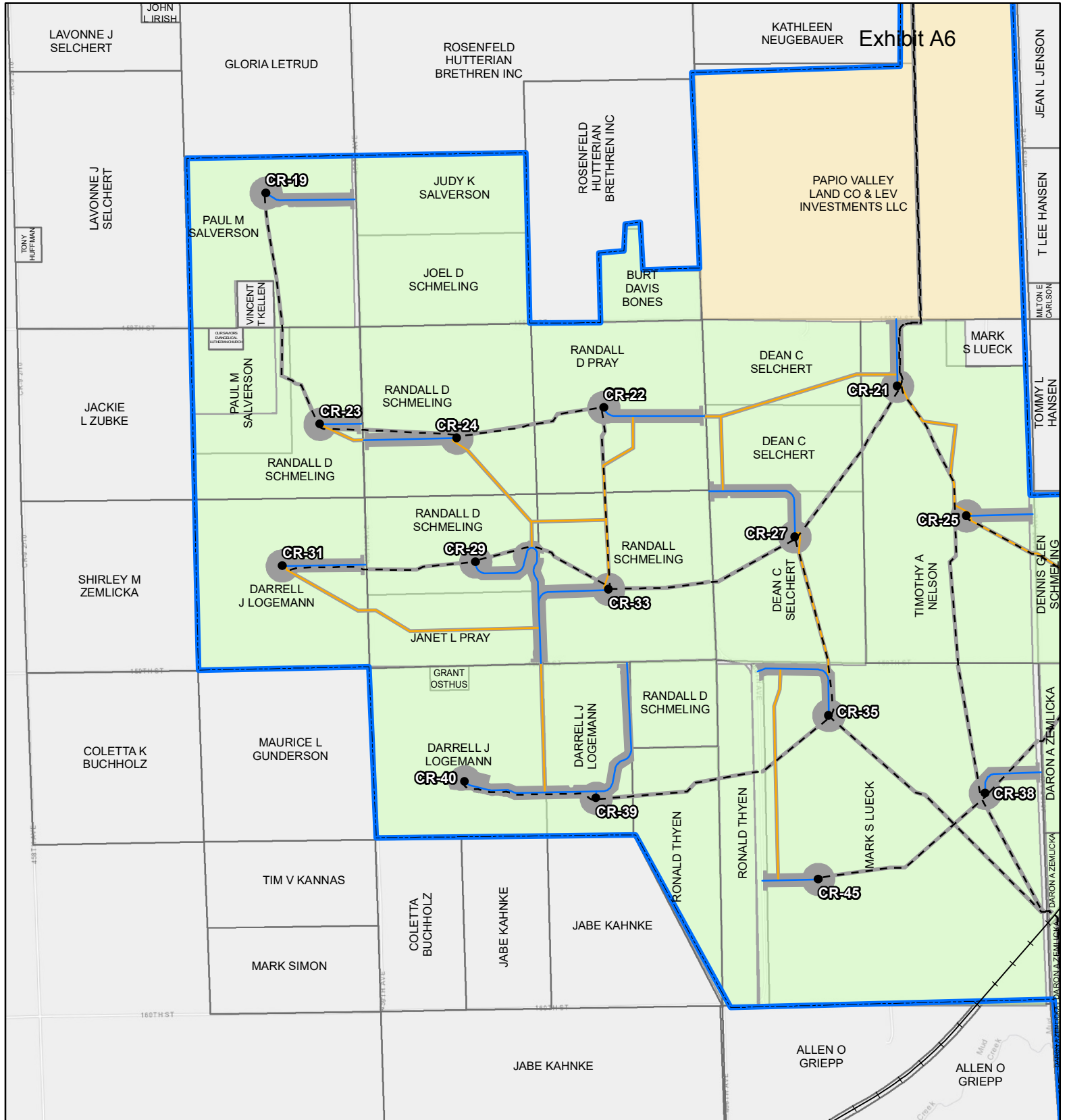

Exhibit A6

Figure 3a. Project Map
Crowned Ridge Wind Farm

- Turbine
- ⊕ MET Tower
- ⊙ City
- Railroad
- - - Collector Line
- Proposed Turbine Access Road
- Crane Path
- O&M Facility/Substation
- Construction Easement
- Batch Plant
- Laydown Yard
- Land_Status**
- Lease, Signed
- Pending Approval
- Parcel Boundary
- Project Boundary
- County Boundary



Kilometers
0 0.5 1

Miles
0 0.25 0.5

Service Layer Credits: Esri, HERE, Garmin, © OpenStreetMap contributors, and the GIS user community
 Quadrangle: Still Lake SE (1970), South Shore (1973)
 Township/Range: T119N, R52W, T119N, R51W, T118N, R52W, T118N, R51W
 Codington County, South Dakota

Page 000013 **SWCA**
ENVIRONMENTAL CONSULTANTS

Projection: NAD 1983 UTM Zone 14N

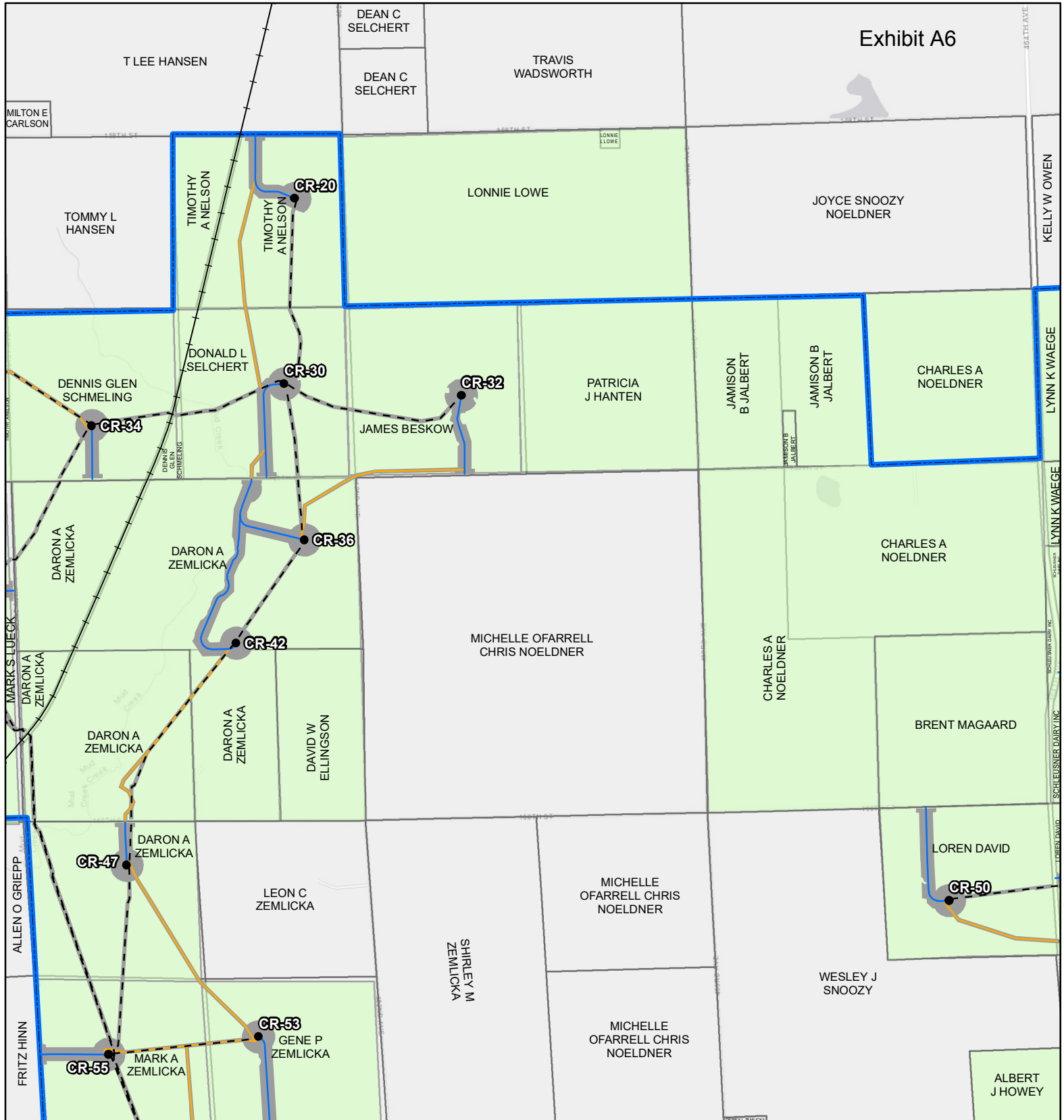
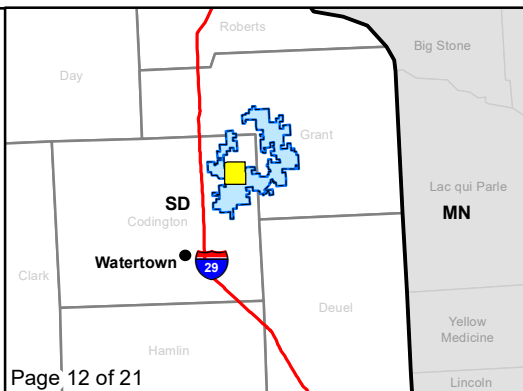

Figure 3a. Project Map
Crowned Ridge Wind Farm

- Turbine
 - ⊕ MET Tower
 - ⊙ City
 - Railroad
 - - - Collector Line
 - Proposed Turbine Access Road
 - Crane Path
 - O&M Facility/Substation
 - Construction Easement
 - Batch Plant
 - Laydown Yard
- Land_Status**
- Lease, Signed
 - Pending Approval
 - Parcel Boundary
 - Project Boundary
 - County Boundary



0 0.5 1
Kilometers

0 0.25 0.5
Miles

Service Layer Credits: Esri, HERE, Garmin, © OpenStreetMap contributors, and the GIS user community
Quadrangle: South Shore (1973)

Township/Range: T119N, R51W, T118N, R51W
Codington County, South Dakota

Page 000014 **SWCA**
ENVIRONMENTAL CONSULTANTS

Projection: NAD 1983 UTM Zone 14N

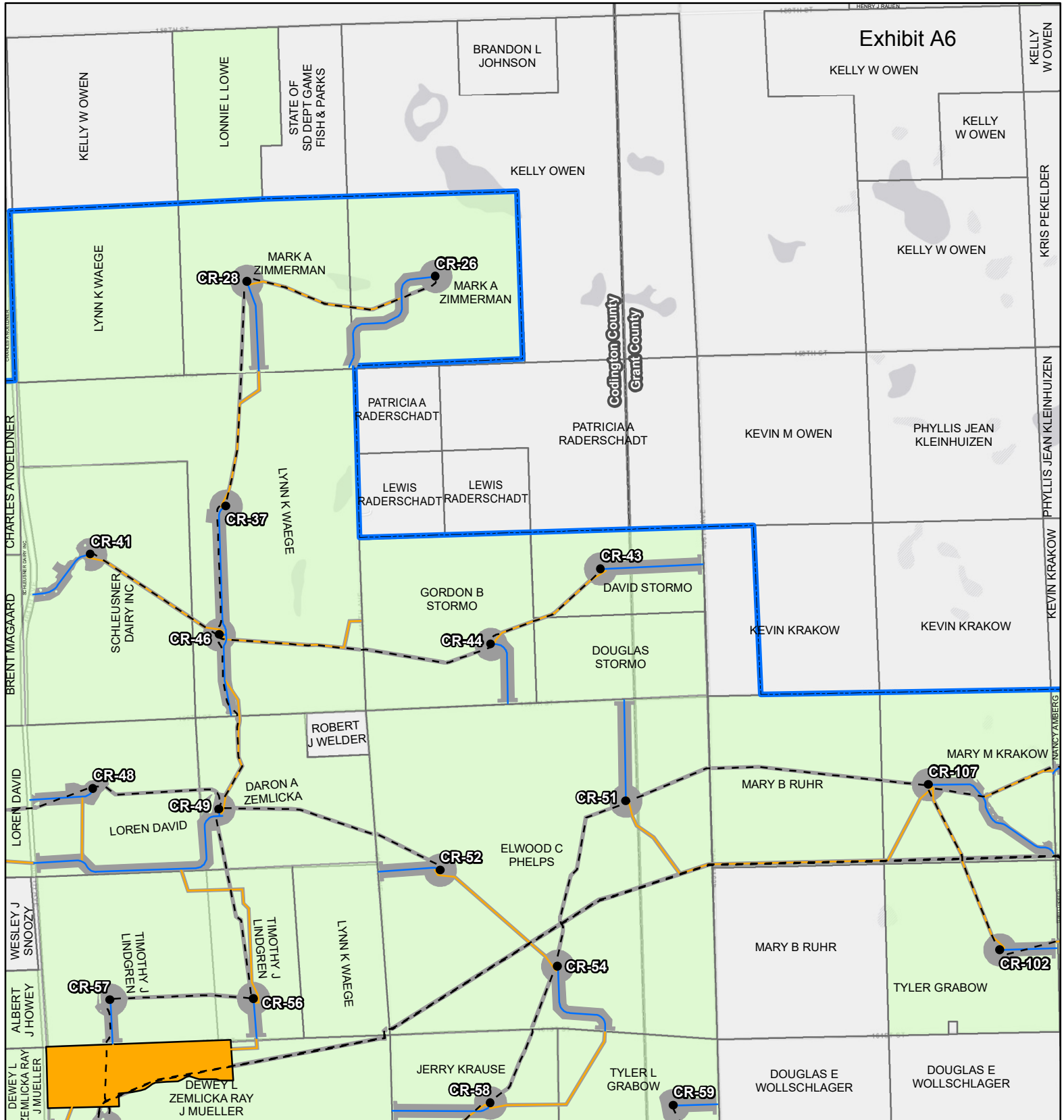
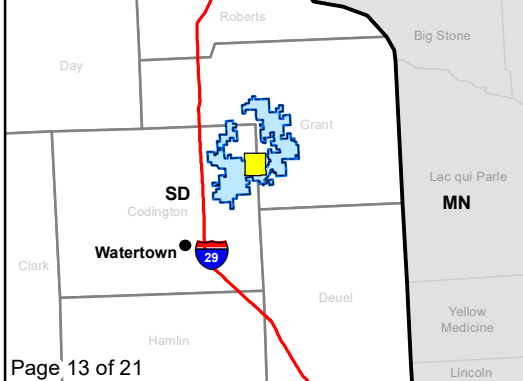

Exhibit A6

Figure 3a. Project Map
Crowned Ridge Wind Farm

- Turbine
 - ⊕ MET Tower
 - ⊙ City
 - Railroad
 - - - Collector Line
 - Proposed Turbine Access Road
 - Crane Path
 - O&M Facility/Substation
 - Construction Easement
 - Batch Plant
 - Laydown Yard
- Land_Status**
- Lease, Signed
 - Pending Approval
 - Parcel Boundary
 - Project Boundary
 - County Boundary



Kilometers
0 0.5 1

Miles
0 0.25 0.5

Service Layer Credits: Esri, HERE, Garmin, © OpenStreetMap contributors, and the GIS user community
 Quadrangle: South Shore (1973), Stockholm (1973)
 Township/Range: T119N, R51W, T119N, R50W, T118N, R51W, T118N, R50W
 Codington and Grant Counties, South Dakota

Page 000015 **SWCA**
ENVIRONMENTAL CONSULTANTS

Projection: NAD 1983 UTM Zone 14N

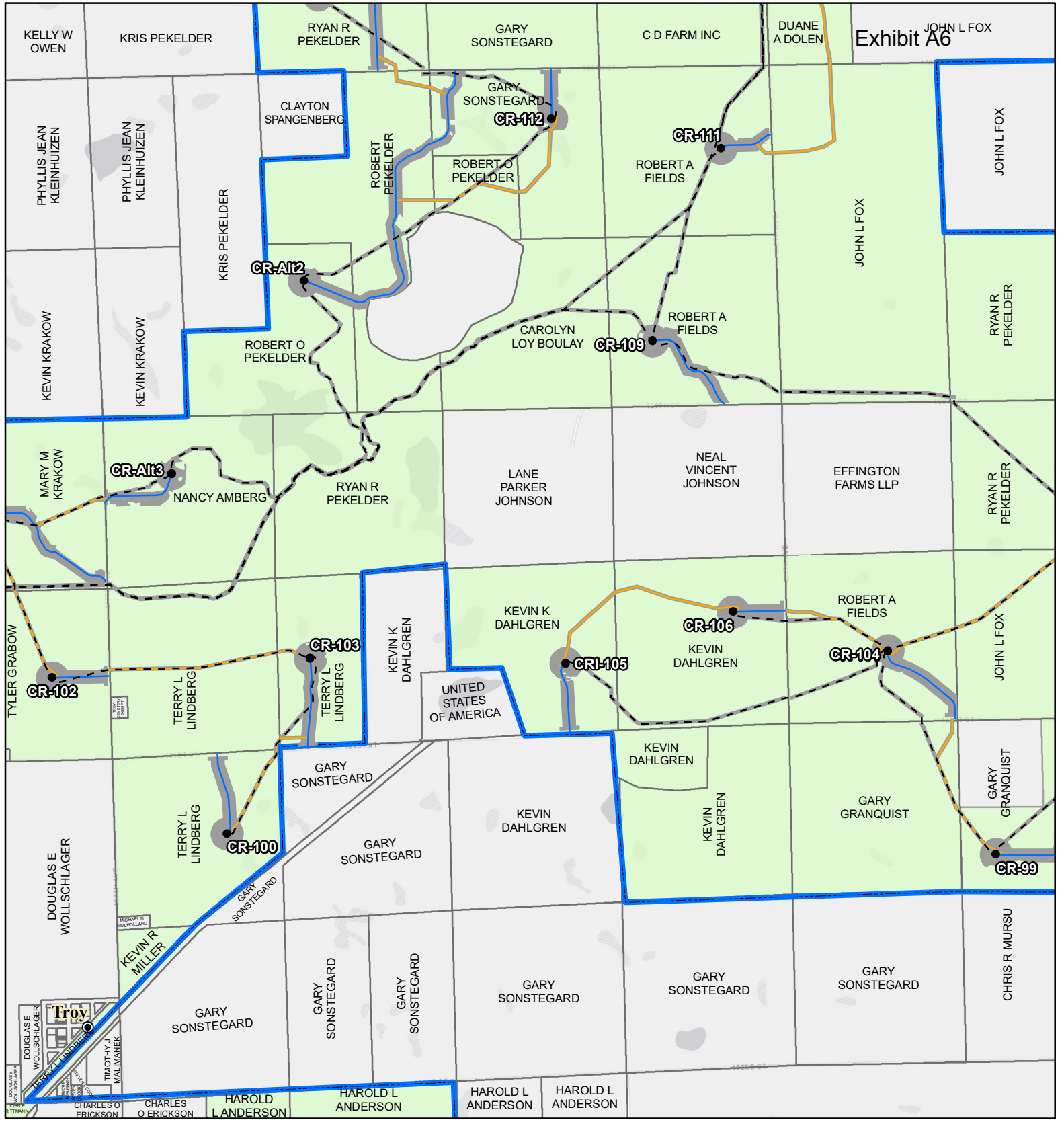

Figure 3a. Project Map
Crowned Ridge Wind Farm

- Turbine
 - ⊕ MET Tower
 - City
 - Railroad
 - - - Collector Line
 - Proposed Turbine Access Road
 - Crane Path
 - O&M Facility/Substation
 - Construction Easement
 - Batch Plant
 - Laydown Yard
- Land_Status**
- Lease, Signed
 - Pending Approval
 - Parcel Boundary
 - Project Boundary
 - County Boundary



0 0.5 1
Kilometers

0 0.25 0.5
Miles

Service Layer Credits: Esri, HERE, Garmin, © OpenStreetMap contributors, and the GIS user community
Quadrangle: Stockholm (1973)

Township/Range: T119N, R50W, T118N, R50W
Grant County, South Dakota

Page 000016 **SWCA**
ENVIRONMENTAL CONSULTANTS

Projection: NAD 1983 UTM Zone 14N

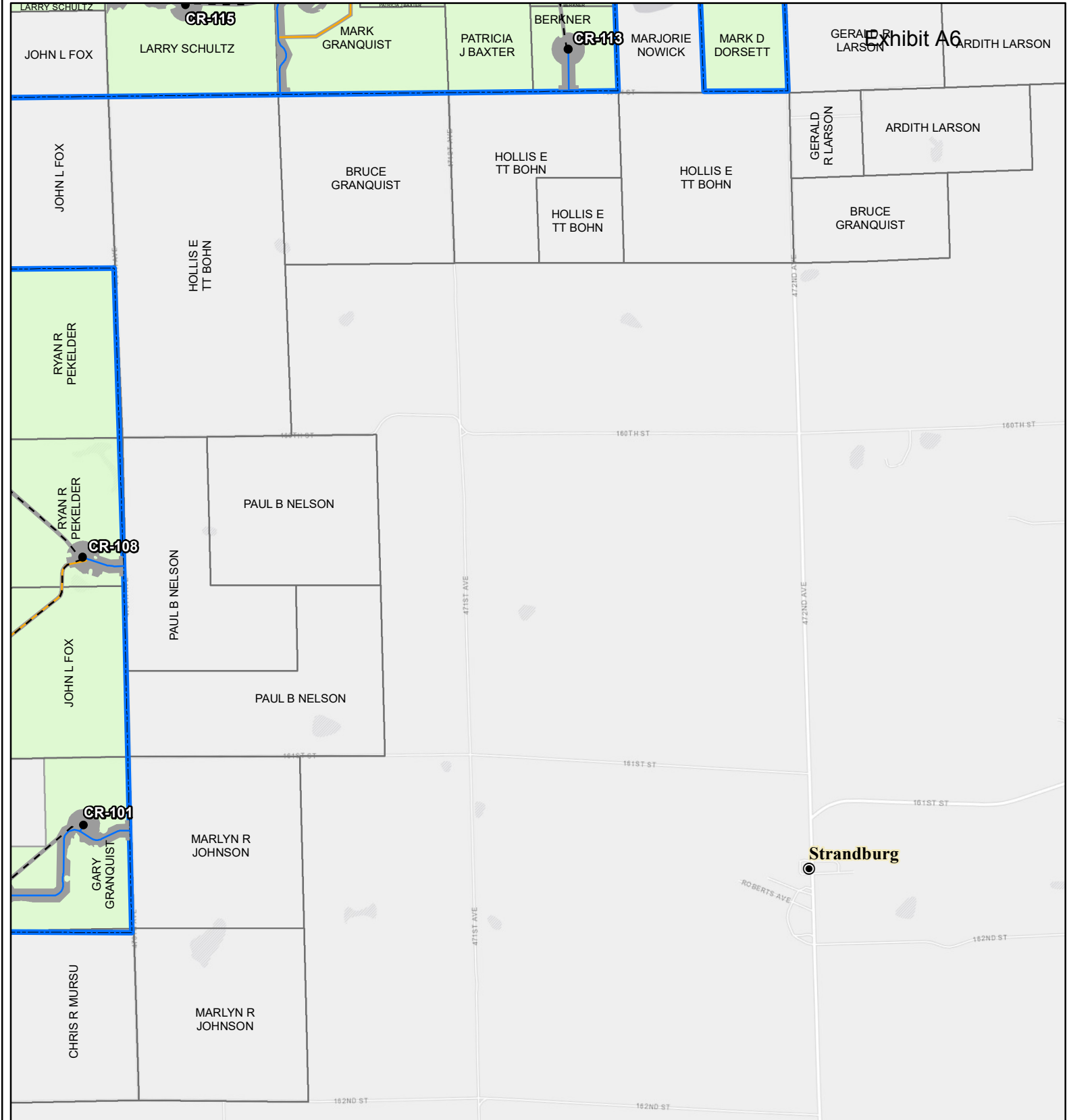

Exhibit A6

Figure 3a. Project Map
Crowned Ridge Wind Farm

- Turbine
 - ⊕ MET Tower
 - ⦿ City
 - Railroad
 - - - Collector Line
 - Proposed Turbine Access Road
 - Crane Path
 - O&M Facility/Substation
 - Construction Easement
 - Batch Plant
 - Laydown Yard
- Land_Status**
- Lease, Signed
 - Pending Approval
 - Parcel Boundary
 - Project Boundary
 - County Boundary



0 0.5 1
Kilometers

0 0.25 0.5
Miles

Service Layer Credits: Esri, HERE, Garmin, © OpenStreetMap contributors, and the GIS user community
Quadrangle: Stockholm (1973)

Township/Range: T119N, R50W, T118N, R50W
Grant County, South Dakota

Page 000017 **SWCA**
ENVIRONMENTAL CONSULTANTS

Projection: NAD 1983 UTM Zone 14N

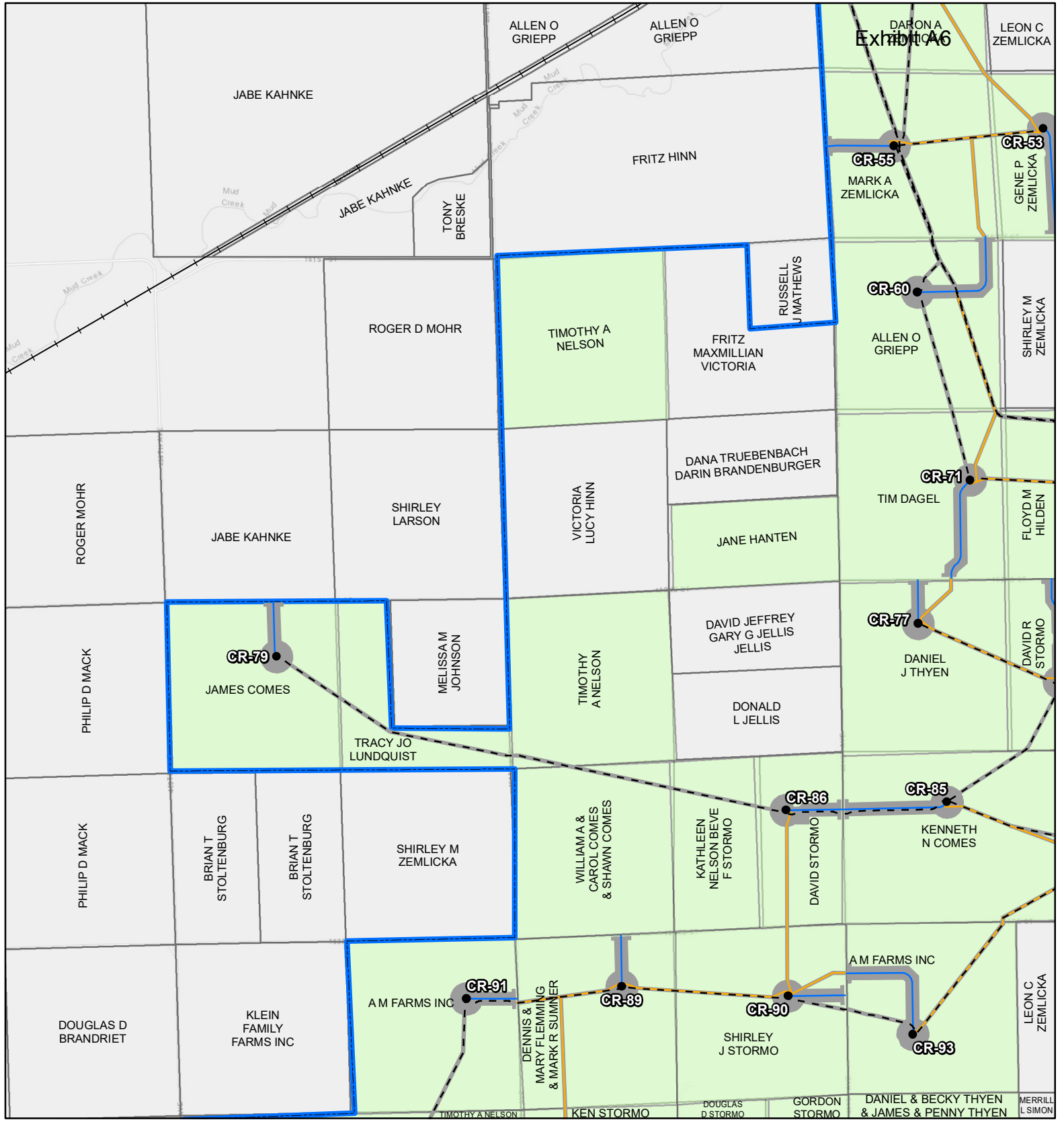

Figure 3a. Project Map
Crowned Ridge Wind Farm

- Turbine
 - ⊕ MET Tower
 - City
 - Railroad
 - - - Collector Line
 - Proposed Turbine Access Road
 - Crane Path
 - O&M Facility/Substation
 - Construction Easement
 - Batch Plant
 - Laydown Yard
- Land_Status**
- Lease, Signed
 - Pending Approval
 - Parcel Boundary
 - Project Boundary
 - County Boundary



Kilometers
 0 0.5 1
 Miles
 0 0.25 0.5

Service Layer Credits: Esri, HERE, Garmin,
 © OpenStreetMap contributors, and the GIS user
 community
 Quadrangle: Still Lake SE (1970),
 South Shore (1973)
 Township/Range: T118N, R52W,
 T118N, R51W
 Codington County, South Dakota

Page 000018 **SWCA**
 ENVIRONMENTAL CONSULTANTS

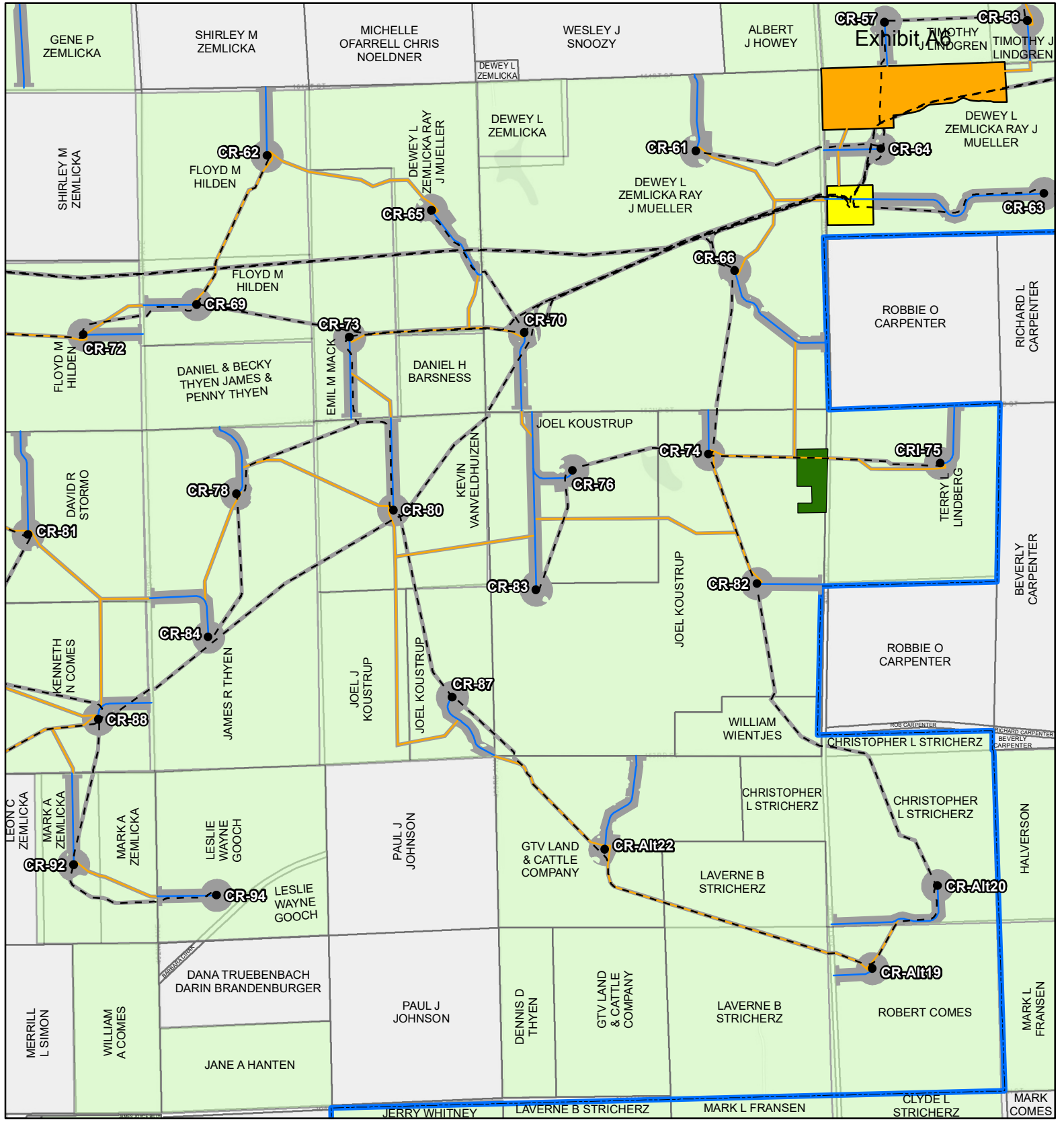

Figure 3a. Project Map
Crowned Ridge Wind Farm

- Turbine
 - ⊕ MET Tower
 - City
 - Railroad
 - - - Collector Line
 - Proposed Turbine Access Road
 - Crane Path
 - O&M Facility/ Substation
 - Construction Easement
 - Batch Plant
 - Laydown Yard
- Land_Status**
- Lease, Signed
 - Pending Approval
 - Parcel Boundary
 - Project Boundary
 - County Boundary



Kilometers
0 0.5 1

Miles
0 0.25 0.5

Service Layer Credits: Esri, HERE, Garmin, © OpenStreetMap contributors, and the GIS user community
Quadrangle: South Shore (1973)

Township/Range: T118N, R51W

Codington County, South Dakota

Page 000019 **SWCA**
ENVIRONMENTAL CONSULTANTS

Projection: NAD 1983 UTM Zone 14N

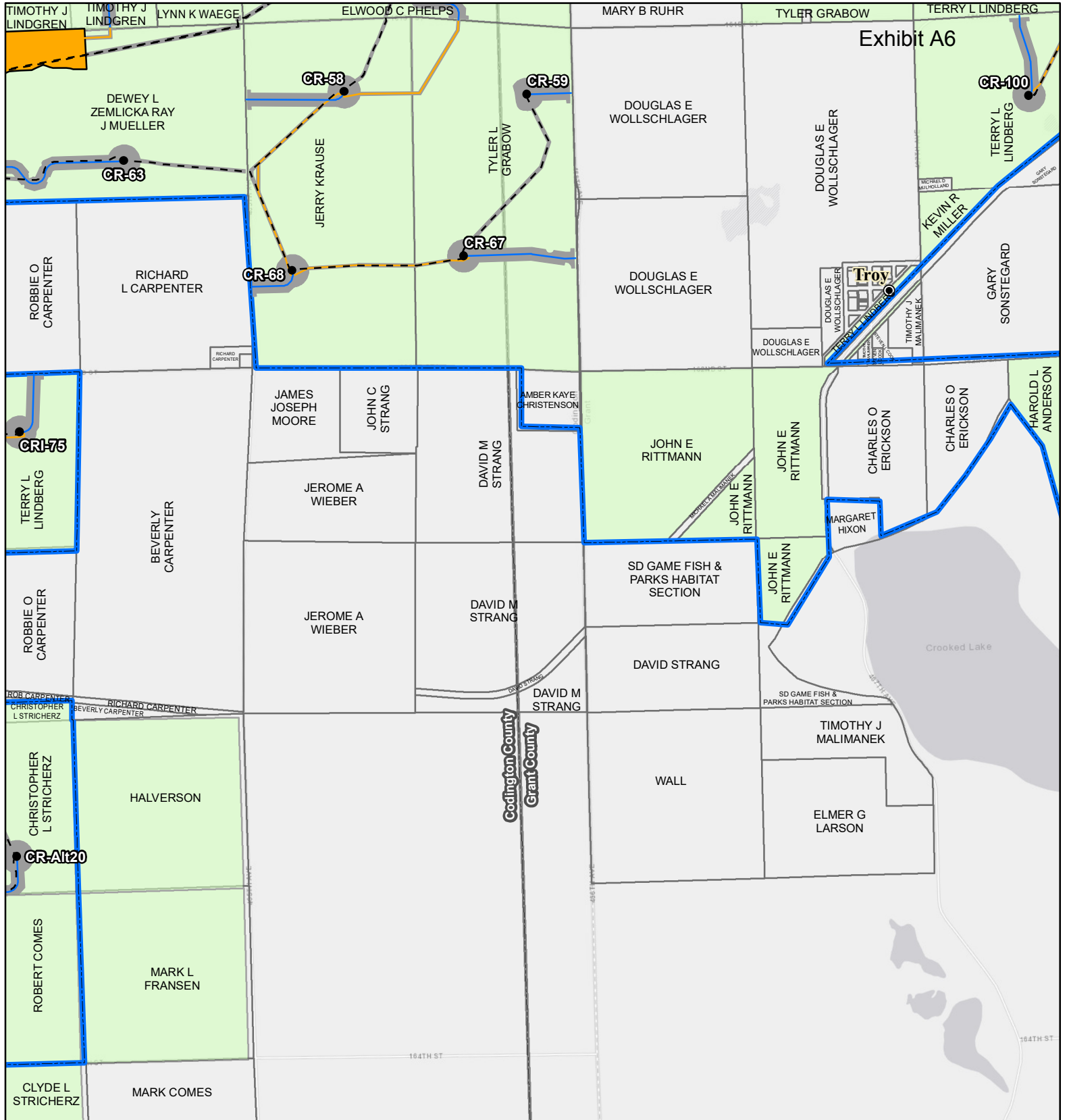
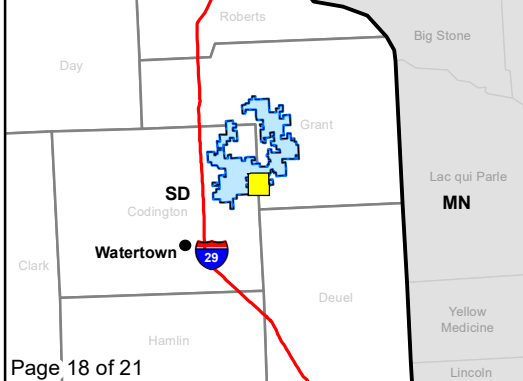

Exhibit A6

Figure 3a. Project Map
Crowned Ridge Wind Farm

- Turbine
- ⊕ MET Tower
- City
- Railroad
- - - Collector Line
- Proposed Turbine Access Road
- Crane Path
- O&M Facility/Substation
- Construction Easement
- Batch Plant
- Laydown Yard
- Land_Status**
- Lease, Signed
- Pending Approval
- Parcel Boundary
- Project Boundary
- County Boundary



Kilometers
 0 0.5 1
 Miles
 0 0.25 0.5

Service Layer Credits: Esri, HERE, Garmin,
 © OpenStreetMap contributors, and the GIS user
 community
 Quadrangle: South Shore (1973),
 Stockholm (1973)
 Township/Range: T118N, R51W,
 T118N, R50W
 Codrington and Grant Counties, South Dakota

Page 000020 **SWCA**
 ENVIRONMENTAL CONSULTANTS

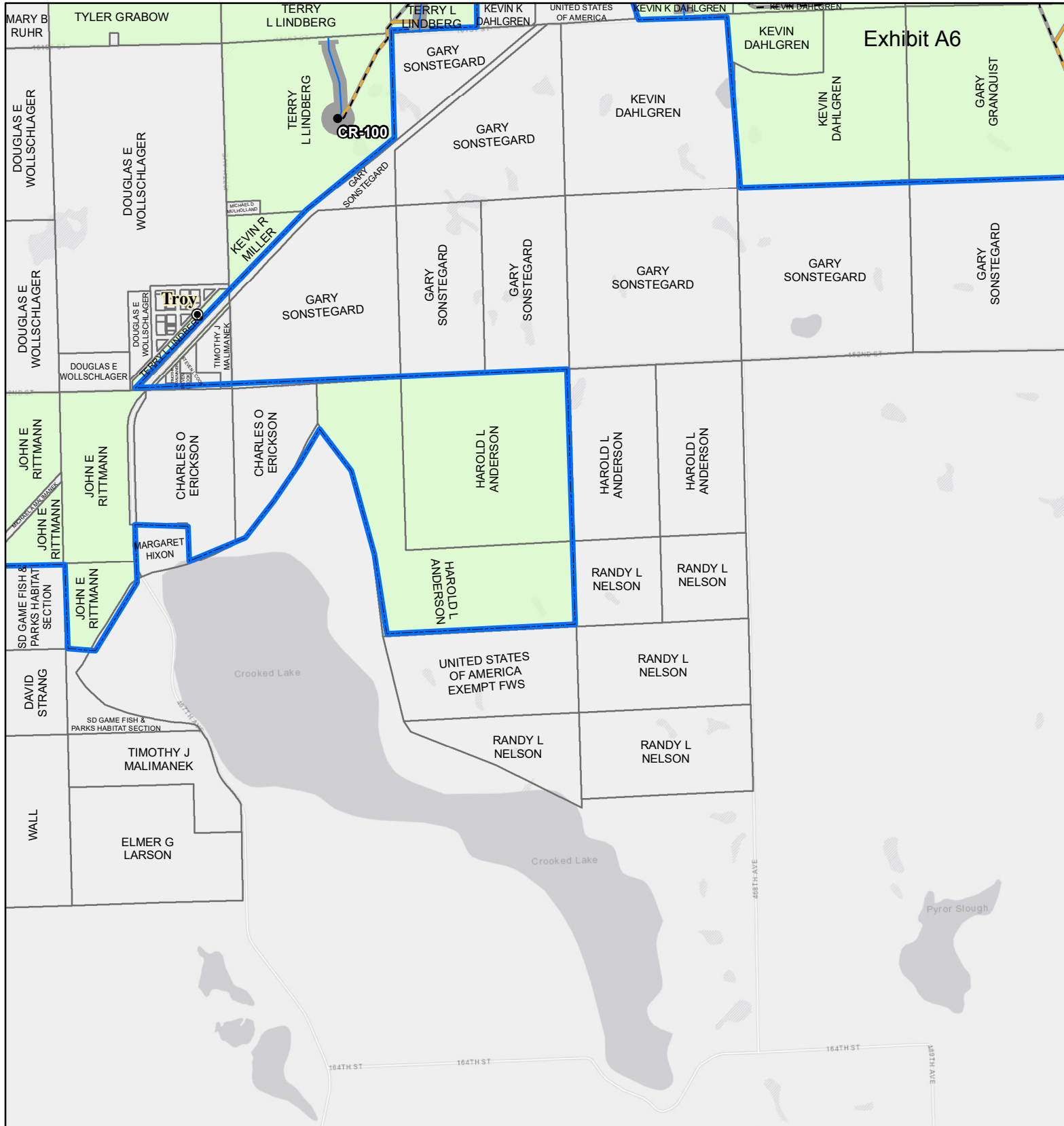

Exhibit A6

Figure 3a. Project Map
Crowned Ridge Wind Farm

- Turbine
- ⊕ MET Tower
- City
- Railroad
- - - Collector Line
- Proposed Turbine Access Road
- Crane Path
- O&M Facility/Substation
- Construction Easement
- Batch Plant
- Laydown Yard
- Land_Status**
- Lease Status**
- Lease, Signed
- Pending Approval
- Parcel Boundary
- Project Boundary
- County Boundary



0 0.5 1
Kilometers

0 0.25 0.5
Miles

Service Layer Credits: Esri, HERE, Garmin, © OpenStreetMap contributors, and the GIS user community
 Quadrangle: South Shore (1973), Stockholm (1973)
 Township/Range: T118N, R50W

Grant County, South Dakota
Page 000021 **SWCA**
 ENVIRONMENTAL CONSULTANTS

Projection: NAD 1983 UTM Zone 14N

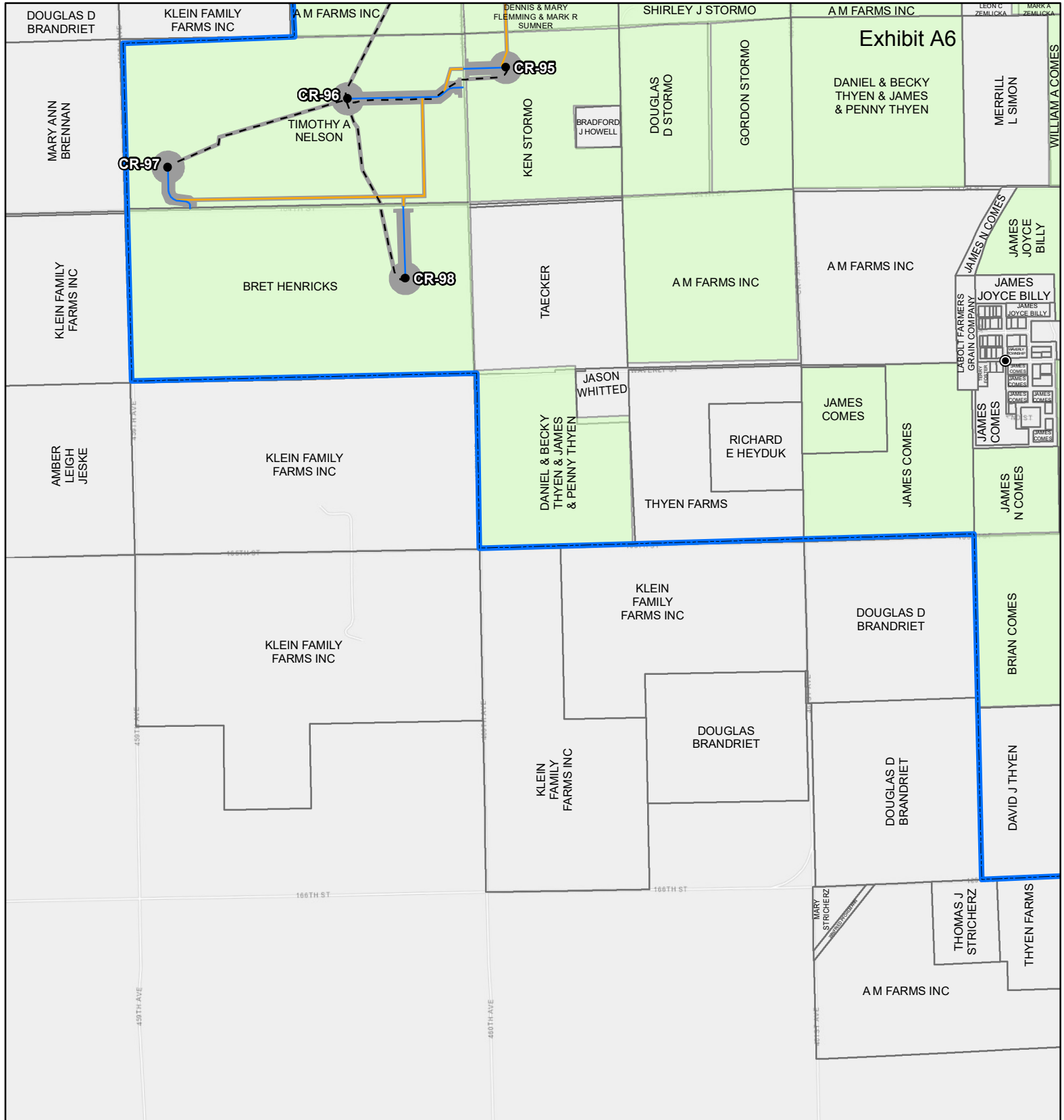
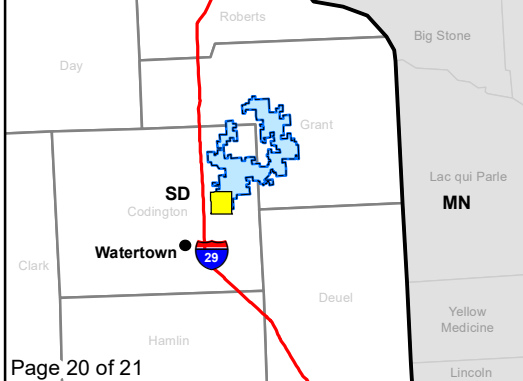

Figure 3a. Project Map
Crowned Ridge Wind Farm

- Turbine
- ⊕ MET Tower
- ⊙ City
- Railroad
- - - Collector Line
- Proposed Turbine Access Road
- Crane Path
- O&M Facility/Substation
- Construction Easement
- Batch Plant
- Laydown Yard
- Land_Status**
- Lease Status**
- Lease, Signed
- Pending Approval
- Parcel Boundary
- Project Boundary
- County Boundary



Kilometers
0 0.5 1

Miles
0 0.25 0.5

Service Layer Credits: Esri, HERE, Garmin, © OpenStreetMap contributors, and the GIS user community
 Quadrangle: Still Lake SE (1970), Watertown East (1969), South Shore (1973), Kranzburg (1970)
 Township/Range: T118N, R52W, T118N, R51W, T117N, R52W, T117N, R51W
 Codington County, South Dakota

Page 000022 **SWCA**
ENVIRONMENTAL CONSULTANTS

Projection: NAD 1983 UTM Zone 14N

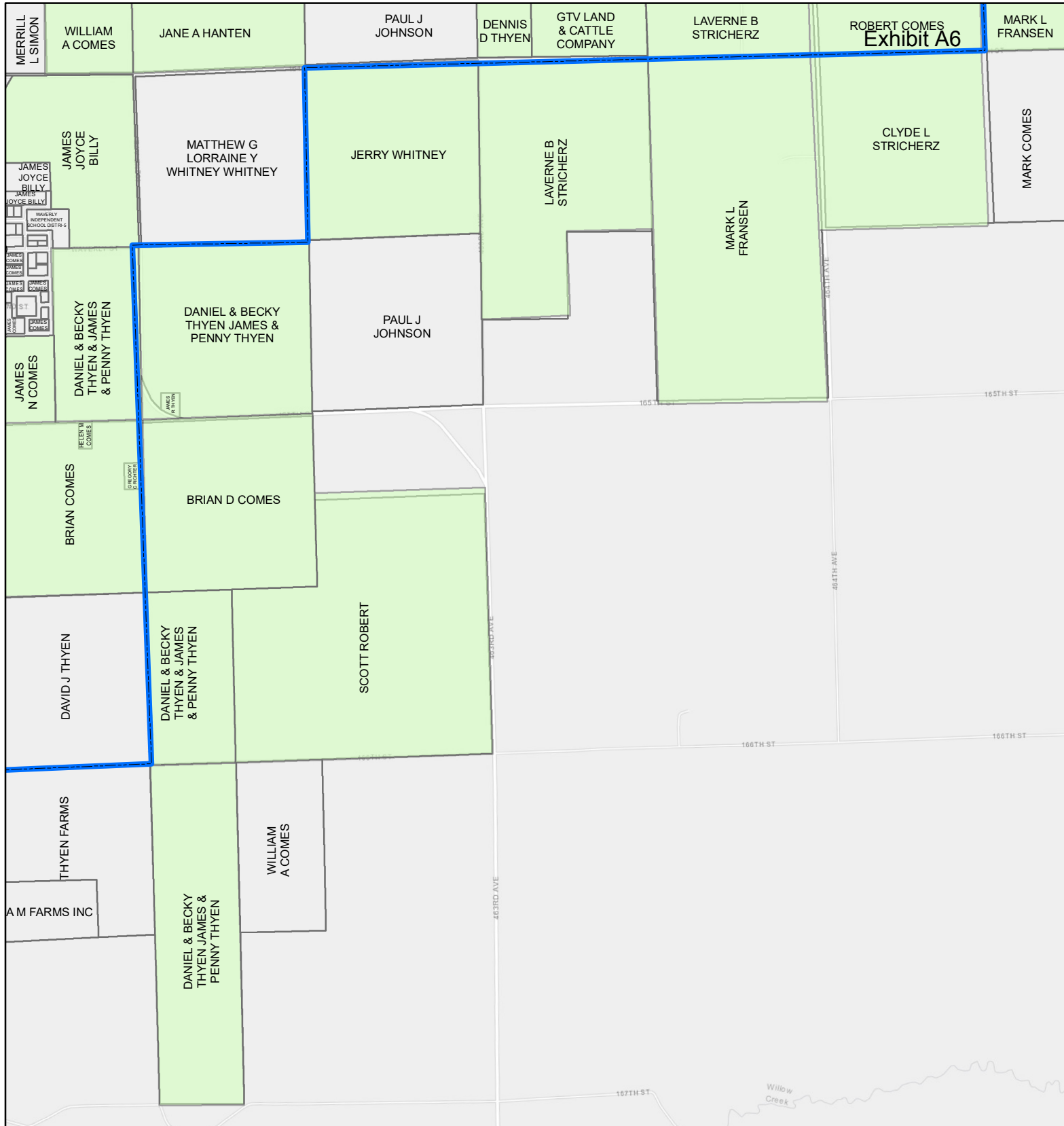

Figure 3a. Project Map
Crowned Ridge Wind Farm

- Turbine
- ⊕ MET Tower
- City
- Railroad
- - - Collector Line
- Proposed Turbine Access Road
- Crane Path
- O&M Facility/ Substation
- Construction Easement
- Batch Plant
- Laydown Yard
- Land_Status**
- Lease Status**
- Lease, Signed
- Pending Approval
- Parcel Boundary
- Project Boundary
- County Boundary



Kilometers
 0 0.5 1
 Miles
 0 0.25 0.5

Service Layer Credits: Esri, HERE, Garmin, © OpenStreetMap contributors, and the GIS user community
 Quadrangle: South Shore (1973), Kranzburg (1970)
 Township/Range: T118N, R51W, T117N, R51W
 Codington County, South Dakota

Page 000023 **SWCA**
 ENVIRONMENTAL CONSULTANTS

Projection: NAD 1983 UTM Zone 14N