

Offsets \_\_\_\_\_ Date \_\_\_\_\_ Ckd \_\_\_\_\_  
 Revised \_\_\_\_\_ Date \_\_\_\_\_ Ckd \_\_\_\_\_  
 Totaled \_\_\_\_\_ Date \_\_\_\_\_ Ckd \_\_\_\_\_  
 Rev. As Const WMS Date 1-25-49 Ckd \_\_\_\_\_

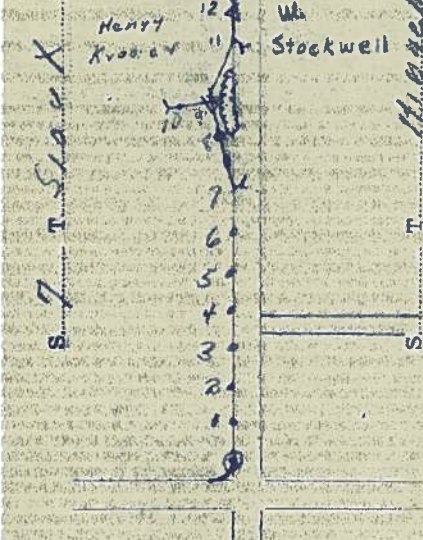

M. A. K. S. H. (S. O.)

Offset	Span	Stake No.	PRIMARY				SECONDARY					SERVICE									
			Poles		Assemblies		Guys	Lead	Anchors	Keys	Guards	Grounds	Pole No.	Trans.	Assemblies		Conductor		Wireholder	No. 6 W. P.	
			Misc. Sizes	Rake	A	Misc.									Poles	Misc.	Size and Type	Wires			Length
-1	290	12	40-50	A5	2-E12	30w	F12	1				6663		3							Meter on this Pole
-3	335	11	35-52W	A2	E12	8ME	F12	1													
Set	4	10					E12	85	F12	1			30-6	3							# 3 118
1E	167	9	35-50	A2	E12	85	F12	1				6653		3							
1E	300	8	35-6	1																	
-3	400	7	35-52W	A2	E12	10i	F12	1													
-1	330	6	35-6	1																	
-1 1/2	320	5	35-6	1																	
-1	300	4	35-6	1																	
1/2	400	3	35-6	1																	
-3/2	370	2	40-6	1																	
-4/2	330	1	30-6	1																	



Ruling Span 385'  
 Lined at 344'

Pri. Conductor 2" AA-50  
 Feet of Line 3542

1-40-6  
 1-40-5  
 5-35-6  
 3-35-5  
 1-30-6

3-AZ  
 1-A5

6-E1-2 6-F1-2

1-666-3 1-30-6  
 1-665-3

W.O.

Offset indicates distance from Stake to Hole, + means towards road, - towards field.  
 REMARKS:

BROWN ENGINEERING CO., DES MOINES, ENGINEERS

PROJECT: Iowa, 50 kV line  
 Staked by EPM, Date 2-13-48 Lined by EPM, Date 2-24-48  
 Checked by \_\_\_\_\_ Date \_\_\_\_\_ Staking Sheet No. 200-4