

Appendix C
Agency Letters and Responses



April 25, 2008

Michael M Olson
Township Clerk
Argo Township
19829 475th Ave
White, SD 57276

RE: Buffalo Ridge II 210 MW Wind Project in Brookings County, South Dakota

Dear Mr. Olson:

HDR Engineering, Inc. (HDR) is currently gathering environmental information for a 210 Megawatts (MW) Wind Farm proposed by PPM Energy in Brookings County, South Dakota. PPM Energy has applied to interconnect the wind farm with Xcel Energy's Brookings County Substation near White, South Dakota. Because the project is over 100 MW in size, PPM Energy is required to apply for an Energy Facility Siting Permit through the South Dakota Public Utility Commission (SDPUC). Additionally, PPM will submit an application for a Conditional Use Permit for the proposed facility to the Brookings County Zoning office. HDR requests your review of the above-mentioned project to identify potential impacts from the project and any permits that the project might require.

Typically wind facility construction includes erecting wind turbines and constructing associated facilities such as gravel access roads, an underground collector system and overhead 34.5 kV and 115 kV transmission lines. Although final turbine locations, access roads and electrical connections have not been determined at this time, the table below identifies Township sections potentially affected by the project:

Township Name	Township	Range	Sections
Richland	111 N	47 W	6, 7, 18, 19, 30
Lake Hendricks	112 N	47 W	31
Sherman	111 N	48 W	1, 2, 3, 4, 12, 13, 24, 25
Oak Lake	112 N	48 W	1-11, 14-23, 25-30, 32-36
Argo	112 N	49 W	1-4, 10-14, 23-26

Your input on the project will assist PPM Energy and HDR in their review of this project. If we do not hear from you within 30 days, we will assume that you have no comment on the project at this time. This notification precedes publication of the SDPUC Energy Facility Siting Permit application but does not preclude subsequent review and comment on the documents after publication. Other formal opportunities to comment on the project will follow at a later date when public information meetings and public hearings are held, anticipated to occur in summer and fall 2008.

Enclosed is a project location map to facilitate your review. If you have any questions relating to this matter, please contact me at (763) 591-5443.

Sincerely,



Joyce E. Pickle
Environmental Scientist

Enclosures:
Project Location Map

Cc: Timothy Seck, PPM Energy Inc.
Sarah Emery, HDR Engineering Inc.

April 25, 2008

Mr. Doug Backlund
South Dakota Department of Game, Fish and Parks
Foss Building
523 East Capitol
Pierre, SD 57501-3182

RE: Buffalo Ridge II 210 MW Wind Project in Brookings County, South Dakota

Dear Mr. Backlund:

HDR Engineering, Inc. (HDR) is currently gathering environmental information for a 210 Megawatts (MW) Wind Farm proposed by PPM Energy in Brookings County, South Dakota. PPM Energy has applied to interconnect the wind farm with Xcel Energy's Brookings County Substation near White, South Dakota. Because the project is over 100 MW in size, PPM Energy is required to apply for an Energy Facility Siting Permit through the South Dakota Public Utility Commission (SDPUC). HDR requests your review of the above-mentioned project for potential effects to known federally- and state-listed threatened or endangered species and rare natural features.

Typically, wind facility construction includes erecting wind turbines and constructing associated facilities such as gravel access roads, an underground collector system and overhead 34.5 kV and 115 kV transmission lines. Although final turbine locations, access roads and electrical connections have not been determined at this time, the table below identifies sections potentially affected by the project:

Township Name	Township	Range	Sections
Richland	111 N	47 W	6, 7, 18, 19, 30
Lake Hendricks	112 N	47 W	31
Sherman	111 N	48 W	1, 2, 3, 4, 12, 13, 24, 25
Oak Lake	112 N	48 W	1-11, 14-23, 25-30, 32-36
Argo	112 N	49 W	1-4, 10-14, 23-26

Your input on the project will assist PPM Energy and HDR in their review of this project. If we do not hear from you within 30 days, we will assume that you have no comment on the project at this time. This notification precedes publication of the SDPUC Energy Facility Siting Permit application but does not preclude subsequent review and comment on the documents after publication. Other

formal opportunities to comment on the project will follow at a later date when public information meetings and public hearings are held, anticipated to occur in summer and fall 2008.

Enclosed is a project location map to facilitate your review. If you have any questions relating to this matter, please contact me at (763) 591-5443.

Sincerely,
HDR Engineering, Inc.



Joyce E. Pickle
Environmental Scientist

Enclosure: Project Location Map

Cc: Timothy Seck, PPM Energy Inc.
Sarah Emery, HDR Engineering Inc

April 25, 2008

Ms. Leslie Petersen
Environmental Review & Management
South Dakota Department of Game, Fish and Parks
Foss Building
523 East Capitol
Pierre, SD 57501-3182

RE: Buffalo Ridge II 210 MW Wind Project in Brookings County, South Dakota

Dear Ms. Petersen:

HDR Engineering, Inc. (HDR) is currently gathering environmental information for a 210 Megawatts (MW) Wind Farm proposed by PPM Energy in Brookings County, South Dakota. PPM Energy has applied to interconnect the wind farm with Xcel Energy's Brookings County Substation near White, South Dakota. Because the project is over 100 MW in size, PPM Energy is required to apply for an Energy Facility Siting Permit through the South Dakota Public Utility Commission (SDPUC). HDR requests your review of the above-mentioned project to identify potential impacts from the project and any permits that the project might require.

Typically, wind facility construction includes erecting wind turbines and constructing associated facilities such as gravel access roads, an underground collector system and overhead 34.5 kV and 115 kV transmission lines. Although final turbine locations, access roads and electrical connections have not been determined at this time, the table below identifies sections potentially affected by the project:

Township Name	Township	Range	Sections
Richland	111 N	47 W	6, 7, 18, 19, 30
Lake Hendricks	112 N	47 W	31
Sherman	111 N	48 W	1, 2, 3, 4, 12, 13, 24, 25
Oak Lake	112 N	48 W	1-11, 14-23, 25-30, 32-36
Argo	112 N	49 W	1-4, 10-14, 23-26

Your input on the project will assist PPM Energy and HDR in their review of this project. If we do not hear from you within 30 days, we will assume that you have no comment on the project at this time. This notification precedes publication of the SDPUC Energy Facility Siting Permit application but does not preclude subsequent review and comment on the documents after publication. Other

formal opportunities to comment on the project will follow at a later date when public information meetings and public hearings are held, anticipated to occur in summer and fall 2008.

Enclosed is a project location map to facilitate your review. If you have any questions relating to this matter, please contact me at (763) 591-5443.

Sincerely,
HDR Engineering, Inc.



Joyce E. Pickle
Environmental Scientist

Enclosure: Project Location Map

Cc: Timothy Seck, PPM Energy Inc.
Sarah Emery, HDR Engineering Inc



April 25, 2008

Ms. Paige Hoskinson Olson
South Dakota State Historical Society
Cultural Heritage Center
Pierre, SD 57501-2217

RE: Buffalo Ridge II 210 MW Wind Project in Brookings County, South Dakota

Dear Ms. Hoskinson Olson:

HDR Engineering, Inc. (HDR) is currently gathering environmental information for a 210 Megawatts (MW) Wind Farm proposed by PPM Energy in Brookings County, South Dakota. PPM Energy has applied to interconnect the wind farm with Xcel Energy's Brookings County Substation near White, South Dakota. Because the project is over 100 MW in size, PPM Energy is required to apply for an Energy Facility Siting Permit through the South Dakota Public Utility Commission (SDPUC). The SD Energy Facility Siting Rules require applicants to describe and forecast impacts on cultural resources including "places of historical significance" and "landmarks and cultural resources of historic, religious, archaeological, scenic, natural, or other cultural significance." While coordination with the State Historic Preservation Office (SHPO) is not required during the SDPUC application process, PPM recognizes that your office has a keen interest in the cultural resources of South Dakota and their protection. We welcome any comments the SHPO may have at this time or throughout the permit application process.

Typically wind facility construction includes erecting wind turbines and constructing associated facilities such as gravel access roads, an underground collector system and overhead 34.5 kV and 115 kV transmission lines. Although final turbine locations, access roads and electrical connections have not been determined at this time, the table below identifies Township sections potentially affected by the project:

Township Name	Township	Range	Sections
Richland	111 N	47 W	6, 7, 18, 19, 30
Lake Hendricks	112 N	47 W	31
Sherman	111 N	48 W	1, 2, 3, 4, 12, 13, 24, 25
Oak Lake	112 N	48 W	1-11, 14-23, 25-30, 32-36
Argo	112 N	49 W	1-4, 10-14, 23-26

PPM intends to review existing databases at your office and the South Dakota State Archaeological Research Center (SARC) and other archival sources for information on previously identified cultural

HDR Engineering, Inc.

701 Xenia Avenue South
Minneapolis, MN 55416-3636

Phone (763) 591-5400
Fax (763) 591-5413
www.hdrinc.com

resources in these areas. PPM may also sponsor additional cultural resources desktop and/or field studies for the project. Should PPM deem it necessary to perform such studies, the results would be forwarded to SHPO and SARC to solicit comment and/or to place the results in the archival record. PPM sponsored archaeological field investigations for previous projects in South Dakota (MinnDakota Wind project and Buffalo Ridge I Wind Project) and followed a similar agency notification process.

This letter notification precedes publication of the SDPUC Energy Facility Siting Permit application but does not preclude subsequent review and comment on the documents after publication. Other formal opportunities to comment on the project will follow at a later date when public information meetings and public hearings are held, anticipated to occur in summer and fall 2008. We welcome SHPO input at any time during the permit application and review process; however, input on the project at this early stage would greatly assist PPM Energy and HDR in their review of this project.

Enclosed is a project location map to facilitate a review. If you have any questions relating to this matter, please contact me at (763) 591-5443.

Sincerely,



Joyce E. Pickle
Environmental Scientist

Enclosures:
Project Location Map

Cc: Timothy Seck, PPM Energy Inc.
Sarah Emery, HDR Engineering Inc.
Michael Madson, HDR Engineering, Inc.



April 25, 2008

Mr. Steve Naylor
Regulatory Program Manager
U.S. Army Corps of Engineers
28563 Powerhouse Road, Room 118
Pierre, SD 57501

RE: Buffalo Ridge II 210 MW Wind Project in Brookings County, South Dakota

Dear Mr. Naylor:

HDR Engineering, Inc. (HDR) is currently gathering environmental information for a 210 Megawatts (MW) Wind Farm proposed by PPM Energy in Brookings County, South Dakota. PPM Energy has applied to interconnect the wind farm with Xcel Energy's Brookings County Substation near White, South Dakota. Because the project is over 100 MW in size, PPM Energy is required to apply for an Energy Facility Siting Permit through the South Dakota Public Utility Commission (SDPUC). HDR requests your review of the above-mentioned project to identify potential impacts from the project and any permits that the project might require.

Typically wind facility construction includes erecting wind turbines and constructing associated facilities such as gravel access roads, an underground collector system and overhead 34.5 kV and 115 kV transmission lines. Although final turbine locations, access roads, and electrical connections have not been determined at this time, the table below identifies sections potentially affected by the project:

Township Name	Township	Range	Sections
Richland	111 N	47 W	6, 7, 18, 19, 30
Lake Hendricks	112 N	47 W	31
Sherman	111 N	48 W	1, 2, 3, 4, 12, 13, 24, 25
Oak Lake	112 N	48 W	1-11, 14-23, 25-30, 32-36
Argo	112 N	49 W	1-4, 10-14, 23-26

Your input on the project will assist PPM Energy and HDR in their review of this project. If we do not hear from you within 30 days, we will assume that you have no comment on the project at this time. This notification precedes publication of the SDPUC Energy Facility Siting Permit application

HDR Engineering, Inc.

701 Xenia Avenue South
Minneapolis, MN 55416-3636

Phone (763) 591-5400
Fax (763) 591-5413
www.hdrinc.com

but does not preclude subsequent review and comment on the documents after publication. Other formal opportunities to comment on the project will follow at a later date when public information meetings and public hearings are held, anticipated to occur in summer and fall 2008.

Enclosed is a project location map to facilitate your review. If you have any questions relating to this matter, please contact me at (763) 591-5443.

Sincerely,



Joyce E. Pickle
Environmental Scientist

Enclosures:
Project Location Map

Cc: Timothy Seck, PPM Energy Inc.
Sarah Emery, HDR Engineering Inc.



April 25, 2008

Ms. Natalie Gates
U.S. Fish and Wildlife Service
Ecological Services
420 South Garfield Avenue, Suite 400
Pierre, SD 57501-5408

RE: Buffalo Ridge II 210 MW Wind Project in Brookings County, South Dakota

Dear Ms. Gates:

HDR Engineering, Inc. (HDR) is currently gathering environmental information for a 200 Megawatts (MW) Wind Farm proposed by PPM Energy in Brookings County, South Dakota. PPM Energy has applied to interconnect the wind farm with Xcel Energy's Brookings County Substation near White, South Dakota. Because the project is over 100 MW in size, PPM Energy is required to apply for an Energy Facility Siting Permit through the South Dakota Public Utility Commission (SDPUC). HDR requests your review of the above-mentioned project for potential effects to known federally-listed threatened or endangered species and rare natural features.

Typically wind facility construction includes erecting wind turbines and constructing associated facilities such as gravel access roads, an underground collector system and overhead 34.5 kV and 115 kV transmission lines. Although final turbine locations, access roads and electrical connections have not been determined at this time, the table below identifies Township sections potentially affected by the project:

Township Name	Township	Range	Sections
Richland	111 N	47 W	6, 7, 18, 19, 30
Lake Hendricks	112 N	47 W	31
Sherman	111 N	48 W	1, 2, 3, 4, 12, 13, 24, 25
Oak Lake	112 N	48 W	1-11, 14-23, 25-30, 32-36
Argo	112 N	49 W	1-4, 10-14, 23-26

Your input on the project will assist PPM Energy and HDR in their review of this project. If we do not hear from you within 30 days, we will assume that you have no comment on the project at this time. This notification precedes publication of the SDPUC Energy Facility Siting Permit application but does not preclude subsequent review and comment on the documents after publication. Other

formal opportunities to comment on the project will follow at a later date when public information meetings and public hearings are held, anticipated to occur in summer and fall 2008.

Enclosed is a project location map to facilitate your review. If you have any questions relating to this matter, please contact me at (763) 591-5443.

Sincerely,



Joyce E. Pickle
Environmental Scientist

Enclosures:
Project Location Map

Cc: Timothy Seck, PPM Energy Inc.
Sarah Emery, HDR Engineering Inc.



April 25, 2008

Mr. Tedd Eggebratten
Superintendent
Brookings County Highway Department
422 Western Avenue
Brookings, SD 57006

RE: Buffalo Ridge II 210 MW Wind Project in Brookings County, South Dakota

Dear Mr. Eggerbratten:

HDR Engineering, Inc. (HDR) is currently gathering environmental information for a 200 Megawatts (MW) Wind Farm proposed by PPM Energy in Brookings County, South Dakota. PPM Energy has applied to interconnect the wind farm with Xcel Energy's Brookings County Substation near White, South Dakota. Because the project is over 100 MW in size, PPM Energy is required to apply for an Energy Facility Siting Permit through the South Dakota Public Utility Commission (SDPUC). Additionally, PPM will submit an application for a Conditional Use Permit for the proposed facility to the Brookings County Zoning Office. HDR requests your review of the above-mentioned project to identify potential impacts from the project and any permits that the project might require.

Typically wind facility construction includes erecting wind turbines and constructing associated facilities such as gravel access roads, an underground collector system and overhead 34.5 kV and 115 kV transmission lines. Although final turbine locations, access roads, and electrical connections have not been determined at this time, the table below identifies Township sections potentially affected by the project:

Township Name	Township	Range	Sections
Richland	111 N	47 W	6, 7, 18, 19, 30
Lake Hendricks	112 N	47 W	31
Sherman	111 N	48 W	1, 2, 3, 4, 12, 13, 24, 25
Oak Lake	112 N	48 W	1-11, 14-23, 25-30, 32-36
Argo	112 N	49 W	1-4, 10-14, 23-26

Your input on the project will assist PPM Energy and HDR in their review of this project. If we do not hear from you within 30 days, we will assume that you have no comment on the project at this

HDR Engineering, Inc.

701 Xenia Avenue South
Minneapolis, MN 55416-3636

Phone (763) 591-5400
Fax (763) 591-5413
www.hdrinc.com

time. This notification precedes publication of the SDPUC Energy Facility Siting Permit application but does not preclude subsequent review and comment on the documents after publication. Other formal opportunities to comment on the project will follow at a later date when public information meetings and public hearings are held, anticipated to occur in summer and fall 2008.

Enclosed is a project location map to facilitate your review. If you have any questions relating to this matter, please contact me at (763) 591-5443.

Sincerely,



Joyce E. Pickle
Environmental Scientist

Enclosures:
Project Location Map

Cc: Timothy Seck, PPM Energy Inc.
Sarah Emery, HDR Engineering Inc.



ONE COMPANY | Many Solutions

April 25, 2008

Mr. Robert Hill
Supervisor
Brookings County Zoning & Drainage Office
County Resource Center
826 32nd Avenue
Brookings, SD 57006

RE: Buffalo Ridge II 210 MW Wind Project in Brookings County, South Dakota

Dear Mr. Hill:

HDR Engineering, Inc. (HDR) is currently gathering environmental information for a 210 Megawatts (MW) Wind Farm proposed by PPM Energy in Brookings County, South Dakota. PPM Energy has applied to interconnect the wind farm with Xcel Energy's Brookings County Substation near White, South Dakota. Because the project is over 100 MW in size, PPM Energy is required to apply for an Energy Facility Siting Permit through the South Dakota Public Utility Commission (SDPUC). Additionally, PPM will submit an application for a Conditional Use Permit for the proposed facility to your office. HDR requests your review of the above-mentioned project to identify potential impacts from the project and any permits that the project might require.

Typically wind facility construction includes erecting wind turbines and constructing associated facilities such as gravel access roads, an underground collector system and overhead 34.5 kV and 115 kV transmission lines. Although final turbine locations, access roads and electrical connections have not been determined at this time, the table below identifies Township sections potentially affected by the project:

Township Name	Township	Range	Sections
Richland	111 N	47 W	6, 7, 18, 19, 30
Lake Hendricks	112 N	47 W	31
Sherman	111 N	48 W	1, 2, 3, 4, 12, 13, 24, 25
Oak Lake	112 N	48 W	1-11, 14-23, 25-30, 32-36

HDR Engineering, Inc.

701 Xenia Avenue South
Minneapolis, MN 55416-3636

Phone (763) 591-5400
Fax (763) 591-5413
www.hdrinc.com

Argo	112 N	49 W	1-4, 10-14, 23-26
------	-------	------	-------------------

Your input on the project will assist PPM Energy and HDR in their review of this project. If we do not hear from you within 30 days, we will assume that you have no comment on the project at this time. This notification precedes publication of the SDPUC Energy Facility Siting Permit application but does not preclude subsequent review and comment on the documents after publication. Other formal opportunities to comment on the project will follow at a later date when public information meetings and public hearings are held, anticipated to occur in summer and fall 2008.

Enclosed is a project location map to facilitate your review. If you have any questions relating to this matter, please contact me at (763) 591-5443.

Sincerely,



Joyce E. Pickle
Environmental Scientist

Enclosures:
Project Location Map

Cc: Timothy Seck, PPM Energy Inc.
Sarah Emery, HDR Engineering Inc.



April 25, 2008

Thomas W Reeves
Township Clerk
Lake Hendricks Township
Box 6
Hendricks MN 56136

RE: Buffalo Ridge II 210 MW Wind Project in Brookings County, South Dakota

Dear Mr. Reeves:

HDR Engineering, Inc. (HDR) is currently gathering environmental information for a 210 Megawatts (MW) Wind Farm proposed by PPM Energy in Brookings County, South Dakota. PPM Energy has applied to interconnect the wind farm with Xcel Energy's Brookings County Substation near White, South Dakota. Because the project is over 100 MW in size, PPM Energy is required to apply for an Energy Facility Siting Permit through the South Dakota Public Utility Commission (SDPUC). Additionally, PPM will submit an application for a Conditional Use Permit for the proposed facility to the Brookings County Zoning office. HDR requests your review of the above-mentioned project to identify potential impacts from the project and any permits that the project might require.

Typically wind facility construction includes erecting wind turbines and constructing associated facilities such as gravel access roads, an underground collector system and overhead 34.5 kV and 115 kV transmission lines. Although final turbine locations, access roads and electrical connections have not been determined at this time, the table below identifies Township sections potentially affected by the project:

Township Name	Township	Range	Sections
Richland	111 N	47 W	6, 7, 18, 19, 30
Lake Hendricks	112 N	47 W	31
Sherman	111 N	48 W	1, 2, 3, 4, 12, 13, 24, 25
Oak Lake	112 N	48 W	1-11, 14-23, 25-30, 32-36
Argo	112 N	49 W	1-4, 10-14, 23-26

Your input on the project will assist PPM Energy and HDR in their review of this project. If we do not hear from you within 30 days, we will assume that you have no comment on the project at this time. This notification precedes publication of the SDPUC Energy Facility Siting Permit application but does not preclude subsequent review and comment on the documents after publication. Other formal opportunities to comment on the project will follow at a later date when public information meetings and public hearings are held, anticipated to occur in summer and fall 2008.

Enclosed is a project location map to facilitate your review. If you have any questions relating to this matter, please contact me at (763) 591-5443.

Sincerely,



Joyce E. Pickle
Environmental Scientist

Enclosures:
Project Location Map

Cc: Timothy Seck, PPM Energy Inc.
Sarah Emery, HDR Engineering Inc.



April 25, 2008

Mr. Darrell Granbois
USDA – NRCS
Brookings County Field Office
205 6th Street
Brookings, SD 57006

RE: Buffalo Ridge II 210 MW Wind Project in Brookings County, South Dakota

Dear Mr. Granbois:

HDR Engineering, Inc. (HDR) is currently gathering environmental information for a 210 Megawatts (MW) Wind Farm proposed by PPM Energy in Brookings County, South Dakota. PPM Energy has applied to interconnect the wind farm with Xcel Energy's Brookings County Substation near White, South Dakota. Because the project is over 100 MW in size, PPM Energy is required to apply for an Energy Facility Siting Permit through the South Dakota Public Utility Commission (SDPUC). HDR requests your review of the above-mentioned project to identify potential impacts from the project and any permits that the project might require.

Typically wind facility construction includes erecting wind turbines and constructing associated facilities such as gravel access roads, an underground collector system and overhead 34.5 kV and 115 kV transmission lines. Although final turbine locations, access roads, and electrical connections have not been determined at this time, the table below identifies Township sections potentially affected by the project:

Township Name	Township	Range	Sections
Richland	111 N	47 W	6, 7, 18, 19, 30
Lake Hendricks	112 N	47 W	31
Sherman	111 N	48 W	1, 2, 3, 4, 12, 13, 24, 25
Oak Lake	112 N	48 W	1-11, 14-23, 25-30, 32-36
Argo	112 N	49 W	1-4, 10-14, 23-26

Your input on the project will assist PPM Energy and HDR in their review of this project. If we do not hear from you within 30 days, we will assume that you have no comment on the project at this time. This notification precedes publication of the SDPUC Energy Facility Siting Permit application but does not preclude subsequent review and comment on the documents after publication. Other formal opportunities to comment on the project will follow at a later date when public information meetings and public hearings are held, anticipated to occur in summer and fall 2008.

Enclosed is a project location map to facilitate your review. If you have any questions relating to this matter, please contact me at (763) 591-5443.

Sincerely,



Joyce E. Pickle
Environmental Scientist

Enclosures:
Project Location Map

Cc: Timothy Seck, PPM Energy Inc.
Sarah Emery, HDR Engineering Inc.



April 25, 2008

Norris Patrick
Township Clerk
Oak Lake Township
20062 482nd Ave
White, SD 57276

RE: Buffalo Ridge II 210 MW Wind Project in Brookings County, South Dakota

Dear Mr. Patrick:

HDR Engineering, Inc. (HDR) is currently gathering environmental information for a 210 Megawatts (MW) Wind Farm proposed by PPM Energy in Brookings County, South Dakota. PPM Energy has applied to interconnect the wind farm with Xcel Energy's Brookings County Substation near White, South Dakota. Because the project is over 100 MW in size, PPM Energy is required to apply for an Energy Facility Siting Permit through the South Dakota Public Utility Commission (SDPUC). Additionally, PPM will submit an application for a Conditional Use Permit for the proposed facility to the Brookings County Zoning office. HDR requests your review of the above-mentioned project to identify potential impacts from the project and any permits that the project might require.

Typically wind facility construction includes erecting wind turbines and constructing associated facilities such as gravel access roads, an underground collector system and overhead 34.5 kV and 115 kV transmission lines. Although final turbine locations, access roads and electrical connections have not been determined at this time, the table below identifies Township sections potentially affected by the project:

Township Name	Township	Range	Sections
Richland	111 N	47 W	6, 7, 18, 19, 30
Lake Hendricks	112 N	47 W	31
Sherman	111 N	48 W	1, 2, 3, 4, 12, 13, 24, 25
Oak Lake	112 N	48 W	1-11, 14-23, 25-30, 32-36
Argo	112 N	49 W	1-4, 10-14, 23-26

Your input on the project will assist PPM Energy and HDR in their review of this project. If we do not hear from you within 30 days, we will assume that you have no comment on the project at this time. This notification precedes publication of the SDPUC Energy Facility Siting Permit application but does not preclude subsequent review and comment on the documents after publication. Other formal opportunities to comment on the project will follow at a later date when public information meetings and public hearings are held, anticipated to occur in summer and fall 2008.

Enclosed is a project location map to facilitate your review. If you have any questions relating to this matter, please contact me at (763) 591-5443.

Sincerely,



Joyce E. Pickle
Environmental Scientist

Enclosures:
Project Location Map

Cc: Timothy Seck, PPM Energy Inc.
Sarah Emery, HDR Engineering Inc.



April 25, 2008

Sharon Leiferman
Township Clerk
Richland Township
20584 486th Ave
White, SD 57276

RE: Buffalo Ridge II 210 MW Wind Project in Brookings County, South Dakota

Dear Ms Leiferman.:

HDR Engineering, Inc. (HDR) is currently gathering environmental information for a 210 Megawatts (MW) Wind Farm proposed by PPM Energy in Brookings County, South Dakota. PPM Energy has applied to interconnect the wind farm with Xcel Energy's Brookings County Substation near White, South Dakota. Because the project is over 100 MW in size, PPM Energy is required to apply for an Energy Facility Siting Permit through the South Dakota Public Utility Commission (SDPUC). Additionally, PPM will submit an application for a Conditional Use Permit for the proposed facility to the Brookings County Zoning office. HDR requests your review of the above-mentioned project to identify potential impacts from the project and any permits that the project might require.

Typically wind facility construction includes erecting wind turbines and constructing associated facilities such as gravel access roads, an underground collector system and overhead 34.5 kV and 115 kV transmission lines. Although final turbine locations, access roads and electrical connections have not been determined at this time, the table below identifies Township sections potentially affected by the project:

Township Name	Township	Range	Sections
Richland	111 N	47 W	6, 7, 18, 19, 30
Lake Hendricks	112 N	47 W	31
Sherman	111 N	48 W	1, 2, 3, 4, 12, 13, 24, 25
Oak Lake	112 N	48 W	1-11, 14-23, 25-30, 32-36
Argo	112 N	49 W	1-4, 10-14, 23-26

Your input on the project will assist PPM Energy and HDR in their review of this project. If we do not hear from you within 30 days, we will assume that you have no comment on the project at this time. This notification precedes publication of the SDPUC Energy Facility Siting Permit application but does not preclude subsequent review and comment on the documents after publication. Other formal opportunities to comment on the project will follow at a later date when public information meetings and public hearings are held, anticipated to occur in summer and fall 2008.

Enclosed is a project location map to facilitate your review. If you have any questions relating to this matter, please contact me at (763) 591-5443.

Sincerely,



Joyce E. Pickle
Environmental Scientist

Enclosures:
Project Location Map

Cc: Timothy Seck, PPM Energy Inc.
Sarah Emery, HDR Engineering Inc.



April 25, 2008

Mr. Bruce Lindholm
Program Manager
South Dakota Aeronautics Commission
Becker Hanson Building
700 East Broadway
Pierre, SD 57501

RE: Buffalo Ridge II 210 MW Wind Project in Brookings County, South Dakota

Dear Mr. Lindholm:

HDR Engineering, Inc. (HDR) is currently gathering environmental information for a 210 Megawatts (MW) Wind Farm proposed by PPM Energy in Brookings County, South Dakota. PPM Energy has applied to interconnect the wind farm with Xcel Energy's Brookings County Substation near White, South Dakota. Because the project is over 100 MW in size, PPM Energy is required to apply for an Energy Facility Siting Permit through the South Dakota Public Utility Commission (SDPUC). PPM Energy also will apply for an Aeronautical Hazard Permit from the South Dakota Aeronautics Commission. HDR requests your review and comment on the above-mentioned project.

Typically wind facility construction includes erecting wind turbines and constructing associated facilities such as gravel access roads, an underground collector system and overhead 34.5 kV and 115 kV transmission lines. Although final turbine locations, access roads and electrical connections have not been determined at this time, the table below identifies Township sections potentially affected by the project:

Township Name	Township	Range	Sections
Richland	111 N	47 W	6, 7, 18, 19, 30
Lake Hendricks	112 N	47 W	31
Sherman	111 N	48 W	1, 2, 3, 4, 12, 13, 24, 25
Oak Lake	112 N	48 W	1-11, 14-23, 25-30, 32-36
Argo	112 N	49 W	1-4, 10-14, 23-26

Your input on the project will assist PPM Energy and HDR in their review of this project. If we do not hear from you within 30 days, we will assume that you have no comment on the project at this time. This notification precedes publication of the SDPUC Energy Facility Siting Permit application but does not preclude subsequent review and comment on the documents after publication. Other formal opportunities to comment on the project will follow at a later date when public information meetings and public hearings are held, anticipated to occur in summer and fall 2008.

Enclosed is a project location map to facilitate your review. If you have any questions relating to this matter, please contact me at (763) 591-5443.

Sincerely,



Joyce E. Pickle
Environmental Scientist

Enclosures:
Project Location Map

Cc: Timothy Seck, PPM Energy Inc.
Sarah Emery, HDR Engineering Inc.



April 25, 2008

Mr. Tim Tollefsrud
Director, Environmental Services
South Dakota Department of Environment and Natural Resources
Joe Foss Building
523 East Capitol
Pierre, SD 57501

RE: Buffalo Ridge II 210 MW Wind Project m in Brookings County, South Dakota

Dear Mr. Tollefsrud:

HDR Engineering, Inc. (HDR) is currently gathering environmental information for a 210 Megawatts (MW) Wind Farm proposed by PPM Energy in Brookings County, South Dakota. PPM Energy has applied to interconnect the wind farm with Xcel Energy's Brookings County Substation near White, South Dakota. Because the project is over 100 MW in size, PPM Energy is required to apply for an Energy Facility Siting Permit through the South Dakota Public Utility Commission (SDPUC). HDR requests your review of the above-mentioned project to identify potential impacts from the project and any permits that the project might require.

Typically wind facility construction includes erecting wind turbines and constructing associated facilities such as gravel access roads, an underground collector system and overhead 34.5 kV and 115 kV transmission lines. Although final turbine locations, access roads and electrical connections have not been determined at this time, the table below identifies Township sections potentially affected by the project:

Township Name	Township	Range	Sections
Richland	111 N	47 W	6, 7, 18, 19, 30
Lake Hendricks	112 N	47 W	31
Sherman	111 N	48 W	1, 2, 3, 4, 12, 13, 24, 25
Oak Lake	112 N	48 W	1-11, 14-23, 25-30, 32-36
Argo	112 N	49 W	1-4, 10-14, 23-26

Your input on the project will assist PPM Energy and HDR in their review of this project. If we do not hear from you within 30 days, we will assume that you have no comment on the project at this time. This notification precedes publication of the SDPUC Energy Facility Siting Permit application but does not preclude subsequent review and comment on the documents after publication. Other formal opportunities to comment on the project will follow at a later date when public information meetings and public hearings are held, anticipated to occur in summer and fall 2008.

Enclosed is a project location map to facilitate your review. If you have any questions relating to this matter, please contact me at (763) 591-5443.

Sincerely,



Joyce E. Pickle
Environmental Scientist

Enclosures:
Project Location Map

Cc: Timothy Seck, PPM Energy Inc.
Sarah Emery, HDR Engineering Inc.



April 25, 2008

Mr. Loren Schaefer
Director, Division of Planning & Engineering
South Dakota Department of Transportation
700 East Broadway Avenue
Pierre, SD 57501

RE: Buffalo Ridge II 210 MW Wind Project m in Brookings County, South Dakota

Dear Mr. Schaefer:

HDR Engineering, Inc. (HDR) is currently gathering environmental information for a 210 Megawatts (MW) Wind Farm proposed by PPM Energy in Brookings County, South Dakota. PPM Energy has applied to interconnect the wind farm with Xcel Energy's Brookings County Substation near White, South Dakota. Because the project is over 100 MW in size, PPM Energy is required to apply for an Energy Facility Siting Permit through the South Dakota Public Utility Commission (SDPUC). HDR requests your review of the above-mentioned project to identify potential impacts from the project and any permits that the project might require.

Typically wind facility construction includes erecting wind turbines and constructing associated facilities such as gravel access roads, an underground collector system and overhead 34.5 kV and 115 kV transmission lines. Although final turbine locations, access roads and electrical connections have not been determined at this time, the table below identifies Township sections potentially affected by the project:

Township Name	Township	Range	Sections
Richland	111 N	47 W	6, 7, 18, 19, 30
Lake Hendricks	112 N	47 W	31
Sherman	111 N	48 W	1, 2, 3, 4, 12, 13, 24, 25
Oak Lake	112 N	48 W	1-11, 14-23, 25-30, 32-36
Argo	112 N	49 W	1-4, 10-14, 23-26

Your input on the project will assist PPM Energy and HDR in their review of this project. If we do not hear from you within 30 days, we will assume that you have no comment on the project at this time. This notification precedes publication of the SDPUC Energy Facility Siting Permit application

HDR Engineering, Inc.

701 Xenia Avenue South
Minneapolis, MN 55416-3636

Phone (763) 591-5400
Fax (763) 591-5413
www.hdrinc.com

but does not preclude subsequent review and comment on the documents after publication. Other formal opportunities to comment on the project will follow at a later date when public information meetings and public hearings are held, anticipated to occur in summer and fall 2008.

Enclosed is a project location map to facilitate your review. If you have any questions relating to this matter, please contact me at (763) 591-5443.

Sincerely,



Joyce E. Pickle
Environmental Scientist

Enclosures:
Project Location Map

Cc: Timothy Seck, PPM Energy Inc.
Sarah Emery, HDR Engineering Inc.



April 25, 2008

Mr. Terry Peterson
Outside Plant Supervisor
Interstate Telecommunications Cooperative
312 Fourth Street West
Clear Lake, SD 57226

RE: Buffalo Ridge II 210 MW Wind Project in Brookings County, South Dakota

Dear Mr. Peterson:

HDR Engineering, Inc. (HDR) is currently gathering environmental information for a 210 Megawatts (MW) Wind Farm proposed by PPM Energy in Brookings County, South Dakota. PPM Energy has applied to interconnect the wind farm with Xcel Energy's Brookings County Substation near White, South Dakota. Because the project is over 100 MW in size, consisting of between 80 and 100 turbines, PPM Energy is required to apply for an Energy Facility Siting Permit through the South Dakota Public Utility Commission (SDPUC). HDR requests your review of the above-mentioned project to identify potential interference to your telecommunications infrastructure from the development.

Typically wind facility construction includes erecting wind turbines and constructing associated facilities such as gravel access roads, an underground collector system and overhead 34.5 kV and 115 kV transmission lines. Although final turbine locations, access roads and electrical connections have not been determined at this time, the table below identifies Township sections potentially affected by the project:

Township Name	Township	Range	Sections
Richland	111 N	47 W	6, 7, 18, 19, 30
Lake Hendricks	112 N	47 W	31
Sherman	111 N	48 W	1, 2, 3, 4, 12, 13, 24, 25
Oak Lake	112 N	48 W	1-11, 14-23, 25-30, 32-36
Argo	112 N	49 W	1-4, 10-14, 23-26

Your input will assist PPM and HDR in their development of this project. South Dakota statute (49-32-3.1) allows telecommunications companies with telecommunications facilities within one mile of the project area to request a planning meeting with the wind developer to discuss the proposed wind farm. Interstate Telecommunications Cooperative (ITC) is the sole telecommunications provider for the project area. We are available to meet with ITC to discuss the proposed wind farm and associated electrical infrastructure. South Dakota statute requires that you notify us with a meeting request within 30 days. A meeting shall then be scheduled within 30 days of our receipt of that request. If we are not notified, we will assume that you have no comment on the project at this time.

Enclosed is a project location map to facilitate your review. If you have any questions relating to this matter, please contact:

Joyce Pickle
HDR Engineering
701 Xenia Ave. S, Suite 600
Minneapolis, MN 55416
(763) 591-5443

OR

Tim Seck
PPM Energy
2221 Riverwood Place
St. Paul, MN 55104
(651) 917-9285

Sincerely,
HDR Engineering, Inc.



Joyce E. Pickle
Environmental Scientist

Enclosure: Project Location Map

cc: Tim Seck, PPM Energy, Inc.
Sarah Emery, HDR Engineering Inc.



April 25, 2008

Wanda Tyler
Township Clerk
Sherman Township
47987 206th St
White, SD 57276

RE: Buffalo Ridge II 210 MW Wind Project in Brookings County, South Dakota

Dear Ms. Tyler:

HDR Engineering, Inc. (HDR) is currently gathering environmental information for a 210 Megawatts (MW) Wind Farm proposed by PPM Energy in Brookings County, South Dakota. PPM Energy has applied to interconnect the wind farm with Xcel Energy's Brookings County Substation near White, South Dakota. Because the project is over 100 MW in size, PPM Energy is required to apply for an Energy Facility Siting Permit through the South Dakota Public Utility Commission (SDPUC). Additionally, PPM will submit an application for a Conditional Use Permit for the proposed facility to the Brookings County Zoning office. HDR requests your review of the above-mentioned project to identify potential impacts from the project and any permits that the project might require.

Typically wind facility construction includes erecting wind turbines and constructing associated facilities such as gravel access roads, an underground collector system and overhead 34.5 kV and 115 kV transmission lines. Although final turbine locations, access roads and electrical connections have not been determined at this time, the table below identifies Township sections potentially affected by the project:

Township Name	Township	Range	Sections
Richland	111 N	47 W	6, 7, 18, 19, 30
Lake Hendricks	112 N	47 W	31
Sherman	111 N	48 W	1, 2, 3, 4, 12, 13, 24, 25
Oak Lake	112 N	48 W	1-11, 14-23, 25-30, 32-36
Argo	112 N	49 W	1-4, 10-14, 23-26

Your input on the project will assist PPM Energy and HDR in their review of this project. If we do not hear from you within 30 days, we will assume that you have no comment on the project at this time. This notification precedes publication of the SDPUC Energy Facility Siting Permit application but does not preclude subsequent review and comment on the documents after publication. Other formal opportunities to comment on the project will follow at a later date when public information meetings and public hearings are held, anticipated to occur in summer and fall 2008.

Enclosed is a project location map to facilitate your review. If you have any questions relating to this matter, please contact me at (763) 591-5443.

Sincerely,





Joyce E. Pickle
Environmental Scientist

Enclosures:
Project Location Map

Cc: Timothy Seck, PPM Energy Inc.
Sarah Emery, HDR Engineering Inc.

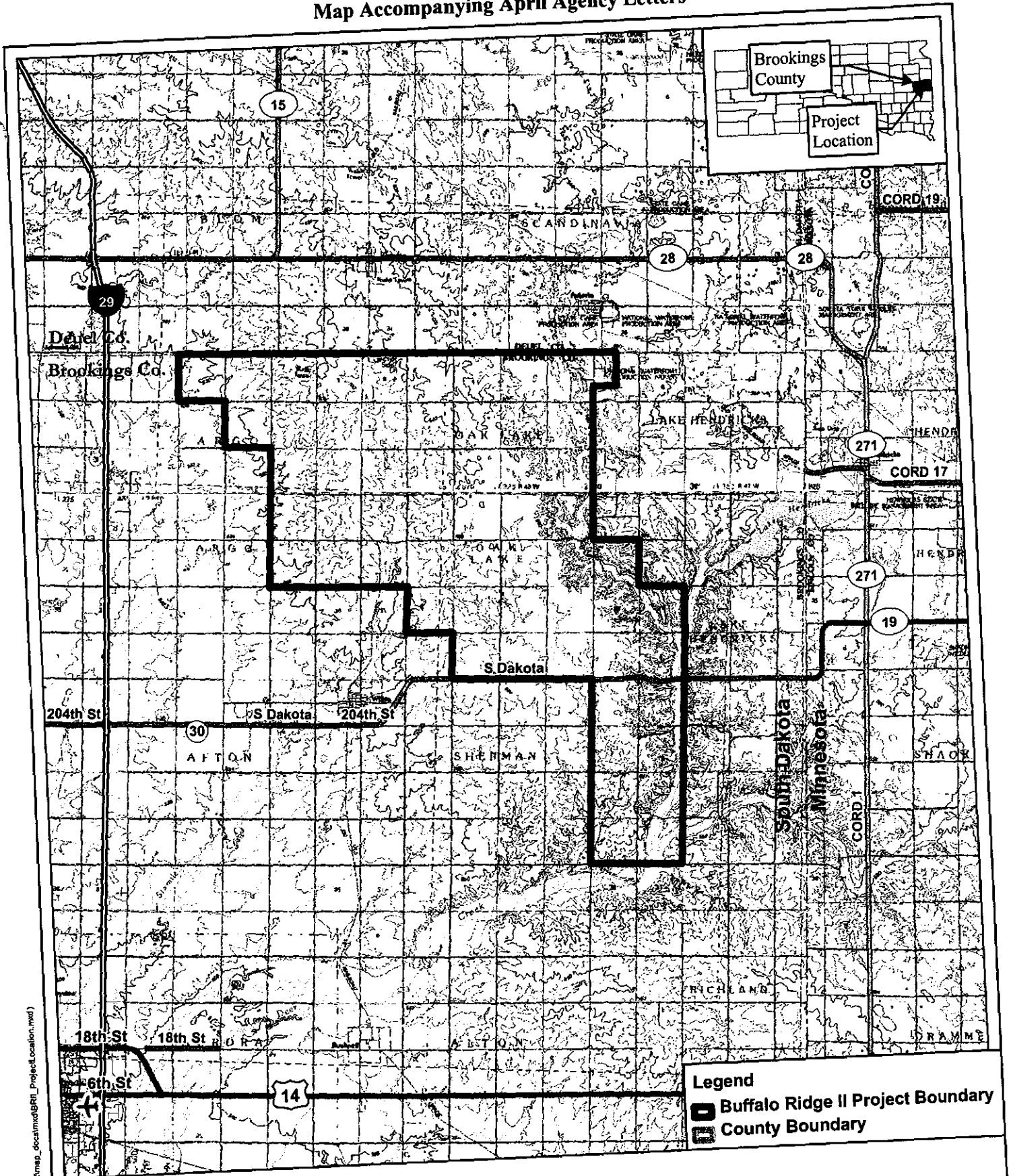
Map Accompanying April Agency Letters



- Legend**
-  Buffalo Ridge II Project Boundary
 -  County Boundary

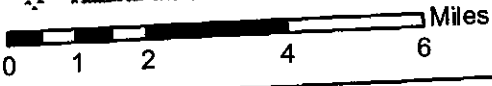

Project Location Map
 Buffalo Ridge II
 PPM Energy
 Brookings County, SD

PPM179122(mso_dccamvd)BRII_Project_Location.mxd
 Map Document: N
 3/15/2008 10:31:42



Department of Tourism and State Development

May 7, 2008

RECEIVED
MAY 9 8 2008
HDR Engineering, Inc.

Ms. Joyce E. Pickle
HDR
701 Xenia Avenue South Suite 600
Minneapolis MN 55416-3636

Dear Ms. Pickle:

Thank you for the opportunity to review the proposed Buffalo Ridge II 210 MW Wind Project in Brookings County, South Dakota. Based on the information provided it is unclear if your project is an undertaking as defined by 36 CFR part 800.16(y), the enabling legislation for the National Historic Preservation Act of 1966 (as amended), or if your project is subject to South Dakota Codified Law: SDCL 1-19A-11.1.

While it is unclear where the exact location of the proposed 13-turbine wind farm will be located, it does appear there are known cultural resources within or near the proposed project location. We strongly recommend your company complete an on-the-ground survey of the project area prior to any ground disturbing activities and seek to avoid all identified sites. It is also unclear if there will be any visual effects to historic structures within or near the project area. We also recommend completing an architectural records search of the project area.

For your convenience I have enclosed information concerning Section 106 of the National Historic Preservation Act and a copy of our state preservation law South Dakota Codified Law: SDCL 1-19A-11.1.

Should you require additional information, please contact Paige Hoskinson Olson, Review & Compliance Coordinator, at (605) 773-6004. Your concern for the non-renewable cultural heritage of our state is appreciated.

Sincerely,

Jay D. Vogt
State Historic Preservation Officer

Paige Hoskinson Olson
Review & Compliance Coordinator

Office of Tourism
Governor's Office of Economic
Development
Tribal Government Relations
711 E Wells Ave / Pierre, SD 57501-3369
Phone: 605-773-3301 / Fax: 605-773-3256
travel.sd.com / sdgreatprofits.com /
sdtribalrelations.com

South Dakota Arts Council
800 Governors Dr. / Pierre, SD 57501-2294
Phone: 605-773-3131 or 1-800-423-6665 in SD
Fax: 605-773-6962
sdac@state.sd.us / sdarts.org

South Dakota State
Historical Society
990 Governors Dr. / Pierre, SD 57501-2217
Phone: 605-773-3458 / Fax: 605-773-6041
sdhistory.org

South Dakota Housing
Development Authority
PO Box 1237 / Pierre, SD 57501-1237
Phone: 605-773-3181 / Fax: 605-773-5154
sdhda.org





**DEPARTMENT of ENVIRONMENT
and NATURAL RESOURCES**

PMB 2020
JOE FOSS BUILDING
523 EAST CAPITOL
PIERRE, SOUTH DAKOTA 57501-3182
www.state.sd.us/denr

RECEIVED
JUN - 2 2008
HDR Engineering, Inc.

Joyce Pickle
HDR Engineering Inc
701 Xenia Avenue
Suite 600
Minneapolis, MN 55416

Dear Ms. Pickle:

The South Dakota Department of Environment and Natural Resources (DENR) reviewed the Buffalo Ridge II 210 MW Wind Project in Brookings County, South Dakota dated April 25, 2008. Based on the general information provided the DENR has the following comments:

The Air Quality Program

The department does not anticipate any adverse impacts to the air quality of the state. The Air Quality Program has no objections to this project.

The Surface Water Program

1. Best Management Practices (BMP) for sediment and erosion control should be incorporated into the planning, design, and construction.
2. A Surface Water Discharge (SWD) permit may be required if any construction dewatering should occur. Please contact this office for more information.
3. Surface water bodies may be impacted by this project. The discharge of pollutants from any source, including indiscriminate use of fill material, may not cause destruction or impairment except where authorized under Section 404 of the Federal Water Pollution Control Act. Please contact the U.S. Army Corps of Engineers concerning this permit.
4. A General Storm Water Permit for Construction Activities may be required. If you have any questions, please contact Stacy Splittstoesser at 1-800-SDSTORM (1-800-737-8676).

The Drinking Water Program

The department does not anticipate any adverse impacts to drinking waters of the state. The Drinking Water Program has no objections to this project. However, it is requested that the rural water provider in the area be notified to ensure that the cable installations do not adversely impact the existing water distribution systems that may be present.

The Ground Water Quality Program

The department does not anticipate adverse impacts to ground water quality by this project.

However, there have been accidental petroleum and other chemical releases throughout the state. There is the possibility that this project may encounter contaminated material. If you would like to do research regarding accidental releases, information on accidental releases reported in South Dakota may be obtained at the following website:

<http://www.state.sd.us/denr/DES/ground/dataspil.htm>. In the unlikely event that contamination is encountered during construction activities, PPM Energy, Inc. or its designated representative must report the contamination to the department at (605) 773-3296. Any contaminated soil encountered must be temporarily stockpiled and sampled to determine disposal requirements and the materials of construction through the contaminated area should be evaluated for chemical compatibility and adjusted accordingly.

The Waste Management Program

The Waste Management Program does not anticipate any adverse impacts. Any construction debris needs to be disposed of at a permitted solid waste facility. Please contact the Waste Management Program if you have any questions on solid waste disposal at (605) 773-3153.

Thank you for the submitting this information, however, the DENR requests the opportunity to review this project again when the information becomes more specific. If you have any questions concerning these comments, please contact me at (605) 773-3351.

Sincerely,



John Miller
Environmental Program Scientist
Surface Water Quality Program

cc: Sheldon Hamann, Ground Water Quality Program
Mark Mayer, Drinking Water Program
Brad Schultz, Air Quality Program
Vonni Kallemeyn, Waste Management Program



DEPARTMENT OF GAME, FISH AND PARKS

Foss Building
523 East Capitol
Pierre, South Dakota 57501-3182

June 3, 2008

Joyce E. Pickle
HDR Engineering, Inc.
701 Xenia Avenue South, Suite 600
Minneapolis, MN 55416

RE: Request for environmental review of a 210 megawatt wind power project in Brookings County, South Dakota.

Dear Joyce,

The following information and comments are in response to your letter dated April 25, 2008 and phone call of April 29, 2008 requesting environmental review of the above referenced wind power project. The Proposed Project Area is located near the town of White, South Dakota in portions of Richland, Lake Hendricks, Sherman, Oak Lake, and Argo Townships. The number of turbines and the amount of infrastructure associated with the proposed wind power project has not yet been described. Once these details are determined, we request that this information be provided.

Doug Backlund, our Natural Heritage Database (NHD) manager, has provided location information on rare and protected species known to be within or near the Proposed Project Area. Please note that absence of a species from the NHD does not preclude its presence in the Proposed Project Area. Many areas in South Dakota have not been surveyed for rare or protected species. The species location information along with an invoice was provided to you via electronic mail on May 8, 2008. If you have further questions regarding the NHD search, please contact Doug Backlund at (605) 773-4345. If you have specific questions about the plant records, please contact our botanist, Dave Ode, at (605) 773-4227.

The proposed siting and operation of a wind power project has potential to directly and indirectly impact area wildlife. This may occur by altering important and declining habitats and breeding and movement behavior of wildlife and/or by killing bats and birds through wind turbine and power line strikes. While we applaud efforts to provide

renewable energy sources, we offer the following information on wildlife habitats and associated species that are important in South Dakota and that may be impacted. If impacts are unavoidable, we recommend mitigation to avoid or lessen direct and indirect impacts. We also provide, when appropriate, mitigation suggestions and additional contacts and resources for further information.

Ecoregions (Bryce et al. 1998) - Ecoregions are areas that are similar in the type, quality, and quantity of environmental resources (e.g. geology, physiography, vegetation, climate, soils, land use, wildlife, and hydrology). The Proposed Project Area is located within the Big Sioux Basin Ecoregion. This ecoregion is lightly glaciated with rolling topography and a well developed drainage network; there are a limited number of basin wetlands. Average annual precipitation is some of the highest in the state (20-22 inches). Agricultural tillage dominates the ecoregion. Potential natural vegetation is primarily tall-grass species such as big and little bluestem, switchgrass, indiangrass, sideoats grama, and lead plant. Riparian vegetation includes willows, cordgrass and/or hardwoods trees.

Grasslands - The Proposed Project Area is located within the tall-grass prairie zone. Native grasslands within this zone are decreasing at an alarming rate. Less than one percent of native tall-grass prairie habitat in South Dakota remains (Samson et al. 1998). Other grassland types such as rangeland (grazed grasslands with native plant spp.), pasture (grazed grasslands with non-native plant spp.) and Conservation Reserve Program lands (tilled land planted to vegetative cover) serve as grassland wildlife habitat (Haufler 2005). Fragmentation resulting from woody encroachment, road construction, and conversion of surrounding habitat has resulted in the remaining grassland habitats existing as smaller disjunct patches. Patches often provide less suitable habitat for many native species of grassland wildlife. Some of the last remaining contiguous grasslands tracts may occur in the southeastern portion of the Proposed Project Area.

Grassland Birds - Placement of turbines in the Proposed Project Area may fragment grassland wildlife habitat reducing its suitability to serve as habitat and modify behavior of grassland bird species, a group of species which has shown the most consistent and long term declines of any other group of bird species in North America (Peterjohn and Sauer 1999). Johnson and Igl (2001) gave a regional perspective on the area-sensitivity of several Great Plains bird species. The breeding ranges of four area-sensitive species are found within the Proposed Project Area. The Sedge Wren, Clay-colored Sparrow, Grasshopper Sparrow, and Bobolink. Northern Harrier, Upland Sandpiper, Field, Vesper, Savannah, Henslow's and Song sparrows, and the Dickcissel also are grassland bird species that have shown area-sensitivity (Johnson 2001) and have breeding ranges in the Proposed Project Area. Note that local, species-specific breeding habitat conditions must exist for reproductive activities to occur. Properly timed, species-appropriate surveys for grassland bird species should be conducted pre-construction. Surveys are best conducted in June, although mid-May through early July is acceptable.

Butterflies – The Dakota skipper and the Ottoe skipper are two rare butterfly species located near the Proposed Project Area.

The Dakota skipper is primarily found in western Minnesota, northeastern South Dakota, and scattered prairies across most of North Dakota. More specifically, the range of the Dakota skipper in South Dakota is limited to eleven counties in the north eastern portion of the state, including Brookings County. The Dakota skipper is reduced to scattered populations in fragmented prairies unsuitable for agricultural production, mostly in glacial hills that are too steep or rocky to plow. The Dakota skipper requires native mid- to tall-grass prairie and is currently found on rolling rangeland with abundant wetlands. Larval host plants are grasses, especially little bluestem. Flight of emerging adults occurs from June to mid-July. Adults use various prairie flowers as nectar sources. Current threats to this species include, but are not limited to, improper land management uses, agricultural cultivation, road construction, and invasive plant species.

South Dakota populations are important to the existence of this species. Approximately half of known populations are located on private lands. Dakota skippers, though not found within the Proposed Project Area boundary, are found nearby on the Oak Lake Field Station managed by South Dakota State University. Similar grassland habitat needed by this species may be found in the extreme eastern and southeastern portions of the Proposed Project Area.

This species is a candidate for listing under the Federal Endangered Species Act (ESA). As such, I recommend contacting the U.S. Fish and Wildlife (USFWS) Ecological Services Field Office in Pierre, SD (605-224-6893 or Natalie_Gates@fws.gov) for further information regarding the protection of this species required under ESA.

The Ottoe skipper range is located in the mid-section of North America, extending from Manitoba south to Texas, west to Montana and east to Michigan and Indiana. Distribution in South Dakota is very local and generally uncommon to rare occurring with known occurrences scattered in various counties. The Ottoe skipper requires relatively undisturbed native prairie with nectar sources (coneflowers, grayfeathers, asters, etc). It is uncommon to rare throughout the state. Peak flight for the Ottoe skipper is in mid-July. The reduction and degradation of prairie habitat is the main threat to this species. Our NHD records of this species do not fall within the boundary of the Proposed Project Area but are found nearby on contiguous grasslands. Similar grassland habitat needed by this species may be found in the extreme eastern and southeastern portions of the Proposed Project Area.

The presence of butterfly species that require native prairie are good indicators that high quality native prairie remains. Protection of these remaining tracts of native prairie and associated nectar sources and larval host plants is required for the conservation of these rare butterfly species. There are potential disturbances to these rare butterfly species associated with the construction and maintenance of a wind power project. Road construction and turbine maintenance increases the chances of non-native,

invasive plant species invasion. Road construction is a known threat to the Dakota skipper. Pre-construction surveys for rare butterfly species should be conducted before, during, and after the construction of wind turbines and during the appropriate times (flight periods). Construction in areas that are or potential rare butterfly habitat should be avoided.

Bats - Construction of a wind power plant may affect daily and seasonal bat movements between breeding and foraging areas. There has been limited research conducted on bats in South Dakota. However, thirteen species of bats are currently known to be found in South Dakota, some of which are summer residents, year-round residents, or migratory (Table 1).

Table 1. South Dakota Bats

Common Name	Scientific Name	State Residency
Big Brown Bat ¹	<i>Eptesicus fuscus</i>	Year-round resident
Fringed Myotis ²	<i>Myotis thysanodes</i>	Year-round resident
Little Brown Myotis	<i>Myotis lucifugus</i>	Year-round resident
Long-eared Myotis ²	<i>Myotis evotis</i>	Year-round resident
Long-legged Myotis	<i>Myotis volans</i>	Year-round resident
Northern Myotis ²	<i>Myotis septentrionalis</i>	Year-round resident
Townsend's Big-eared Bat ²	<i>Corynorhinus townsendii</i>	Year-round resident
Western Small-footed Myotis	<i>Myotis ciliolabrum</i>	Year-round resident
Hoary Bat ¹	<i>Lasiurus cinereus</i>	Summer resident
Eastern Red Bat ¹	<i>Lasiurus borealis</i>	Summer resident
Silver-haired Bat ^{1,2}	<i>Lasionycteris noctivagans</i>	Summer resident
Evening Bat ²	<i>Nycticeius humeralis</i>	Migratory
Eastern pipistrell ¹	<i>Pipistrellus subflavus</i>	unclassified

¹ = species known to be killed by wind turbines (Higgins et al. 2007)

² = monitored by the Natural Heritage Program

According to Swier (2006), big brown bat, eastern red bat, hoary bat, and little brown myotis are known to be found within Brookings County. In particular the eastern red bat was captured at Oak Lake Field station which is adjacent to the eastern boundary of the Proposed Project Area. Species of bats that migrate are currently the most commonly known species killed at wind power projects in the US (Kunz et al. 2007). The eastern red and hoary bats are two known migratory species that may occur in the Proposed Project Area.

Eastern red bats migrate into South Dakota in mid-April and migrate south by late August or early September (Swier 2006). Gestation is 80-90 days with parturition occurring in mid-June (Higgins et al. 2000). Hoary bats also do not winter in South Dakota. After a 90 day gestation period, pups are born between mid-May and July.

Migration occurs in spring and fall, specifics on migration timing of this species is unknown.

There have been no known surveys for bats within the Proposed Project Area. Because of limited, project-specific data, we recommend pre-construction surveys of the area for potential bat habitat and species and post-construction surveys for documentation and evaluation of strike morality. Surveys for species should be conducted for at least one full year before construction and encompass all seasons. We are aware that acoustic surveys for bats are being conducted from mid-June to mid-October. We encourage timing of these surveys to occur as soon as possible to account for migration and/or beginning additional pre-construction acoustic surveys in April of 2009.

South Dakota Department of Game, Fish and Parks (SDGFP) in cooperation with the South Dakota Bat Working Group (SDBWG), developed the *South Dakota Bat Management Plan* specific to bats and their habitats in South Dakota (<http://www.sdgifp.info/Wildlife/Diversity/batmanagementplan71304.pdf>). Please review this document for pertinent information. Again, because bats reside and migrate through South Dakota, it is important to evaluate the Proposed Project Areas for roosting, feeding, migration and/or stopover habitat and to survey these areas for bats.

Bird and Bat Strikes - Birds and bats are known to be susceptible to direct strikes with wind turbines. Refer to Table 1 in Higgins et al. (2007) for a list of bird species with known wind turbine strike mortality found at a wind power project in the Buffalo Ridge area of Minnesota. Several of these species are migratory and are protected by the Migratory Bird Treaty Act which is administered by the US Fish and Wildlife Service. Please contact Natalie Gates at the South Dakota Ecological Services Field Office in Pierre, SD (605-224-6893 or Natalie_Gates@fws.gov) for more information. All bat species, excluding the little brown Myotis, that have been documented in Brookings County have had documented mortalities at wind turbines (Higgins et al. 2007; Table 2).

Threatened and Endangered Species – Although there are no records of the state listed bald eagle and the state and federally endangered whooping crane, they could occur in the area. Bald eagles may be nesting in the area without our knowledge. Migrant bald eagles and whooping cranes are possible in the spring and fall.

The Topeka shiner is a federally endangered species that occupies a high percentage of known historic locations in South Dakota (Shearer 2003). The Topeka shiner is found near the Proposed Project Area. Landscape alterations that occur during construction projects, etc. can cause land erosion and alter the sediment load and water regime of prairie streams affecting habitat available to fish, e.g., Topeka shiners. Conversion of prairie landscape and wetland drainage act in combination to reduce individual populations of Topeka shiners thereby affecting the Topeka shiner population rangewide (Shearer 2003). Since Topeka shiners are found in streams near the Proposed Project Area, it is likely construction near natural drainages will influence Topeka shiner habitat. South Dakota Game, Fish & Parks, in collaboration with the US

Fish and Wildlife Service developed the Topeka Shiner Management Plan (<http://stage.sdgfp.info/Wildlife/Diversity/Topeka%20Shiner/TopekaShinerManagementPlan-Revised.pdf>). Please refer to this document for information regarding habitat protection and/or mitigation of prairie streams.

The Northern redbelly dace is a state threatened species and is found in the Big Sioux and Minnesota watersheds. A record of this species is found just outside of the eastern border of the Proposed Project Area. This is a small fish (2 inches) that inhabits spring-fed streams, boggy lakes, ponds, beaver ponds, and pools of headwaters and creeks preferring areas that have beds of aquatic vegetation. Waters are often tea colored and over fine detritus or silt. Threats include stream channelization, reduced discharge and changes in water quality.

Landscape considerations - Placement of a wind power project should take into account landscape-level (e.g. surrounding land uses) impacts and the impacts of project associated infrastructure (i.e. transmission lines and roads).

Placement of public lands is often done so in areas with existing and potential wildlife habitat. Management of these lands is done for wildlife and conducted in the public interest. Wildlife using these areas may be affected by the placement of a wind power project in the surrounding area. South Dakota Game, Fish and Parks Department owns tracts of land within three miles of the Proposed Project Area including Astoria, Black Slough Slough and Kvernmoen Slough Game Production Areas, and Lake Hendricks Lakeside Use Area.

In addition Oak Lake Field Station is located adjacent to the eastern border of the Proposed Project Area. The Station is managed by South Dakota State University's Department of Biology and Microbiology as a site to foster appreciation of the Great Plains ecosystem through education, research, and service. The field station is open to the public throughout the year. The station director is Nels H. Trolestrup Jr. He can be contacted at 605-688-5503 or Nels.Troelstrup@sdstate.edu.

The US Fish and Wildlife Service owns and manages several Waterfowl Production Areas within or near the proposed project boundary. These lands are managed out of the Madison Wetland Management District (WMD). Tom Tornow, WMD manager can be contacted at 605-256-2974 or MadisonWetlands@fws.gov. The location of these and other public lands can be found on line at <http://www.sdgfp.info/Wildlife/PublicLands/PubLand.htm>.

Construction and placement of new power lines is often associated with a proposed wind power project. Power line strikes are a known cause of mortality to birds (Erickson et al. 2005). Waterfowl (ducks, geese, swans, and cranes), raptors, and passerines are species most susceptible to power line collisions. The Avian Protection Power line Interaction Committee has developed two documents that may be of use to reduce power line strikes and mortality: 1) *Suggested Practices for Avian Protection on Power Lines: The State of the Art in 2006* and 2) *Mitigating Bird Collisions with Power Lines*.

Both of these documents are available from the Edison Institute (<http://www.aplic.org/>, under 'products and services'). existing power lines associated with the proposed project should be buried, marked, or retrofitted to reduce strikes and electrocutions of bird species and poles modified to prevent their use as raptor perch sites.

As roads are built, wildlife habitat is often altered, fragmented and/or lost (Forman et al. 2003). Area-sensitive and/or rare species become less and less resilient to changes in their environment as habitat quantity and quality diminishes (Forman et al. 2003). Similar impacts to area-sensitive species in South Dakota may occur from wind power project- associated roads.

Non-native/invasive plant species - During the construction and maintenance phase of a wind power project existing roads often experience increased traffic and new roads are constructed. This increases the amount of area disturbed and allows for the introduction and establishment of non-native plant species. Non-native plant species are a major threat to threatened and endangered wildlife species. Resulting control of non-native, invasive species through pesticides and herbicides may also impact habitats of rare wildlife species. Improved road access into an area can also increase the amount of human disturbance to wildlife.

Research and Monitoring - Before project construction, we strongly encourage appropriately timed surveys be conducted to determine wildlife use of the project areas. These types of surveys are often time specific, require trained personnel and often take a minimum of one year.

Based upon results of these baseline studies, project construction should be modified, continued, or cancelled. If the project is continued, monitoring should be conducted for a minimum of two years post-construction to determine if and how many bird and bat strikes are caused by this project, if habitats have been significantly altered, and if the surrounding public lands and their uses have been impacted. Any mitigation should be carefully planned, funded, and carried out.

If monitoring involves live trapping or collection of wildlife species, you must first obtain a collection permit from our agency. Also, we request that if you or your associates observe any of the animal or plant species monitored by the NHP, please contact myself or any of our NHP staff. A list of species monitored by the NHP and staff contact information can be found at <http://www.sdgifp.info/Wildlife/Diversity/>.

The US Geological Survey is currently investigating the influence of wind generators on breeding grassland bird density and species composition in the Dakotas. The results of this study may be of interest as you work on the siting and development of this proposed project. Please contact Jill Shaffer with Northern Prairie Wildlife Research Center, Jamestown, ND for more information (701-253-5547 or jshaffer@usgs.gov).

Siting Guidelines - In coordination with the SDBWG, the SDGFP has developed *Siting Guidelines for Wind Power Projects in South Dakota*. This document addresses many

of the concerns involved with siting wind power projects in South Dakota and may be found at on the web (<http://www.sdgfp.info/Wildlife/Diversity/windpower.htm>). These voluntary guidelines are currently being updated using a multi-stakeholder, consensus-based approach.

Summary - As outlined above, our agency has concerns regarding direct and indirect impacts to wildlife and habitats in association with the siting of the proposed project. The native prairie and/or contiguous grassland habitats in a portion of the Proposed Project Areas play a crucial role in the life history of several wildlife species, many of which are experiencing population declines.

Because of the potential impacts placement of the proposed wind power project would have on unique and declining habitats in the region and their associated species, we recommend the placement of turbines in areas currently disturbed (e.g. cultivated areas) and the use of existing infrastructure (roads and transmission lines) as much as possible. We recommend avoiding the placement of turbines in the extreme eastern and south eastern portion of the proposed project area, if field evaluation reveals presence of native prairie and/or contiguous grassland habitat.

The SDGFP appreciates the opportunity to provide comments. If you have any questions on the above comments, please feel free to contact me at 605-773-2742 or Silka.Kempema@state.sd.us.

Regards,

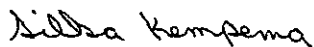

Silka L. F. Kempema
Terrestrial Wildlife Biologist

CC: Doug Backlund, SD Game, Fish and Parks, Pierre, SD
Natalie Gates, US Fish and Wildlife Service, Pierre, SD
Ron Schauer, SD Game, Fish and Parks, Sioux Falls, SD
Jill Shaffer, US Geological Survey, Jamestown, ND

References

- Bryce, S. J. M. Omernik, D. E. Pater, M. Ulmer, J. Schaar, J. Freeouf, R. Johnson, P. Kuck, and S. H. Azevedo. 1998. Ecoregions of North Dakota and South Dakota. [Two sided color poster with map, descriptive text, summary tables, and photographs.] Reston, Virginia: U.S. Geological Survey (scale 1:1,500,000).
- Erickson, W. P., G. D. Johnson, D. P. Young, Jr. 2005. A summary and comparison of bird mortality from anthropogenic causes with an emphasis on collisions. USDA Forest Service General Technical Report PSW-GTR-191. pages 1029-1042.
- Forman, R. T. D. Sperling, J. A. Bissonette, A. P. Clevenger, C. D. Cutshall, V. H. Dale, L. Fahrig, R. France, C. R. Goldman, K. Heanue, J. A. Jones, F. J. Swanson, T. Turrentine, and T. C. Winter. 2003. Road Ecology: Science and solutions. Island Press, Washington, D.C. 481 pages.
- Haufler, J.B., editor. 2005. Fish and wildlife benefits of the Farm Bill conservation programs: 2000-2005 update. The Wildlife Society Technical Review 05-2. 205 pages.
- Higgins, K. F., R. G. Osborn, D. E. Naugle. 2007. Effects of wind turbines on birds and bats in southwestern Minnesota, U.S.A. in *Birds and Wind Farms Risk Assessment and Mitigation* pages 153-175. Eds. M. deLucas, G. F. E. Janss, and M. Ferrer. Quercus, Madrid, Spain.
- Johnson, D. H. 2001. Habitat fragmentation effects on birds in grasslands and wetlands: a critique of our knowledge. *Great Plains Research* 11:211-213.
- Johnson, D. H., and L. D. Igl. 2001. Area requirements of grassland birds: a regional perspective. *Auk* 118:24-34.
- Kunz, T. H., E. B. Arnett, W. P. Erickson, A. R. Hoar, G. D. Johnson, R. P. Larkin, M. D. Strickland, R. W. Thresher, and M. D. Tuttle. 2007. Ecological impacts of wind energy development on bats: questions, research needs, and hypotheses. *Frontiers in Ecology and Environment* 5:315-324.
- Peterjohn, B. G., and J. R. Sauer. 1999. Population status of North American grassland birds from the North American Breeding Bird Survey, 1966-1996. *Studies in Avian Biology* 19:27-44.
- Samson, F. B., F. L. Knopf, and W. R. Ostlie. 1998. Grasslands. Pages 437-472 in M. J. Mac, P. A. Opler, C. E. Puckett Haecker, and P. D. Doran, eds. *Status and Trends of the Nation's Biological Resources, Vol. 2*. U.S. Department of the Interior, U.S. Geological Survey.

Shearer, J.S. 2003. Topeka shiner (*Notropis topeka*) management plan for the state of South Dakota. South Dakota Department of Game, Fish and Parks, Pierre, Wildlife Division Report No. 2003-10, 82 pp.

Swier, V. J. 2006. Recent distribution and life history information for bats of Eastern South Dakota. Museum of Texas Tech University Occasional Papers, Number 264. 21 pages.



Telephone Record

Project:	Buffalo Ridge II	Project No:	79112
Date:	8/19/2008	Subject:	DOT comments on Project
Call	Joyce Pickle- HDR		
Participants:	Tim Bjornberg- SDDOT		

Discussion, Agreement and/or Action:

The purpose of the call was to discuss SDDOT comments on the Buffalo Ridge II project (Project). Iberdrola Renewables (IBR) requested comment from the USFWS on the proposed 210 MW Project via a letter dated April 25, 2008. At this time Mr. Bjornberg said that the department does not have any comments on the Project. If IBR proposes to occupy SDDOT right of way (ROW), they will need to obtain the appropriate permits through coordination with the SDDOT Watertown office.

Telephone Record

Project:	Buffalo Ridge II	Project No:	79112
Date:	7/31/2008	Subject:	FWS comments on Project
Call Participants:	Natalie Gates, Charlene Bessken – USFWS Joyce Pickle, Sarah Emery – HDR Andy Linehan – Iberdrola Renewables Clayton Derby - WEST		

Discussion, Agreement and/or Action:

The purpose of the conference call was to discuss USFWS comments on the Buffalo Ridge II project (Project). Because there is no expected federal nexus for the project, no Section 7 consultation is anticipated. Iberdrola Renewables (IBR) requested comment from the USFWS on the proposed 210 MW Project via a letter dated April 25, 2008. HDR and WEST also provided USFWS with proposed avian, bat and Dakota/Ottoo skipper pre-construction survey protocol and requested comment. In an email dated June 23, 2008, Ms. Gates provided initial comments on the Project and survey protocols; Ms. Bessken commented on the skipper survey protocols on June 24th (attached). A conference call was scheduled to discuss these USFWS comments and provide a recorded response to the Project to include as part of the application to the South Dakota Public Utilities Commission for an Energy Facility Site Permit.

Avian and Bat Survey Protocols

WEST summarized the pre-construction avian and bat survey protocols. The avian point count surveys began in May 2008 and will continue through fall migration. The bat surveys began in mid-summer 2008 and will continue through fall 2008. Because a majority of the site is in cropped fields, it is not anticipated that the Project area is in a high use corridor. Ms. Gates initially expressed a preference for more than one year of pre-construction avian and bat surveys, and asked if there were any planned post-construction mortality surveys. She also inquired if the results of the survey would be used to help site the proposed wind farm layout. IBR responded that given the agricultural setting of the project area, and the existence of long-term avian and bat surveys previously done in the vicinity on the Buffalo Ridge area, they did not feel that more than one year of pre-construction surveys would be necessary for the Project. In addition, the Service’s “Interim Windpower Guidelines” also state that “an average of three years monitoring data” is recommended only in areas with “high seasonal concentrations of birds.” IBR said that if “hot-spots” or high use areas are identified as part of the pre-construction surveys this information would be used to as criteria for the final layout. USFWS found this acceptable.

IBR indicated that they are proposing one year of post construction mortality surveys; protocol will be developed for these surveys once final design is determined, also using results of the pre-construction surveys to help refine the parameters. IBR and USFWS discussed the number of years

for post-construction mortality surveys. It was agreed that one year was sufficient; however, if problem areas of high mortality are recorded, IBR agreed to discuss the possibility of additional years of surveys with USFWS.

Western Prairie Fringed Orchid

Ms. Gates stated that the orchid could occur in Brookings County. HDR described the project area and indicated that suitable habitat (wet/mesic prairies) does not exist in the vicinity of proposed facilities. USFWS agreed that an orchid survey is not warranted for the Project.

Topeka Shiners

Ms. Gates stated that the project is within the range of the Topeka shiner, and the USFWS would have concerns over any impacts to shiner streams. HDR explained that they have worked with the USFWS on projects within watersheds containing Topeka shiners, and that HDR and IBR would work to avoid direct impacts and manage construction to avoid sedimentation into shiner streams. However, HDR indicated that previous experience has shown that some upper portions of tributaries in shiner habitat can be dry and unsuitable for the shiner; HDR said that in these cases the possibility of trenching should be left available. Ms. Gates said that she would appreciate being sent photos of any proposed stream crossings in order to confirm that Topeka shiner habitat would not be impacted. Ms. Gates indicated that trenching through dried tributaries would likely be but any pools should be avoided. It was determined that if a culvert or bridge crossing of a suitable Topeka shiner stream is proposed, a Habitat Conservation Plan (HCP) would need to be developed and approved (since no Section 7 consultation is anticipated) before permission to affect the stream would be granted. IBR stated that would avoid triggering the HCP process if at all possible. (HDR anticipates that if a stream crossing is necessary for the Project, then a Section 404 permit from the U.S. Army Corps of Engineers would be required and the USFWS would provide Section 7 consultation).

Dakota Skippers

Ms. Gates and Ms. Bessken indicated that there is the potential for prairie remnants within the Project boundary that may provide Dakota skipper habitat. HDR summarized the results of the skipper survey that was conducted by Dr. Jerry Selby on July 8th and 11th, 2008. As the skipper survey protocol lay out, only pasture areas containing native plant populations proposed to be crossed by Project facilities were surveyed for skippers during their flight time. Three such parcels were surveyed by Dr. Selby, and no Dakota or Ottoe skippers were documented. Dr. Selby did observe the target species in other prairie remnants in the general Project vicinity as part of surveys he was doing at the same time for the Minnesota Department of Natural Resources; therefore, the survey did occur during the correct flight period. Ms. Bessken indicated that even though the target species were not found during the survey that does not mean that they are not there. HDR replied that they would work with IBR to map any native prairie communities within the Project vicinity (whether or not the skippers were found) and develop a prairie management plan to avoid and minimize impacts to this habitat to the greatest extent possible. USFWS indicated that this approach was acceptable.

Map Document: \\v:\10172008 - 111635\file\gis\proj\PPM179112\map_docs\mxd\SDPUCPermit\ERIL_AppendixC_Shiner_Streams.mxd

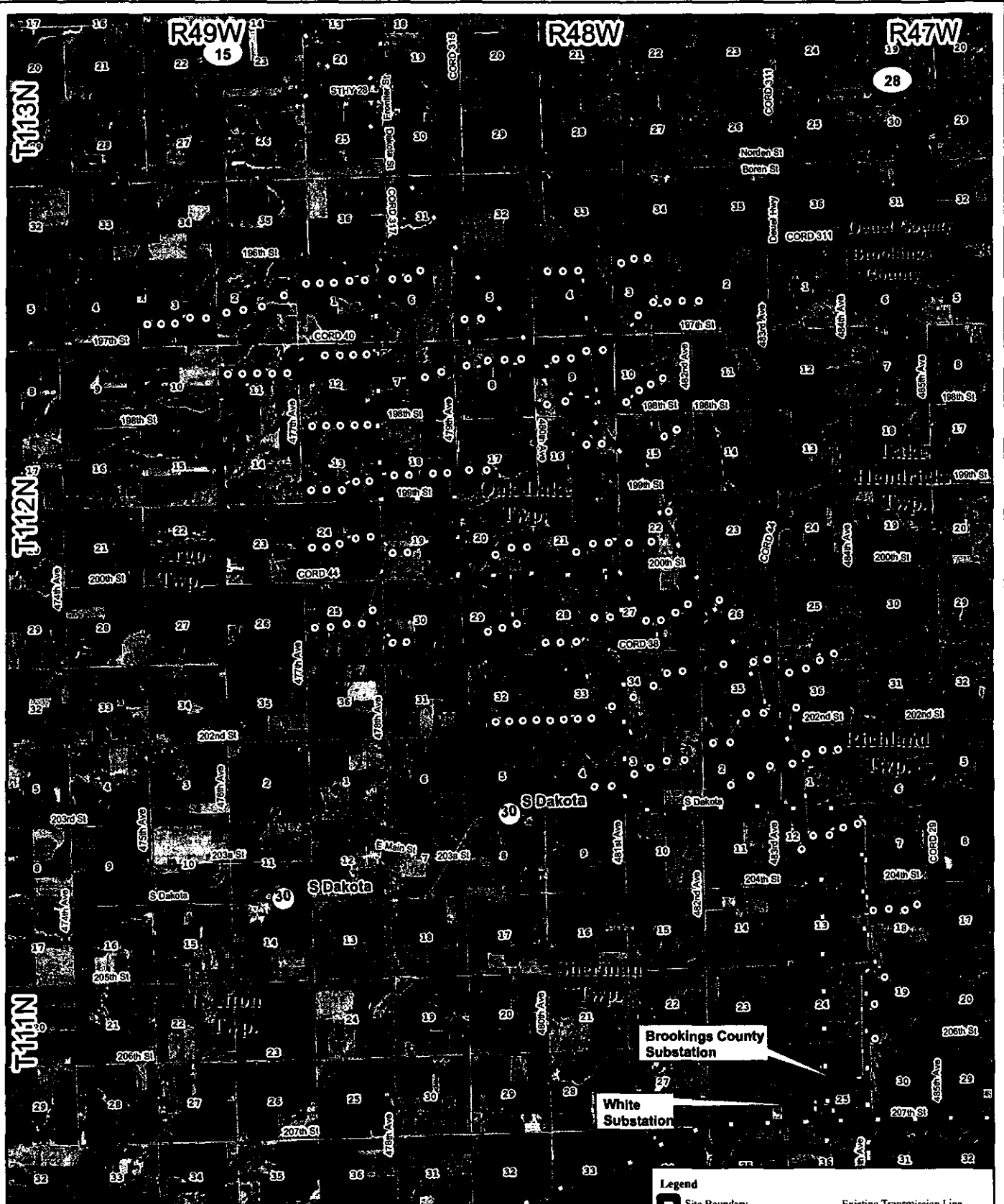

Source: Digitized from maps provided by USFWS, 2007

IBERDROLA RENEWABLES

Miles
0 0.5 1 2

Appendix C - Topeka Shiner Streams
Buffalo Ridge II
Iberdrola Renewables
Brookings County, SD

Legend

- Site Boundary
- Turbine
- Temporary Met Towers
- Project Substation
- Access Roads
- Underground Cabling
- Proposed Overhead Transmission Line
 - 115 kV
 - 34.5 kV
- Existing Transmission Line
 - 115 kV
 - 345 kV
- Topeka Shiner Streams
 - Low Potential
 - Low to Moderate Potential
 - Moderate to High Potential
 - High Potential

Desmond, Meg

From: Charlene_Bessken@fws.gov
Sent: Tuesday, June 24, 2008 10:35 AM
To: Pickle, Joyce E.
Cc: Natalie_Gates@fws.gov
Subject: Re: Fw: Buffalo Ridge II - response to SD GFP comments on proposed Dakota and Ottoe skipper survey protocol

Just got this yesterday, but did a quick review.

I agree with Silka's comments about two surveys being better than one. Try to conduct the surveys in low wind, but this is South Dakota so good luck. The weather will be the biggest factor in timing the surveys. These species have been known to have early flight periods in other years due to weather.

Your June 13 email states that your surveyor "will be doing the actual skipper surveys for this project the first week of July". If the Dakota skipper's peak flight time is late June to early July aren't you running the risk of missing the peak flight period? You might want to start now.

If your surveyor comes back with a negative report and comments about bad weather, I would recommend conducting surveys again next year. Dakota skippers are known to exist close to the project area.

If possible, please add Poweshiek skipperling (*Oarisma poweshiek*) to your list of species to watch for. There is a good possibility that this species will get some type of protected status in the future. It's flight time is mid-June to the end of July. I can get you more information on the species if you need it.

Thanks for the opportunity to review your protocol.

Charlene "Charlie" Bessken
Fish and Wildlife Biologist / TWS Certified Wildlife Biologist USFWS South Dakota Field
Office 420 South Garfield Avenue, Suite 400 Pierre, SD 57501
(605) 224-8693 Ext. 231
Fax 605-224-9974
<http://www.fws.gov/southdakotafieldoffice>

Natalie
Gates/R6/FWS/DOI

06/20/2008 02:47
PM

To
Charlene Bessken/R6/FWS/DOI@FWS
cc
Subject
Fw: Buffalo Ridge II - response to
SD GFP comments on proposed Dakota
and Ottoe skipper survey protocol

----- Forwarded by Natalie Gates/R6/FWS/DOI on 06/20/2008 02:47 PM -----

"Pickle, Joyce
E."
<Joyce.Pickle@hdr
inc.com>

<Silka.Kempema@state.sd.us> To
cc

06/20/2008 12:04
PM

<natalie_gates@fws.gov>, "Linehan,
Andrew"
<Andrew.Linehan@iberdrolausa.com>,
"Parsons, Sara McMahon"
<Sara.Parsons@iberdrolausa.com>,
"Seck, Timothy"
<Timothy.Seck@iberdrolausa.com>,
"Emery, Sarah L"
<Sarah.Emery@hdrinc.com>

Subject
Buffalo Ridge II - response to SD
GFP comments on proposed Dakota and
Ottoe skipper survey protocol

Hello Silka. I have talked with Dr. Selby about your office's comments on the proposed skipper survey protocol for the Buffalo Ridge II wind project in Brookings County. Below please find our responses to your comments - please call or write with any further questions or comments. Natalie, I'm cc'ing you since I know you are having someone in your office look at the protocol as well. Please feel free to share this with them too.

Thanks everyone, and have a good weekend!

SDGFP Comment 1:

Other key native plant species to watch for indicating Dakota Skipper habitat include again purple coneflower and also needle-and-thread. Little bluestem serves as the larval host plant. Energy sources for adults include purple coneflower, fleabane, and black-eyed susan.

For Ottoe Skipper relatively undisturbed tall and mixed grass prairie are appropriate habitat. Larval host plants include the bluestem grasses (little and big) and sideoats gramma. Coneflowers, gayfeathers, asters, milkweeds, alfalfa, leadplant, black-eyed susan and sunflowers are adult nectar sources.

HDR/IBR Response: Noted, surveyor will look for and document these species

SDGFP Comment 2:

"Little to no invasive plant species" needs further definition, although the photos seem representative of the appropriate places to survey. I think that if you focus on the presence of the nectar and larval food sources you'll be ok.

HDR/IBR Response: Prairie pasture parcels that may be impacted by construction and that contain the nectar/larval food sources noted above will be surveyed. Most of the pasture

parcels in the project area have a clear majority coverage of brome and other invasives (as shown on Photo 2)

SDGFP Comment #3:

Peak flight period of Ottoe skipper is mid-July

HDR/IBR Response: HDR concurs that the published guidelines show that the Ottoe skipper peak flight time is generally in mid July. The surveys for this Project will occur in early to early mid July in concert with other surveys in the project vicinity. The other surveys in the project vicinity will occur prior to this Project survey in parcels known to have the target species, and will serve as a baseline check that the target species are actually out and in flight in the general project area. HDR and Dr. Selby, the skipper surveyor, believe that these nearby surveys will determine the appropriate time for doing the surveys during this particular year.

SDGFP Comment #4:

I would counter that the Natural Heritage Database has already confirmed presence of the species in the general project vicinity and that surveys should be done in appropriate habitat. Skadsen (2003) identified native prairie south of Oak Lake Research Center along Deer creek as a priority for future suveys, indicating a high possibility that Dakota skippers may be present. See <http://www.sdgfp.info/Wildlife/Diversity/dskipper%20surveys.pdf> for a list of relevant SD-Dakota skipper literature.

HDR/IBR Response - In emails dated 6/17/08, Joyce Pickle of HDR clarified that: when we say that "surveys will be conducted once it has been determined that the target species are out in other areas in the general project vicinity" - this is just to clarify that we're planning on first going to sites known/documented to have these species in the project vicinity to try to confirm that these species are actually out and flying, before we go to these project-specific sites. We do understand that the species have been confirmed to occur in the project vicinity, but we are just trying to make as sure as possible that we're looking for them while they're out this year. Silka Kempema responded saying that the clarification made sense

SDGFP Comment #5:

A minimum of two surveys during the peak flight period would be preferred. Although there are published peak flight times for these two species and they do serve as a great guideline, they are not definitive and may vary with weather (cool and wet may delay) and location.

HDR/IBR Response - All attempts will be made to make two surveys at each suitable habitat site, as weather allows during flight time

SDGFP Comment #6:

I would suggest lowering the maximum wind speed to 10 mph [from 20 mph].

HDR/IBR Response -

All attempts will be made to survey at suitable sites when the wind speed is 10 mph or less. However, given the other time constraints of the limited flight time, and

temperature and cloud cover guidelines, plus the fact that the project site is within a proposed wind project with a high wind resource, it may not be feasible for every surveyed parcel.

SDGFP Comment #7:

Being with the Natural Heritage Program, I feel a need to recommend that observations of our monitored species (both the Dakota and Ottoe skipper) be reported for inclusion into our database

HDR/IBR Response - IBR will share any location information with the DNR and FWS if skipper species are found during the surveys in the project area.

Joyce

Joyce Pickle
Environmental Scientist

HDR ONE COMPANY | Many Solutions
701 Xenia Avenue South, Suite 600 | Minneapolis, MN | 55416
Phone: 763.591.5443 | Fax: 763.591.5413 | Email: joyce.pickle@hdrinc.com

Desmond, Meg

From: Natalie_Gates@fws.gov
Sent: Monday, June 23, 2008 12:06 PM
To: Pickle, Joyce E.
Subject: Re: Buffalo Ridge II - response to SD GFP comments on proposed Dakota and Ottoe skipper survey protocol

Joyce,

A few comments below on the avian/bat survey protocol you'd sent for this project....Charlene has not provided any feedback on the Dakota skipper protocol yet.

It appears that the avian survey will provide minimal information over a minimal timeframe. One year pre- and one year post-construction will provide some data, but will not be as useful as multiple years during those timeframes. No mortality searches are proposed to evaluate the survey predictions. Surveys do not appear intensive; sampling is to be done only every other week. A variety of factors may affect wildlife use of the project area over multiple seasons regardless of the proposed project, thus the information obtained over the timeframe proposed may not provide an adequate picture of actual use.

Will these surveys affect turbine locations? It is not clear that the survey information will be used to site turbines away from high-use bird/bat areas, but rather only to predict the level of impact anticipated.

In short, its good that there will be some data collected, but it appears to be relatively limited in its value/use. More intensive surveys over longer timeframes, with means of evaluating the predicted risks to birds/bats is recommended. And use of the data to site turbines in a manner to minimize wildlife impacts is also recommended.

One item to note: the project area encompasses known occupied Topeka shiner habitat. If access roads are to be built over/near Topeka streams, the potential for adverse affects to this minnow exist. Six mile Creek, North Deer Creek, and Deer Creek are all in the vicinity of the project and known to harbor this species. If the project may impact these waterways and their tributaries, further consultation with this office is needed.

Additionally, while the Western prairie fringed orchid has not been recently located in South Dakota, it may be possible that the species exists here in as yet undiscovered populations. If suitable habitat exists in the project area, surveys for this species should be considered and results reported to this office.

I did review the Dakota skipper protocol. One question in my mind is how the surveyors) will actually spot and identify skippers. It sound like they will simply walk around and look.....I would think it'd be very easy to miss these tiny butterflies, and be unable to identify them before they flutter off, but I will leave more specific comments to Charlene and forward those (if any) when I receive them. If you wish, you might contact Charlene Bessken directly at (605) 224-8693 extension 231.

Thank you for the opportunity to comment.

-Natalie

Natalie Gates
U.S. Fish and Wildlife Service
Ecological Services, South Dakota Field Office 420 South Garfield Avenue, Suite 400
Pierre, South Dakota 57501
Phone: (605) 224-8693 x234
Fax: (605) 224-9974
Email: Natalie_Gates@fws.gov



REPLY TO
ATTENTION OF

DEPARTMENT OF THE ARMY
CORPS OF ENGINEERS, OMAHA DISTRICT
SOUTH DAKOTA REGULATORY OFFICE
28563 POWERHOUSE ROAD, ROOM 118
PIERRE, SOUTH DAKOTA 57501-6174

August 7, 2008

South Dakota Regulatory Office
28563 Powerhouse Road, Room 118
Pierre, South Dakota 57501

HDR Engineering, Inc.
Attn: Joyce E. Pickle
701 Xenia Avenue South
Minneapolis, Minnesota 55416-3636

Dear Ms. Pickle,

Reference is made to the preliminary information received August 7, 2008, concerning Department of the Army authorization requirements for the proposed wind farm by PPM Energy in Brookings County, South Dakota.

The Corps' jurisdiction is derived from Section 404 calls for Federal regulation of the discharge of dredged or fill material into certain waterways, lakes and/or wetlands, (i.e. waters of the United States). If the proposed project involves either the discharge of dredged or fill material into waters subject to Federal regulation, it is requested that the project proponent submit an application for a Department of the Army permit.

Enclosed is the necessary application form (ENG Form 4345). When completing the application form, we would request from the applicant (a) a detailed description of the work activity [i.e., explain precisely what you are going to do and how you are going to accomplish it; include fill and/or excavation quantities and dimensions to be performed below the ordinary high water elevation (if in a lake, river or stream) or to be performed within the boundary of jurisdictional wetlands (if the project involves wetlands), along with the source/type of fill and the type of equipment to be used during construction]; (b) the purpose, need and/or benefits of the proposed project; and (c) any alternative project designs or locations considered.

Along with the completed application form, we would request from the applicant (1) detailed drawings (plan and cross-sectional views; the drawings should be submitted on 8-1/2x11 inch paper), (2) a location map showing the project site, (3) a delineation of affected wetlands if the project involves wetlands, (4) if available, colored pictures showing at least two views of the proposed project site and (5) any ecological or environmental information available that you feel may be pertinent to your project (i.e., area wildlife activity, area vegetation, area land use, quality of fishery, etc.).

RECEIVED
AUG 7 1 2008
HDR Engineering, Inc.

Adherence to the above information requests will speed up the application evaluation and permit processing time. The requested information is used to help the Corps determine the type of permit to process if a permit is required and is used in the public review.

Regarding your request for comment relative to environmental impacts, this office assesses project impacts, including environmental impacts, after receipt of the detailed, site specific information required via our permit application process.

You can obtain additional information about the Regulatory Program and download forms from our website: <https://www.nwo.usace.army.mil/html/od-rsd/frame.html>.

If you have any questions or need any assistance, please feel free to contact this office at the above Regulatory Office address or telephone Carolyn Kutz at (605) 224-8531.

Sincerely,



Steven E. Naylor
Regulatory Program Manager,
South Dakota

Enclosures

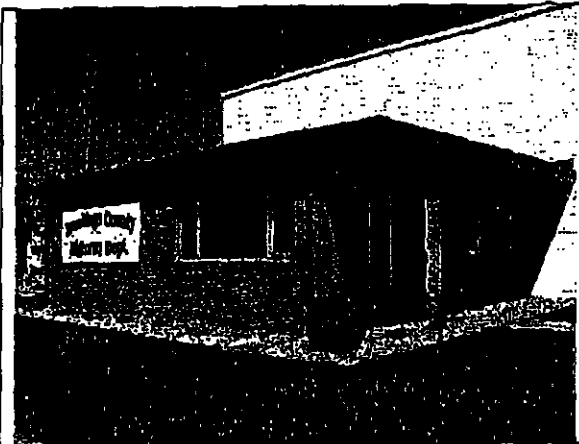

A facsimile from

Brookings County Highway

422 Western Avenue
Brookings, SD 57006

Phone: 605-696-8270
Fax: 605-696-8278

Pages: including this cover

To: *Joyce*
 Fax number: *1-763-591-5413*
 Phone: *763-591-5443*
 Attention: *Joyce.*

Date: 8/11/2008

Regarding: *Buffalo Ridge II Wind project,*

Comments: *Joyce I have read thru your fax, and reviewed the map. This area contains 6 of our County Roads. I have included a list of permits needed when occupying or using our*
 Please note: Office hours are Monday through Thursday 7:00 a.m. - 5:30 p.m. Central Standard Time. *Roads,*

Larry Jensen
 Larry Jensen
 Brookings County Highway Dept.

BROOKINGS COUNTY HIGHWAY DEPARTMENT
422 WESTERN AVE.
BROOKINGS, SD 57006
VOICE: 605-696-8270
FAX: 605-696-8278

AGREEMENT FOR USE AND RESTORATION HAUL ROAD DOT 45

Prior to the use of Brookings County roads an inspection (not to exceed 30 days prior) will be made of the haul road/roads to be used by the contractor. This agreement states that the contractor agrees to RESTORE the portion of county road used to haul. Application is legal upon signature from a Brookings County official.

AGREEMENT FOR USE AND RESTORATION OF CONTRACTOR'S HAUL ROAD

DOT 45A

Prior to the use of Brookings County roads and inspection (not to exceed 30 days prior) will be made of the haul road/roads to be used by the contractor. This agreement states that the contractor agrees to MAINTAIN DURING CONSTRUCTION the portion of county road used to haul. To include the contractor agrees to RESTORE after construction the portion of county road used to haul. Application is legal upon signature from a Brookings County official.

HAUL ROUTE INSPECTON REPORT DOT 45 & 45A

The agreement as to the condition of the haul road.

AGREEMENT FOR USE AND RESTORATION OF HAUL ROAD RELEASE

Upon completion of the construction project and inspection will determine the condition of the restored haul road by Brookings County Highway Superintendent and contractor representative. This document will release the contractor once repairs are complete to the satisfaction of the highway superintendent. Application is legal upon signature from a Brookings County official.

DRIVEWAY APPLICATION AND CONSTRUCTION PERMIT

The purpose of this permit is to determine the appropriate location for placement of a driveway or approach. Application is made to the highway superintendent. Safety is a major factor in approval of proposed location. The county will approve one approach per 1/4 mile. All others must be approved by the Superintendent but is built at the owners expense. Application is legal upon signature from a Brookings County official.

APPLICATION FOR OCCUPANCY OF RIGHT OF WAY OF COUNTY HIGHWAYS

This application is giving permission to bore or open cut Brookings County roads. Right of way is measured approximately 33 to 50 feet either side of the center line of the county road. Application is legal upon signature from a Brookings County official.

OVER WIDTH, OVER HEIGHT, OVER LENGTH PERMIT

This permit will give the carrier permission to travel Brookings County roads in the event that a load meets the legal load limits but is over width, over height or over length. Only single trip permits are issued. Multiple loads will require multiple permits. Over width is anything over 8'6". Application is legal upon signature from a Brookings County official.

OVER WEIGHT AND OVER DIMENSION LOADS

The Brookings County Highway Superintendent may issue a single trip permit to allow the operation of a motor vehicle on the county roads in Brookings County in excess of the maximum weight or size set by state law. The request for a permit to exceed the maximum vehicle weight limit or size must be made at least twenty-four (24) hours in advance. Application is legal upon signature from a Brookings County official.



October 17, 2008

Michael M Olson
Township Clerk
Argo Township
19829 475th Ave
White, SD 57276

RE: Update to Buffalo Ridge II Wind Project in Brookings and Deuel Counties, South Dakota

Dear Mr. Olson:

HDR Engineering, Inc. (HDR) is currently gathering environmental information for the Buffalo Ridge II Wind Project proposed by Iberdrola Renewables (IBR) in Brookings and Deuel Counties, South Dakota. The purpose of this letter is to inform you that the boundaries of the Buffalo Ridge II Wind Project have been slightly modified from what was described in the April 25, 2008 letter sent to you. The project boundary now includes 18 sections in Deuel County and an additional section in Brookings County (Table 1). The project boundary has been extended in order to accommodate an increase in overall project size. The total megawatts (MW) for the project has increased from 210 MW to 306 MW. The general project description remains the same as described in the April 25, 2008 letter.

Table 1 below identifies the sections included in the extended project boundary that are in addition to the sections listed in the April 25, 2008 letter. Table 2 identifies the existing sections that were included in the April 25, 2008 letter; these sections remain within the project boundary.

IBR has applied to interconnect the wind farm with Xcel Energy's Brookings County Substation near White, South Dakota. Because the project is over 100 MW in size, IBR is required to apply for an Energy Facility Siting Permit through the South Dakota Public Utility Commission (SDPUC). IBR is planning to submit a permit application to the SDPUC in fall 2008 for the 306 MW project. At this time, HDR requests your review specifically of the project sections identified in Table 1. Your comments will be incorporated into the SDPUC review process for the Buffalo Ridge II project.

Table 1 – Sections within Extended Project Boundary

County	Township Name	Township	Range	Sections
Brookings	Lake Hendricks	112 N	47 W	30
Deuel	Scandinavia	113N	48W	26, 27, 28, 29, 30, 31, 32, 33, 34, 35
	Blom	113N	49W	25, 26, 27, 28, 33, 34, 35, 36

Table 2 – Sections within Original Project Area, Brookings County

Township Name	Township	Range	Sections
Richland	111 N	47 W	6, 7, 18, 19, 30
Lake Hendricks	112 N	47 W	31
Sherman	111 N	48 W	1, 2, 3, 4, 12, 13, 24, 25
Oak Lake	112 N	48 W	1-11, 14-23, 25-30, 32-36
Argo	112 N	49 W	1-4, 10-14, 23-26

Enclosed is a map detailing the location and revised project boundary of the Buffalo Ridge II Project area to facilitate your review. If you require further information or have questions regarding this matter, please call me at (763) 591-5443.

Sincerely,



Joyce E. Pickle
 Environmental Scientist

Enclosures:
 Updated Project Location Map

Cc: Timothy Seck, Iberdrola Renewables
 Sarah Emery, Iberdrola Renewables



ONE COMPANY | *Many Solutions*

October 17, 2008

Ruth Lenning
Township Clerk
Blom Township
19333 473 Avenue
Toronto, SD 57268

RE: Buffalo Ridge II 306 MW Wind Project in Brookings and Deuel Counties, South Dakota

Dear Ms. Lenning:

HDR Engineering, Inc. (HDR) is currently gathering environmental information for a 306 Megawatt (MW) Wind Project proposed by Iberdrola Renewables (formerly PPM Energy, Inc. (IBR)) in Brookings and Deuel Counties, South Dakota. IBR has applied to interconnect the wind farm with Xcel Energy's Brookings County Substation near White, South Dakota. Because the project is over 100 MW in size, IBR is required to apply for an Energy Facility Siting Permit through the South Dakota Public Utility Commission (SDPUC). Additionally, IBR will submit an application for a Conditional Use Permit for the proposed facility to the Brookings County Zoning office and Deuel County Zoning office, as applicable. HDR requests your review of the above-mentioned project to identify potential impacts from the project and any permits that the project might require. Your comments will be incorporated into the SDPUC review process for the Buffalo Ridge II project.

Typically wind facility construction includes erecting wind turbines and constructing associated facilities such as gravel access roads, an underground collector system and overhead 34.5 kV and 115 kV transmission lines. The original project boundary remained within Brookings County, but due to a recent increase in megawatts, was extended into Deuel County. Although final turbine locations, access roads and electrical connections have not been determined at this time, the table below identifies Township sections potentially affected by the project:

Table 1

County	Township Name	Township	Range	Sections
Deuel	Scandinavia	113N	48W	26-35
Deuel	Blom	113N	49W	25-28, 33-36
Brookings	Richland	111 N	47 W	6, 7, 18, 19, 30
Brookings	Lake Hendricks	112 N	47 W	30,31
Brookings	Sherman	111 N	48 W	1- 4, 12, 13, 24, 25
Brookings	Oak Lake	112 N	48 W	1-11, 14-23, 25-30, 32-36
Brookings	Argo	112 N	49 W	1-4, 10-14, 23-26

Your input on the project will assist IBR and HDR in their review of this project. If we do not hear from you within 30 days, we will assume that you have no comment on the project at this time. This notification precedes publication of the SDPUC Energy Facility Siting Permit application but does not preclude subsequent review and comment on the documents after publication. Other formal opportunities to comment on the project will follow at a later date when public information meetings and public hearings are held.

Enclosed is a project location map to facilitate your review. If you have any questions relating to this matter, please contact me at (763) 591-5443.

Sincerely,



Joyce E. Pickle
Environmental Scientist

Enclosures:
Project Location Map

Cc: Timothy Seck, Iberdrola Renewables
Sarah Emery, Iberdrola Renewables



ONE COMPANY | Many Solutions

October 17, 2008

Mr. Larry Benson
Superintendent
Brookings County Highway Department
422 Western Avenue
Brookings, SD 57006

RE: Update to Buffalo Ridge II Wind Project in Brookings and Deuel Counties, South Dakota

Dear Mr. Benson:

HDR Engineering, Inc. (HDR) is currently gathering environmental information for the Buffalo Ridge II Wind Project proposed by Iberdrola Renewables (IBR) in Brookings and Deuel Counties, South Dakota. The purpose of this letter is to inform you that the boundaries of the Buffalo Ridge II Wind Project have been slightly modified from what was described in the April 25, 2008 letter sent to you. The project boundary now includes 18 sections in Deuel County and an additional section in Brookings County (Table 1). The project boundary has been extended in order to accommodate an increase in overall project size. The total megawatts (MW) for the project has increased from 210 MW to 306 MW. The general project description remains the same as described in the April 25, 2008 letter.

Table 1 below identifies the sections included in the extended project boundary that are in addition to the sections listed in the April 25, 2008 letter. Table 2 identifies the existing sections that were included in the April 25, 2008 letter; these sections remain within the project boundary.

IBR has applied to interconnect the wind farm with Xcel Energy's Brookings County Substation near White, South Dakota. Because the project is over 100 MW in size, IBR is required to apply for an Energy Facility Siting Permit through the South Dakota Public Utility Commission (SDPUC). IBR is planning to submit a permit application to the SDPUC in fall 2008 for the 306 MW project. HDR received your August 11, 2008 reply, which identified the permits necessary for the previous project boundary. HDR requests your review of the sections listed in Table 1 to identify potential impacts from the extended project boundary and any additional permits that the project might require. Your comments will be incorporated into the SDPUC review process for the Buffalo Ridge II project.

Table 1 – Sections within Extended Project Boundary

County	Township Name	Township	Range	Sections
Brookings	Lake Hendricks	112 N	47 W	30
Deuel	Scandinavia	113N	48W	26, 27, 28, 29, 30, 31, 32, 33, 34, 35
	Blom	113N	49W	25, 26, 27, 28, 33, 34, 35, 36

Table 2 – Sections within Original Project Area, Brookings County

Township Name	Township	Range	Sections
Richland	111 N	47 W	6, 7, 18, 19, 30
Lake Hendricks	112 N	47 W	31
Sherman	111 N	48 W	1, 2, 3, 4, 12, 13, 24, 25
Oak Lake	112 N	48 W	1-11, 14-23, 25-30, 32-36
Argo	112 N	49 W	1-4, 10-14, 23-26

Enclosed is a map detailing the location and revised project boundary of the Buffalo Ridge II Project area to facilitate your review. If you require further information or have questions regarding this matter, please call me at (763) 591-5443.

Sincerely,



Joyce E. Pickle
 Environmental Scientist

Enclosures:
 Updated Project Location Map

Cc: Timothy Seck, Iberdrola Renewables
 Sarah Emery, Iberdrola Renewables



October 17, 2008

Mr. Robert Hill
Supervisor
Brookings County Zoning & Drainage Office
County Resource Center
826 32nd Avenue
Brookings, SD 57006

RE: Update to Buffalo Ridge II Wind Project in Brookings and Deuel Counties, South Dakota

Dear Mr. Hill:

HDR Engineering, Inc. (HDR) is currently gathering environmental information for the Buffalo Ridge II Wind Project proposed by Iberdrola Renewables (IBR) in Brookings and Deuel Counties, South Dakota. The purpose of this letter is to inform you that the boundaries of the Buffalo Ridge II Wind Project have been slightly modified from what was described in the April 25, 2008 letter sent to you. The project boundary now includes 18 sections in Deuel County and an additional section in Brookings County (Table 1). The project boundary has been extended in order to accommodate an increase in overall project size. The total megawatts (MW) for the project has increased from 210 MW to 306 MW. The general project description remains the same as described in the April 25, 2008 letter.

Table 1 below identifies the sections included in the extended project boundary that are in addition to the sections listed in the April 25, 2008 letter. Table 2 identifies the existing sections that were included in the April 25, 2008 letter; these sections remain within the project boundary.

IBR has applied to interconnect the wind farm with Xcel Energy's Brookings County Substation near White, South Dakota. Because the project is over 100 MW in size, IBR is required to apply for an Energy Facility Siting Permit through the South Dakota Public Utility Commission (SDPUC). IBR is planning to submit a permit application to the SDPUC in fall 2008 for the 306 MW project. HDR received your August 19, 2008 response, which identified the permits necessary for the previous project boundary. HDR requests your review of the sections listed in Table 1 to identify potential impacts from the extended project boundary and any additional permits that the project might require. Your comments will be incorporated into the SDPUC review process for the Buffalo Ridge II project.

Table 1 – Sections within Extended Project Boundary

County	Township Name	Township	Range	Sections
Brookings	Lake Hendricks	112 N	47 W	30
Deuel	Scandinavia	113N	48W	26, 27, 28, 29, 30, 31, 32, 33, 34, 35
	Blom	113N	49W	25, 26, 27, 28, 33, 34, 35, 36

Table 2 – Sections within Original Project Area, Brookings County

Township Name	Township	Range	Sections
Richland	111 N	47 W	6, 7, 18, 19, 30
Lake Hendricks	112 N	47 W	31
Sherman	111 N	48 W	1, 2, 3, 4, 12, 13, 24, 25
Oak Lake	112 N	48 W	1-11, 14-23, 25-30, 32-36
Argo	112 N	49 W	1-4, 10-14, 23-26

Enclosed is a map detailing the location and revised project boundary of the Buffalo Ridge II Project area to facilitate your review. If you require further information or have questions regarding this matter, please call me at (763) 591-5443.

Sincerely,



Joyce E. Pickle
 Environmental Scientist

Enclosures:
 Updated Project Location Map

Cc: Timothy Seck, Iberdrola Renewables
 Sarah Emery, Iberdrola Renewables



ONE COMPANY | *Many Solutions*

October 17, 2008

Mr. Bruce Lindholm
Program Manager
South Dakota Aeronautics Commission
700 East Broadway
Pierre, SD 57501

RE: Update to Buffalo Ridge II Wind Project in Brookings and Deuel Counties, South Dakota

Dear Mr. Lindholm:

HDR Engineering, Inc. (HDR) is currently gathering environmental information for the Buffalo Ridge II Wind Project proposed by Iberdrola Renewables (IBR) in Brookings and Deuel Counties, South Dakota. The purpose of this letter is to inform you that the boundaries of the Buffalo Ridge II Wind Project have been slightly modified from what was described in the April 25, 2008 letter sent to you. The project boundary now includes these sections in Deuel County (Table 1) and Section 30 of Lake Hendricks Township in Brookings County. The project boundary has been extended in order to accommodate an increase in overall project size. The total megawatts (MW) for the project has increased from 210 MW to 306 MW. The general project description remains the same as described in the April 25, 2008 letter.

Table 1 below identifies the sections included in the extended project boundary that are in addition to the sections listed in the April 25, 2008 letter. Table 2 identifies the existing sections that were included in the April 25, 2008 letter; these sections remain within the project boundary.

IBR has applied to interconnect the wind farm with Xcel Energy's Brookings County Substation near White, South Dakota. Because the project is over 100 MW in size, IBR is required to apply for an Energy Facility Siting Permit through the South Dakota Public Utility Commission (SDPUC). IBR is planning to submit a permit application to the SDPUC in fall 2008 for the 306 MW project. HDR received Jennifer Clements' May 6, 2008 letter, which indicated the need for an Aeronautical Hazard Permit. HDR requests your review of the sections listed in Table 1 to identify potential impacts from the project and any additional permits that the project might require. Your comments will be incorporated into the SDPUC review process for the Buffalo Ridge II project.

Table 1 – Sections within Extended Project Boundary

County	Township Name	Township	Range	Sections
Brookings	Lake Hendricks	112 N	47 W	30
Deuel	Scandinavia	113N	48W	26, 27, 28, 29, 30, 31, 32, 33, 34, 35
	Blom	113N	49W	25, 26, 27, 28, 33, 34, 35, 36

Table 2 – Sections within Original Project Area, Brookings County

Township Name	Township	Range	Sections
Richland	111 N	47 W	6, 7, 18, 19, 30
Lake Hendricks	112 N	47 W	31
Sherman	111 N	48 W	1, 2, 3, 4, 12, 13, 24, 25
Oak Lake	112 N	48 W	1-11, 14-23, 25-30, 32-36
Argo	112 N	49 W	1-4, 10-14, 23-26

Enclosed is a map detailing the location and revised project boundary of the Buffalo Ridge II Project area to facilitate your review. If you require further information or have questions regarding this matter, please call me at (763) 591-5443.

Sincerely,



Joyce E. Pickle
 Environmental Scientist

Enclosures:
 Updated Project Location Map

Cc: Timothy Seck, Iberdrola Renewables
 Sarah Emery, Iberdrola Renewables



ONE COMPANY | Many Solutions™

October 17, 2008

Mr. Doug Backlund
South Dakota Department of Game, Fish and Parks
Foss Building
523 East Capitol
Pierre, SD 57501-3182

RE: Update to Buffalo Ridge II Wind Project in Brookings and Deuel Counties, South Dakota

Dear Mr. Backlund:

HDR Engineering, Inc. (HDR) is currently gathering environmental information for the Buffalo Ridge II Wind Project proposed by Iberdrola Renewables (IBR) in Brookings and Deuel Counties, South Dakota. The purpose of this letter is to inform you that the boundaries of the Buffalo Ridge II Wind Project have been slightly modified from what was described in the April 25, 2008 letter sent to you. The project boundary now includes 18 sections in Deuel County and an additional section in Brookings County (Table 1). The project boundary has been extended in order to accommodate an increase in overall project size. The total megawatts (MW) for the project has increased from 210 MW to 306 MW. The general project description remains the same as described in the April 25, 2008 letter.

Table 1 below identifies the sections included in the extended project boundary that are in addition to the sections listed in the April 25, 2008 letter. Table 2 identifies the existing sections that were included in the April 25, 2008 letter; these sections remain within the project boundary.

IBR has applied to interconnect the wind farm with Xcel Energy's Brookings County Substation near White, South Dakota. Because the project is over 100 MW in size, IBR is required to apply for an Energy Facility Siting Permit through the South Dakota Public Utility Commission (SDPUC). IBR is planning to submit a permit application to the SDPUC in fall 2008 for the 306 MW project. HDR received your May 8, 2008 response containing documented occurrences of state and federal species within the initial project boundary. At this time, HDR requests your review specifically of the project sections identified in Table 1 for potential effects to known federally and state-listed threatened or endangered species and rare natural features. Your comments will be incorporated into the SDPUC review process for the Buffalo Ridge II project.

Table 1 – Sections within Extended Project Boundary

County	Township Name	Township	Range	Sections
Brookings	Lake Hendricks	112 N	47 W	30
Deuel	Scandinavia	113N	48W	26, 27, 28, 29, 30, 31, 32, 33, 34, 35
	Blom	113N	49W	25, 26, 27, 28, 33, 34, 35, 36

Table 2 – Sections within Original Project Area, Brookings County

Township Name	Township	Range	Sections
Richland	111 N	47 W	6, 7, 18, 19, 30
Lake Hendricks	112 N	47 W	31
Sherman	111 N	48 W	1, 2, 3, 4, 12, 13, 24, 25
Oak Lake	112 N	48 W	1-11, 14-23, 25-30, 32-36
Argo	112 N	49 W	1-4, 10-14, 23-26

Enclosed are a map and shapefile detailing the location and revised project boundary of the Buffalo Ridge II Project area to facilitate your review. Please provide us with GIS species data for the sections listed in Table 1. If you require further information or have questions regarding this matter, please call me at (763) 591-5443.

Sincerely,



Joyce E. Pickle
 Environmental Scientist

Enclosures:
 Updated Project Location Map
 Project Location Shapefile

Cc: Timothy Seck, Iberdrola Renewables
 Sarah Emery, Iberdrola Renewables



ONE COMPANY | Many Solutions

October 17, 2008

Ms. Silka Kempema
Environmental Review & Management
South Dakota Department of Game, Fish and Parks
Foss Building
523 East Capitol
Pierre, SD 57501-3182

RE: Update to Buffalo Ridge II Wind Project in Brookings and Deuel Counties, South Dakota

Dear Ms. Kempema:

HDR Engineering, Inc. (HDR) is currently gathering environmental information for the Buffalo Ridge II Wind Project proposed by Iberdrola Renewables (IBR) in Brookings and Deuel Counties, South Dakota. The project boundary now includes 18 sections in Deuel County and an additional section in Brookings County (Table 1). The project boundary now includes these sections in Deuel County (Table 1) and Section 30 of Lake Hendricks Township in Brookings County. The project boundary has been extended in order to accommodate an increase in overall project size. The total megawatts (MW) for the project has increased from 210 MW to 306 MW. The general project description remains the same as described in the April 25, 2008 letter.

Table 1 below identifies the sections included in the extended project boundary that are in addition to the sections listed in the April 25, 2008 letter. Table 2 identifies the existing sections that were included in the April 25, 2008 letter; these sections remain within the project boundary.

IBR has applied to interconnect the wind farm with Xcel Energy's Brookings County Substation near White, South Dakota. Because the project is over 100 MW in size, IBR is required to apply for an Energy Facility Siting Permit through the South Dakota Public Utility Commission (SDPUC). IBR is planning to submit a permit application to the SDPUC in fall 2008 for the 306 MW project. HDR received your June 3, 2008 response letter to the initial project boundary. At this time, HDR requests your review specifically of the project sections identified in Table 1 for potential effects to known federally and state-listed threatened or endangered species and rare natural features. At this time, HDR requests your review specifically of the project sections identified in Table 1 to identify potential impacts from the project. Your comments will be incorporated into the SDPUC review process for the Buffalo Ridge II project.

Table 1 – Sections within Extended Project Boundary

County	Township Name	Township	Range	Sections
Brookings	Lake Hendricks	112 N	47 W	30
Deuel	Scandinavia	113N	48W	26, 27, 28, 29, 30, 31, 32, 33, 34, 35
	Blom	113N	49W	25, 26, 27, 28, 33, 34, 35, 36

Table 2 – Sections within Original Project Area, Brookings County

Township Name	Township	Range	Sections
Richland	111 N	47 W	6, 7, 18, 19, 30
Lake Hendricks	112 N	47 W	31
Sherman	111 N	48 W	1, 2, 3, 4, 12, 13, 24, 25
Oak Lake	112 N	48 W	1-11, 14-23, 25-30, 32-36
Argo	112 N	49 W	1-4, 10-14, 23-26

Enclosed is a map detailing the location and revised project boundary of the Buffalo Ridge II Project area to facilitate your review. If you require further information or have questions regarding this matter, please call me at (763) 591-5443.

Sincerely,



Joyce E. Pickle
 Environmental Scientist

Enclosures:
 Updated Project Location Map

Cc: Timothy Seck, Iberdrola Renewables
 Sarah Emery, Iberdrola Renewables



October 17, 2008

Ms. Paige Hoskinson Olson
South Dakota State Historical Society
Cultural Heritage Center
Pierre, SD 57501-2217

RE: Update to Buffalo Ridge II Wind Project in Brookings and Deuel Counties, South Dakota

Dear Ms. Hoskinson Olson:

HDR Engineering, Inc. (HDR) is currently gathering environmental information for the Buffalo Ridge II Wind Project proposed by Iberdrola Renewables (IBR) in Brookings and Deuel Counties, South Dakota. The purpose of this letter is to inform you that the boundaries of the Buffalo Ridge II Wind Project have been slightly modified from what was described in the April 25, 2008 letter sent to you. The project boundary now includes these sections in Deuel County (Table 1) and Section 30 of Lake Hendricks Township in Brookings County. The project boundary has been extended in order to accommodate an increase in overall project size. The total megawatts (MW) for the project has increased from 210 MW to 306 MW. The general project description remains the same as described in the April 25, 2008 letter.

Table 1 below identifies the sections included in the extended project boundary that are in addition to the sections listed in the April 25, 2008 letter. Table 2 identifies the existing sections that were included in the April 25, 2008 letter; these sections remain within the project boundary.

IBR has applied to interconnect the wind farm with Xcel Energy's Brookings County Substation near White, South Dakota. Because the project is over 100 MW in size, IBR is required to apply for an Energy Facility Siting Permit through the South Dakota Public Utility Commission (SDPUC). IBR is planning to submit a permit application to the SDPUC in fall 2008 for the 306 MW project. HDR received Jay Vogt's May 7, 2008 response letter to the initial project boundary. At this time, HDR requests your review specifically of the project sections identified in Table 1. Your comments will be incorporated into the SDPUC review process for the Buffalo Ridge II project. The SD Energy Facility Siting Rules require applicants to describe and forecast impacts on cultural resources including "places of historical significance" and "landmarks and cultural resources of historic, religious, archaeological, scenic, natural, or other cultural significance." While coordination with the State Historic Preservation Office (SHPO) is not required during the SDPUC application process, IBR recognizes that your office has a keen interest in the cultural resources of South Dakota and their protection. We welcome any comments the SHPO may have at this time or throughout the permit application process on the additional Township sections.

Table 1 – Sections within Extended Project Boundary

County	Township Name	Township	Range	Sections
Brookings	Lake Hendricks	112 N	47 W	30
Deuel	Scandinavia	113N	48W	26, 27, 28, 29, 30, 31, 32, 33, 34, 35
	Blom	113N	49W	25, 26, 27, 28, 33, 34, 35, 36

Table 2 – Sections within Original Project Area, Brookings County

Township Name	Township	Range	Sections
Richland	111 N	47 W	6, 7, 18, 19, 30
Lake Hendricks	112 N	47 W	31
Sherman	111 N	48 W	1, 2, 3, 4, 12, 13, 24, 25
Oak Lake	112 N	48 W	1-11, 14-23, 25-30, 32-36
Argo	112 N	49 W	1-4, 10-14, 23-26

Enclosed is a map detailing the location and revised project boundary of the Buffalo Ridge II Project area to facilitate your review. If you require further information or have questions regarding this matter, please call me at (763) 591-5443.

Sincerely,



Joyce E. Pickle
 Environmental Scientist

Enclosures:
 Updated Project Location Map

Cc: Timothy Seck, Iberdrola Renewables
 Sarah Emery, Iberdrola Renewables



ONE COMPANY | *Many Solutions*

October 17, 2008

Mr. Steve Naylor
Regulatory Program Manager
U.S. Army Corps of Engineers
28563 Powerhouse Road, Room 118
Pierre, SD 57501

RE: Update to Buffalo Ridge II Wind Project in Brookings and Deuel Counties, South Dakota

Dear Mr. Naylor:

HDR Engineering, Inc. (HDR) is currently gathering environmental information for the Buffalo Ridge II Wind Project proposed by Iberdrola Renewables (IBR) in Brookings and Deuel Counties, South Dakota. The purpose of this letter is to inform you that the boundaries of the Buffalo Ridge II Wind Project have been slightly modified from what was described in the April 25, 2008 letter sent to you. The project boundary now includes 18 sections in Deuel County and an additional section in Brookings County (Table 1). The project boundary has been extended in order to accommodate an increase in overall project size. The total megawatts (MW) for the project has increased from 210 MW to 306 MW. The general project description remains the same as described in the April 25, 2008 letter.

Table 1 below identifies the sections included in the extended project boundary that are in addition to the sections listed in the April 25, 2008 letter. Table 2 identifies the existing sections that were included in the April 25, 2008 letter; these sections remain within the project boundary.

IBR has applied to interconnect the wind farm with Xcel Energy's Brookings County Substation near White, South Dakota. Because the project is over 100 MW in size, IBR is required to apply for an Energy Facility Siting Permit through the South Dakota Public Utility Commission (SDPUC). IBR is planning to submit a permit application to the SDPUC in fall 2008 for the 306 MW project. HDR received your August 7, 2008 response letter and request for site specific information to the initial project boundary. As the project design is finalized, HDR and IBR will coordinate more with your office regarding more project specific information. At this time, HDR requests your review specifically of the project sections identified in Table 1. Your comments will be incorporated into the SDPUC review process for the Buffalo Ridge II project.

Table 1 – Sections within Extended Project Boundary

County	Township Name	Township	Range	Sections
Brookings	Lake Hendricks	112 N	47 W	30
Deuel	Scandinavia	113N	48W	26, 27, 28, 29, 30, 31, 32, 33, 34, 35
	Blom	113N	49W	25, 26, 27, 28, 33, 34, 35, 36

Table 2 – Sections within Original Project Area, Brookings County

Township Name	Township	Range	Sections
Richland	111 N	47 W	6, 7, 18, 19, 30
Lake Hendricks	112 N	47 W	31
Sherman	111 N	48 W	1, 2, 3, 4, 12, 13, 24, 25
Oak Lake	112 N	48 W	1-11, 14-23, 25-30, 32-36
Argo	112 N	49 W	1-4, 10-14, 23-26

Enclosed is a map detailing the location and revised project boundary of the Buffalo Ridge II Project area to facilitate your review. If you require further information or have questions regarding this matter, please call me at (763) 591-5443.

Sincerely,



Joyce E. Pickle
 Environmental Scientist

Enclosures:
 Updated Project Location Map

Cc: Timothy Seck, Iberdrola Renewables
 Sarah Emery, Iberdrola Renewables



ONE COMPANY | Many Solutions

October 17, 2008

Mr. Darrell Granbois
USDA - NRCS
Brookings County Field Office
205 6th Street
Brookings, MN 57006

RE: Update to Buffalo Ridge II Wind Project in Brookings and Deuel Counties, South Dakota

Dear Mr. Granbois:

HDR Engineering, Inc. (HDR) is currently gathering environmental information for the Buffalo Ridge II Wind Project proposed by Iberdrola Renewables (IBR) in Brookings and Deuel Counties, South Dakota. The purpose of this letter is to inform you that the boundaries of the Buffalo Ridge II Wind Project have been slightly modified from what was described in the April 25, 2008, letter sent to you. The project boundary now includes 18 sections in Deuel County and an additional section in Brookings County (Table 1). The project boundary has been extended in order to accommodate an increase in overall project size. The total megawatts (MW) for the project has increased from 210 MW to 306 MW. The general project description remains the same as described in the April 25, 2008, letter.

Table 1 below identifies the sections included in the extended project boundary that are in addition to the sections listed in the April 25, 2008, letter. Table 2 identifies the existing sections that were included in the April 25, 2008, letter; these sections remain within the project boundary.

IBR has applied to interconnect the wind farm with Xcel Energy's Brookings County Substation near White, South Dakota. Because the project is over 100 MW in size, IBR is required to apply for an Energy Facility Siting Permit through the South Dakota Public Utility Commission (SDPUC). IBR is planning to submit a permit application to the SDPUC in fall 2008 for the 306 MW project. HDR requests your review of the sections listed in Table 1 to identify potential impacts from the project and any permits that the project might require. Your comments will be incorporated into the SDPUC review process for the Buffalo Ridge II project.

Table 1 – Sections within Extended Project Boundary

County	Township Name	Township	Range	Sections
Brookings	Lake Hendricks	112 N	47 W	30
Deuel	Scandinavia	113N	48W	26, 27, 28, 29, 30, 31, 32, 33, 34, 35
	Blom	113N	49W	25, 26, 27, 28, 33, 34, 35, 36

Table 2 – Sections within Original Project Area, Brookings County

Township Name	Township	Range	Sections
Richland	111 N	47 W	6, 7, 18, 19, 30
Lake Hendricks	112 N	47 W	31
Sherman	111 N	48 W	1, 2, 3, 4, 12, 13, 24, 25
Oak Lake	112 N	48 W	1-11, 14-23, 25-30, 32-36
Argo	112 N	49 W	1-4, 10-14, 23-26

Enclosed is a map detailing the location and revised project boundary of the Buffalo Ridge II Project area to facilitate your review. If you require further information or have questions regarding this matter, please call me at (763) 591-5443.

Sincerely,



Joyce E. Pickle
 Environmental Scientist

Enclosures:
 Updated Project Location Map

Cc: Timothy Seck, Iberdrola Renewables
 Sarah Emery, Iberdrola Renewables



October 17, 2008

Ms. Natalie Gates
U.S. Fish and Wildlife Service
Ecological Services
420 South Garfield Avenue, Suite 400
Pierre, SD 57501

RE: Update to Buffalo Ridge II Wind Project in Brookings and Deuel Counties, South Dakota

Dear Ms. Gates:

HDR Engineering, Inc. (HDR) is currently gathering environmental information for the Buffalo Ridge II Wind Project proposed by Iberdrola Renewables (IBR) in Brookings and Deuel Counties, South Dakota. The purpose of this letter is to inform you that the boundaries of the Buffalo Ridge II Wind Project have been slightly modified from what was described in the April 25, 2008 letter sent to you. The project boundary now includes 18 sections in Deuel County and an additional section in Brookings County (Table 1). The project boundary has been extended in order to accommodate an increase in overall project size. The total megawatts (MW) for the project has increased from 210 MW to 306 MW. The general project description remains the same as described in the April 25, 2008 letter.

Table 1 below identifies the sections included in the extended project boundary that are in addition to the sections listed in the April 25, 2008 letter. Table 2 identifies the existing sections that were included in the April 25, 2008 letter; these sections remain within the project boundary.

IBR has applied to interconnect the wind farm with Xcel Energy's Brookings County Substation near White, South Dakota. Because the project is over 100 MW in size, IBR is required to apply for an Energy Facility Siting Permit through the South Dakota Public Utility Commission (SDPUC). IBR is planning to submit a permit application to the SDPUC in fall 2008 for the 306 MW project. HDR received comments from you on the initial project boundary in a July 31, 2008, phone conversation. We welcome any comments the U.S. Fish and Wildlife Service may have at this time or throughout the permit application process on the additional Township sections. In particular, HDR requests your review of the sections identified in Table 1 for potential effects to known federally-listed threatened or endangered species and rare natural features. Your comments will be incorporated into the SDPUC review process for the Buffalo Ridge II project.

Table 1 – Sections within Extended Project Boundary

County	Township Name	Township	Range	Sections
Brookings	Lake Hendricks	112 N	47 W	30
Deuel	Scandinavia	113N	48W	26, 27, 28, 29, 30, 31, 32, 33, 34, 35
	Blom	113N	49W	25, 26, 27, 28, 33, 34, 35, 36

Table 2 – Sections within Original Project Area, Brookings County

Township Name	Township	Range	Sections
Richland	111 N	47 W	6, 7, 18, 19, 30
Lake Hendricks	112 N	47 W	31
Sherman	111 N	48 W	1, 2, 3, 4, 12, 13, 24, 25
Oak Lake	112 N	48 W	1-11, 14-23, 25-30, 32-36
Argo	112 N	49 W	1-4, 10-14, 23-26

Enclosed is a map detailing the location and revised project boundary of the Buffalo Ridge II Project area to facilitate your review. If you require further information or have questions regarding this matter, please call me at (763) 591-5443.

Sincerely,



Joyce E. Pickle
 Environmental Scientist

Enclosures:
 Updated Project Location Map

Cc: Timothy Seck, Iberdrola Renewables
 Sarah Emery, Iberdrola Renewables



October 17, 2008

Mr. Tom Tornow
Manager, Madison Wetland Management District
U.S. Fish and Wildlife Service
P.O. Box 48
Madison, SD 57042

RE: Update to Buffalo Ridge II Wind Project in Brookings and Deuel Counties, South Dakota

Dear Mr. Tornow:

HDR Engineering, Inc. (HDR) is currently gathering environmental information for the Buffalo Ridge II Wind Project proposed by Iberdrola Renewables (IBR) in Brookings and Deuel Counties, South Dakota. The purpose of this letter is to inform you that the boundaries of the Buffalo Ridge II Wind Project have been slightly modified from what was described in the April 25, 2008 letter sent to you. The project boundary now includes 18 sections in Deuel County and an additional section in Brookings County (Table 1). The project boundary has been extended in order to accommodate an increase in overall project size. The total megawatts (MW) for the project has increased from 210 MW to 306 MW. The general project description remains the same as described in the April 25, 2008 letter.

Table 1 below identifies the sections included in the extended project boundary that are in addition to the sections listed in the April 25, 2008 letter. Table 2 identifies the existing sections that were included in the April 25, 2008 letter; these sections remain within the project boundary.

IBR has applied to interconnect the wind farm with Xcel Energy's Brookings County Substation near White, South Dakota. Because the project is over 100 MW in size, IBR is required to apply for an Energy Facility Siting Permit through the South Dakota Public Utility Commission (SDPUC). IBR is planning to submit a permit application to the SDPUC in fall 2008 for the 306 MW project. HDR has contacted the HAPET office and received information on USFWS easements and lands both within the original boundary and the expanded boundary, and cc'd your office on the maps that Sue Kvas from the HAPET office provided. We welcome any comments the you may have on the USFWS lands shown on the HAPET maps or any other issues of concern to your office at this time or throughout the permit application process. Your comments will be incorporated into the SDPUC review process for the Buffalo Ridge II project.

Table 1 – Sections within Extended Project Boundary

County	Township Name	Township	Range	Sections
Brookings	Lake Hendricks	112 N	47 W	30
Deuel	Scandinavia	113N	48W	26, 27, 28, 29, 30, 31, 32, 33, 34, 35
	Blom	113N	49W	25, 26, 27, 28, 33, 34, 35, 36

Table 2 – Sections within Original Project Area, Brookings County

Township Name	Township	Range	Sections
Richland	111 N	47 W	6, 7, 18, 19, 30
Lake Hendricks	112 N	47 W	31
Sherman	111 N	48 W	1, 2, 3, 4, 12, 13, 24, 25
Oak Lake	112 N	48 W	1-11, 14-23, 25-30, 32-36
Argo	112 N	49 W	1-4, 10-14, 23-26

Enclosed is a map detailing the location and revised project boundary of the Buffalo Ridge II Project area to facilitate your review. If you require further information or have questions regarding this matter, please call me at (763) 591-5443.

Sincerely,



Joyce E. Pickle
 Environmental Scientist

Enclosures:
 Updated Project Location Map

Cc: Timothy Seck, Iberdrola Renewables
 Sarah Emery, Iberdrola Renewables



ONE COMPANY | *Many Solutions™*

October 17, 2008

Mary Nosbush
Zoning Officer
Deuel County
PO Box 616
408 4th Street West
Clear Lake, SD 57226

RE: Buffalo Ridge II 306 MW Wind Project in Brookings and Deuel Counties, South Dakota

Dear Ms. Nosbush:

HDR Engineering, Inc. (HDR) is currently gathering environmental information for a 306 Megawatt (MW) Wind Project proposed by Iberdrola Renewables (formerly PPM Energy, Inc. (IBR)) in Brookings and Deuel Counties, South Dakota. IBR has applied to interconnect the wind farm with Xcel Energy's Brookings County Substation near White, South Dakota. Because the project is over 100 MW in size, IBR is required to apply for an Energy Facility Siting Permit through the South Dakota Public Utility Commission (SDPUC). Additionally, IBR will submit an application for a Conditional Use Permit for the proposed facility to the Brookings County Zoning office and Deuel County Zoning office, as applicable. HDR requests your review of the above-mentioned project to identify potential impacts from the project and any permits that the project might require. Your comments will be incorporated into the SDPUC review process for the Buffalo Ridge II project.

Typically wind facility construction includes erecting wind turbines and constructing associated facilities such as gravel access roads, an underground collector system and overhead 34.5 kV and 115 kV transmission lines. The original project boundary remained within Brookings County, but due to a recent increase in megawatts, was extended into Deuel County. Although final turbine locations, access roads and electrical connections have not been determined at this time, the table below identifies Township sections potentially affected by the project:

Table 1

County	Township Name	Township	Range	Sections
Deuel	Scandinavia	113N	48W	26-35
Deuel	Blom	113N	49W	25-28, 33-36
Brookings	Richland	111 N	47 W	6, 7, 18, 19, 30
Brookings	Lake Hendricks	112 N	47 W	30,31
Brookings	Sherman	111 N	48 W	1- 4, 12, 13, 24, 25
Brookings	Oak Lake	112 N	48 W	1-11, 14-23, 25-30, 32-36
Brookings	Argo	112 N	49 W	1-4, 10-14, 23-26

Your input on the project will assist IBR and HDR in their review of this project. If we do not hear from you within 30 days, we will assume that you have no comment on the project at this time. This notification precedes publication of the SDPUC Energy Facility Siting Permit application but does not preclude subsequent review and comment on the documents after publication. Other formal opportunities to comment on the project will follow at a later date when public information meetings and public hearings are held.

Enclosed is a project location map to facilitate your review. If you have any questions relating to this matter, please contact me at (763) 591-5443.

Sincerely,



Joyce E. Pickle
Environmental Scientist

Enclosures:
Project Location Map

Cc: Timothy Seck, Iberdrola Renewables
Sarah Emery, Iberdrola Renewables



ONE COMPANY | *Many Solutions*

October 17, 2008

Jamie Hintz
Highway Superintendent
Deuel County Highway Department
18028 SD Hwy 15
Clear Lake, SD 57226

RE: Buffalo Ridge II 306 MW Wind Project in Brookings and Deuel Counties, South Dakota

Dear Mr. Hintz:

HDR Engineering, Inc. (HDR) is currently gathering environmental information for a 306 Megawatt (MW) Wind Project proposed by Iberdrola Renewables (formerly PPM Energy, Inc. (IBR)) in Brookings and Deuel Counties, South Dakota. IBR has applied to interconnect the wind farm with Xcel Energy's Brookings County Substation near White, South Dakota. Because the project is over 100 MW in size, IBR is required to apply for an Energy Facility Siting Permit through the South Dakota Public Utility Commission (SDPUC). Additionally, IBR will submit an application for a Conditional Use Permit for the proposed facility to the Brookings County Zoning office and Deuel County Zoning office, as applicable. HDR requests your review of the above-mentioned project to identify potential impacts from the project and any permits that the project might require. Your comments will be incorporated into the SDPUC review process for the Buffalo Ridge II project.

Typically wind facility construction includes erecting wind turbines and constructing associated facilities such as gravel access roads, an underground collector system and overhead 34.5 kV and 115 kV transmission lines. The original project boundary remained within Brookings County, but due to a recent increase in megawatts, was extended into Deuel County. Although final turbine locations, access roads and electrical connections have not been determined at this time, the table below identifies Township sections potentially affected by the project:

Table 1

County	Township Name	Township	Range	Sections
Deuel	Scandinavia	113N	48W	26-35
Deuel	Blom	113N	49W	25-28, 33-36
Brookings	Richland	111 N	47 W	6, 7, 18, 19, 30
Brookings	Lake Hendricks	112 N	47 W	30,31
Brookings	Sherman	111 N	48 W	1- 4, 12, 13, 24, 25
Brookings	Oak Lake	112 N	48 W	1-11, 14-23, 25-30, 32-36
Brookings	Argo	112 N	49 W	1-4, 10-14, 23-26

Your input on the project will assist IBR and HDR in their review of this project. If we do not hear from you within 30 days, we will assume that you have no comment on the project at this time. This notification precedes publication of the SDPUC Energy Facility Siting Permit application but does not preclude subsequent review and comment on the documents after publication. Other formal opportunities to comment on the project will follow at a later date when public information meetings and public hearings are held.

Enclosed is a project location map to facilitate your review. If you have any questions relating to this matter, please contact me at (763) 591-5443.

Sincerely,



Joyce E. Pickle
Environmental Scientist

Enclosures:
Project Location Map

Cc: Timothy Seck, Iberdrola Renewables
Sarah Emery, Iberdrola Renewables



October 17, 2008

Thomas W Reeves
Township Clerk
Lake Hendricks Township
Box 6
Hendricks, MN 56136

RE: Update to Buffalo Ridge II Wind Project in Brookings and Deuel Counties, South Dakota

Dear Mr. Reeves:

HDR Engineering, Inc. (HDR) is currently gathering environmental information for the Buffalo Ridge II Wind Project proposed by Iberdrola Renewables (IBR) in Brookings and Deuel Counties, South Dakota. The purpose of this letter is to inform you that the boundaries of the Buffalo Ridge II Wind Project have been slightly modified from what was described in the April 25, 2008 letter sent to you. The project boundary now includes 18 sections in Deuel County and an additional section in Brookings County (Table 1). The project boundary has been extended in order to accommodate an increase in overall project size. The total megawatts (MW) for the project has increased from 210 MW to 306 MW. The general project description remains the same as described in the April 25, 2008 letter.

Table 1 below identifies the sections included in the extended project boundary that are in addition to the sections listed in the April 25, 2008 letter. Table 2 identifies the existing sections that were included in the April 25, 2008 letter; these sections remain within the project boundary.

IBR has applied to interconnect the wind farm with Xcel Energy's Brookings County Substation near White, South Dakota. Because the project is over 100 MW in size, IBR is required to apply for an Energy Facility Siting Permit through the South Dakota Public Utility Commission (SDPUC). IBR is planning to submit a permit application to the SDPUC in fall 2008 for the 306 MW project. HDR requests your review of the sections listed in Table 1 to identify potential impacts from the project and any permits that the project might require. Your comments will be incorporated into the SDPUC review process for the Buffalo Ridge II project.

Table 1 – Sections within Extended Project Boundary

County	Township Name	Township	Range	Sections
Brookings	Lake Hendricks	112 N	47 W	30
Deuel	Scandinavia	113N	48W	26, 27, 28, 29, 30, 31, 32, 33, 34, 35
	Blom	113N	49W	25, 26, 27, 28, 33, 34, 35, 36

Table 2 – Sections within Original Project Area, Brookings County

Township Name	Township	Range	Sections
Richland	111 N	47 W	6, 7, 18, 19, 30
Lake Hendricks	112 N	47 W	31
Sherman	111 N	48 W	1, 2, 3, 4, 12, 13, 24, 25
Oak Lake	112 N	48 W	1-11, 14-23, 25-30, 32-36
Argo	112 N	49 W	1-4, 10-14, 23-26

Enclosed is a map detailing the location and revised project boundary of the Buffalo Ridge II Project area to facilitate your review. If you require further information or have questions regarding this matter, please call me at (763) 591-5443.

Sincerely,



Joyce E. Pickle
 Environmental Scientist

Enclosures:
 Updated Project Location Map

Cc: Timothy Seck, Iberdrola Renewables
 Sarah Emery, Iberdrola Renewables



October 17, 2008

Norris Patrick
Township Clerk
Oak Lake Township
20062 482nd Ave
White, SD 57276

RE: Update to Buffalo Ridge II Wind Project in Brookings and Deuel Counties, South Dakota

Dear Mr. Patrick:

HDR Engineering, Inc. (HDR) is currently gathering environmental information for the Buffalo Ridge II Wind Project proposed by Iberdrola Renewables (IBR) in Brookings and Deuel Counties, South Dakota. The purpose of this letter is to inform you that the boundaries of the Buffalo Ridge II Wind Project have been slightly modified from what was described in the April 25, 2008 letter sent to you. The project boundary now includes 18 sections in Deuel County and an additional section in Brookings County (Table 1). The project boundary has been extended in order to accommodate an increase in overall project size. The total megawatts (MW) for the project has increased from 210 MW to 306 MW. The general project description remains the same as described in the April 25, 2008 letter.

Table 1 below identifies the sections included in the extended project boundary that are in addition to the sections listed in the April 25, 2008 letter. Table 2 identifies the existing sections that were included in the April 25, 2008 letter; these sections remain within the project boundary.

IBR has applied to interconnect the wind farm with Xcel Energy's Brookings County Substation near White, South Dakota. Because the project is over 100 MW in size, IBR is required to apply for an Energy Facility Siting Permit through the South Dakota Public Utility Commission (SDPUC). IBR is planning to submit a permit application to the SDPUC in fall 2008 for the 306 MW project. HDR requests your review of the sections listed in Table 1 to identify potential impacts from the project and any permits that the project might require. Your comments will be incorporated into the SDPUC review process for the Buffalo Ridge II project.

Table 1 – Sections within Extended Project Boundary

County	Township Name	Township	Range	Sections
Brookings	Lake Hendricks	112 N	47 W	30
Deuel	Scandinavia	113N	48W	26, 27, 28, 29, 30, 31, 32, 33, 34, 35
	Blom	113N	49W	25, 26, 27, 28, 33, 34, 35, 36

Table 2 – Sections within Original Project Area, Brookings County

Township Name	Township	Range	Sections
Richland	111 N	47 W	6, 7, 18, 19, 30
Lake Hendricks	112 N	47 W	31
Sherman	111 N	48 W	1, 2, 3, 4, 12, 13, 24, 25
Oak Lake	112 N	48 W	1-11, 14-23, 25-30, 32-36
Argo	112 N	49 W	1-4, 10-14, 23-26

Enclosed is a map detailing the location and revised project boundary of the Buffalo Ridge II Project area to facilitate your review. If you require further information or have questions regarding this matter, please call me at (763) 591-5443.

Sincerely,



Joyce E. Pickle
 Environmental Scientist

Enclosures:
 Updated Project Location Map

Cc: Timothy Seck, Iberdrola Renewables
 Sarah Emery, Iberdrola Renewables



October 17, 2008

Sharon Leiferman
Township Clerk
Richland Township
20584 486th Ave
White, SD 57276

RE: Update to Buffalo Ridge II Wind Project in Brookings and Deuel Counties, South Dakota

Dear Ms. Leiferman:

HDR Engineering, Inc. (HDR) is currently gathering environmental information for the Buffalo Ridge II Wind Project proposed by Iberdrola Renewables (IBR) in Brookings and Deuel Counties, South Dakota. The purpose of this letter is to inform you that the boundaries of the Buffalo Ridge II Wind Project have been slightly modified from what was described in the April 25, 2008 letter sent to you. The project boundary now includes 18 sections in Deuel County and an additional section in Brookings County (Table 1). The project boundary has been extended in order to accommodate an increase in overall project size. The total megawatts (MW) for the project has increased from 210 MW to 306 MW. The general project description remains the same as described in the April 25, 2008 letter.

Table 1 below identifies the sections included in the extended project boundary that are in addition to the sections listed in the April 25, 2008 letter. Table 2 identifies the existing sections that were included in the April 25, 2008 letter; these sections remain within the project boundary.

IBR has applied to interconnect the wind farm with Xcel Energy's Brookings County Substation near White, South Dakota. Because the project is over 100 MW in size, IBR is required to apply for an Energy Facility Siting Permit through the South Dakota Public Utility Commission (SDPUC). IBR is planning to submit a permit application to the SDPUC in fall 2008 for the 306 MW project. HDR requests your review of the sections listed in Table 1 to identify potential impacts from the project and any permits that the project might require. Your comments will be incorporated into the SDPUC review process for the Buffalo Ridge II project.

Table 1 – Sections within Extended Project Boundary

County	Township Name	Township	Range	Sections
Brookings	Lake Hendricks	112 N	47 W	30
Deuel	Scandinavia	113N	48W	26, 27, 28, 29, 30, 31, 32, 33, 34, 35
	Blom	113N	49W	25, 26, 27, 28, 33, 34, 35, 36

Table 2 – Sections within Original Project Area, Brookings County

Township Name	Township	Range	Sections
Richland	111 N	47 W	6, 7, 18, 19, 30
Lake Hendricks	112 N	47 W	31
Sherman	111 N	48 W	1, 2, 3, 4, 12, 13, 24, 25
Oak Lake	112 N	48 W	1-11, 14-23, 25-30, 32-36
Argo	112 N	49 W	1-4, 10-14, 23-26

Enclosed is a map detailing the location and revised project boundary of the Buffalo Ridge II Project area to facilitate your review. If you require further information or have questions regarding this matter, please call me at (763) 591-5443.

Sincerely,



Joyce E. Pickle
 Environmental Scientist

Enclosures:
 Updated Project Location Map

Cc: Timothy Seck, Iberdrola Renewables
 Sarah Emery, Iberdrola Renewables



ONE COMPANY | *Many Solutions*

October 17, 2008

Jesse Christianson
Township Clerk
Scandinavia Township
19471 485 Avenue
Astoria, SD 57213

RE: Buffalo Ridge II 306 MW Wind Project in Brookings and Deuel Counties, South Dakota

Dear Mr. Christianson:

HDR Engineering, Inc. (HDR) is currently gathering environmental information for a 306 Megawatt (MW) Wind Project proposed by Iberdrola Renewables (formerly PPM Energy, Inc. (IBR)) in Brookings and Deuel Counties, South Dakota. IBR has applied to interconnect the wind farm with Xcel Energy's Brookings County Substation near White, South Dakota. Because the project is over 100 MW in size, IBR is required to apply for an Energy Facility Siting Permit through the South Dakota Public Utility Commission (SDPUC). Additionally, IBR will submit an application for a Conditional Use Permit for the proposed facility to the Brookings County Zoning office and Deuel County Zoning office, as applicable. HDR requests your review of the above-mentioned project to identify potential impacts from the project and any permits that the project might require. Your comments will be incorporated into the SDPUC review process for the Buffalo Ridge II project.

Typically wind facility construction includes erecting wind turbines and constructing associated facilities such as gravel access roads, an underground collector system and overhead 34.5 kV and 115 kV transmission lines. The original project boundary remained within Brookings County, but due to a recent increase in megawatts, was extended into Deuel County. Although final turbine locations, access roads and electrical connections have not been determined at this time, the table below identifies Township sections potentially affected by the project:

Table 1

County	Township Name	Township	Range	Sections
Deuel	Scandinavia	113N	48W	26-35
Deuel	Blom	113N	49W	25-28, 33-36
Brookings	Richland	111 N	47 W	6, 7, 18, 19, 30
Brookings	Lake Hendricks	112 N	47 W	30,31
Brookings	Sherman	111 N	48 W	1- 4, 12, 13, 24, 25
Brookings	Oak Lake	112 N	48 W	1-11, 14-23, 25-30, 32-36
Brookings	Argo	112 N	49 W	1-4, 10-14, 23-26

Your input on the project will assist IBR and HDR in their review of this project. If we do not hear from you within 30 days, we will assume that you have no comment on the project at this time. This notification precedes publication of the SDPUC Energy Facility Siting Permit application but does not preclude subsequent review and comment on the documents after publication. Other formal opportunities to comment on the project will follow at a later date when public information meetings and public hearings are held.

Enclosed is a project location map to facilitate your review. If you have any questions relating to this matter, please contact me at (763) 591-5443.

Sincerely,



Joyce E. Pickle
Environmental Scientist

Enclosures:
Project Location Map

Cc: Timothy Seck, Iberdrola Renewables
Sarah Emery, Iberdrola Renewables



October 17, 2008

Mr. Tim Tollefsrud
Director, Environmental Services
South Dakota Department of Environment and Natural Resources
Joe Foss Building
523 East Capitol
Pierre, SD 57501

RE: Update to Buffalo Ridge II Wind Project in Brookings and Deuel Counties, South Dakota

Dear Mr. Tollefsrud:

HDR Engineering, Inc. (HDR) is currently gathering environmental information for the Buffalo Ridge II Wind Project proposed by Iberdrola Renewables (IBR) in Brookings and Deuel Counties, South Dakota. The purpose of this letter is to inform you that the boundaries of the Buffalo Ridge II Wind Project have been slightly modified from what was described in the April 25, 2008 letter sent to you. The project boundary now includes 18 sections in Deuel County and an additional section in Brookings County (Table 1). The project boundary has been extended in order to accommodate an increase in overall project size. The total megawatts (MW) for the project has increased from 210 MW to 306 MW. The general project description remains the same as described in the April 25, 2008 letter.

Table 1 below identifies the sections included in the extended project boundary that are in addition to the sections listed in the April 25, 2008 letter. Table 2 identifies the existing sections that were included in the April 25, 2008 letter; these sections remain within the project boundary.

IBR has applied to interconnect the wind farm with Xcel Energy's Brookings County Substation near White, South Dakota. Because the project is over 100 MW in size, IBR is required to apply for an Energy Facility Siting Permit through the South Dakota Public Utility Commission (SDPUC). IBR is planning to submit a permit application to the SDPUC in fall 2008 for the 306 MW project. HDR received John Miller's comments on the initial project boundary in a May 29, 2008 response letter. HDR additionally requests your review of the sections listed in Table 1 to identify potential impacts from the project and any permits that the project might require. Your comments will be incorporated into the SDPUC review process for the Buffalo Ridge II project.

Table 1 – Sections within Extended Project Boundary

County	Township Name	Township	Range	Sections
Brookings	Lake Hendricks	112 N	47 W	30
Deuel	Scandinavia	113N	48W	26, 27, 28, 29, 30, 31, 32, 33, 34, 35
	Blom	113N	49W	25, 26, 27, 28, 33, 34, 35, 36

Table 2 – Sections within Original Project Area, Brookings County

Township Name	Township	Range	Sections
Richland	111 N	47 W	6, 7, 18, 19, 30
Lake Hendricks	112 N	47 W	31
Sherman	111 N	48 W	1, 2, 3, 4, 12, 13, 24, 25
Oak Lake	112 N	48 W	1-11, 14-23, 25-30, 32-36
Argo	112 N	49 W	1-4, 10-14, 23-26

Enclosed is a map detailing the location and revised project boundary of the Buffalo Ridge II Project area to facilitate your review. If you require further information or have questions regarding this matter, please call me at (763) 591-5443.

Sincerely,



Joyce E. Pickle
 Environmental Scientist

Enclosures:
 Updated Project Location Map

Cc: Timothy Seck, Iberdrola Renewables
 Sarah Emery, Iberdrola Renewables



ONE COMPANY | *Many Solutions*

October 17, 2008

Mr. Tim Bjornberg
Director, Division of Planning & Engineering
South Dakota Department of Transportation
700 East Broadway Avenue
Pierre, SD 57501

RE: Update to Buffalo Ridge II Wind Project in Brookings and Deuel Counties, South Dakota

Dear Mr. Schaefer:

HDR Engineering, Inc. (HDR) is currently gathering environmental information for the Buffalo Ridge II Wind Project proposed by Iberdrola Renewables (IBR) in Brookings and Deuel Counties, South Dakota. The purpose of this letter is to inform you that the boundaries of the Buffalo Ridge II Wind Project have been slightly modified from what was described in the April 25, 2008 letter sent to you. The project boundary now includes 18 sections in Deuel County and an additional section in Brookings County (Table 1). The project boundary has been extended in order to accommodate an increase in overall project size. The total megawatts (MW) for the project has increased from 210 MW to 306 MW. The general project description remains the same as described in the April 25, 2008 letter.

Table 1 below identifies the sections included in the extended project boundary that are in addition to the sections listed in the April 25, 2008 letter. Table 2 identifies the existing sections that were included in the April 25, 2008 letter; these sections remain within the project boundary.

IBR has applied to interconnect the wind farm with Xcel Energy's Brookings County Substation near White, South Dakota. Because the project is over 100 MW in size, IBR is required to apply for an Energy Facility Siting Permit through the South Dakota Public Utility Commission (SDPUC). IBR is planning to submit a permit application to the SDPUC in fall 2008 for the 306 MW project. HDR spoke with you regarding the original project location on August 19, 2008, regarding potential permits that IBR may need if project facilities may occupy SDDOT right of way HDR requests your review of the sections listed in Table 1 to identify any other potential permits that the project might require. Your comments will be incorporated into the SDPUC review process for the Buffalo Ridge II project.

Table 1 – Sections within Extended Project Boundary

County	Township Name	Township	Range	Sections
Brookings	Lake Hendricks	112 N	47 W	30
Deuel	Scandinavia	113N	48W	26, 27, 28, 29, 30, 31, 32, 33, 34, 35
	Blom	113N	49W	25, 26, 27, 28, 33, 34, 35, 36

Table 2 – Sections within Original Project Area, Brookings County

Township Name	Township	Range	Sections
Richland	111 N	47 W	6, 7, 18, 19, 30
Lake Hendricks	112 N	47 W	31
Sherman	111 N	48 W	1, 2, 3, 4, 12, 13, 24, 25
Oak Lake	112 N	48 W	1-11, 14-23, 25-30, 32-36
Argo	112 N	49 W	1-4, 10-14, 23-26

Enclosed is a map detailing the location and revised project boundary of the Buffalo Ridge II Project area to facilitate your review. If you require further information or have questions regarding this matter, please call me at (763) 591-5443.

Sincerely,



Joyce E. Pickle
 Environmental Scientist

Enclosures:
 Updated Project Location Map

Cc: Timothy Seck, Iberdrola Renewables
 Sarah Emery, Iberdrola Renewables



ONE COMPANY | *Many Solutions*

October 17, 2008

Mr. Terry Peterson
Outside Plant Supervisor
Interstate Telecommunications Cooperative
312 Fourth Street West
Clear Lake, SD 57226

RE: Update to Buffalo Ridge II Wind Project in Brookings and Deuel Counties, South Dakota

Dear Mr. Peterson:

HDR Engineering, Inc. (HDR) is currently gathering environmental information for the Buffalo Ridge II Wind Project proposed by Iberdrola Renewables (IBR) in Brookings and Deuel Counties, South Dakota. The purpose of this letter is to inform you that the boundaries of the Buffalo Ridge II Wind Project have been slightly modified from what was described in the April 25, 2008 letter sent to you. The project boundary now includes 18 sections in Deuel County and an additional section in Brookings County (Table 1). The project boundary has been extended in order to accommodate an increase in overall project size. The total megawatts (MW) for the project has increased from 210 MW to 306 MW. The general project description remains the same as described in the April 25, 2008 letter.

Table 1 below identifies the sections included in the extended project boundary that are in addition to the sections listed in the April 25, 2008 letter. Table 2 identifies the existing sections that were included in the April 25, 2008 letter; these sections remain *within* the project boundary.

IBR has applied to interconnect the wind farm with Xcel Energy's Brookings County Substation near White, South Dakota. Because the project is over 100 MW in size, IBR is required to apply for an Energy Facility Siting Permit through the South Dakota Public Utility Commission (SDPUC). IBR is planning to submit a permit application to the SDPUC in fall 2008 for the 306 MW project. Based on the June 16, 2008 conference call with your office, IBR and HDR will continue to coordinate with your company regarding this project. HDR requests your review of the sections listed in Table 1 to identify potential impacts from the project and any permits that the project might require. Your comments will be incorporated into the SDPUC review process for the Buffalo Ridge II project.

Table 1 – Sections within Extended Project Boundary

County	Township Name	Township	Range	Sections
Brookings	Lake Hendricks	112 N	47 W	30
Deuel	Scandinavia	113N	48W	26, 27, 28, 29, 30, 31, 32, 33, 34, 35
	Blom	113N	49W	25, 26, 27, 28, 33, 34, 35, 36

Table 2 – Sections within Original Project Area, Brookings County

Township Name	Township	Range	Sections
Richland	111 N	47 W	6, 7, 18, 19, 30
Lake Hendricks	112 N	47 W	31
Sherman	111 N	48 W	1, 2, 3, 4, 12, 13, 24, 25
Oak Lake	112 N	48 W	1-11, 14-23, 25-30, 32-36
Argo	112 N	49 W	1-4, 10-14, 23-26

Enclosed is a map detailing the location and revised project boundary of the Buffalo Ridge II Project area to facilitate your review. If you require further information or have questions regarding this matter, please call me at (763) 591-5443.

Sincerely,



Joyce E. Pickle
 Environmental Scientist

Enclosures:
 Updated Project Location Map

Cc: Timothy Seck, Iberdrola Renewables
 Sarah Emery, Iberdrola Renewables



October 17, 2008

Wanda Tyler
Township Clerk
Sherman Township
47987 206th St
White, SD 57276

RE: Update to Buffalo Ridge II Wind Project in Brookings and Deuel Counties, South Dakota

Dear Ms. Tyler:

HDR Engineering, Inc. (HDR) is currently gathering environmental information for the Buffalo Ridge II Wind Project proposed by Iberdrola Renewables (IBR) in Brookings and Deuel Counties, South Dakota. The purpose of this letter is to inform you that the boundaries of the Buffalo Ridge II Wind Project have been slightly modified from what was described in the April 25, 2008 letter sent to you. The project boundary now includes 18 sections in Deuel County and an additional section in Brookings County (Table 1). The project boundary has been extended in order to accommodate an increase in overall project size. The total megawatts (MW) for the project has increased from 210 MW to 306 MW. The general project description remains the same as described in the April 25, 2008 letter.

Table 1 below identifies the sections included in the extended project boundary that are in addition to the sections listed in the April 25, 2008 letter. Table 2 identifies the existing sections that were included in the April 25, 2008 letter; these sections remain within the project boundary.

IBR has applied to interconnect the wind farm with Xcel Energy's Brookings County Substation near White, South Dakota. Because the project is over 100 MW in size, IBR is required to apply for an Energy Facility Siting Permit through the South Dakota Public Utility Commission (SDPUC). IBR is planning to submit a permit application to the SDPUC in fall 2008 for the 306 MW project. HDR requests your review of the sections listed in Table 1 to identify potential impacts from the project and any permits that the project might require. Your comments will be incorporated into the SDPUC review process for the Buffalo Ridge II project.

Table 1 – Sections within Extended Project Boundary

County	Township Name	Township	Range	Sections
Brookings	Lake Hendricks	112 N	47 W	30
Deuel	Scandinavia	113N	48W	26, 27, 28, 29, 30, 31, 32, 33, 34, 35
	Blom	113N	49W	25, 26, 27, 28, 33, 34, 35, 36

Table 2 – Sections within Original Project Area, Brookings County

Township Name	Township	Range	Sections
Richland	111 N	47 W	6, 7, 18, 19, 30
Lake Hendricks	112 N	47 W	31
Sherman	111 N	48 W	1, 2, 3, 4, 12, 13, 24, 25
Oak Lake	112 N	48 W	1-11, 14-23, 25-30, 32-36
Argo	112 N	49 W	1-4, 10-14, 23-26

Enclosed is a map detailing the location and revised project boundary of the Buffalo Ridge II Project area to facilitate your review. If you require further information or have questions regarding this matter, please call me at (763) 591-5443.

Sincerely,



Joyce E. Pickle
 Environmental Scientist

Enclosures:
 Updated Project Location Map

Cc: Timothy Seck, Iberdrola Renewables
 Sarah Emery, Iberdrola Renewables

Map Accompanying October Agency Letters

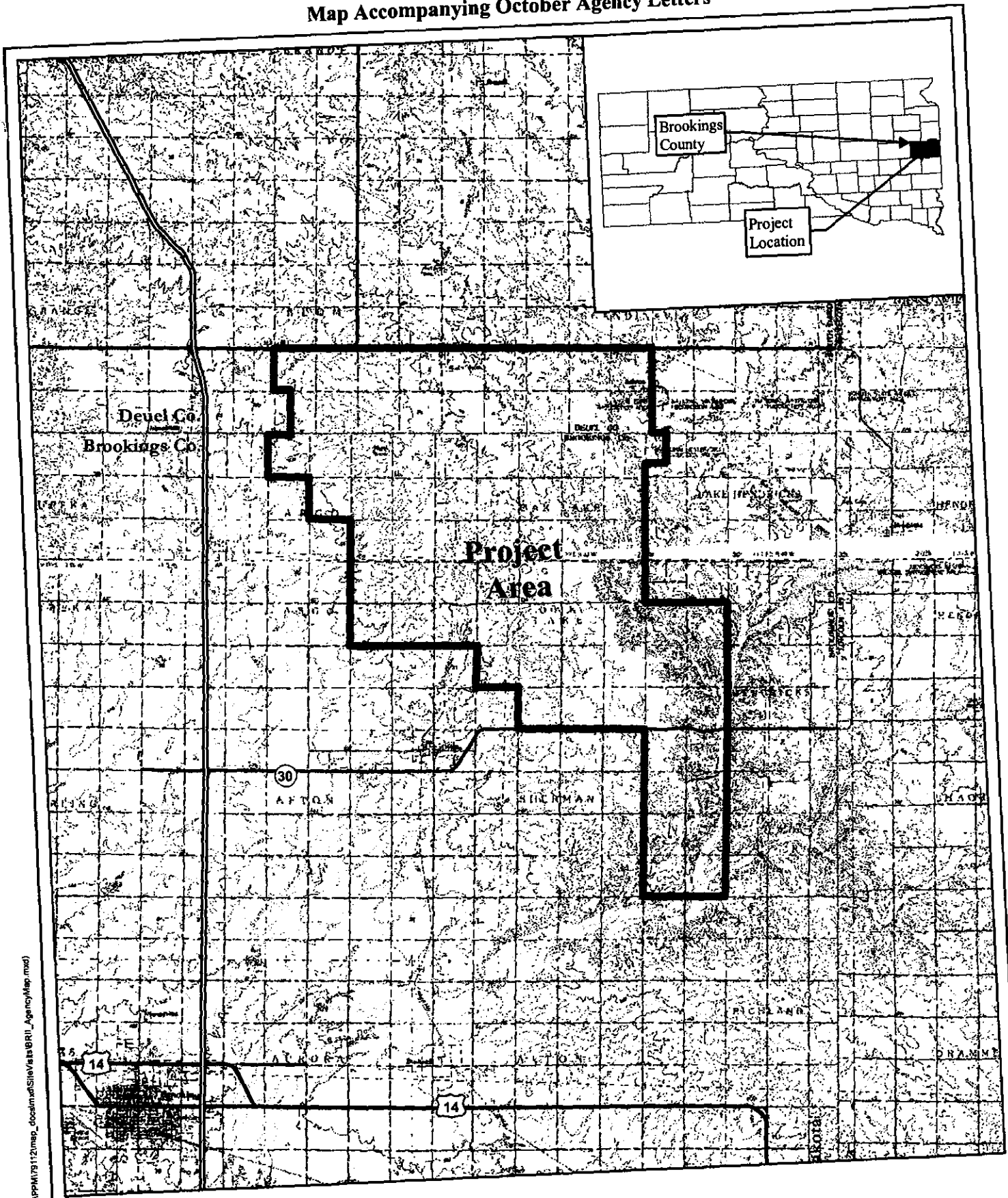
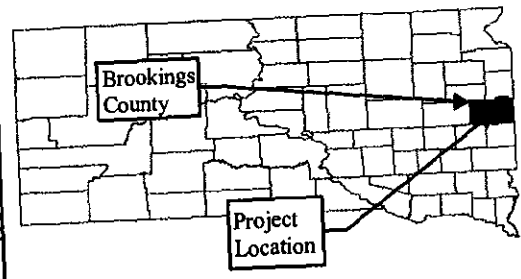

Project Location
Buffalo Ridge II
Iberdrola Renewables
Brookings and Deuel Counties, SD

Legend

- Site Boundary
- County



Map Document (\\n101192008-1.19.24) e:\gsa\ppm\79112\map_docs\mst\Site\IBR\IBR_II_Agency\Map.mxd