

RIGHT-OF-WAY HORIZONTAL REPRESENTATION (2D)	TRACT NUMBER OWNERSHIP/AGENCY	LENGTH APPLICABLE DWG. NO.	LAND USE
ML-SD-HA-0820.0000	661+4.2	667+85	
ML-SD-HA-0821.0000	667+85	667+85	
ML-SD-HA-0822.0000	667+85	667+85	
ML-SD-HA-0823.0000	667+85	667+85	
ML-SD-HA-0826.0000	667+85	667+85	
ML-SD-HA-0827.0000	667+85	667+85	

PIPELINE PROFILE
<p>HORIZ: 1"=500' VERT: 1"=100'</p>

LEGEND
— KEYSTONE PIPELINE
— STATE BOUNDARY
— COUNTY/TOWNSHIP
— SECTIONS
— NATIONAL OR STATE RESERVATION BOUNDARY
— PROPERTY LINE
— FENCE
— EXCLUSIONARY FENCE
— POWER LINE
— TELEPHONE LINE
— BURIED CABLE
— WATER LINE
— SANITARY SEWER LINE
— SD STORM SEWER / DRAIN
— FOREIGN PIPELINE
— RAILROAD
— HIGHWAY / ROAD
— STREAM / DITCH
— WETLAND
— INTERSTATE ROUTE
— U.S. ROUTE
— STATE ROUTE
— POINT OF INTERSECTION (PI)
— PIPELINE MILEPOST
— DIRECTION OF FLOW
— HOUSE
— BUILDING
— WATER WELL
— MAINLINE VALVE
— TRACT NUMBER

PIPELINE SCHEMATIC	STATIONS (2D)	STATIONS (3D)	REPRESENTATION (2D)
HEAVY WALL PIPE WELD FITTING TRANSITION PIECE CASING PIPE CONCRETE COATING SET-ON WEIGHTS PIPELINE WARNING SIGN PIPELINE MARKER MATERIAL ITEM			
GROUNDING MAT ZINC RIBBON AERIAL MARKER CATHODIC TEST STATION MAINLINE VALVE CHECK VALVE OPEN CUT BORE DRINKING WATER USA ECOLOGICAL USA HIGHLY POPULATED AREA OPERATOR (KEYSTONE) DEFINED OTHER POPULATED AREA SOURCE WATER PROTECTION AREA WELLHEAD PROTECTION AREA	650+42 651+00 5.0 CVR. 652+42 5.0 CVR. 657+31 M.P. 371 661+45 FENCE (BARBED WIRE) 663+48 P.L. 07'53.38' RT. 665+71 P.L. 11'34.04' RT. 665+11 P.L. 02'45.48' RT. 667+94 FENCE (BARBED WIRE) 668+08 7.0 CVR. 668+28 7.0 CVR. 668+38 7.0 CVR. 668+45 FENCE (BARBED WIRE) 670+27 P.L. 11'53.07' LT.	652+35 P.L. 08'24.48' RT. 667+85 668+45 FENCE (BARBED WIRE) 669+22 FENCE (BARBED WIRE) 669+22 FENCE (BARBED WIRE) 706+64 5.6 CVR. 707+81 FENCE (BARBED WIRE) 714+11 M.P. 372 714+14 P.L. 11'22.20' LT. 715+14 P.L. 13'49.30' LT. 716+48 P.L. 03'32.41' LT. 716+48 POWERLINE AND POWERLINE 716+48 POWERLINE AND POWERLINE 716+48 FENCE (BARBED WIRE) 716+48 EDGE OF ROAD 716+48 EDGE OF ROAD 717+11 EDGE OF ROAD 718+25 P.L. 05'16.15' RT. 77 CVR. 782+26 P.L. 07'20.06' LT. 788+08 P.L. 07'21.36' LT. 741+48 FENCE (BARBED WIRE) 741+48 WATER SUPPLY LINE 10.0 CVR. CLR. 0N/C. 751+48 P.L. 07'15.52' LT. 751+48 P.L. 11'03.52' LT. 754+28 P.L. 01'10.28' LT. 754+18 FENCE (BARBED WIRE) 765+38 5.0 CVR. 765+38 M.P. 373	

TEST SECTIONS (3D)	TEST SECTION 3B-3 ILTO-027-2010

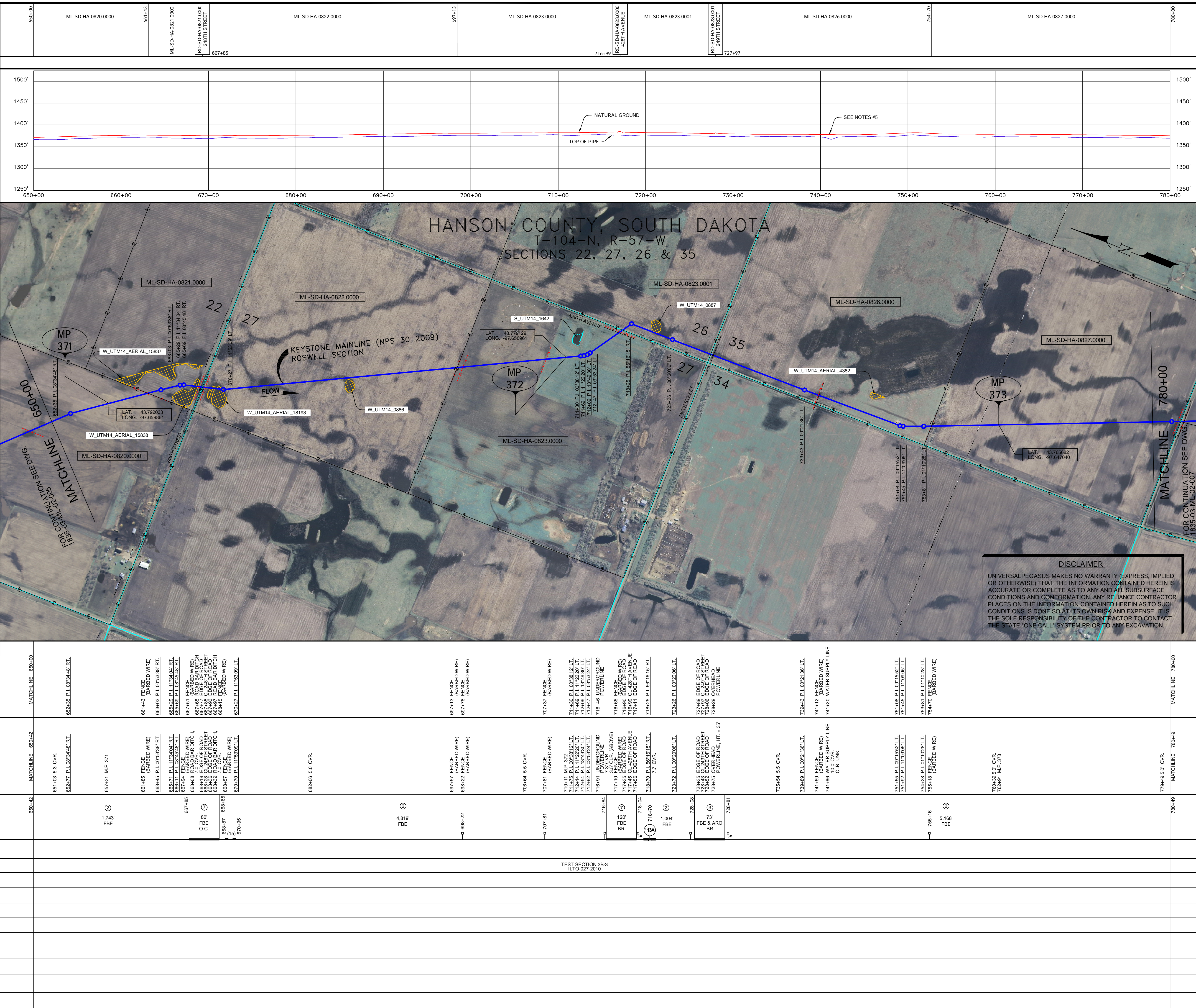

GENERAL NOTES	
1) ALL CHAINAGES ARE IN FEET UNLESS OTHERWISE SPECIFIED.	
2) DATUM ELEVATION AND PROJECTION ARE BASED ON MEAN SEA LEVEL AND NAD 83.	
3) FIELD PIPE LOCATING REQUIRED TO DETERMINE PLACEMENT OF PIPELINE WITHIN PERMANENT EASEMENT.	
4) UNLESS OTHERWISE NOTED, 48 INCHES MINIMUM COVER EXCEPT 36 INCHES IN AREAS OF CONSOLIDATED ROCK.	
5) NO ACTUAL AS-BUILT GROUND SHOTS WERE TAKEN AT THIS LOCATION. THE PROFILE REPRESENTS A PROJECTION FROM SHOTS TAKEN AT 150' TO 250' INTERVALS.	
6) THE TYPE OF COATING APPLIED TO THE FIELD WELDS DURING THE ORIGINAL CONSTRUCTION WAS TWO COMPONENT LIQUID EPOXY. THE COATING PRODUCTS USED WERE DENSO 7200 OR SPC SP-2888.	
7) THE SUBSTANTIAL CONSTRUCTION COMPLETION DATE, BASED ON CALPER PIG RUN, WAS OCTOBER 31, 2009 FOR M.P. 343.98 TO 377.31, NOVEMBER 01, 2009 FOR M.P. 377.29 TO 403.97 AND AUGUST 17, 2009 FOR M.P. 403.9 TO 422.96.	
8) ORIGINAL IN-SERVICE DATE OF THE KEYSTONE PIPELINE (PHASE 1): JUNE 30, 2010.	
9) CPS CALCULATION DATE: MAY 2010.	
10) ORION STATION SERIES NUMBER: 1182700.	
11) TO DETERMINE THE MILE POST AT A GIVEN LOCATION, ADD THE 3D STATION NUMBER FROM THIS SEGMENT TO THE STATION NUMBER 18931+49 AND DIVIDE BY 5280.	

OPERATING AND TEST PRESSURE	
1. THE MAXIMUM OPERATING PRESSURE (MOP) IS 1400 PSIG.	
2. THE MINIMUM TEST PRESSURE WAS 1600 PSIG.	

BILL OF MATERIALS (3D)		
ITEM NO.	DESCRIPTION	QUANTITY
2	30" O.D. X 0.386" W.T. API-5LX-70 W/FBE COATING	12,734'
3	30" O.D. X 0.516" W.T. API-5LX-70 W/FBE COATING & ABRASION RESISTANT OVERCOAT	73'
7	30" O.D. X 0.516" W.T. API-5LX-70 W/FBE COATING	200'
113A	30" x 55' x 3 DIA RAD WELD FITTING 0.515" W.T. Y-70, W/2-4 FEET LONG 30" O.D. X 0.428" W.T. API 5LX-70 PUPS	1 EA
	PIPELINE MARKERS	0 EA
	PIPELINE WARNING SIGNS	7 EA
	CATHODIC TEST STATION	2 EA
	AERIAL MARKER	0 EA

REFERENCE DRAWINGS			
REF. NO.	DRAWING NO.	REV. NO.	DRAWING TITLE

REVISIONS						
NO.	DATE	REV BY	CHK APPR	ENV APPR	DESCRIPTION	
1	5/17/09	UEI	RDG	LAG	SEC	ISSUED FOR CONSTRUCTION
2	10/17/14	UEI				ISSUED FOR AS-BUILT
						1835-03-ML-02-008
						REPLACES COVERAGE OF IFC DRAWINGS
						1835-03-ML-02-009
						1835-03-ML-02-010

ENGINEERING RECORDS					
DRAWN BY	INITIAL	DATE	ENV APPR	INITIAL	DATE
UEI		10/02/22			
CHECKED BY			APPR. BY		

PROFESSIONAL ENGINEER				
NAME	STATE	LIC#	REV#	DATE
LOYD ALVIN GRAY, III	SD	CE9004		

SCALE: 0 125 250 500 Feet

TransCanada
in business to deliver

KEYSTONE MAINLINE (NPS 30 2009) ROSWELL SECTION

F# 1835 SPREAD 3B DISCIPLINE 03

AS-BUILT ALIGNMENT		
M.P. 370.87 TO M.P. 373.33		
SHEET 6 OF 20 SHEETS		
STA. 650+42 TO STA. 780+49		
DRAWING NO. 1835-03-ML-02-006		(3D) REV: 2

DISCLAIMER

UNIVERSAL PEGASUS MAKES NO WARRANTY (EXPRESS, IMPLIED OR OTHERWISE) THAT THE INFORMATION CONTAINED HEREIN IS ACCURATE OR COMPLETE AS TO ANY AND ALL SUBSURFACE CONDITIONS AND COMPOSITION. ANY RELIANCE CONTRACTOR PLACES ON THE INFORMATION CONTAINED HEREIN AS TO SUCH CONDITIONS IS DONE SO AT ITS OWN RISK AND EXPENSE. IT IS THE SOLE RESPONSIBILITY OF THE CONTRACTOR TO CONTACT THE STATE "ONE-CALL" SYSTEM PRIOR TO ANY EXCAVATION.