

RIGHT-OF-WAY HORIZONTAL REPRESENTATION (2D)
TRACT NUMBER
OWNERSHIP/AGENCY
LENGTH APPLICABLE DWG. NO.
LAND USE

PIPELINE PROFILE
HORIZ: 1"=500' VER: 1"=100'
HORIZONTAL REPRESENTATION (2D)

LEGEND

- KEYSTONE PIPELINE
- STATE BOUNDARY
- COUNTY/TOWNSHIP
- SECTIONS
- NATIONAL OR STATE RESERVATION BOUNDARY
- PROPERTY LINE
- FENCE
- EXCLUSIONARY FENCE
- POWER LINE
- TELEPHONE LINE
- BURIED CABLE
- WATER LINE
- SANITARY SEWER LINE
- STORM SEWER / DRAIN
- FOREIGN PIPELINE
- RAILROAD
- HIGHWAY / ROAD
- STREAM / DITCH
- WETLAND
- INTERSTATE ROUTE
- U.S. ROUTE
- STATE ROUTE
- POINT OF INTERSECTION (PI)
- PIPELINE MILEPOST
- DIRECTION OF FLOW
- HOUSE
- BUILDING
- WATER WELL
- MAINLINE VALVE

PIPELINE SCHEMATIC

- HEAVY WALL PIPE
- WELD FITTING
- TRANSITION PIECE
- CASING PIPE
- CONCRETE COATING
- SET-ON WEIGHTS
- PIPELINE WARNING SIGN
- PIPELINE MARKER
- MATERIAL ITEM
- GROUNDING MAT
- ZINC RIBBON
- AERIAL MARKER
- CATHODIC TEST STATION
- MAINLINE VALVE
- CHECK VALVE
- OPEN CUT
- BORER
- DRINKING WATER USA
- ECOLOGICAL USA
- HIGHLY POPULATED AREA
- OPERATOR (KEYSTONE) DEFINED
- OTHER POPULATED AREA
- SOURCE WATER PROTECTION AREA
- WELLHEAD PROTECTION AREA

TEST SECTIONS (3D)

ENVIRONMENTAL MITIGATION/RECLAMATION STATIONS (2D)

- TOPSOIL SALVAGE METHOD
- STREAMS
- WETLANDS
- TIMING CONSTRAINTS
- STATIONS
- MONITORING
- RECLAMATION
- SPECIAL CONSIDERATIONS

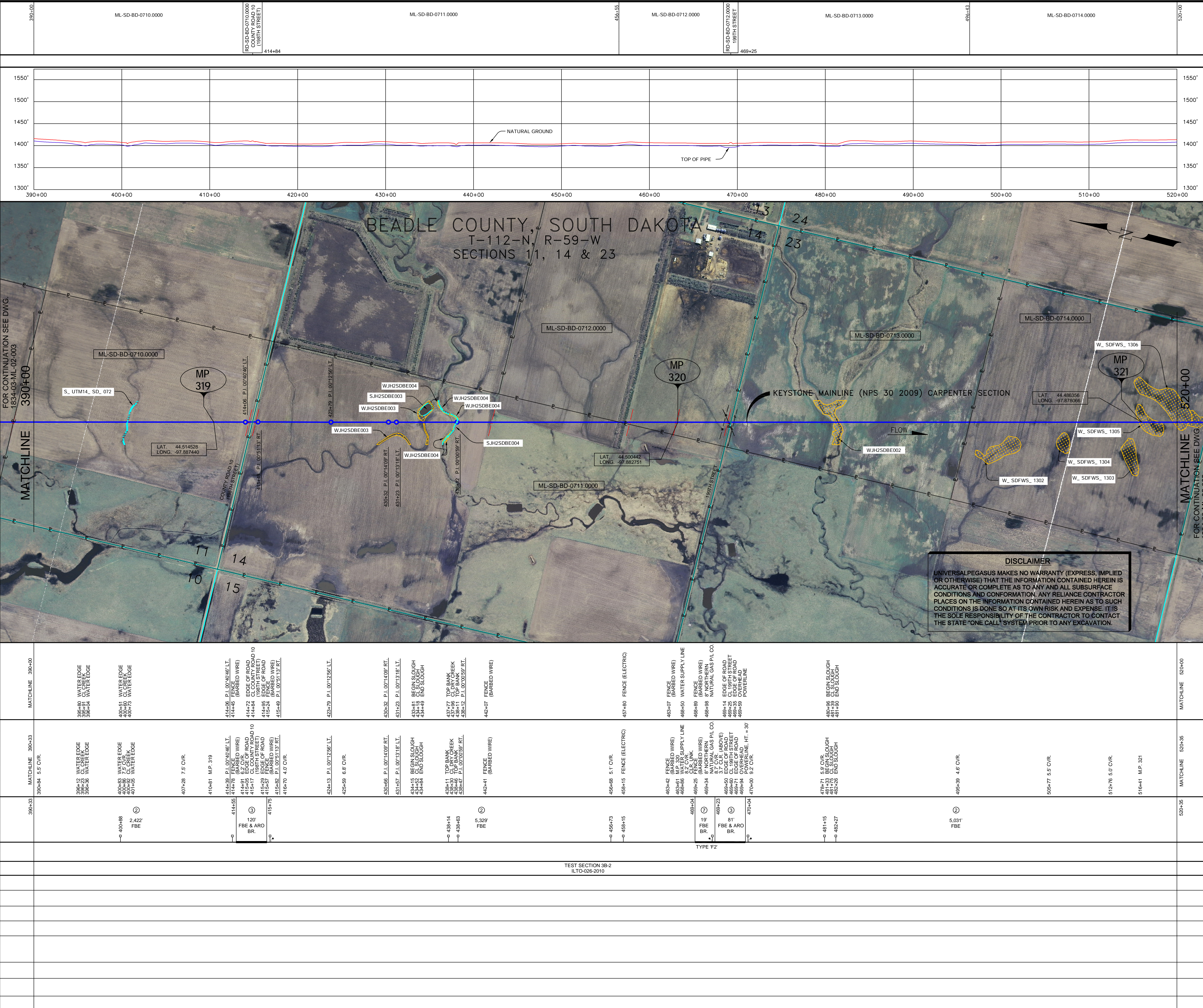

GENERAL NOTES

- ALL CHAINAGES ARE IN FEET UNLESS OTHERWISE SPECIFIED.
- DATUM ELEVATION AND PROJECTION ARE BASED ON MEAN SEA LEVEL AND NAD 83.
- FIELD PIPE LOCATING REQUIRED TO DETERMINE PLACEMENT OF PIPELINE WITHIN PERMANENT EASEMENT.
- UNLESS OTHERWISE NOTED, 48 INCHES MINIMUM COVER EXCEPT 36 INCHES IN AREAS OF CONSOLIDATED ROCK.
- NO ACTUAL AS-BUILT GROUND SHOTS WERE TAKEN AT THIS LOCATION. THE PROFILE REPRESENTS A PROJECTION FROM SHOTS TAKEN AT 150' TO 250' INTERVALS.
- THE TYPE OF COATING APPLIED TO THE FIELD WELDS DURING THE ORIGINAL CONSTRUCTION WAS TWO COMPONENT LIQUID EPOXY. THE COATING PRODUCTS USED WERE DENSO 7200 OR SPC SP-2888.
- THE SUBSTANTIAL CONSTRUCTION COMPLETION DATE, BASED ON CALIPER PIG RUN, WAS OCTOBER 10, 2009 FOR M.P. 301.75 TO M.P. 343.98 AND OCTOBER 31, 2009 FOR M.P. 343.98 TO 377.31.
- ORIGINAL IN-SERVICE DATE OF THE KEYSTONE PIPELINE (PHASE 1): JUNE 30, 2010.
- CPS CALCULATION DATE: MAY 2010.
- ORION STATION SERIES NUMBER: 1182700.
- TO DETERMINE THE MILE POST AT A GIVEN LOCATION, ADD THE 3D STATION NUMBER FROM THIS SEGMENT TO STATION NUMBER 16432+39 AND DIVIDE BY 5280.

OPERATING AND TEST PRESSURE

- THE MAXIMUM OPERATING PRESSURE (MOP) IS 1440 PSIG.
- THE MINIMUM TEST PRESSURE WAS 160 PSIG.

BILL OF MATERIALS (3D)

ITEM NO.	DESCRIPTION	QUANTITY
2	30" O.D. X 0.386" W.T., API-5LX-70 W/FBE COATING	12,762'
3	30" O.D. X 0.516" W.T., API-5LX-70 W/FBE COATING & ABRASION RESISTANT OVERCOAT	201'
7	30" O.D. X 0.516" W.T., API-5LX-70 W/FBE COATING	19'

PIPELINE MARKERS: 0 EA
PIPELINE WARNING SIGNS: 11 EA
CATHODIC TEST STATION: 3 EA
AERIAL MARKER: 0 EA

REVISIONS DRAWINGS

REF. NO.	DRAWING NO.	REV. NO.	DRAWING TITLE

REVISIONS

NO.	DATE	REV BY	CHECKED BY	APPROVED BY	DESCRIPTION
1	5/17/08	UEI	RDG	LAG	ISSUED FOR CONSTRUCTION
2	10/17/09	UEI			ISSUED FOR AS-BUILT
					REPLACES COVERAGE OF IFC DRAWINGS
					1834-03-ML-02-005
					1834-03-ML-02-006
					1834-03-ML-02-007

ENGINEERING RECORDS

DRAWN BY	INITIAL	DATE	ENY APPRD.	INITIAL	DATE
UEI		10/02/15			

PROFESSIONAL ENGINEER

NAME	STATE	LIC#	REV#	DATE
LOYS ALVIN GRAY, III	SD	CE9004		

SCALE: 0 125 250 500 Feet

TransCanada
In business to deliver

KEYSTONE MAINLINE (NPS 30 2009) CARPENTER SECTION

SCALE: 1834 SPREAD 3B DISCIPLINE 03

AS-BUILT ALIGNMENT
M.P. 318.61 TO M.P. 321.07
SHEET 4 OF 20 SHEETS
STA. 390+33 TO STA. 520+35 (3D)
DRAWING NO. 1834-03-ML-02-004 REV. 2