

RIGHT-OF-WAY HORIZONTAL REPRESENTATION (2D)
TRACT NUMBER OWNERSHIP AGENCY
LENGTH APPLICABLE DWG. NO.

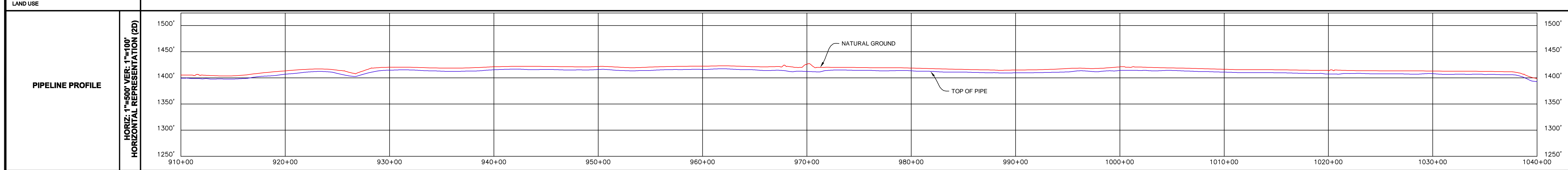

LEGEND: KEYSTONE PIPELINE, STATE BOUNDARY, COUNTY/TOWNSHIP, SECTIONS, NATIONAL OR STATE RESERVATION BOUNDARY, PROPERTY LINE, FENCE, EXCLUSIONARY FENCE, POWER LINE, TELEPHONE LINE, BURIED CABLE, WATER LINE, SANITARY SEWER LINE, STORM SEWER / DRAIN, FOREIGN PIPELINE, RAILROAD, HIGHWAY / ROAD, STREAM / DITCH, WETLAND, INTERSTATE ROUTE, U.S. ROUTE, STATE ROUTE, POINT OF INTERSECTION (PI), PIPELINE MILEPOST, DIRECTION OF FLOW, HOUSE, BUILDING, WATER WELL, MAINLINE VALVE.

GENERAL NOTES: 1) ALL CHAINAGES ARE IN FEET UNLESS OTHERWISE SPECIFIED. 2) DATUM ELEVATION AND PROJECTION ARE BASED ON MEAN SEA LEVEL NAD 83. 3) FIELD PIPE LOCATING REQUIRED TO DETERMINE PLACEMENT OF PIPELINE WITHIN PERMANENT EASEMENT.

OPERATING AND TEST PRESSURE: 1. THE MAXIMUM OPERATING PRESSURE (MOP) IS 1400 PSIG. 2. THE MINIMUM TEST PRESSURE WAS 1800 PSIG.
BILL OF MATERIALS (3D)
REFERENCE DRAWINGS
REVISIONS
ENGINEERING RECORDS
PROFESSIONAL ENGINEER
AS-BUILT ALIGNMENT

ENVIRONMENTAL MITIGATION RECLAMATION STATIONS (2D)
TEST SECTIONS (3D)
ENVIRONMENTAL MITIGATION RECLAMATION STATIONS (2D)
TEST SECTIONS (3D)

RIGHT-OF-WAY HORIZONTAL REPRESENTATION (2D)
TRACT NUMBER OWNERSHIP AGENCY
LENGTH APPLICABLE DWG. NO.
LAND USE
PIPELINE PROFILE
PIPELINE PLAN (SCALE 1"=500') HORIZONTAL REPRESENTATION (2D)
GENERAL NOTES
OPERATING AND TEST PRESSURE
BILL OF MATERIALS (3D)
REFERENCE DRAWINGS
REVISIONS
ENGINEERING RECORDS
PROFESSIONAL ENGINEER
AS-BUILT ALIGNMENT