

**ATTACHMENT B  
DATA FORMS**

# CONFIDENTIAL

**ROUTINE WETLAND DETERMINATION FORM (1987  
USACE METHOD)**

Site ID No.:

GPS File:

Milepost:

Date:

**WETLAND COORDINATES:**

Staff/Team I.D.:

Client/Project Name:

Logbook Page No's.:

Block/Lot/Tract No.:

Photo LOCATIONS:

Nearest Waterway:

Watershed:

Drainage Basin:

Loop/Facility:

State/County/Municipality:

DOMINANT PLANT SPECIES	Stratum	Indicator	NON-DOMINANT PLANT SPECIES	Stratum	Indicator
1.			1.		
2.			2.		
3.			3.		
4.			4.		
5.			5.		
6.			6.		
7.			7.		
8.			8.		

Per Cent of Dominant Species that are OBL, FACW, or FAC (excluding FAC-):

**REMARKS:**

**HYDROLOGY**

Recorded Data?

Describe:

Depth of Surface Water: \_\_\_\_\_ (in. or cm)

Depth to Free Water in Pit: \_\_\_\_\_ (in. or cm)

Depth to Saturated Soil: \_\_\_\_\_ (in. or cm)

**Primary Wetland Indicators:**

**Secondary Wetland Indicators (2 or more required):**

\_\_\_ Inundated

\_\_\_ Oxidized Root Channels in Upper 12 Inches (30 cm)

\_\_\_ Saturated in Upper 12 Inches (30 cm)

\_\_\_ Water-Stained Leaves

\_\_\_ Water Marks

\_\_\_ Local Soil Survey Data

\_\_\_ Drift Lines

\_\_\_ FAC-Neutral Test

\_\_\_ Sediment Deposits

\_\_\_ Other (Explain in Remarks)

\_\_\_ Drainage Patterns in Wetlands

**REMARKS:**

**SOILS**

Soil Survey Map Unit (Series and Phase):

Drainage Class:

Taxonomy (to Subgroup):

Field Observations Confirm Mapped Type?

**Profile Description:**

USDA Land Resource Region:

Depth Range (Inches or cm)	Horizon Desig.	Matrix Color (Munsell Moist)	Mottles (Abundance/Contrast/Color)	Texture, Concretions, Structure, Redox Concen., etc.

\_\_\_ Histosol

\_\_\_ Concretions or Redox Concentrations

\_\_\_ Histic Epipedon

\_\_\_ High Organic Content

\_\_\_ Sulfidic Odor

\_\_\_ Organic Streaking in Sandy Soils

\_\_\_ Aquic Moisture Regime

\_\_\_ Listed on Local Hydric Soils List

\_\_\_ Gleyed or Low-Chroma Colors

\_\_\_ Other USDA Hydric Soil Indicator (Explain in Remarks)

**REMARKS (INCLUDE SOIL PIT COORDINATES):**

**WETLAND DETERMINATION**

Hydrophytic Vegetation Present?      Yes      No

Wetland Hydrology Present?      Yes      No

Hydric Soils Present?      Yes      No

**Is This Sampling Point Within a Wetland?      YES      NO**

**REMARKS:**

Normal Circumstances?

Significantly Disturbed (Atypical):

Potential Problem Area?

COMPLETE SKETCH OF WETLAND ON BACK OF THIS SHEET; INCLUDE SOIL PIT AND PHOTO LOCATIONS, NORTH ARROW, AND CROSS-SECTION.

**ENSR/AECOM**

# CONFIDENTIAL

<b>STREAM DATA -</b>		Stream Name/Feature I.D. Number	GPS File/Coordinates:	MILEPOST:
Date:	Client/Project Name:		Topo Name:	
Survey Staff/Team Code:	State/County/Municipality:	LOOP/FACILITY NAME:		
Logbook page No's.:	Block/ Lot/Tract No.:	Photo No(s).:	Upstr	Dnstr
Stream Sketch Plan (include surrounding area, cardinal direction arrow, flow direction arrow, cross-section of crossing with bank heights) – not required if entered on other sheet; use back if additional space required.				

<b>Stream Flow</b>	Perceptible Flow? Y or N	Fast Perennial	Moderate Intermittent	Slow Ephemeral	Pooled	None				
Direction: _____										
<b>Avg. Flow Depth (in.)</b>	0 ___	0-3 ___	3-6 ___	6-12 ___	12-24 ___	24-36 ___	36-48 ___	48-60 ___	60+ ___	
<b>Stream Width at Crossing (ft.)</b>	Top of Banks:			Channel OHWM:		Water Surface:				
<b>Stream Substrate %</b>	Bedrock %	Gravel %	Sand %	Silt/Clay %	Organic %					
<b>Bank Height (ft.)</b> (looking downstream)	Left	0-2	2-4	4-6	6-8	8+				
	Right	0-2	2-4	4-6	6-8	8+				
<b>Bank Slope (%)</b> (looking downstream)	Left	0-20	20-40	40-60	60-80	80+				
	Right	0-20	20-40	40-60	60-80	80+				
<b>Water Clarity</b>	Clear	Slightly Turbid	Turbid	Very Turbid	Color:					
<b>Aquatic Habitat</b>	Sand Bar	Gravel Bar	Mud Bar	Gravel Riffles	Deep Pools					
Undercut Banks/Evidence of Erosion?	Overhanging trees/shrubs	In-stream emergent plants	In-stream submerged plants	Bank root systems	Fringing Wetlands					
<b>Aquatic Organisms Observed</b>	Waterfowl	Fish (adult)	Fish (juvenile)	Frogs	Turtles					
	Snakes	Invertebrates	Other:							

**T/E SPECIES / SUITABLE HABITAT**

**RIPARIAN VEGETATION DESCRIPTION**

**Comments** (e.g. pipeline crossing angle, construction constraints, erosion potential, existing disturbances, meanders or width variations)

<b>STREAM QUALITY</b> (indicate)	1	2	3
<i>High Quality</i> – no indication of stress or disturbance in stream or adjacent area – diverse and mature fringing shrub-dominated cover - diverse and stable fish & wildlife habitat – gravel beds, submerged logs, undercut banks, riffles and pools – no channelization –			
<i>Medium Quality</i> – mild to moderate disturbances result in minor recognizable alterations – existing pipeline, road, railroad, other ROWs – provides fair fish and wildlife habitat – some erosion potential – some habitat diversity – fine sediment deposition predominate – flow and depth variation restricted – some channelization – trees, grass, or forbs dominate bank vegetation			
<i>Low Quality</i> – disturbances cause significant changes affecting plant species – mechanical alteration of plant species and/or soils – intense grazing activities – stream course channelization or ditching – exotic, nuisance, or invasive species – habitat diversity lacking – high erosion potential – flow and depth variation lacking – does not provide suitable wildlife habitat – grass or forbs dominate bank vegetation			

ENSR

1601 Prospect Parkway, Fort Collins, Colorado 80525-9769  
T 970.493.8878 F 970.493.0213 www.ensraecom.com

March 21, 2006

Ms. Patsy Crooke  
Project Manager  
USACE-North Dakota Regional Office  
1513 S. 12<sup>th</sup> Street  
Bismarck, ND 58504

**Subject: Keystone Pipeline Project**

Dear Ms. Crooke,

We look forward to meeting with you via phone on Wednesday, March 29 at 10 am at Steven Naylor's office in Pierre, South Dakota to provide a project status update on the Keystone Pipeline Project and to discuss our proposed field programs for 2006. Scott Ellis and Karen Caddis with ENSR will be attending. We understand that Keith Tillotson and Russ Rocheford with the COE will also be attending via phone. The overall purpose of this meeting is to discuss survey and application requirements and the information that Keystone will provide to the U.S. Army Corps of Engineers (COE) so that project-related wetland and water body jurisdictional determinations can be made.

To assist with preparation for the meeting and review of the project, please find the following attachments:

1. Pipeline Route maps. These strip maps illustrate the proposed pipeline alignment on an aerial photo and topographic base at a scale of 1:24,000. The National Wetland Inventory polygons have been included as an overlay on both bases. Also included are preliminary wetland survey areas that were determined by ENSR from aerial photo review.
2. Drainage crossings. A table listing drainage crossings is derived from the USGS watershed drainage GIS layers. Crossing locations are correlated with project mileposts. This table is the starting point for the Waters of the U.S. review.
3. Wetland/waterbody crossing methods. This is a section from the filing that Keystone will submit to the Department of State at the end of March.
4. Draft Survey Protocol. The survey protocol will be provided to you later this week via e-mail.

#### Preliminary Meeting Agenda

The following is a list of items that we would like to cover. We would appreciate your input on these, and other topics that should be discussed.

1. Introductions
2. Keystone Waterbody and Wetland Crossing Methods
3. Pipeline route review (routing considerations and concerns)
4. Overview of 2006 Field Program
5. Field Survey Technical Issues (definitions and level of survey)

Client Name  
Page 2

- Waters of the U.S.
  - Farmed wetlands
  - Prairie potholes
6. Technical reports (content and format).
  7. COE expectations, and future communications

If you have questions regarding the attached information prior to the meeting on March 29, please call Karen Caddis or Scott Ellis at 970-493-8878, or contact us by e-mail ([kcaddis@ensr.aecom.com](mailto:kcaddis@ensr.aecom.com) or [sellis@ensr.aecom.com](mailto:sellis@ensr.aecom.com)). We appreciate the opportunity to meet with staff from all the COE offices within the Omaha District with responsibilities for this project.

Sincerely yours,



Karen Caddis  
Senior Technical Specialist/Wetlands Program Coordinator



Scott Ellis  
Environmental Permitting Project Manager

CONFIDENTIAL

ATTACHMENTS  
SAME AS  
THOSE FOR  
ROCHEFORD  
LETTER

ATTACHMENTS  
SAME AS  
THOSE FOR  
ROCHEFORD  
LETTER

ENSR

1601 Prospect Parkway, Fort Collins, Colorado 80526-9769  
T 970.493.8878 F 970.493.0210 www.ensracom.com

March 21, 2006

Mr. Keith Tillotson  
Project Manager  
USACE- Kearney Field Office  
1430 Central Avenue  
Kearney, NE 68847

**Subject: Keystone Pipeline Project**

Dear Mr. Tillotson,

We look forward to meeting with you via phone on Wednesday, March 29 at 10 am at Steven Naylor's office in Pierre, South Dakota to provide a project status update on the Keystone Pipeline Project and to discuss our proposed field programs for 2006. Scott Ellis and Karen Caddis with ENSR will be attending. We understand that Patsy Crooke and Russ Rocheford with the COE will also be attending via phone. The overall purpose of this meeting is to discuss survey and application requirements and the information that Keystone will provide to the U.S. Army Corps of Engineers (COE) so that project-related wetland and water body jurisdictional determinations can be made.

To assist with preparation for the meeting and review of the project, please find the following attachments:

1. Pipeline Route maps. These strip maps illustrate the proposed pipeline alignment on an aerial photo and topographic base at a scale of 1:24,000. The National Wetland Inventory polygons have been included as an overlay on both bases. Also included are preliminary wetland survey areas that were determined by ENSR from aerial photo review.
2. Drainage crossings. A table listing drainage crossings is derived from the USGS watershed drainage GIS layers. Crossing locations are correlated with project mileposts. This table is the starting point for the Waters of the U.S. review.
3. Wetland/waterbody crossing methods. This is a section from the filing that Keystone will submit to the Department of State at the end of March.
4. Draft Survey Protocol. The survey protocol will be provided to you later this week via e-mail.

#### Preliminary Meeting Agenda

The following is a list of items that we would like to cover. We would appreciate your input on these, and other topics that should be discussed.

1. Introductions
2. Keystone Waterbody and Wetland Crossing Methods
3. Pipeline route review (routing considerations and concerns)
4. Overview of 2006 Field Program
5. Field Survey Technical Issues (definitions and level of survey)



Client Name  
Page 2

- Waters of the U.S.
- Farmed wetlands
- Prairie potholes

6. Technical reports (content and format).
7. COE expectations, and future communications

If you have questions regarding the attached information prior to the meeting on March 29, please call Karen Caddis or Scott Ellis at 970-493-8878, or contact us by e-mail ([kcaddis@ensr.aecom.com](mailto:kcaddis@ensr.aecom.com) or [sellis@ensr.aecom.com](mailto:sellis@ensr.aecom.com)). We appreciate the opportunity to meet with staff from all the COE offices within the Omaha District with responsibilities for this project.

Sincerely yours,



Karen Caddis  
Senior Technical Specialist/Wetlands Program Coordinator



Scott Ellis  
Environmental Permitting Project Manager

CONFIDENTIAL

ATTACHMENTS  
SAME AS  
THOSE FOR  
ROCHEFORD  
LETTER

# CONFIDENTIAL

Table 1 Waterbodies Crossed by the Proposed Keystone Pipeline Project – Omaha District

State / County	Approximate ROW Milepost	Waterbody Name	Intermittent, Perennial, Reservoir, or Lake	State Water Quality Classification
<b>KEYSTONE MAINLINE</b>				
<b>NORTH DAKOTA</b>				
Cavalier	0.62	Unnamed	Intermittent Stream/River	
Cavalier	1.7	Unnamed	Intermittent Stream/River	
Cavalier	2.66	Unnamed	Intermittent Stream/River	
Cavalier		Unnamed	Intermittent Stream/River	
Cavalier	3.68	Unnamed	Intermittent Stream/River	
Pembina	7.09	Pembina River	Perennial Stream/River	Fish and Other Aquatic Biota, Recreation, Class 1A
Pembina	10.49	Unnamed	Intermittent Stream/River	
Pembina	10.84	Unnamed	Intermittent Stream/River	
Pembina	11.73	Unnamed	Intermittent Stream/River	
Pembina	11.83	Unnamed	Intermittent Stream/River	
Pembina	11.92	Unnamed	Intermittent Stream/River	
Pembina	12.01	Unnamed	Intermittent Stream/River	
Pembina	13.13	Unnamed	Intermittent Stream/River	
Pembina	16.14	Unnamed	Intermittent Stream/River	
Pembina	16.5	Unnamed	Intermittent Stream/River	
Pembina	17.01	Unnamed	Intermittent Stream/River	
Pembina	17.41	Unnamed	Intermittent Stream/River	
Pembina	17.76	Unnamed	Intermittent Stream/River	
Pembina	18.38	Tongue River	Perennial Stream/River	Fish and Other Aquatic Biota, Class II
Pembina	18.85	Tributary to Tongue River	Intermittent Stream/River	Fish and Other Aquatic Biota

# CONFIDENTIAL

State / County	Approximate ROW Milepost	Waterbody Name	Intermittent, Perennial, Reservoir, or Lake	State Water Quality Classification
Pembina	19.12	Unnamed	Intermittent Stream/River	
Pembina	20.05	Unnamed	Intermittent Stream/River	
Pembina	20.48	Unnamed	Intermittent Stream/River	
Pembina	20.62	Willow Creek	Intermittent Stream/River	
Pembina	21.54	Unnamed	Intermittent Stream/River	
Pembina	21.98	Unnamed	Intermittent Stream/River	
Pembina	22.27	Unnamed	Intermittent Stream/River	
Pembina	22.65	Unnamed	Intermittent Stream/River	
Pembina	22.81	Unnamed	Intermittent Stream/River	
Pembina	23.23	Unnamed	Intermittent Stream/River	
Pembina	23.73	Cart Creek	Intermittent Stream/River	
Pembina	24.74	Unnamed	Intermittent Stream/River	
Pembina	25.21	Unnamed	Intermittent Stream/River	
Pembina	26.02	Unnamed	Intermittent Stream/River	
Pembina	26.15	Unnamed	Intermittent Stream/River	
Pembina	26.77	Unnamed	Intermittent Stream/River	
Pembina	27.9	Unnamed	Intermittent Stream/River	
Pembina	29.44	North Branch Park River	Intermittent Stream/River	Fish and Other Aquatic Biota, Class III
Pembina	31.05	Unnamed	Intermittent Stream/River	
Pembina	31.82	Unnamed	Intermittent Stream/River	
Walsh	32.98	Unnamed	Intermittent Stream/River	
Walsh	33.28	Unnamed	Intermittent Stream/River	
Walsh	33.34	Middle Branch Park River	Intermittent Stream/River	Fish and Other Aquatic Biota, Class III
Walsh	34.26	Unnamed	Intermittent Stream/River	

# CONFIDENTIAL

State / County	Approximate ROW Milepost	Waterbody Name	Intermittent, Perennial, Reservoir, or Lake	State Water Quality Classification
Walsh	34.76	Unnamed	Intermittent Stream/River	
Walsh	35.3	Unnamed	Intermittent Stream/River	
Walsh	36.28	Unnamed	Intermittent Stream/River	
Walsh	37.15	Unnamed	Intermittent Stream/River	
Walsh	37.39	Unnamed	Intermittent Stream/River	
Walsh	38.09	Unnamed	Intermittent Stream/River	
Walsh	38.68	Unnamed	Intermittent Stream/River	
Walsh	39.08	Unnamed	Intermittent Stream/River	
Walsh	39.53	Unnamed	Intermittent Stream/River	
Walsh	40.17	Unnamed	Intermittent Stream/River	
Walsh	41.56	South Branch Park River	Intermittent Stream/River	Fish and Other Aquatic Biota, Class II
Walsh	42.25	Unnamed	Intermittent Stream/River	
Walsh	42.28	Unnamed	Intermittent Stream/River	
Walsh	42.33	Unnamed	Intermittent Stream/River	
Walsh	42.44	Unnamed	Intermittent Stream/River	
Walsh	42.91	Unnamed	Intermittent Stream/River	
Walsh	43.18	Unnamed	Intermittent Stream/River	
Walsh	43.67	Unnamed	Intermittent Stream/River	
Walsh	43.78	Unnamed	Intermittent Stream/River	
Walsh	43.96	Unnamed	Intermittent Stream/River	
Walsh	44.29	Unnamed	Intermittent Stream/River	
Walsh	44.71	Unnamed	Intermittent Stream/River	
Walsh	45	Unnamed	Intermittent Stream/River	
Walsh	45.26	Unnamed	Intermittent Stream/River	
Walsh	45.99	Unnamed	Intermittent	

# CONFIDENTIAL

State / County	Approximate ROW Milepost	Waterbody Name	Intermittent, Perennial, Reservoir, or Lake	State Water Quality Classification
			Stream/River	
Walsh	46.31	North Branch Forest River	Intermittent Stream/River	Fish and Other Aquatic Biota, Class III
Walsh	46.81	Unnamed	Intermittent Stream/River	
Walsh	46.98	Unnamed	Intermittent Stream/River	
Walsh	47.2	Unnamed	Intermittent Stream/River	
Walsh	47.68	Unnamed	Intermittent Stream/River	
Walsh	47.82	Unnamed	Intermittent Stream/River	
Walsh	48.31	Unnamed	Intermittent Stream/River	
Walsh	48.53	Unnamed	Intermittent Stream/River	
Walsh	48.92	Unnamed	Intermittent Stream/River	
Walsh	49.34	Unnamed	Intermittent Stream/River	
Walsh	49.8	Unnamed	Intermittent Stream/River	
Walsh	50.07	Unnamed	Intermittent Stream/River	
Walsh	50.32	Unnamed	Intermittent Stream/River	
Walsh	50.99	Unnamed	Intermittent Stream/River	
Walsh	51.56	Unnamed	Intermittent Stream/River	
Walsh	51.88	Unnamed	Intermittent Stream/River	
Walsh	52.59	Unnamed	Intermittent Stream/River	
Walsh	53.17	Unnamed	Intermittent Stream/River	
Walsh	54.51	Middle Branch Forest River	Perennial Stream/River	Fish and Other Aquatic Biota
Walsh	55.39	Unnamed	Intermittent Stream/River	
Nelson	56.91	South Branch Forest River	Intermittent Stream/River	Fish and Other Aquatic Biota
Nelson	57.41	Unnamed	Intermittent Stream/River	
Nelson	58.16	Unnamed	Intermittent Stream/River	
Nelson	58.8	Unnamed	Intermittent	

# CONFIDENTIAL

State / County	Approximate ROW Milepost	Waterbody Name	Intermittent, Perennial, Reservoir, or Lake	State Water Quality Classification
			Stream/River	
Nelson	59.18	Unnamed	Intermittent Stream/River	
Nelson	59.42	Unnamed	Intermittent Stream/River	
Nelson	60.25	Unnamed	Intermittent Stream/River	
Nelson	60.45	Unnamed	Intermittent Stream/River	
Nelson	61.18	Unnamed	Intermittent Stream/River	
Nelson	62.53	Unnamed	Intermittent Stream/River	
Nelson	64.04	Unnamed	Intermittent Stream/River	
Nelson	64.64	Skunk Coulee	Intermittent Stream/River	
Nelson	66.97	North Branch Turtle River	Intermittent Stream/River	Class II (Turtle river)
Nelson	71.54	Unnamed	Intermittent Lake/Pond	
Nelson	76.46	Goose River	Intermittent Stream/River	Fish and Other Aquatic Biota; Recreation, Class IA
Nelson	84.35	Beaver Creek	Intermittent Stream/River	
Steele	94.82	Unnamed	Intermittent Lake/Pond	
Steele	100.23	Unnamed	Intermittent Lake/Pond	
Steele	103.47	Unnamed	Intermittent Stream/River	
Steele	105.9	Unnamed	Intermittent Stream/River	
Steele	107.93	Unnamed	Intermittent Stream/River	
Steele	108.33	Unnamed	Intermittent Stream/River	
Steele	109.53	Unnamed	Intermittent Stream/River	
Steele	~110.7	Unnamed	Intermittent Lake/Pond	
Steele	111.81	Unnamed	Intermittent Stream/River	
Steele	114.53	Unnamed	Intermittent Stream/River	
Steele		Unnamed	Intermittent Lake/Pond	
Steele		Unnamed	Intermittent Lake/Pond	
Barnes		Unnamed	Intermittent Lake/Pond	
Barnes	123.08	Unnamed	Intermittent Stream/River	

# CONFIDENTIAL

State / County	Approximate ROW Milepost	Waterbody Name	Intermittent, Perennial, Reservoir, or Lake	State Water Quality Classification
Barnes	125.04	Unnamed	Intermittent Stream/River	
Barnes	126.15	Unnamed	Intermittent Stream/River	
Barnes	130.41	Unnamed	Intermittent Stream/River	
Barnes	132.44	Unnamed	Intermittent Lake/Pond	
Barnes		Unnamed	Intermittent Lake/Pond	
Barnes	145.94	Unnamed	Intermittent Stream/River	
Barnes	148.88	Unnamed	Intermittent Stream/River	
Barnes	149.42	Unnamed	Intermittent Stream/River	
Barnes	149.74	Unnamed	Intermittent Stream/River	
Barnes	149.97	Unnamed	Intermittent Stream/River	
Barnes	151.13	Unnamed	Intermittent Stream/River	
Barnes	151.48	Unnamed	Intermittent Stream/River	
Barnes	156.47	Unnamed	Intermittent Lake/Pond	
Barnes	162.35	Unnamed	Intermittent Lake/Pond	
Ransom	166.9	Sheyenne River	Perennial Stream/River	Fish and Other Aquatic Biota; Recreation, Class IA
Ransom	167.11	Tributary to Sheyenne River	Intermittent Stream/River	Fish and Other Aquatic Biota
Ransom	170.09	Unnamed	Intermittent Stream/River	
Ransom	170.97	Unnamed	Intermittent Stream/River	
Ransom	171.51	Unnamed	Intermittent Stream/River	
Ransom	171.69	Unnamed	Intermittent Stream/River	
Ransom	174.21	Unnamed	Intermittent Stream/River	
Ransom	178.68	Tributary to Lone Tree Lake	Intermittent Stream/River	
Sargent	189.17	Unnamed	Intermittent Stream/River	
Sargent	203.54	Unnamed	Intermittent Stream/River	

**SOUTH DAKOTA**



# CONFIDENTIAL

State / County	Approximate ROW Milepost	Waterbody Name	Intermittent, Perennial, Reservoir, or Lake	State Water Quality Classification
Marshall	225.46	Crow Creek	Intermittent Stream/River	
Marshall	225.51	Unnamed	Canal/Ditch	
Marshall		Unnamed	Intermittent Lake/Pond	
Day	241.21	Antelope Creek	Intermittent Stream/River	
Day	241.84	Unnamed	Intermittent Stream/River	
Day	245.23	Unnamed	Intermittent Stream/River	
Day	246.52	Unnamed	Intermittent Stream/River	
Day	247.66	Unnamed	Intermittent Stream/River	
Day	247.66	Unnamed	Intermittent Stream/River	
Day	248.08	Unnamed	Intermittent Stream/River	
Day	248.76	Unnamed	Intermittent Stream/River	
Day	249.69	Unnamed	Intermittent Stream/River	
Day	250.73	Unnamed	Intermittent Stream/River	
Day	252.38	Unnamed	Intermittent Stream/River	
Day	253.12	Unnamed	Intermittent Stream/River	
Day	254.42	Unnamed	Intermittent Stream/River	
Day	255.66	Mud Creek	Perennial Stream/River	
Day	256.27	Unnamed	Intermittent Stream/River	
Day	257.04	Unnamed	Intermittent Stream/River	
Day	257.3	Unnamed	Intermittent Stream/River	
Day	258.24	Unnamed	Intermittent Stream/River	
Day	261.49	Unnamed	Intermittent Stream/River	
Day	261.66	Unnamed	Intermittent Stream/River	
Day	262.65	Unnamed	Intermittent Stream/River	
Day	262.83	Foster Creek	Intermittent Stream/River	
Day	263.27	Unnamed	Intermittent Stream/River	

# CONFIDENTIAL

State / County	Approximate ROW Milepost	Waterbody Name	Intermittent, Perennial, Reservoir, or Lake	State Water Quality Classification
Day	264.35	Unnamed	Intermittent Stream/River	
Day	264.92	Unnamed	Intermittent Stream/River	
Day	265.2	Unnamed	Intermittent Stream/River	
Day	265.47	Unnamed	Intermittent Stream/River	
Day	265.74	Unnamed	Intermittent Stream/River	
Day	266.01	Unnamed	Intermittent Stream/River	
Day	266.45	Unnamed	Intermittent Stream/River	
Day	267.54	Unnamed	Intermittent Stream/River	
Day	267.96	Unnamed	Intermittent Stream/River	
Day	268.29	Unnamed	Intermittent Stream/River	
Day	268.6	Unnamed	Intermittent Stream/River	
Clark	269.16	Unnamed	Intermittent Stream/River	
Clark	270.59	Unnamed	Intermittent Stream/River	
Clark	270.76	Unnamed	Intermittent Stream/River	
Clark	273.02	Unnamed	Intermittent Stream/River	
Clark	273.55	Unnamed	Intermittent Stream/River	
Clark	274.04	Unnamed	Intermittent Stream/River	
Clark	274.51	Unnamed	Intermittent Stream/River	
Clark	275.72	Unnamed	Intermittent Stream/River	
Clark	275.83	Unnamed	Intermittent Stream/River	
Clark	276.44	Unnamed	Intermittent Stream/River	
Clark	277.29	Unnamed	Intermittent Stream/River	
Clark	277.61	Unnamed	Intermittent Stream/River	
Clark	278.34	Unnamed	Intermittent Stream/River	
Clark	278.62	Unnamed	Intermittent Stream/River	

# CONFIDENTIAL

State / County	Approximate ROW Milepost	Waterbody Name	Intermittent, Perennial, Reservoir, or Lake	State Water Quality Classification
Clark	279.16	Unnamed	Intermittent Stream/River	
Clark	280.17	Unnamed	Intermittent Stream/River	
Clark	280.58	Unnamed	Intermittent Stream/River	
Clark	280.87	Unnamed	Intermittent Stream/River	
Clark	280.93	Unnamed	Intermittent Stream/River	
Clark	282.98	Unnamed	Intermittent Stream/River	
Clark	284.85	Unnamed	Intermittent Stream/River	
Clark	286.7	Unnamed	Intermittent Stream/River	
Clark	287.8	Unnamed	Intermittent Stream/River	
Clark	288.54	Unnamed	Intermittent Stream/River	
Clark	290.35	Logan Dam	Perennial Lake/Pond	
Clark	290.36	Unnamed	Artificial Path	
Clark	294.31	Foster Creek	Intermittent Stream/River	
Clark	295.31	Unnamed	Intermittent Stream/River	
Clark	300.32	Unnamed	Intermittent Stream/River	
Clark	300.48	Unnamed	Intermittent Stream/River	
Clark	301.74	Unnamed	Intermittent Stream/River	
Clark	302.43	Unnamed	Intermittent Stream/River	
Beadle	305.77	Unnamed	Intermittent Stream/River	
Beadle	307.37	Unnamed	Intermittent Stream/River	
Beadle	307.96	Unnamed	Intermittent Stream/River	
Beadle	309.43	Shue Creek	Intermittent Stream/River	WW marginal fish life propagation waters, limited-contact recreation waters
Beadle	310.06	Unnamed	Intermittent Stream/River	
Beadle	311.29	Unnamed	Intermittent Stream/River	

# CONFIDENTIAL

State / County	Approximate ROW Milepost	Waterbody Name	Intermittent, Perennial, Reservoir, or Lake	State Water Quality Classification
Beadle	311.86	Pearl Creek	Intermittent Stream/River	WW marginal fish life propagation waters, limited-contact recreation waters
Beadle	312.37	Unnamed	Intermittent Stream/River	
Beadle	314.07	Middle Pearl Creek	Intermittent Stream/River	
Kingsbury	321.43	Unnamed	Intermittent Lake/Pond	
Kingsbury	322.37	South Fork Pearl Creek	Intermittent Stream/River	
Kingsbury	325.35	Unnamed	Intermittent Stream/River	
Kingsbury	331.29	Unnamed	Intermittent Stream/River	
Kingsbury	333.63	West Redstone Creek	Intermittent Stream/River	
Kingsbury		Trib to West Redstone Creek	Intermittent Stream/River	
Kingsbury	336.2	Unnamed	Intermittent Stream/River	
Miner	339.34	Redstone Creek	Intermittent Stream/River	WW marginal fish life propagation waters, limited-contact recreation waters (classification for segment in Sanborn county)
Miner	341.24	Unnamed	Intermittent Stream/River	
Miner	348.74	Unnamed	Intermittent Lake/Pond	
Miner	351.85	Unnamed	Intermittent Lake/Pond	
Miner	351.96	Unnamed	Intermittent Lake/Pond	
Miner	352.06	Unnamed	Intermittent Lake/Pond	
Miner	352.36	Unnamed	Intermittent Stream/River	
Miner	354.89	Unnamed	Intermittent Stream/River	
Miner	355.07	Unnamed	Intermittent Stream/River	
Miner	355.36	Unnamed	Intermittent Stream/River	
Miner	355.53	Unnamed	Intermittent Stream/River	
Miner	357.64	Unnamed	Intermittent Stream/River	

# CONFIDENTIAL

State / County	Approximate ROW Milepost	Waterbody Name	Intermittent, Perennial, Reservoir, or Lake	State Water Quality Classification
Miner	358.36	Rock Creek	Intermittent Stream/River	WW marginal fish life propagation waters, limited-contact recreation waters (classification for segment in Hanson county)
Miner	358.5	Rock Creek	Intermittent Stream/River	WW marginal fish life propagation waters, limited-contact recreation waters (classification for segment in Hanson county)
Miner		Unnamed	Intermittent Lake/Pond	
Miner	358.55	Rock Creek	Intermittent Stream/River	WW marginal fish life propagation waters, limited-contact recreation waters (classification for segment in Hanson county)
Miner	359.6	Unnamed	Intermittent Stream/River	
Miner	359.7	Unnamed	Intermittent Stream/River	
Miner	359.79	Unnamed	Intermittent Stream/River	
Miner	359.9	Unnamed	Intermittent Stream/River	
Miner	360.9	Unnamed	Intermittent Stream/River	
Hanson	362.62	Unnamed	Intermittent Lake/Pond	
Hanson	363.61	Pierre Creek	Intermittent Stream/River	
Hanson		Unnamed	Intermittent Lake/Pond	
Hanson	368.86	Unnamed	Intermittent Stream/River	
Hanson	371.9	Wolf Creek	Intermittent Stream/River	WW marginal fish life propagation waters, limited-contact recreation waters
Hanson	373.8	Unnamed	Intermittent Stream/River	
Hanson	374.89	Unnamed	Intermittent Lake/Pond	
Hanson	375.86	Unnamed	Intermittent	

# CONFIDENTIAL

State / County	Approximate ROW Milepost	Waterbody Name	Intermittent, Perennial, Reservoir, or Lake	State Water Quality Classification
			Stream/River	
McCook	380.24	Wolf Creek	Intermittent Stream/River	WW marginal fish life propagation waters, limited-contact recreation waters
McCook	381.73	Unnamed	Intermittent Lake/Pond	
McCook	382.77	Unnamed	Intermittent Stream/River	
McCook	387.23	Wolf Creek	Perennial Stream/River	WW marginal fish life propagation waters, limited-contact recreation waters
McCook		Unnamed	Intermittent Lake/Pond	
McCook	387.57	Unnamed	Intermittent Stream/River	
McCook	389	Unnamed	Intermittent Stream/River	
McCook	391.01	Unnamed	Intermittent Stream/River	
Hutchinson	392.26	Unnamed	Intermittent Stream/River	
Hutchinson	393.84	Unnamed	Intermittent Stream/River	
Hutchinson	394.91	Unnamed	Intermittent Stream/River	
Hutchinson	396.28	Unnamed	Intermittent Stream/River	
Hutchinson	397.26	Unnamed	Intermittent Stream/River	
Hutchinson	397.89	Unnamed	Intermittent Stream/River	
Hutchinson	398.28	Unnamed	Intermittent Stream/River	
Hutchinson	401.91	Unnamed	Intermittent Stream/River	
Hutchinson	402.36	Unnamed	Intermittent Stream/River	
Hutchinson	402.76	Unnamed	Intermittent Stream/River	
Hutchinson	403.4	Unnamed	Intermittent Stream/River	
Hutchinson	404.52	Unnamed	Intermittent Stream/River	
Hutchinson	405.14	Unnamed	Intermittent Stream/River	
Hutchinson	407.19	Unnamed	Intermittent Stream/River	
Hutchinson	407.54	Unnamed	Intermittent	

# CONFIDENTIAL

State / County	Approximate ROW Milepost	Waterbody Name	Intermittent, Perennial, Reservoir, or Lake	State Water Quality Classification
			Stream/River	
Yankton	413.95	Unnamed	Intermittent Stream/River	
Yankton	417.96	James River	Perennial Stream/River	WW semiperm fish life propagation waters, Limited contact recreation waters
Yankton	419.75	Unnamed	Intermittent Stream/River	
Yankton	420.78	Unnamed	Intermittent Stream/River	
Yankton	422.23	Unnamed	Intermittent Stream/River	
Yankton	424.15	Beaver Creek	Perennial Stream/River	WW marginal fish life propagation waters, limited-contact recreation waters
Yankton	424.74	Unnamed	Intermittent Stream/River	
Yankton	427.05	Unnamed	Intermittent Stream/River	
Yankton	430.02	Unnamed	Intermittent Stream/River	
Yankton	431.92	Unnamed	Perennial Stream/River	
Yankton	431.92	Unnamed	Perennial Stream/River	
Yankton	431.92	Unnamed	Perennial Stream/River	
Yankton	432.04	Marne Creek	Artificial Path	
<b>NEBRASKA</b>				
Yankton/Cedar	432.05	Missouri River	Artificial Path	Primary Contact Recreation; Aquatife Life Use; Ag Water Supply; Industrial Water Supply
Cedar	433.03	Unnamed	Intermittent Stream/River	
Cedar	434.23	Antelope Creek	Perennial Stream/River	No Data
Cedar	435.46	Unnamed	Intermittent Stream/River	
Cedar	436.1	Unnamed	Intermittent Stream/River	
Cedar	436.57	Unnamed	Intermittent Stream/River	
Cedar	436.82	Unnamed	Intermittent Stream/River	
Cedar	437.25	Unnamed	Intermittent Stream/River	
Cedar	438.08	Unnamed	Intermittent	

# CONFIDENTIAL

State / County	Approximate ROW Milepost	Waterbody Name	Intermittent, Perennial, Reservoir, or Lake	State Water Quality Classification
			Stream/River	
Cedar	438.98	Unnamed	Intermittent Stream/River	
Cedar	439.44	Unnamed	Intermittent Stream/River	
Cedar	439.67	Unnamed	Intermittent Stream/River	
Cedar	441.04	Unnamed	Intermittent Stream/River	
Cedar	442.38	Unnamed	Intermittent Stream/River	
Cedar	443.57	Unnamed	Intermittent Stream/River	
Cedar	444.11	Bow Creek	Perennial Stream/River	
Cedar	445.13	Unnamed	Intermittent Stream/River	
Cedar	446.96	Unnamed	Intermittent Stream/River	
Cedar	447.28	Unnamed	Intermittent Stream/River	
Cedar	447.58	Norwegian Bow Creek	Perennial Stream/River	No Data
Cedar	448.35	Unnamed	Intermittent Stream/River	
Cedar	449.04	Unnamed	Intermittent Stream/River	
Cedar	449.84	Unnamed	Intermittent Stream/River	
Cedar	451.15	Unnamed	Intermittent Stream/River	
Cedar	452.79	Bow Creek	Perennial Stream/River	No Data
Cedar	453.32	Unnamed	Intermittent Stream/River	
Cedar	455.75	Unnamed	Intermittent Stream/River	
Cedar	456.66	Pearl Creek	Intermittent Stream/River	
Cedar	457.51	Unnamed	Intermittent Stream/River	
Cedar	457.83	Unnamed	Intermittent Stream/River	
Cedar	458.19	Unnamed	Intermittent Stream/River	
Cedar	458.59	Unnamed	Intermittent Stream/River	
Cedar	459.93	Unnamed	Intermittent Stream/River	
Cedar	461.63	Unnamed	Intermittent Stream/River	
Cedar	462.14	Unnamed	Intermittent	



# CONFIDENTIAL

State / County	Approximate ROW Milepost	Waterbody Name	Intermittent, Perennial, Reservoir, or Lake	State Water Quality Classification
			Stream/River	
Cedar	462.87	Unnamed	Intermittent Stream/River	
Cedar	463.46	Unnamed	Intermittent Stream/River	
Cedar	464.44	Unnamed	Intermittent Stream/River	
Cedar	465.32	Unnamed	Intermittent Stream/River	
Cedar	466.2	Middle Logan Creek	Perennial Stream/River	No Data
Wayne	469.96	Dog Creek	Intermittent Stream/River	
Wayne	472.3	Deer Creek	Intermittent Stream/River	
Wayne	473.04	Tributary to Deer Creek	Intermittent Stream/River	
Wayne	474	Tributary to Deer Creek	Intermittent Stream/River	
Wayne	476.06	Unnamed	Intermittent Stream/River	
Wayne	477.26	South Branch Deer Creek	Intermittent Stream/River	
Wayne	483	Spring Branch	Intermittent Stream/River	
Wayne	485.44	Unnamed	Intermittent Stream/River	
Wayne	486.42	Unnamed	Intermittent Stream/River	
Stanton	487.16	Unnamed	Intermittent Stream/River	
Stanton	489.72	Unnamed	Intermittent Stream/River	
Stanton	490.39	Unnamed	Intermittent Stream/River	
Stanton	491.09	Unnamed	Intermittent Stream/River	
Stanton	492.28	Unnamed	Intermittent Stream/River	
Stanton	493.14	Unnamed	Intermittent Stream/River	
Stanton	496.3	Pleasant Run	Intermittent Stream/River	
Stanton	496.65	Pleasant Run	Intermittent Stream/River	
Stanton		Tributary to Pleasant Run	Intermittent Stream/River	
Stanton	498.05	Unnamed	Perennial Stream/River	
Stanton	498.07	Elkhorn River	Artificial Path	Primary Contact Recreation; Aquatic Life Use

# CONFIDENTIAL

State / County	Approximate ROW Milepost	Waterbody Name	Intermittent, Perennial, Reservoir, or Lake	State Water Quality Classification
Stanton	498.79	Unnamed	Intermittent Stream/River	
Stanton	500.3	Union Creek	Perennial Stream/River	
Stanton	501.32	Unnamed	Intermittent Stream/River	
Stanton	502.89	Unnamed	Intermittent Stream/River	
Stanton	503.36	Unnamed	Intermittent Stream/River	
Stanton	505.95	Unnamed	Intermittent Stream/River	
Stanton	507.48	Unnamed	Intermittent Stream/River	
Stanton	508.14	Unnamed	Intermittent Stream/River	
Stanton	513.55	Unnamed	Intermittent Stream/River	
Colfax	513.96	Tributary to West Fork Maple Creek	Intermittent Stream/River	
Colfax	514.75	Unnamed	Intermittent Stream/River	
Colfax	517.05	Unnamed	Intermittent Stream/River	
Colfax	519.67	Unnamed	Intermittent Stream/River	
Colfax	519.74	Unnamed	Intermittent Stream/River	
Colfax	527.24	Shell Creek	Perennial Stream/River	No Data
Colfax	533.08	Unnamed	Canal/Ditch	
Colfax	533.71	Unnamed	Intermittent Stream/River	
Colfax	534.76	Lost Creek	Perennial Stream/River	No Data
Colfax	535.37	Unnamed	Intermittent Stream/River	
Colfax	535.95	Unnamed	Intermittent Stream/River	
Colfax	536.22	Unnamed	Intermittent Stream/River	
Colfax	536.93	Unnamed	Perennial Stream/River	
Colfax/Butler	536.98	Platte River	Artificial Path	Primary Contact Recreation; Aquatic Life Use; Agriculture Water Supply
Butler	537.04	Unnamed	Perennial Stream/River	
Butler	537.1	Unnamed	Perennial Stream/River	
Butler	537.22	Unnamed	Perennial Stream/River	
Butler	537.23	Unnamed	Artificial Path	

# CONFIDENTIAL

State / County	Approximate ROW Milepost	Waterbody Name	Intermittent, Perennial, Reservoir, or Lake	State Water Quality Classification
Butler	537.48	Unnamed	Perennial Stream/River	
Butler	539.4	Deer Creek	Intermittent Stream/River	No Data
Butler	542.17	Deer Creek	Intermittent Stream/River	No Data
Butler	542.35	Unnamed	Perennial Lake/Pond	
Butler	542.52	Deer Creek	Intermittent Stream/River	No Data
Butler	542.55	Deer Creek	Intermittent Stream/River	No Data
Butler	545.87	Unnamed	Intermittent Stream/River	
Butler	549.55	Unnamed	Intermittent Stream/River	
Butler	550.13	Unnamed	Intermittent Stream/River	
Butler	552.09	Unnamed	Intermittent Stream/River	
Butler	554.57	Unnamed	Intermittent Stream/River	
Butler	555.48	Unnamed	Intermittent Stream/River	
Butler	556.15	Unnamed	Intermittent Stream/River	
Butler	558.11	Unnamed	Intermittent Stream/River	
Butler	558.44	Unnamed	Intermittent Stream/River	
Seward	561.55	Unnamed	Intermittent Stream/River	
Seward	567.78	Tributary to Big Weedy Creek	Intermittent Stream/River	
Seward	568.58	Big Blue River	Perennial Stream/River	Aquatic Life Use; Agriculture Water Supply
Seward	569.03	Unnamed	Intermittent Stream/River	
Seward	570.63	Coon Branch	Perennial Stream/River	
Seward	571.09	Unnamed	Intermittent Stream/River	
Seward	572.93	Tributary to Lone Tree Lake	Intermittent Stream/River	
Seward	574.23	Unnamed	Intermittent Stream/River	
Seward	575.61	Crooked Creek	Perennial Stream/River	
Seward		Unnamed	Perennial Lake/Pond	
Seward	578.68	Unnamed	Intermittent Stream/River	

# CONFIDENTIAL

State / County	Approximate ROW Milepost	Waterbody Name	Intermittent, Perennial, Reservoir, or Lake	State Water Quality Classification
Seward	580.74	Coon Creek	Intermittent Stream/River	
Seward	581.04	Unnamed	Intermittent Stream/River	
Seward	581.57	Unnamed	Intermittent Stream/River	
Seward	582.17	Unnamed	Intermittent Stream/River	
Seward	583.22	Unnamed	Intermittent Stream/River	
Seward	583.86	Unnamed	Intermittent Stream/River	
Seward	584.33	Unnamed	Intermittent Stream/River	
Seward	584.84	Unnamed	Intermittent Stream/River	
Seward	585.2	Unnamed	Intermittent Stream/River	
Saline	586.15	Unnamed	Intermittent Stream/River	
Saline	586.84	West Fork Big Blue River	Perennial Stream/River	Primary Contact Recreation; Aquatic Life Use; Ag Water Supply
Saline	587.62	Unnamed	Intermittent Stream/River	
Saline	590.6	Squaw Creek	Intermittent Stream/River	
Saline	591.03	Unnamed	Intermittent Stream/River	
Saline	593.55	Unnamed	Intermittent Stream/River	
Saline	595.83	Turkey Creek	Perennial Stream/River	No Data
Saline	596.57	Coon Creek	Intermittent Stream/River	
Saline	598.06	Unnamed	Intermittent Stream/River	
Saline	598.08	Unnamed	Intermittent Stream/River	
Saline	598.21	Unnamed	Intermittent Stream/River	
Saline	598.58	Brush Creek	Intermittent Stream/River	
Saline	598.97	Unnamed	Intermittent Stream/River	
Saline	599.1	Unnamed	Intermittent Stream/River	
Saline	599.11	Unnamed	Intermittent Stream/River	
Saline	599.95	Unnamed	Intermittent	

# CONFIDENTIAL

State / County	Approximate ROW Milepost	Waterbody Name	Intermittent, Perennial, Reservoir, or Lake	State Water Quality Classification
			Stream/River	
Saline	600.58	Dry Creek	Intermittent Stream/River	
Saline	600.88	Unnamed	Intermittent Stream/River	
Saline	601.62	Unnamed	Intermittent Stream/River	
Saline	603.14	Unnamed	Intermittent Stream/River	
Saline	604.5	Plummers Branch	Intermittent Stream/River	
Saline	604.61	Plummers Branch	Intermittent Stream/River	
Saline	604.63	Plummers Branch	Intermittent Stream/River	
Saline	604.7	Unnamed	Intermittent Stream/River	
Saline	605.85	Unnamed	Intermittent Stream/River	
Saline	607.94	Swan Creek	Perennial Stream/River	Aquatic Life Use; Agriculture Water Supply
Saline	609.69	Unnamed	Intermittent Stream/River	
Jefferson	611.2	Unnamed	Intermittent Stream/River	
Jefferson	611.53	Unnamed	Intermittent Stream/River	
Jefferson	612.24	Unnamed	Intermittent Stream/River	
Jefferson	613.4	Unnamed	Intermittent Stream/River	
Jefferson	616.38	Unnamed	Intermittent Stream/River	
Jefferson	617.19	Cub Creek	Perennial Stream/River	No Data
Jefferson	618.13	Unnamed	Intermittent Stream/River	
Jefferson	619.15	Unnamed	Intermittent Stream/River	
Jefferson	622.15	Unnamed	Intermittent Stream/River	
Jefferson	623.98	Big Indian Creek	Intermittent Stream/River	
Jefferson	625.8	Unnamed	Intermittent Stream/River	
Jefferson	628.11	Unnamed	Intermittent Stream/River	
Jefferson	628.16	Unnamed	Intermittent Stream/River	
Jefferson	629.47	Unnamed	Intermittent	

# CONFIDENTIAL

State / County	Approximate ROW Milepost	Waterbody Name	Intermittent, Perennial, Reservoir, or Lake	State Water Quality Classification
			Stream/River	
Jefferson	631.11	Unnamed	Intermittent Stream/River	
Jefferson	632.35	Unnamed	Intermittent Stream/River	
Jefferson	632.82	Unnamed	Intermittent Stream/River	
Jefferson	633.84	Unnamed	Intermittent Stream/River	
Jefferson	634.23	Unnamed	Intermittent Stream/River	
Jefferson	634.62	Unnamed	Intermittent Stream/River	
Jefferson	636.03	Unnamed	Intermittent Stream/River	
Jefferson	637.02	Unnamed	Intermittent Stream/River	
Jefferson	639.07	Horseshoe Creek	Intermittent Stream/River	
Jefferson	644	Unnamed	Intermittent Stream/River	
Jefferson	646.12	Little Indian Creek	Intermittent Stream/River	

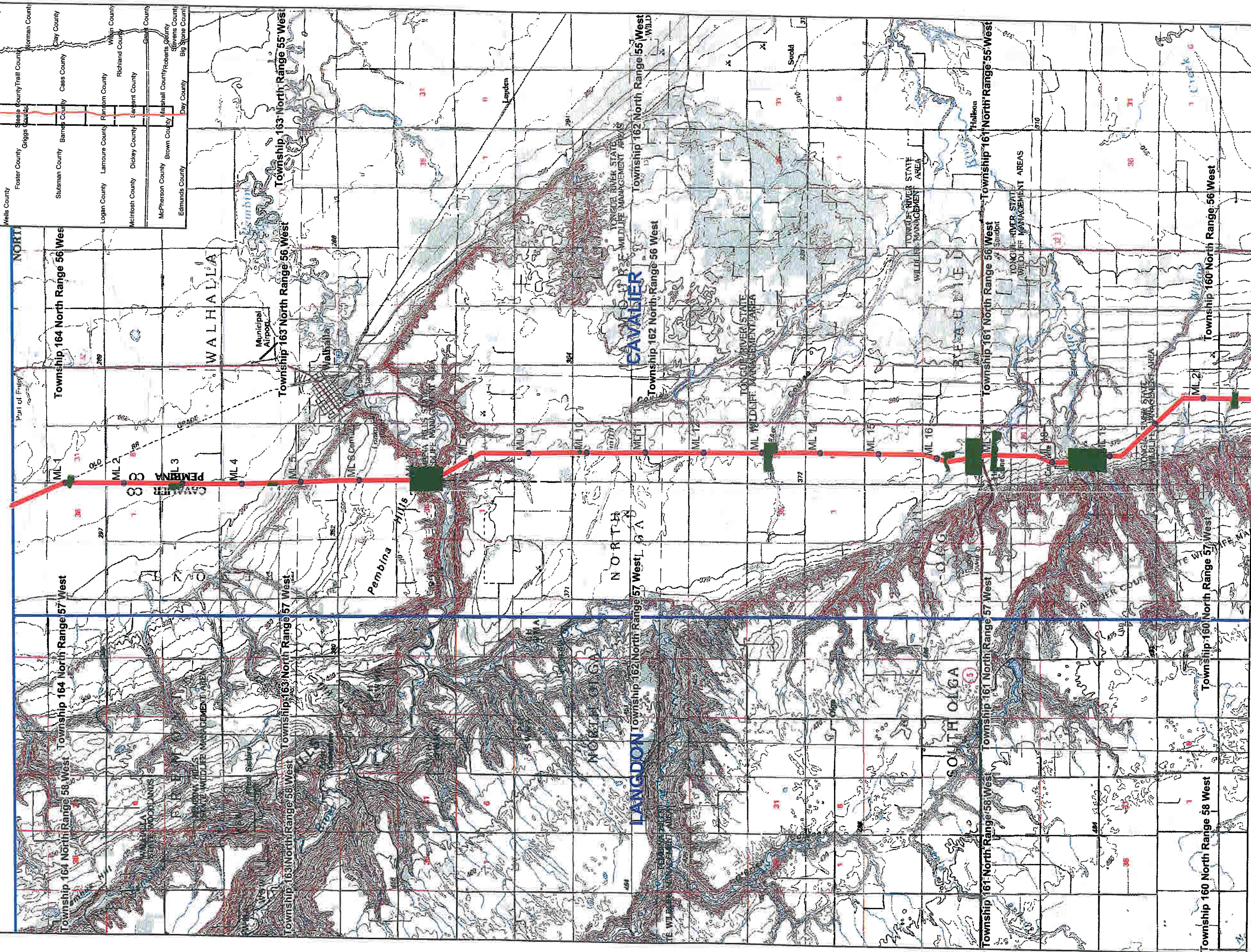
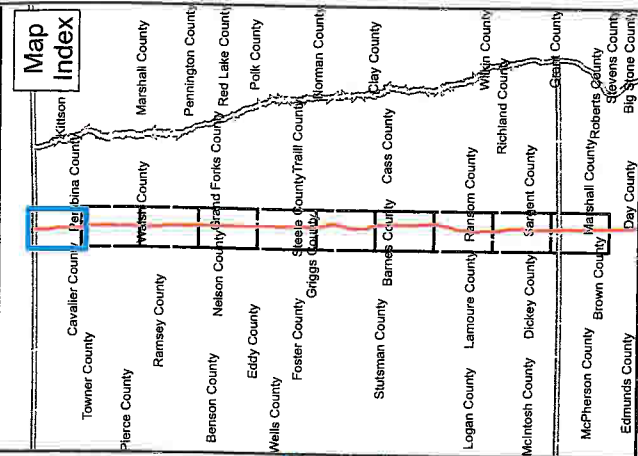

Keystone Pipeline Project

**TransCanada**  
In business to deliver

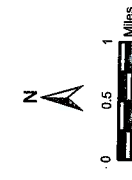

Proposed Wetland and Waterbody Survey Areas

Pipeline

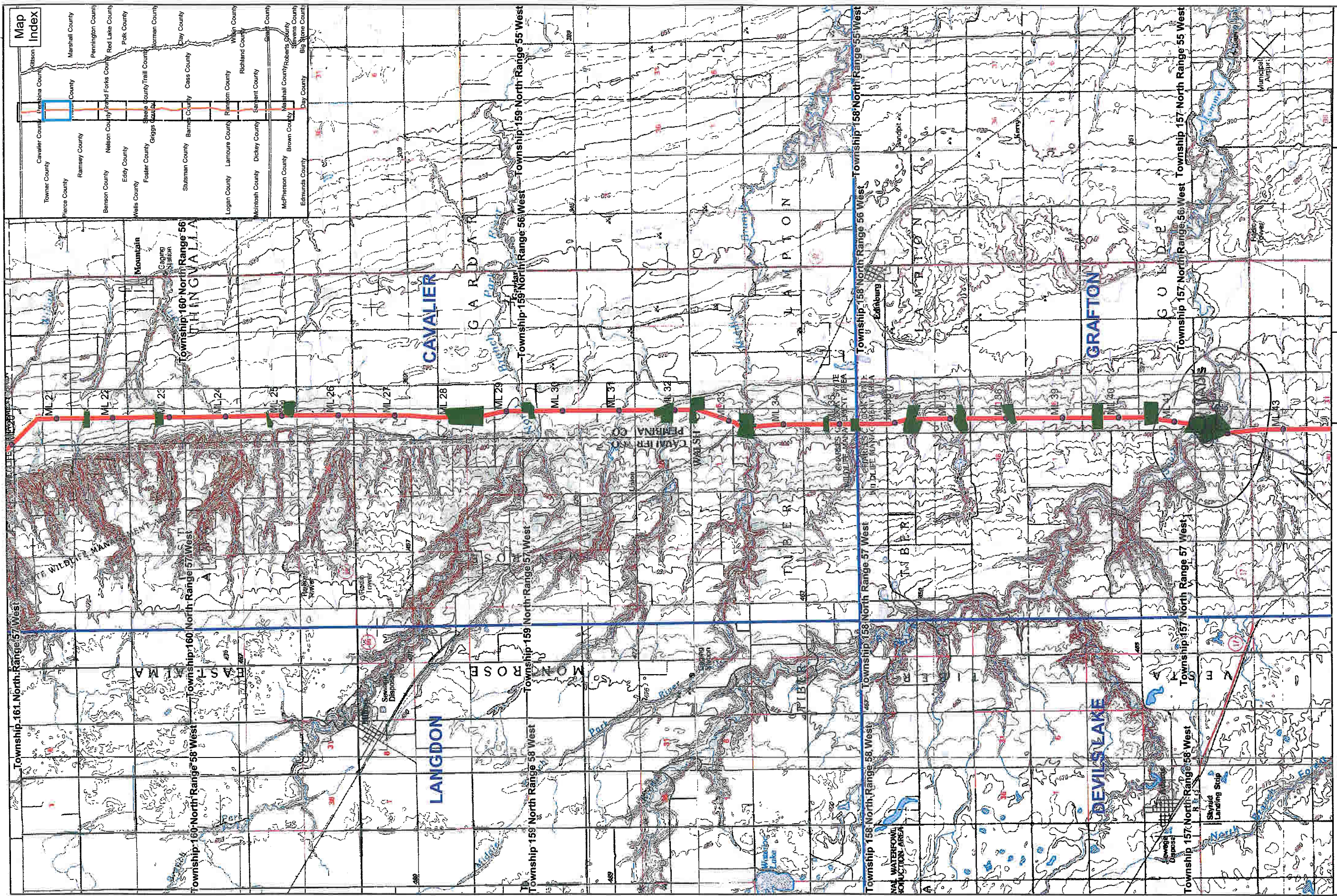

**Map Index**

Towner County	Cavalier County	Franklin County	Killbuck County
Pierce County	Ramsey County	Marshall County	
Benson County	Nelson County	Grand Forks County	Pennington County
Eddy County	Wells County	Red Lake County	Folk County
Foster County	Sheep County	Trail County	Norman County
Stutsman County	Barnes County	Cass County	Clay County
Logan County	Lamoure County	Ransom County	Williston County
Mountrail County	Dickey County	Sargent County	Richland County
McPherson County	Brown County	Marshall County	Roberts County
Edmunds County	Big Stone County		

**Legend**

- Pipeline
- Proposed Wetland and Waterbody Survey Areas

**Map 2 of 10**  
Land Access Areas (North Dakota)

**Keystone Pipeline Project**  
**TransCanada**  
*In business to deliver*

Scale: 0, 0.5, 1 Miles

Handwritten: **BAEA - WEST - AVOID**



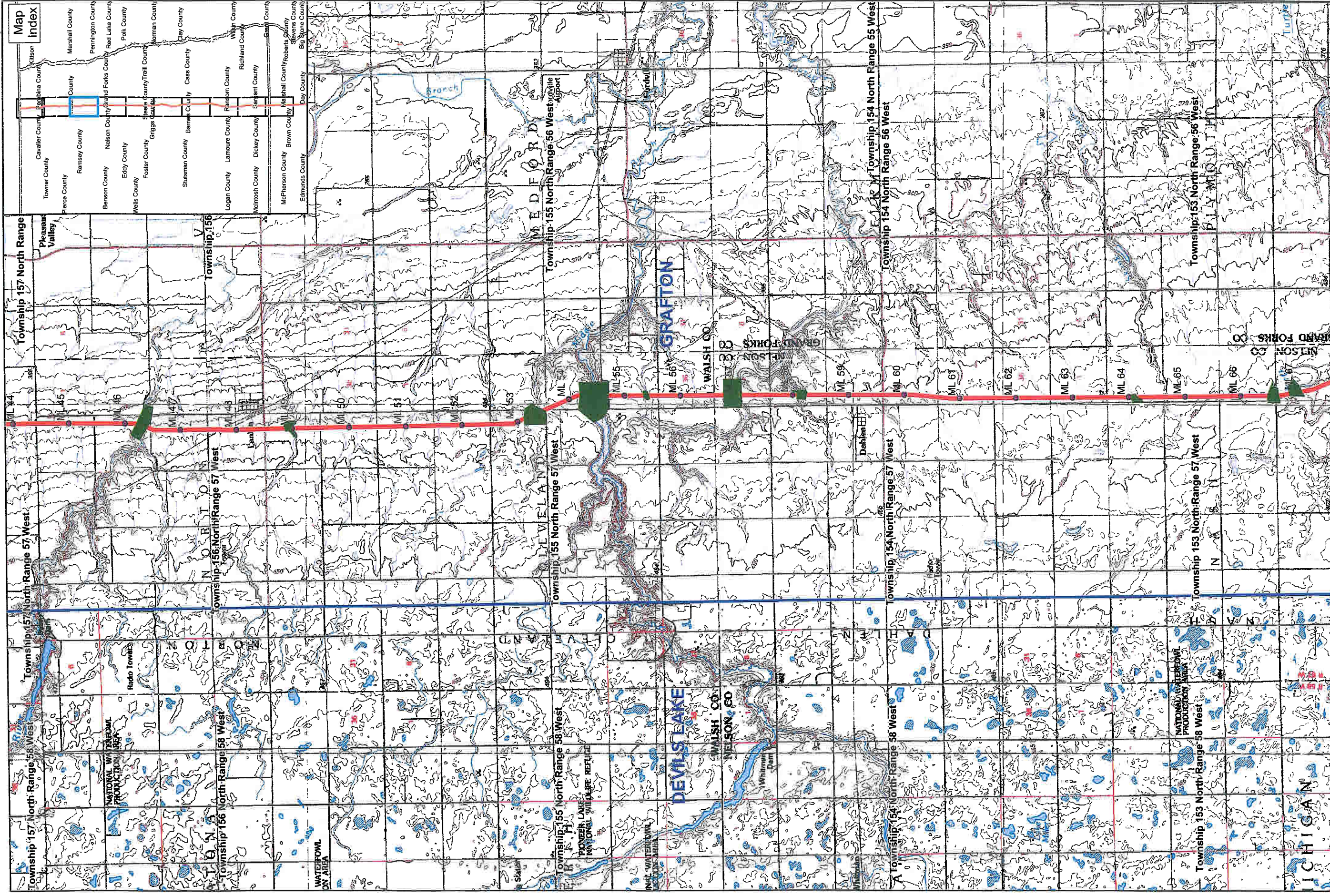

Pipeline  
Proposed Wetland and Waterbody Survey Areas





Keystone Pipeline Project

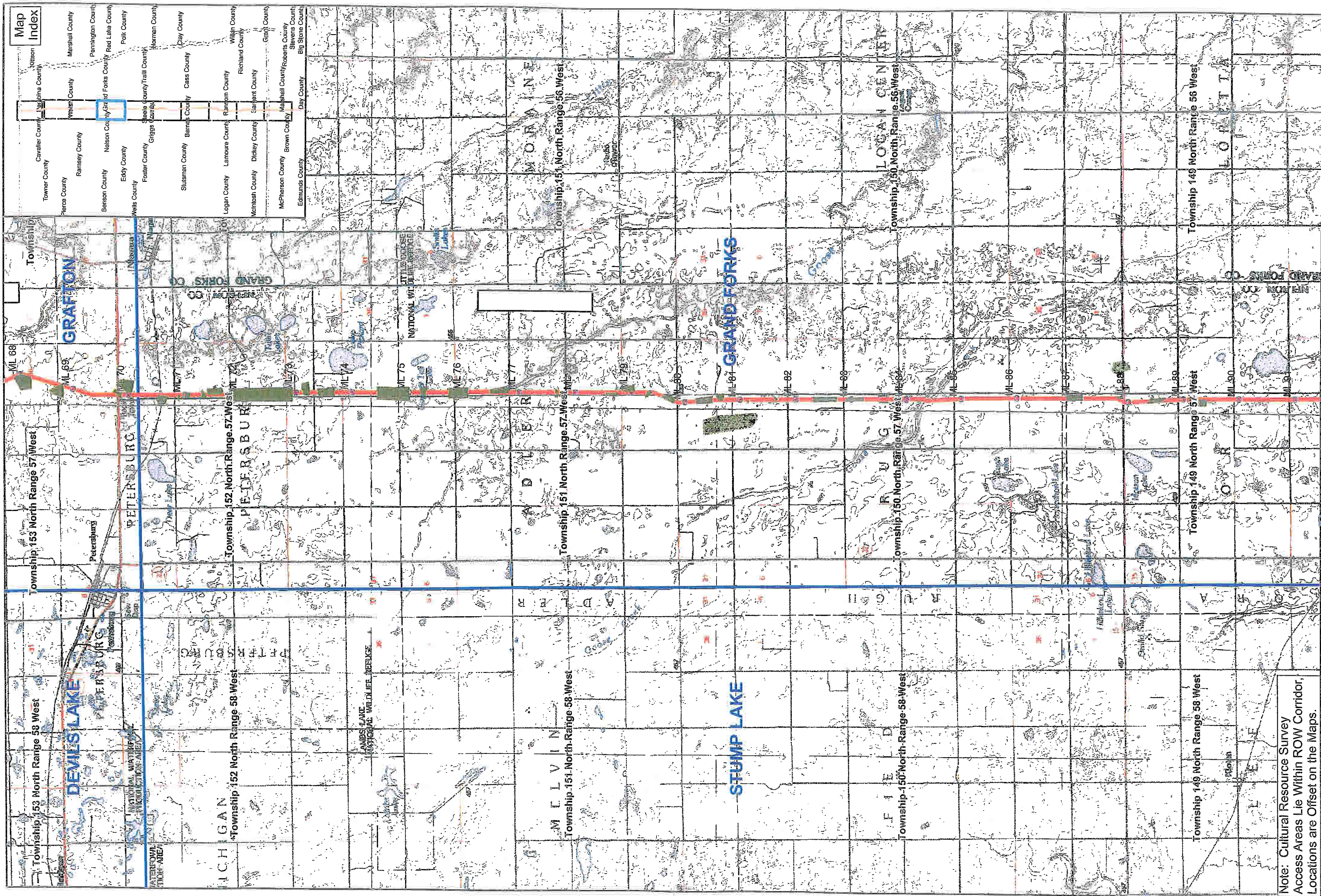

Map 3 of 10  
Land Access Areas  
(North Dakota)



Note: Cultural Resource Survey Access Areas Lie Within ROW Corridor, Locations are Offset on the Maps.

-  Pipeline
-  Biological Surveys Access Permission Request Areas
-  Cultural Resource 100% Pedestrian Survey (Class II)
-  Cultural Resource Limited Access Survey (Class I)

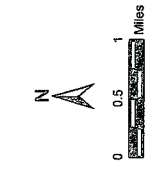

Keystone Pipeline Project



TransCanada  
In business to deliver

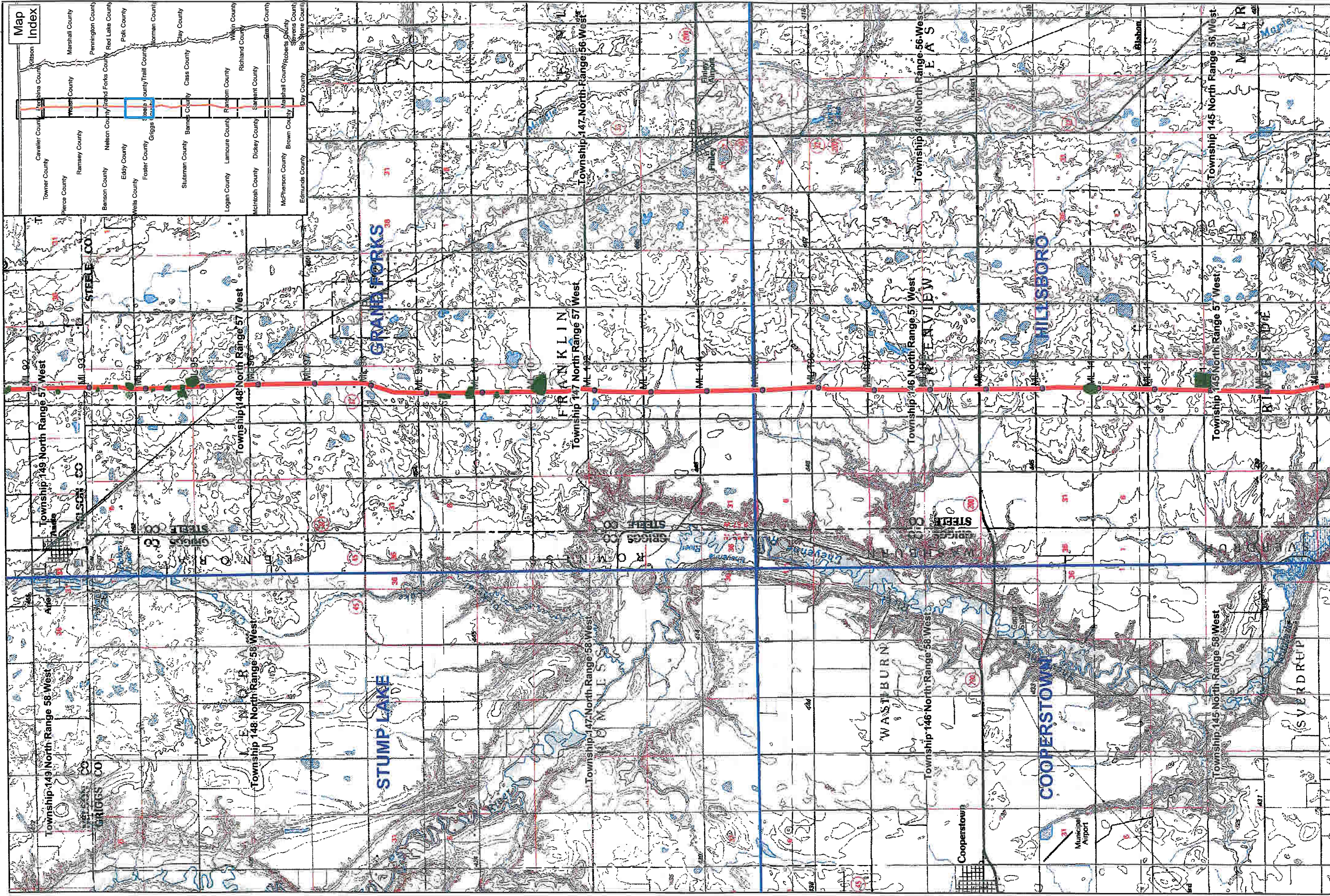

Pipeline  
Proposed Wetland and Waterbody Survey Areas

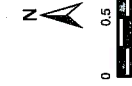

Keystone Pipeline Project  
  
In business to deliver

Map 5 of 10  
 Land Access Areas  
 (North Dakota)

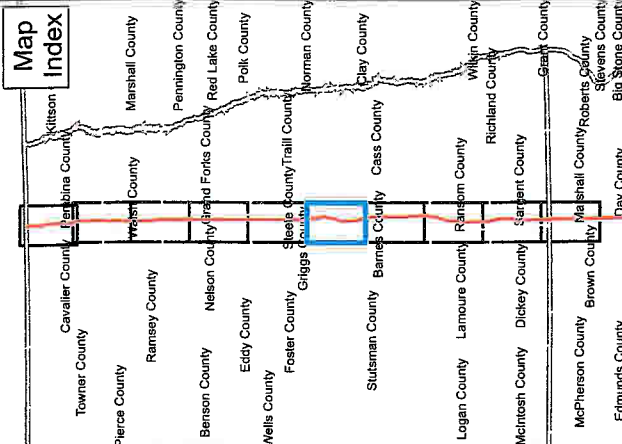
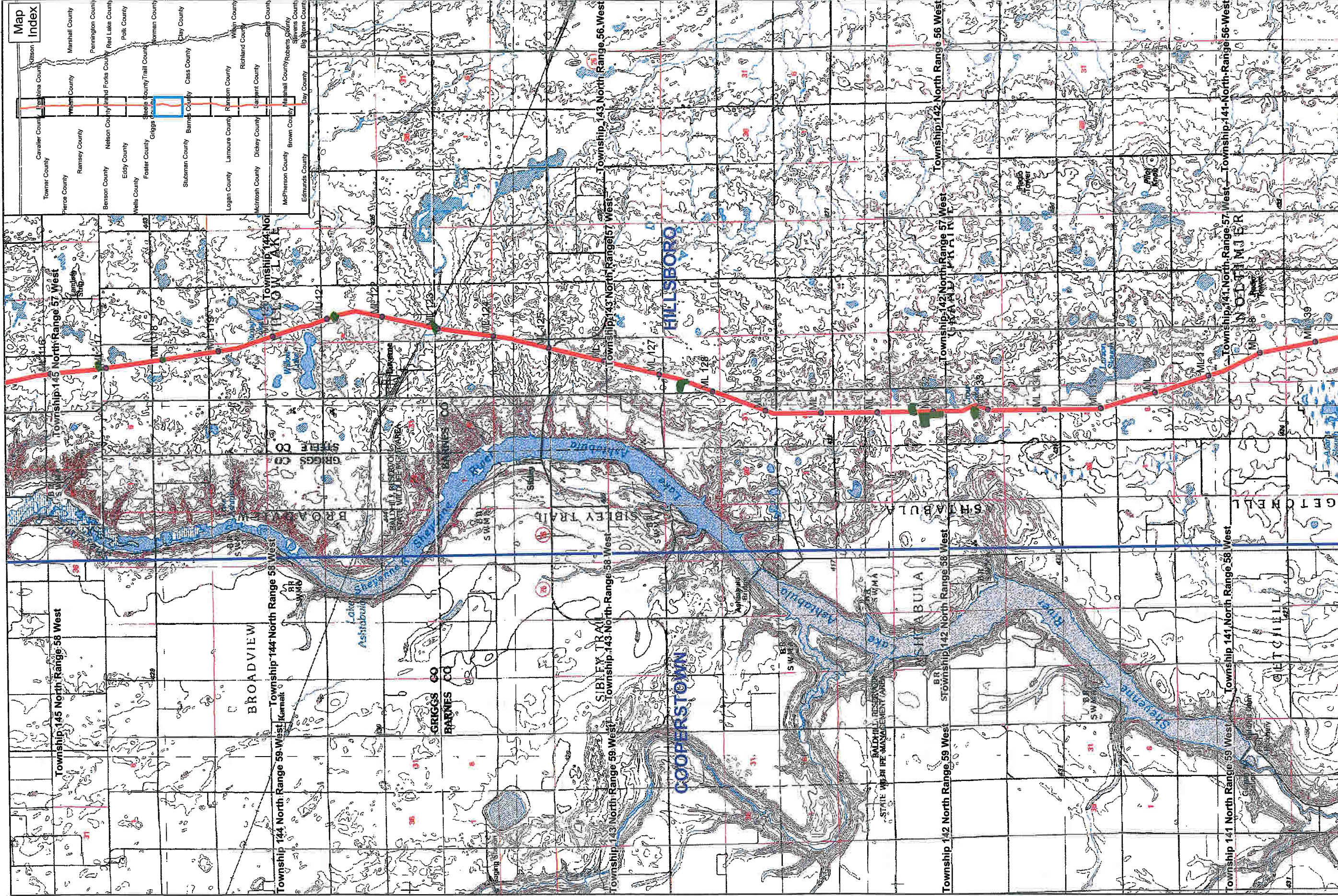

 Pipeline  
 Proposed Wetland and Waterbody Survey Areas

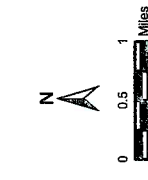

Keystone Pipeline Project  
  
 TransCanada  
*In business to deliver*

Map 6 of 10  
 Land Access Areas  
 (North Dakota)

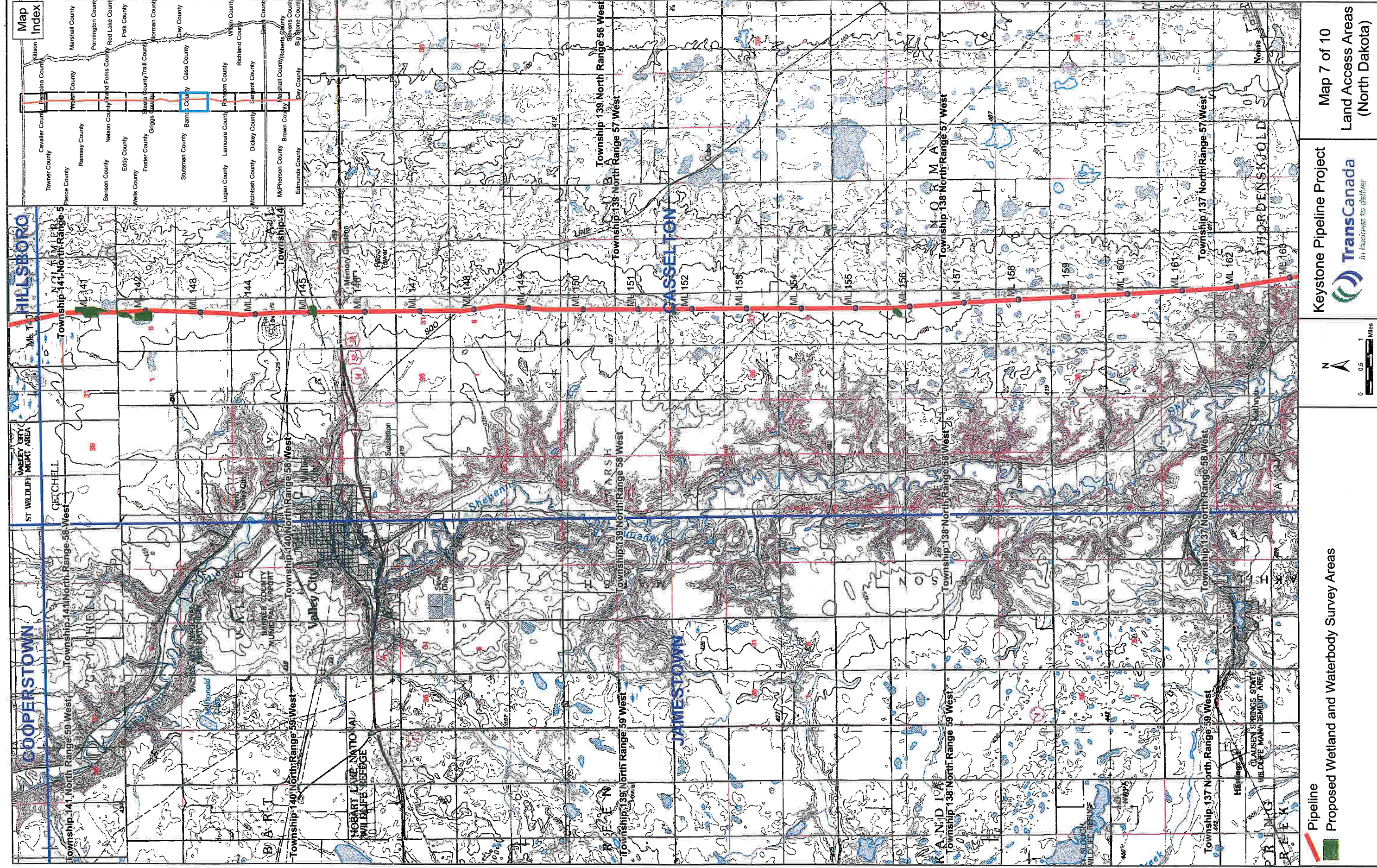

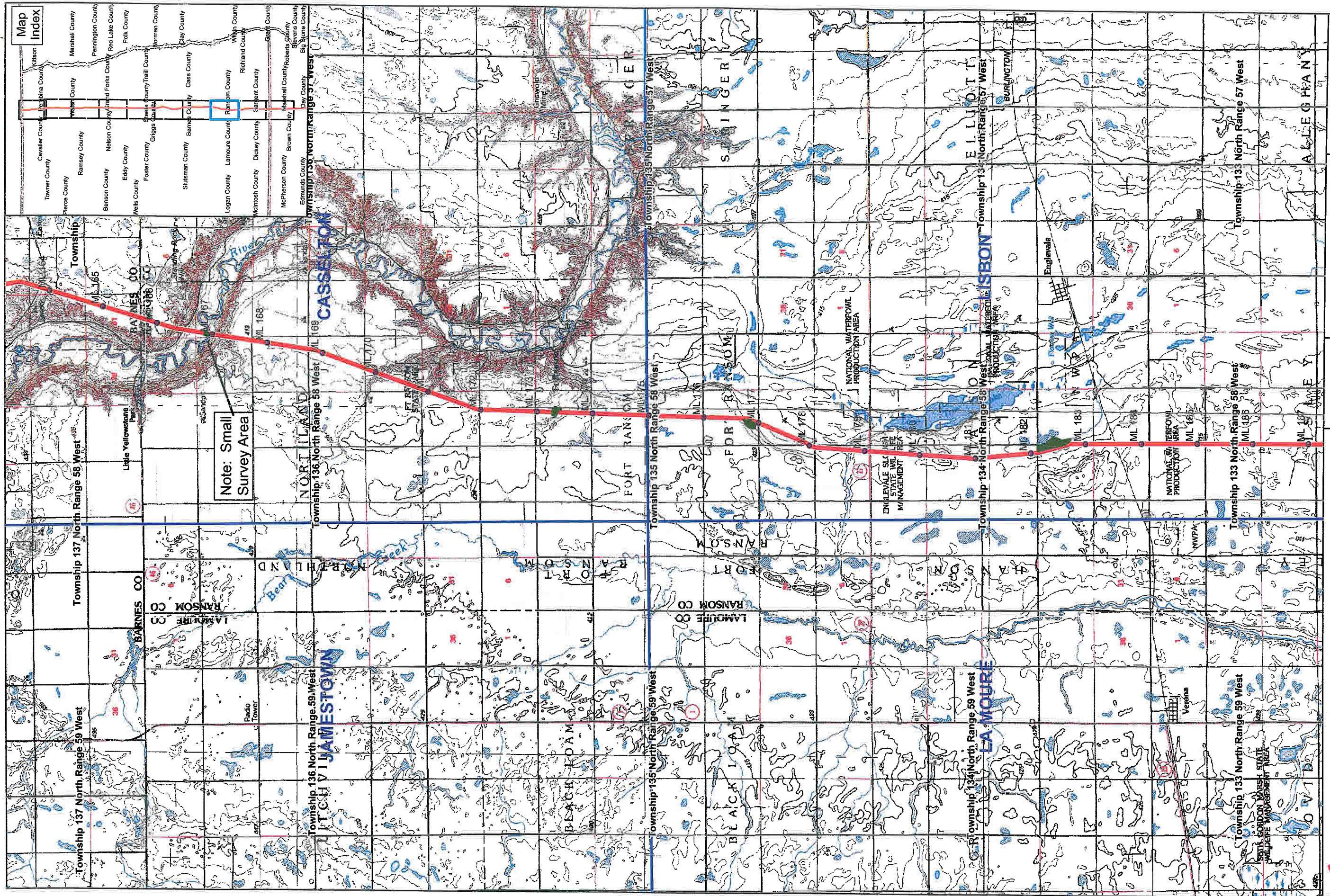

Note: Small Survey Area

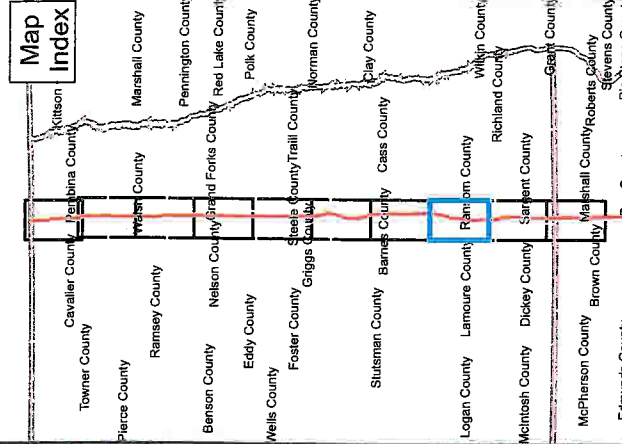

Pipeline  
 Proposed Wetland and Waterbody Survey Areas

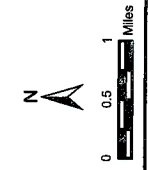

Keystone Pipeline Project  
 TransCanada  
 In business to deliver

Map 8 of 10  
 Land Access Areas  
 (North Dakota)

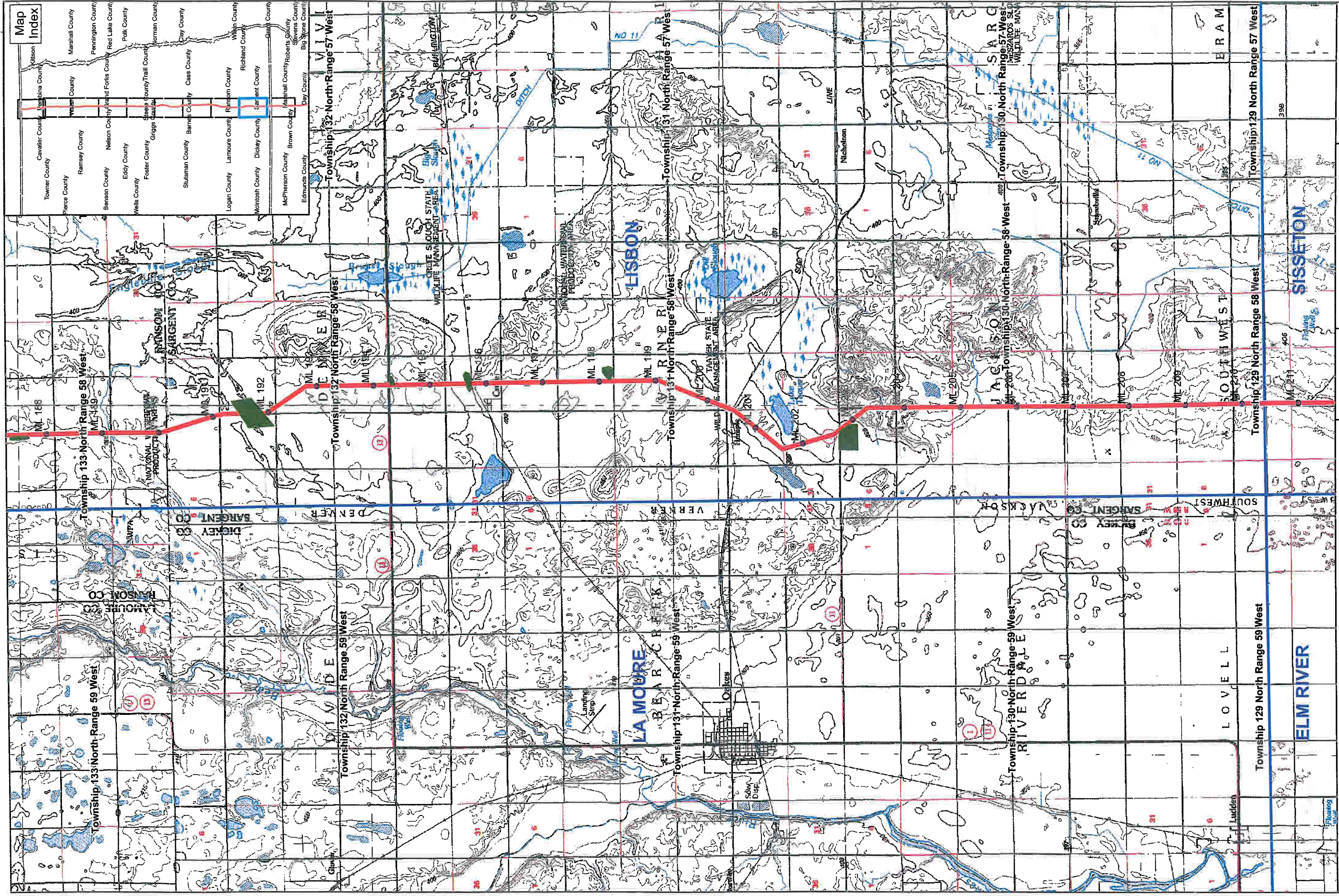

Map Index

Towner County	Cavaller County	Pierce County	Benson County	Wells County	Stutsman County	Logan County	McPherson County
Walton County	DeBona County	Ramsay County	Nelson County	Foster County	Stutsman County	Logan County	Edmunds County
Marshall County	Walton County	Ramsay County	Nelson County	Eddy County	Stutsman County	Logan County	Edmunds County
Pennington County	Walton County	Ramsay County	Nelson County	Eddy County	Stutsman County	Logan County	Edmunds County
Red Lake County	Walton County	Ramsay County	Nelson County	Eddy County	Stutsman County	Logan County	Edmunds County
Polk County	Walton County	Ramsay County	Nelson County	Eddy County	Stutsman County	Logan County	Edmunds County
Norman County	Walton County	Ramsay County	Nelson County	Eddy County	Stutsman County	Logan County	Edmunds County
Clay County	Walton County	Ramsay County	Nelson County	Eddy County	Stutsman County	Logan County	Edmunds County
Williston County	Walton County	Ramsay County	Nelson County	Eddy County	Stutsman County	Logan County	Edmunds County
Grand County	Walton County	Ramsay County	Nelson County	Eddy County	Stutsman County	Logan County	Edmunds County
Richland County	Walton County	Ramsay County	Nelson County	Eddy County	Stutsman County	Logan County	Edmunds County
Sargent County	Walton County	Ramsay County	Nelson County	Eddy County	Stutsman County	Logan County	Edmunds County
McPherson County	Walton County	Ramsay County	Nelson County	Eddy County	Stutsman County	Logan County	Edmunds County
Edmunds County	Walton County	Ramsay County	Nelson County	Eddy County	Stutsman County	Logan County	Edmunds County
Stevens County	Walton County	Ramsay County	Nelson County	Eddy County	Stutsman County	Logan County	Edmunds County
Big Stone County	Walton County	Ramsay County	Nelson County	Eddy County	Stutsman County	Logan County	Edmunds County

Pipeline  
Proposed Wetland and Waterbody Survey Areas

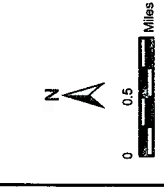

Keystone Pipeline Project  
TransCanada  
In business to deliver

Map 9 of 10  
Land Access Areas  
(North Dakota)

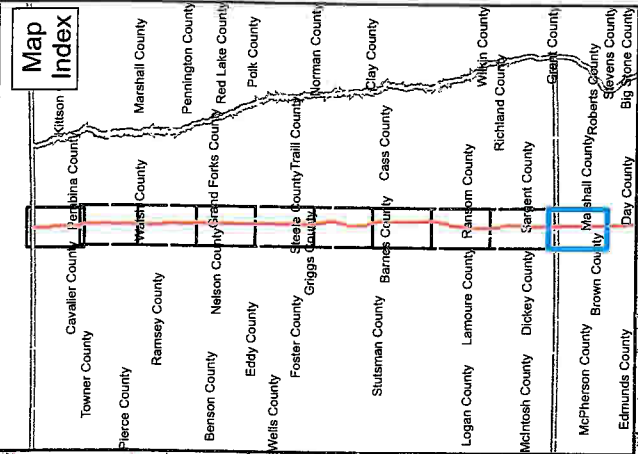
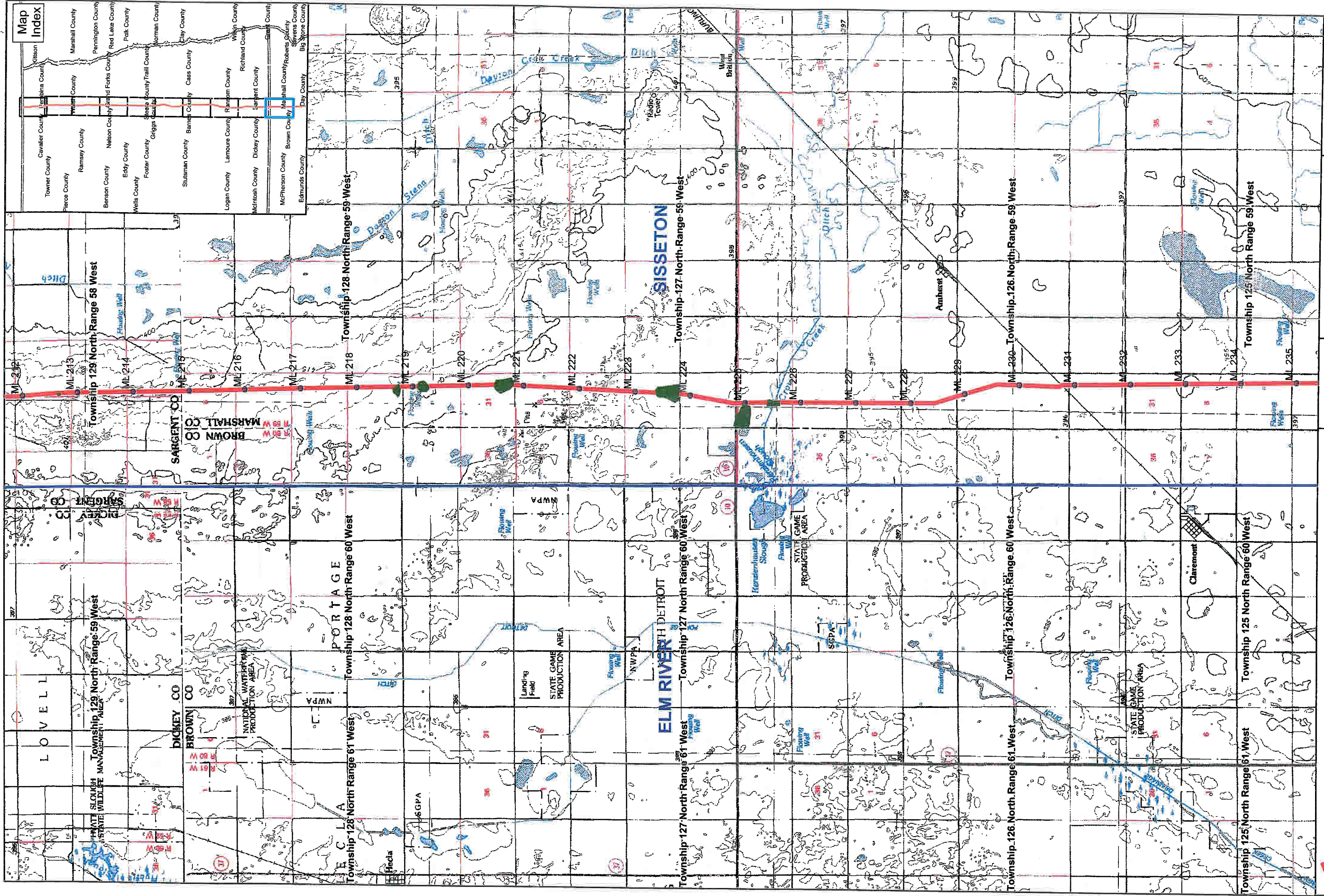

 Pipeline  
 Proposed Wetland and Waterbody Survey Areas

Keystone Pipeline Project



Map 10 of 10  
Land Access Areas  
(North Dakota)

